

## IMPORTANT

Carefully remove all the parts from the carton and place them individually on a soft cloth to prevent scratches or other damage.

Carefully and strictly follow these assembly instructions to ensure a completed product as designed.

Do not use power tools above 8 volts to assemble.

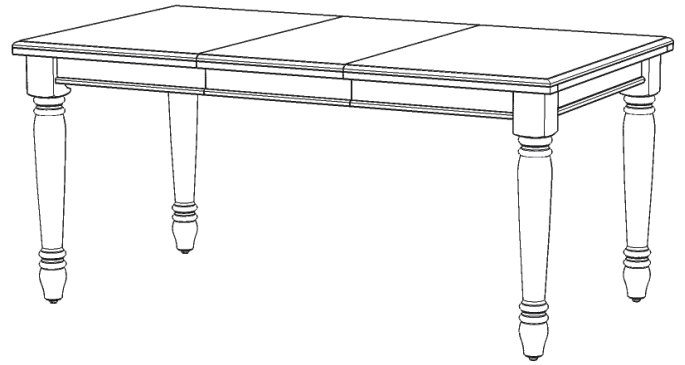

## Part List

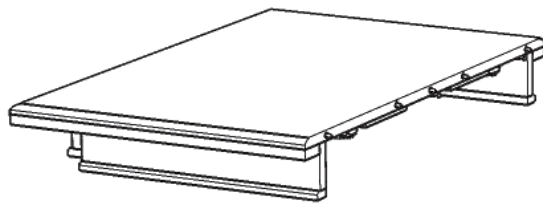

A.  
Top  
1 pc.

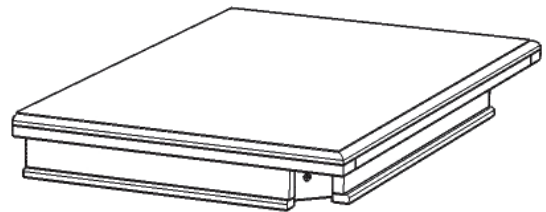

B.  
Top  
1 pc.

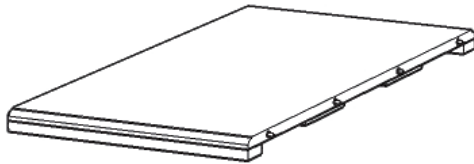

C.  
Leaf  
1 pc.



D.  
Apron  
2 pcs.



E.  
Leg  
4 pcs.

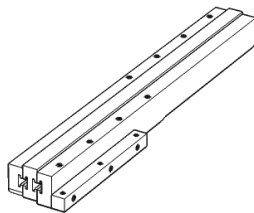

F.  
Table Slide  
2 pcs.

## Hardware List

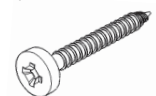
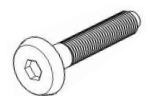
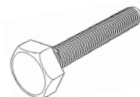
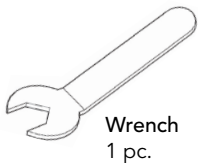

Tool(s) required for assembly: Phillips screwdriver, Level

## Assembly Instructions 2/4

### IMPORTANT

- Use a soft cloth between these parts and the floor.
- Do not use power tools above 8 volts to assemble.
- Do not tighten all the bolts until each part is properly assembled.
- The unit must be level to work properly. Use the included adjustable levelers to level.
- Keep Hex Wrench and Wrench as the bolts may need to be tightened in the future.

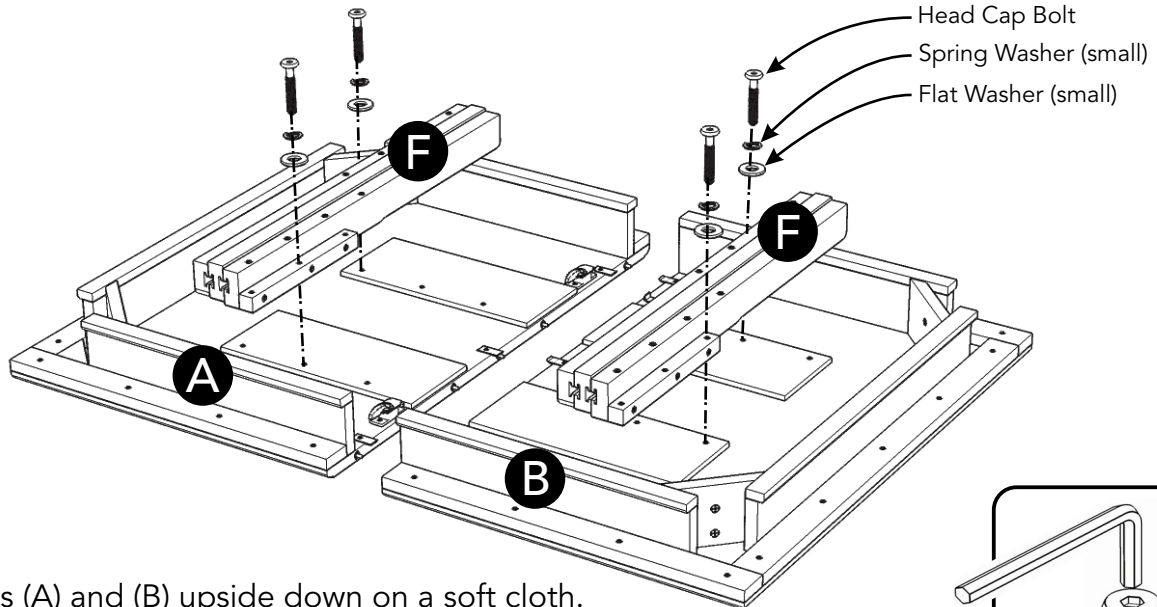

### STEP 1

Place Tops (A) and (B) upside down on a soft cloth.

Remove Table Slides (F) from their packing position by removing Head Cap Bolts, Spring Washers (small) and Flat Washers (small). (See Figure 1)

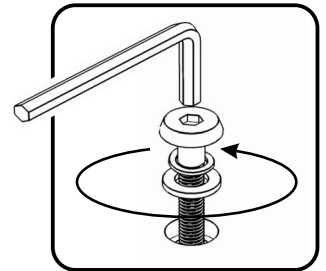

Figure 1

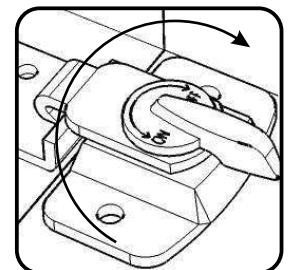
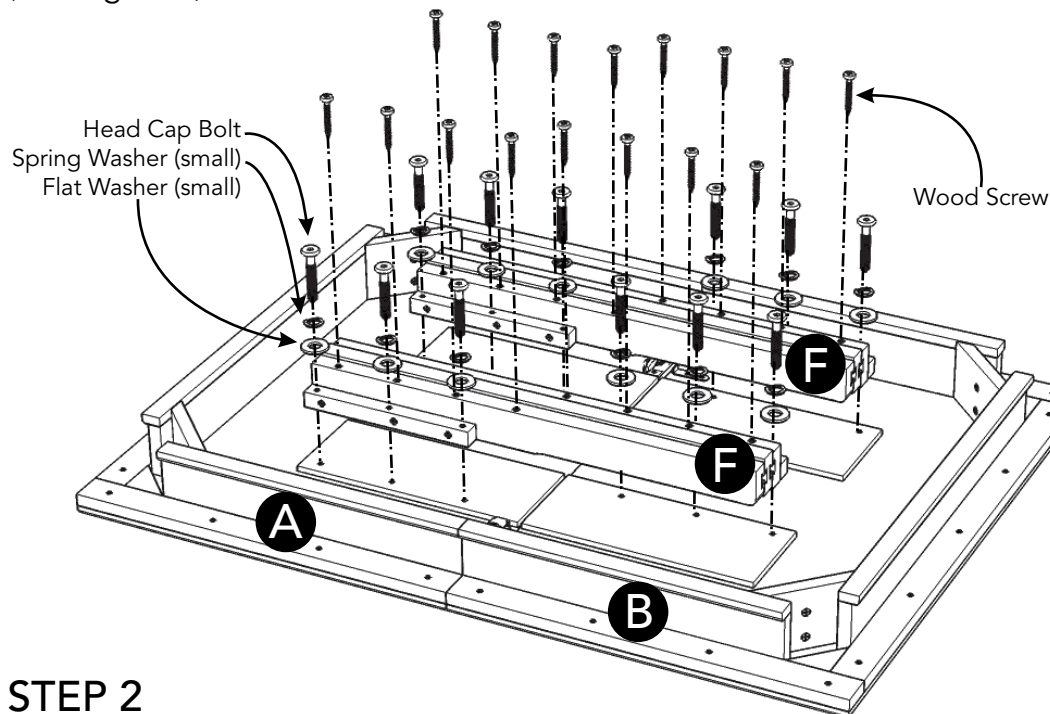

Figure 2

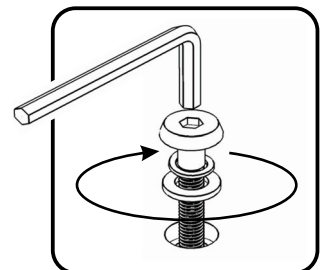

Figure 3

### STEP 2

Attach Tops (A) and (B) by aligning metal pins with holes and firmly pushing together.

Engage locks by turning lock handles clockwise 1/4 turn. (See Figure 2)

Attach Table Slides (F) to unit with Flat Washers (small), Spring Washers (small), Head Cap Bolts and Wood Screws. (See Figures 3 and 4)

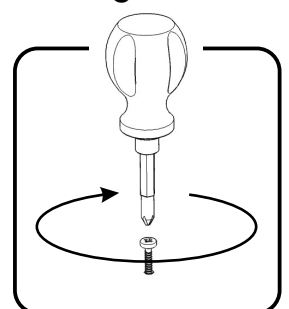

Figure 4

## Assembly Instructions 3/4

### STEP 3

Attach Legs (E) to unit with Flat Washers, Spring Washers and Bolts. (See Figure 5)

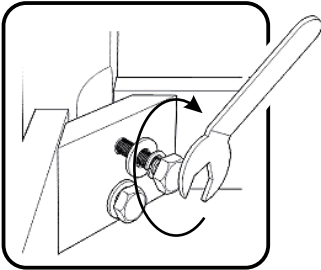
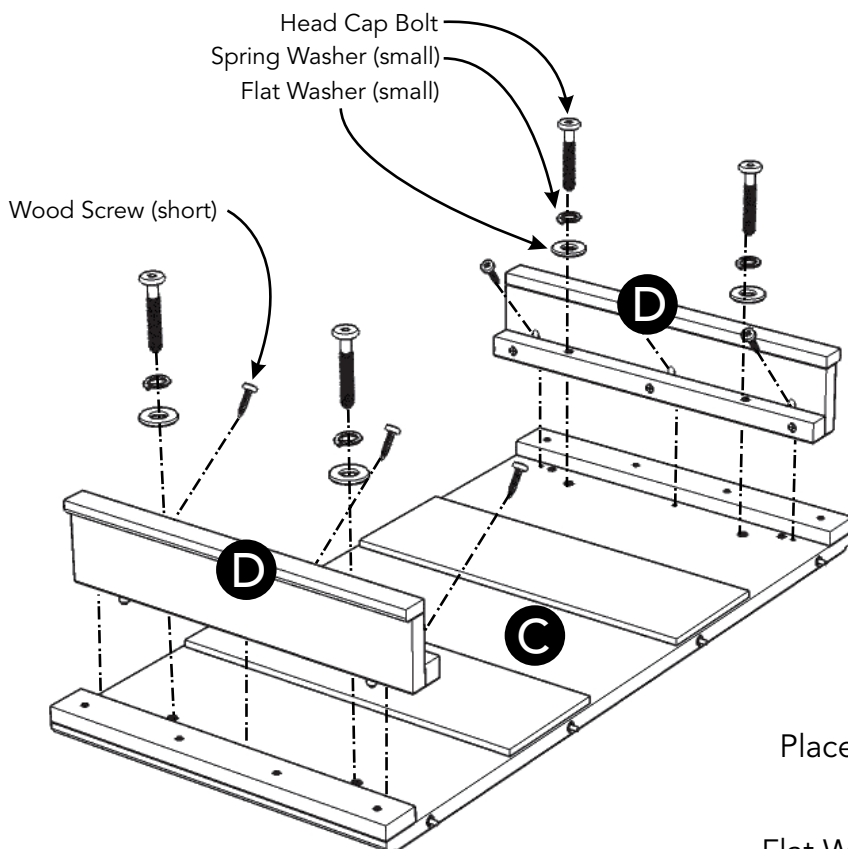
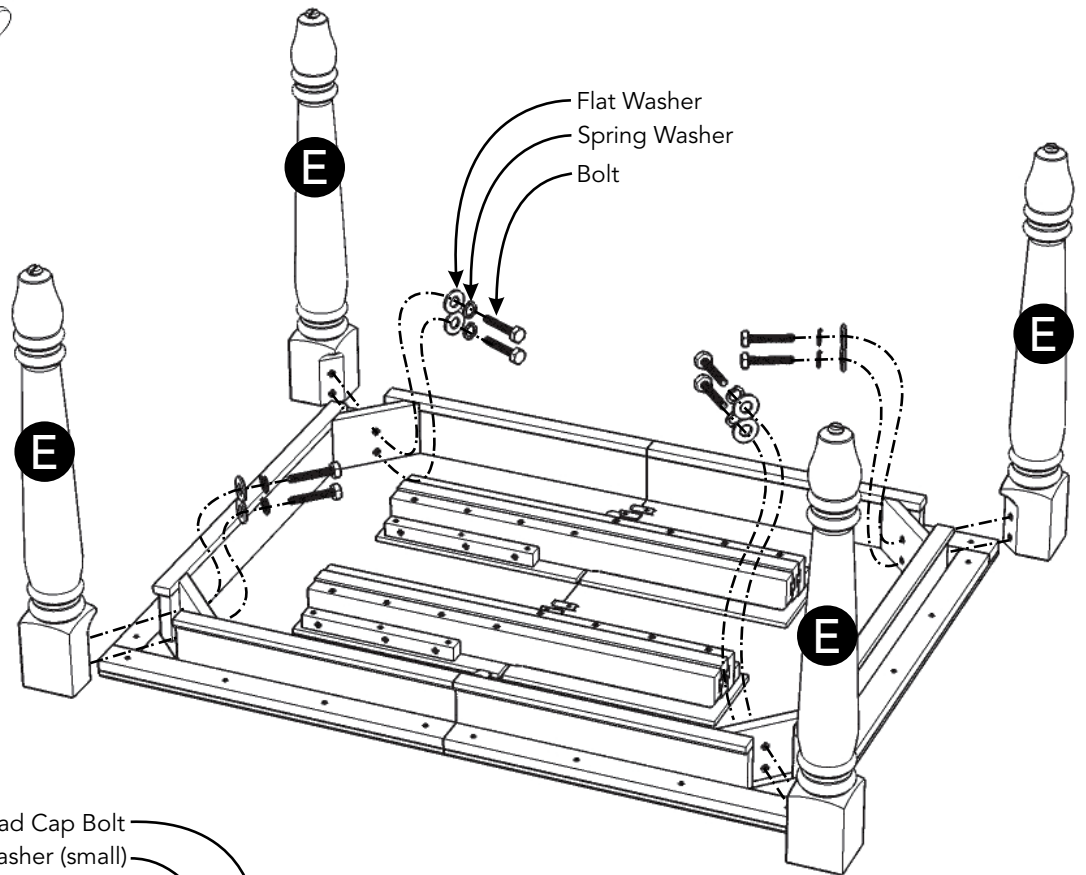

Figure 5



### STEP 4

Place Leaf (C) upside down on a soft cloth.

Attach Aprons (D) to Leaf (C) with Flat Washers (small), Spring Washers (small), Head Cap Bolts and Wood Screws (short).

## Assembly Instructions 4/4

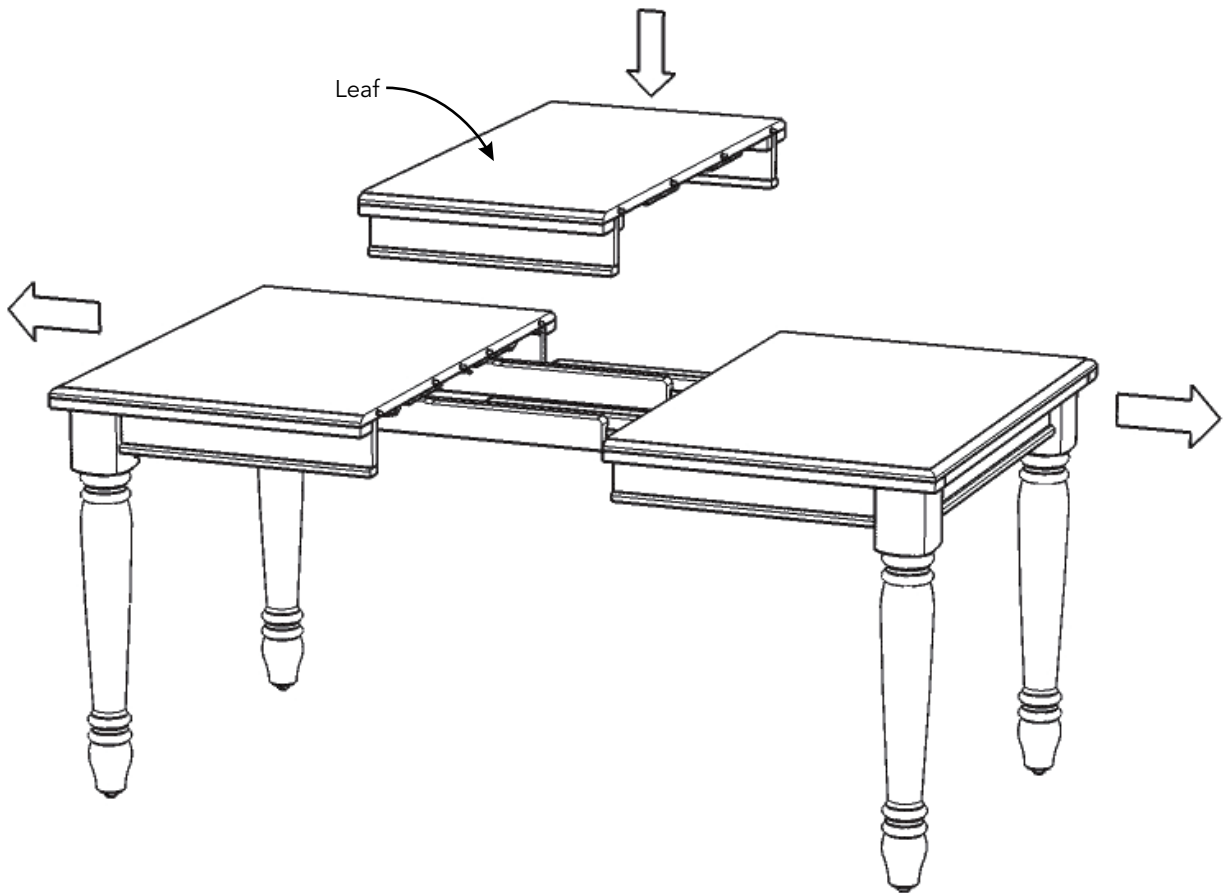

### STEP 5

Turn table over to its' upright position.

Disengage locks by turning lock handles counter-clockwise 1/4 turn. (See Figure 6)

Pull out both ends of table, then place leaf in unit as shown, aligning metal pins with holes.

Push table together firmly, then engage locks by turning lock handles clockwise 1/4 turn.

Level unit by adjusting the adjustable levelers on bottom of legs. (See Figure 7)

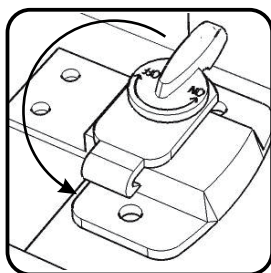

Figure 6

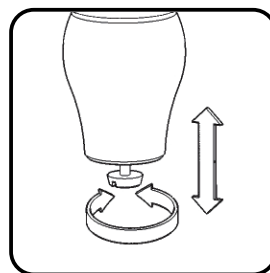

Figure 7