

PARTS LIST		
QTY	PART NUMBER	DESCRIPTION
5	7046	CEILING HOOK
10	7190	SLEEVE SCREW
10	7191	SLEEVE
1	7201	HEX KEY
12	7213	CONNECTING BOLT
4	7254	1-1/4" LONG SCREW
1	80047L	LEFT SIDE
1	80047R	RIGHT SIDE
1	80060	SHELF
1	80061	TOP PANEL
4	80062	DIVIDER
1	80063	HANGING STRIP
1	80063NH	HANGING STRIP - NO HOLES
2	80064	BACK



CAUTION: CHOKING HAZARD

Adult assembly required due to the presence of small parts and sharp edges.

Questions? Please call:

1-800-346-6313

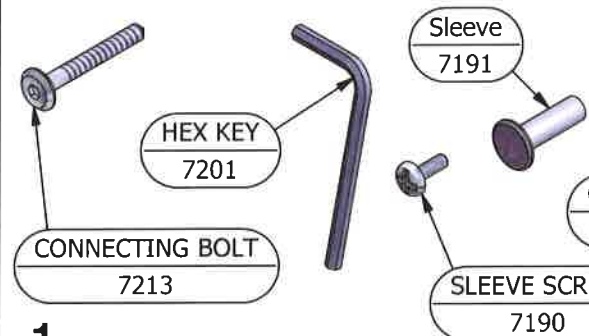

1

Attach the left side to the top, shelf and bottom using 6 connecting bolts. Be sure the slots for the dividers are facing UP and the slots for the back panels are aligned.

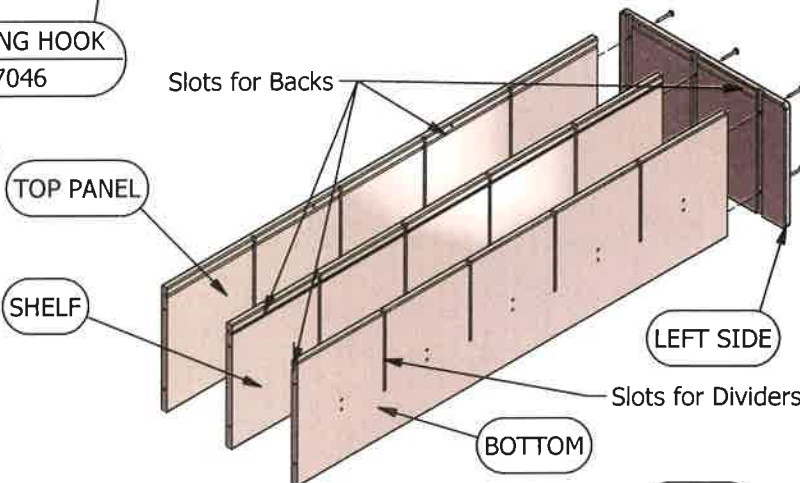
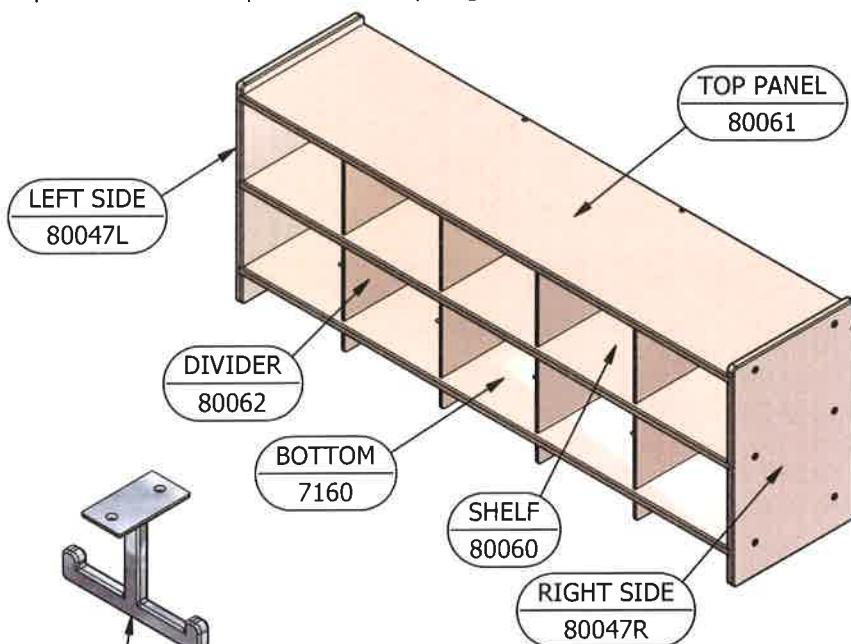

2

Slide the dividers into the slots in the top, shelf and bottom as shown. Be sure each divider is completely in the slots in each panel.

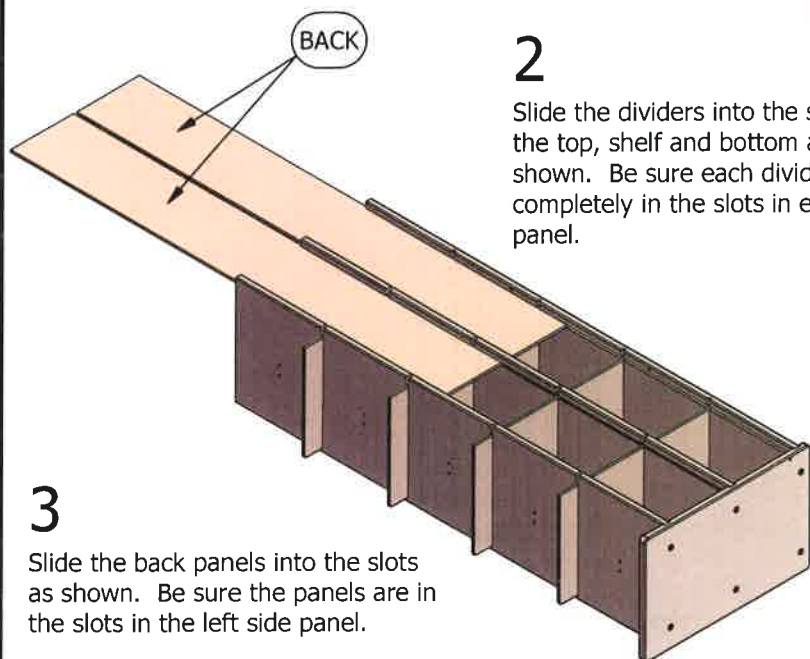

3

Slide the back panels into the slots as shown. Be sure the panels are in the slots in the left side panel.

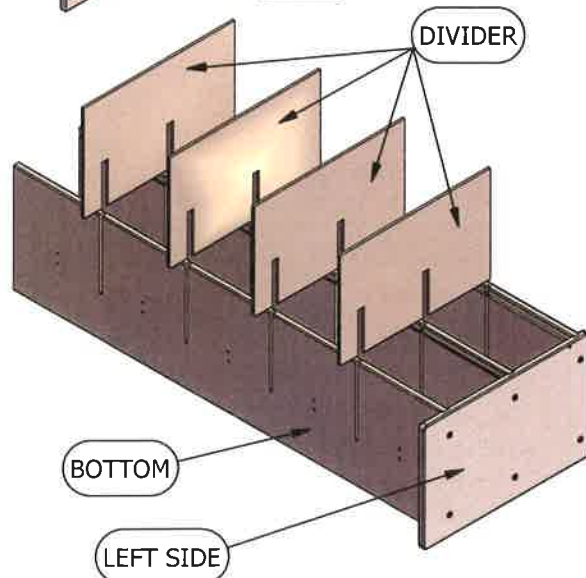

4

Attach the right side using 6 connecting bolts. Be sure the top, shelf, bottom and back panels are in the slots in the side panel. Go back and make sure all bolts are tight in both side panels.

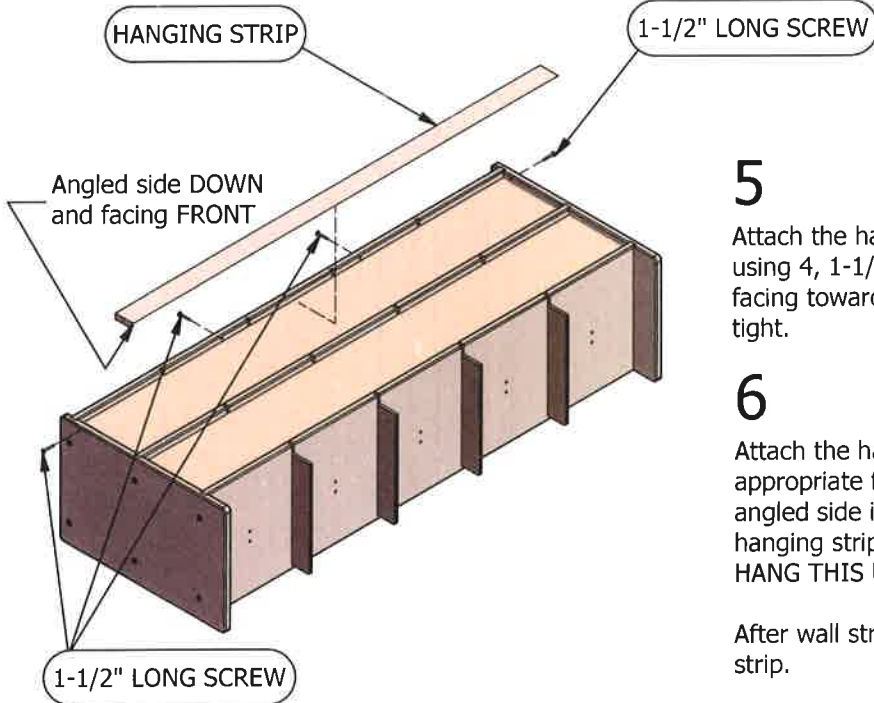
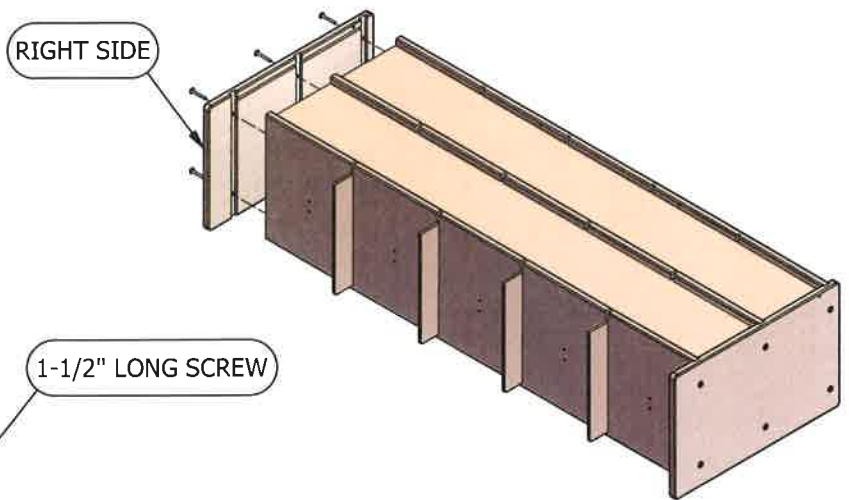

5

Attach the hanging strip (with holes) to the top and side panels using 4, 1-1/4" long screws. The angled side on the strip must be facing towards the FRONT of the cabinet. Be sure all screws are tight.

6

Attach the hang strip to the wall using fasteners that are appropriate for your building construction. Be sure the angled side is facing UP and the angle is facing the wall. The hanging strip MUST be attached to a wall stud. DO NOT HANG THIS UNIT ON DRYWALL ONLY!!

After wall strip is securely in place, lift the cabinet onto the strip.

CHECK ALL SCREWS PERIODICALLY TO MAKE SURE THEY ARE TIGHT!!

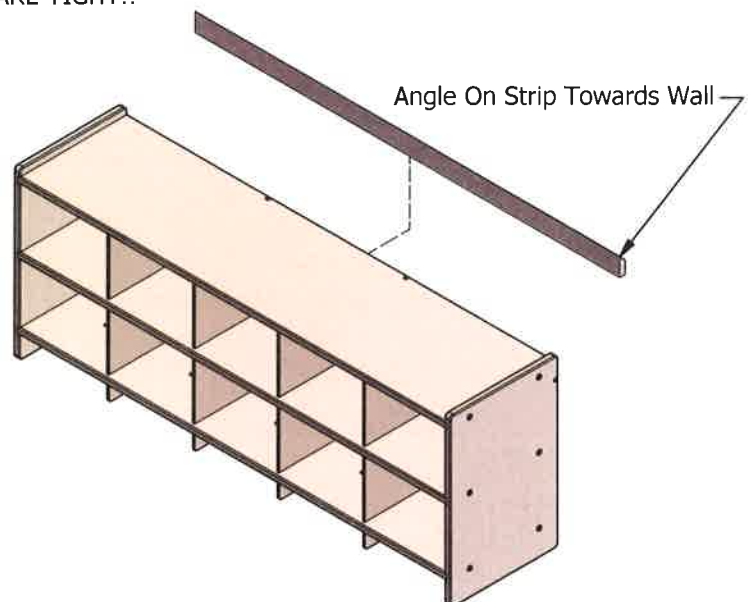

7

Attach the 5 coat hooks onto the bottom panel. Place a sleeve through each hole and attach each hook as shown. Be sure all screws are tight.

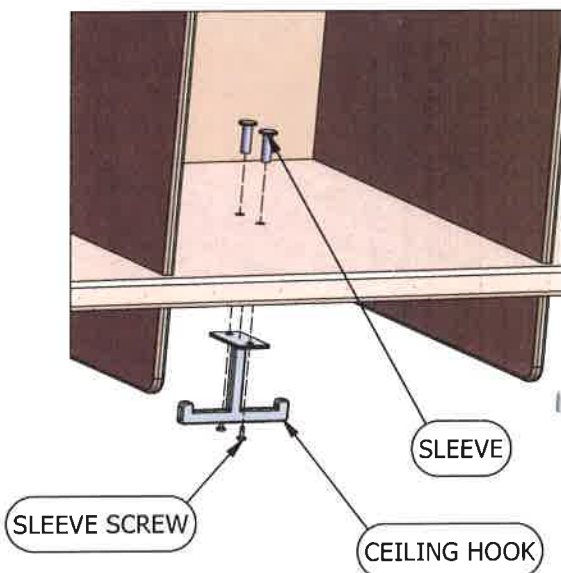

WARNING: It is critical that the hanging strip is fastened to the wall correctly. The cabinet may fall off the wall if installed incorrectly. We recommend you consult a building professional if you are unsure of the correct fastener.