



BOERBOEL[®]
Gate Solutions

Cable Latch Installation Instructions



Read all instructions prior to installing product.

Refer to manufacturers safety instructions when operating any tools.

To register your product, please visit:

BoerboelGateSystems.com

⚠ WARNING:

- Improper installation of this product can result in personal injury. Always wear safety goggles when cutting, drilling and assembling the product.
- Incorrect installation may cause harm to the gate or individual.

NOTICE:

- DO NOT attempt to assemble the kit if parts are missing or damaged.
- DO NOT return the product to the store, for assistance or replacement parts call: 1-800-336-2383.

Component list:

QTY	Description
1	Latch with Cable
1	Striker
1	Striker Bracket
5	1/4" Lag Screws

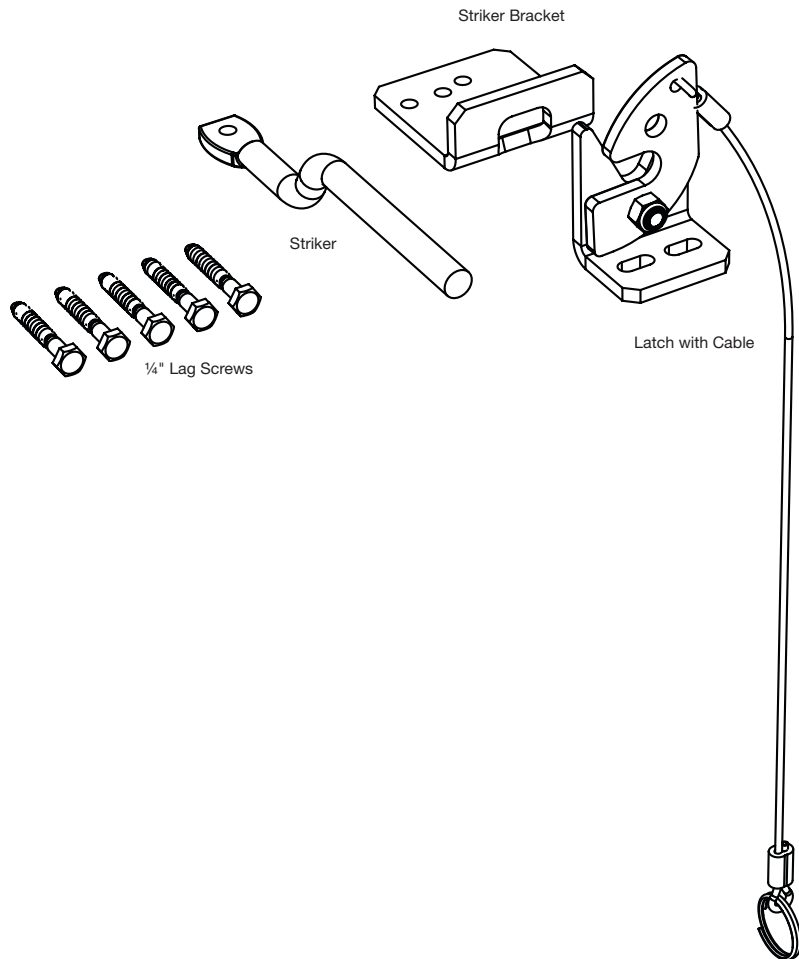

1

Determine Latch Specifications for Clearance:

- a. The Cable Latch requires a latch clearance of 1 1/2" - 4" and works with a post size of 2"+ and upright size of 3"+ (Fig. 1).

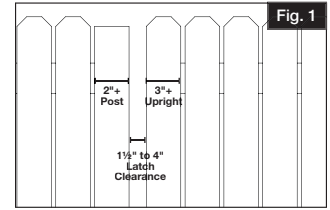

2

Determine Latch Location:

NOTE: Latch should be on the same side as the hinges.

- a. With gate closed, align latch on post and mark screw locations (Fig. 2).
- b. Drill 5/32" pilot holes on the post for latch location (Fig. 3).

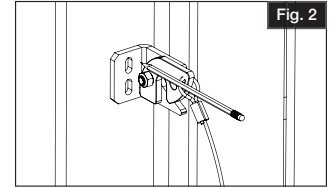

3

Mount Latch on Post:

- a. Install latch to post with screws provided.

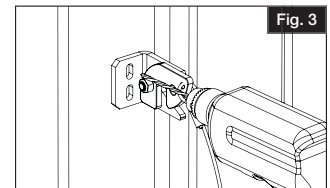

4

Drill Hole for Cable and Install:

- a. Open catch to determine cable hole position and mark (Fig. 4). Drill 1/2" hole through the post (Fig. 5).
- b. Unclip the ring and push the cable through the hole
- c. Clip the ring to the cable (Fig. 6).

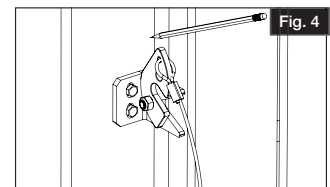

5

Determine Striker Location:

- a. Align striker on gate. Striker bracket should be no more than 1/2" above latch to allow for gate sag. Mark screw locations. Lower middle hole should be marked for striker; upper middle hole will not be drilled (Fig. 7).

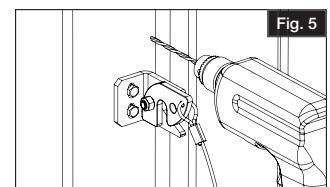

6

Mount Striker on Gate

- a. Drill 5/32" pilot holes on the gate for striker bracket location (Fig. 8). Lower middle hole should be drilled for striker.
- b. Install striker to gate with provided screws and tighten (Fig. 9). Striker bar screw should not be overtightened to allow bar to "float" or move.

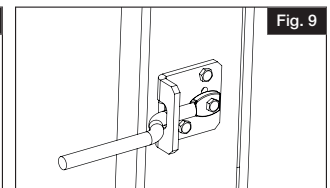
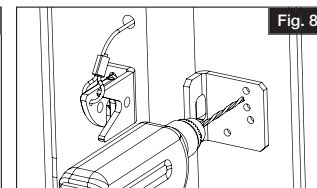
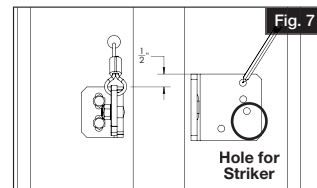
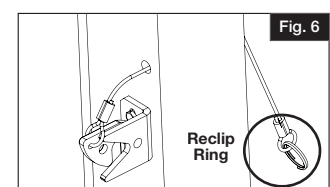

BARRETTE OUTDOOR LIVING

7830 FREEWAY CIRCLE
MIDDLEBURG HEIGHTS, OHIO 44130

TEL: (800) 336-2383
WWW.BOERBOELGATESYSTEMS.COM



BOERBOEL[®]
Gate Solutions

