

K81-120-BL
K81-120-WH
K81-120-BWH
K81-120-RWH

△ REQUIRES ITEM 14

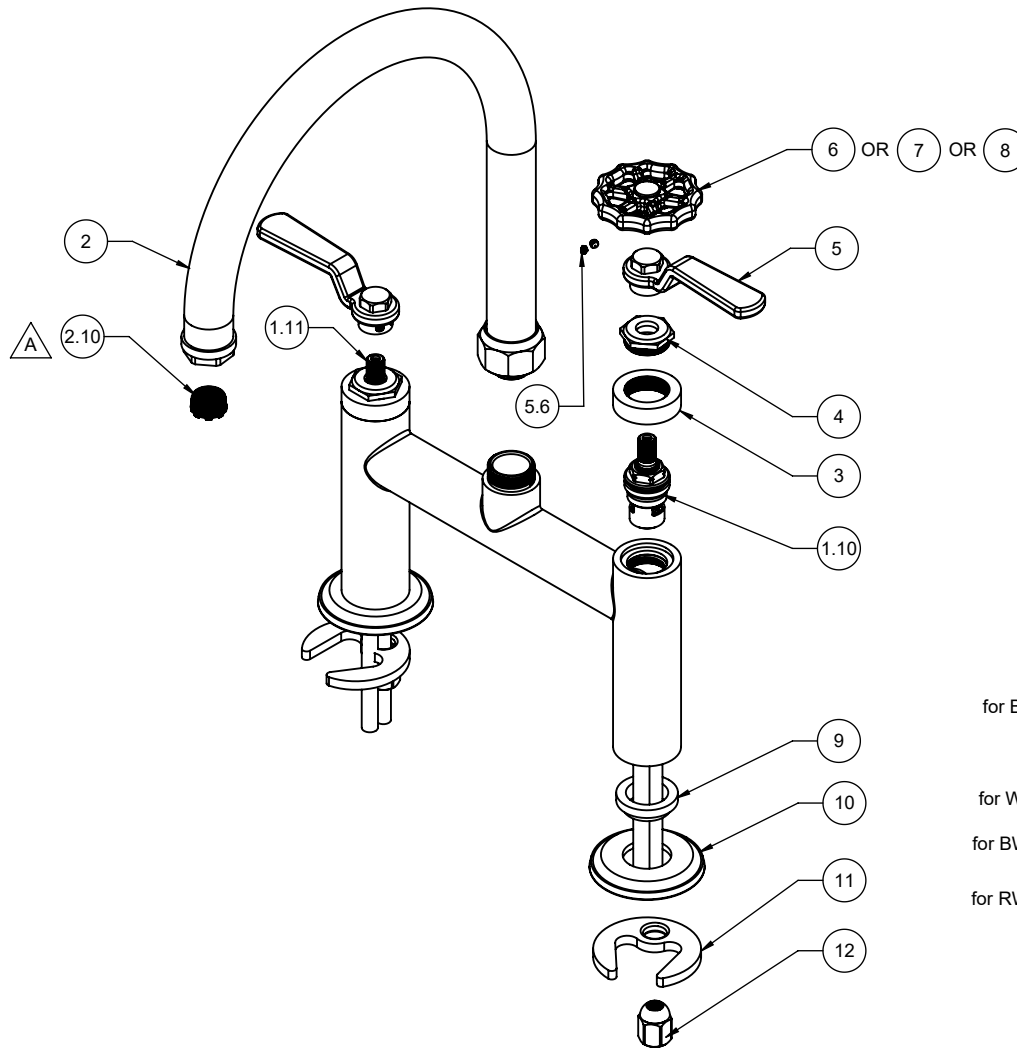

ITEM	PART NO	DESCRIPTION	QTY.
1.10	880431-99	CART 1/2" 16-T W/FRICTION BRG M24X1 MALE THD - LTC "NL"	1
1.11	880430-99	CART 1/2" 16-T W/FRICTION BRG M24X1 MALE THD - RTC "NL"	1
2	7-100440-ZZ	ASM, SPOUT, HEX TIP BRIDGE KIT <i>(incl. 2.10)</i>	1
2.10	880527-81	INSERT, 1.75 GPM, TJ AERATED (PCA CACHE)	1
3	11005-ZZ	SLEEVE, BRIDGE HEX CART	2
4	11008-ZZ	HEX, BRIDGE CART CAP	2
for BL series	5	7-100536-ZZ ASM, BALL LEVER HDL <i>(incl. 5.6)</i>	2
5.6	86170-WW	SETSCREW 8-32 X 1/8" SCKT CONE PT SS	2
for WH series	6	7-100465-ZZ ASM, SPOKED WHEEL <i>(incl. 5.6)</i>	1
for BWH series	7	7-100465B-ZZ ASM, SPOKED WHEEL - BLACK <i>(incl. 5.6)</i>	1
for RWH series	8	7-100465R-ZZ ASM, SPOKED WHEEL - RED <i>(incl. 5.6)</i>	1
9	11143-98	SLEEVE, BRIDGE CONT LEG	2
10	50760-ZZ	RING, SCALLOPED AIR SWITCH BASE	2
11	880309-98	MOUNTING BRACKET, SINGLE HOLE CRESCENT	2
12	10184-98	NUT, HEX W/ DOME	2
for ITEM 5.6	13	882042-99 KEY, ALLEN, 5/64", BLACK	1
for ITEM 2.10	14	880079-99 KEY, TJ AERATED CACHE	1