

# How to Adjust Euro Hinges

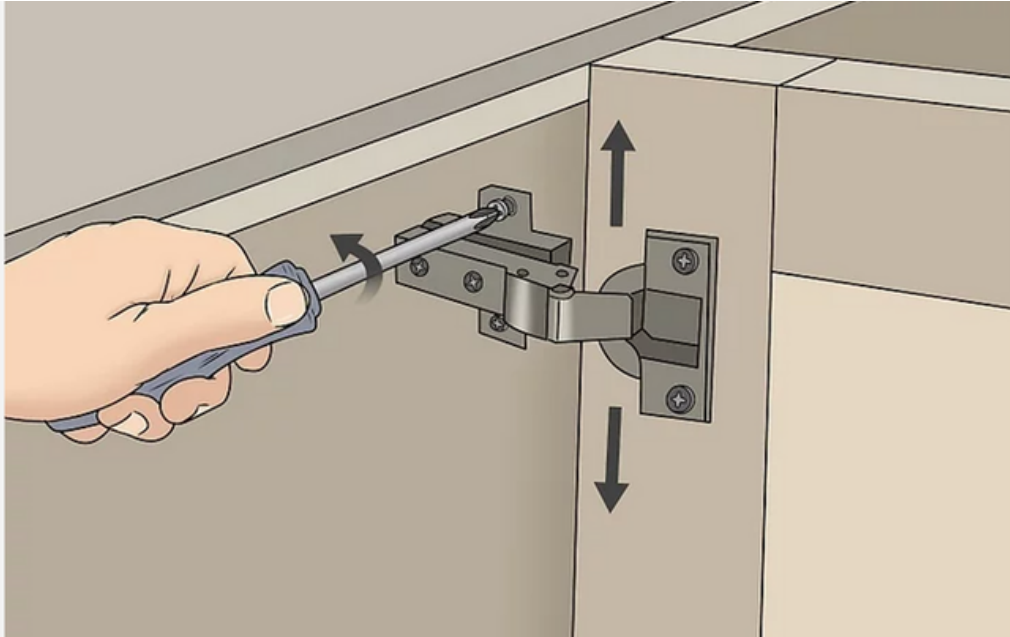

**1** Use the upper and lower screws to move the door vertically. Each hinge has a pair of screws oriented vertically. One will be above the hinge and the other will be below it. Turn these screws counterclockwise to loosen them until you are able to move the door up or down. Tighten the screws back up when you're done with the adjustment.

- Try to keep the door flush with the bottom of the cabinet and about 4 mm (0.16 in) from the top of the cabinet. That is the perfect height for most cabinet doors.
- The door will be unsteady when you loosen the screws for this adjustment, so keep a firm grip on it until you're done tightening them again.

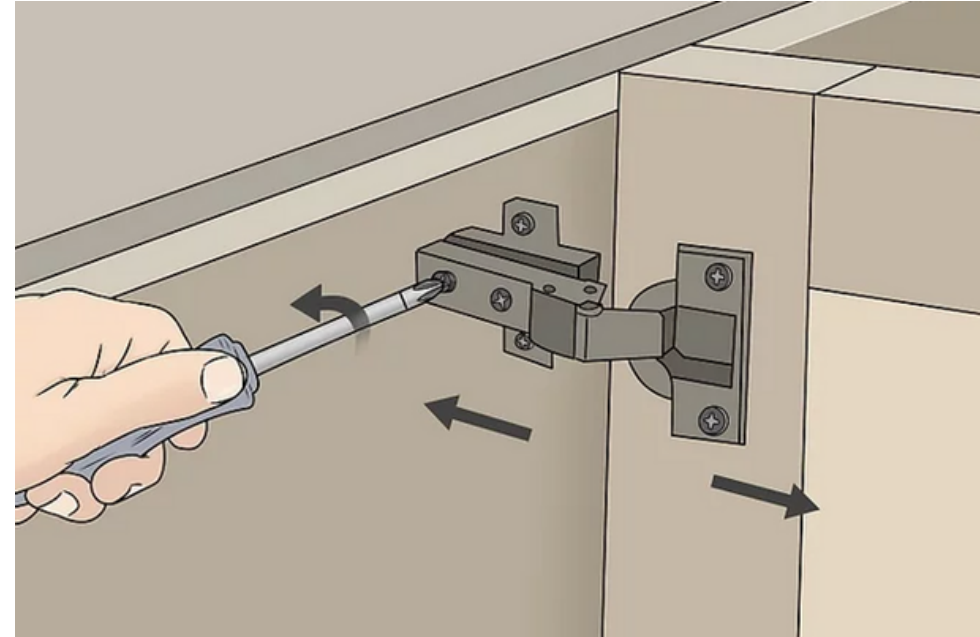

**2** Adjust the rear screw if you need to move the door in or out. The screw responsible for in and out adjustments is furthest from the door. Turn it counterclockwise to move the door away from the cabinet frame. Tightening it will move the door back toward the frame.<sup>[4]</sup>

- Ideally, there should be a gap of 1 mm (0.039 in) between the door and frame on most cabinets. After retightening the screws, you can test this by shutting the door to see if it glides closed smoothly.
- Adjust the hinges in this direction one at a time to prevent the door from falling out of position. If you loosen them all at once, support the door.

<https://www.youtube.com/watch?v=56cqWMnKRz0>