

## Universal Fit Decorative Tank Lever

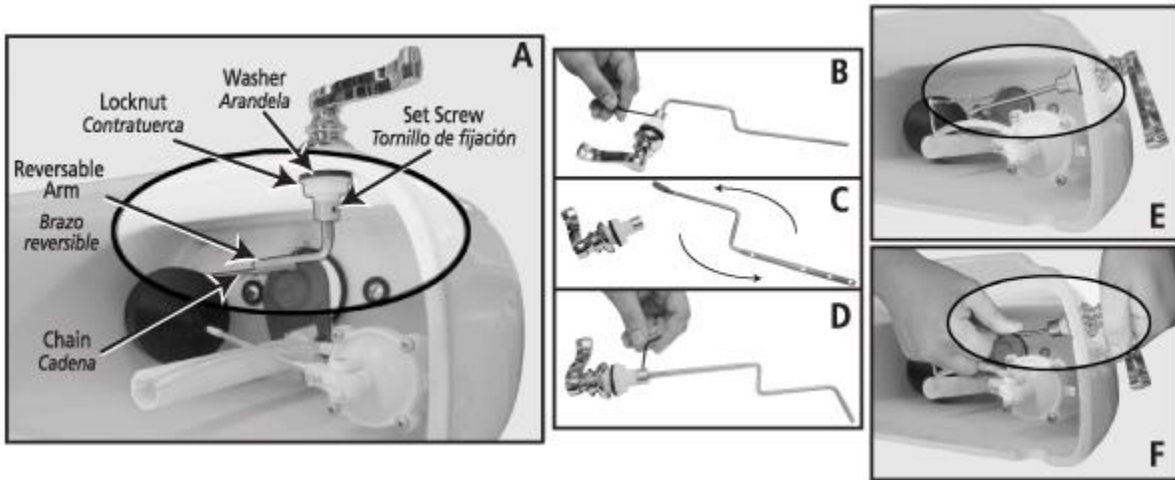

### Instructions:

1. Remove old tank lever. (Most locknuts are left hand thread)
2. For 4" applications cut rod at line just after 4" hole.
3. For angled tanks bend rod slowly to match angle of old tank lever (F). For side mount lever proceed to step 4 all others step 6.
4. Using hex wrench, loosen inner set screw on tank lever and remove rod from handle (B).
5. Flip rod (C) insert opposite end of rod into the handle as indicated in picture (D) and retighten set screw.
6. Remove locknut and washer and place new tank lever into position through tank hole, slide on rubber washer followed by locknut and tighten counter-clockwise (special left handed nut.)
7. If necessary, bend rod slowly to clear any internal parts so end of rod is directly over the flapper (F).
8. Reconnect flapper chain or lift wire to appropriate hole and adjust to proper length.  
Note: Use included clip for molded rubber flapper chains or as a replacement.