

ASSEMBLY INSTRUCTIONS (CONTINUED)

STEP 5

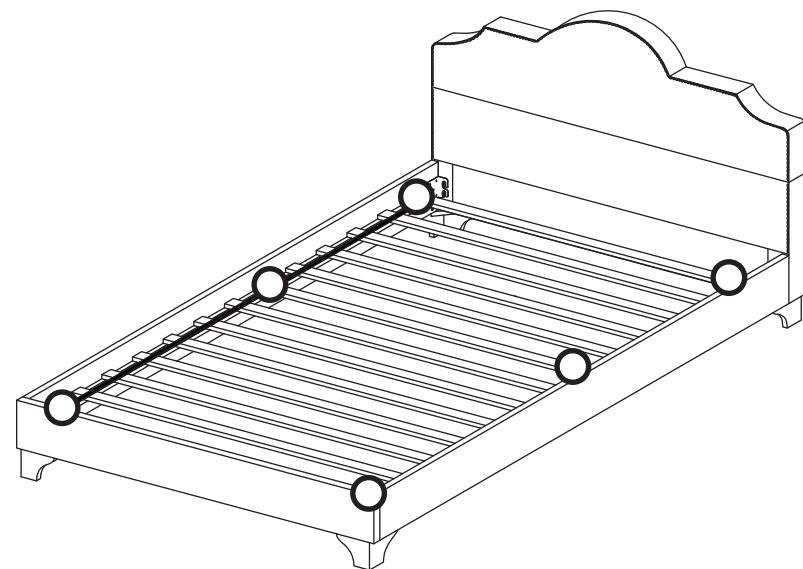
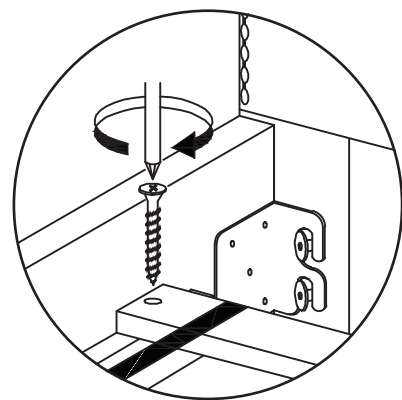
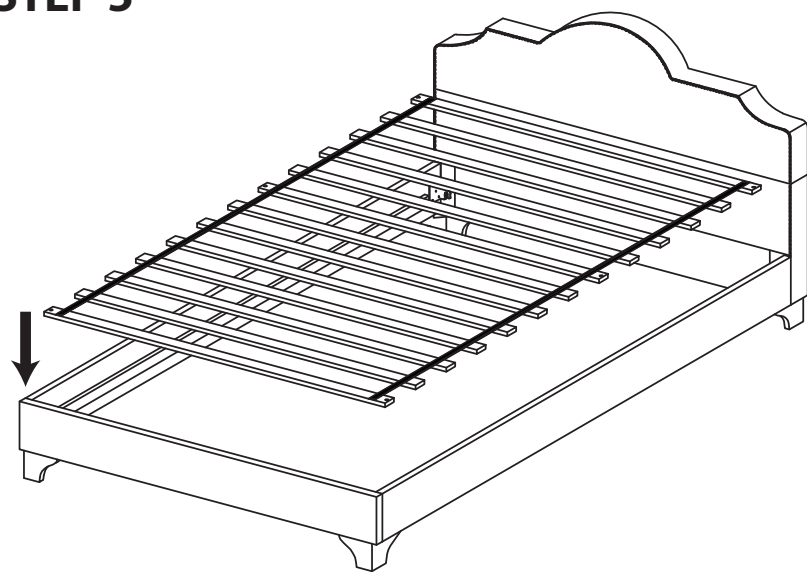

Roll out the Wood Slat System (Part F) and secure it in place with 6 38mm screws (Part N) using the pre-drilled holes and a phillips screwdriver.

Enjoy your new platform bed!

TW Platform Bed Assembly Instructions Contains One Bed and Hardware

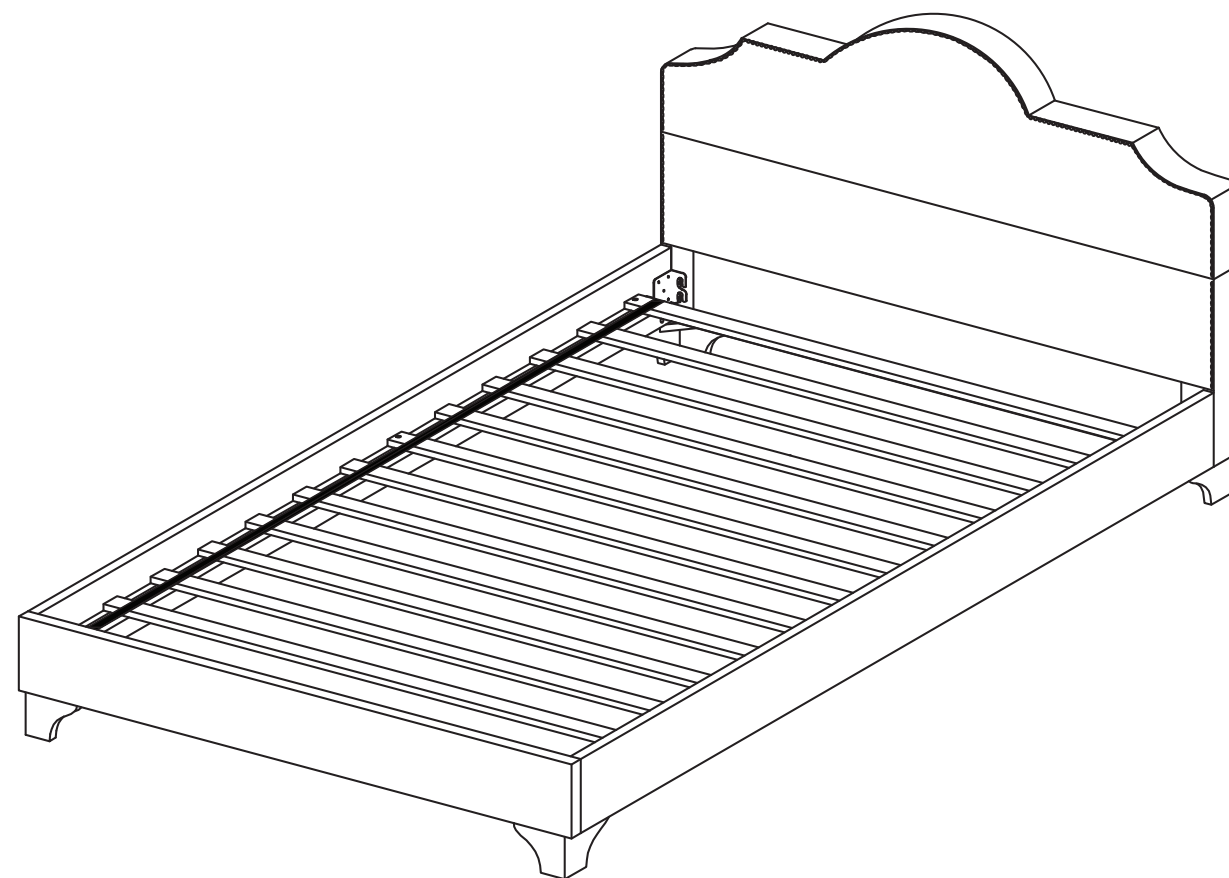

IMPORTANT NOTE:

Carefully remove all the parts from the box. Arrange on a flat surface and verify you have all of the following parts and hardware.

SIZE: TW

TOOLS REQUIRED:

Phillips Screwdriver

PARTS LIST

A. Headboard Top (1 pc)

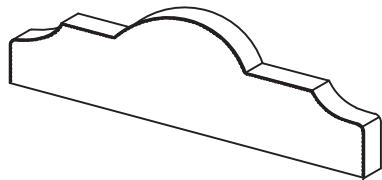

B. Headboard Bottom (1 pc)

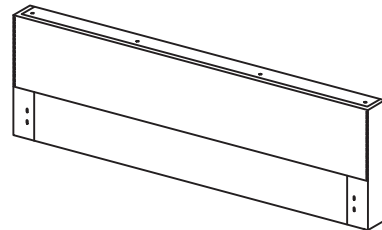

C. Footboard (1 pc)

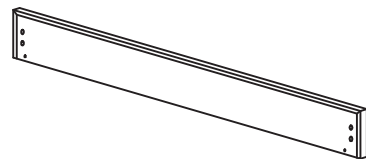

D. Siderail (2 pcs)



E. Leg (4 pcs)



F. Wood Slat System (1 pc)

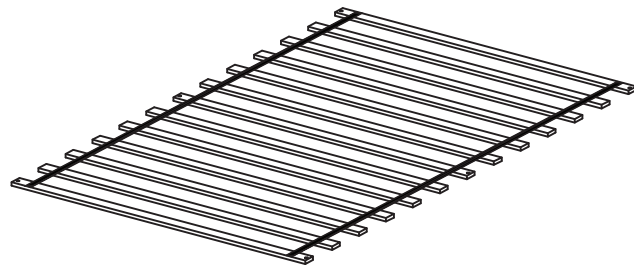

Note. Parts G and H do not exist.

HARDWARE LIST

I. M8 x 40mm Bolt (12 pcs)



J. M8 x 20mm Bolt (4 pcs)



K. M6 x 20mm Bolt (4 pcs)



L. Large Hex Key (1 pc)



M. Small Hex Key (1 pc)



N. 38mm Screw (6 pcs)



O. 20mm Screw (10 pcs)



Q. Wrench (1 pc)



R. Leg Bracket (2 pcs)



S. Hex Nut (2 pcs)



T. Spring Washer (8 pcs)



U. Flat Washer (8 pcs)



Note. Part P does not exist.

ASSEMBLY INSTRUCTIONS

STEP 1

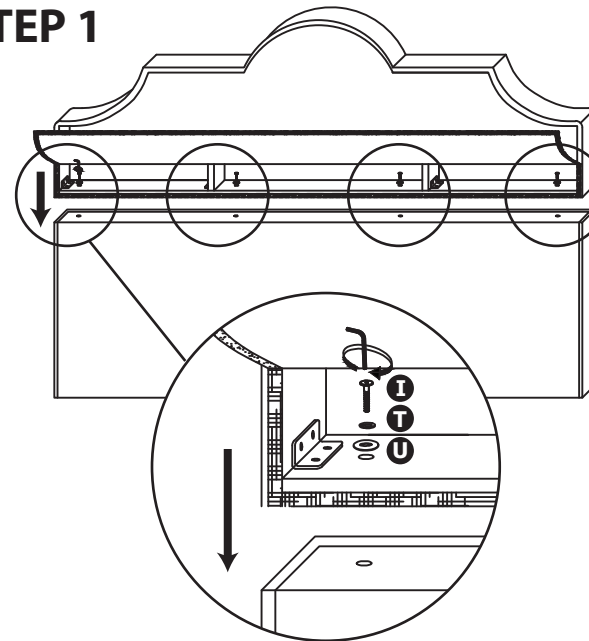

Undo the Velcro and pull the cover off on the back of the Headboard Top (Part A). Assemble the Headboard by attaching the Headboard Top (Part A) to the Headboard Bottom (Part B) using four M8x40mm bolts (Part I), four spring washers (Part T), and four flat washers (Part U).

STEP 2

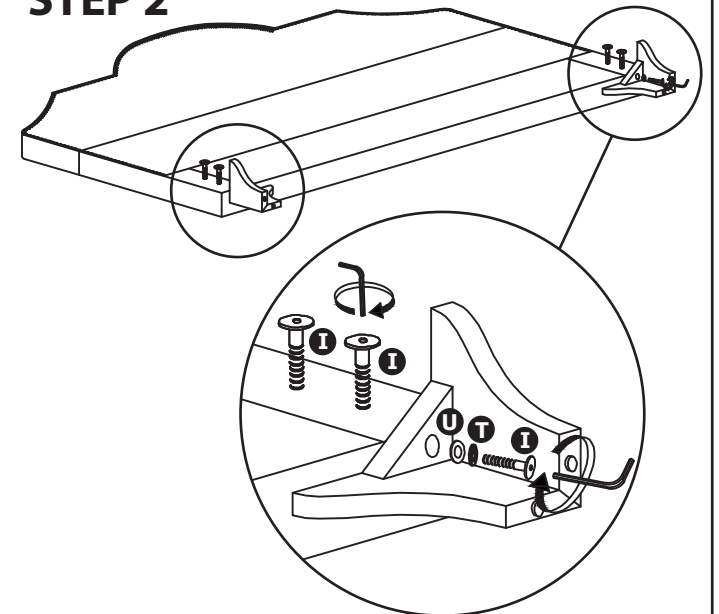

Attach two Legs (Part E) to the Headboard using one M8x40mm bolt (Part I), one spring washer (Part T) and one flat washer (Part U) for each Leg. Also screw two M8x40mm bolts (Part I) half way into each side of the Headboard. These bolts will later be used to attach the Siderails.

STEP 3

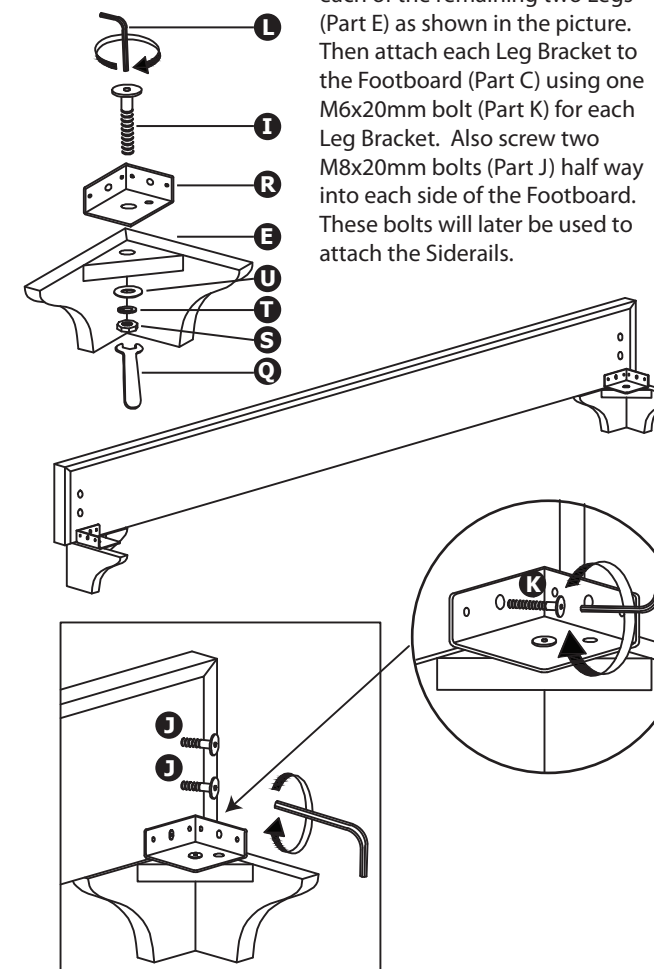

Attach one Leg Bracket (Part R) to each of the remaining two Legs (Part E) as shown in the picture. Then attach each Leg Bracket to the Footboard (Part C) using one M6x20mm bolt (Part K) for each Leg Bracket. Also screw two M8x20mm bolts (Part J) half way into each side of the Footboard. These bolts will later be used to attach the Siderails.

STEP 4

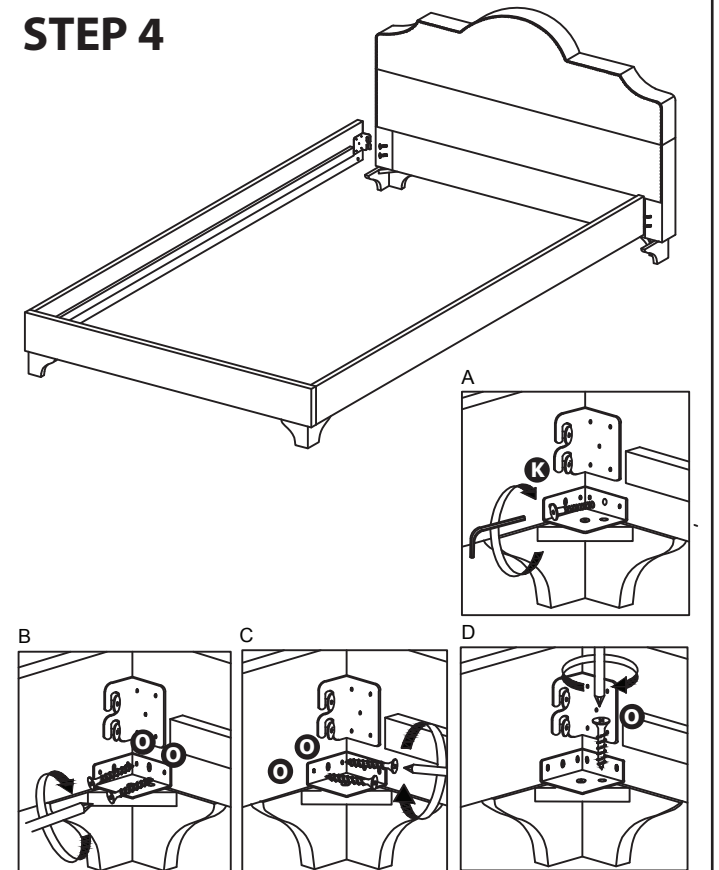

Hang the Siderails (Part D) from the bolts you screwed half way into the Headboard and Footboard in Steps 2 and 3. Then tighten the bolts. Next, finish installing the Leg Brackets (Part R) using the small hex key (Part M) as shown in Step A and using a phillips screwdriver as shown in Steps B, C and D.

(Continued on back)