

1. Install the bracket to the wall junction box with screw ⑥.
2. Connect the wire to your home line with cap connector ⑦.
3. Install the fixture to the bracket with screw ③.

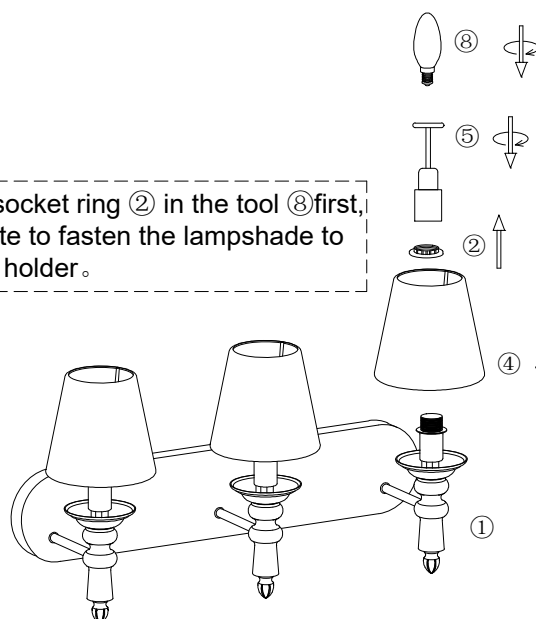

Please operate with gloves to avoid leaving stains on the lampshade.

Put the socket ring ② in the tool ⑧ first, and rotate to fasten the lampshade to the bulb holder.



4. Use tool ⑤ to install the lampshade ④ to the fixture with socket ring ②, after that install the bulb ⑧.

Please read carefully before installation!!!

Note : Please make sure that the electricity is powered off during installation !

Only a professional electrician should install this kind of product !