

Product Instructions

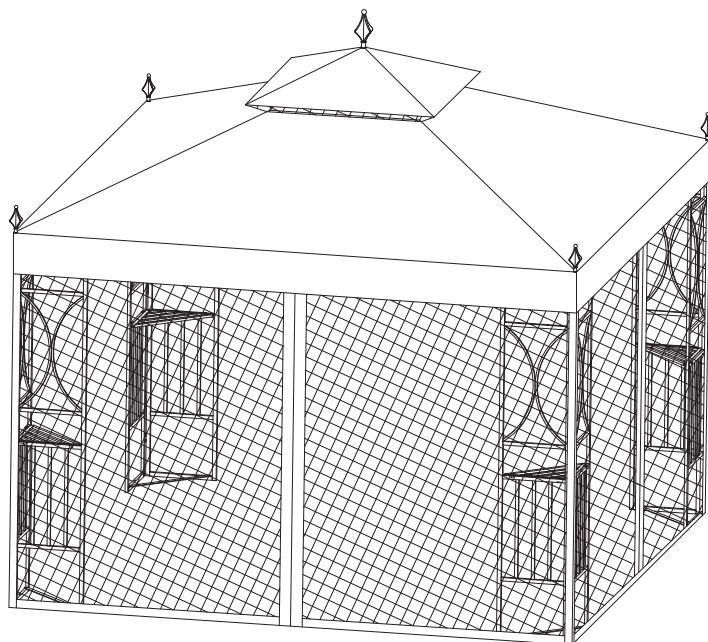

A		4
B		4
C		4
D		4
E		4
F		4
G		4
H		4
J		1
K		1
L		4

M		4
N		4
P		1
Q		4
R		1
S		4
T		1
U		1
V		1
①	M6*14mm	40+1
②		8
③		24
④		8

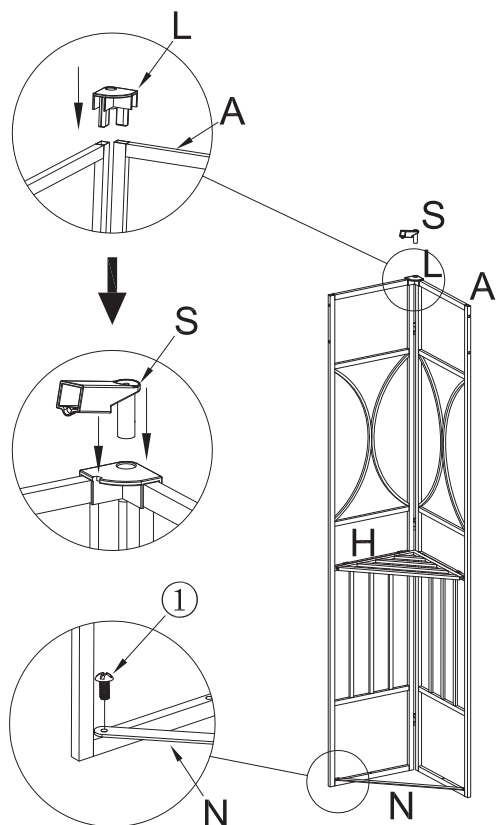

Step 1: Insert Part L to the corner of Part A, then insert Part S to Part L. Put Part N at the bottom of Part A and put Screw ① into the hole of them and tighten them. Hang Part H on the middle section of Part A. The other three Part A should be installed as this step.

①

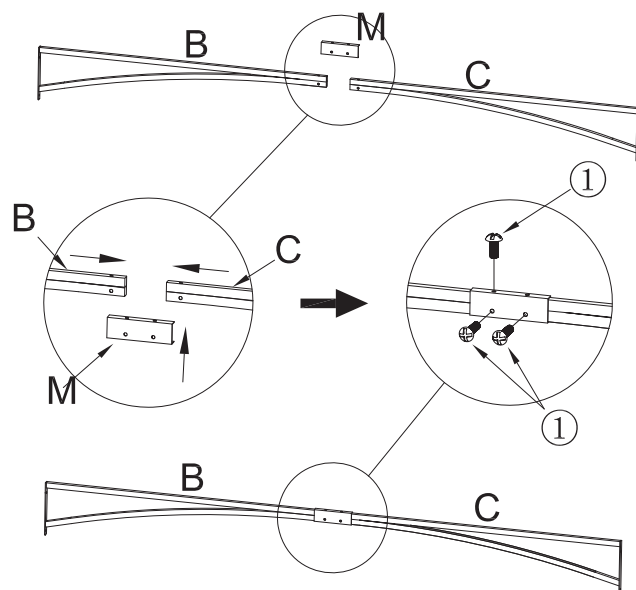

Step 2: Put Part B and Part C together, and insert Part M to the side of Part B and C. Use three Screw ① to tighten them. The other three couple of Part B and C should be installed as this step.

②

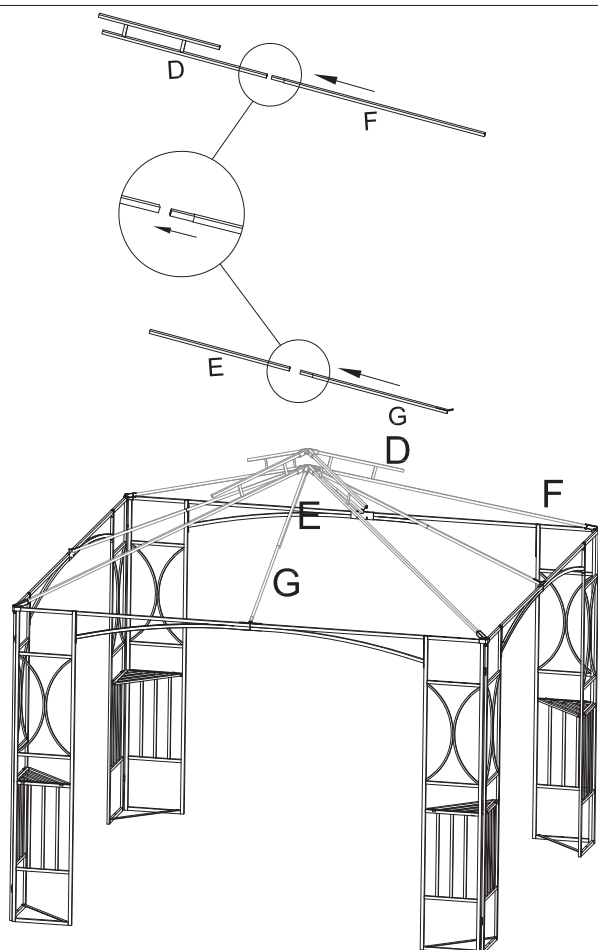

Step 3: Insert small head of Part F to the long side of Part D, insert small head of Part G to Part E. Please note: Part E is a short pole, Part F is a long pole.

③

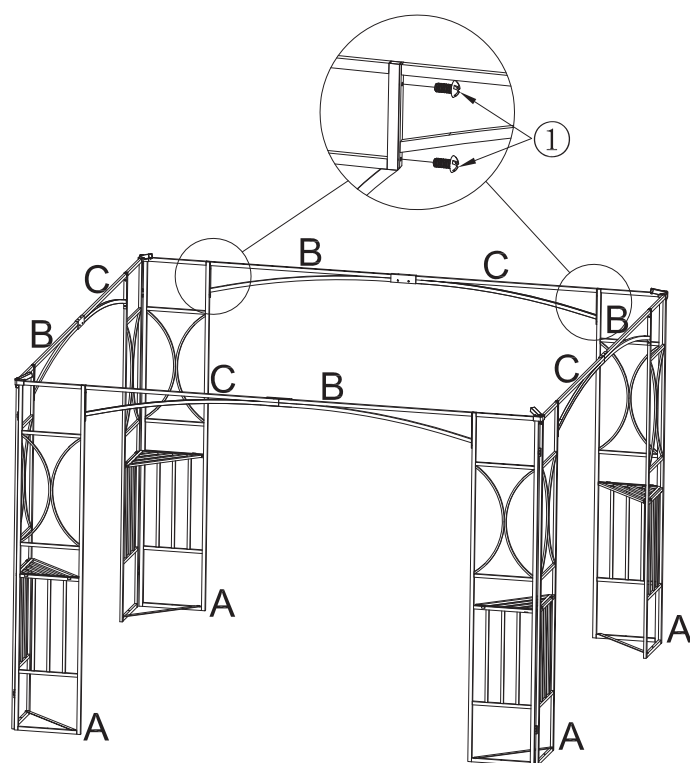

Step 4: Place Part B and Part C in the middle of two Part A, use Screw ① to connect them.

④

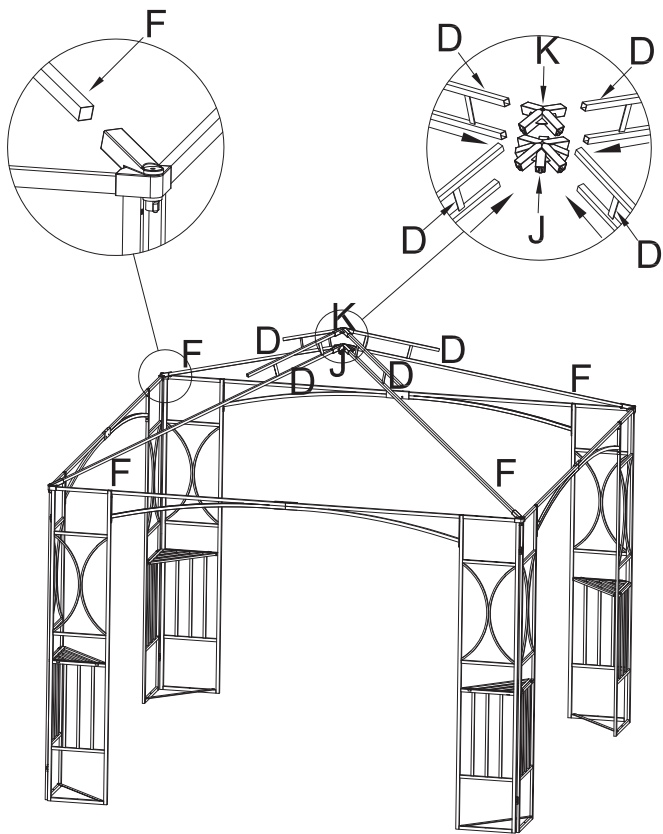

Step5: Insert Part F to Part S. Insert the long side of Part D to Part J. Insert the short side of Part D to Part K.

⑤

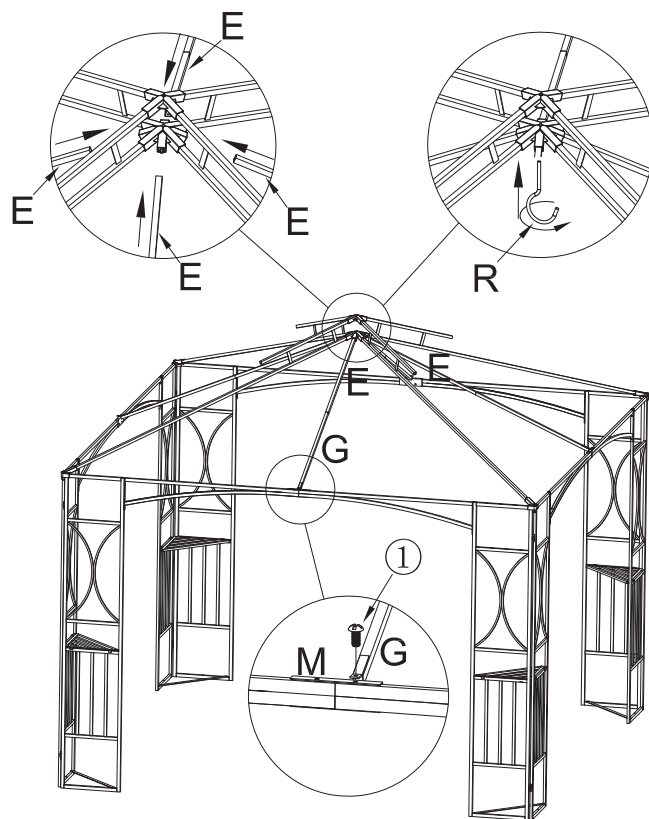

Step6: Use Screw ① to fix Part G and Part M. Insert Part E to Part J. Insert Part R to Part J and turn it to be tight.

⑥

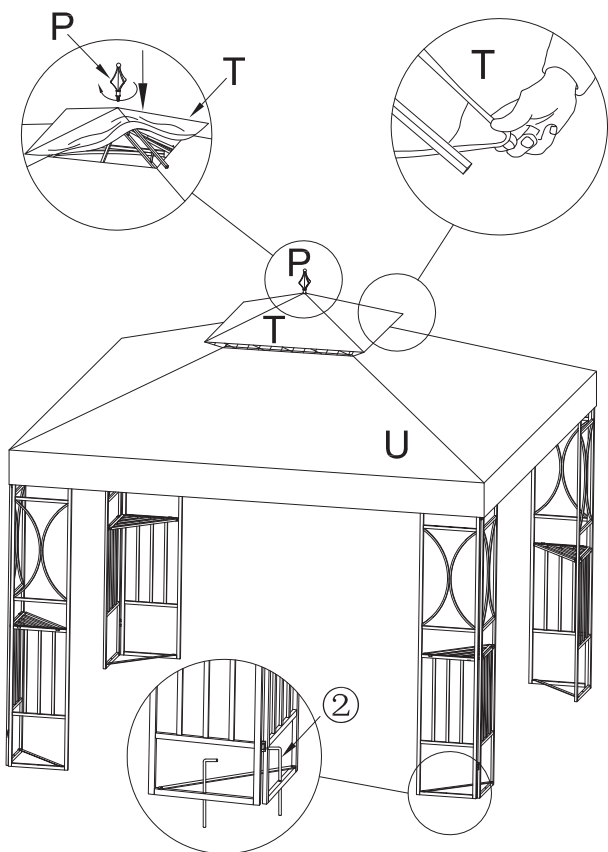

Step7: Install Part T,U on the frame and expand them. Make the four corners of the frame covered fully. Then put the top poles into the corner pockets of Part T. Insert Part P to Part K, turn it. Insert Part ② through the bottom of Part A to the ground.

⑦

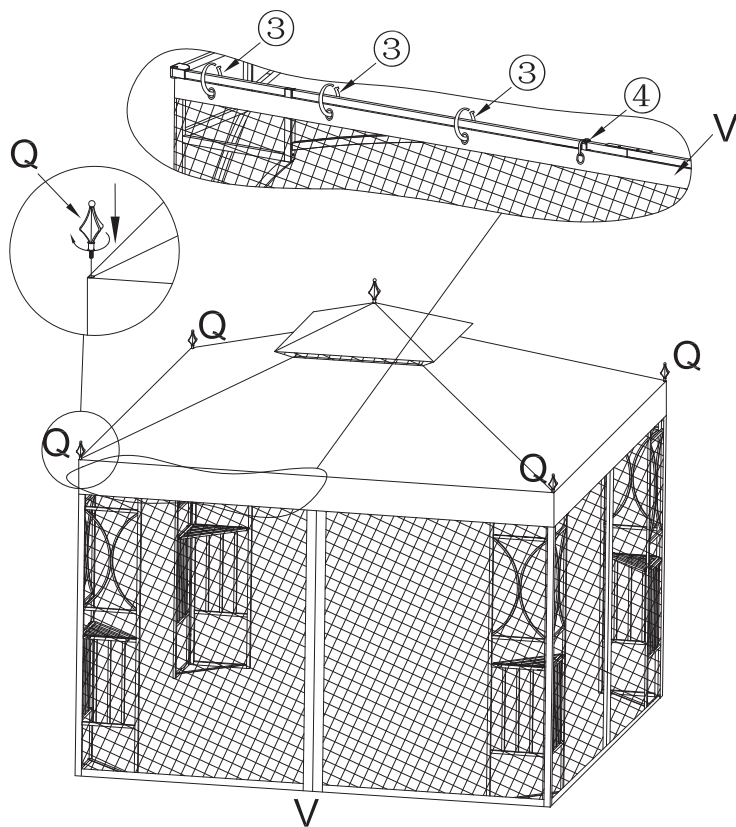

Step8: Insert four Part Q to four corners of the frame, then turn it to be tight. Use three Part ③ and one Part ④ per side to hang the netting on the frame.

⑧