

TAYAMA®



Manual Ice Shaver
TB-100M

Please read all instructions carefully before operating the appliance and keep for future reference.

TAYAMA®

Parts Diagram

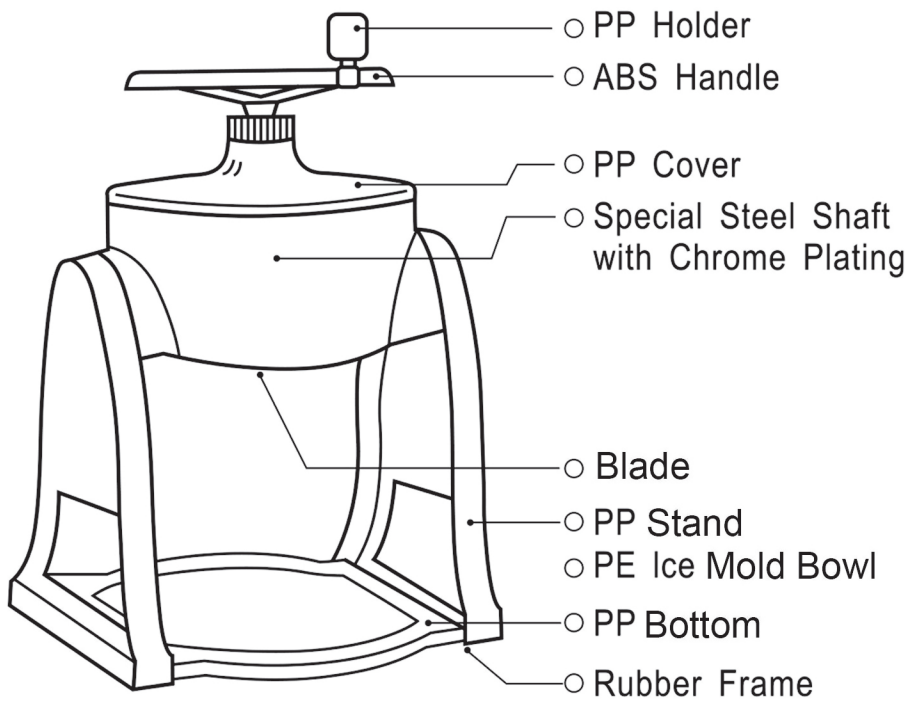

⚠ **IMPORTANT SAFEGUARD:**

The ice shave blade is extremely sharp to offer you the best performance. Please follow these Important Safeguards.

- Do not put fingers into the shaver
- Do not let children use unattended
- Sharp blade and metal points can cause injury

-1-

TAYAMA®

How to Use



Remove the cover by turning the top cover counter-clockwise.

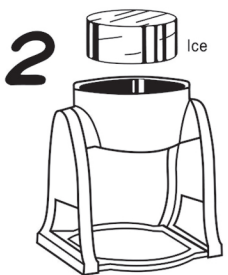

Remove the frozen ice block from the mold or add crushed ice pieces into the compartment.

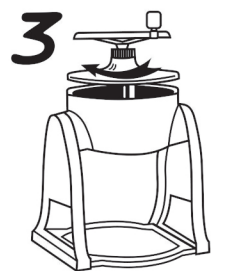

Put the cover back on and turn clockwise to lock the cover on.



Place a bowl or plate under the compartment to catch the shaved ice. Hold the top cover firmly with one hand and with the other hand, rotate the handle clock-wise for shaving ice.

-2-

TAYAMA®

Freezing Instructions

Fill bowls 3/4 full with water. Put into freezer. Remove ice blocks when frozen and place them in the ice shaver. Close lid tightly. Hold the top of the shaver firmly with one hand and with other hand, rotate handle clockwise direction. Blade can be lowered for finer ice.

Helpful Tip: Make extra ice block molds and store in the freezer for when you need it!

Care & Cleaning

Hand wash is recommended, and carefully dry blades with a wash cloth or towel after cleaning. Always use caution when handling the blade. When not in use, please place the unit back in the box and store away in a cool and dry place.

Tayama Appliance USA Inc.
www.tayama-usa.com
support@tayama-usa.com

-3-