

# Dual Ultrawide Vertical Monitor Desk Stand

*SKU: STAND-V202L*  
Instruction Manual

---

*Assembly Video & Product Info*  
[www.vivo-us.com/products/stand-v202l](http://www.vivo-us.com/products/stand-v202l)



[ THIS PAGE INTENTIONALLY LEFT BLANK ]



## CAUTION!

If you do not understand these directions, or if you have any doubts about the safety of the installation, please contact our product support team at 309-278-5303 or [help@vivo-us.com](mailto:help@vivo-us.com) for further assistance. Check carefully to make sure there are no missing or defective parts. Improper installation may cause damage or serious injury. Do not use this product for any purpose that is not explicitly specified in this manual. Do not exceed weight capacity. We cannot be liable for damage or injury caused by improper mounting, incorrect assembly or inappropriate use.



### WARNING: CHOKING HAZARD

SMALL PARTS - NOT FOR CHILDREN UNDER 3 YEARS. ADULT SUPERVISION IS REQUIRED.



### DO NOT EXCEED WEIGHT CAPACITY

FAILURE TO DO SO MAY RESULT IN SERIOUS INJURY.

---

## We're Here for You

Open **Monday - Friday 7:00am - 7:00pm CST**, our dedicated support team can offer immediate assistance with rapid response times. If any parts are received damaged or defective, please contact us. We are happy to replace parts to ensure you have a fully functioning product.



Give us a Call:  
**309-278-5303**

AVG. RESOLUTION TIME (*within office hrs*): **5M 4S**



Chat Us:  
**[www.vivo-us.com](http://www.vivo-us.com)**

AVG. RESOLUTION TIME (*within office hrs*): **< 15 M**



Email Us:  
**[help@vivo-us.com](mailto:help@vivo-us.com)**

AVG. RESPONSE TIME (*within office hrs*): **1HR 8M**

- 23% within < 15m
- 38% within < 30m
- 61% within < 1hr
- 83% within < 2hr
- 92% within < 3hr

# Package Contents

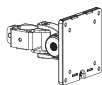

**A (x2)**  
VESA Bracket



**B (x1)**  
Base

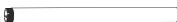

**C (x1)**  
Lower Pole

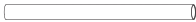

**D (x1)**  
Upper Pole



**E (x1)**  
Pole Cap



**F (x4)**  
Pads



**G (x2)**  
Cable Clip

## Included Hardware & Tools



**S-A (x3)**  
M6x16mm  
Screw



**T-A (x1)**  
4mm Allen  
Wrench



**T-B (x1)**  
6mm Allen  
Wrench



**M-A (x8)**  
M4x12mm  
Screw



**M-B (x8)**  
M5x12mm  
Screw



**M-C (x8)**  
M5 Washer

## Tools Needed



**Phillips  
Screwdriver**

## Weight Capacity



*PER ARM*



*TOTAL*

## ASSEMBLY STEPS

### STEP 1

Press Pole Cap (**E**) into Pole (**D**), using the side without internal threading .

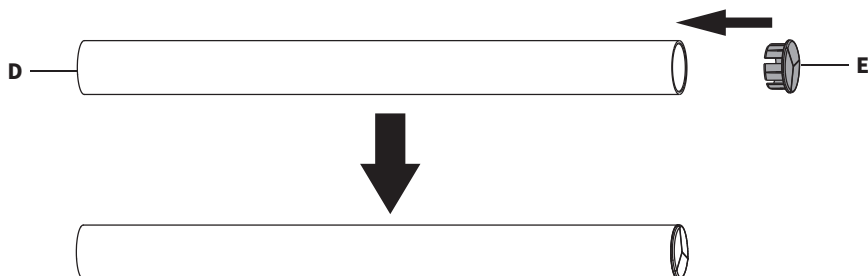

### STEP 2

Install Pole (**C**) to Base (**B**) using M6x16mm Screws (**S-A**) and 4mm Allen Wrench (**T-A**).  
Remove protective film from Pads (**F**) and apply them to Base (**B**) as shown.

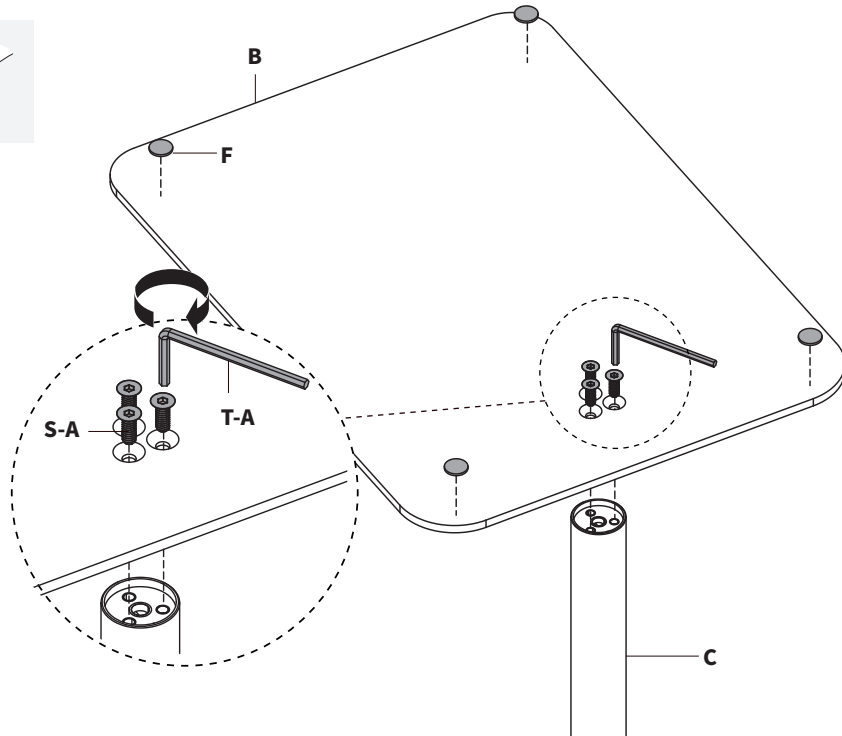

### STEP 3

Slide Pole Cable Clip (**G**) and one of the VESA Brackets (**A**) onto the Lower Pole (**C**). Adjust the height location of the VESA Bracket and tighten using the 6mm Allen Wrench (**T-B**).

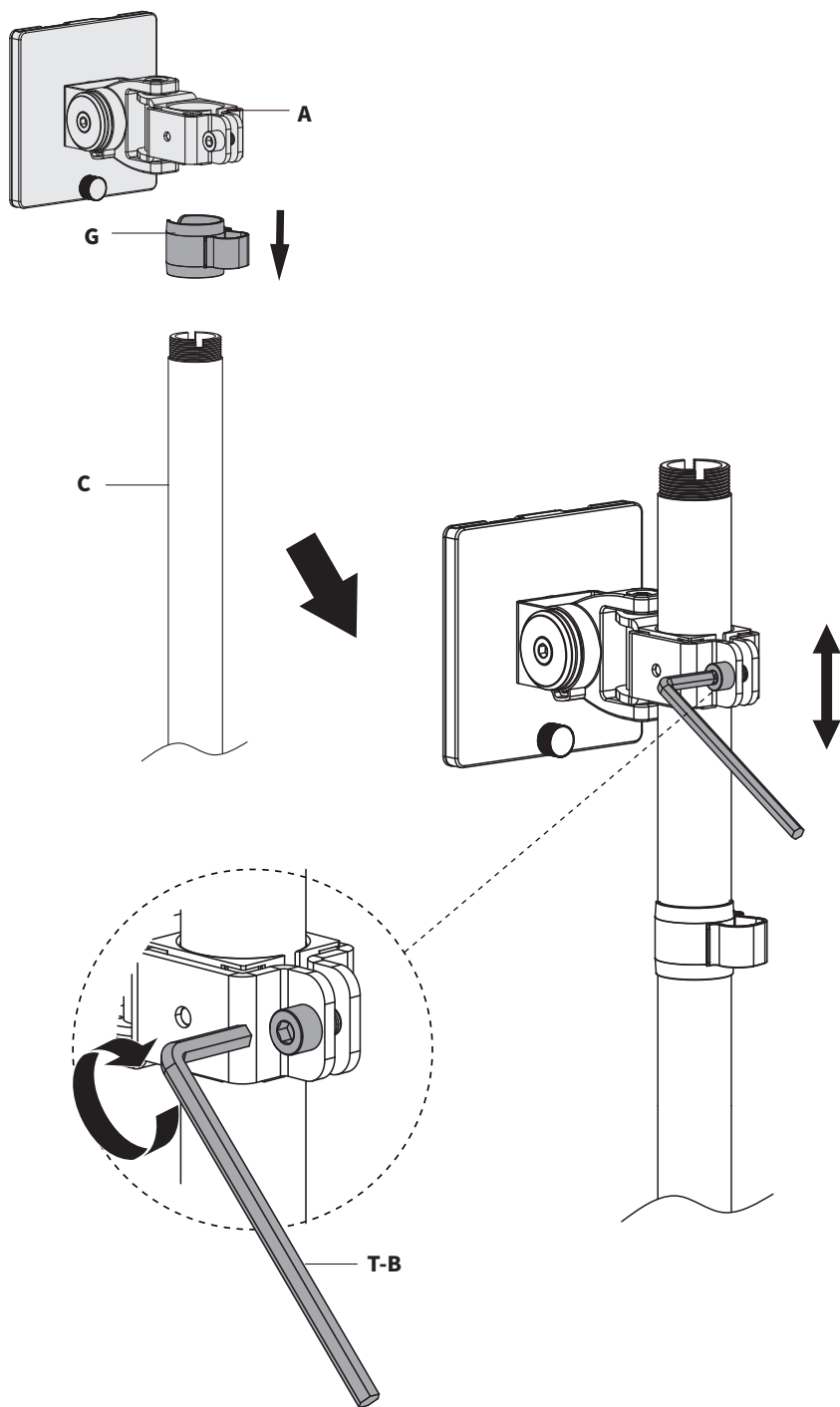

## STEP 4

Screw the Upper Pole (**D**) onto the Lower Pole (**C**). Slide the remaining Pole Cable Clip (**G**) and VESA Bracket (**A**) onto the Upper Pole. Adjust the height location of the VESA Bracket and tighten using the 6mm Allen Wrench (**T-B**).

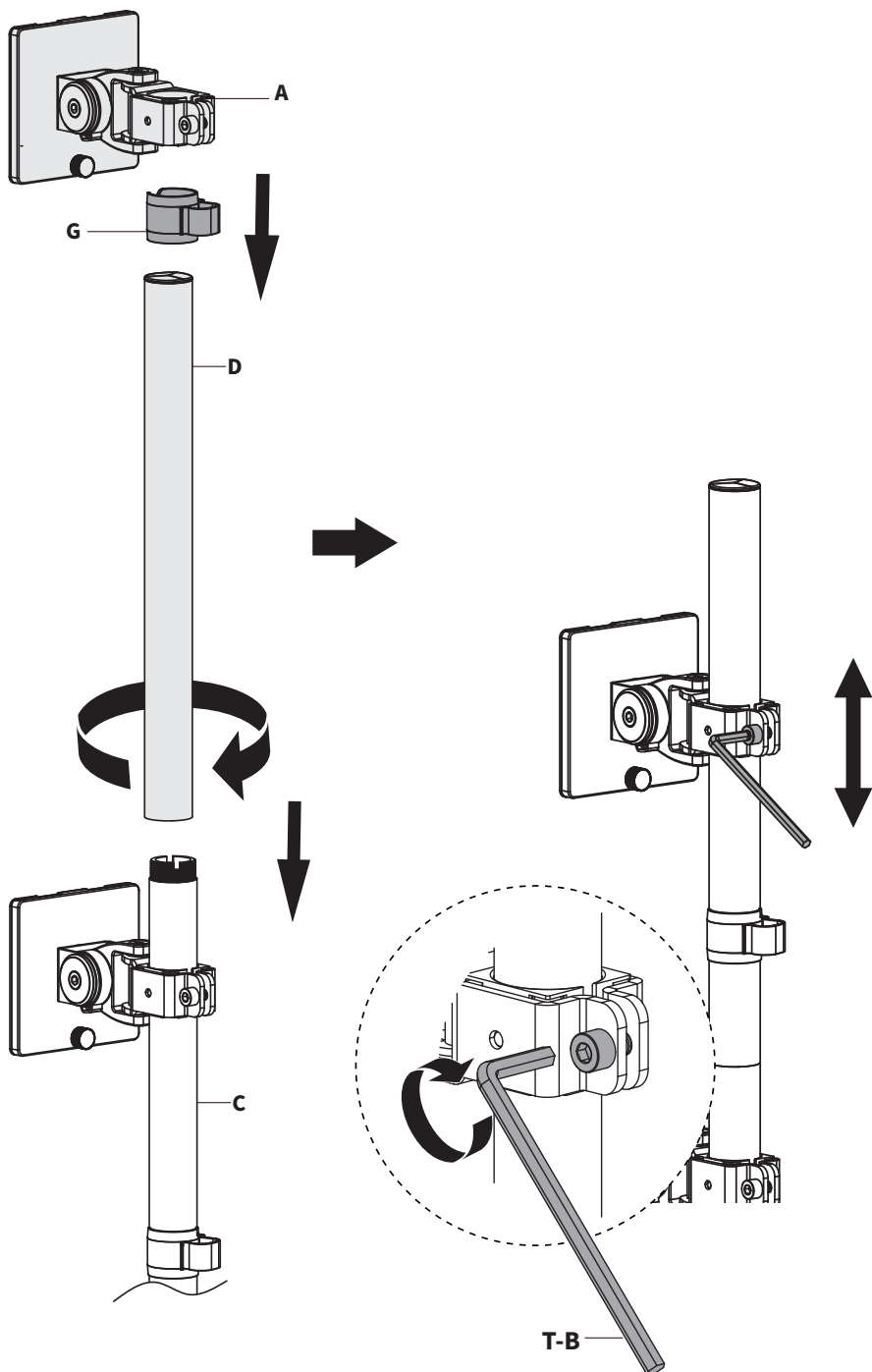

## STEP 5

Loosen the Thumbscrew (**A2**) on the back of both VESA Brackets (**A1**), then separate and remove VESA Plates (**A3**) by pulling out and sliding upwards.

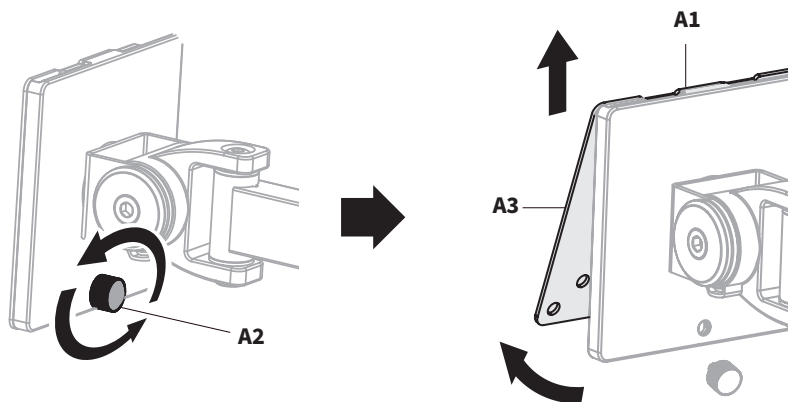

Install the VESA Plates (**A3**) onto the back of your monitors using M4x12mm Screws (**M-A**) or M5x12mm Screws (**M-B**) and M5 Washers (**M-C**), orienting the arrow on the VESA Plates pointing up. Tighten screws using a Phillips screwdriver making sure not to over tighten.

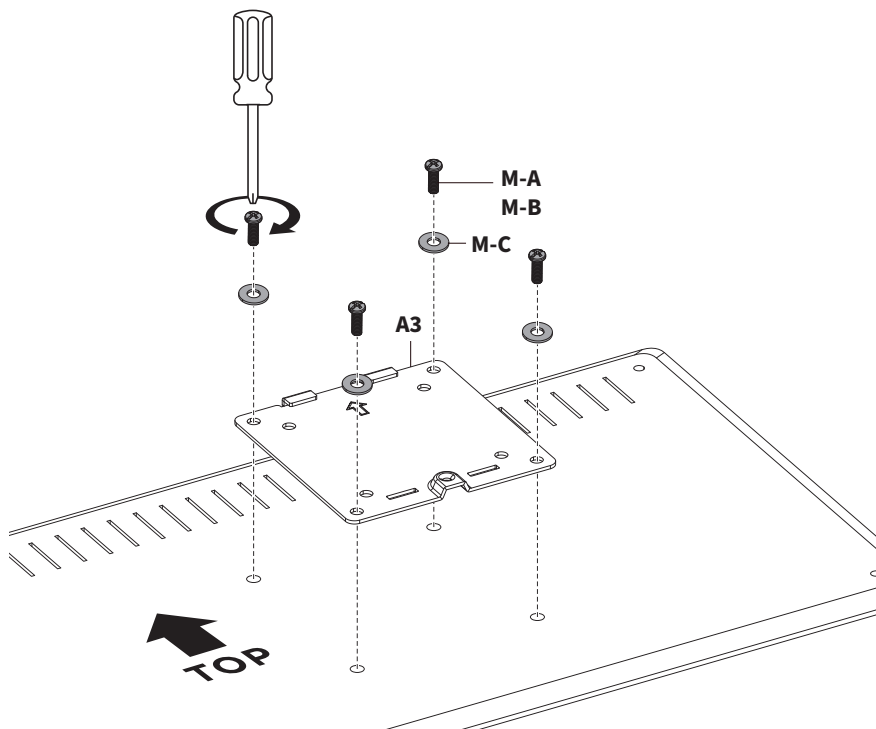

## Adjusting the Tilt Joint

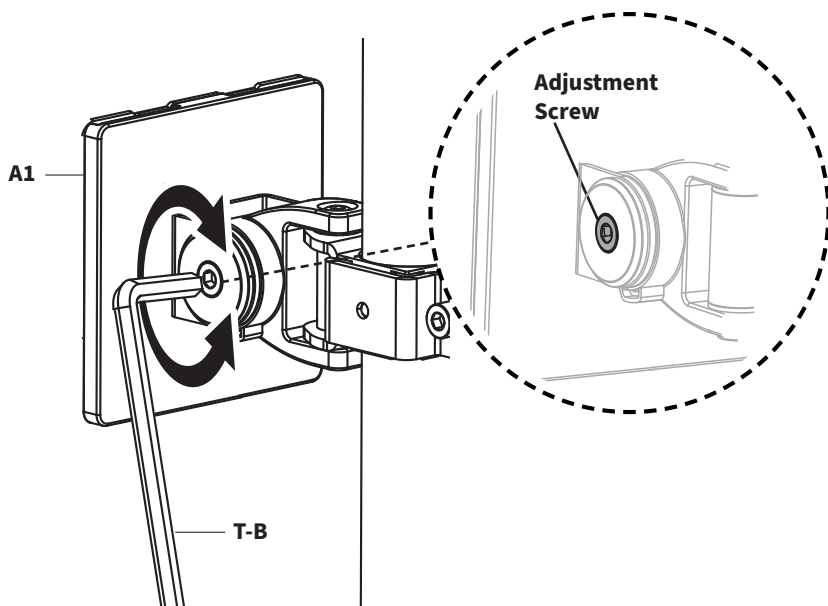

### 1. Loosen Tilt Joint

Use 6mm Allen Wrench (T-B) to loosen the **Tilt Joint Adjustment Screw**, located on the side of VESA Bracket (A1).

### 2. Set Angle

Firmly grip the VESA Bracket and adjust to your desired viewing angle, and hold in place.

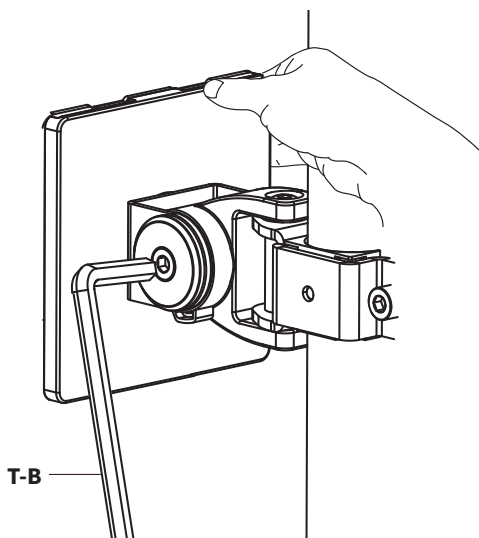

### 3. Lock Angle

Tighten as much as possible using the 6mm Allen Wrench (T-B) to lock the angle.

**\*Firmly hold VESA Bracket in place while adjusting tilt angle.**

## STEP 7

With the assistance of a second person, line up the VESA Plates (**A3**) on your monitors with the **VESA Bracket (A1)** and the Plate Hooks into the pockets of the VESA Brackets. Monitor & VESA Brackets may need to be angled backwards slightly when sliding on.



2 Person Mounting is  
Recommended

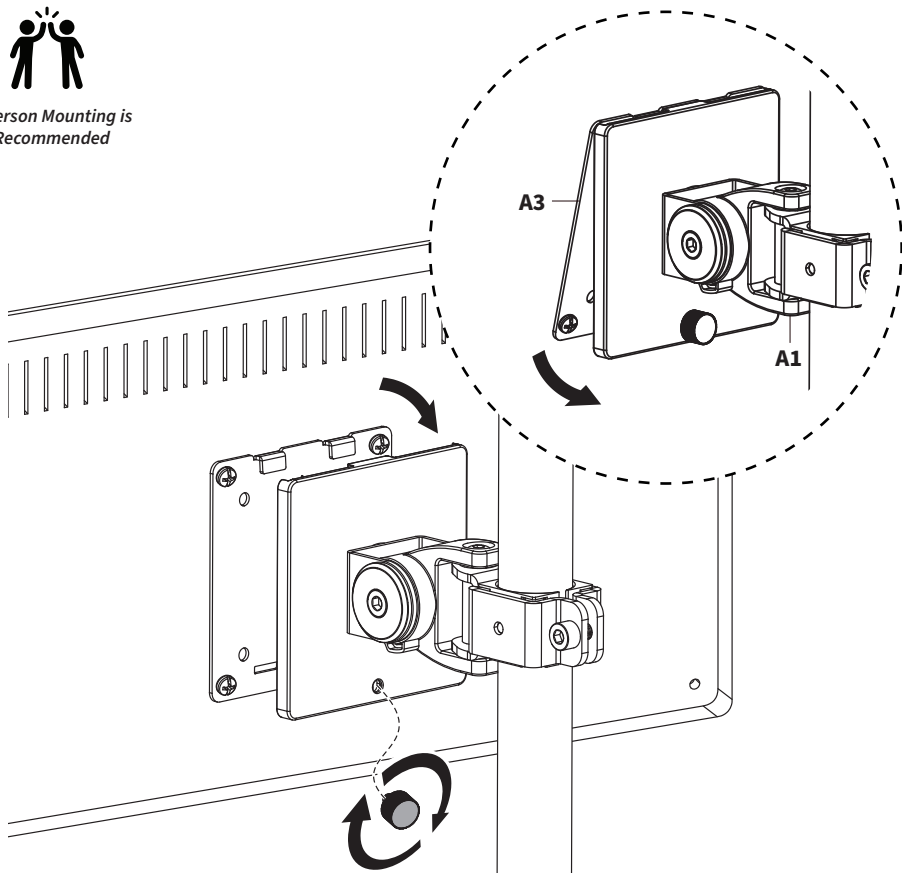

*\*Monitor & VESA Bracket may need to be angled backwards slightly when sliding on.*



### Monitor Tilted Too Far?

**\*\* See Next Step \*\***

Refer to instructions in next step to adjust. **DO NOT** try to adjust angle freely. Doing so may result in accidental damage to your screen.

## Fine Tune Tilt Angle

*If the monitor is angled further than intended...*



### Heavy Weighted/ Ultrawide Monitors

[ 22lbs - 44lbs ]

#### 1. Firmly Hold Monitor

Firmly grasp and hold the monitor in place. Do NOT release monitor until you have completed steps below.

#### 2. Loosen Tilt Joint

With a hand still on the monitor, use 6mm Allen Wrench (**T-B**) to loosen the tilt joint **Adjustment Screw**, located on the side of VESA Bracket (**A1**).

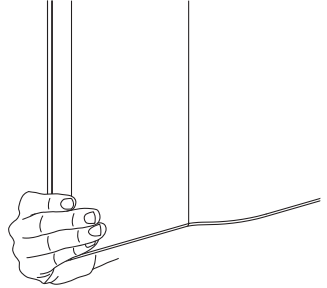

#### 3. Set & Lock Angle

Adjust screen slightly past your desired viewing angle, then tighten the screw as much as possible using 6mm Allen Wrench (**T-B**).

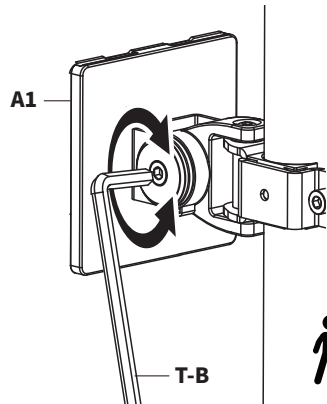

#### 4. Straighten Angle

Slowly adjust the monitor down until your desired angle is reached. Release monitor and check angle. Repeat process as necessary



**2 Person  
Adjustment is  
Recommended**

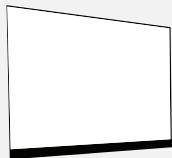

### Ultra Thin Monitors



#### **ALWAYS REMOVE MONITOR BEFORE RE-ADJUSTING**

To prevent accidental damage to your screen, remove monitor and then follow Tilt Adjustment instructions. Reinstall monitor when desired angle is reached.

## STEP 8

Route cables through Pole Cable Clip (**G**) and store Allen Wrenches (**T-A**, **T-B**) in the provided slots.

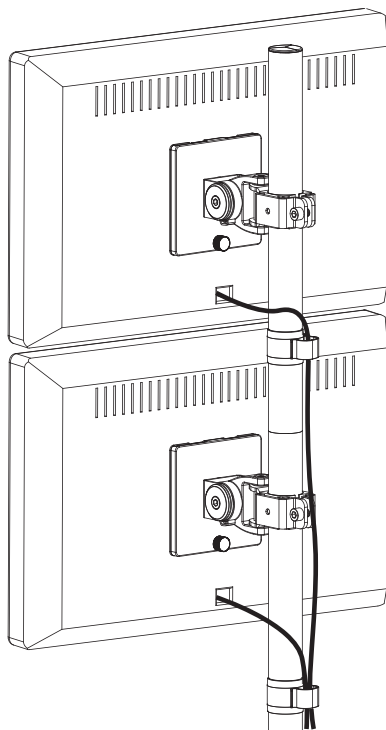
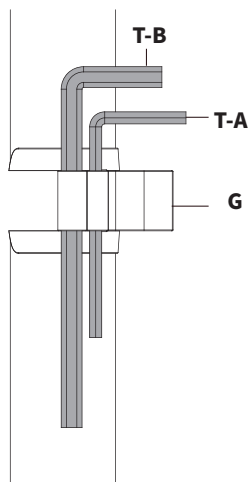

## STEP 9

Make adjustments as desired on swivel and orientation.

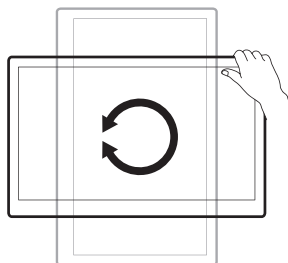
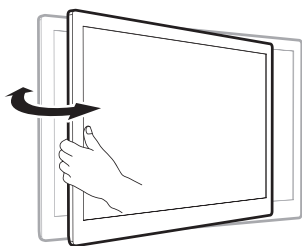



## **WARNING!**

If you are using the stand with the clamp, do **NOT** extend the arm past the back of the clamp to prevent possible damage to your monitor and stand.

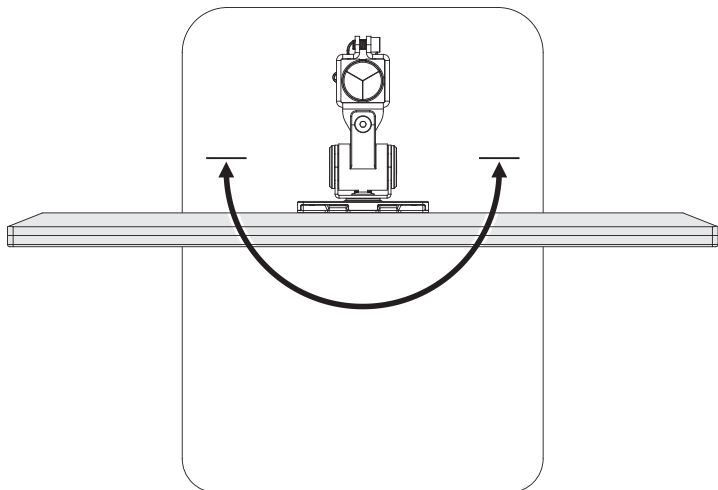

## Adjust Monitors as Desired

If further height adjustment is needed, use 6mm Allen Wrench (**T-B**) to loosen VESA Bracket (**A**) and adjust height, then tighten Bracket again to secure.

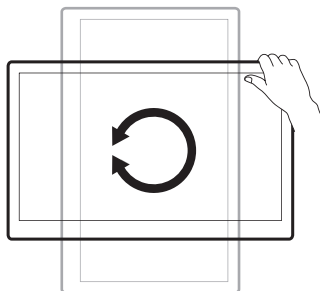
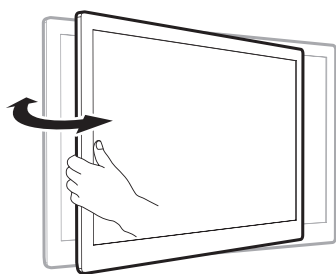
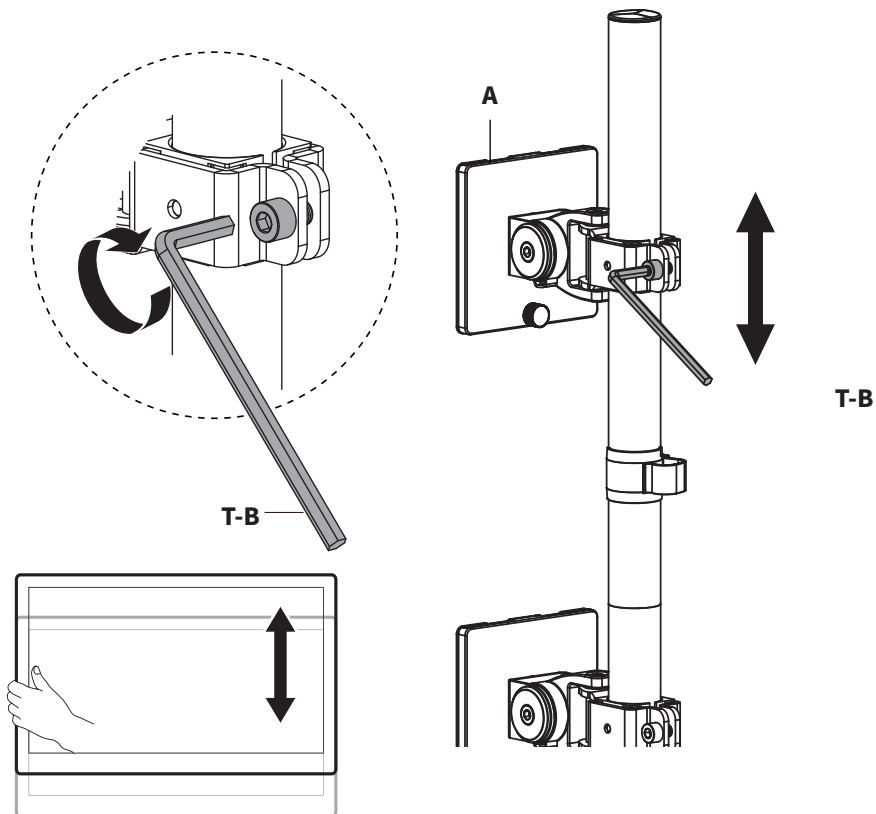

[ THIS PAGE HAS BEEN INTENTIONALLY LEFT BLANK ]



## Need Help? Get In Touch

Monday-Friday from 7:00am-7:00pm CST



[help@vivo-us.com](mailto:help@vivo-us.com)



[www.vivo-us.com](http://www.vivo-us.com)

*Chat live with an agent!*



309-278-5303



**VIVO-us** @vivo\_us

FOR MORE GREAT VIVO PRODUCTS,  
CHECK OUT OUR WEBSITE AT: [WWW.VIVO-US.COM](http://WWW.VIVO-US.COM)