

BMS7404 / BMS7405 Vista™ Storage Shed

ASSEMBLY INSTRUCTIONS

Tools Required

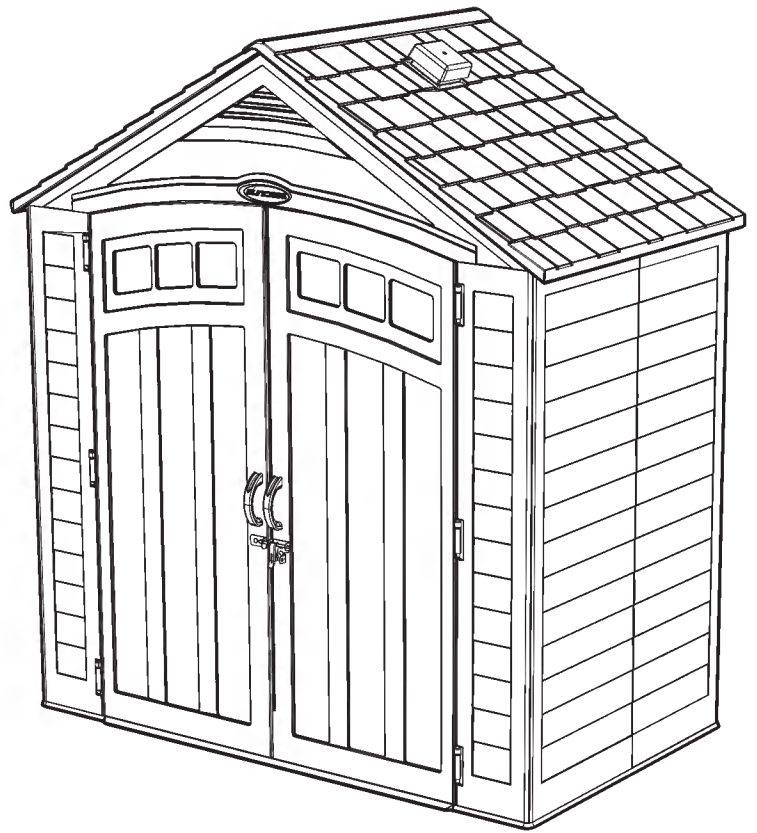
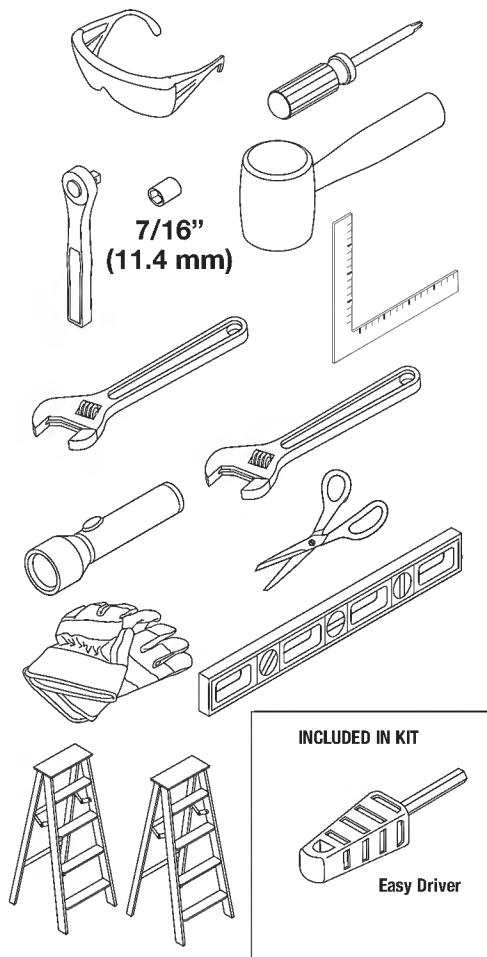

suncast®

Built for Everyday Life™

Thank you for purchasing this Suncast® product.

Register within 90 days of purchase to activate Warranty!

Registration is not required for products with a warranty term of 90 days or less.

1. Verify warranty term of your product by visiting **[www/suncast.com/warranty](http://www.suncast.com/warranty)** (products with a warranty term of 90 days or less do not require registration)
2. Complete registration: fill out the form and upload a copy of your receipt by visiting **<https://support.suncast.com>** or scanning the QR code



Have Questions?

For product questions, assembly assistance, replacement parts and more:



<https://support.suncast.com>



Suncast Corporation Customer Care
701 N. Kirk Road, Batavia, IL 60510



1-800-846-2345
1-630-381-6309



Before you Begin...

- **Consult your local authorities for any permits required to construct shed.**

Prior to the construction of your shed, check with the local building code official to review any required permits or building limitations.

- **A level and sturdy foundation is required before shed construction can begin.**

Site preparation information is available later in this manual. A foundation that differs from the specifications within this manual could prevent proper assembly and may damage parts.

- **Read instructions thoroughly prior to assembly.**

This kit contains parts that can be damaged if assembled incorrectly or in the wrong sequence.

- **Please follow instructions.**

Suncast is not responsible for replacing parts lost or damaged due to incorrect assembly.



Indicates at least 1 additional adult is needed to complete this step.

IMPORTANT

IF FOUNDATION IS REQUIRED, COMPLETE SITE PREPARATION AND FOUNDATION CONSTRUCTION BEFORE UNPACKING ALL PARTS.

OPEN ALL BOXES FIRST AND NEATLY LAYOUT PARTS. SMALL PARTS MAY BE CONTAINED IN EACH BOX. PLEASE REFERENCE THE PARTS LIST WITHIN THIS MANUAL TO VERIFY ALL PARTS ARE PRESENT.



Caution

- Proper site preparation is required.
- Shed not intended for storage of flammable, caustic or corrosive materials.
- Shed not intended for habitation or for use by children.
- **DO NOT** stand, sit, or store items on the storage shed roof.
- **DO NOT** place near objects that are hot or can become hot.
- Heavy articles should not be leaned against the walls, as this may cause panel distortion and permanent damage.
- Suncast is not responsible for damage caused by weather or misuse.
- This kit contains parts with sharp edges. Please be careful when handling, use of work gloves is recommended.
- **DO NOT** place in areas near highly reflective surfaces (Note: Low-E windows are more reflective than standard windows and may affect the longevity of the product).
- Product is water resistant and now waterproof. Locate unit away from gutter and down spouts for optimal performance.



Care & Maintenance

- At regular intervals, inspect your shed to make sure that assembly integrity has been maintained. **Repair or replace broken parts immediately.**
- Periodically check that the location you have chosen to set your shed is still level.
- Keep roof clean of snow and leaves.
- To maintain the look of your product, we recommend cleaning it at regular intervals with mild soap and water. **DO NOT** use bleach, ammonia, or other caustic cleaners, and **DO NOT** use stiff bristle brushes. Failure to perform cleaning at regular intervals could result in permanent staining of the plastic. This type of damage is not covered under warranty.



Assembly Day Tips

- **DO NOT** attempt to assemble on a day with strong winds.
- Set aside appropriate amount of time to completely assemble shed. An incomplete shed assembly may pose a safety hazard.
- Make sure you have assistance nearby to lift and secure parts in place.
- **DO NOT** use a torque wrench or hand drill to tighten Easy bolts. Use provided Easy Bolt Driver ONLY.
- Suncoast provides extra hardware for small fasteners for customer convenience. In some cases, there will be extra small fasteners once the assembly is complete.

Note: This product contains parts that are used in different orientations to construct the shed. Please take note of the orientation of the parts shown throughout this instruction manual. Failure to follow instructions could result in damage to parts. Suncoast is not responsible for replacing parts lost or damaged due to incorrect assembly.

Note: This product contains parts that are used in different orientations to construct the shed. Please take note of the orientation of the parts shown throughout this instruction manual. Failure to follow instructions could result in damage to parts. Suncoast is not responsible for replacing parts lost or damaged due to incorrect assembly.

Parts- Walls and Floors

IMPORTANT

OPEN ALL BOXES FIRST AND NEATLY LAYOUT PARTS. SMALL PARTS MAY BE CONTAINED IN EACH BOX. PLEASE REFERENCE THE PARTS LIST WITHIN THIS MANUAL TO VERIFY ALL PARTS ARE PRESENT.

COMPLETE SITE PREPARATION AND FOUNDATION CONSTRUCTION BEFORE UNPACKING ALL PARTS.

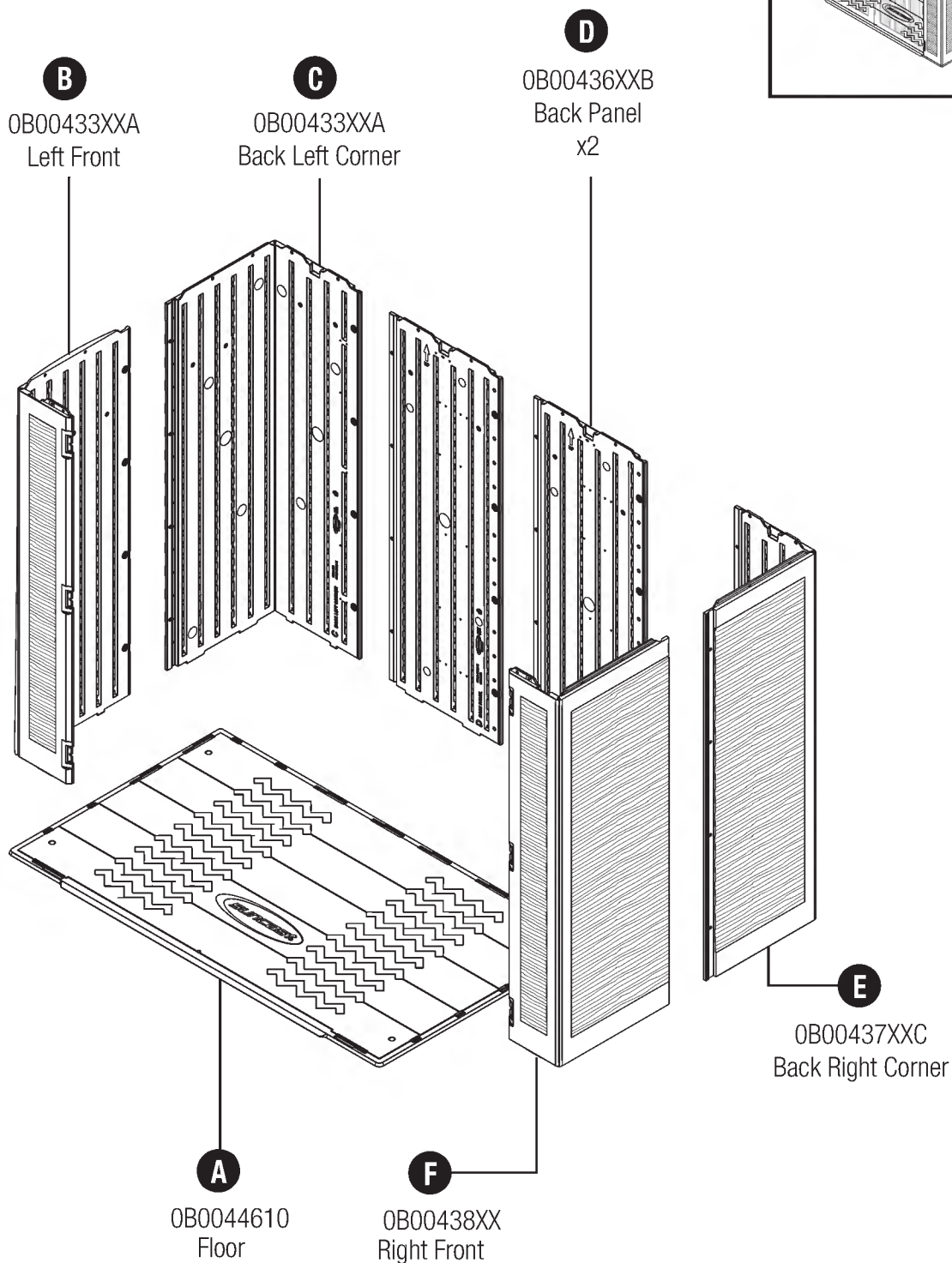
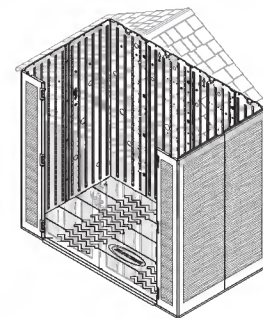

Parts - Doors

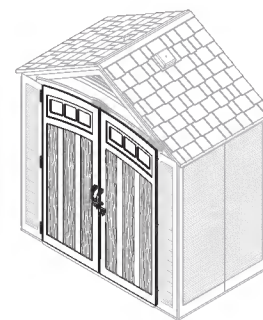

J
0B00439XXC
Left Door

N
0631703
Left Door Window

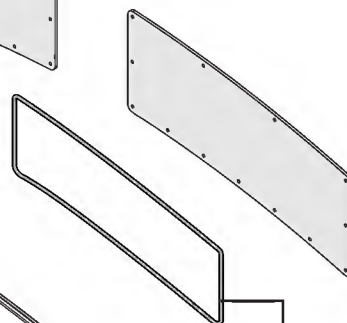
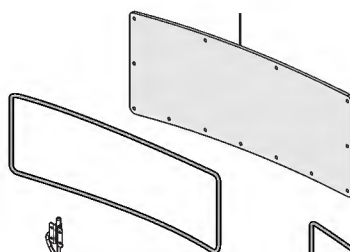
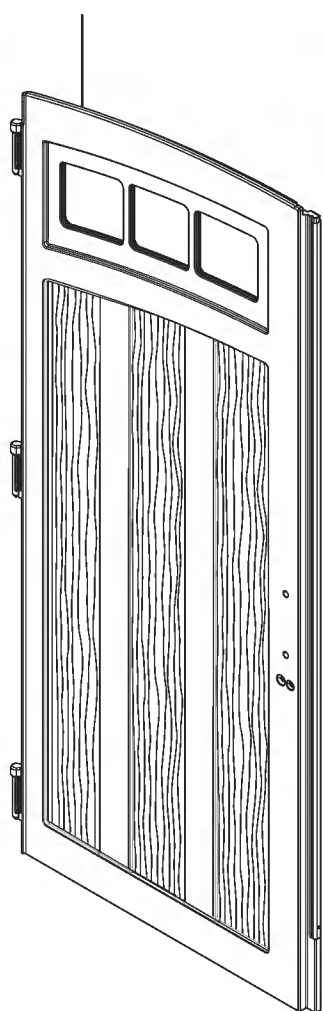

Q
0631702
Right Door Window

P
0440919
Window gasket
x2

O
0440631
D-ring
x2

K
Right Door
0B00440XXC

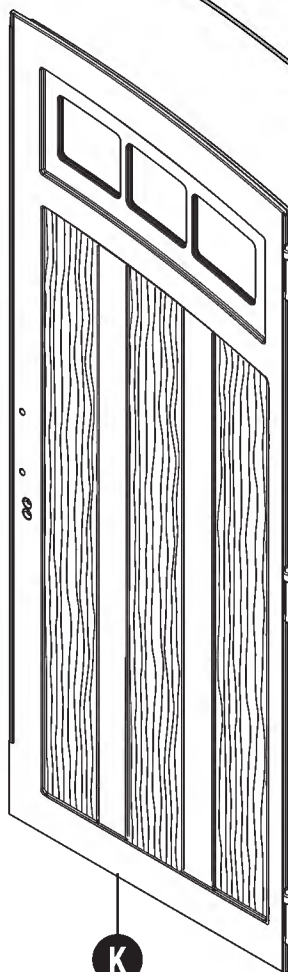

Parts- Headers

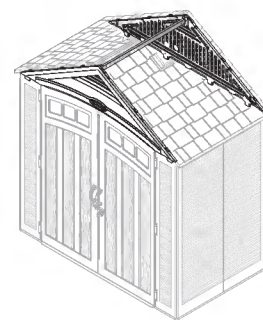

R

1MRG01011
Ridge Beam
46.25"

S

1MPG00001
Header Bracket
x2

H

0B00445XXB
Rear Header

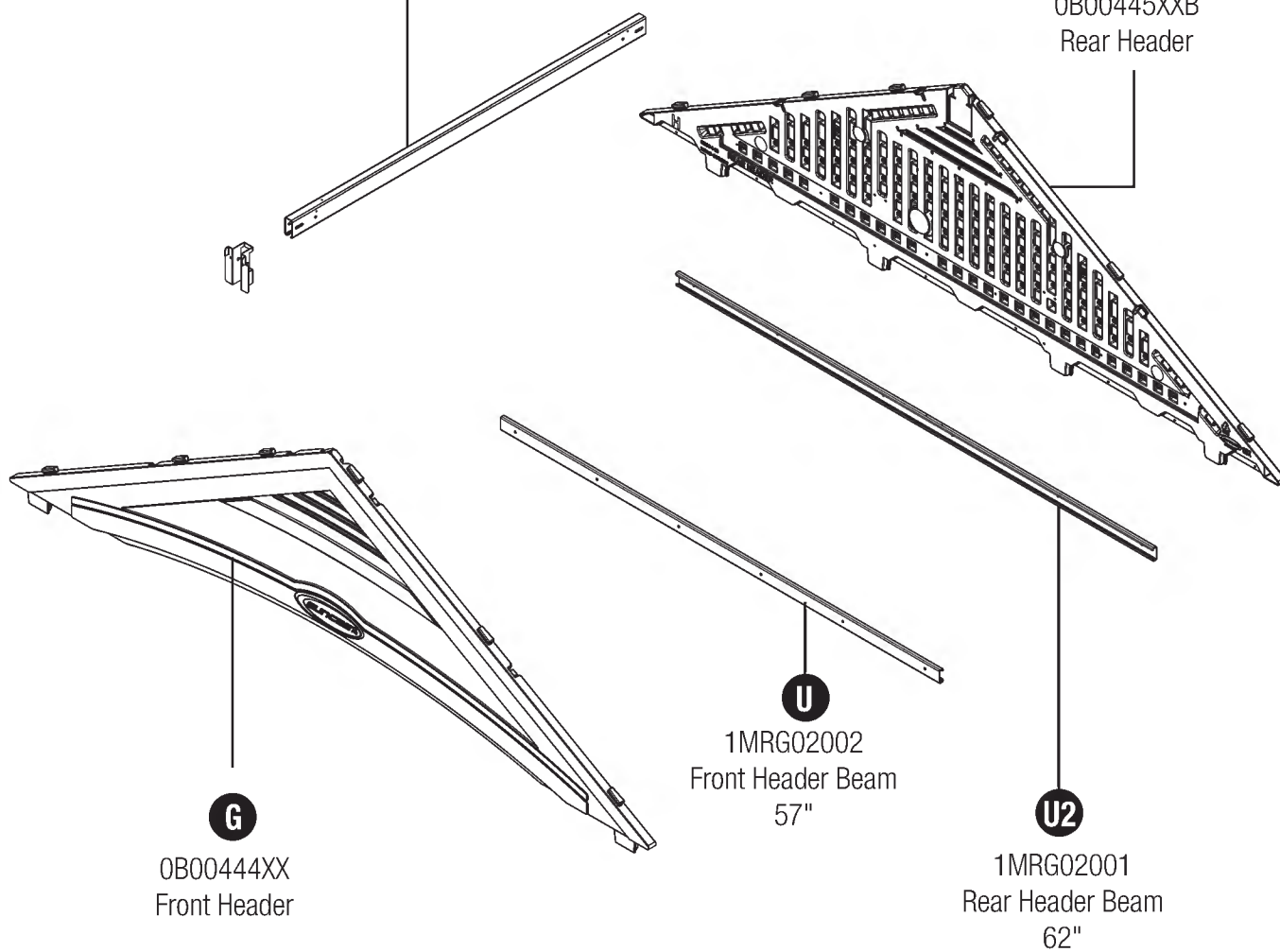

G

0B00444XX
Front Header

U

1MRG02002
Front Header Beam
57"

U2

1MRG02001
Rear Header Beam
62"

Parts - Roof

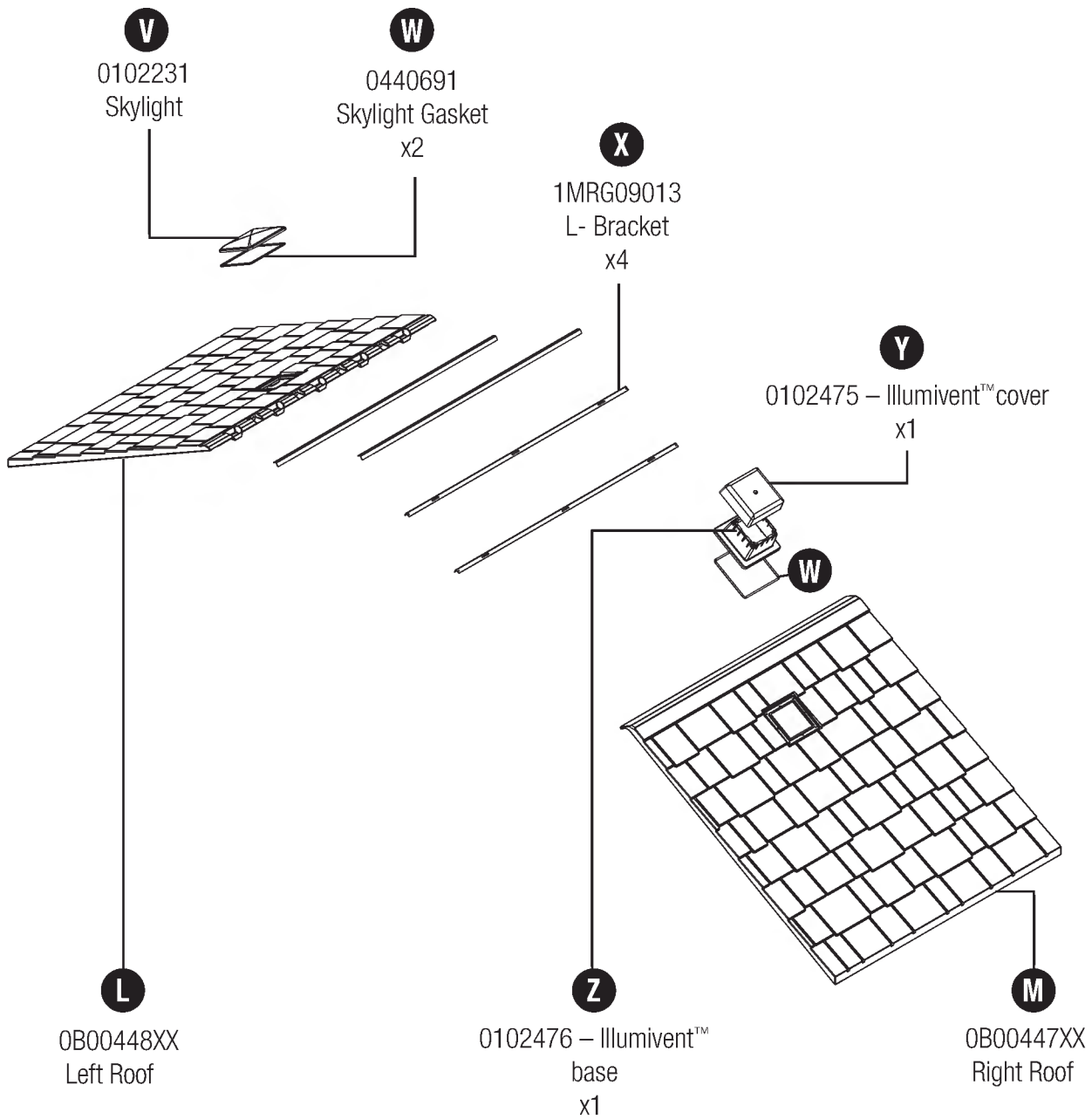
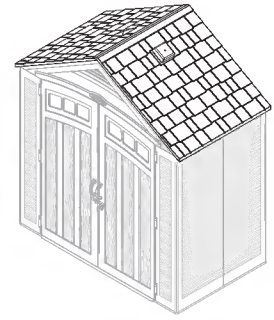

Parts - Hardware

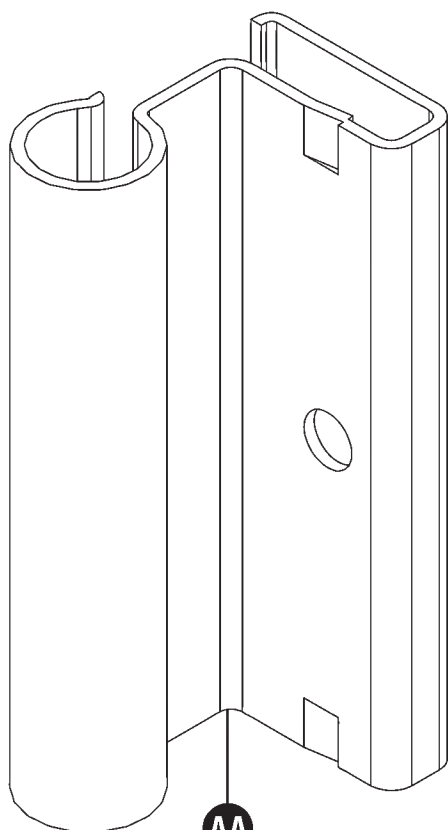

AA
x6

0480374 – Hardware Bag

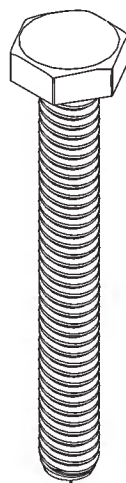

BB
x2

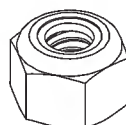

CC
x2

0480445 – Hardware Bag

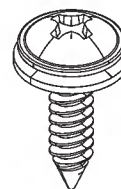

DD
x4



EE
x4

0480298A – Hardware Bag



KK
x42

0480314A – Hardware Bag



KK
x68

0480337– Hardware Bag

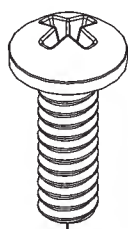

FF
x6

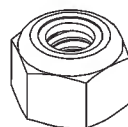

GG
x6

0480452
Hardware Bag



UU
x9

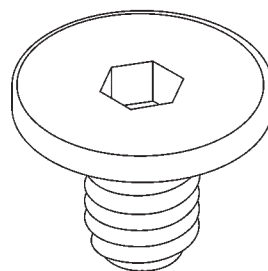

II
x22

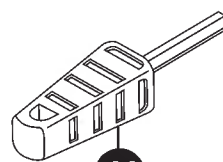

*Easy Bolt Easy Driver

Hardware shown at actual size (*unless otherwise noted). Extra hardware provided. Not all are used.

Parts - Door Handle Kit

0463795A – Door Handle Kit

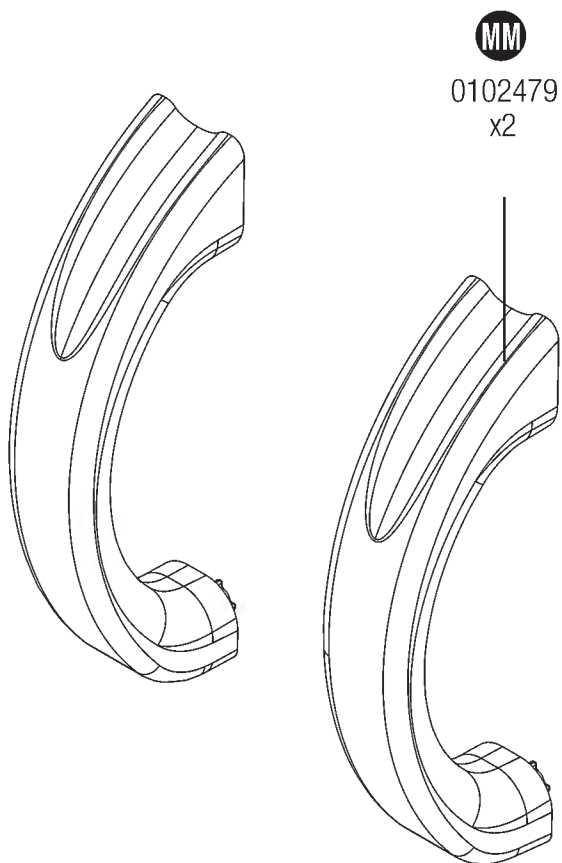

0480370 – Hardware bag

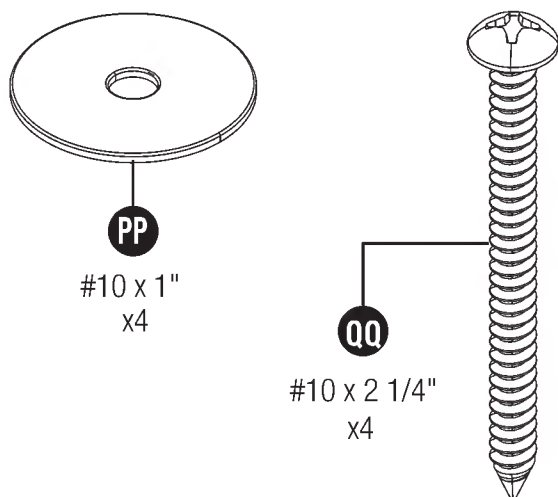

0463797 – Door Latch Kit

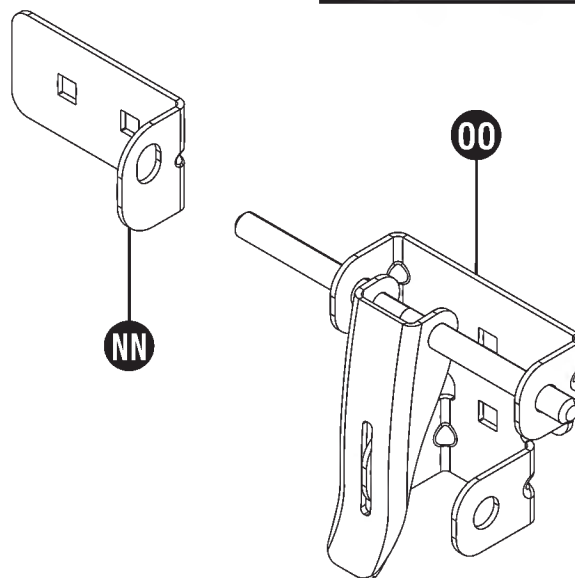
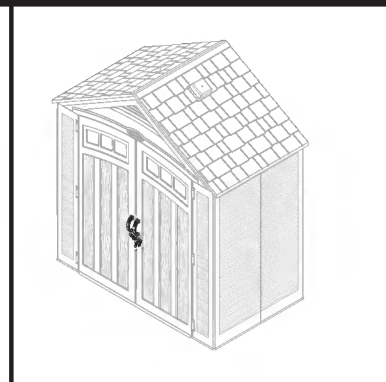

0480439 – Hardware bag

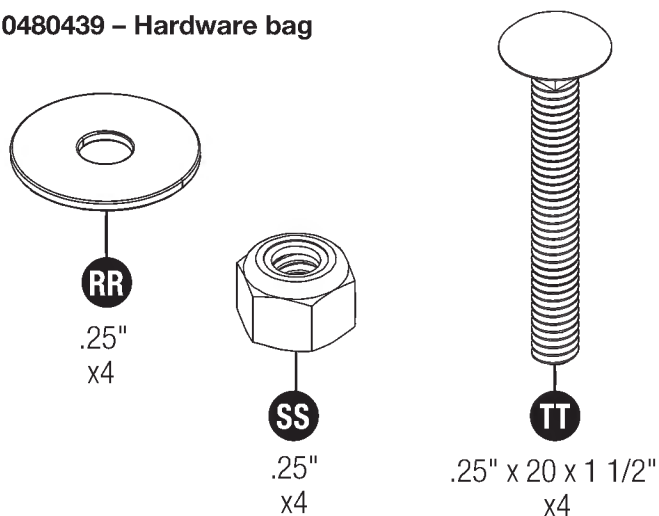

Hardware shown at actual size (*unless otherwise noted). Extra hardware provided. Not all are used.

Site Preparation and Platform Construction

Materials **NOT** supplied with Shed Kit

Important:

- Site preparation is required for this shed. Placing the shed on a properly constructed, square, flat and level foundation, as described below, is required. Without a properly constructed, square, flat and level foundation, settling will eventually occur, causing distortion and damage to the shed. Suncoast is not responsible for replacing parts damaged or property lost due to incorrect foundation construction. Warranty requires a properly constructed foundation as described below.
- Complete the site preparation and foundation construction before unpacking parts and beginning assembly. For tips on site preparation, go to www.suncoast.com, consult retailer, or local codes.

Site Preparation

1. Consult your local authorities for building codes and covenants before beginning foundation or erecting shed.
2. Before any digging, check with local utilities to determine location of buried cables, pipes, etc.
3. Decide which type of foundation is most suitable for your installation. **The foundation surface must be square, flat and level.** Follow the below guidelines for foundation options:

Concrete Slab

- Construct a slab of at least 4" thickness.
- The use of reinforcement bar is recommended.

4. Complete the foundation preparations as follows:
 - A vapor barrier may be applied over the foundation to prevent excessive condensation in the shed. Follow local building codes for a proper vapor barrier.
 - The ground should slope away from the foundation area to provide drainage.

Wood Platform

- Use exterior grade wood.
- Set the platform on pier blocks or footing.

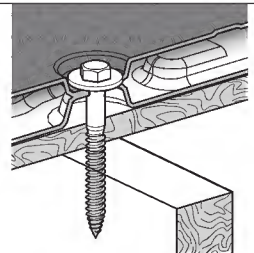

Anchor section example

Anchoring the floor panels to foundation is required after assembly is complete.

- Shed floor panels include flattened areas where anchors or lag screws are to be secured. These flat areas must be drilled through prior to securing the floor panels to the foundation.

Concrete Slab

- Secure shed to concrete slab using 3/8" masonry anchors with 1" washers. Masonry anchors and 1" washers are available at most local hardware retailers. **4 masonry anchors are required for this model**

Wood Platform

- Secure shed to wood platform using 1/4" - 3/8" x 3" lag screws with 1" washers. Lag screws and 1" washers are available at most local hardware retailers. **4 lag screws are required for this model.**

Note: Shed floor fastening locations are designed to align with the under-structure layout. Be sure the front of the base panels are oriented correctly on the platform to ensure lag bolts engage with the under-structure.

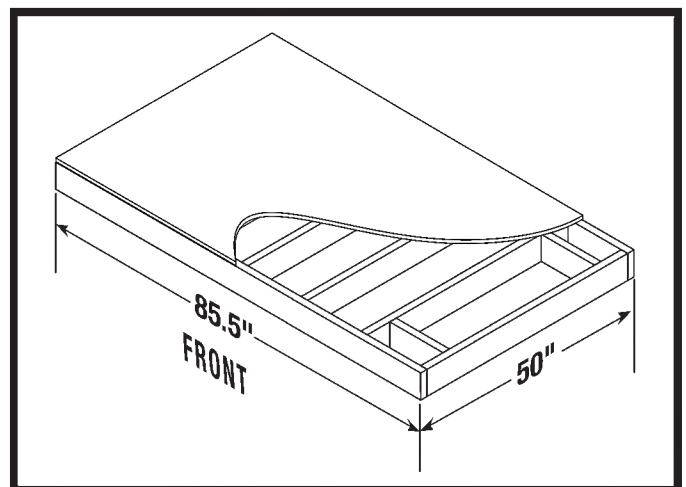
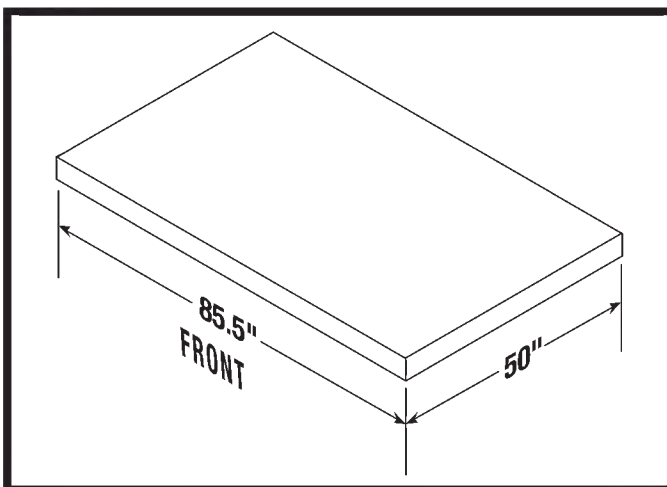

* Dimensions allow for shed to fit within the nearest 1" on each side.

Wood platform critical spacing

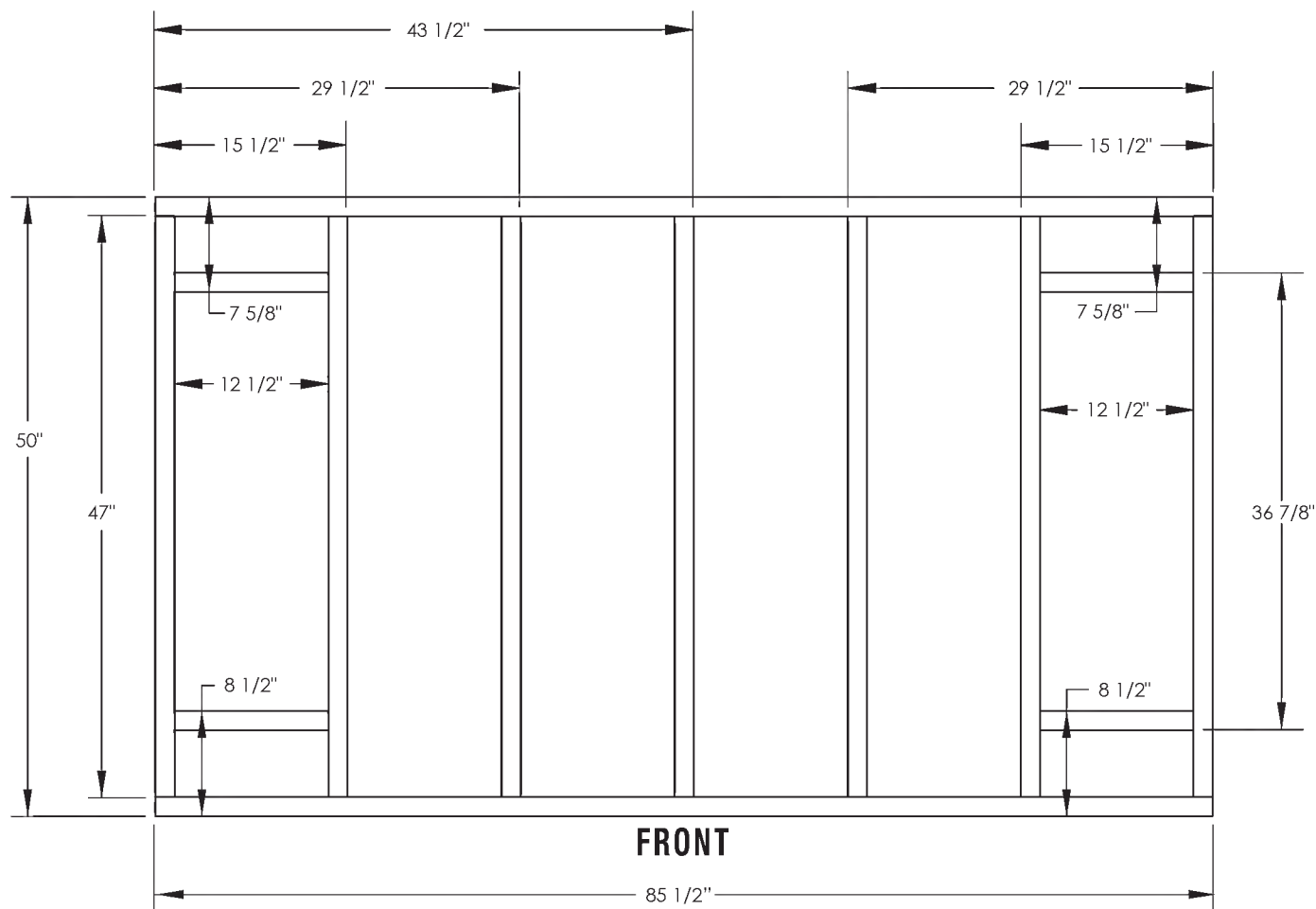

- Check all critical spacing measurements.

Wood platform materials list

| Item | Qty | Size |
|------|-----|---------------------|
| a | 2 | 50" x 42.75" x .75" |
| b | 4 | 2" x 6" x 12.5" |
| c | 2 | 2" x 6" x 85.5" |
| d | 7 | 2" x 6" x 47" |

- Please Note - dimensional lumber is actually 1/2" smaller than noted sizes.

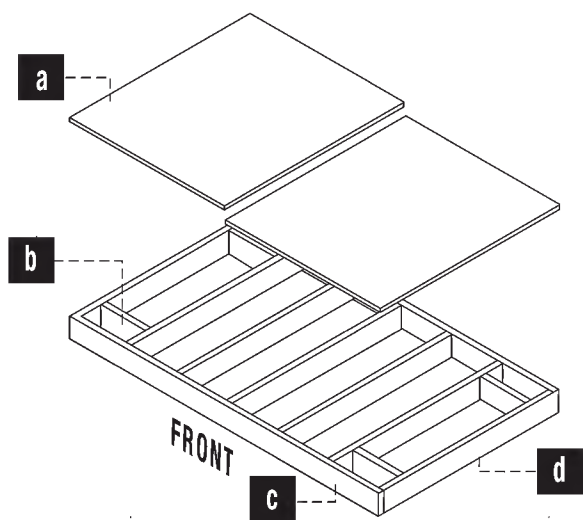

Pre-Assembly

1

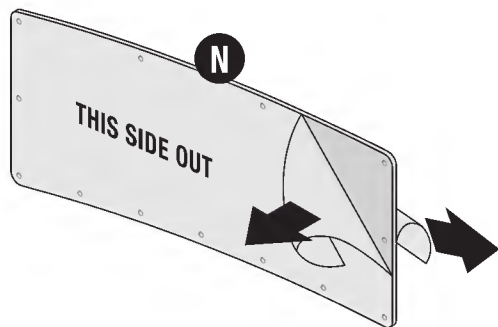

Peel film from both sides of left door window (N).

Note: One side of film will say "THIS SIDE OUT." Make sure this side faces out when installing window.

2

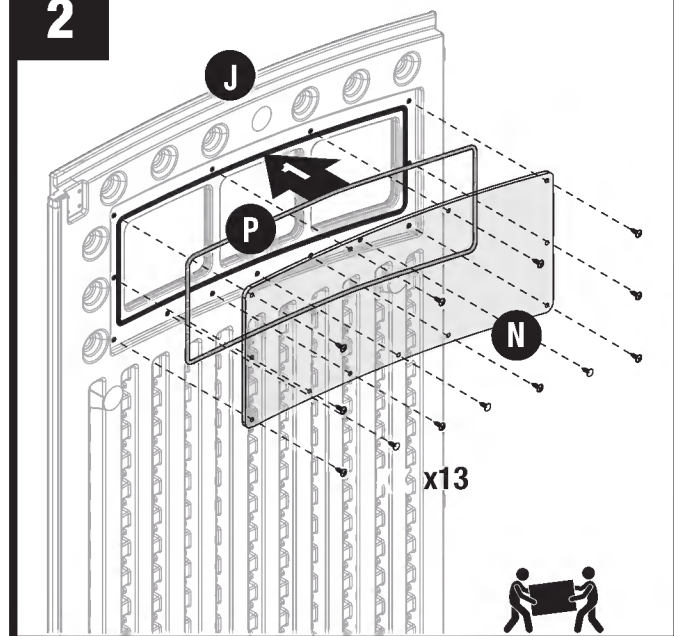

Place gasket (P) and left door window (N) into left door (J) channel. Secure with 13 screws (KK), starting at corners. **DO NOT** over tighten screws.

Note: The cut portion of gasket (P) **MUST** be assembled on top of door channel.

Repeat for right door (K) and right door window (Q).

3

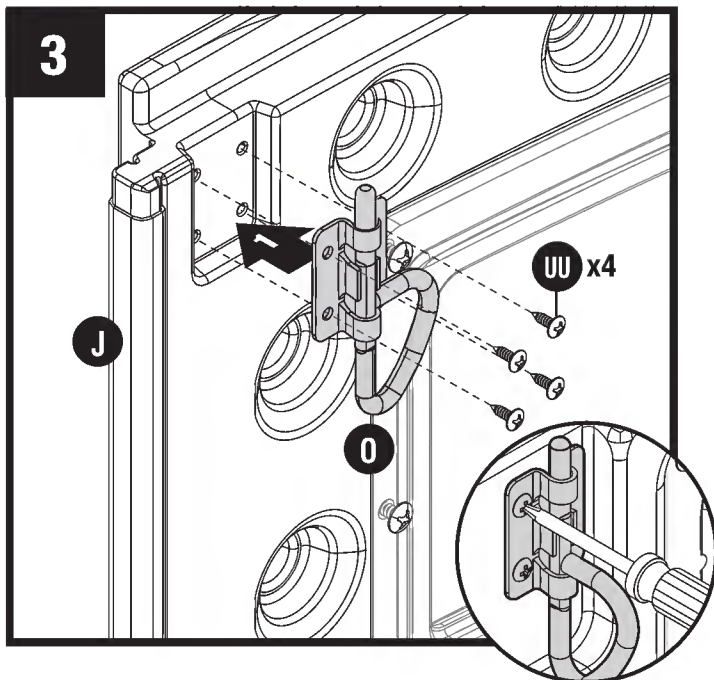

At top interior side of left door (J), attach D-ring (O) with 4 screws (UU) as shown.

4

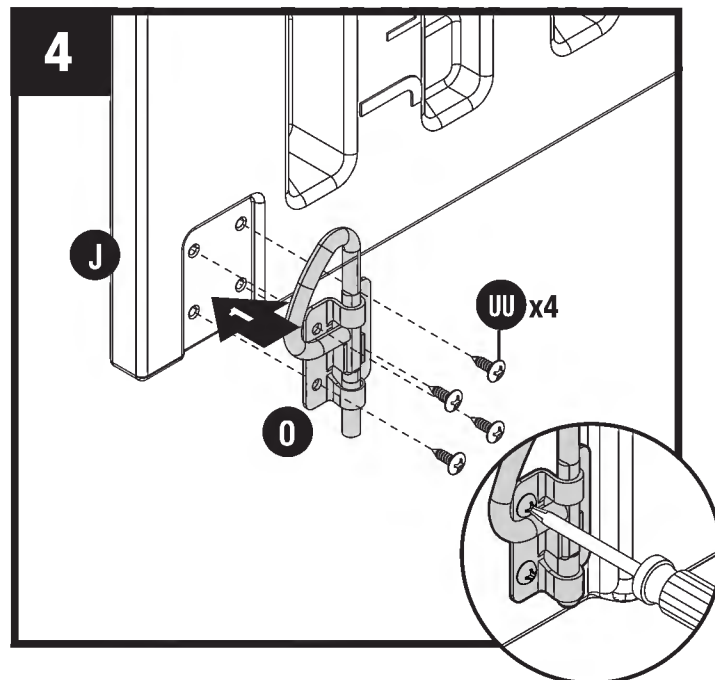

At bottom interior side of left door (J), attach D-ring (O) with 4 screws (UU) as shown.

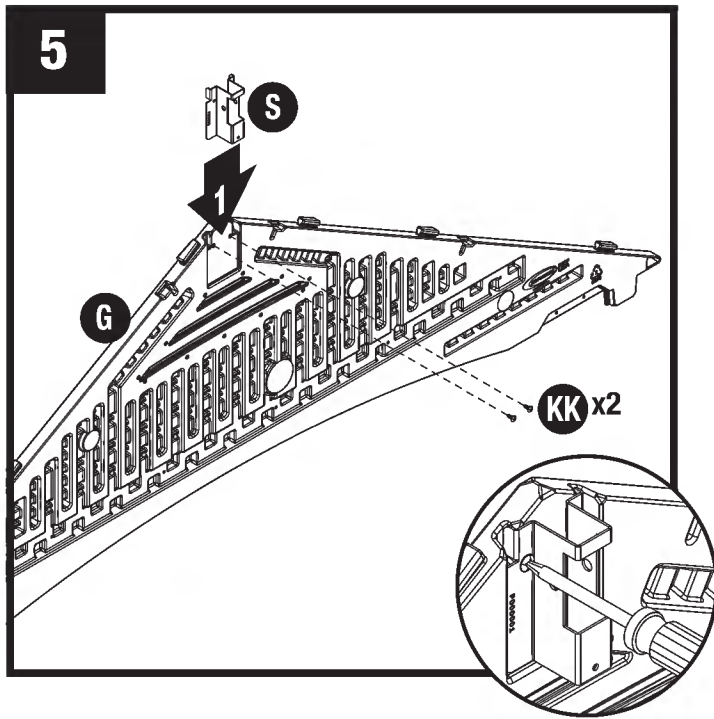

Slide roof ridge beam bracket (S) under tabs on peak of front header (G) and secure with 2 screws (KK).

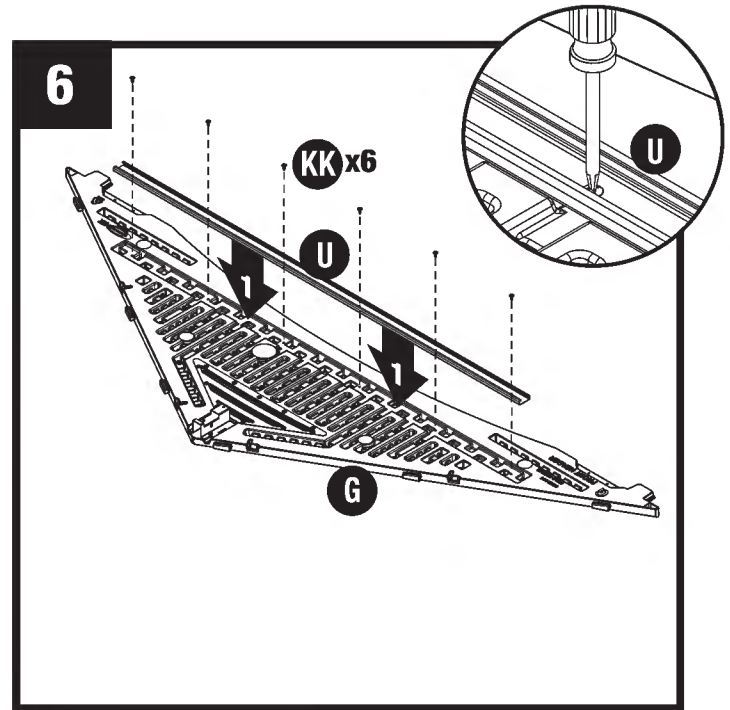

Lay front header (G) on ground as shown. Place front header beam (U, 57") into pocket. Attach with 6 screws (KK).

Repeat for rear header (H) and header beam (U2, 62").

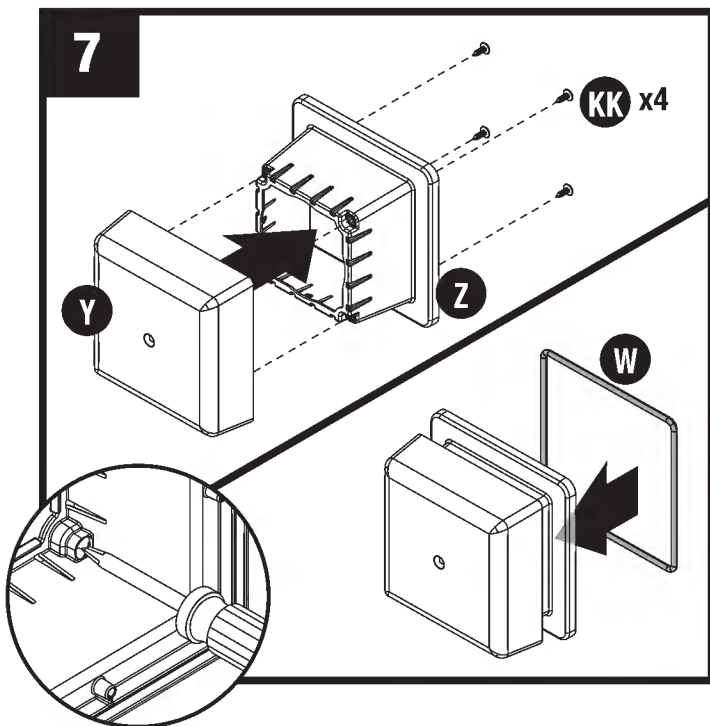

Place Illumivent™ cover (Y) onto bottom (Z). Secure from underside with 4 screws (KK). Place gasket (W) into Illumivent™ bottom (Z).

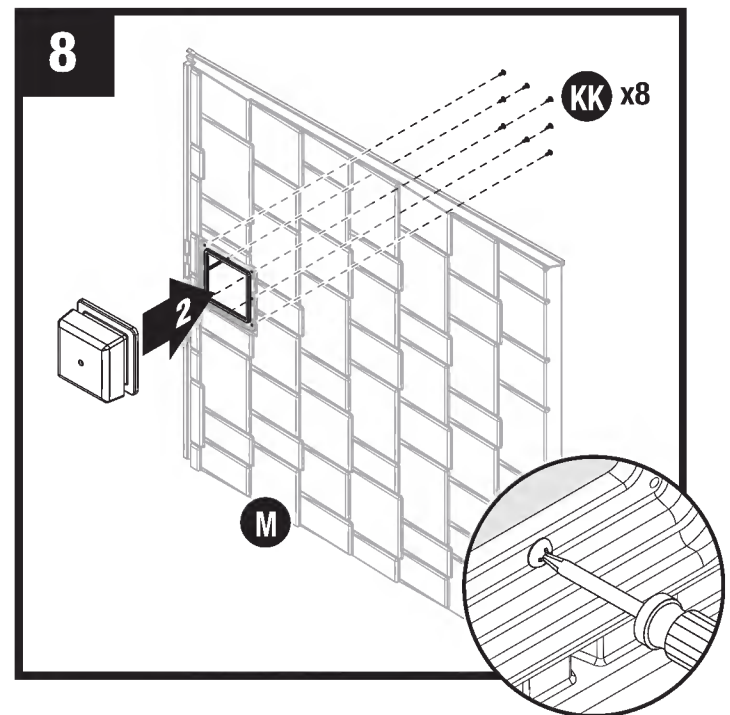

Place Illumivent™ assembly (Y, Z, W) onto right roof panel (M). Secure from underside with 8 screws (KK). Screw corners in first. Make sure rib on plastic parts is seated fully against gasket on Illumivent™.

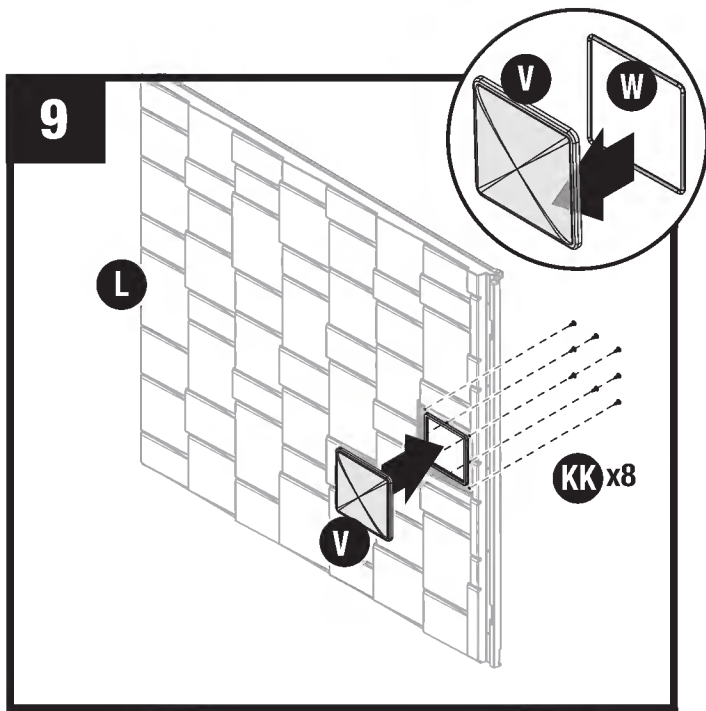

Place skylight gasket (W) into skylight (V). Place skylight (V) onto left roof panel (L). Secure from underside with 8 screws (KK). Make sure rib on plastic parts is seated fully against gasket on skylight.



Assembly

Critical: When installing corners, flex corner hinges back and forth several times. This will help provide a square corner and ensure proper fit of the panels.

IMPORTANT: DO NOT flex in reverse position, this can crack the panel.

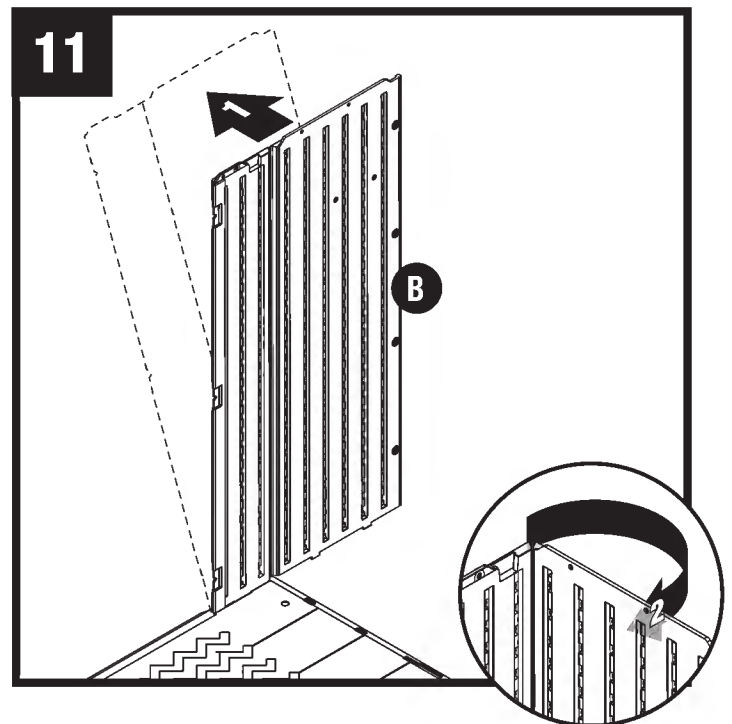
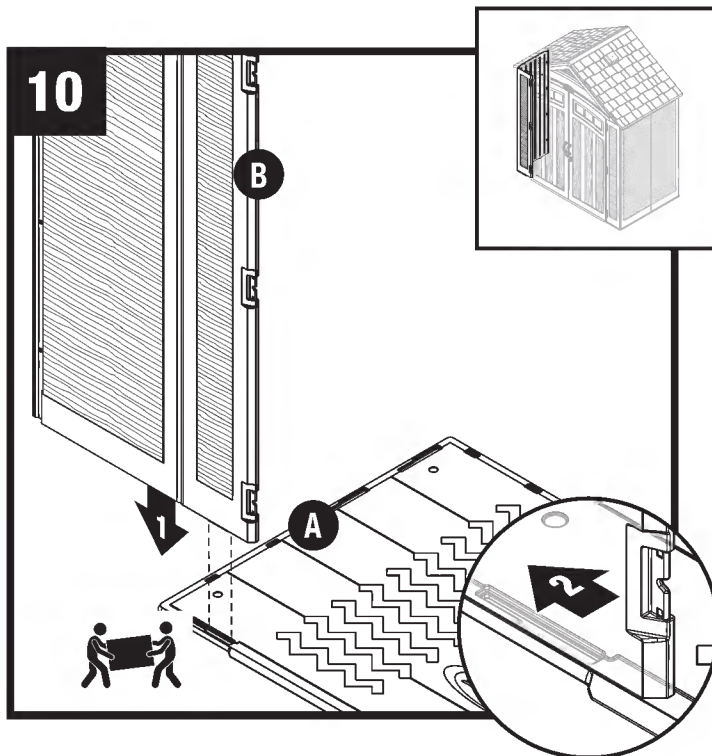

Align tab on bottom right side of left front corner (B) with slot on floor (A). Lower panel into slot and lock in place by sliding panel toward outside of floor.

Note: Use a rubber mallet to “push” left front corner (B) into locked position.

Tip left front corner (B) outward slightly and bend corner hinge.

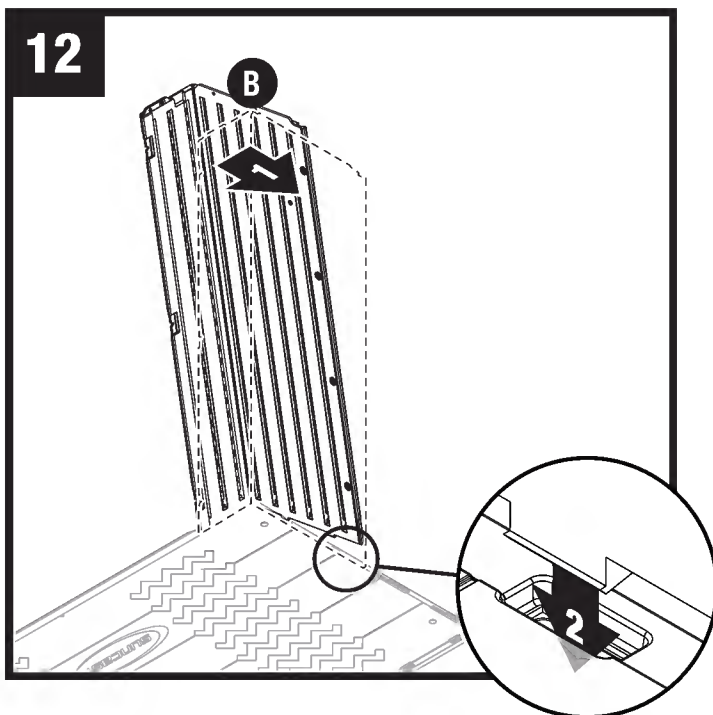

Tip left front corner (B) back to vertical position and align lower tabs on right side with slots in floor.

Note: You will hear a snap when tab is fully engaged.

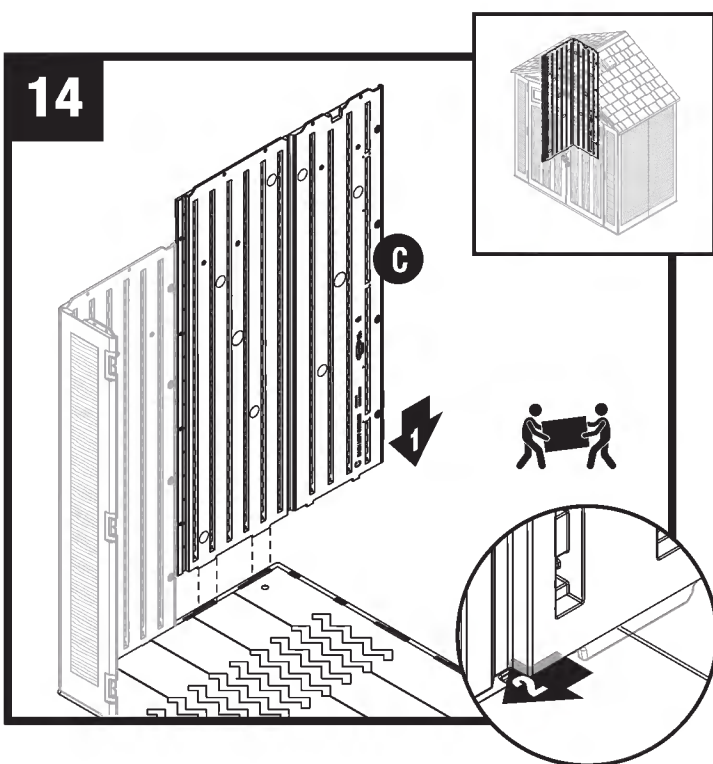
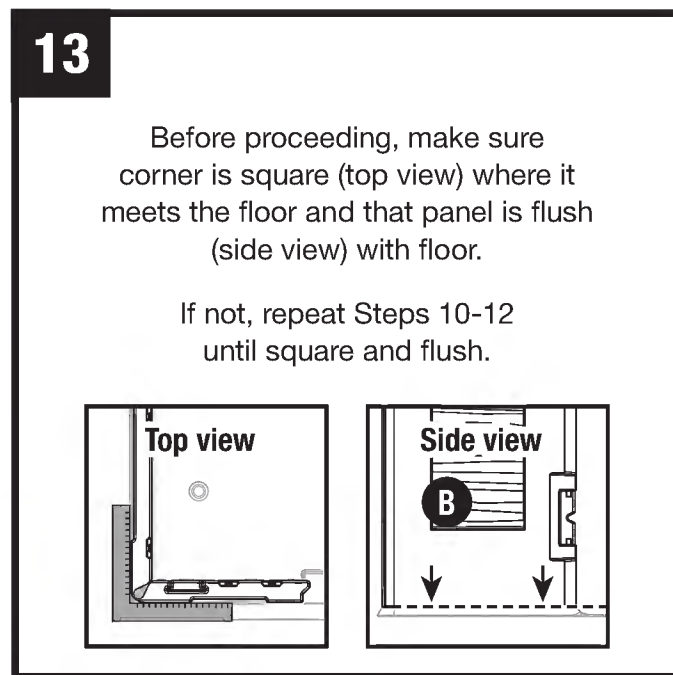

Align tabs on bottom of back left corner (C) with slots along floor. Lower panel into slots and lock in place by sliding panel toward front corner.

Note: Use a rubber mallet to “push” back left corner (C) into locked position.

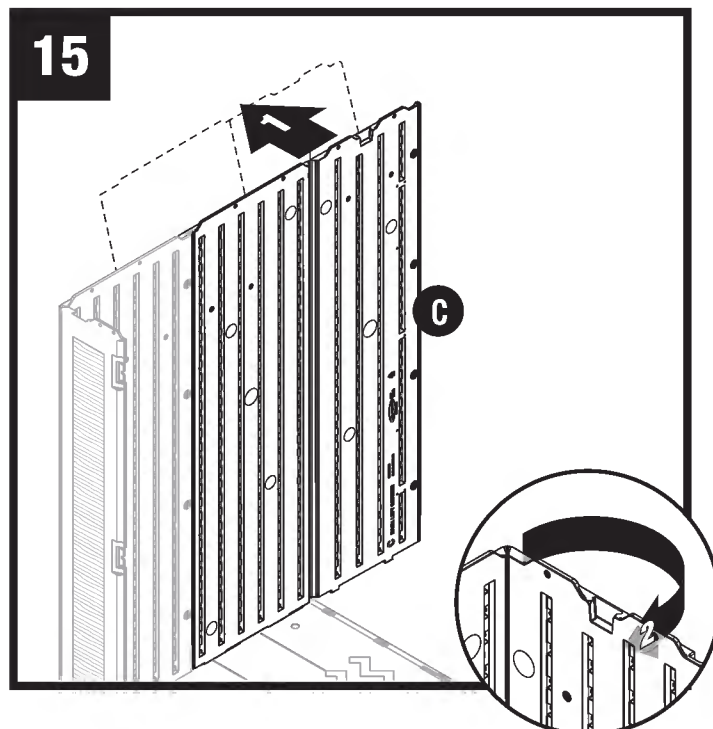

Tip left back corner (C) outward slightly and bend corner hinge.

16

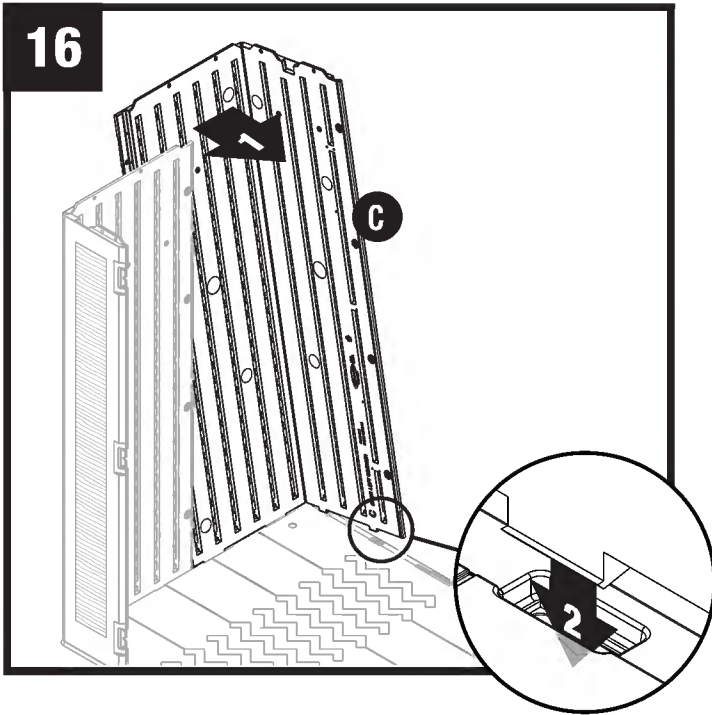

Tip left back corner (C) back to vertical position and align lower tabs on right side with slots in floor.

Note: You will hear a snap when tab is fully engaged.

17

Before proceeding, make sure corner is square (top view) where it meets the floor and that panel is flush (rear view) with floor.

If not, repeat Steps 14-16 until square and flush.

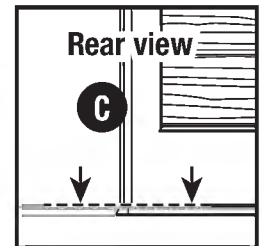
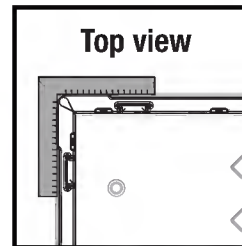

18

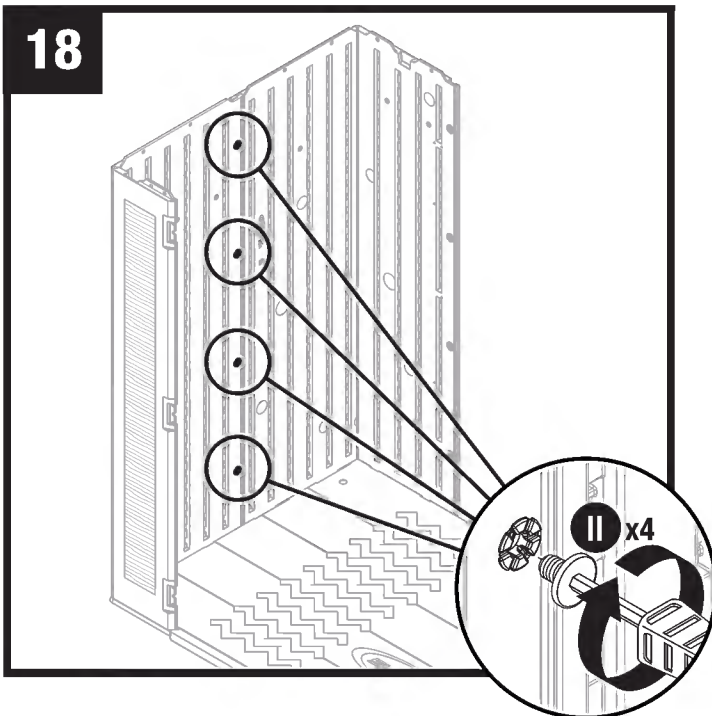

Secure left back corner with 4 easy bolts (II), working from floor to roof. Use easy driver (JJ) and hand tighten.

19

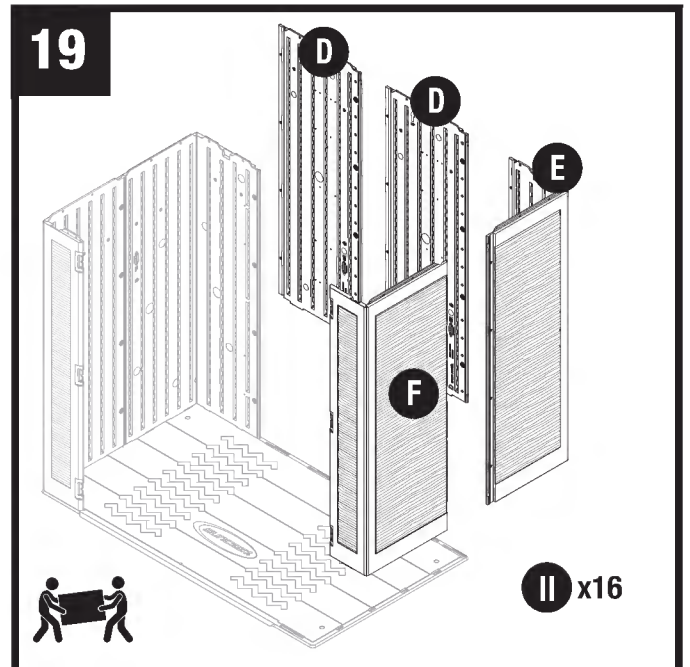

Repeat Steps 10-18 for remaining panels.

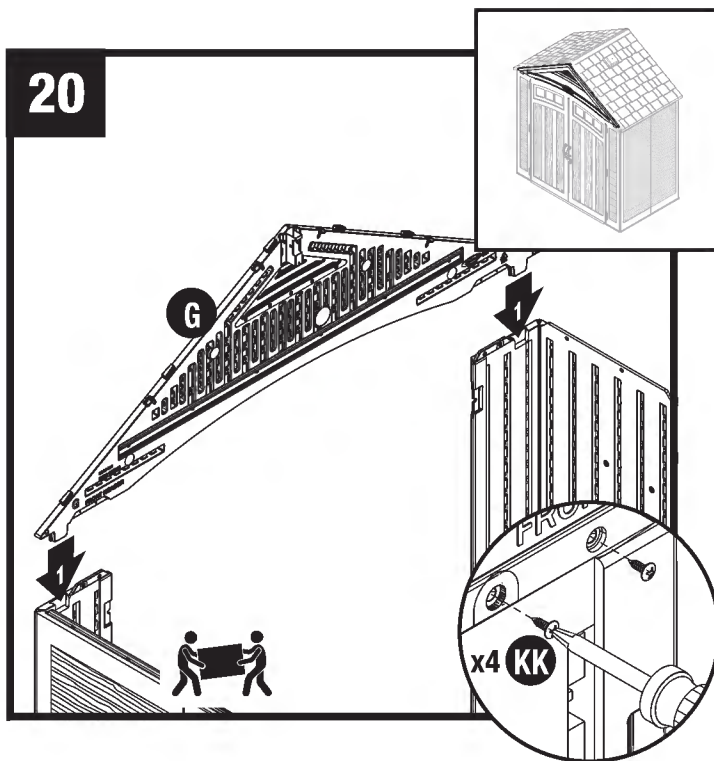

Place front header (G) over door opening and fit two protruding support legs into pockets molded in front corners. Secure front header using 2 screws (KK) in each front corner.

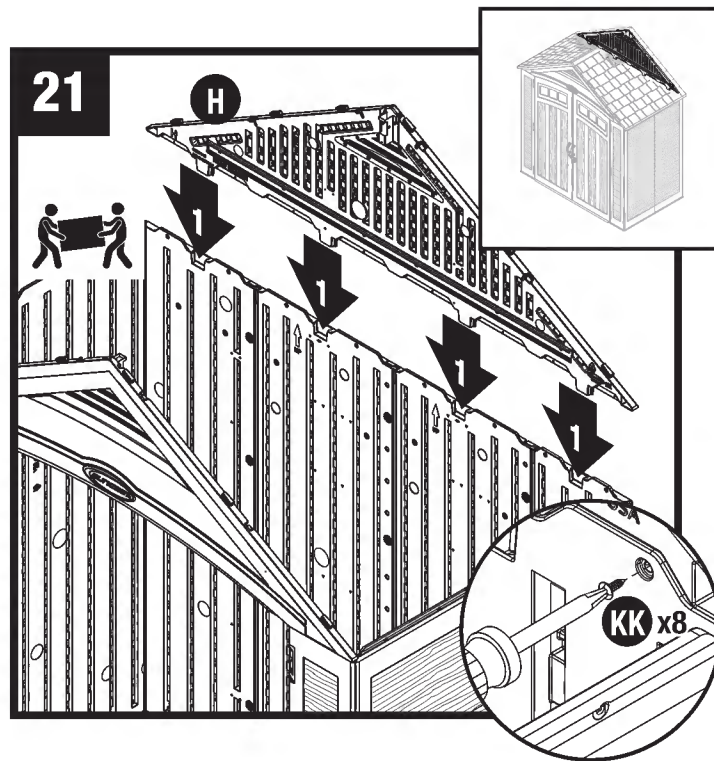

Place rear header (H) over back walls and fit four protruding support legs into pockets molded in back walls. Secure rear header using 8 screws (KK).

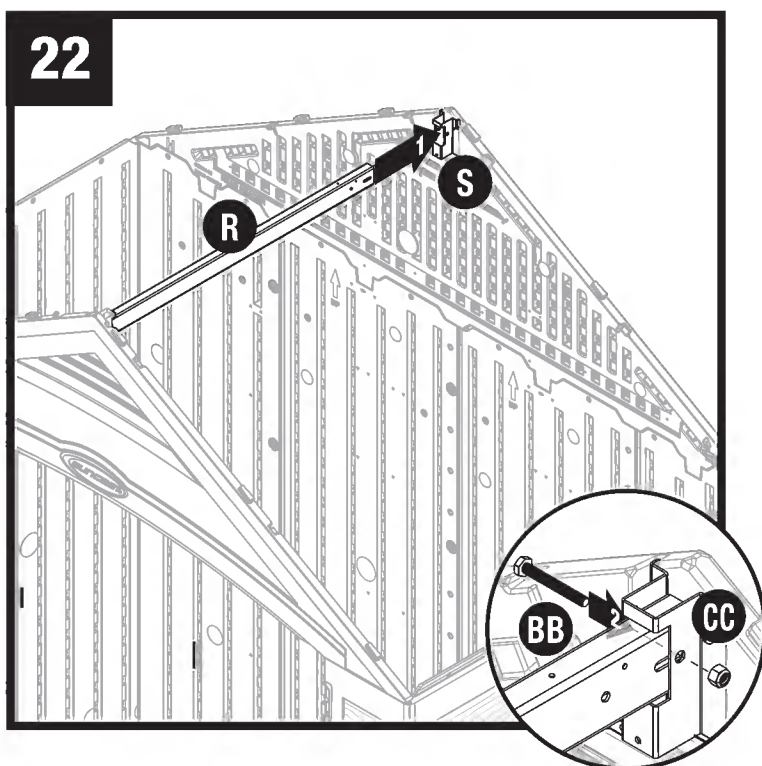

Raise ridge beam (R) up and into rear roof ridge beam bracket (S). Secure with 1/2" hex bolt (BB) and locking nut (CC).

Repeat for front roof ridge beam bracket.

Note: Alignment of ridge beam to bracket may require header panels to be pushed inwards or outwards slightly as ridge beam is slid into place.

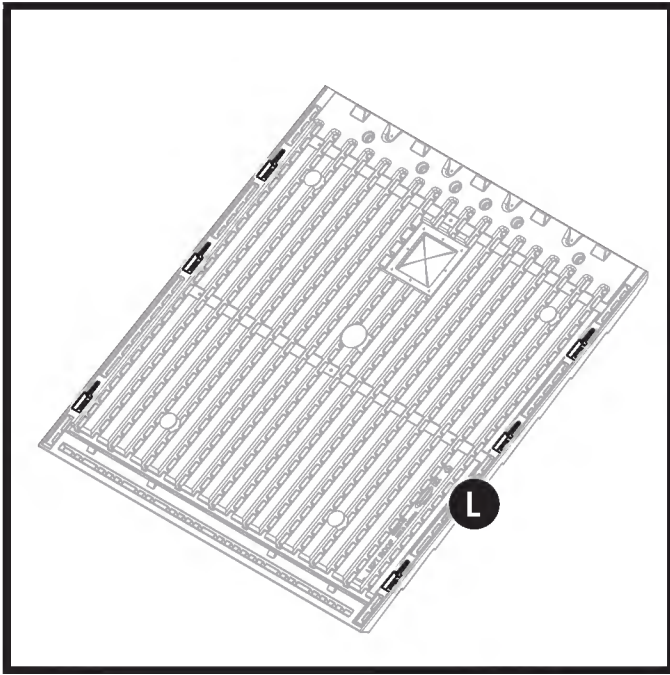

Before proceeding, locate and identify the six slots on interior side of left roof panel (L).

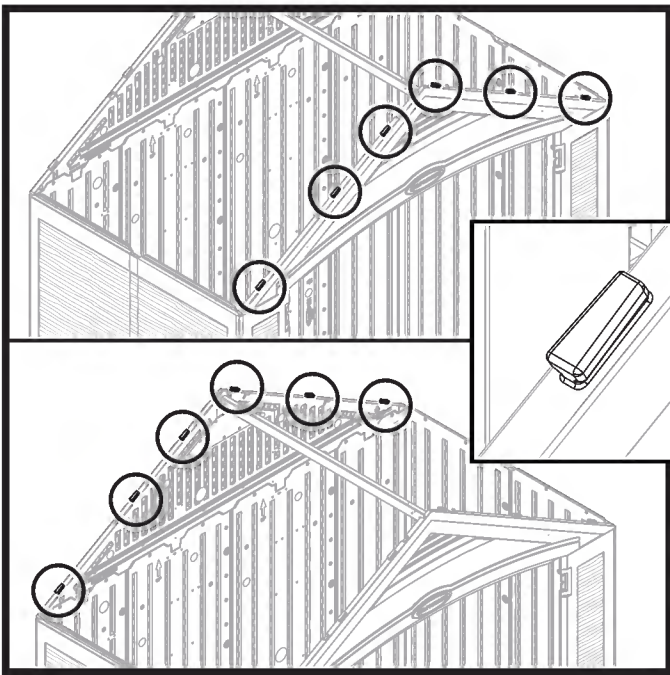

Before proceeding, locate and identify six front header tabs and six rear header tabs.

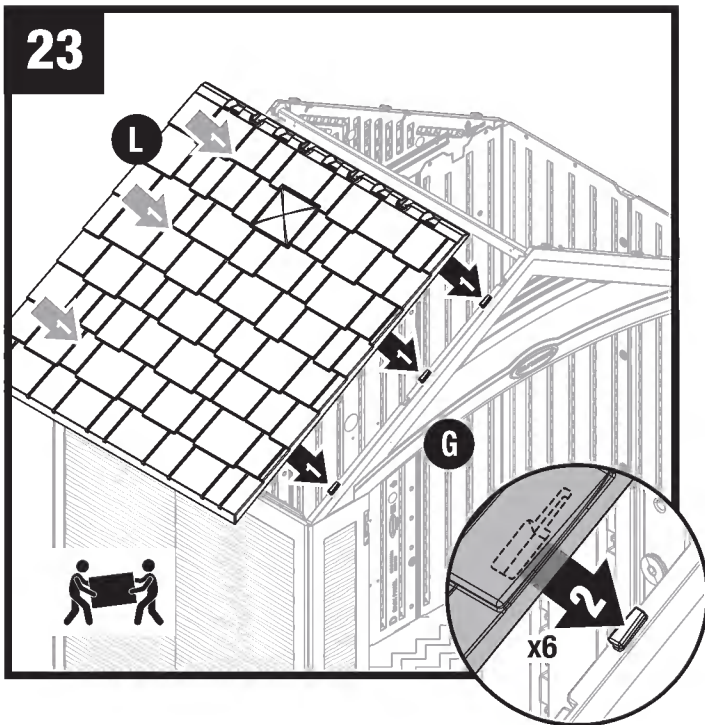

Lay left roof (L) over shed so that the 6 slots on roof (L) align with the tabs on the front (G) and rear (H) headers.

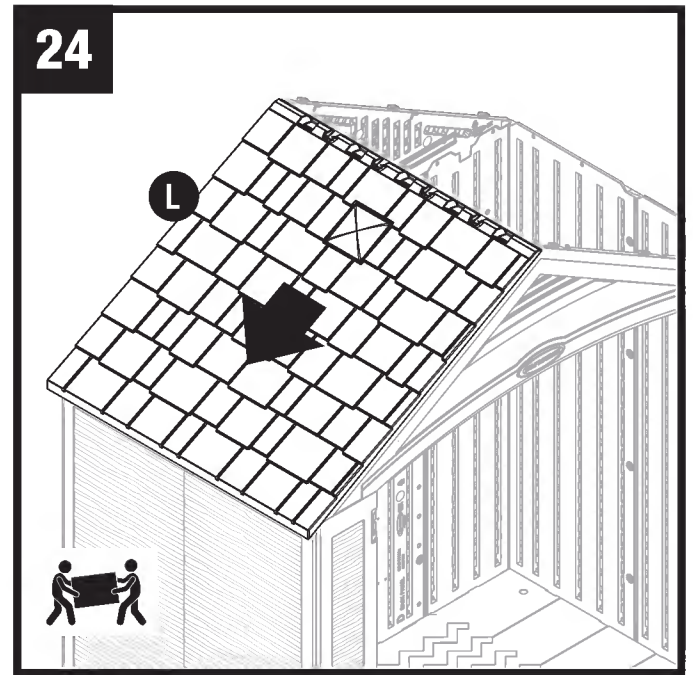

Slide left roof (L) down towards the outside of shed.

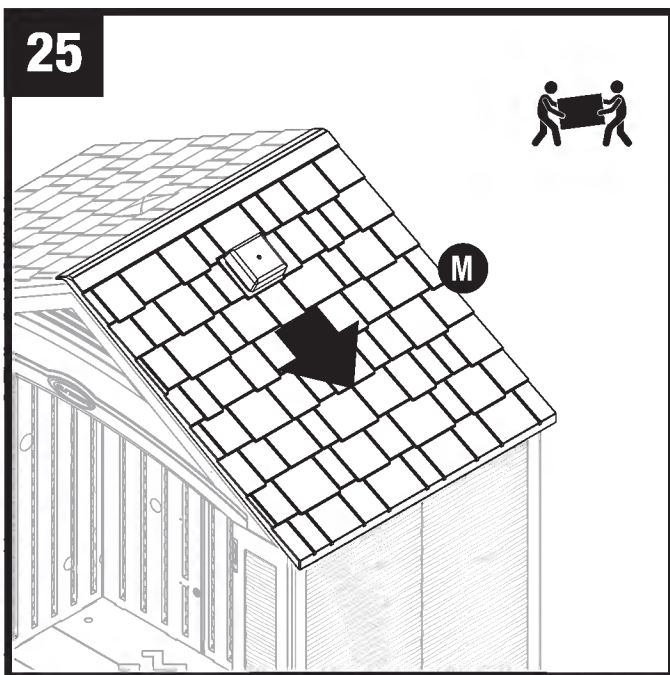

Repeat steps 23-24 for right roof (M).

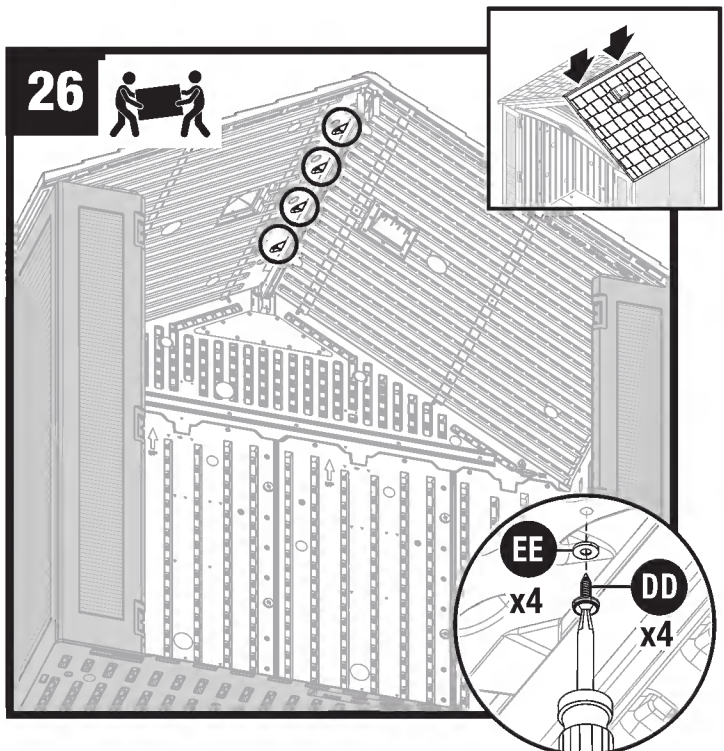

From the outside of the shed, push down where the roof panels join. From the inside of the shed, secure left and right roofs (M,L) together using 4 rubber sealing washers (EE) and 4 sealing screws (DD).

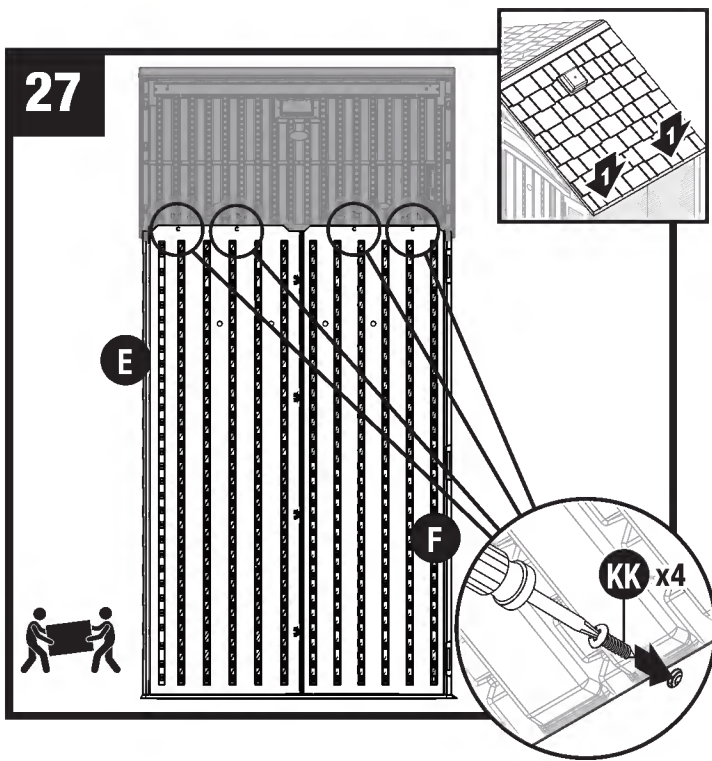

From outside of shed, push down the end of right roof (M). From inside shed, secure roof to right front corner (F) and right back corner (E) with 4 screws (KK).

Repeat for left roof (L).

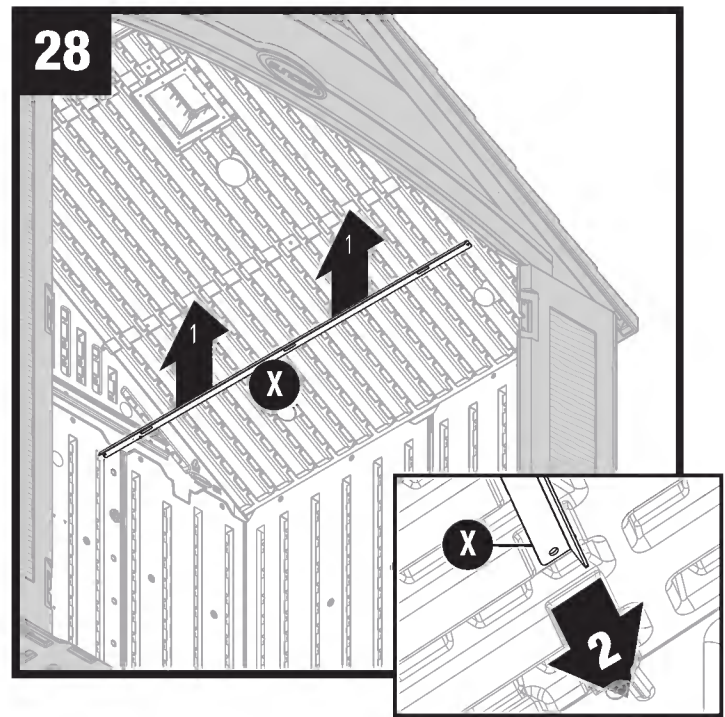

Raise L-bracket (X) into position against roof (M). Slide L-bracket (X) into front and rear headers.

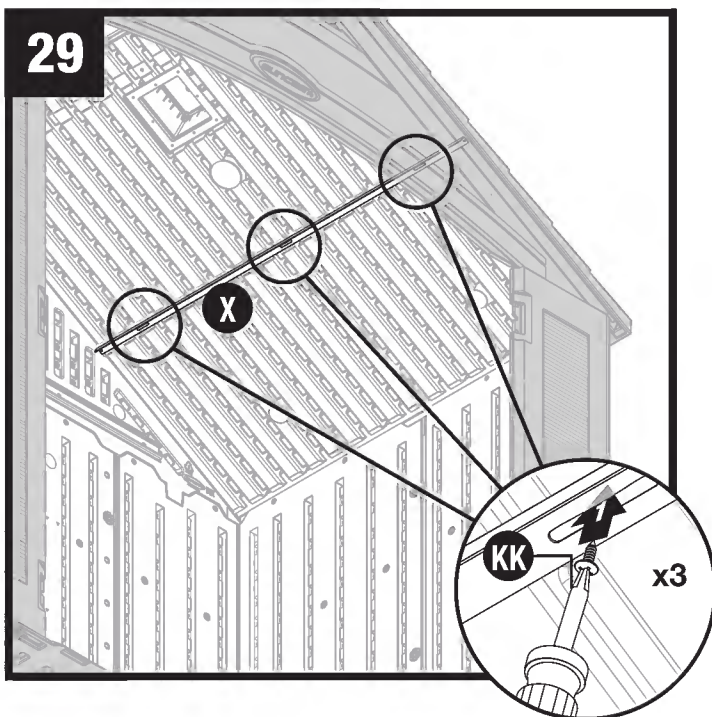

Secure L-bracket (X) to underside of roof with 3 screws (KK).

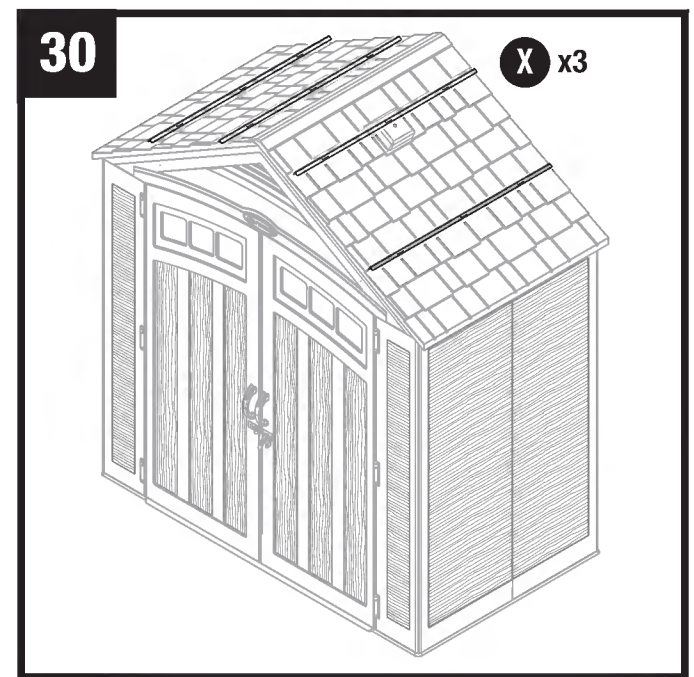

Repeat Step 28-29 to secure remaining L-brackets (X).

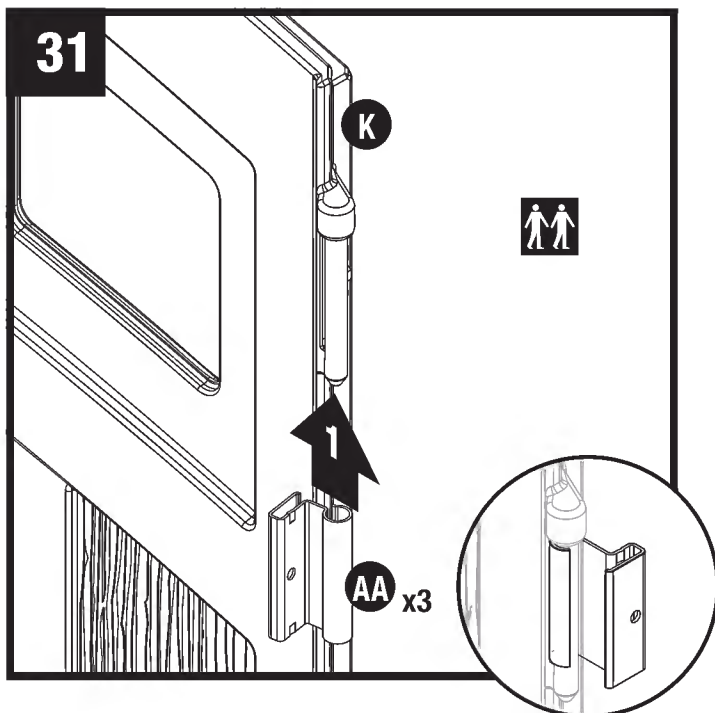

Stand right door (K) upright as shown. Slide 1 metal hinge plate (AA) up onto each hinge pin. Rotate hinges to outside of door.

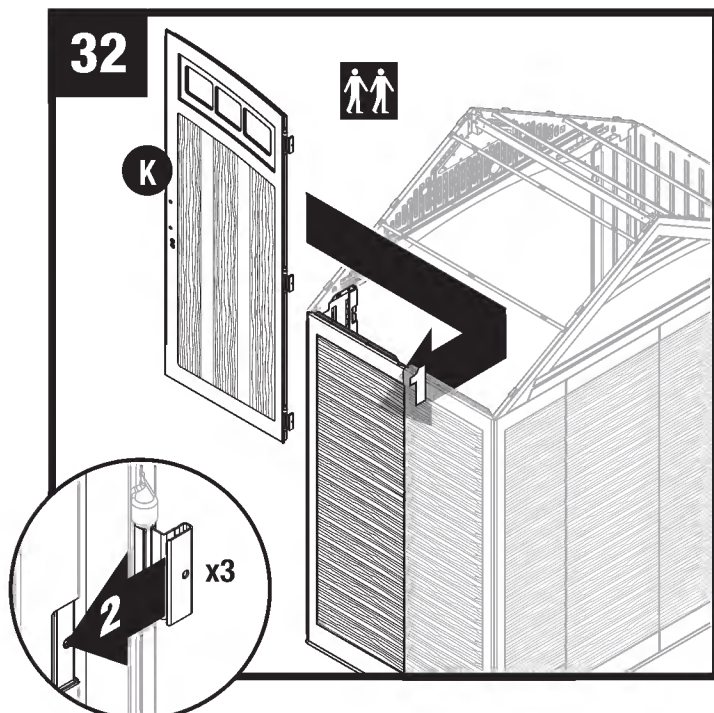

With metal hinge plates in open position, slide 1 hinge over each hinge receptacle on inside of right front panel.

Note: Use a rubber mallet if needed.

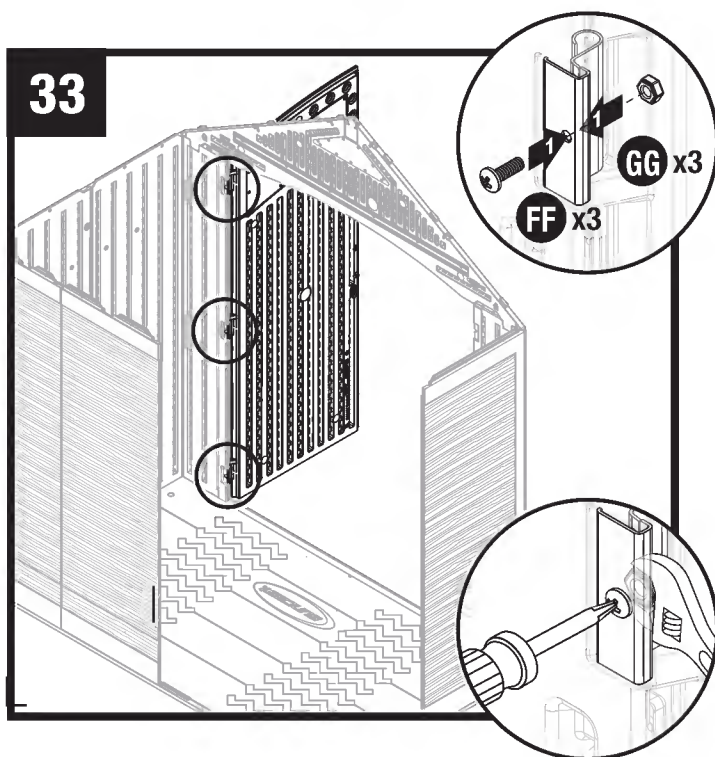

Secure each metal hinge plate with 1 screw (FF) and locking nut (GG).

Repeat Steps 31-32 for left door (J).

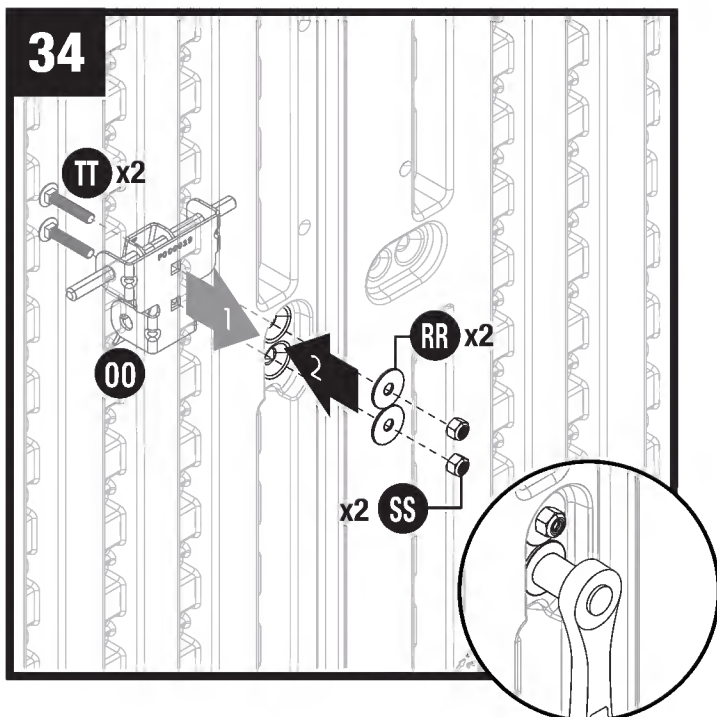

Insert 2 screws (TT) into door latch assembly (OO) and through right door. While holding plate in place on exterior of door, secure each screw with 2 washers (RR) and locking nuts (SS).

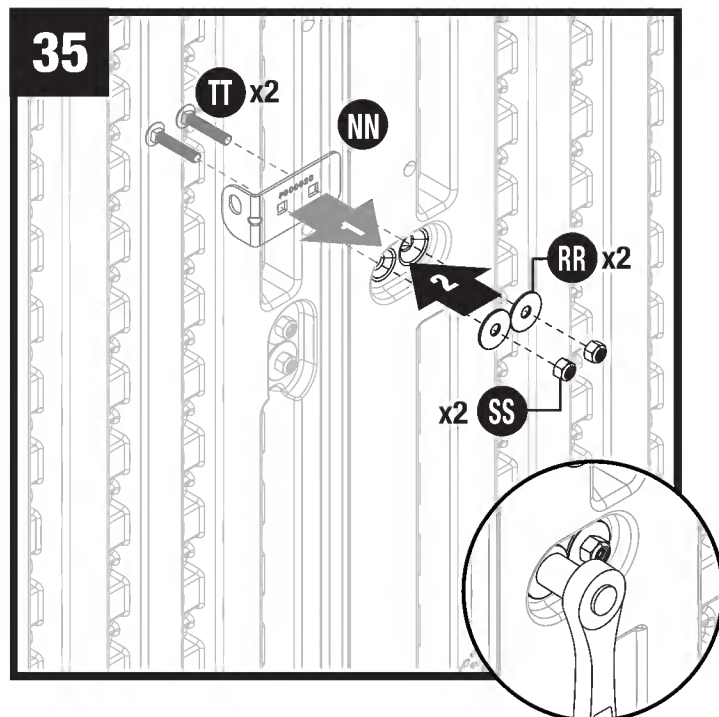

Insert screws (TT) into left latch plate (NN) and through left door. While holding plate in place on exterior of door, secure each screw with 2 washers (RR) and nuts (SS).

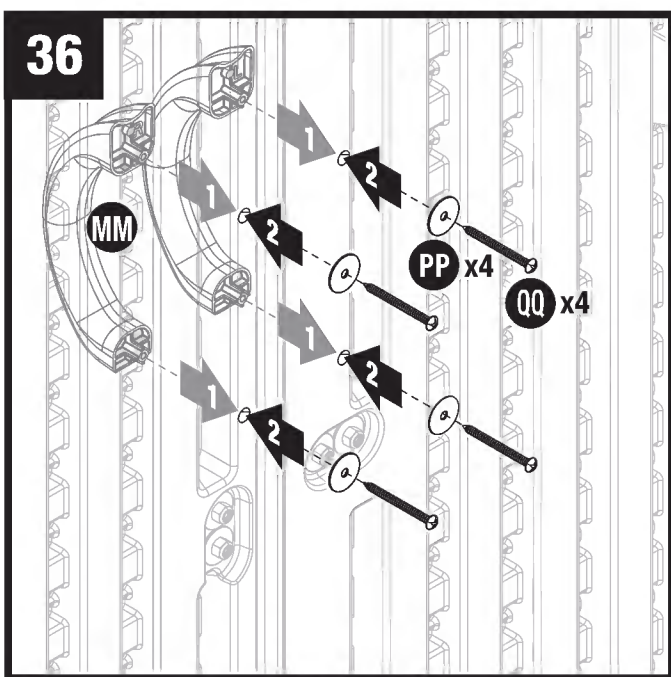

From the outside of doors, insert door handles (MM) stems into holes of left and right doors. On inside of doors, place washers (PP) on each door handle stem, and secure each with 1 screw (QQ).

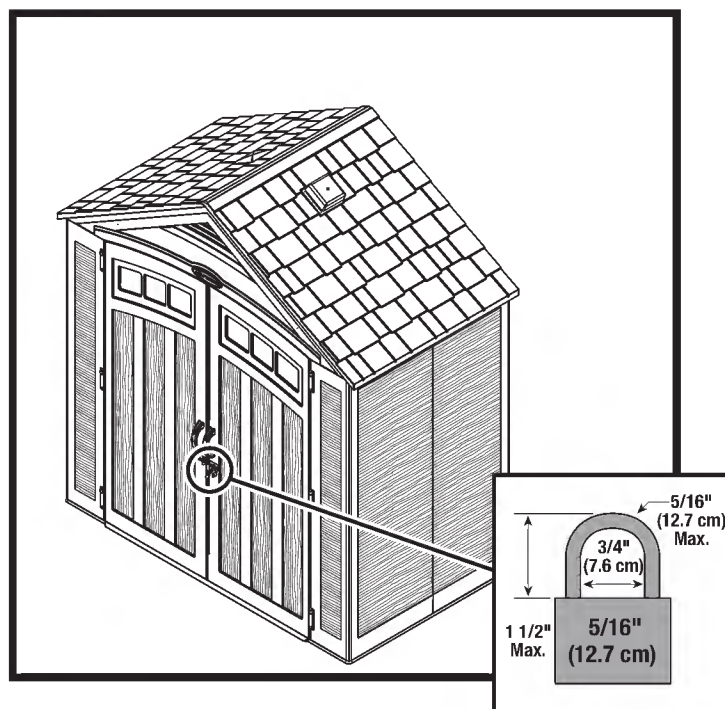

Attach a 5/16" lock (not provided) to door latch, to properly secure shed.

Note: to maintain warranty coverage, the product should be pad-locked at all times when not in use.

