

# Installation Guide

ONE-PIECE PEDESTAL SINK



## Tools and Materials



Safety  
Glasses



Pencil



Caulk



Wrench

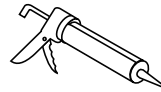

Construction  
Adhesive

## Prior to Installation



**Read the following instructions thoroughly before installation of the sink:**

1. Unpack the sink and inspect it for damage.
2. Observe all local plumbing and building codes.
3. Additional preparations on the floor and wall may be necessary to avoid product damage.
4. Confirm that the sink will fit in the intended location and that plumbing fixtures are located where legally required prior to installation.
5. Make sure to measure the actual dimensions of the sink prior to installation.
6. It's recommended that the sink be installed by two people.

## Installation Procedures



### **STEP I.** Verify Sink Location

- Mark the location on the floor with a pencil where the sink is intended to be installed.

### STEP II. Install Plumbing

- Install the faucet as per the manufacturer's instructions. (faucet not included)
- Connect the plumbing pipes in the wall with the pedestal sink. (plumbing pipes not included)
- Test fit the pedestal sink before proceeding with the next step.

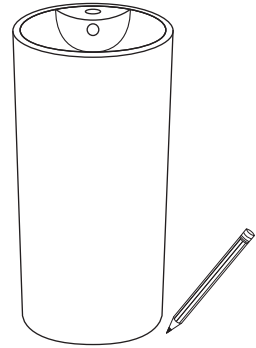

### STEP III. Seal Sink (2 People Required)

- Person 1 - Tilt the sink backward slightly so the pedestal sink partly lifts off ground.
- Person 2 - Apply construction adhesive underneath the sink.
- Lower the sink back to its standing position with care and apply a bead of silicone sealant between the floor and the sink.

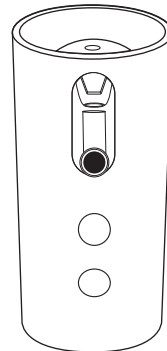

**NOTE** Allow the silicone up to 24 hours to fully dry before using the pedestal sink.

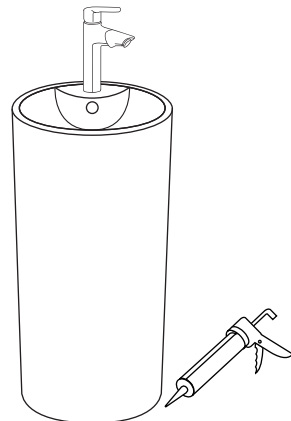
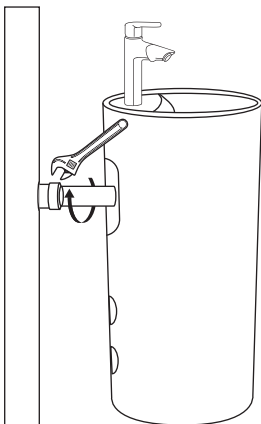

A vitreous china bathroom sink is a popular and durable choice for many homeowners. Eridanus vitreous china bathroom sinks are meticulously handcrafted with fine materials and have undergone strict quality inspections. With proper maintenance and care, Eridanus sinks will keep in new condition and function well for an extended period of time.

### Do's



- ✓ **Cleaning the sink regularly:** Use a mild detergent or cleaning solution and a soft cloth or sponge to wipe down the sink. Avoid using abrasive cleaners or scrubbers as they can scratch the surface of the sink.
- ✓ **Remove stains promptly:** If you notice any stains on the sink, it's important to remove them promptly. Use a cleaning solution specifically designed to remove the type of stain you're dealing with. For example, use a rust remover for rust stains and a hard water stain remover for hard water stains.
- ✓ **Keep the sink dry:** After using the sink, make sure to wipe it dry with a clean towel or cloth. Standing water can cause water spots and mineral buildup, which can be difficult to remove.
- ✓ **Use a drain strainer:** Use a drain strainer to prevent hair, soap, and other debris from clogging the drain. A clogged drain can lead to water damage and other problems.

### Don'ts



- ✗ **Avoid using harsh chemicals:** Harsh chemicals such as bleach, ammonia, or acid-based cleaners can damage the surface of the sink. Avoid using these chemicals and opt for a mild cleaning solution instead.
- ✗ **Avoid placing heavy objects on the sink:** Vitreous china is a durable material, but it can still crack or chip if heavy objects are placed on it. Avoid placing heavy objects on the sink and use a separate surface for storing items such as hair dryers or curling irons.
- ✗ **Avoid hitting it with hard objects or dropping heavy items on it.**
- ✗ **Avoid direct contact with sharp and metallic objects.**



Soft Cloth



Mild Detergent



Plastic Scraper

By following these tips, you can keep your vitreous china bathroom sink in great condition for many years to come. Regular maintenance and care will help to prevent damage and keep the sink looking its best.

# Installation Guide