

Cat Litter Box

User Manual

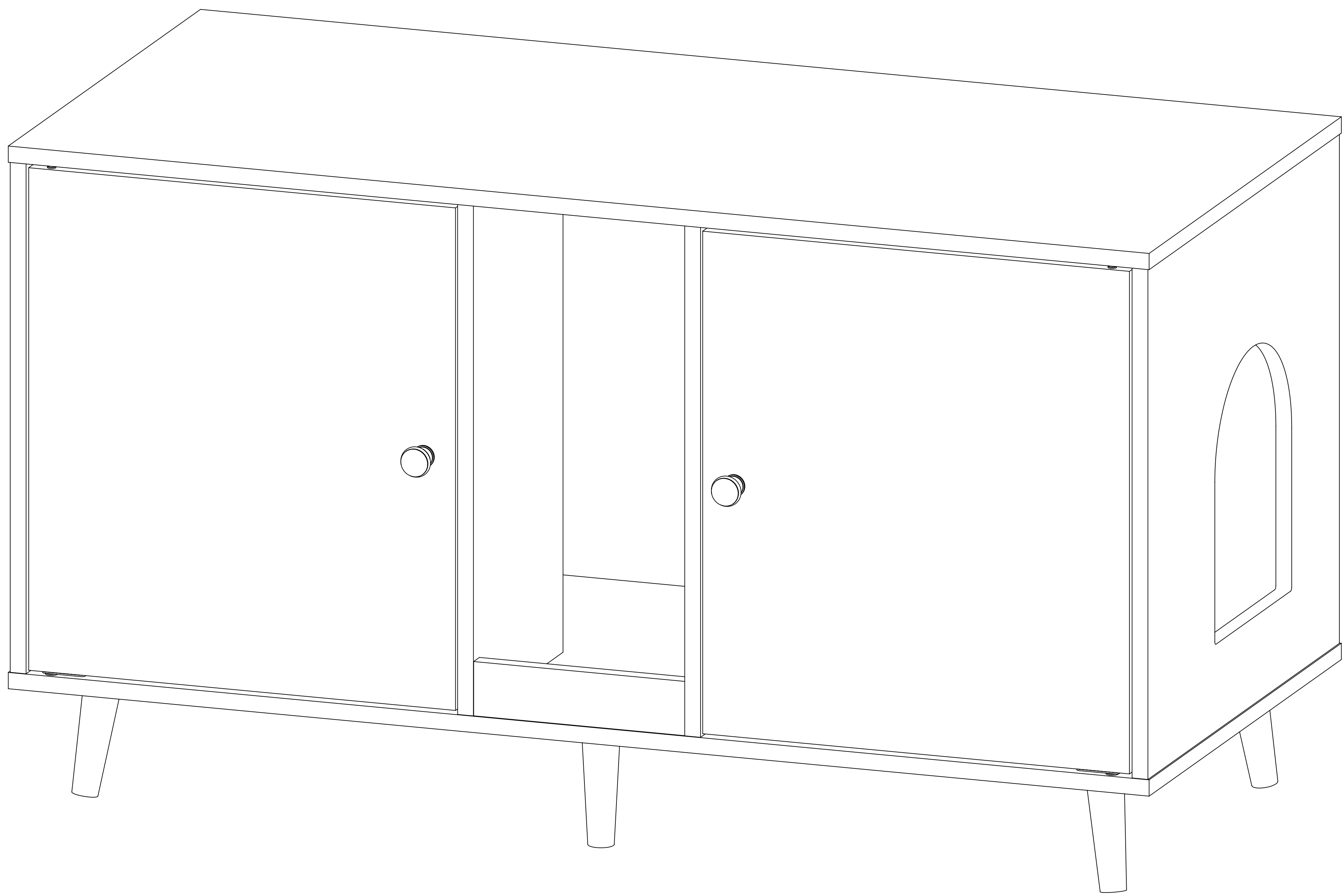

Thank you a lot for ordering Cat Litter Box, we hope this Cat Litter Box will meet your expectation.

GUIDELINE

1. Please read the following instructions carefully and use the product accordingly.
2. Please keep this manual and hand it over when you transfer the product.
3. Please check the original carton and all parts in box before starting to assemble the table.

NOTE

1. The product is intended for indoor use only.
2. Children are not allowed to assemble the product. Please keep any small part out of reach of children as they may be fatal if swallowed or inhaled!
3. Children are not allowed to stand, climb or play on the product to avoid serious bodily injury by the toppling.
4. Keep plastic packing bags out of reach of children to avoid any potential danger, such as suffocation.

MAINTENANCE

1. Use a dry cloth to clean the table.
2. Please avoid long-term exposure to a humid environment to prevent mildew.
3. Avoid sharp objects and corrosive chemicals to prevent damage to the product.
4. The structure of this product can not meet the requirements of kids climbing.

TIPS BEFORE ASSEMBLE THE CAT LITTER BOX

1. Do not use any glue to stick the board pieces.
2. When installing the product, use a soft surface (such as carpet or cardboard) to avoid scratching or damaging the surface of the product.
3. Please try to use a manual screwdriver instead of an electric screwdriver. A manual screwdriver can be used to better control the tightness of the screws.
4. The product is unstable before it is assembled. Please pay attention to the product installation sequence, and align all screws and screw holes before tightening.

ACCESSORIES LIST

Please check parts in box and ensure that you have them all before assemble.

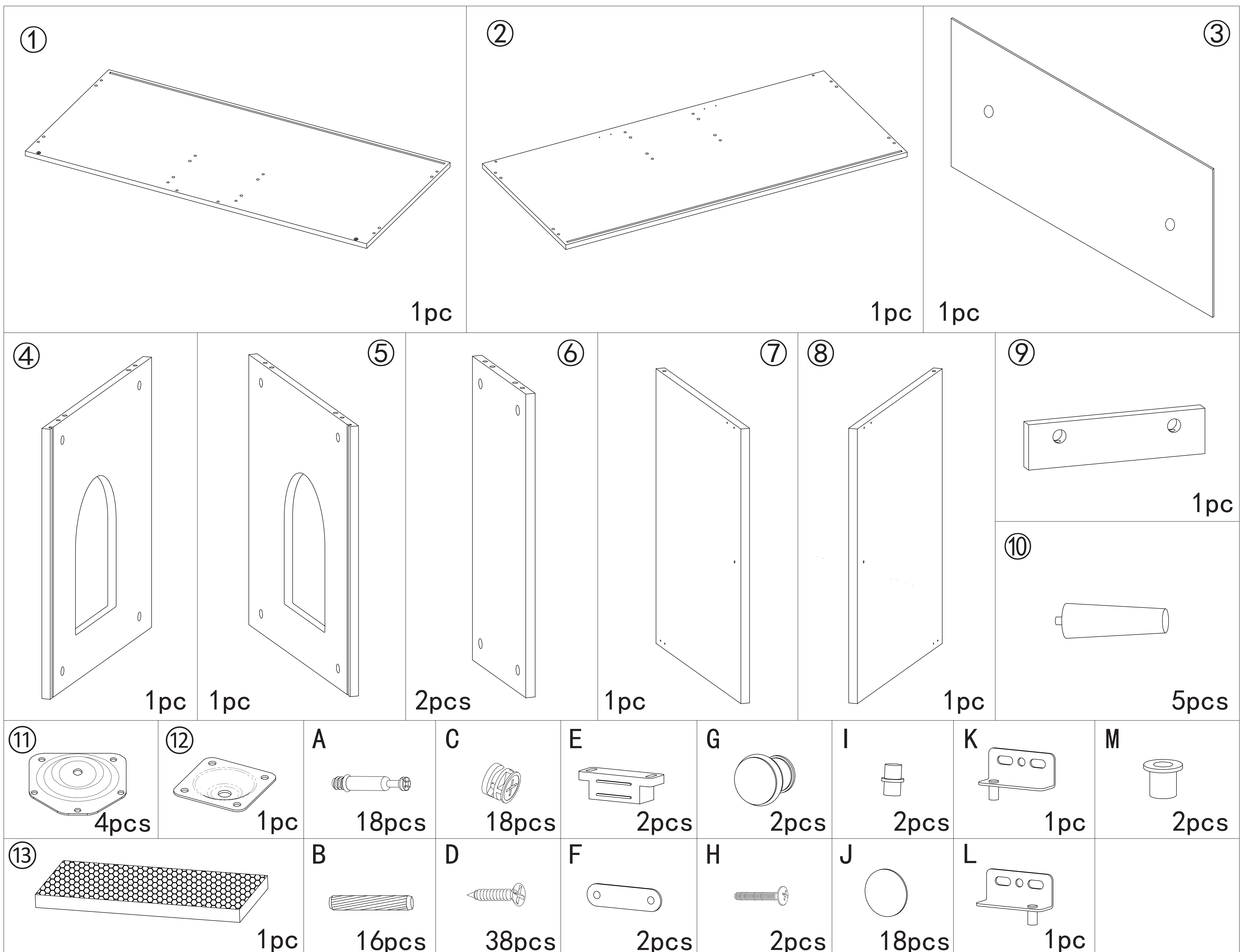

PLEASE USE 3-IN-1 SCREWS CORRECTLY.

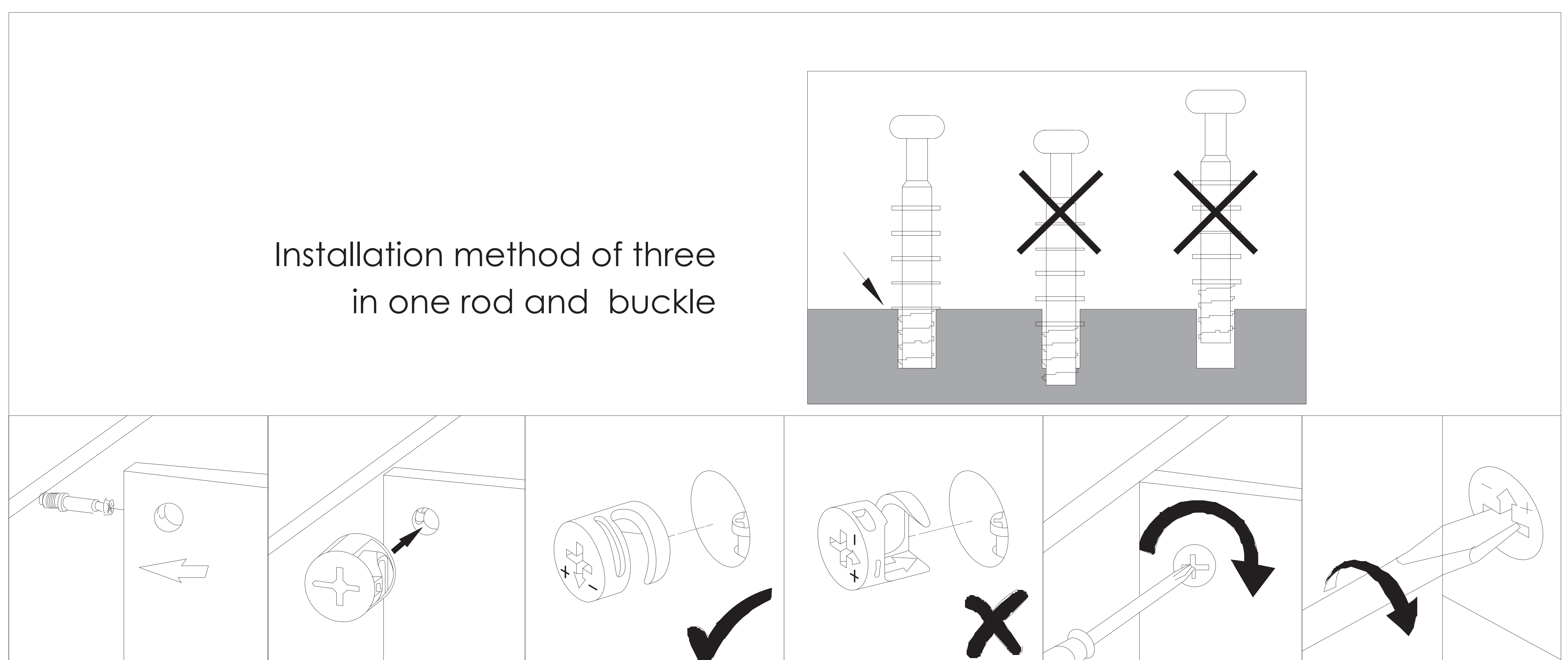

HOW TO ASSEMBLE THE CAT LITTER BOX (Scan QR code on page 8 to watch video of installation.)

PS: You will need a screwdriver tool. There are many small pieces and please read every single diagram carefully, use the right parts and follow the steps to install.

1

You will need

D	x25	(11)	x4	(12)	x1
---	-----	------	----	------	----

2

You will need

(10)	x5		
------	----	--	--

3

You will need

A	x10	B	x10
---	-----	---	-----

4

You will need

C	x6	J	x6
---	----	---	----

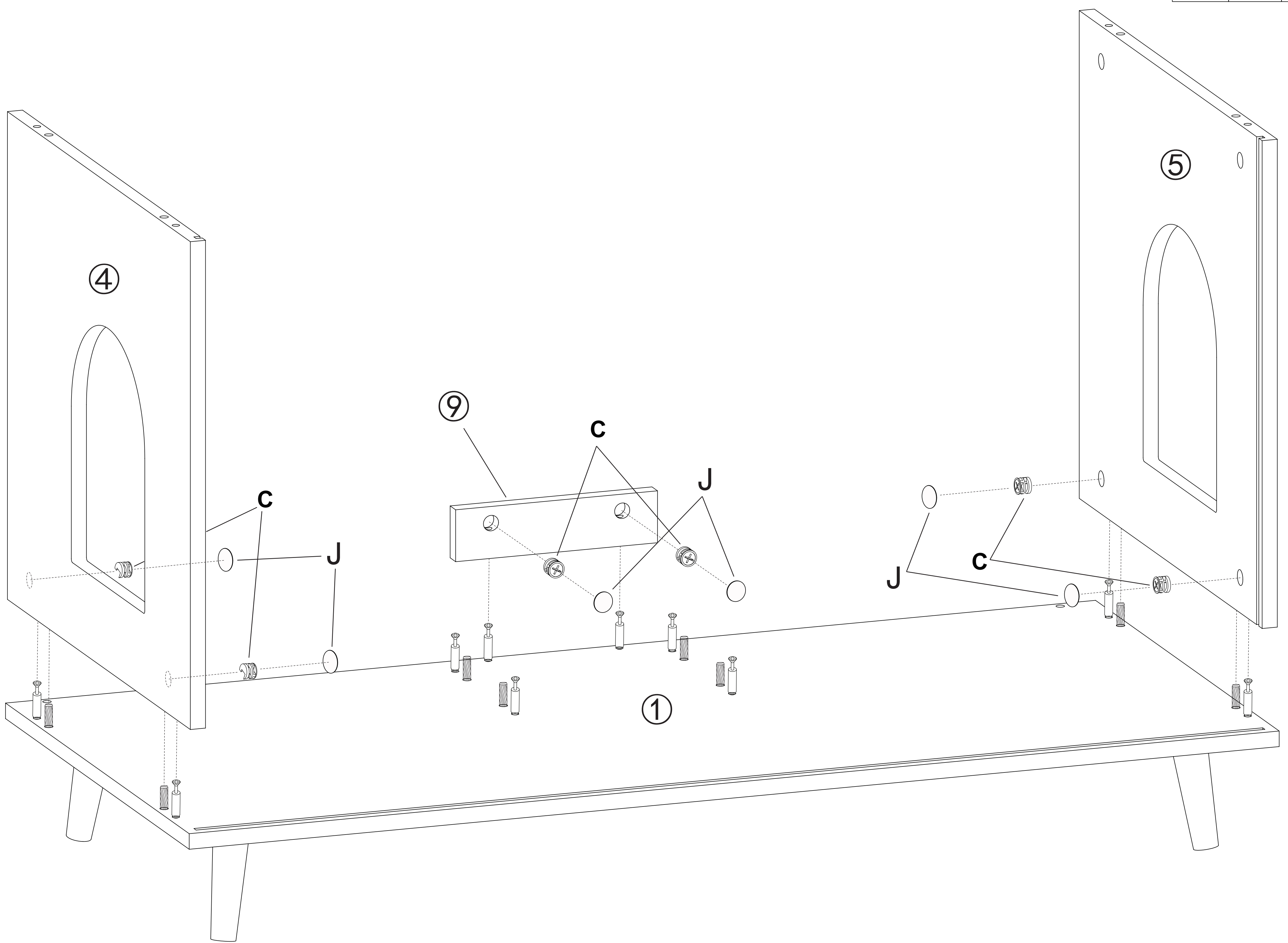

5

You will need

C	x4	J	x4
---	----	---	----

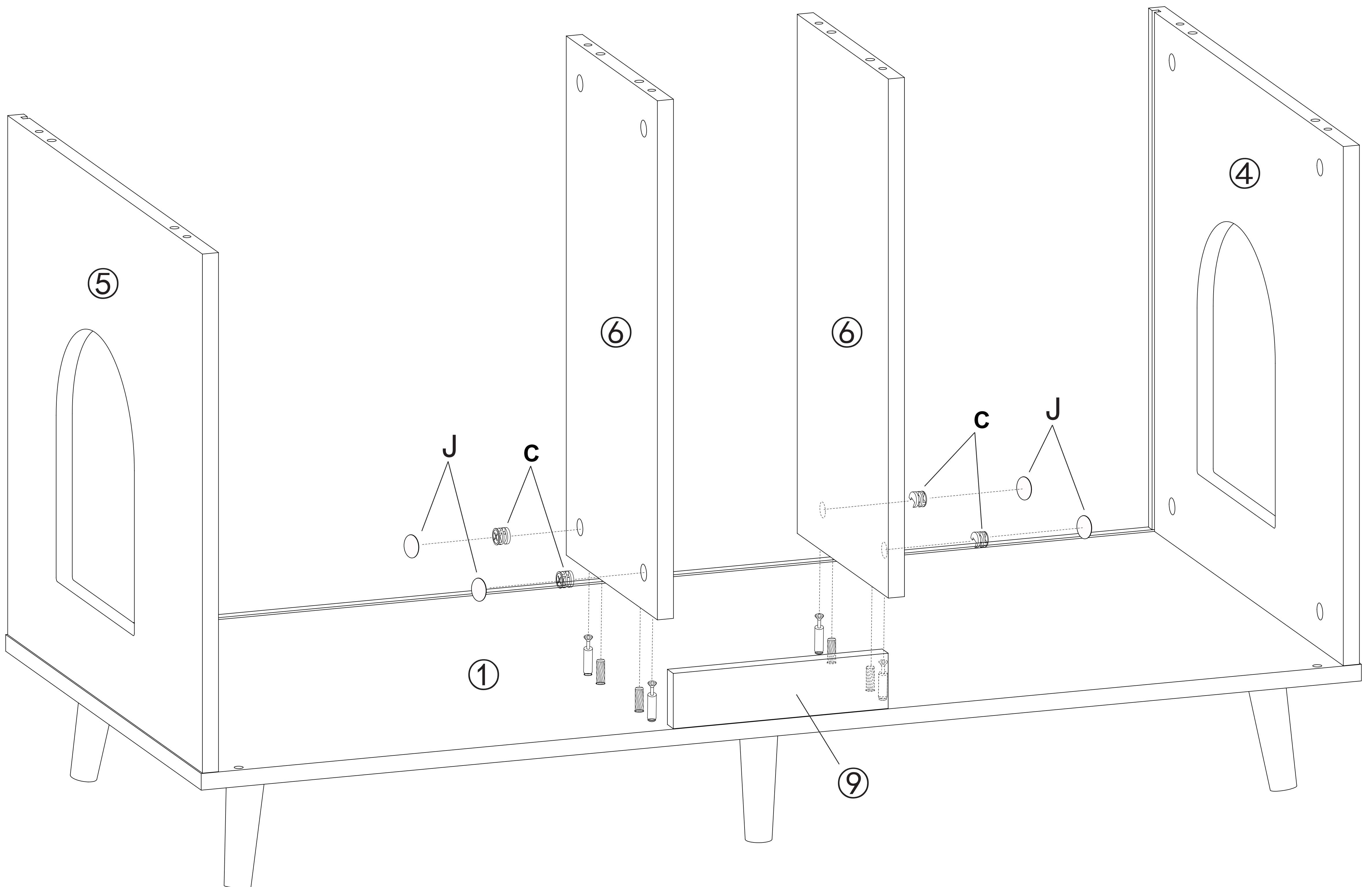

6

You will need

③	x1		
---	----	--	--

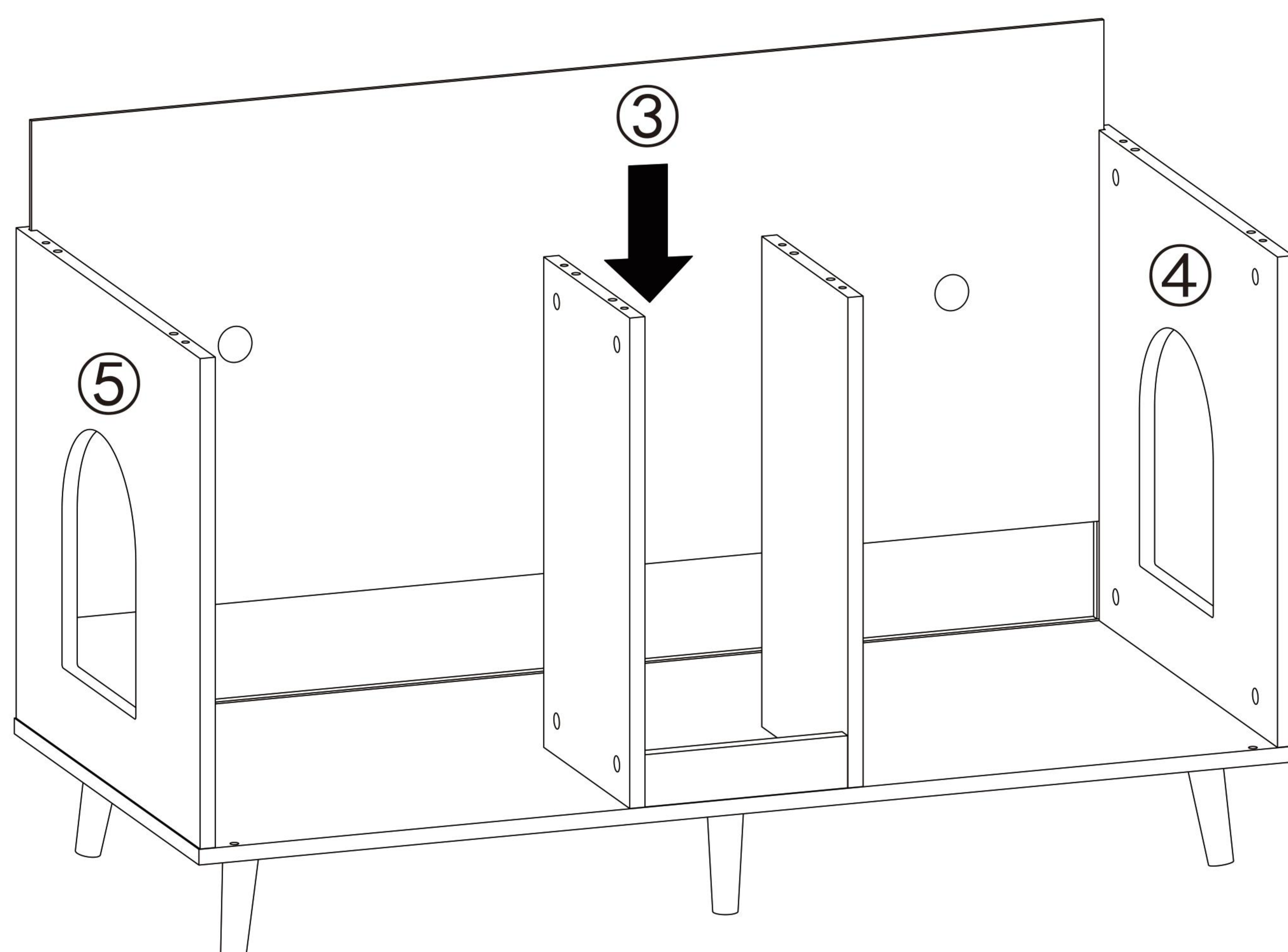

7

You will need

A	x8	B	x8	D	x4	E	x2
---	----	---	----	---	----	---	----

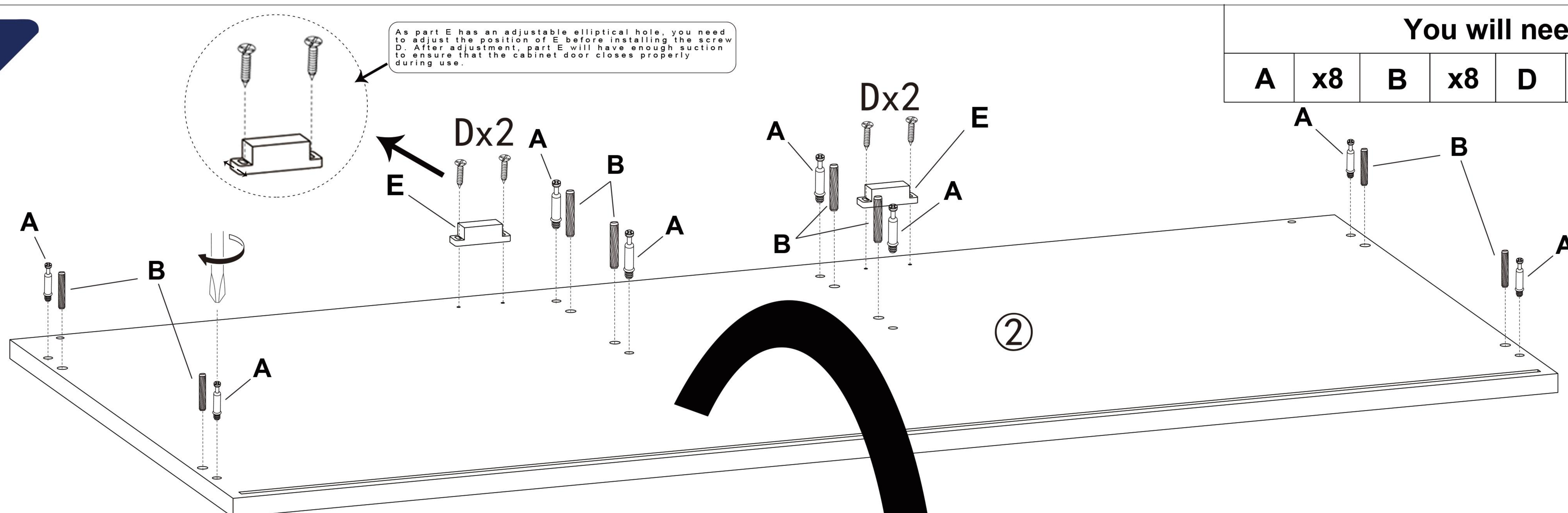

8

You will need

C	x8	J	x8
---	----	---	----

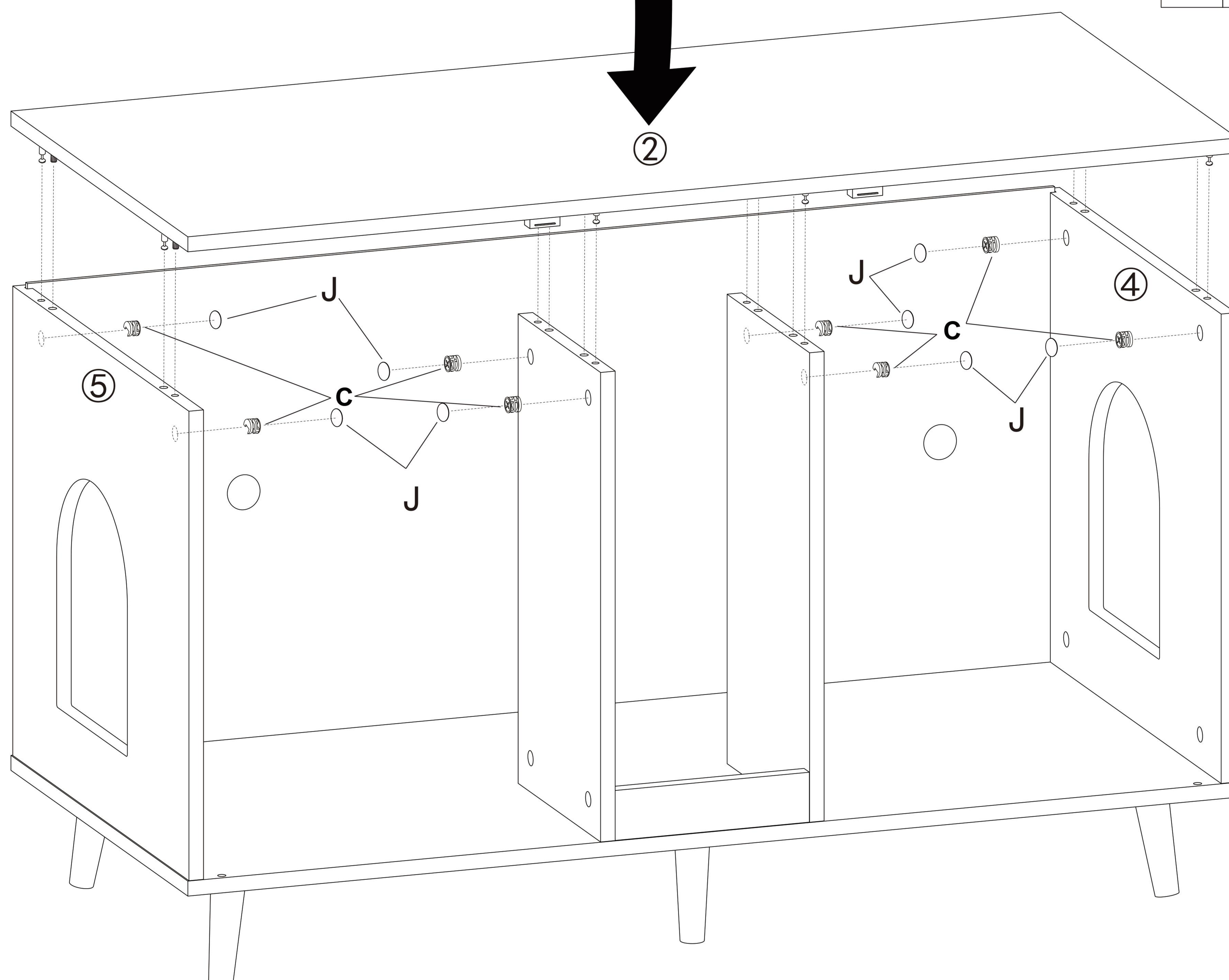

You will need

D	x4	F	x2	G	x2	H	x2
---	----	---	----	---	----	---	----

9

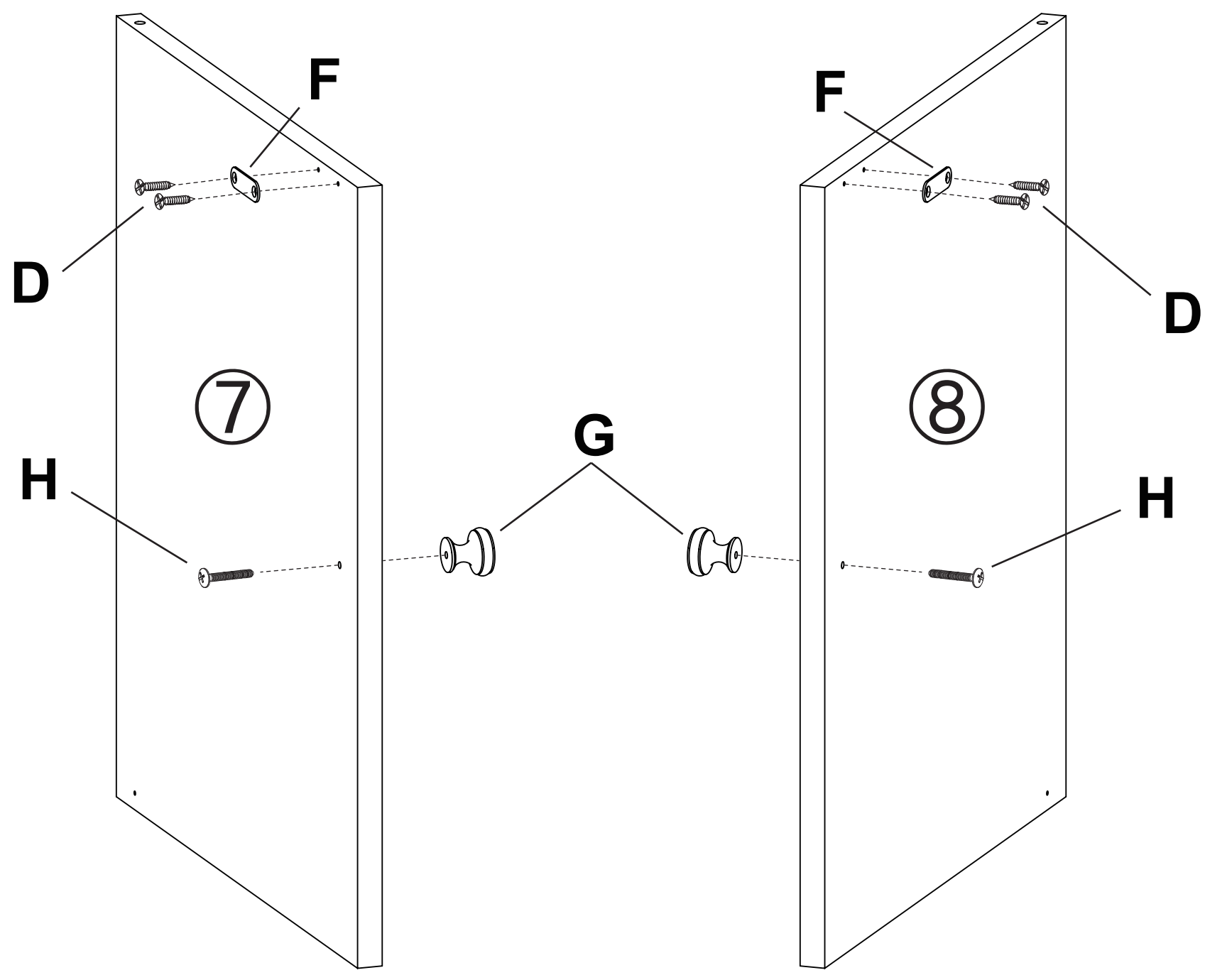

10

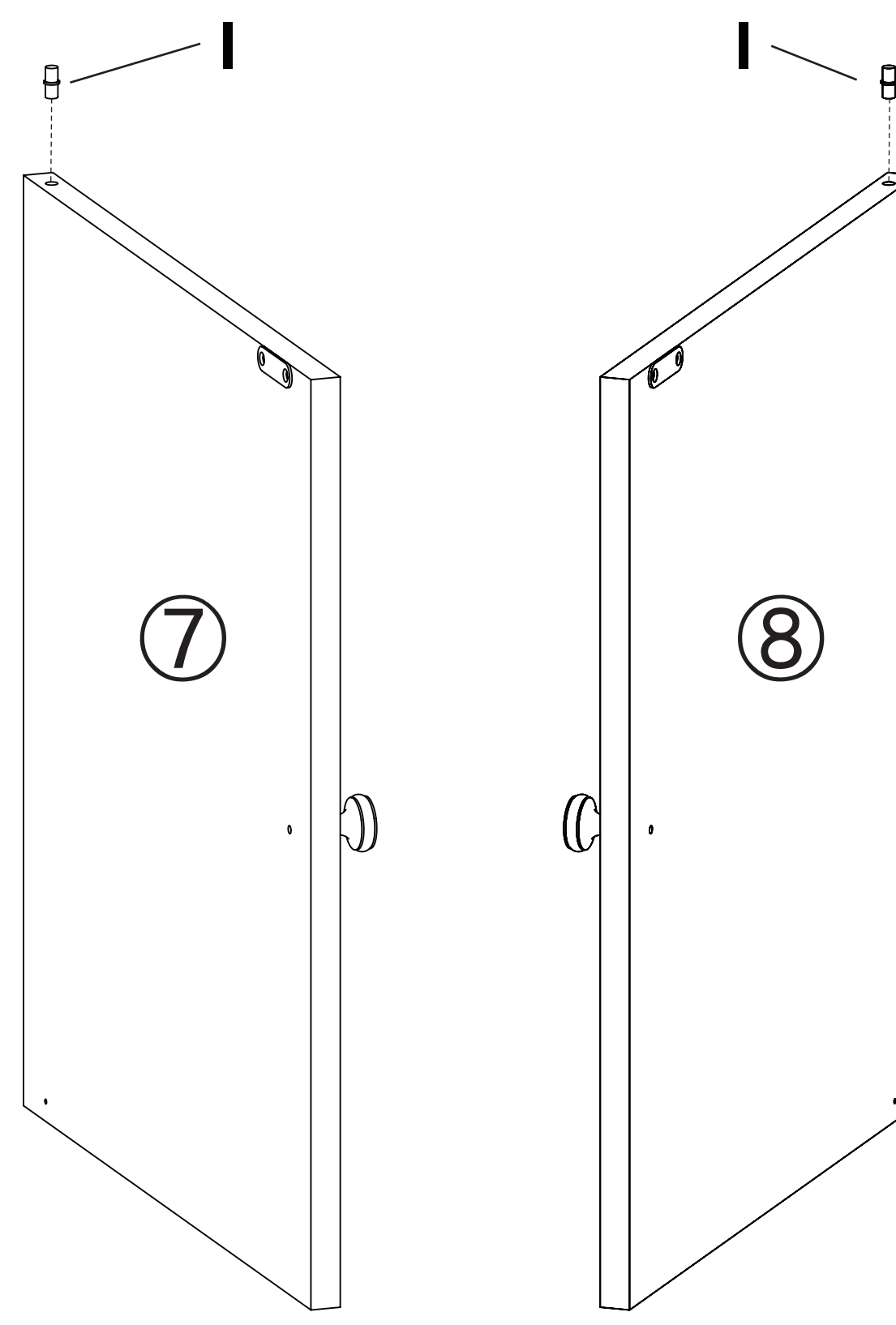

You will need

I	x2		
---	----	--	--

11

You will need

K	x1	L	x1	M	x2
---	----	---	----	---	----

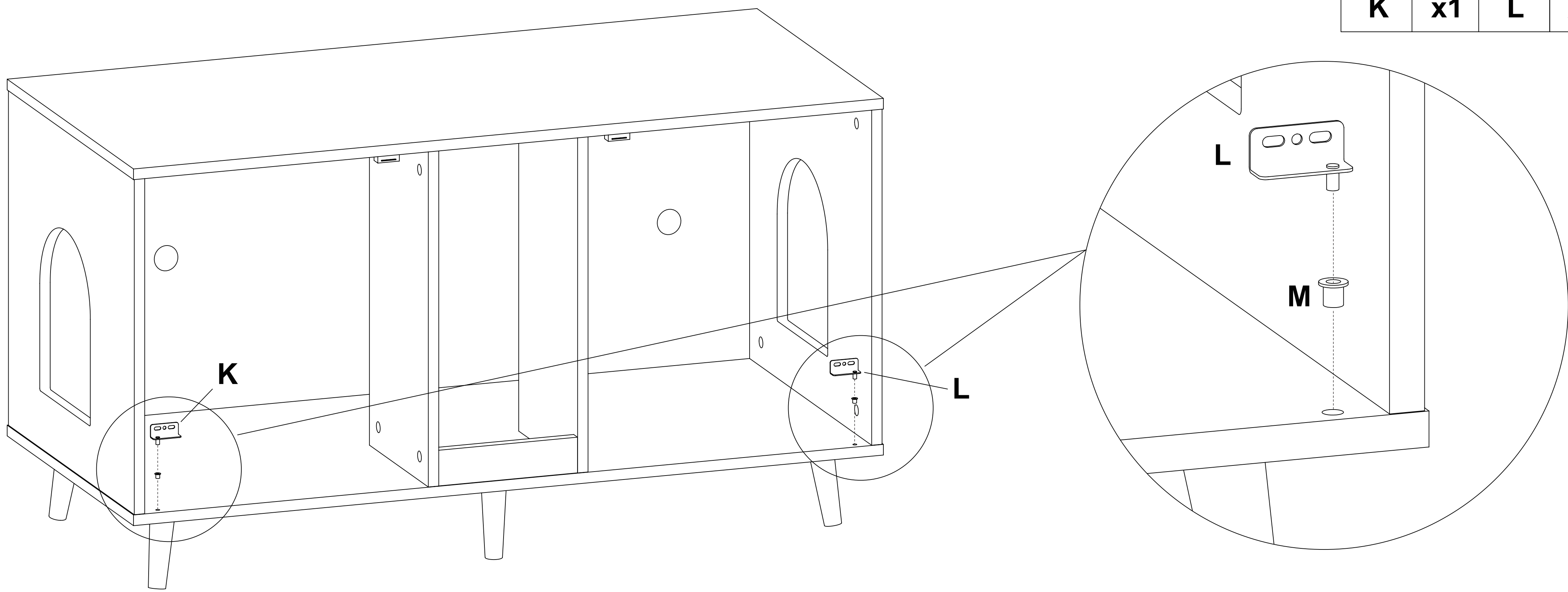

12

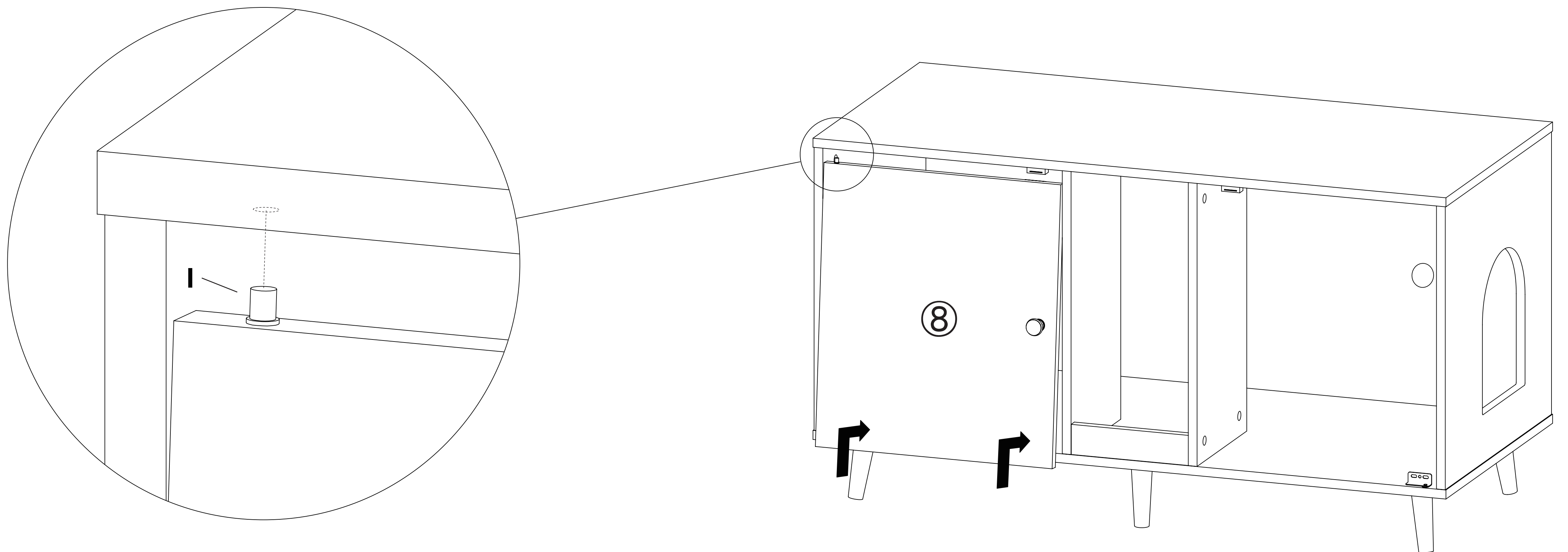

13

You will need

D	x2		
---	----	--	--

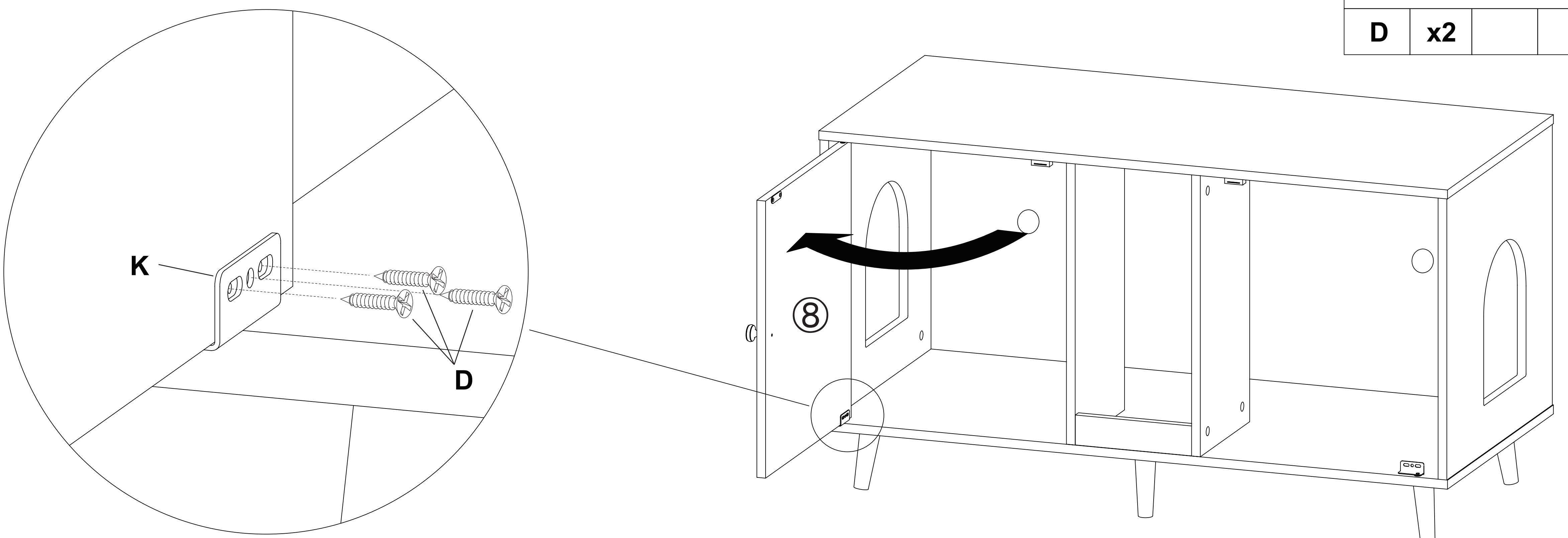

14

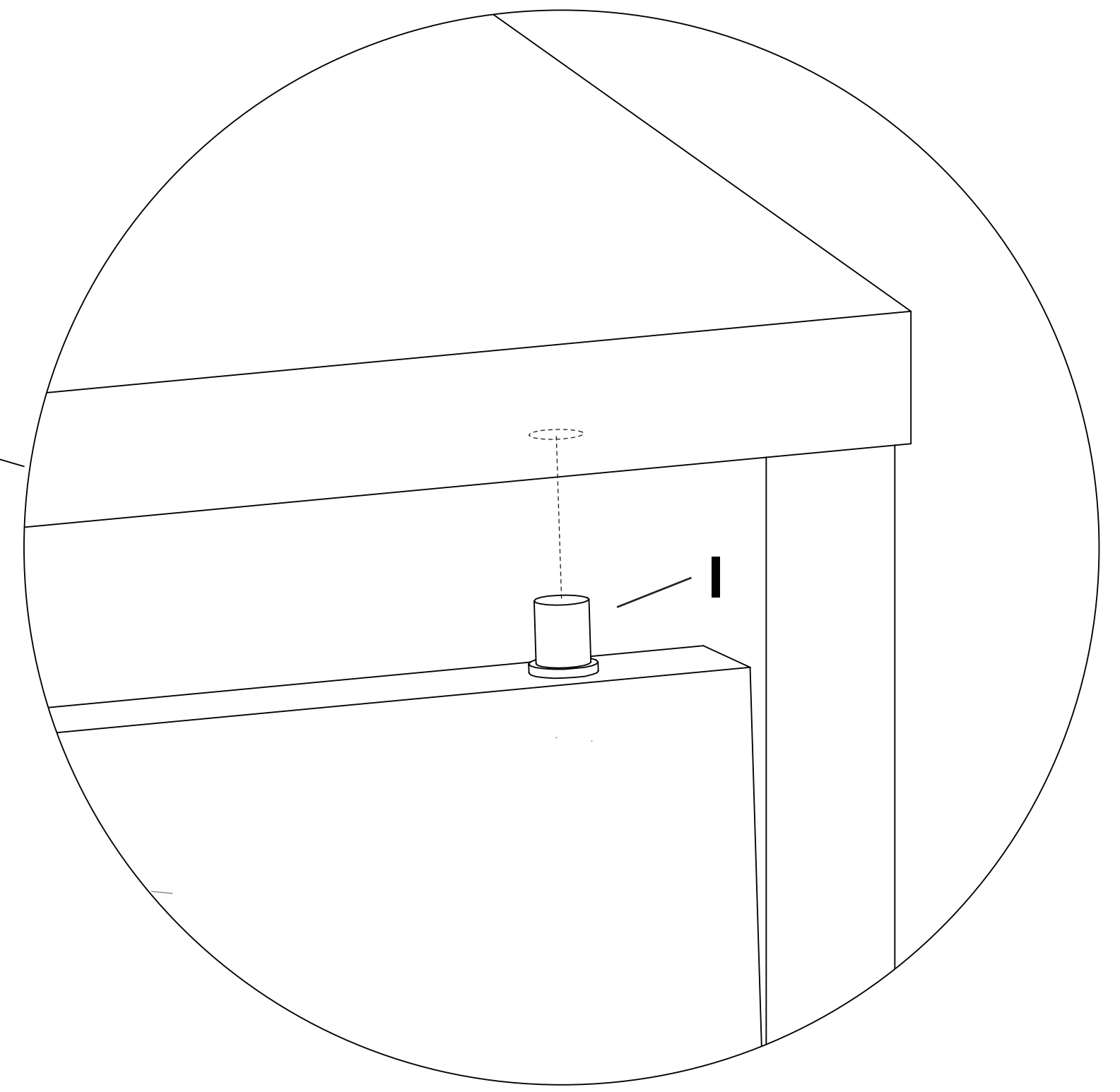
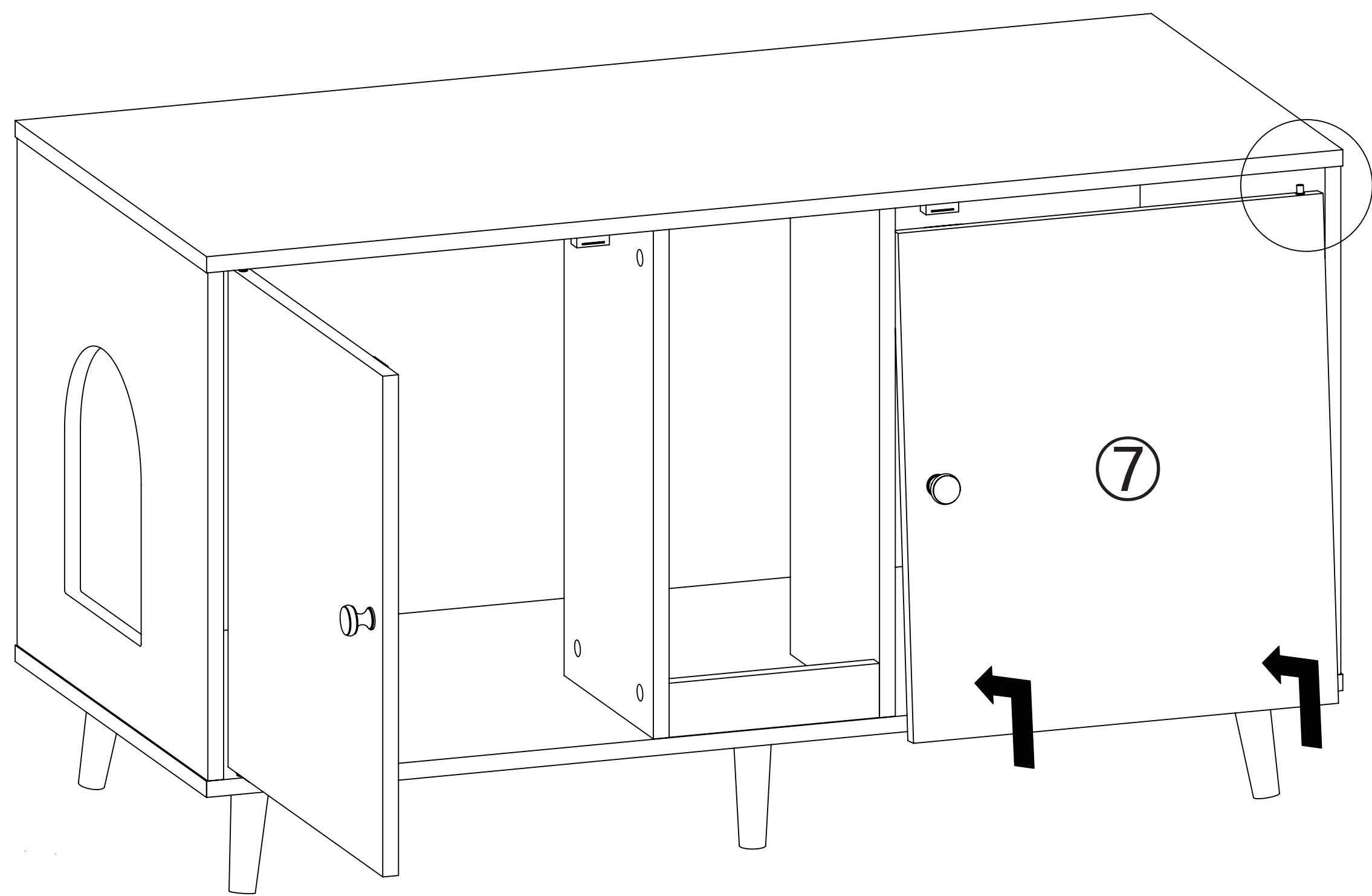

15

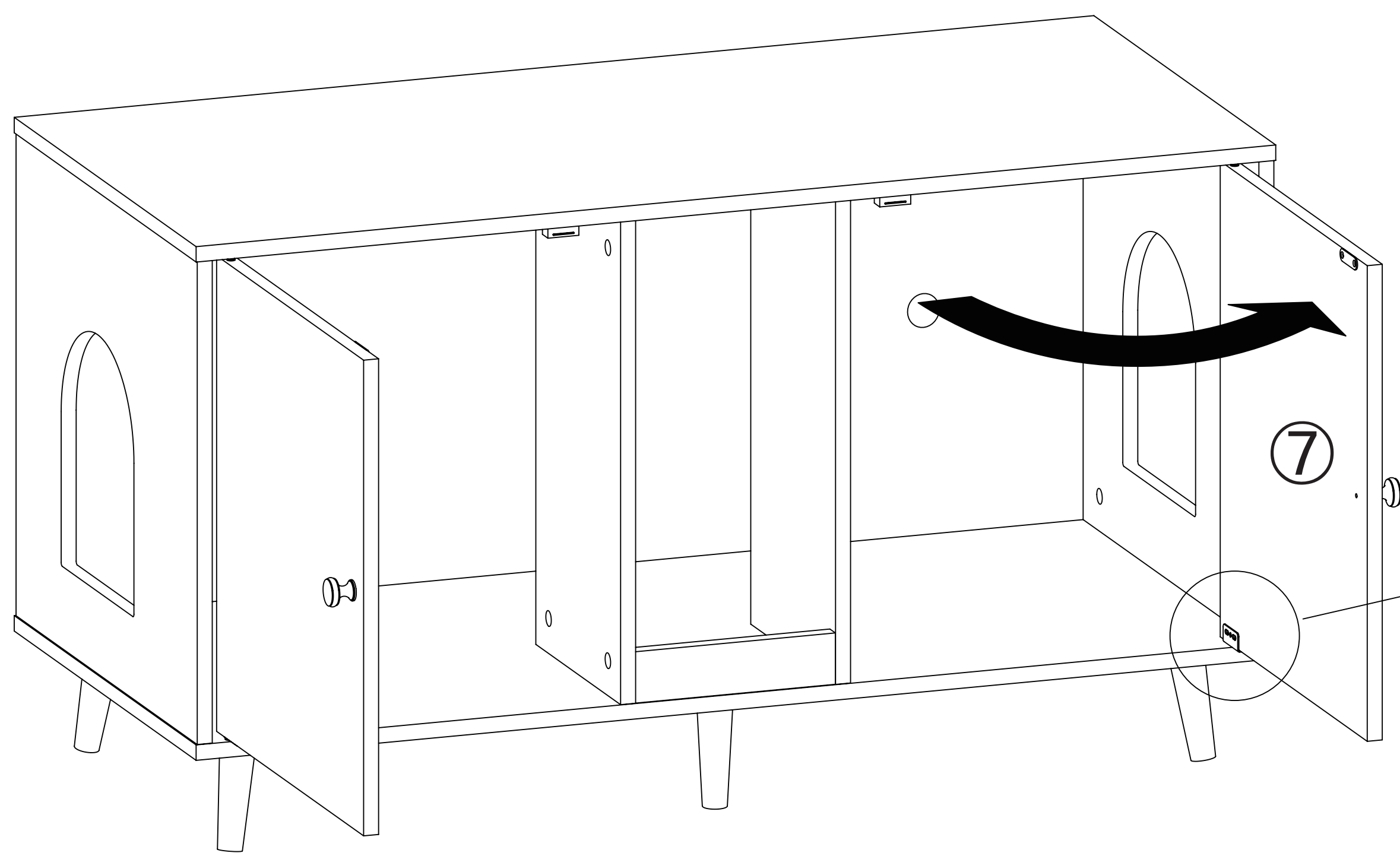

You will need

D	x2		
---	----	--	--

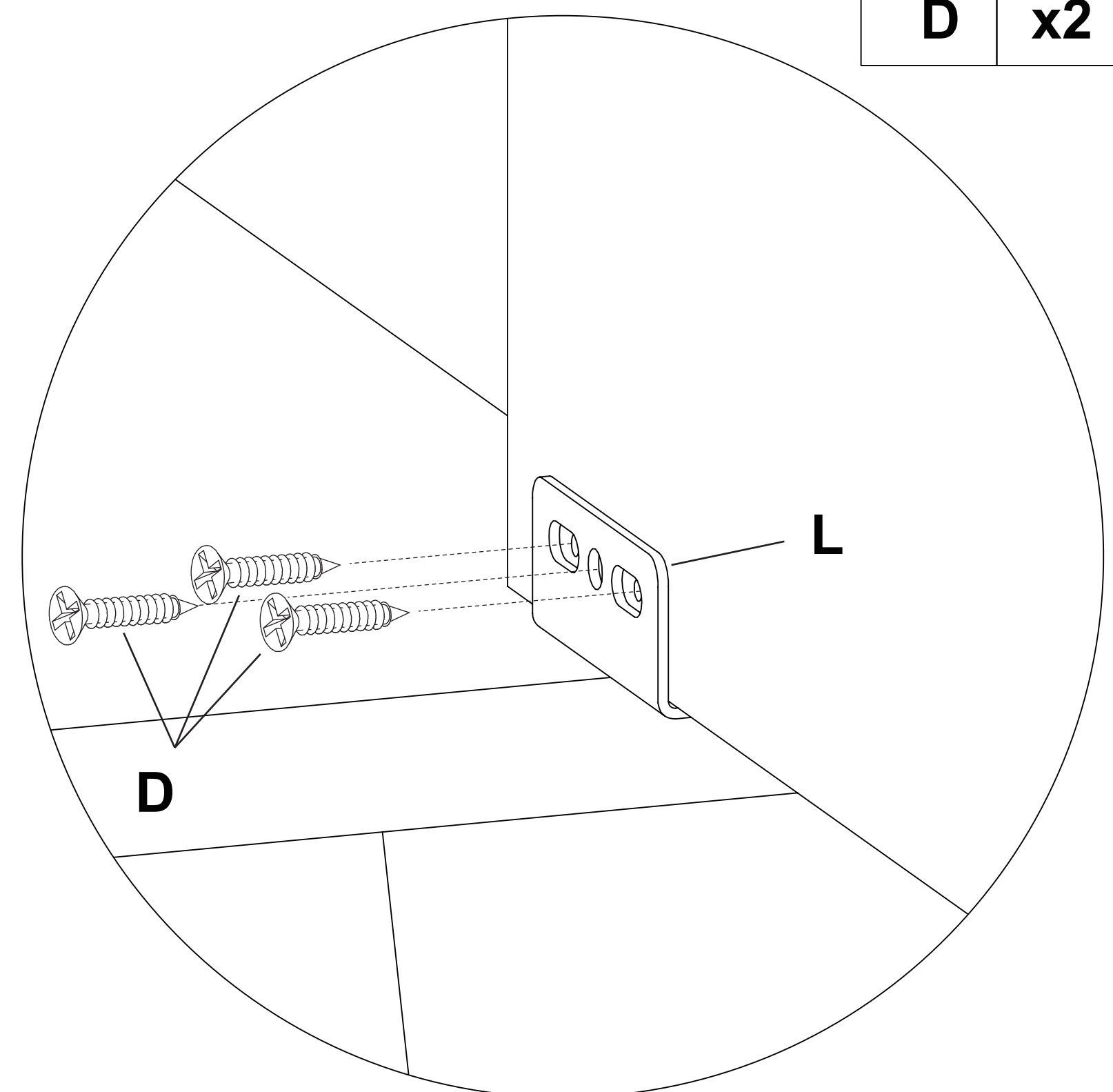

16

INSTALLATION COMPLETED

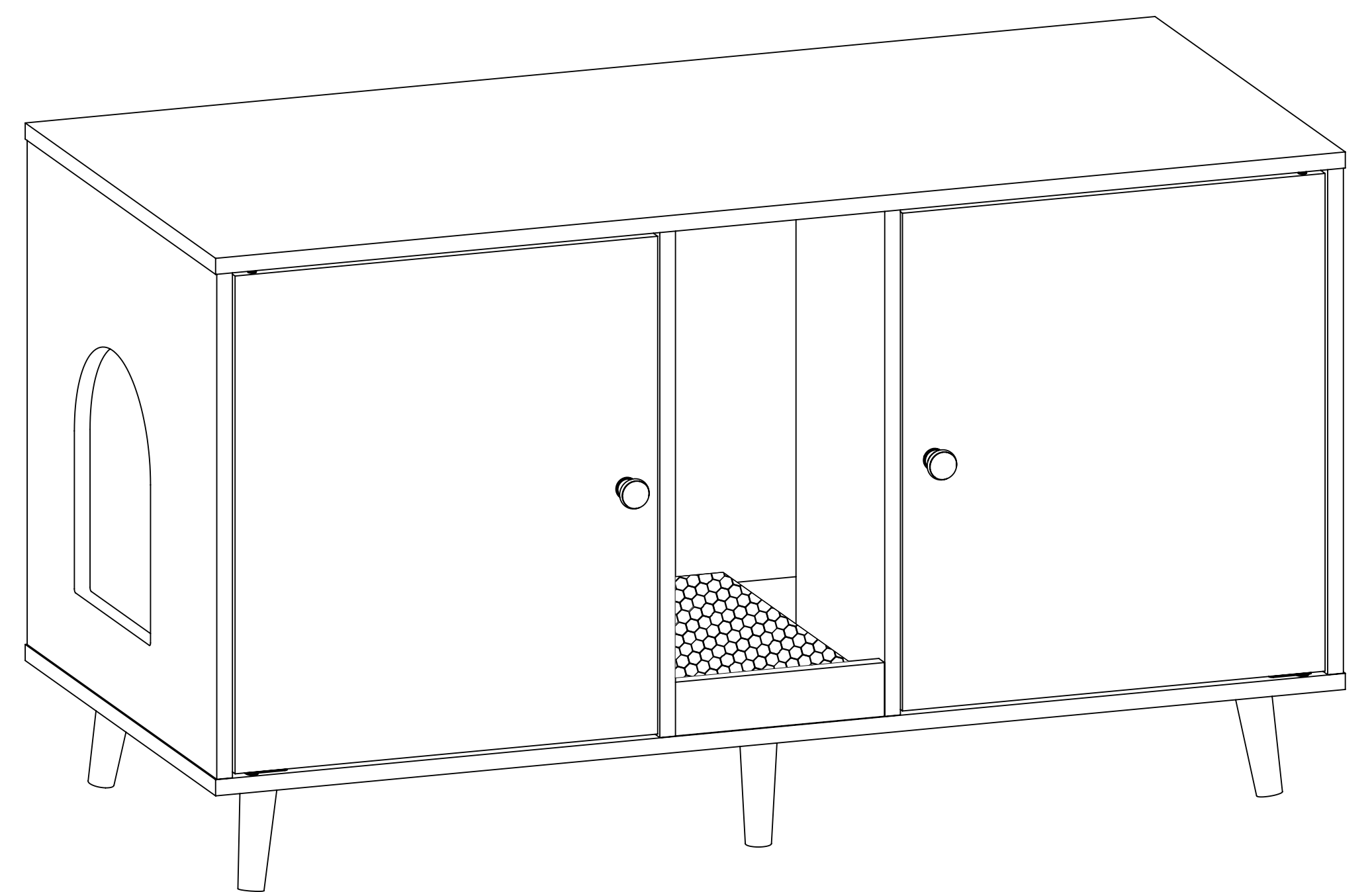
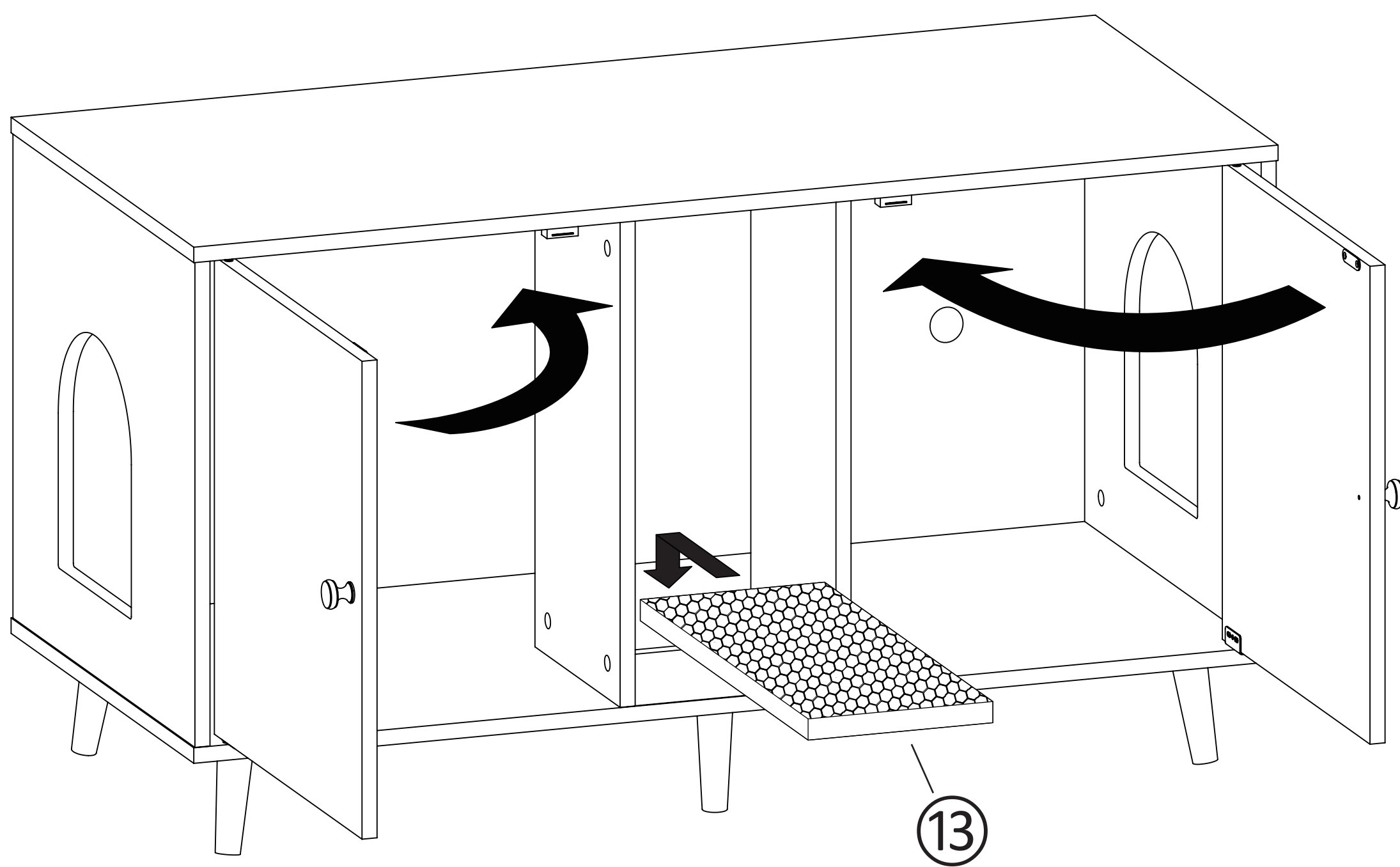

SPECIFICATION

Size of Cat Litter Box	108*50*60.5 cm; 42.5*19.5*23.8 in
Box size	121*58.5*14 cm; 47.6*23*5.5 in
Carton Weight	26 kg/57.3 lb
Capacity	45 kg/100 lb
Material	MDF board, steel, metal