



bene casa

Guaranteeing Product Performance Since 1970
Commitment to a Higher Standard
Designed in the USA / Made in China

Designed to inspire



Connect with us @ClubBeneCasa
www.ClubBeneCasa.com

FOR HOUSEHOLD USE ONLY
SOLAMENTE PARA USO DOMESTICO



Model: BC-47165
Modelo: BC-47165



1800W



3.15 lb
1.43 Kg

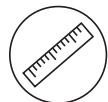

in: 18.11 L x 9.45 W x 3.15 H
cm: 46 L x 24 W x 8 H



Recyclable
Carton



DOUBLE BURNER USER MANUAL



BC-47165

IMPORTANT SAFEGUARDS

When using electrical appliances, basic safety precautions should always be followed to prevent the risk of fire, electric shock, burns, or other injuries or damages:

- Read all instructions.
- Do not touch hot surfaces.
- To protect against electrical shock, do not place this unit in water or other liquid. See instructions for cleaning.
- Close supervision is necessary when any appliance is used by or near children.
- Do not use appliance unattended.
- Unplug from outlet when not in use and before cleaning. Turn control to "0" or "OFF" before unplugging. Allow to cool before cleaning the appliance.
- Do not operate any appliance with a damaged cord or plug or after the appliance malfunctions, or has been damaged in any manner. Return appliance to the nearest authorized service facility for examination, repair or adjustment.
- To reduce the risk of injury, use accessory attachments only if recommended by the appliance manufacture.
- Do not use outdoors or while standing in a damp area.
- Do not let cord hang over edge of table or counter, or touch hot surfaces.
- Do not place on or near a hot gas or electric burner, or in a heated oven,
- Extreme caution must be used when moving any pot or pan containing hot oil or liquids from this appliance.
- Always attach plug to appliance first, then plug cord into the wall outlet. To disconnect, turn any control to "0" or "OFF", then remove plug from wall outlet.
- Do not use appliance except as intended.

ADDITIONAL SAFEGUARDS

- Clean the appliance regularly as a build-up of grease poses a fire hazard.
- Never cook food directly on the burners. Always use proper cookware.
- Do not attempt to cut food in cookware while on the heated burners.
- Do not clean with metal scouring pads. Pieces can break off and touch electrical parts creating a risk of electrical shock.
- When in use, keep unit a minimum of 10-12 inches away from walls. Place on a stable, heat-resistant surface and in a well-ventilated area. Place the appliance on a dry and horizontal surface.
- For long-life performance, avoid dropping anything on the burners.

- Always pull the plug out from the wall outlet. Never pull the cord.
- Electric Power: If the electric circuit is overloaded with other appliances, this appliance may not operate properly. The appliance should be operated on a separate electrical circuit from other operating appliances.

SHORT CORD INSTRUCTIONS

1. A short power-supply cord is provided to reduce the risks resulting from becoming entangled in or tripping over a longer cord.
2. Longer extension cords are available and may be used if care is exercised in their use.
3. If a longer extension cord is used:
 - a. The marked electrical rating of the extension cord should be at least as great as the electrical rating of the appliance.
 - b. The longer cord should be arranged so that it will not drape over the counter top or tabletop where it can be pulled by children or tripped over unintentionally.

POLARIZED PLUGS

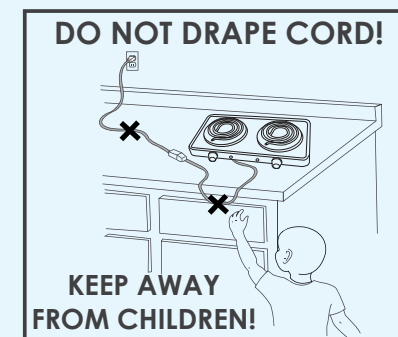
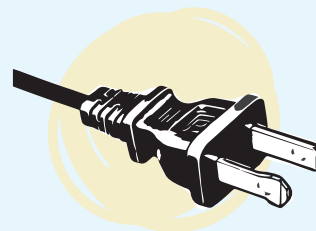

This appliance has a polarized plug (one blade is wider than the other). As a safety feature to reduce the risk of electrical shock, this plug is intended to fit in a polarized outlet only one way. If the plug does not fit fully in the outlet, reverse the plug. If it still does not fit, contact a qualified electrician. Do not attempt to reverse this safety feature or modify the plug in any way. If the plug fits loosely into the AC outlet or if the AC outlet feels warm do not use that outlet.

PARTS IDENTIFICATION

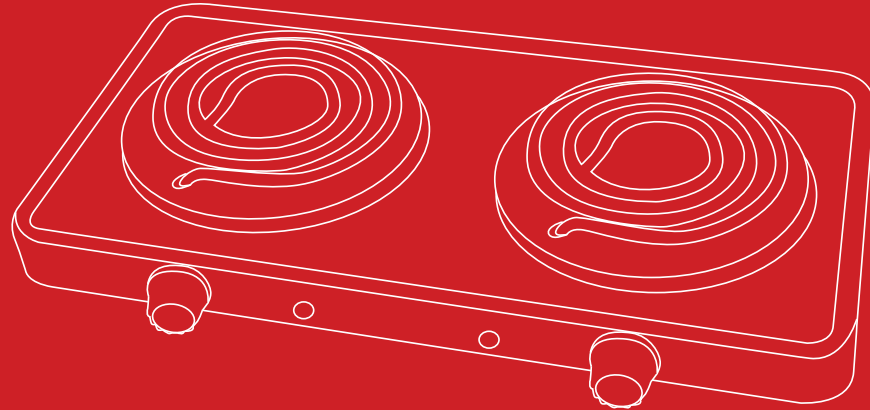

TABLE of CONTENTS

- Important safeguards..... 02
- Power cord instructions 03
- Parts diagram..... 05
- Before first use..... 05
- Operating instructions..... 06

BEFORE FIRST USE

- Read all instructions and important safeguards.
- Remove all packaging materials, labels and/or stickers. Make sure items are received in good condition.
- Throw away all plastic bags as they can pose a risk to children.
- Place the double burner on a flat, sturdy, heat resistant counter, or tabletop for use.
- Wipe burners clean with a damp cloth.
- Set temperature control knobs to OFF position.
- Plug into wall outlet.
- Before your first use, turn the temperature controls to high for 3 to 5 minutes to warm up the unit. Do not place any pots and pans on it yet. This step only needs to be done the first time you use the product.
NOTE: Due to the manufacturing process, the double burner may emit a slight burning odor when it is first activated. Use the double burner in a well-ventilated area.
- Do not use abrasive cleaners or scouring pads.
- Do not immerse any part of this appliance or power cord in water or other liquid.

SUITABLE COOKWARE

- For the most efficient operation of the range, the pots and pans used must be in good shape with a solid base.
- To ensure safety and maximum heat efficiency, use only pots and pans with flat bases. See figure below.
- Stainless steel, nonstick and heat-proof ceramic cookware are suitable to use on the electric burners.
- Please read instructions on all cookware to ensure they can be used on a cooktop.
- The diameter of the bottom of pots and pans should be 6 ½" to 7 ½" and with a maximum cooking capacity of 1 ½ quarts for each hot plate.
- **CAUTION:** Do not use any cookware that does not have a completely flat bottom.

OPERATING INSTRUCTIONS

- Before plugging in your new burner, check to see that the electric circuit is not overloaded with other appliance. This unit should always be operated on a separate 120 volt, AC outlet.
- Be certain that your unit is resting level on the countertop. Avoid using pans that are unstable and easily tipped. Place pan on heating element. Turn the knob to one of the desired settings from 0 to 5 positions. Depending on the model you have purchased, some will be equipped with a pilot light, which will glow indicating the heating element is energized and heating will begin immediately. The metal surfaces will become hot. Do not touch while in use.
- When cooking is finished, turn the power switch back to the "OFF" position. If the burner is not to be in use for a long period of time, it is recommended to unplug unit from the outlet. This helps to prevent accidental burns.

STORAGE

- Store the burners in a cool, dry place.
- To protect the heating elements, do not stack any items on burners when stored.

CLEANING INSTRUCTIONS

Reasonable care will insure many years of service from your unit. Avoid dropping items on the heating elements.

1. Always unplug unit from electrical outlet and allow it to cool before cleaning.
2. NEVER IMMERSE IN WATER.
3. DO NOT ATTEMPT TO REMOVE THE HEATING ELEMENT.
4. Use damp soapy cloth or sponge to clean surface of burner, chrome burner ring, drip pan and base. NEVER USE HARSH ABRASIVES OR STEEL WOOL PADS ON ANY PART OF UNIT.
5. Thoroughly wipe soap from heating element.
6. Any servicing other than cleaning should be performed by an authorized service center