

# Electric Standing Desk Instruction Manual

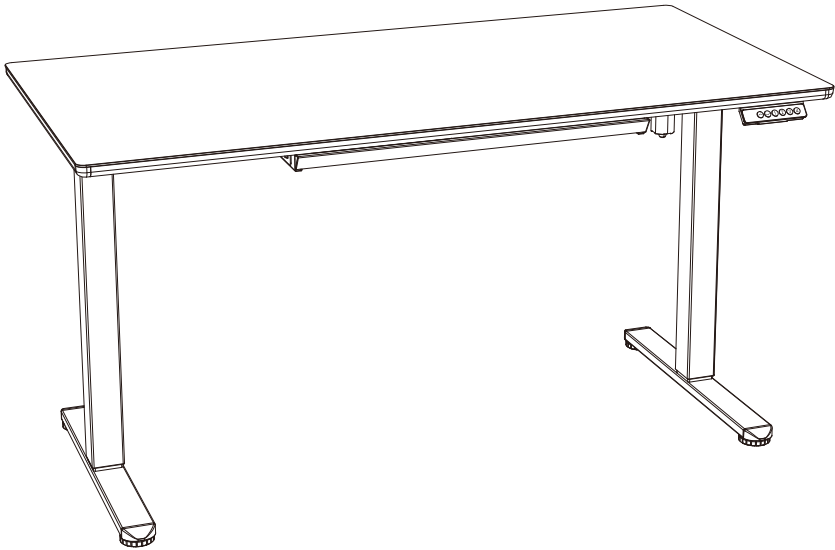

Thank you for choosing this product! We strive to provide you with the best quality products and service in the industry. Should you have any issues, please don't hesitate to contact us.

# Specifications



Height Adjustment Range  
28.3"—46.5" (72–118cm)



Power Input  
100V–240V



Max. Speed  
20mm/s



Operating Noise  
<55dB

Max. Load

110 lbs / 50kg (Desktop + Other Items)



≈



x 8

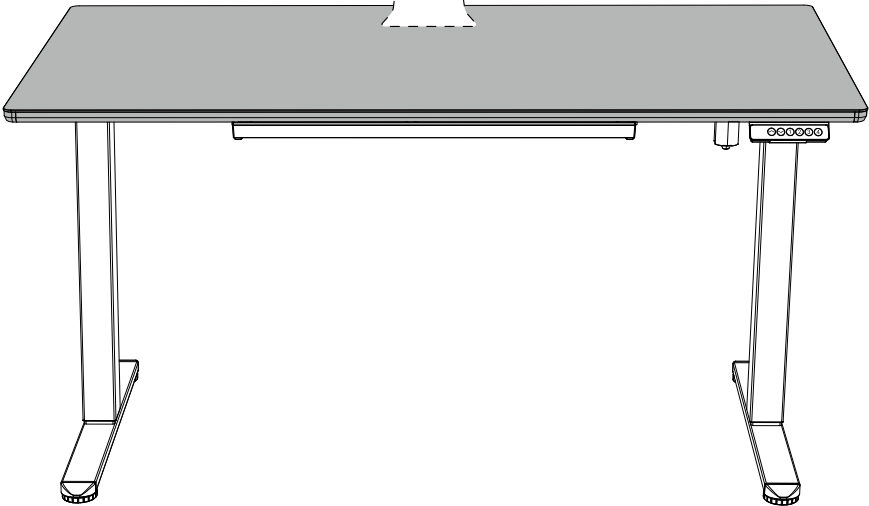

# Supplied Parts and Hardware for Step 1



Bolt  
M6 × 8mm

**A** x 8



Bolt  
M6 × 35mm

**B** x 8



Large Allen Wrench  
3/16" (5mm)

**F** x 1



Crossbar

**01** x 1



Left Desk Leg

**02** x 1



Right Desk Leg

**03** x 1

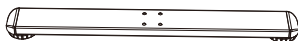

Leg Base

**04** x 2



Side Plate

**05** x 2

# Supplied Parts and Hardware for Step 2



Small Allen Wrench  
5/64" (2mm)

**E** x 1



Transmission Rod

**06** x 1

## Supplied Parts and Hardware for Step 3



Bolt  
M5 × 12mm

**C** x 16



Bolt  
M4 × 10mm

**D** x 2

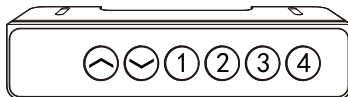

Controller

**07** x 1



Desktop  
With Pre-Drilled Holes

**08** x 1

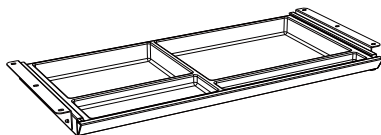

Drawer

**09** x 1

## Supplied Parts and Hardware for Step 4

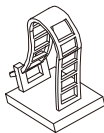

Cable Clip

**G** x 2



AC Adapter

**10** x 1

## Step 1 Assembling the Frame

Attach the crossbar to the desk legs.

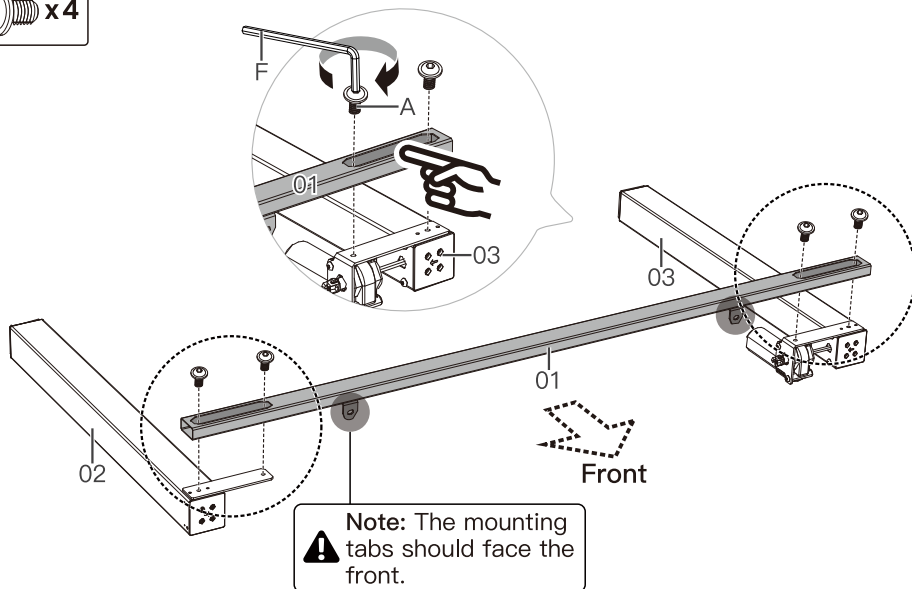
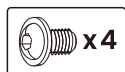

Attach the leg bases.

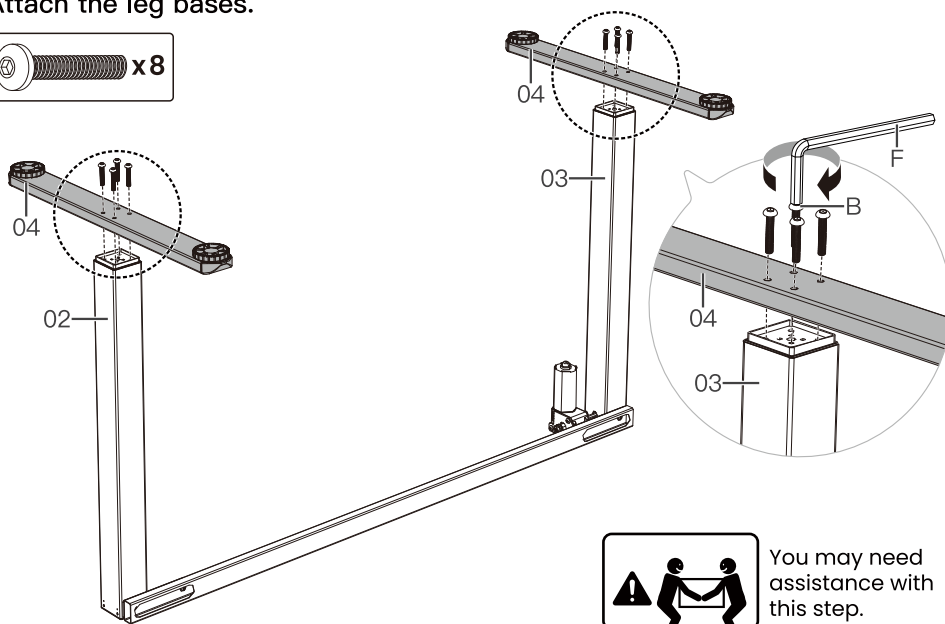
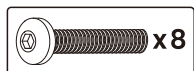

Attach the side plates.

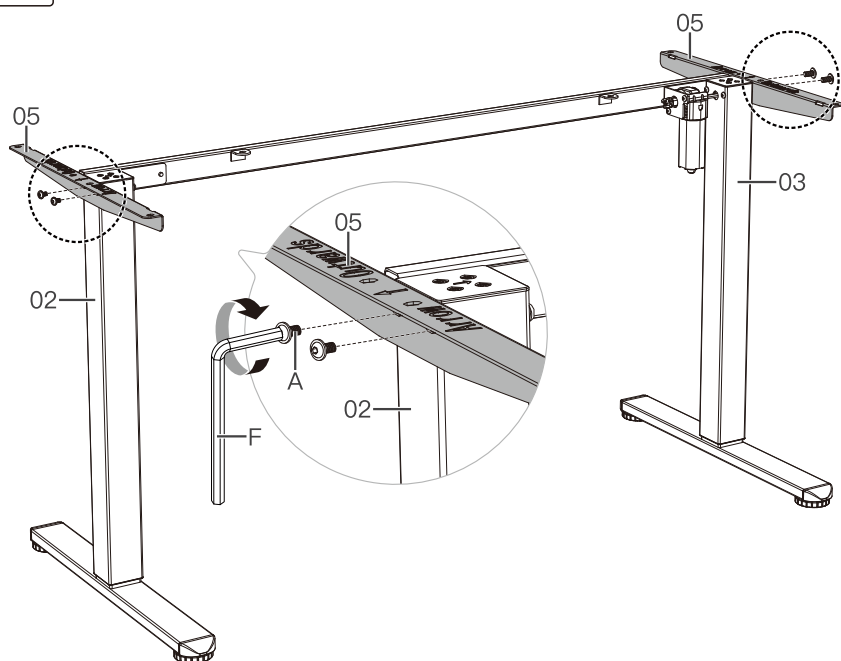
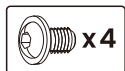

## Step 2 Attaching the Transmission Rod

Loosen the coupling nut to adjust the rod length

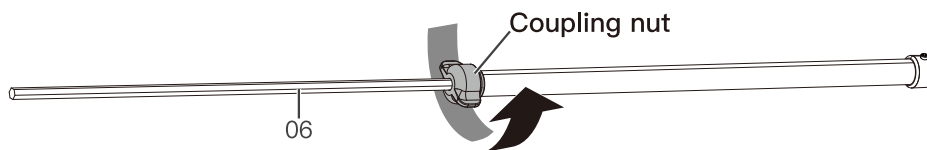

Fully insert the transmission rod into the left leg.

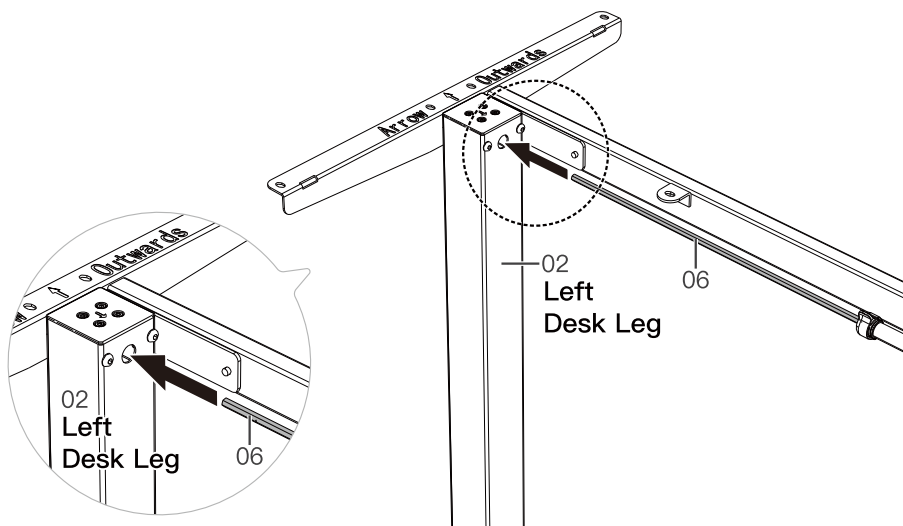

Adjust uneven desk legs if needed:

Measure the heights of the two desk legs to see if they are set at the same level. If not, turn the rod to adjust the left leg until it's level with the right leg. Turn the rod clockwise to lower the left leg or counter-clockwise to raise it.

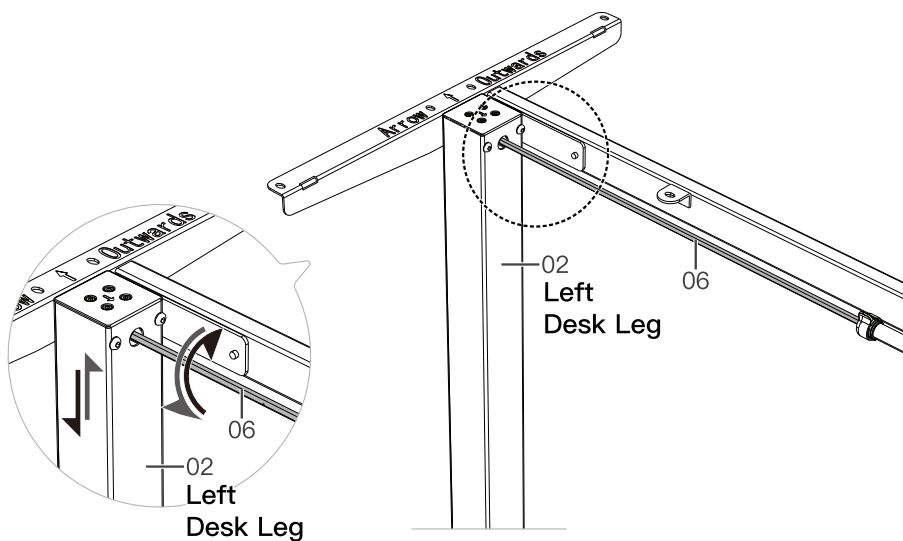

Connect the rod's other end to the motor drive shaft on the right leg, then tighten the set screw to secure.

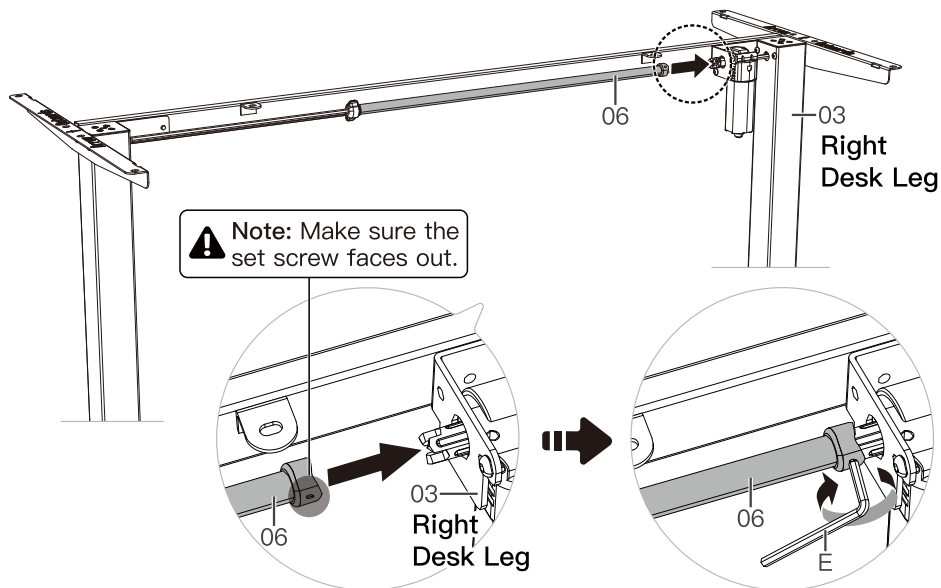

Tighten the coupling nut.

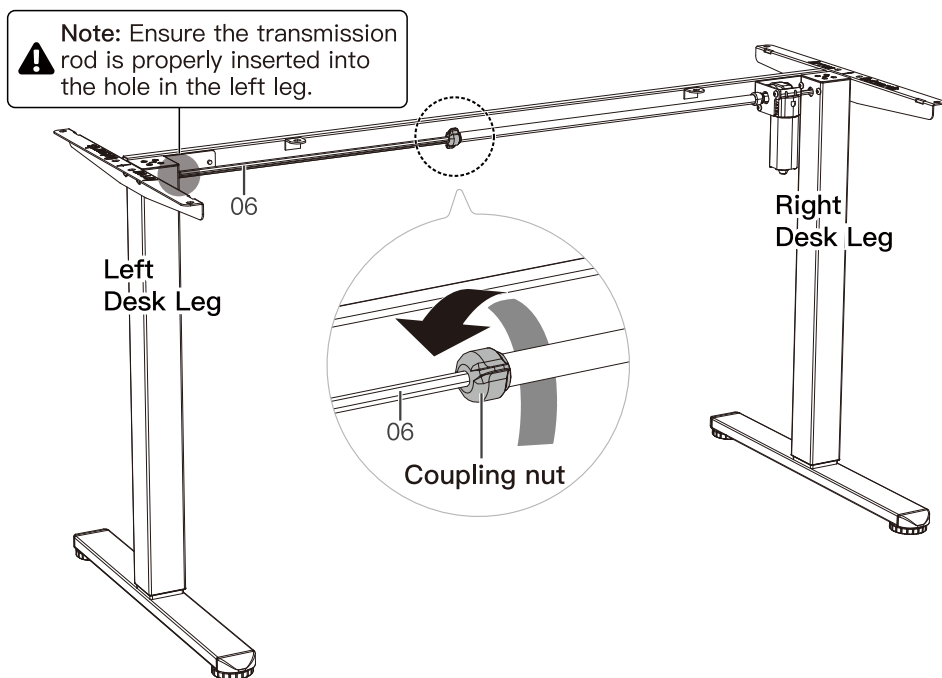



## Step 3 Attaching the Desktop

Attach the frame to the desktop.



Drill with  
suitable  
torque and  
speed

OR



not included

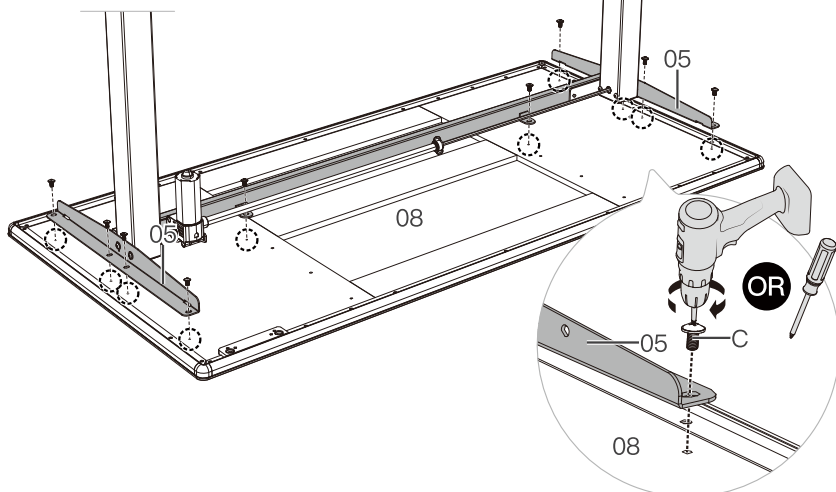

Attach the controller to the desktop.

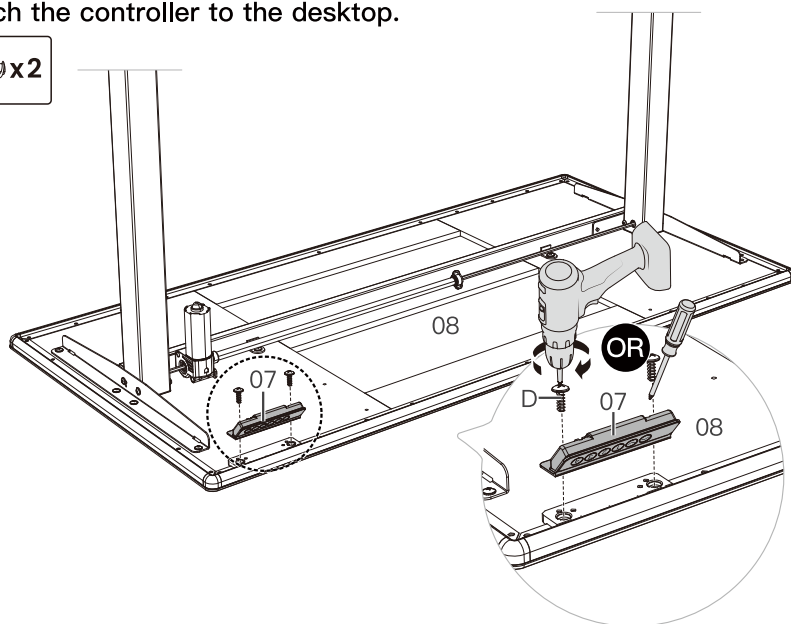

Attach the drawer to the desktop.

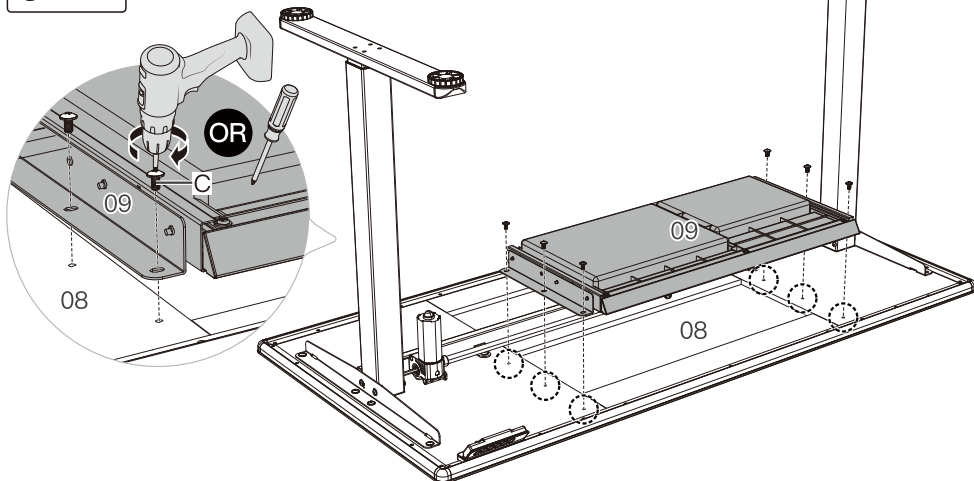

## Step 4 Connecting the Cables



**Note:** An example of a cable clip layout is indicated below. However, the cable clips can be arranged according to your needs.

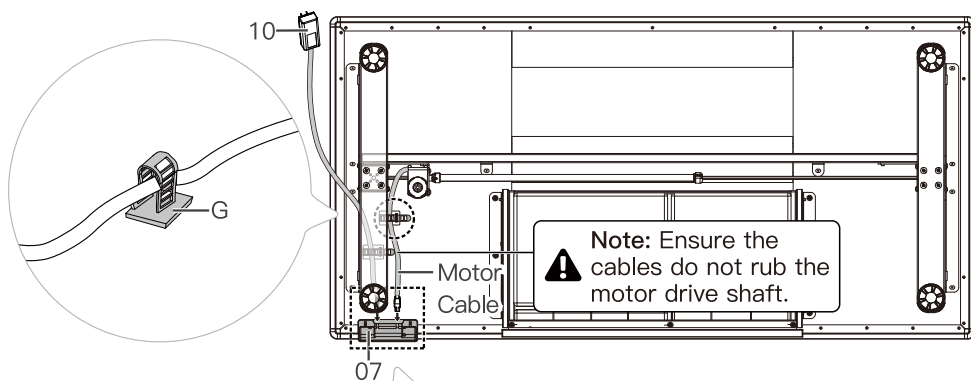

**Tip:** When flipping the desk over, do not allow the controller to collide with the ground, which could cause damage.

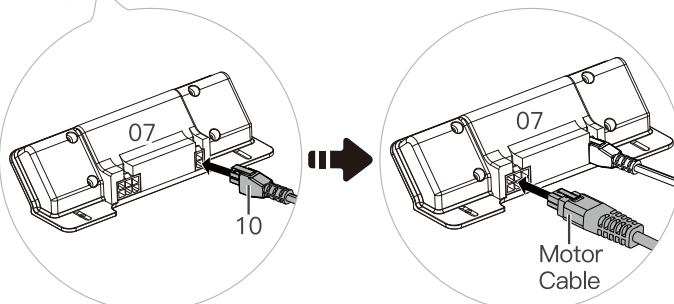

## Using the Controller

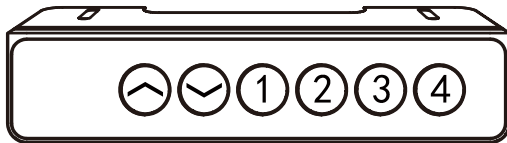

Tip: Reset before first use.

**Note:** Ensure that there are no obstacles when using the desk, that the desktop is not too close to the wall, and that all cables are long enough for the desk to move up and down freely.

**Suggestion:** Set the most comfortable height when you sit down to ① and the most comfortable height when you stand up to ②. The other two presets can be set for another user or for other heights you want to use.

- **Raise the Desk**

Press the ⬆ button to raise the desk continuously until it reaches the highest position of 46.5" (118cm) or the button is released.

- **Lower the Desk**

Press the ⬇ button to lower the desk continuously until it reaches the lowest position of 28.3" (72cm) or the button is released.

- **Save Current Height Setting**

Four heights can be saved. Press and hold the ①, ②, ③, or ④ button for 5 seconds until '1', '2', '3', or '4' is displayed. The current height will be saved to that button.

- **Select Height Setting 1**

Press the ① button. The desk will move to the height that was previously set for that button.

- **Select Height Setting 2**

Press the ② button. The desk will move to the height that was previously set for that button.

- **Select Height Setting 3**

Press the ③ button. The desk will move to the height that was previously set for that button.

- **Select Height Setting 4**

Press the ④ button. The desk will move to the height that was previously set for that button.

## Settings

<b>Reset</b>	1. Press and hold the Ⓢ button until the desk goes down to its lowest level, then release the button.
'RES' displays as  on the screen.	2. Press and hold the Ⓢ button for 5 seconds until the screen displays 'RES' and the desk comes back up slightly. The screen will display the current height, then reset is complete.

## Protection Mode Error Codes

<b>Hot</b>	Overheating Protection: When the motor has been working continuously for 5 minutes, it will stop operating to prevent damage from overheating. Wait for at least 15 minutes before making any further height adjustment.
<b>E10</b>	Sensor Malfunction Warning: Motor safety sensor cannot be detected. Power off, check the connection between the motor and controller, then power back on again.
<b>E20</b>	Overloading Warning: Max load exceeded. If raising the desk, remove all items from the desktop and try again. If lowering the desk, power off, remove all items from the desktop, power back on, then try again. If error code persists, follow the reset instructions.
<b>E02</b>	Operation Status Warning: The desk stops moving if vibration, impact, or incline are detected. If this detection is incorrect, follow the reset instructions before continuing use.
<b>E32</b>	Overvoltage Protection: Input voltage too high. If the correct AC adapter is being used, power off the desk, check the connection between power and the controller, then power on again.
<b>E31</b>	Undervoltage Protection: Input voltage too low. If the correct AC adapter is being used, power off the desk, check the connection between power and the controller, then power on again.
<b>—</b>	Cable Disconnection Warning: Check motor and controller cable connections. Normal operation should return once all connectors are properly connected.