

PLEASE NOTE:



1. When installing, the small leaves are installed on the inside, and the large leaves are installed on the outside.
2. If the transportation leaves are damaged, we have multiple delivery leaves and a large number of damage. Please contact us. We will quickly replenish you for free.
3. The ends of the lamp are worried about transportation damage. When the metal is bent, you can manually stretch the branches of the lamp. The copper material has good flexibility.

Precautions:

1. If you find the ceramics pendant broken or the mounting broken, please don't worry, we also have five percent free ceramics pendant.
2. The lamps shall not be close to acid, alkali chemical objects and gases containing corrosive, shall not be cleaned with water, it is recommended to wipe with a clean soft cloth.
3. Wear white gloves for installation.
4. Safe power supply: Before carrying out any electrical work, ensure that the relevant circuit is closed and use a voltage tester to verify that the wires are not charged. If necessary, turn off the power to the main new circuits or related circuits.
5. Wire Connections: Use the correct size wire and use the appropriate wire connectors to make the connections. Make wire connections in accordance with electrical codes to ensure proper insulation and protection of wire connection points.
6. Safe Spacing: Ensure that there is adequate safe spacing between the chandelier and combustible materials in accordance with the electrical code. This will avoid fire risks and overheating problems.
7. Test and Verify: Before reconnecting the power supply, double-check all wire connections and use a voltage tester to verify that the electrical connections are correct and safe. Make sure the pendant light switch and dimmer are working properly.
8. When you open the package, the thin branches at the ends of the branches need to be extended out. After the expansion is the correct size of the product.

1

SPECIAL FEATURE

Rated voltage	100V~120V,60Hz	Material	Brass+ceramic leaf
Lamp holde	G9	Style	Modern

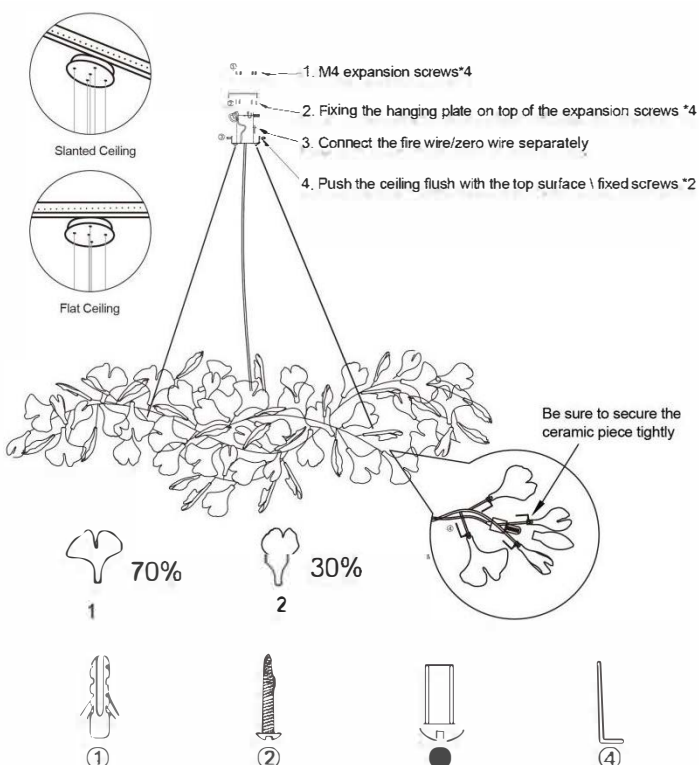

3

LIGHTING INGENUITY INHERITANCE

Make people's living environment better

A brand new online hub for design and quality oriented lighting. Each light is carefully designed and well thought out in terms of material and construction, and to provide the best value to our customers. Inclusivity is at the heart of the light; it complements market-leading designer brands in quality and design, while catering to budgets big and small. We are obsessed with product design, we design and manufacture beautiful, desirable lamps that you will be proud to display in your home. We put the "lamp", a lighting concept based on environmental protection and taste, to the market. For 24 years, the original intention has not changed, and we will create a comfortable, leisure, comfortable and healthy living and home environment for you



3 years warranty

If the goods have transportation and quality problems, free returns and exchanges.



If you have any questions, welcome to contact us by email, we will serve you wholeheartedly.

2

INSTALLATION STEPS

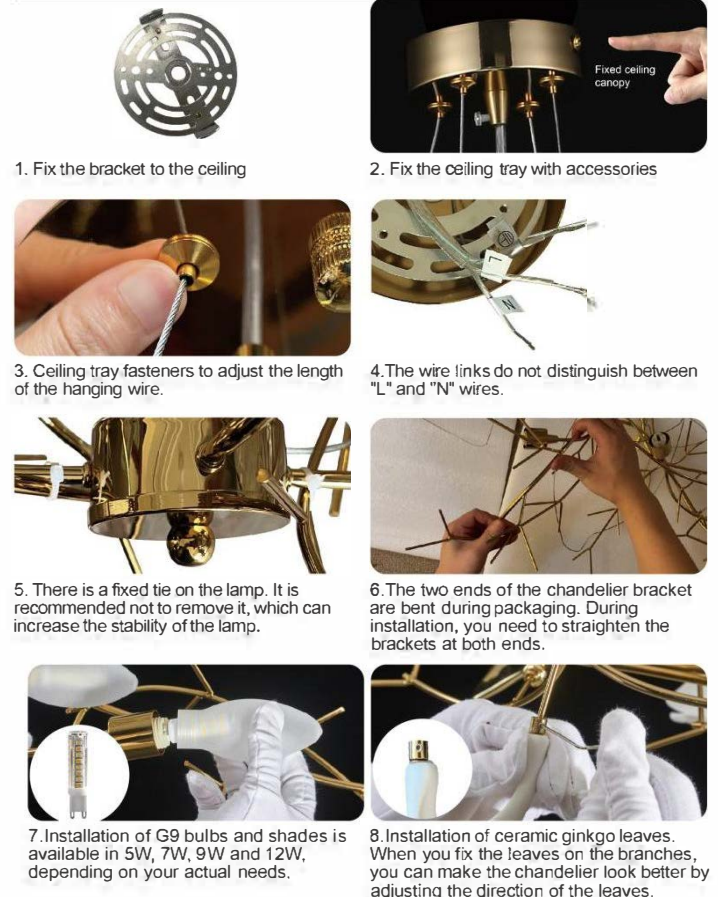

4