

INSTALL INSTRUCTION

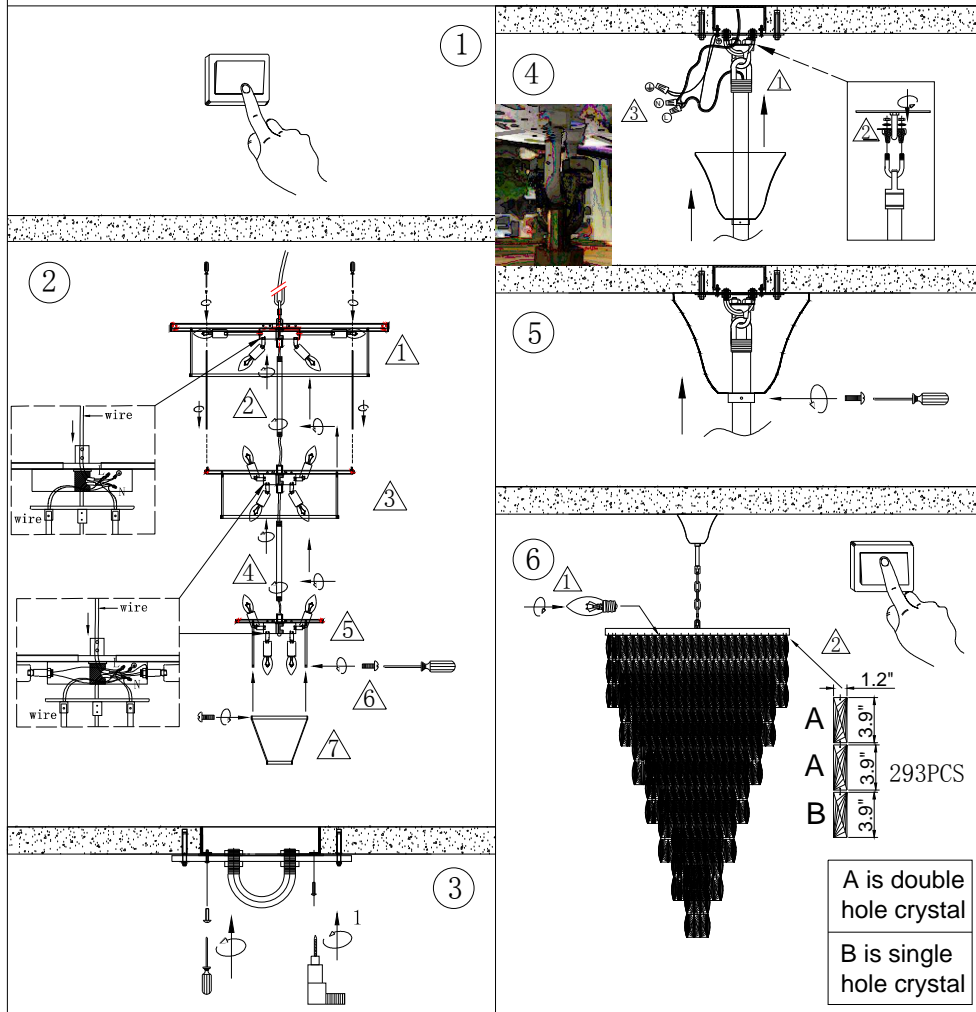

- ① turn off the power
- ② Assemble the lamp holder, see the detailed drawing
- ③ Fixed hanging plate on ceiling
- ④ Connect the power cord and the lamp rack
- ⑤ Lock the screw to fix the bell
- ⑥ Lock the light source, hang the crystal, and finally turn on the light

