

User's Manual

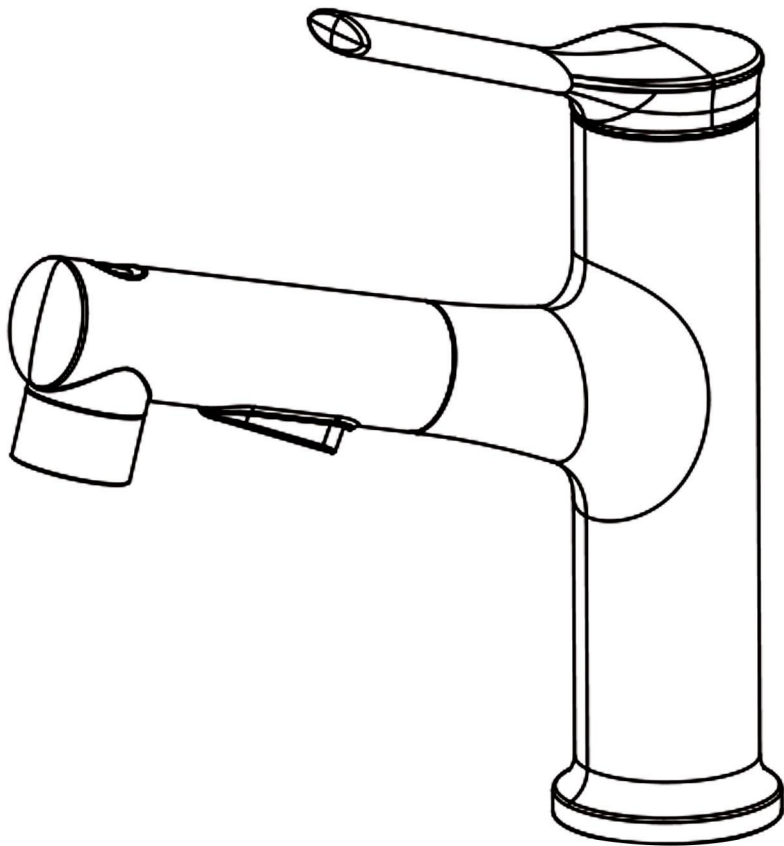

INSTALLATION INSTRUCTIONS

Installation Manual



IAPMO RESEARCH AND TESTING, INC.
5001 East Philadelphia Street, Ontario, California 91761-2816 • USA • 909-472-4100 • 909-472-4244 • www.iapmo.org





CERTIFICATE OF LISTING

IAPMO Research and Testing, Inc. is a product certification body which tests and inspects samples taken from the supplier's stock or from the market or a combination of both to verify compliance to the requirements of applicable codes and standards. This activity is coupled with periodic surveillance of the supplier's factory and operations as well as the assessment of the supplier's Quality Assurance System. This listing is subject to the conditions set forth in the characteristics below and it is to be construed as no recommendation, assurance or guarantee by IAPMO Research and Testing, Inc. of the product compliance by Authorized Listing Jurisdiction.

This certificate is not evidence of current listing. To verify listing status, visit the IAPMO R&T Product Listing Directory at pid.iapmo.org

Effective Date:	December 2019	-Rev. 2/24/2020-	Void After: December 2024
Product:	Flexible Water Connectors		File No. 5311
Issued To:	Fanaki Group Inc. Mechanical & Electrical Industrial Zone, Yuhuan County, Yuhuan 317400, ZHEJIANG China		

Identification: Products shall be marked with manufacturer's name or trademark, a statement "For use with water in accessible locations only." The products shall also bear the cUPC® certification mark. Markings shall be by means of either a permanent mark on the product, a label on the product or a tag attached to the product.

Characteristics: Flexible water connectors manufactured in various sizes, lengths and metal and fittings for hot or cold water applications that consist of an inner tube, which may or may not have an outer braided cover. Connectors are to be installed for use in accessible locations only. To be installed in accordance with the manufacturer's instruction, and the latest edition of the Uniform Plumbing Code and National Plumbing Code of Canada.

Products listed on this certificate have been tested by an IAPMO R&T recognized laboratory. This recognition has been granted based upon the



This listing period is based upon the last date of the month indicated on the Effective Date and Void After Date shown above. Any change in material, manufacturing process, marking or design without having first obtained the approval of the Product Certification Committee, or any extension of the listing period, shall be subject to the approval of the Product Certification Committee. Any change in material, manufacturing process, marking or design without having first obtained the approval of the Product Certification Committee, or any extension of the listing period, shall be subject to the approval of the Product Certification Committee. Any change in material, manufacturing process, marking or design without having first obtained the approval of the Product Certification Committee, or any extension of the listing period, shall be subject to the approval of the Product Certification Committee.

IAPMO RESEARCH AND TESTING, INC.
5001 East Philadelphia Street, Ontario, California 91761-2816 • USA • 909-472-4100 • 909-472-4244 • www.iapmo.org





CERTIFICATE OF LISTING

IAPMO Research and Testing, Inc. is a product certification body which tests and inspects samples taken from the supplier's stock or from the market or a combination of both to verify compliance to the requirements of applicable codes and standards. This activity is coupled with periodic surveillance of the supplier's factory and operations as well as the assessment of the supplier's Quality Assurance System. This listing is subject to the conditions set forth in the characteristics below and it is to be construed as no recommendation, assurance or guarantee by IAPMO Research and Testing, Inc. of the product compliance by Authorized Listing Jurisdiction.

This certificate is not evidence of current listing. To verify listing status, visit the IAPMO R&T Product Listing Directory at pid.iapmo.org

Effective Date:	November 2019		Void After: November 2024
Product:	Plumbing Fixture Fittings		File No. 10433
Issued To:	Aqua Gallery Co., Ltd 11th-15th A/D Block International Ceramic Sanitary City, 528000 Foshan, China		

Identification: Plumbing supply fittings complying with this Standard shall be marked with the manufacturer's recognized name, trademark, or other mark or, in the case of private labeling, the name, trademark or other mark of the customer for whom the fitting was manufactured. The marking shall be accomplished by use of a permanent mark or by placing a permanent label on the product. Markings on plumbing supply fittings shall be visible after installation.

Single-handle, single-control, and automatic compensating mixing bath and shower valves shall have identifiable temperature control settings in which the settings are indicated by words ("cold", "warm", "hot", etc.), by numbers, or graphically.

Packages shall be marked with the manufacturer's name, trademark, or other mark as well as the model number or, in the case of private



This listing period is based upon the last date of the month indicated on the Effective Date and Void After Date shown above. Any change in material, manufacturing process, marking or design without having first obtained the approval of the Product Certification Committee, or any extension of the listing period, shall be subject to the approval of the Product Certification Committee. Any change in material, manufacturing process, marking or design without having first obtained the approval of the Product Certification Committee, or any extension of the listing period, shall be subject to the approval of the Product Certification Committee.

IAPMO RESEARCH AND TESTING, INC.
5001 East Philadelphia Street, Ontario, California 91761-2816 • USA • 909-472-4100 • 909-472-4244 • www.iapmo.org





CERTIFICATE OF LISTING

IAPMO Research and Testing, Inc. is a product certification body which tests and inspects samples taken from the supplier's stock or from the market or a combination of both to verify compliance to the requirements of applicable codes and standards. This activity is coupled with periodic surveillance of the supplier's factory and operations as well as the assessment of the supplier's Quality Assurance System. This listing is subject to the conditions set forth in the characteristics below and it is to be construed as no recommendation, assurance or guarantee by IAPMO Research and Testing, Inc. of the product compliance by Authorized Listing Jurisdiction.

This certificate is not evidence of current listing. To verify listing status, visit the IAPMO R&T Product Listing Directory at pid.iapmo.org

Effective Date:	March 2019		Void After: March 2024
Product:	Plumbing Fixture Fittings - Components		File No. MC-9703
Issued To:	Ringsha Nanhai Cartridge Technology Co., Ltd. Liaohou Zone, Chongqing Fengshui RINGSHO 315538 China		

Identification: Each fitting component shall bear permanent legible markings to identify the manufacturer. This marking shall be the trade name, trademark, or other mark known to identify the manufacturer. The product shall also bear all other markings required by the standards. The marking shall be applied so as to be visible after installation. The product or packaging shall also bear the cUPC® certification mark along with the term "COMPONENT" above.

Characteristics: Plumbing fixture fitting components to be installed in accordance with the manufacturer's instructions and the requirements of the latest edition of the Uniform Plumbing Code.

Products listed on this certificate have been tested by an IAPMO R&T recognized laboratory. This recognition has been granted based upon the Laboratory's compliance to the applicable requirements of ISO/IEC 17025.

Products are in compliance with the following code(s):
Uniform Plumbing Code (UPC®)



This listing period is based upon the last date of the month indicated on the Effective Date and Void After Date shown above. Any change in material, manufacturing process, marking or design without having first obtained the approval of the Product Certification Committee, or any extension of the listing period, shall be subject to the approval of the Product Certification Committee. Any change in material, manufacturing process, marking or design without having first obtained the approval of the Product Certification Committee, or any extension of the listing period, shall be subject to the approval of the Product Certification Committee.

BEFORE INSTALLATION

For your safety, please read the safety precautions carefully before us.

In order to ensure the correct installation of the product, prevent personal harm or property loss to customers or others, please follow the following tips strictly.

There may have a small amount of water trace in the product, which is normal, please feel free to use it.

Prevent you from performing

Daily use

- ⊗ When water leakage occurs, forbid to use the product.

Must be executed

Installation

- ⊕ When installing or repairing the product, the water source must be turned off, otherwise it may lead a flood.
- ⊕ Please install the product accordance with this manual strictly.
- ⊕ Please entrust a qualified professional to install the product.
- ⊕ When installing, please make sure that the articles in the bathroom cabinet are placed in order, to avoid affecting the smooth return of the extraction pipe.

Daily use

- ⊕ When the temperature is lower than 4℃, if the product is not used for a long time, please empty the pipe stored water or close the angle valve, and keep the product on state.
- ⊕ People with disabilities, people with intellectual disabilities, people with lack of common sense and children need to use this product under the supervision of special personnel.

Cleaning and maintenance

- ⊕ Before cleaning up the soups, the faucet should be turned off, otherwise it may cause water leakage, which may cause the household property to be soaked and the property will be damaged.
- ⊕ Regularly (twice a year) confirm the leakage and looseness of the product and its surroundings. Otherwise the parts may be damaged, personnel scald, injury or property damage caused by water leakage due to aging and wear.

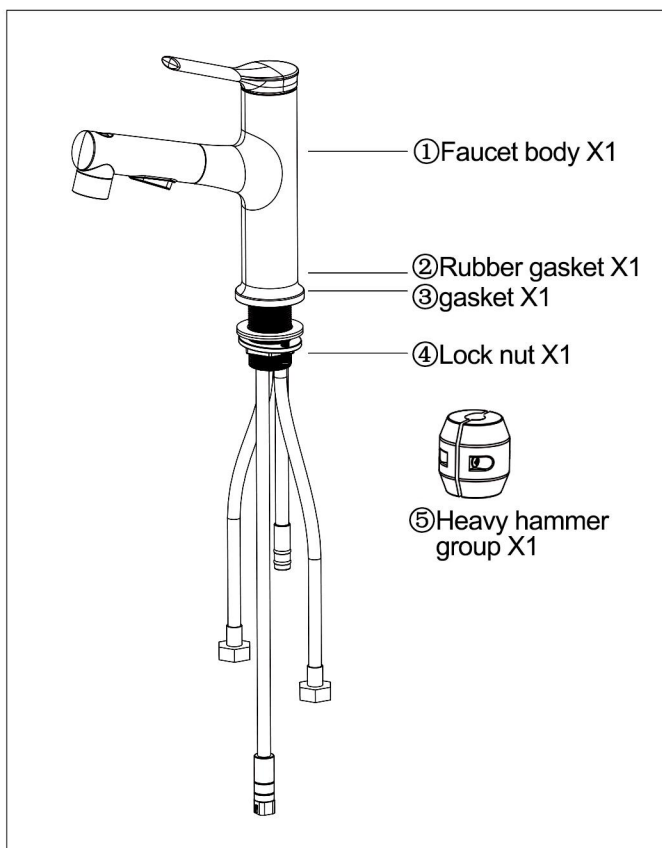

Product size

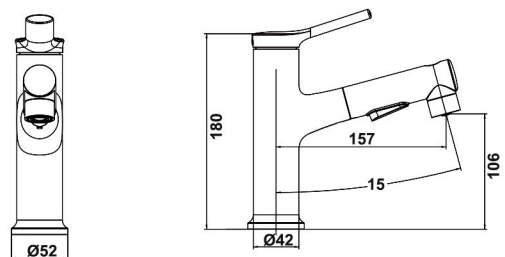

Product specification

The diameter of the mounting hole on the countertop: $\phi 33\text{--}\phi 35\text{mm}$, the distance between the hole center and the wall should be more than 40mm.

Working pressure (static pressure): $\leq 1.0\text{MPa}$, recommend pressure: $0.15\text{MPa--}0.5\text{MPa}$

Applicable water temperature range: $4^{\circ}\text{C--}90^{\circ}\text{C}$, recommend water temperature range: $4^{\circ}\text{C--}70^{\circ}\text{C}$

Service environment temperature: $4^{\circ}\text{C--}50^{\circ}\text{C}$ (for use inside the buildings only)

Suitable for the end of cold and hot water supply pipeline inside the buildings, not suitable for the other media and uses.

Installation tools



Teflon tape

BEFORE INSTALLATION

This product has been inspected and debugged by the factory to the best condition. Please do not disassemble and assemble it yourself.

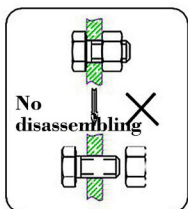

Before installing the faucet, please be sure to remove sundries and sludge from the water pipe to prevent sundries from blocking the faucet.

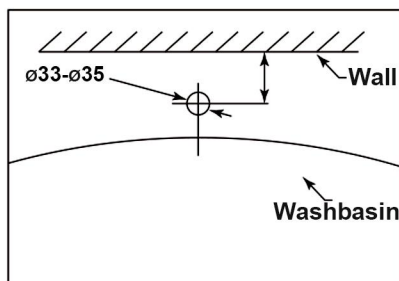
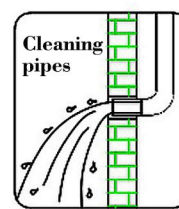

1. Cleaning of water supply pipe

Before the installation, it is necessary to clean the matters such as debris, sand particles in the pipe to avoid blockage.

2. hole setting

When setting the table washbasin, please note that the mounting hole on the wash basin must be between $\phi 33-\phi 35$, the specific installation position and size are shown in the figure as below.

3. Installation of the main body

Before installation, the dirt around the mounting hole must be removed; since the main body surface is electroplated, pay attention not to scratch the electroplated surface when opening the package, to avoid scratching. This product can't be twisted with pipe tongs to prevent deformation or even breaking.

INSTALLATION STEPS

① Insert the faucet body into the ceramic basin hole

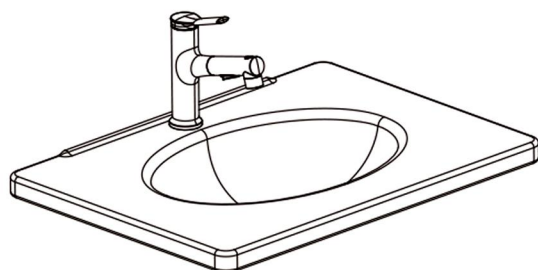

② Lock the faucet

Install AB upward according to the sequence shown in the figure. Lastly install the mounting nut onto the screw thread tube, push it upward, press it tightly, and then screw it clockwise.

a. rubber gasket—
b. shim
c. quick mounting nut

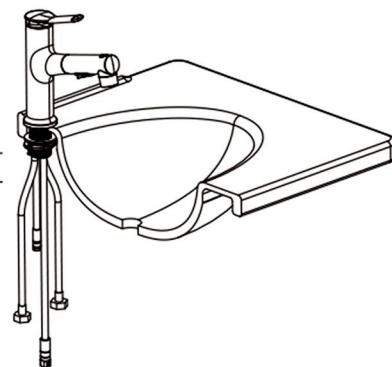

Note: please pass the hot and cold water pipe with hexagon nuts through the dental tube nuts one by one, and then put the hose with quick connect fitting through the dental tube nut.

③ Install the hose

Check whether the outlet water of angle valve is normal, discharge appropriate amount of water to clean the pipeline.

Connect the braided pipe with the red label to the hot water angle valve, and the braided pipe with the blue label to the cold water angle valve, then tighten with a wrench.

Note: when installing the hose, please hold the hose with one hand and then tighten the hexagon nut to prevent the hose from twisting along with the nut. When tightening the hexagon nut, please use proper force, remember not to use too much force. Put the handle in the closed position and open the angle valve to check whether there is water leakage.

Put a bucket under the water pipe at the bottom of the faucet, turn on the handle and check whether the water outlet is normal.

Note: the water supply hose must not be taut, kinked or twisted. If the water supply hose much be coiled, keep the inner diameter above 76mm.

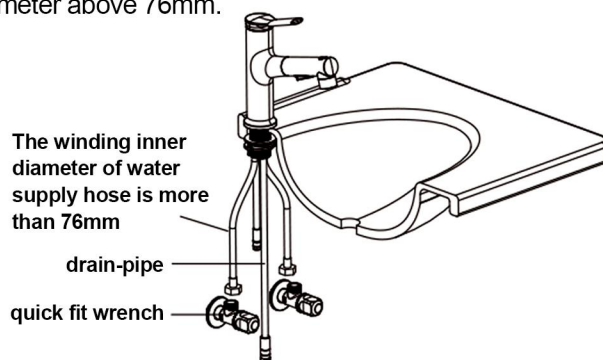

INSTALLATION STEPS

④ Installation of extraction pipe、heavy hammer group

As shown in the figure, insert the connector B onto A, connect the extraction hose.

Note: if you need to pull it out, press and hold the blue part on both sides of the black connector to pull it out. Please do not twist the extraction pipe, otherwise it will not be able to draw the shower head smoothly.

Install the heavy hammer group on the extraction hose, which is 5cm above the lowest point of the nozzle hose.

Note: do not install the heavy hammer near the end of connector, otherwise the extraction head will not be able to return automatically. If the heavy hammer touches the bottom of the bathroom cabinet, please install the heavy hammer group about 10cm away from the bottom of the bathroom cabinet.

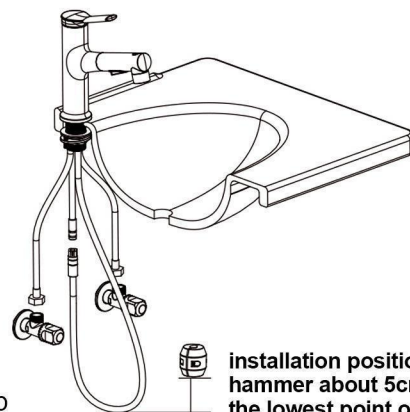

installation position of heavy hammer about 5cm upward the lowest point of the hose.

⑤ Complete the installation

To avoid losing the bubbler wrench, please clip the bubbler wrench onto the cold water pipe as shown.

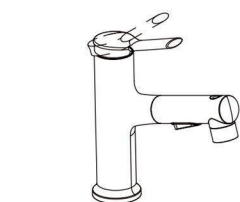
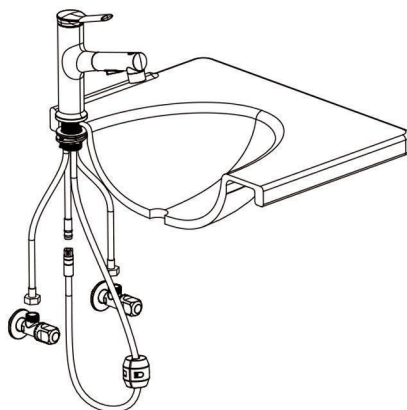

handle switch、
temperature adjustment

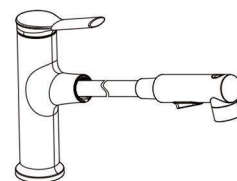

draw freely

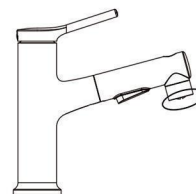

switch splash

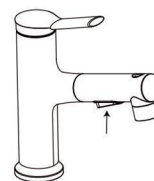

press the key to turn
on the mouthwash

CLEANING CARE

In order to keep the appearance of faucet clean, bright and good performance, please take care of the faucet as follows;

1. Rinse with water only and dry with soft cotton cloth;
2. Use mild liquid and colorless glass cleaner to remove surface dirt and scale film, or use polish without abrasive effect;
3. Do not use abrasive detergent, polish, emery cloth, paper towel or scraper, etc.;
4. Do not use acid cleaner, or cleaner and soap with insoluble gran etc.;
5. In the process of use, mud may accumulate in the bubbler and make the water flow slow. The bubbler can be unscrewed, rinsed with water, and then installed back in place.



