

## Assembly Instructions

- (A) 1 -Top
- (B) 4 -Legs
- (C) 8 -Screw  $\Phi_{16}^{5} * 2'' L$
- (D) 8 -Spring Washer
- (E) 8 -Washer
- (F) 1 -Wench

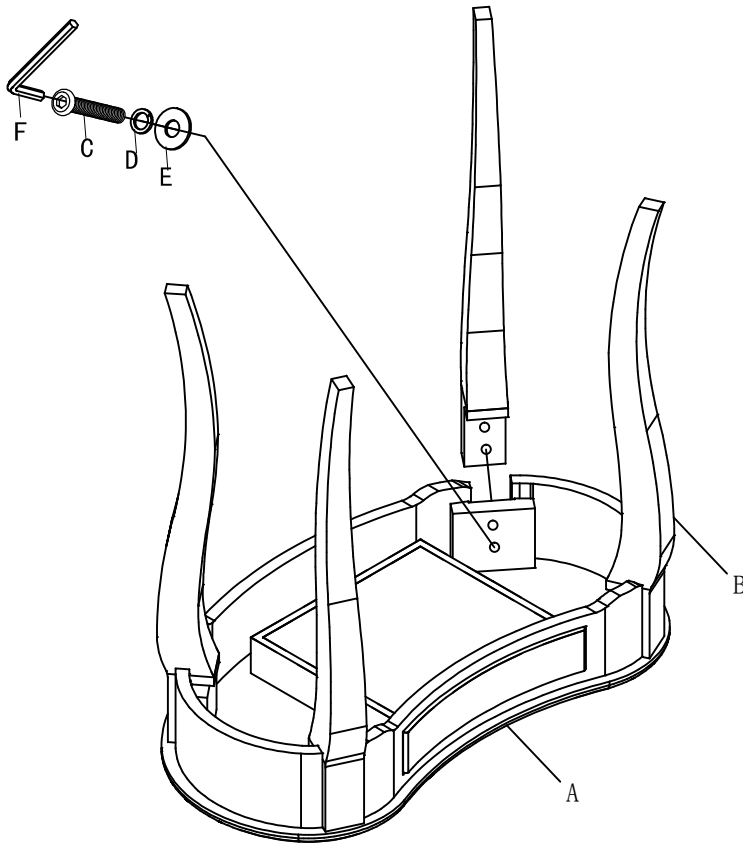
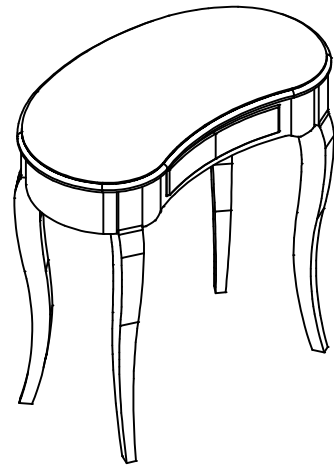

(\*)Caution: DO NOT OVERTIGHTEN.

In any correspondence regarding this product, please include the complete identification number located on the underside of the product.

*We hope this table will be a useful and decorative addition to your home for years to come.*