

ASSEMBLY INSTRUCTION

HALL TREE

ASSEMBLY TIPS:

1. Remove hardware from box and sort by size.
2. Please check to see that all hardware and parts are present prior to start of assembly.
3. Please follow attached instructions in the same sequence as numbered to assure fast & easy assembly.



Warning !

1. Don't attempt to repair or modify parts that are broken or defective . Please contact the store immediately.
2. This product is for home use only and not intended for commercial establishment.

PARTS IDENTIFICATION

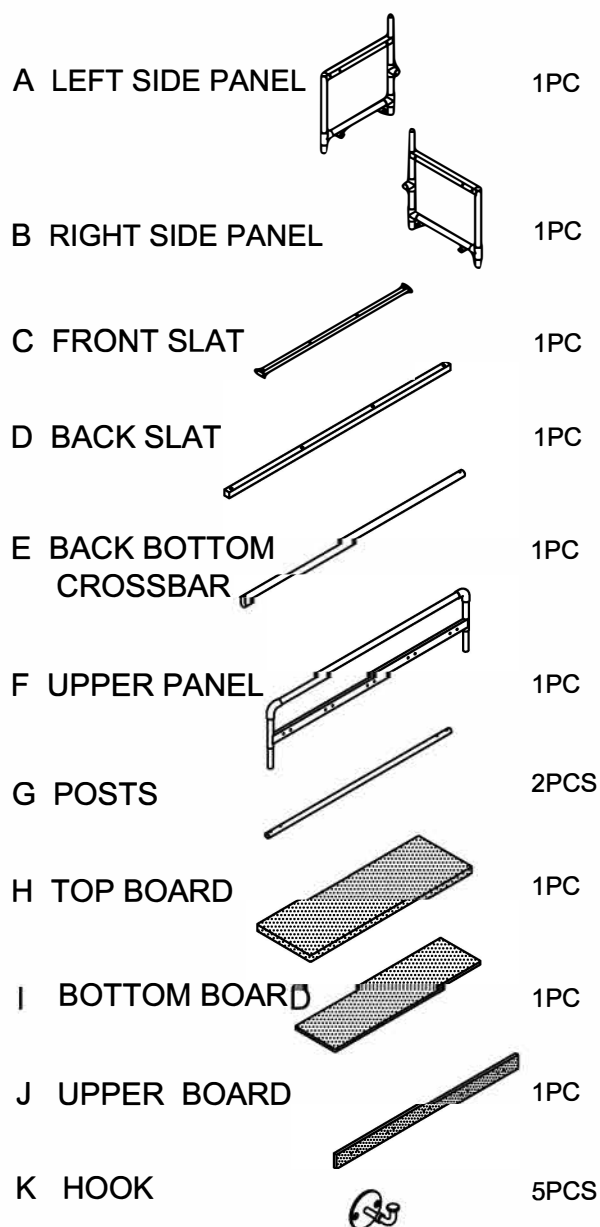

ASSEMBLY TIME PER UNIT: 30 MINUTES

Z HARDWARE PACKAGE

NO	DESCRIPTION	FIGURE	QTY
1	BOLT 1/4"x1/2"		18PCS
2	BOLT 1/4"x1-1/2"		8PCS
3	BOLT 1/4"x2"		2PCS
4	BOLT 3/16"x1-1/4"		10PCS
5	METAL WASHER		18PCS
6	HEX. NUT		4PCS
7	ALLEN WRENCH		1PC
This screwdriver is not provided.			

ASSEMBLY

Do not fully tighten all bolts until assembly is complete. This will help all parts to assemble properly.

Step 1:

6



4PCS

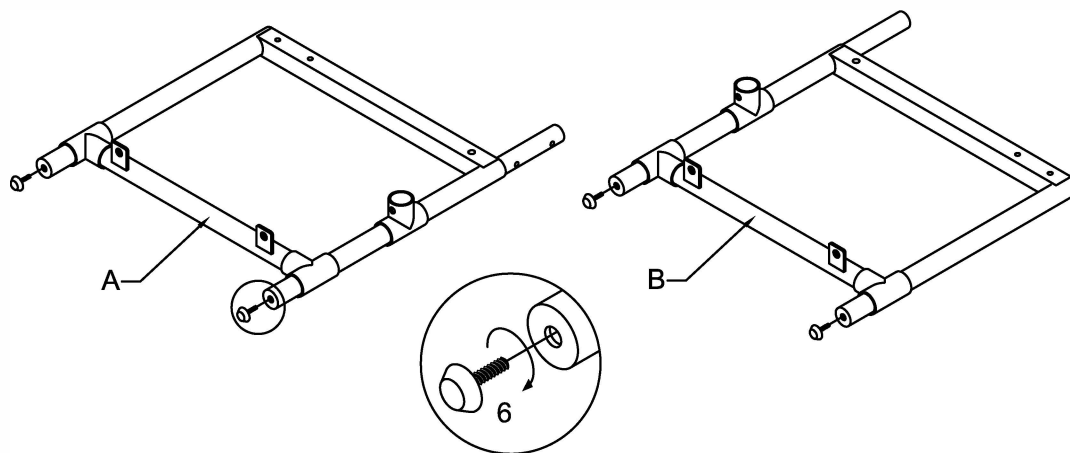

Step 2:

1



2PCS

7

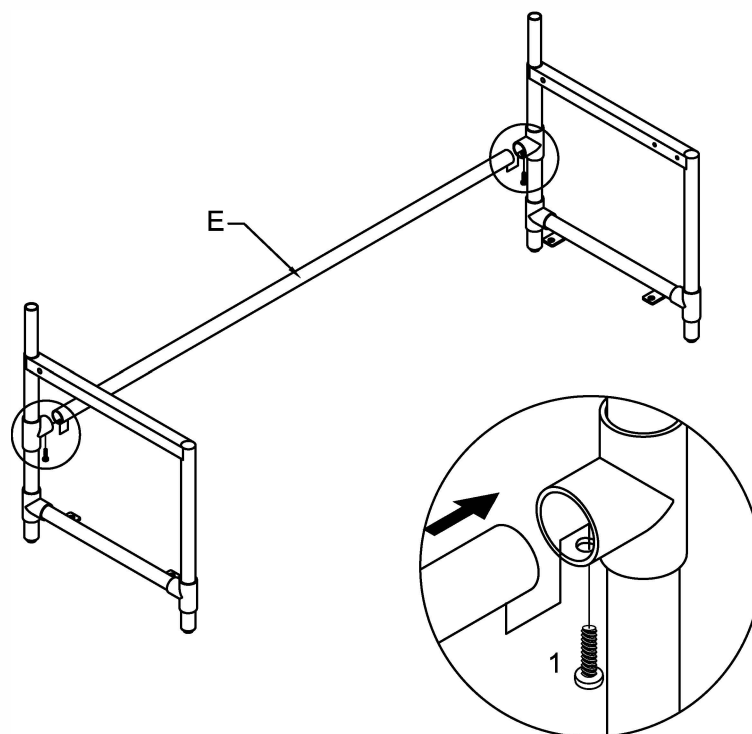

Step 3:

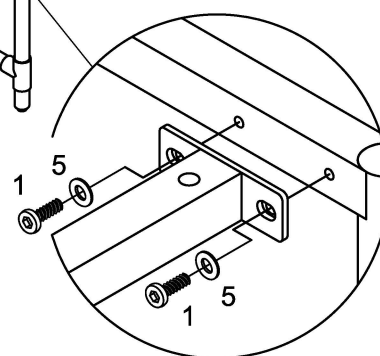
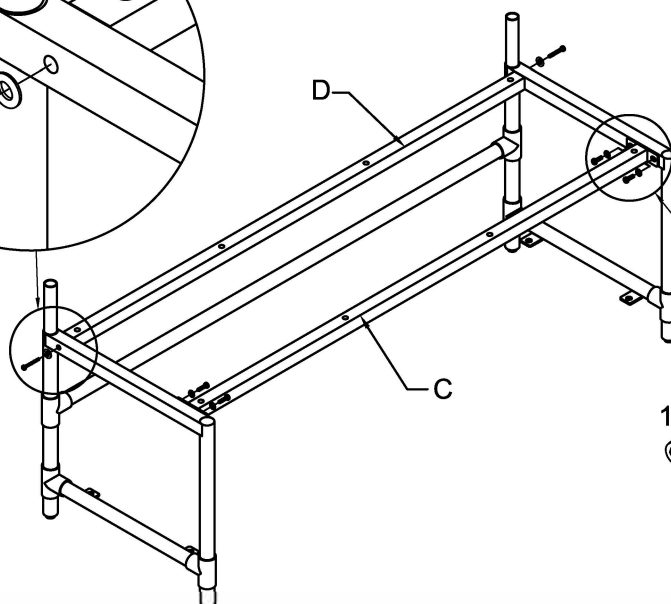
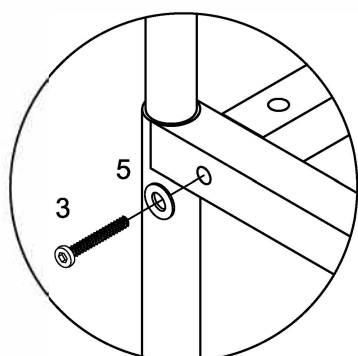

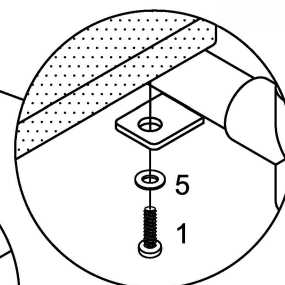
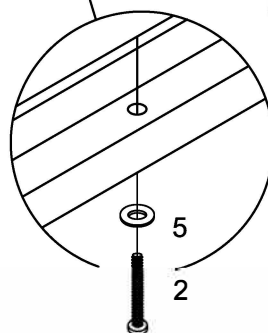
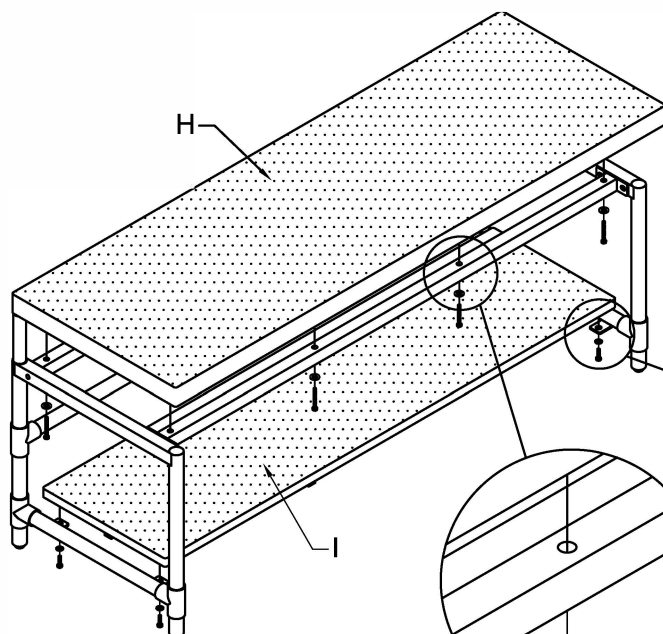

1		4PCS
3		2PCS
5		6PCS
7		

Step 4:



1		4PCS
2		8PCS
5		12PCS
7		

Step 5:

- 1  4PCS
- 7 

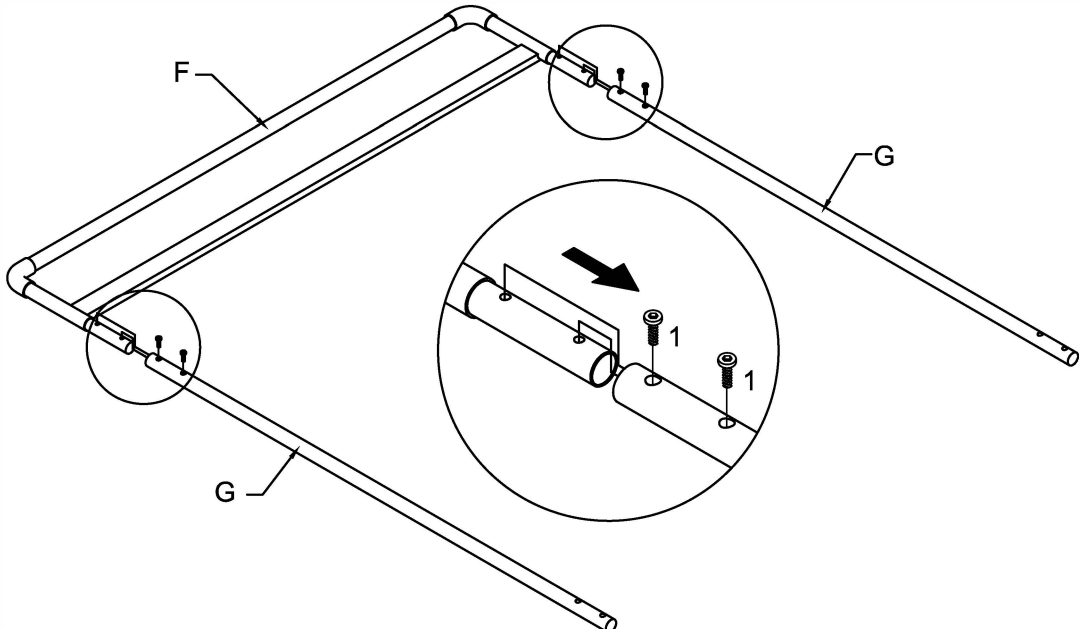

Step 6:

- 4  10PCS

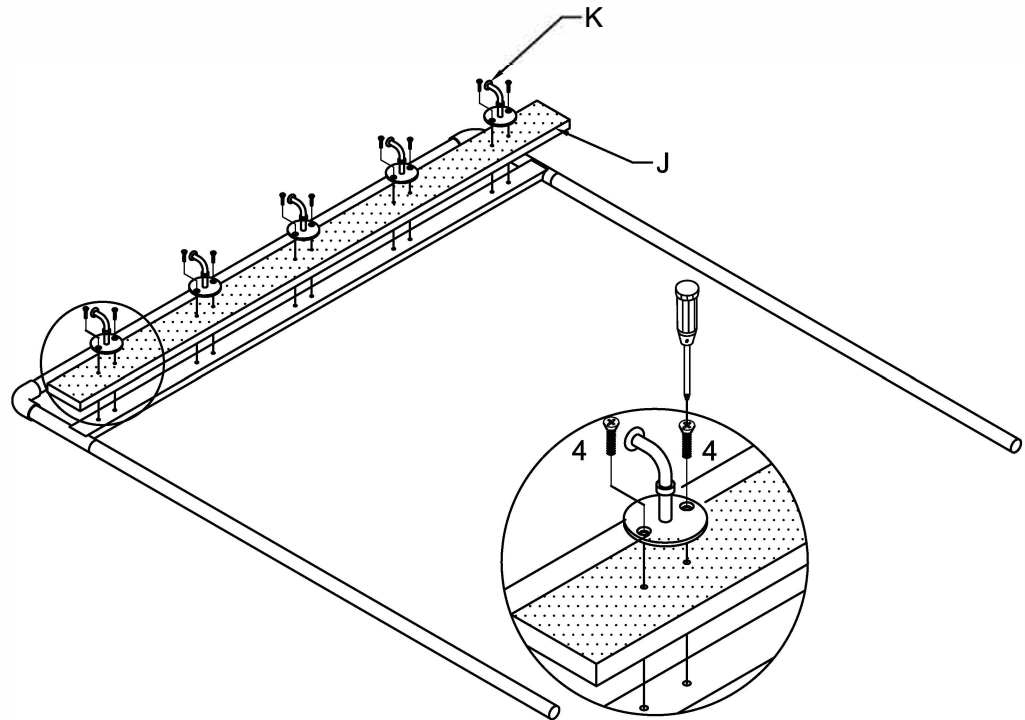

Step 7:

- 1  4PCS
- 7 

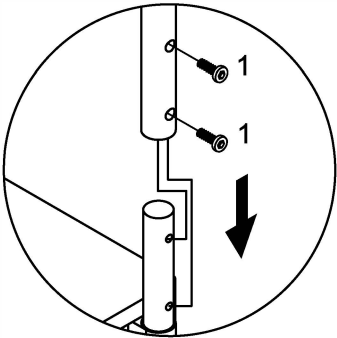
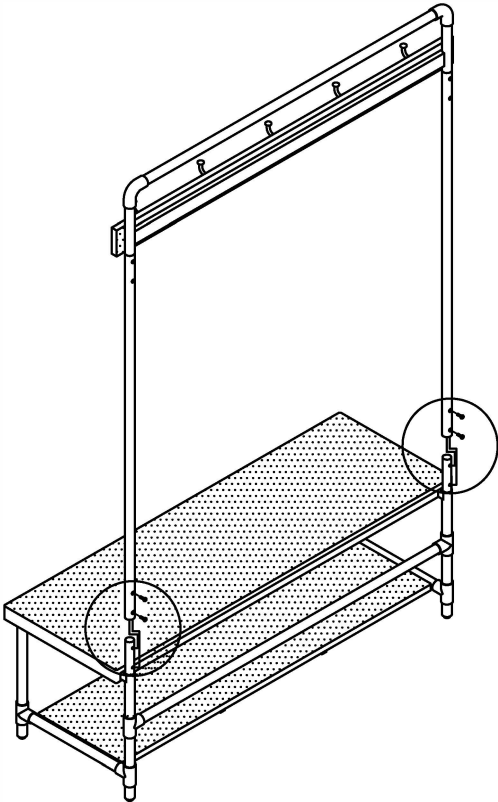

Step 8:

