

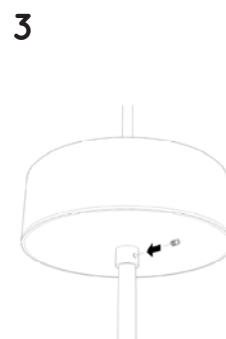

wattage 60W max
socket 1X E26
voltage 120 V ~ 60 Hz

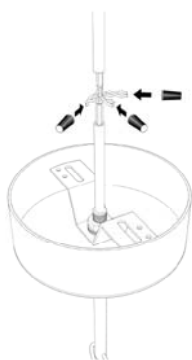

CAUTION:

Before starting, turn off power at main circuit panel.

ATTENTION:

coupez l'alimentation avant de procéder à l'installation.

WARNING

1. The installation work should only be performed by qualified electrician.
2. Ensure the ceiling fixture is disconnected from main power before installation.
3. Make sure the ceiling fixture is securely supported during the installation process and securely fastened to the ceiling once installation and wiring is complete.
4. Ceiling fixture is for indoor use only.

IMPORTANT

1. Wear gloves during installation to avoid scratching the lighting fixture surface
2. Do not install the ceiling fixture on a damp or damaged ceiling.
3. Ensure that the electrical supply complies with the type stated on rating label.
4. Used lighting source shall be of suitable model and wattage.
5. Avoid touching the shade and bulb when the lighting fixture is on.
6. Please turn off power and let the bulb and shade cool down before replacing the bulb and adjust the light direction.
7. Use a dry soft cloth and to clean lighting fixture.
8. If the external flexible cable or cord of lighting fixture is damaged, it shall be exclusively replaced by the manufacturer or his service agent or a similar qualified person in order to avoid a hazard.