

TUB FILLER WITH DIVERTER AND SHOWER RING

Cat. No.
4124



Shower Rod: 48" W x 24" D
Riser Height: 62"
Wall Support: 10" adjustable
Ceiling Support: 30" adjustable

Features:

- ▶ 3/4" Brass tubing
- ▶ Code gooseneck spout
- ▶ 3-3/8" Centers on tub wall
- ▶ 1/4 Turn ceramic disc cartridges
- ▶ Flow rate is 3.68 GPM
- ▶ 3/4" Nipples
- ▶ Porcelain lever handles
- ▶ Includes riser and rectangular shower Rod
- ▶ Includes ceiling and wall support assemblies
- ▶ Supports adjustable by cutting
- ▶ Does Not include showerhead
- ▶ Cast Iron tub use ONLY
- ▶ For Acrylic Tub Use Buy Part# 4122

Finishes:

CP Polished Chrome



WARNING: This product can expose you to chemicals, including lead which is known to the State of California to cause cancer or birth defects or other reproductive harm, for more information, go to www.p65warnings.ca.gov

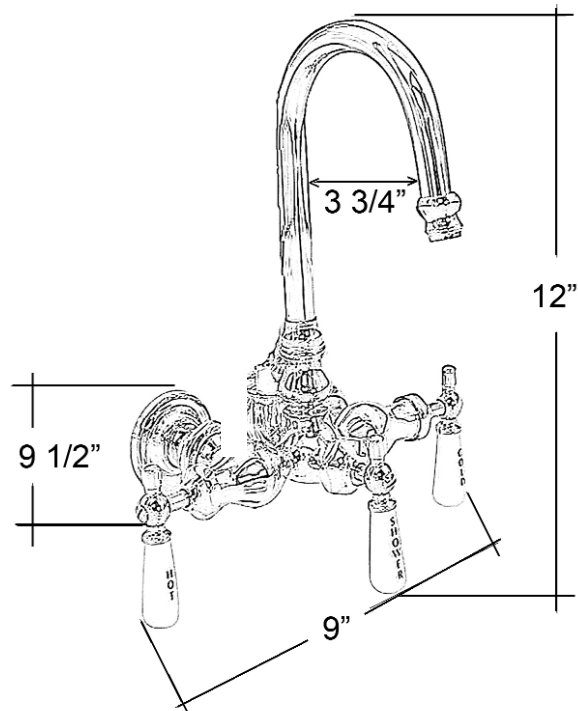

Dimensions are nominal and may vary. Dimensions and specifications subject to change without notice.