



Staccato™
Top-Mount Kitchen Sink
K-3369-1

Features

- 36-inch minimum base cabinet width.
- Double equal bowls.
- 8-inch depth.
- Single faucet hole.
- SilentShield® sound-absorption technology offers quieter performance.
- Includes hardwood cutting board.
- Includes installation hardware.

Material

- 18-gauge stainless steel.

Installation

- Top-mount



For complete listing of available colors, go to kohler.com.

Codes/Standards

ASME A112.19.3/CSA B45.4

**Lifetime Limited Warranty for Kohler
Stainless Steel Sinks**

See website for detailed warranty information.

Product Specification

Sink shall be 33" (838 mm) in length and 22" (559 mm) in width. Sink shall be made of 18-gauge stainless steel. Sink shall be a double (equal) compartment. Sink shall be one deck hole. Sink shall be top-mount. Sink shall be Kohler Model K-3369-1.

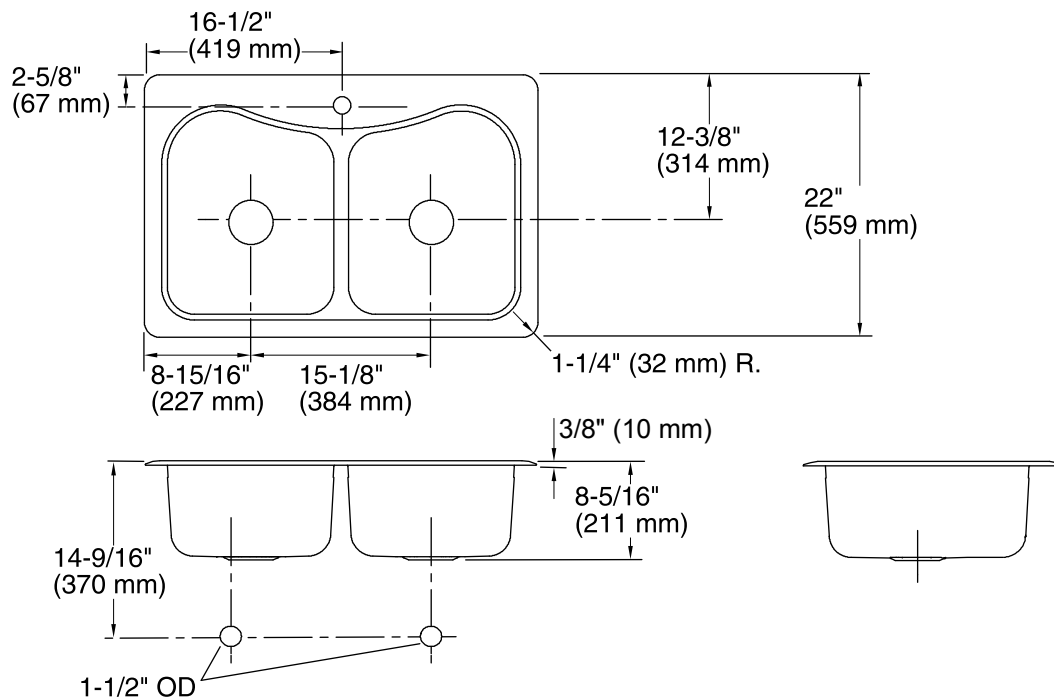

Technical Information

All measurements are approximate only.

Bowl configuration: Double equal

Installation: Top-mount

Cutout: Top-mount, 32-1/2" x 21-1/2" (826 mm x 546 mm) with 1" (25 mm) radius corners

Minimum base cabinet width: 36" (914 mm)

Bowl area (left/right): 17-1/16" x 13-15/16" (433 mm x 354 mm)

Water depth(left/right): 8" (203 mm)

Number of deck holes: 1

Faucet hole(s): 1-7/16" (37 mm)

Drain hole: 3-5/8" (92 mm)

Installation Notes

Install this product according to the installation guide.