

CEILING FAN WITH LIGHTS INSTALLATION MANUAL

SAFETY RULES

1. To reduce the risk of electric shock, ensure electricity has been turned off at the circuit breaker or fuse box before beginning.
2. All wiring must be in accordance with the National Electrical Code and local electrical codes. Electrical installation should be performed by a qualified licensed electrician.
3. **WARNING:** To reduce the risk of electrical shock and fire, do not use this fan with any solid-state fan speed control device.
4. **WARNING:** To reduce the risk of fire, electric shock, or personal injury, mount to outlet box marked "Acceptable for Fan Support of 45kg (99.2 lbs.) Less" and use mounting screws provided with the outlet box. Most outlet boxes commonly used for the support of light fixtures are not acceptable for fan support and may need to be replaced. Due to the complexity of the installation of this fan, a qualified licensed electrician is strongly recommended.
5. The outlet box and support structure must be securely mounted and capable of reliably supporting a minimum of 45KG.
6. The fan must be mounted with a minimum of 7 feet clearance from the trailing edge of the blades to the floor.
7. Avoid placing objects in the path of the blades.
8. To avoid personal injury or damage to the fan and other items, be cautious when working around or cleaning the fan.
9. Do not use water or detergents when cleaning the fan or fan blades. A dry dust cloth or lightly dampened cloth will be suitable for most cleaning.
10. After making electrical connections, spliced conductors should be turned upward and pushed carefully up into the outlet box. The wires should be spread apart with the grounded conductor and the equipment-grounding conductor on one side of the outlet box.
11. Electrical diagrams are for reference only.
12. The fan is suitable for indoor use only.

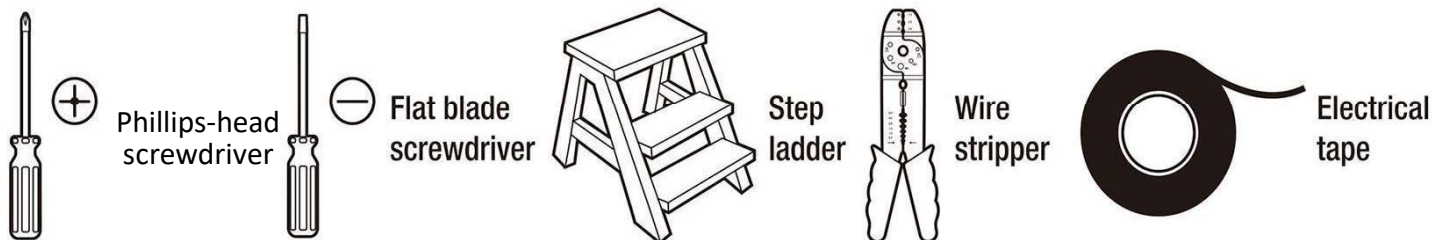



TOOLS REQUIRED

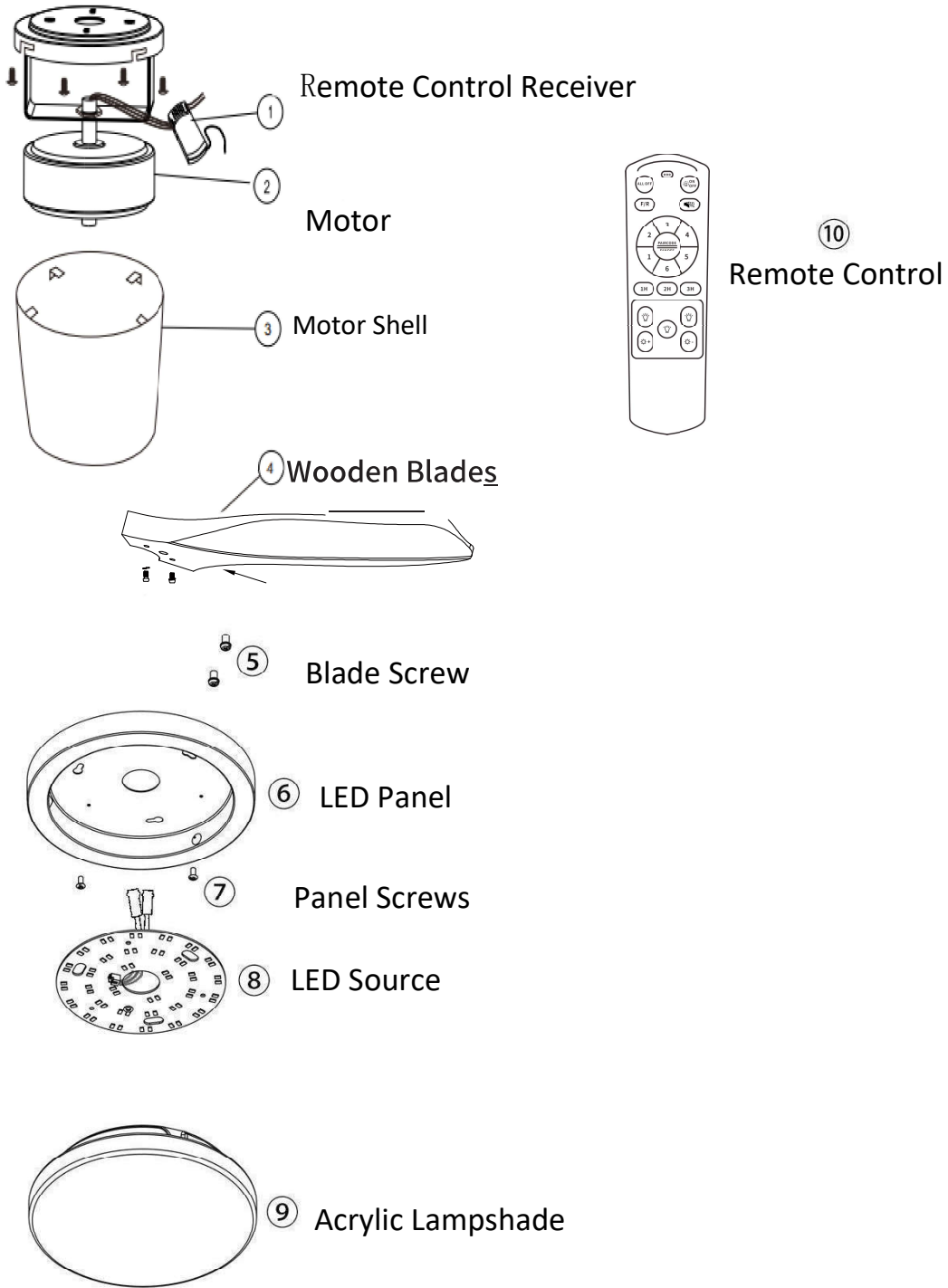

BEFORE INSTALLATION

Unpack your fan and check the contents. You should have the following items:



									
1/4*15 screw	6	Balance sticker	2	Explosion screw	4	Gasket	6	Self-tapping screws	4

INSTALL THE FAN

Tools Required: Phillips Screwdriver, Pair of Pliers, Straight slot Screwdriver, Adjustable Wrench, Step Ladder and Wire Cutters.

INSTALL THE MOUNTING BRACKET

To prevent personal injury and damage, ensure that the hanging location allows the blade a clearance of 7.0 feet (2.3 meter) from the floor and 18 inches (45.72 centimeters) from any wall or obstruction.

1. Then drill two holes in the ceiling. Secure the mounting bracket to the building structure using the two provided expansion screws, and tighten them firmly. (Fig.1)

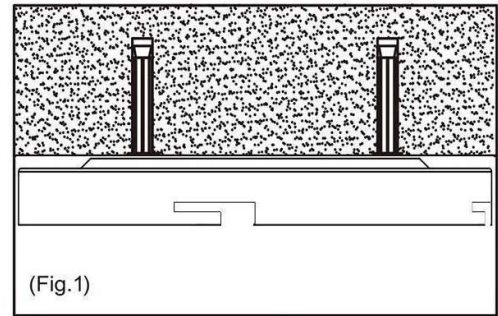

2. For the Wood Ceiling: Mark the location for the ceiling fan first, secure the mounting bracket to the building structure with four screws provided. (Fig.2)

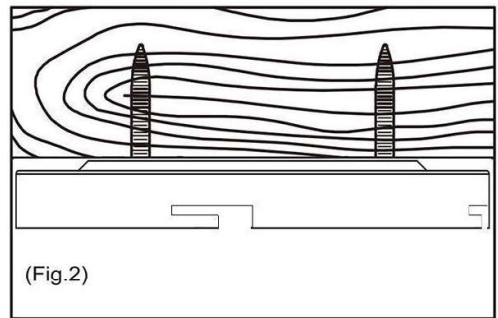

NOTE: The installed hanger must be able to support a weight of at least 45 kg.

INSTALLING RECEIVER

INSTALLING RECEIVER

To install the ceiling fan, follow the steps below:

1. Install the motor: Loosen the four screws on the ceiling mounting bracket, align the motor with the bracket then secure and lock it in place with the screws.
2. Install the receiver: Connect the wires from the motor to the wires on the receiver according to their corresponding colors.(Please refer to the remote control manual for details.)

Note: some models come pre-assembled.

3. Install the shell: Place the shell over the motor, rotate it clockwise and lock it onto the mounting bracket.

Attention: The lead wire must be secured tightly. If loose, it may rub against the motor and cause noise.

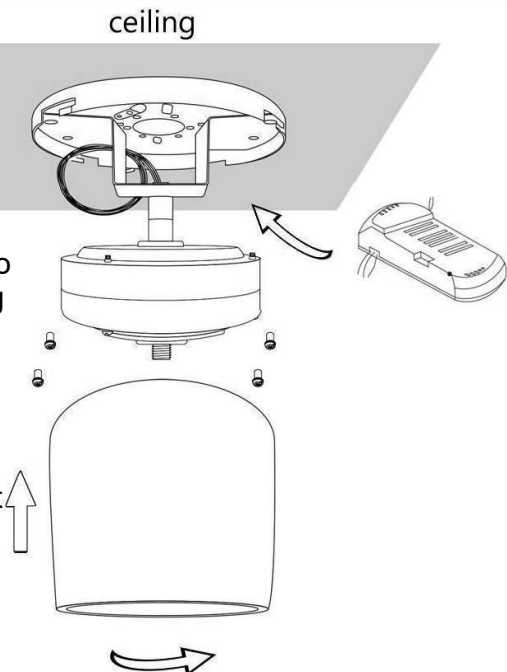

Installation steps of ceiling fan light

1. Hang the fan motor to the ceiling

Ceiling Bracket mount to wood ceiling



Ceiling Bracket mount to concrete Ceiling



Screw down the 6 blades screws



Hang the motor to the ceiling bracket



2. Wire connection

Connect control box to motor at blue point, wire two lines to your electric box at red

Insert connected control box to the ceiling bracket then arrange the wires.

Attention!!!Loose wires will cause wires scrapping working motor and break off.

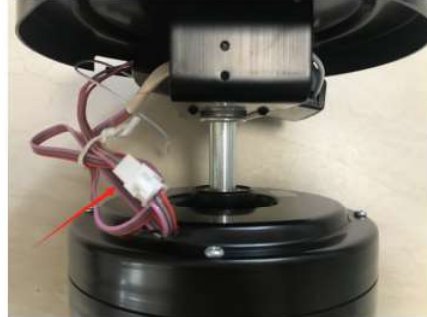
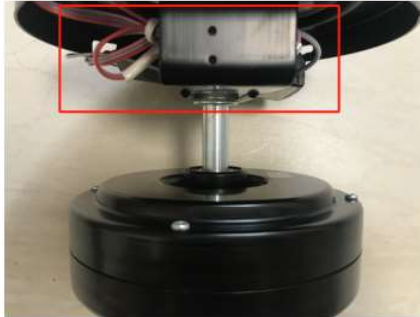
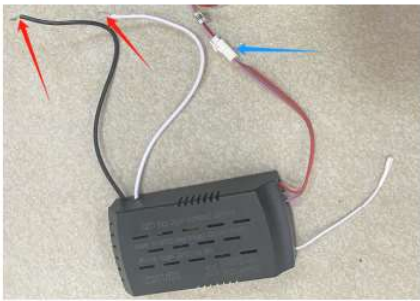

3. Motor Shell assembly

Find 4 small pillar inside the motor shell

Rotate the motor shell in clockwise direction, buckle up the pillar into 4 ceiling bracket indentation.

Motor shell cover the ceiling bracket and the motor



Installing fan blades

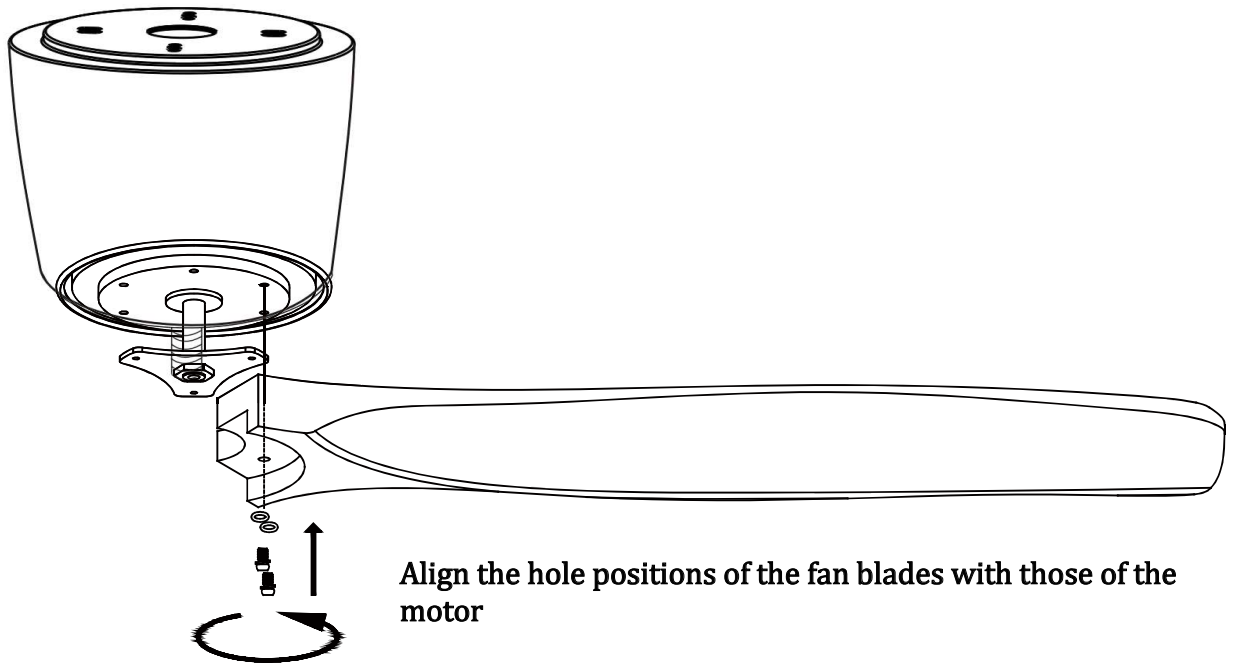

Please confirm that all blades are in correct places and tightly screwed.

Installing Lamp

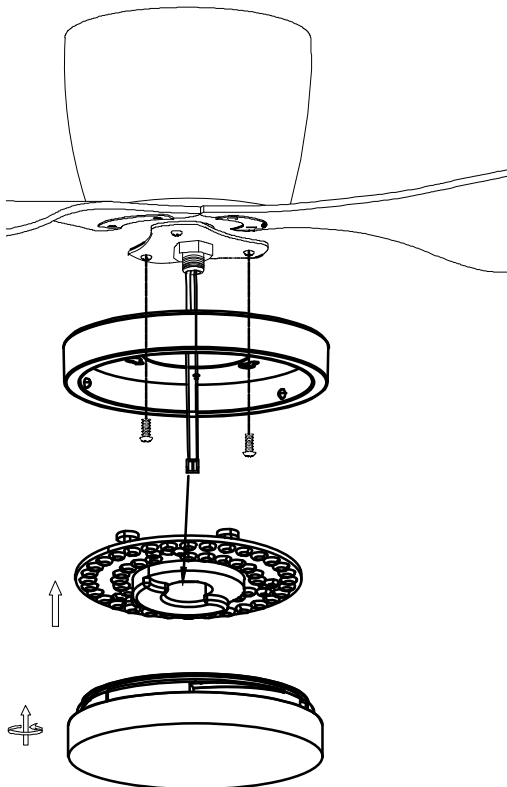

- 1.Remove the screws on the motor bracket.
- 2.Align the holes on the light board with the motor bracket.
- 3.Pass the motor light plug through the central hole of the motor.
- 4.Insert and tighten screws to secure the motor bracket.
- 5.Connect the plugs and attach the LED Source to the light panel.
- 6.Place the Acrylic Lampshade and rotate until secure.

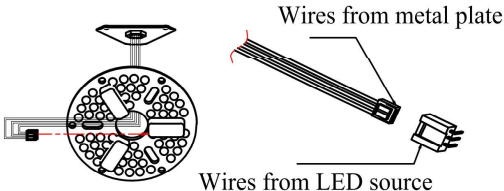

Operating instructions

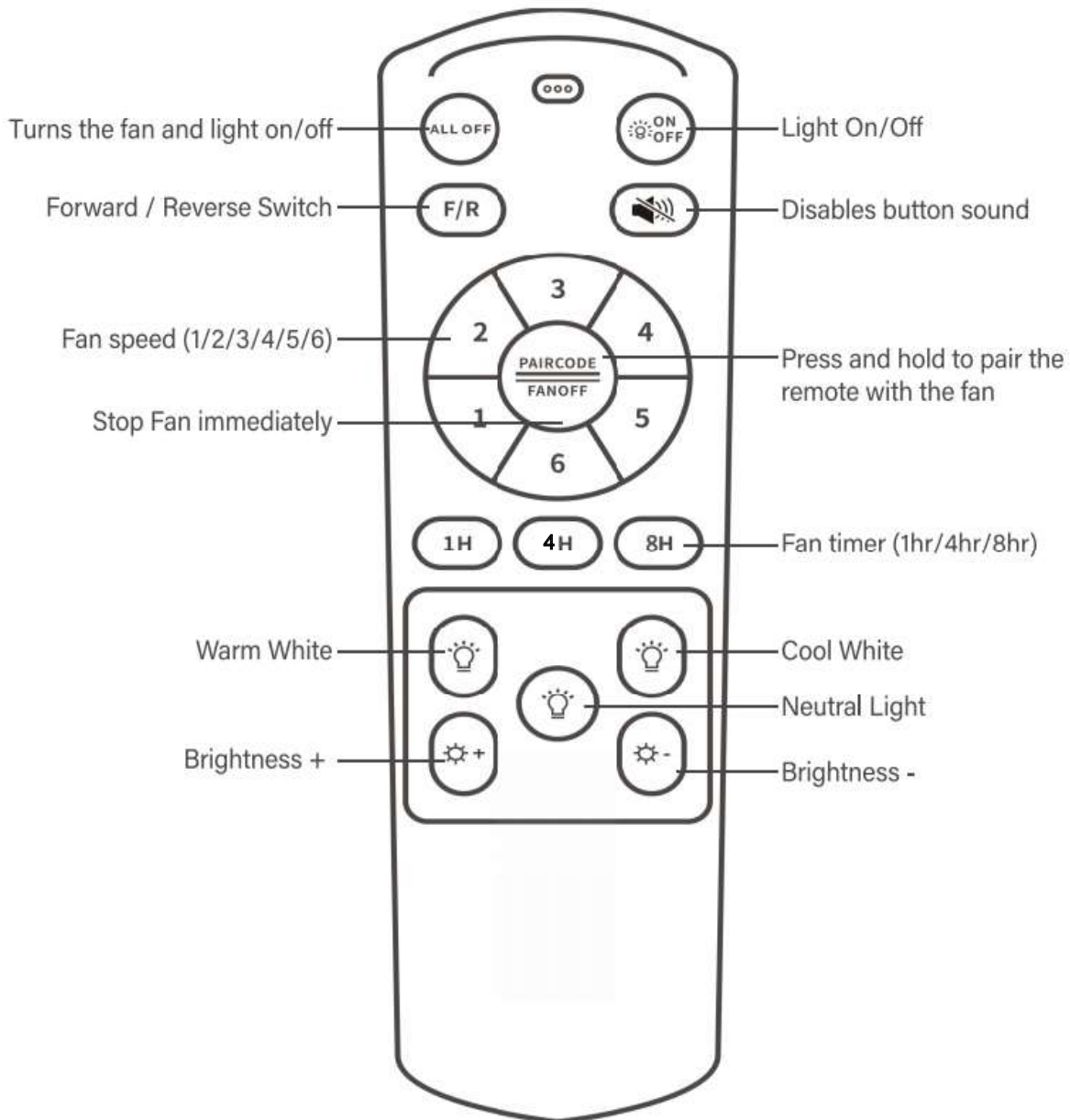

Using AAA 1.5V x2 battery (not included)

When the remote control cannot control the fan light, you can use the following Method to code:

First turn off the power switch (wall or main switch), then turn it back on, after 10 seconds. Once you see the light on, immediately press and hold the "PAIRCODE FAN OFF" button the remote control for 5 seconds to start the fan.

APP OPERATION

Step 1: Download the APP: open the browser→select the version to download.

Step 2: Open the APP→select a room→Click on (+) →select "fan light" →enter the equipment name (such as fan light)→OK

Step 3: Click on (☰) enter

Step 4: Pair code with the app.

a. Click the buttons within 5 seconds when the light turn on, if the light flashes/when you hear a beep, it means the fan and app successfully paired. (APP Control Distance: within 65ft (20m))

b. The previous phone will jump out automatically if the next phone is paired successfully.

APP button function description:



Pairing Button



Timer Setting Mode



Natural Wind Mode



Sleep Wind Mode



The fan reverses to distribute warm air in the room.



The fan rotates forward.



White light



Natural light



Warm light



Night light, 10% brightness.

Adjust Fan Speed

Adjust Light Brightness

Adjust Light CCT

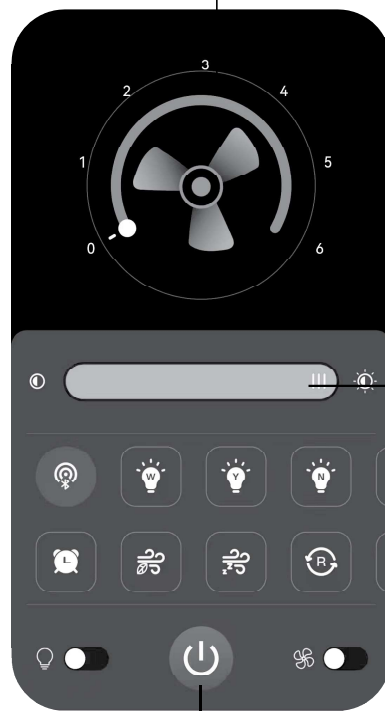

Power Switch

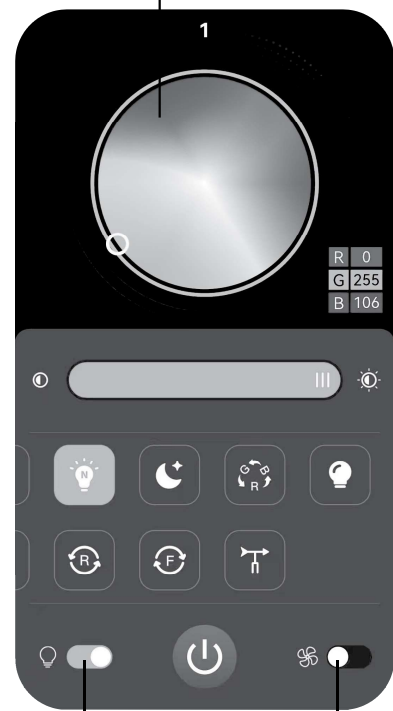

Light Switch

Fan Switch

Does not apply to these function follow:

