

## TOOLS REQUIRED



Allen Wrench

(Included)



2 - People  
Recommended

## ASSEMBLY RATING

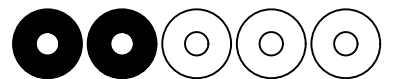

EASY —————> DIFFICULT

The Assembly Rating is a 5-point system showing the level of effort needed to assemble a specific product.

# CHAIR



- Please keep instructions for future reference.
- Check the quantity and irregularity of parts and hardware before you start.

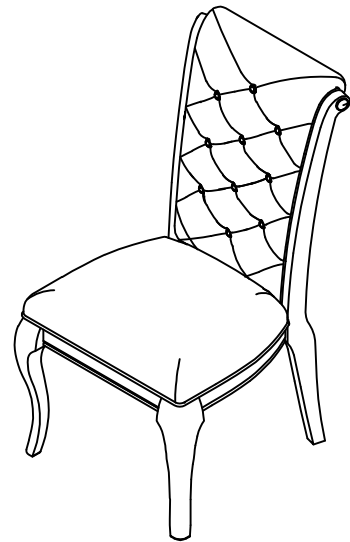

## PARTS

#1 1pcx2

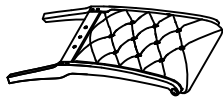

Chair Back

#2 1pcx2

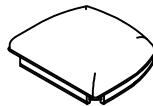

Cushion Seat

#3 2pcsx2



Front Leg

## HARDWARE

#A 2pcsx2



Bolt  $\text{\O}1/4" \times 1-1/2"$

#B 4pcsx2



Bolt  $\text{\O}1/4" \times 2-3/8"$

#C 4pcsx2



Bolt  $\text{\O}1/4" \times 3"$

#D 10pcsx2



Lock Washer  $\text{\O}1/4"$

#E 10pcsx2



Flat Washer

#F 1pcx2

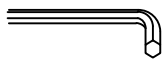

Allen Wrench

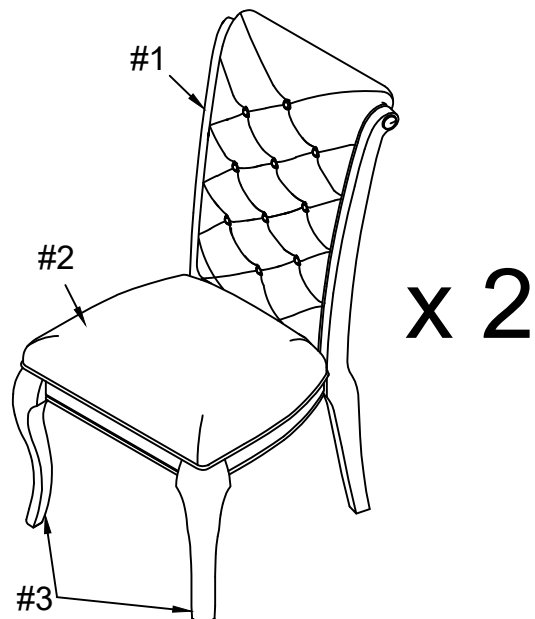

# ASSEMBLY INSTRUCTIONS

## 1

- Parts #1 x 1pc
- Parts #2 x 1pc
- Hardware #A x 2pcs
- Hardware #D x 2pcs
- Hardware #E x 2pcs

1. place the backrest w/legs (#1) onto a protected surface.

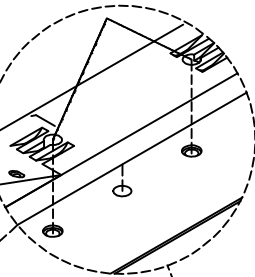
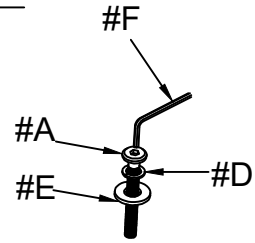
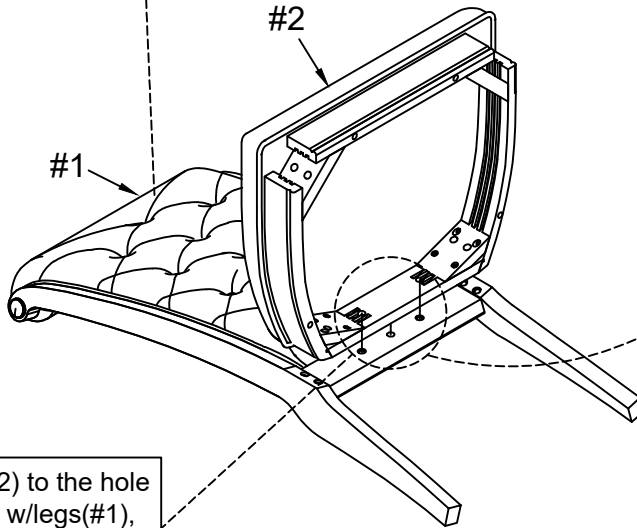

3. Align the seat (#2) to the hole along the backrest w/legs (#1), then insert the bolt assembly. Secure using the Allen wrench.

2. Prepare a bolt assembly by first inserting a lock washer (#D) onto the bolt (#A) then a flat washer (#E) onto that same bolt (#A)

## 2

- Hardware #C x4pcs
- Hardware #D x4pcs
- Hardware #E x4pcs

1. Prepare 4 bolt assemblies by first inserting a lock washer (#D) onto the bolt (#C) then a flat washer (#E) onto that same bolt (#C)

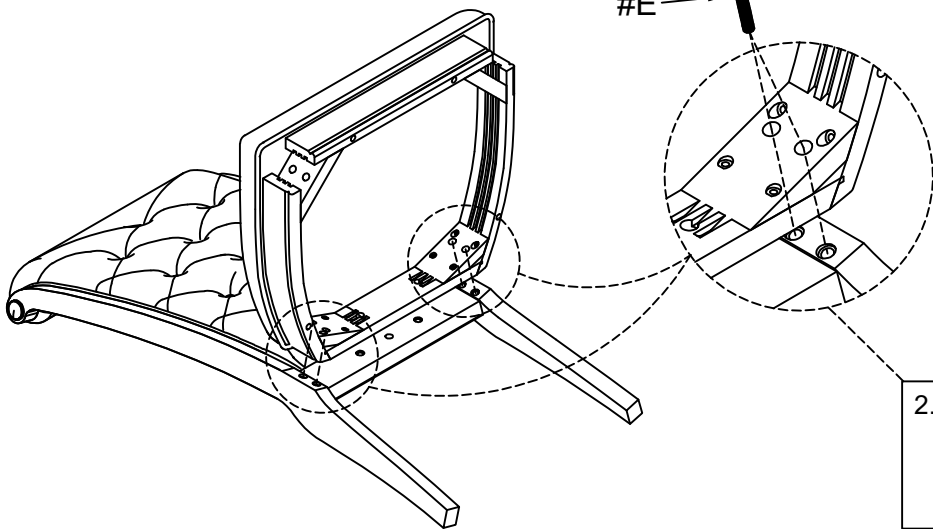

2. Insert 2 bolt assemblies into each back corner of the seat (#2), Secure using the Allen wrench.

# ASSEMBLY INSTRUCTIONS

## 3

1. prepare 4 bolt assemblies by first inserting a lock washer (#D) onto the bolt (#B) then a flat washer (#E) onto that same bolt (#B).

Hardware (#B) x4pcs

Hardware (#D) x4pcs

Hardware (#E) x4pcs

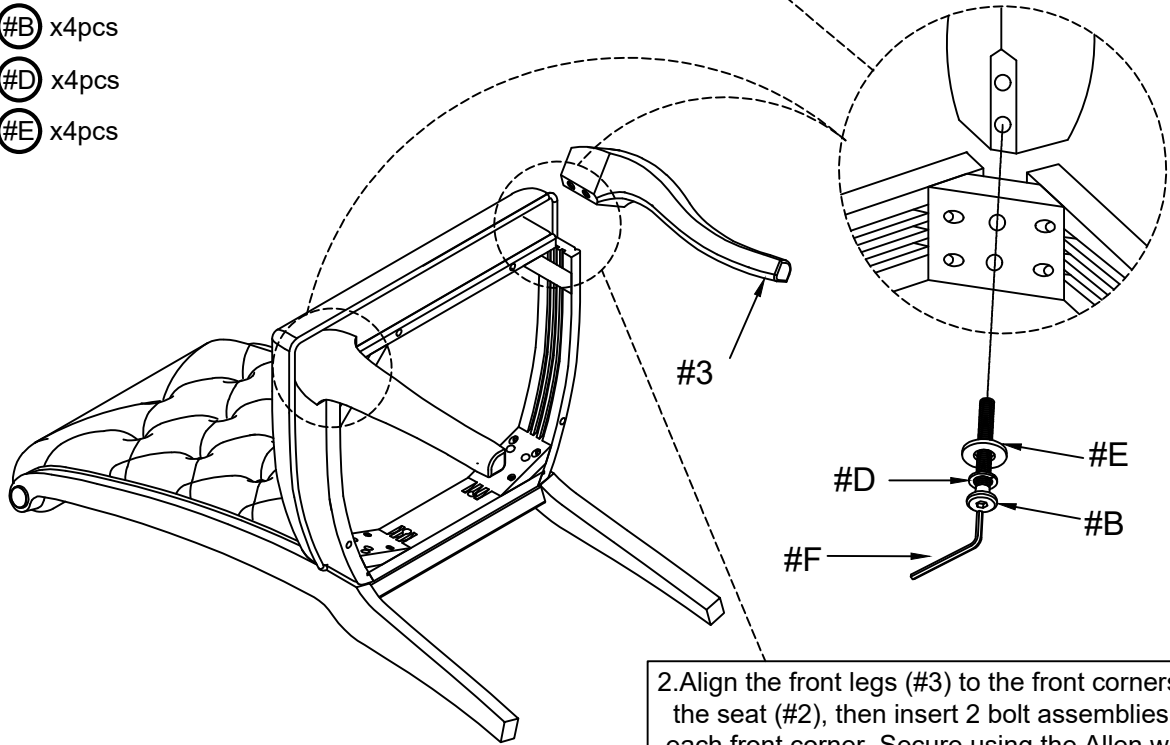

2. Align the front legs (#3) to the front corners of the seat (#2), then insert 2 bolt assemblies into each front corner. Secure using the Allen wrench.

## 4

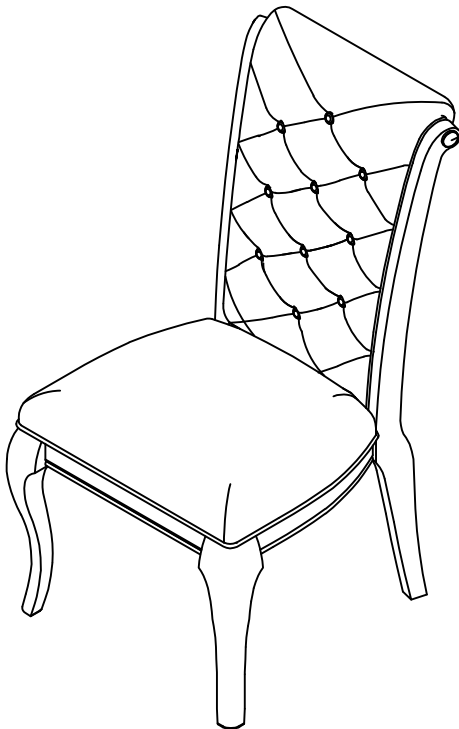

## ASSEMBLY COMPLETED



Please ensure the furniture rests on an even and flat surface. If the product wobbles or feels loose, double-check all bolts and/or screws are properly tightened and secured.



### Keep this handy!

Please retain this instruction manual and any order-related information for future reference.



### Lift, don't drag!

To avoid damage to product please always LIFT the product when transporting or adjusting the placement.