

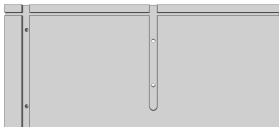

C990476-101 ASSEMBLY INSTRUCTIONS

Parts:

(2) Sides



(2) Doors



Backsplash



Back

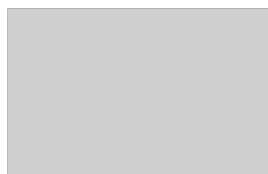

Top



Bottom

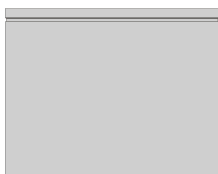

Shelf



(2) Magnets



(2) Magnetic Catches

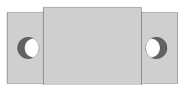

(14) Hex Screws



Allen Wrench



(4) Handle Screws (16) Small Screws



(2) Red Handles (4) Magnetic Screws



Phillips Head Screwdriver
(Not Included)

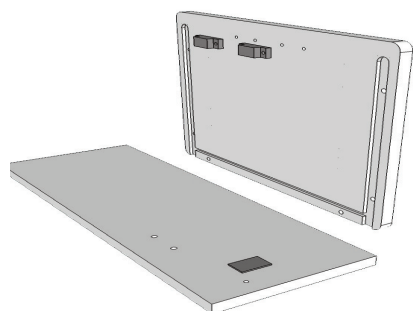

Step 1: Step 1: Attach magnetic hardware to underside of Top Piece (dados side) and inside top of Doors using pre-drilled holes. Magnets that are inside plastic case going underneath Top piece must be facing outward, away from center of Top Piece. **Magnet Catches** use a **Small Screw** and **Magnets** use **Magnet Screws**.

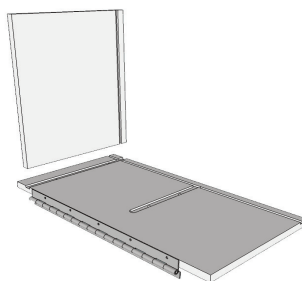

Step 2: Insert edge of **Bottom**, with Bottom groove facing upwards in direction of hinge, into mortise of **Side**. Align Bottom groove and Side back groove. Insert hex screws into each of the pre-drilled holes in **Side**.

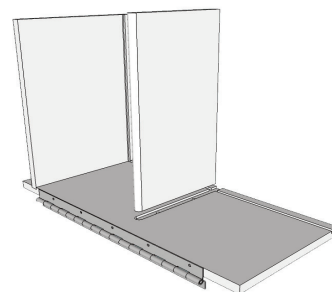

Step 3: Insert edge of **Shelf** into mortise of **Side**. Align back of Shelf with front edge of Side back groove. Front edge of shelf is rounded and when inserted, is edge closest to hinge. Insert hex screws into each of the pre-drilled holes in **Side**.

For assistance, call: Customer Service 1-800-247-8465



C990476-101 ASSEMBLY INSTRUCTIONS

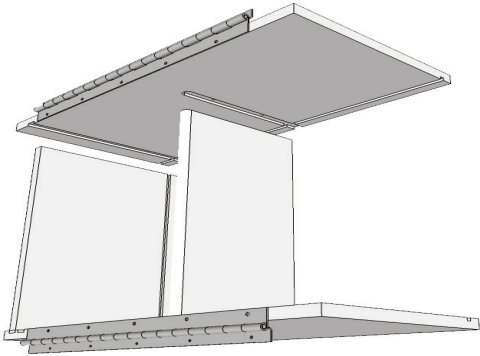

Step 4: Insert edges of second **Side** into edges of **Bottom** and **Shelf**. Make sure back groove of **Side** and **Bottom** groove are aligned, as completed in Step 2. Insert hex screws into pre-drilled holes in **Side**.

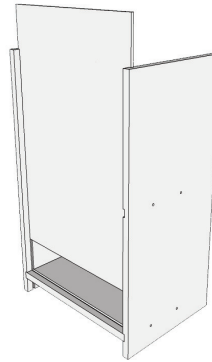

Step 5: Slide **Back** piece into back grooves of **Side** pieces and slide downward until **Back** sits in groove of **Bottom** piece.

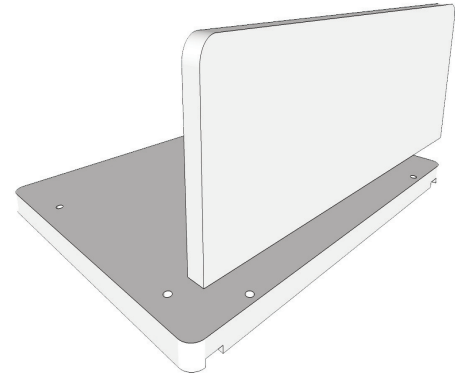

Step 6: Align holes in **Backsplash** with holes in **Top** piece. Insert hex screws into each of pre-drilled holes in underside of **Top** piece, screwing upwards into **Backsplash**. Tighten screws.

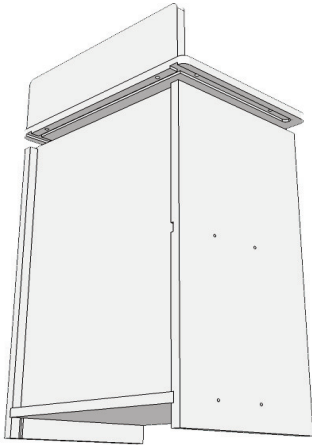

Step 7: Insert remaining edges of **Sides** and **Back** piece into grooves of **Top** piece. Insert hex screws into each of the pre-drilled holes in **Top** piece.

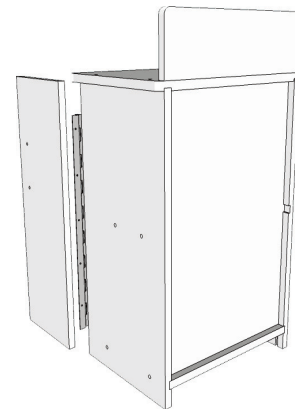

Step 8: Install **Door** to hinge pre-installed to **Side**. Use (8) **Small Screws** to screw **Door** to hinge using pre-drilled holes in door. Make sure handle holes are towards center of cabinet. Repeat for remaining door.

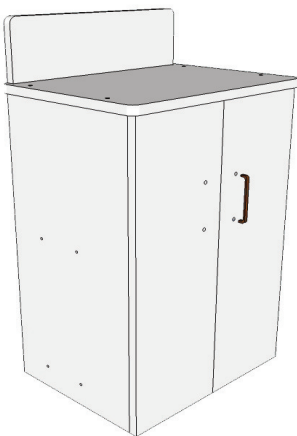

Step 9: Insert **Handle Screw** from back of door into the **Handle** and tighten. Repeat for remaining **Door**.



Step 10: Tighten all screws snugly. **DO NOT OVERTIGHTEN. DO NOT DRILL. Assembly is now complete.**

For assistance, call: Customer Service 1-800-247-8465



C990476-102 ASSEMBLY INSTRUCTIONS

Parts:

(2) Sides

(2) Doors

Backsplash

(14) Hex Screws

Allen Wrench



(4) Handle Screws

(16) Small Screws



(2) Red Handles



(4) Magnet Screws



Phillips Head Screwdriver
(Not Included)



Faucet Set Includes:

(2) 1" screw for faucet



(2) 3/4" screw for faucet



Faucet Set

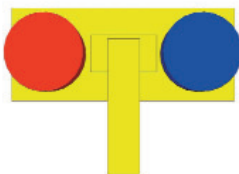

Sink Tray



(2) Magnets



(2) Magnet Catches

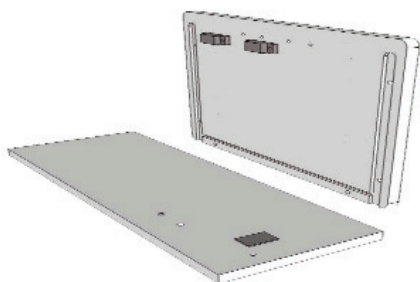

Step 1: Step 1: Attach magnetic hardware to underside of Top Piece (dados side) and inside top of Doors. Magnets that are inside plastic case going underneath Top piece must be facing outward, away from center of Top Piece. **Magnet Catches** use a **Small Screw** and **Magnets** use **Magnet Screws**.

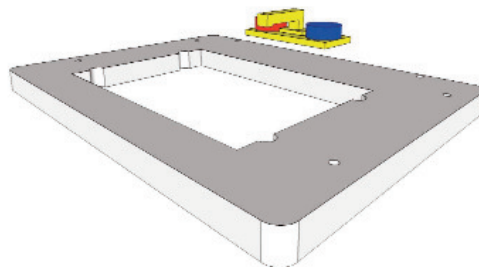

Step 2: Attach **Faucet** assembly to top side of **Top** piece.

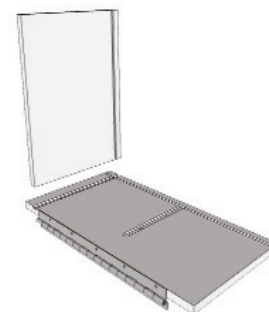

Step 3: Insert edge of **Bottom**, with Bottom groove facing upwards in direction of hinge, into mortise of **Side**. Align Bottom groove and Side back groove. Insert hex screws into each of the pre-drilled holes in **Side**.

For assistance, call: Customer Service 1-800-247-8465



C990476-102 ASSEMBLY INSTRUCTIONS

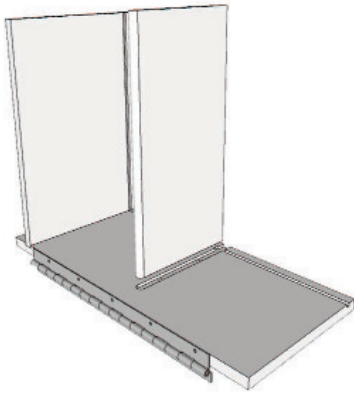

Step 4: Insert edge of **Shelf** into mortise of **Side**. Align back of Shelf flush with front edge of Side back groove. Front edge of shelf is rounded and when inserted, is edge closest to hinge. Insert hex screws into each of the pre-drilled holes in **Side**.

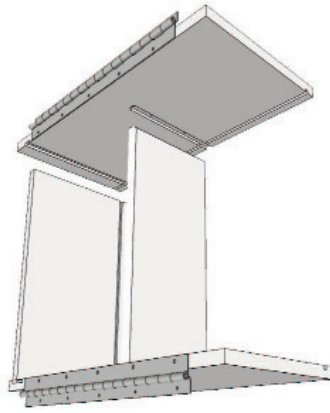

Step 5: Insert edges of second **Side** into edges of **Bottom** and **Shelf**. Make sure back groove of Side and Bottom groove are aligned, as completed in Step 2. Insert hex screws into pre-drilled holes in **Side**.

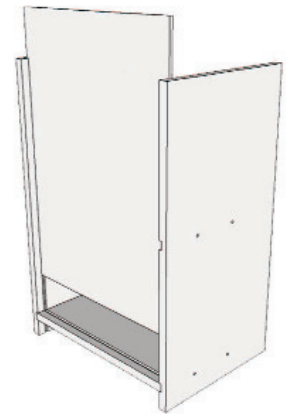

Step 6: Slide **Back** piece into back grooves of **Side** pieces and slide downward until **Back** sits in groove of **Bottom** piece.

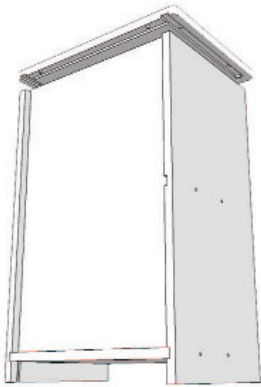

Step 7: Insert remaining edges of **Sides** and **Back** piece into grooves of **Top** piece. Insert hex screws into each of the pre-drilled holes in **Top** piece.

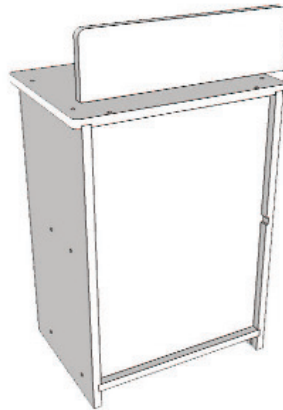

Step 8: Align holes in **Backslash** with holes in **Top** piece. Insert hex screws into each of pre-drilled holes in underside of **Top** piece, screwing upwards into **Backslash**.

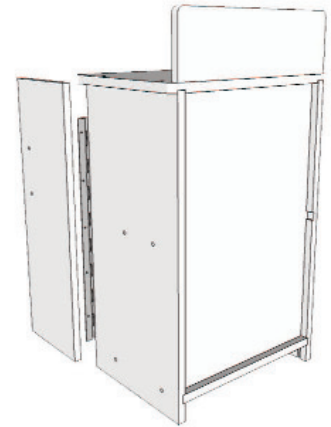

Step 9: Install **Door** to hinge pre-installed to **Side** using **Small Screws**. Repeat for remaining door. Make sure handle holes are towards center of cabinet.

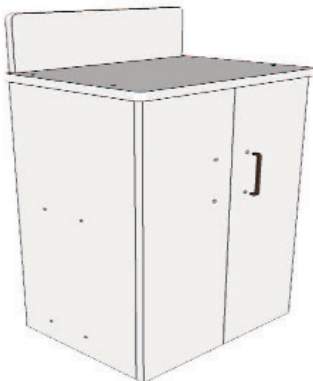

Step 10: Insert **Handle Screw** from back of door into the **Handle** and tighten. Repeat for remaining Door.



Step 11: Insert **Tray** into cutout of **Top** piece.



Step 12: Tighten all screws snugly. DO NOT OVERTIGHTEN. DO NOT DRILL. **Assembly is now complete.**

For assistance, call Customer Service 1-800-247-8465



C990476-104 ASSEMBLY INSTRUCTIONS

Parts:

(2) Sides



Back 1/4" Thick



(2) Doors



Top



(2) Magnets



Bottom

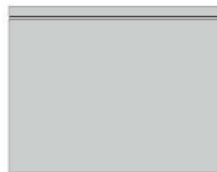

(2) Magnetic Catches



(2) Shelf



(16) Hex Screws



Allen Wrench



(4) Handle Screws



(22) Small Screws



(2) Red Handles



(4) Magnet Screws



Phillips Head Screwdriver
(Not Included)

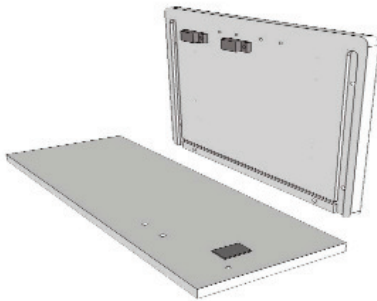

Step 1: Attach magnetic hardware to underside of **Top** Piece (dados side) and inside top of **Doors** using pre-drilled holes. Magnets that are inside plastic case going underneath Top piece must be facing outward, away from center of Top Piece. **Magnet Catches** use a **Small Screw** and **Magnets** use **Magnet Screws**.

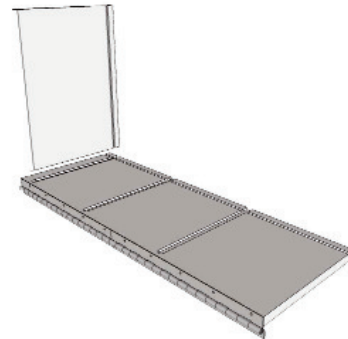

Step 2: Insert edge of **Bottom**, with Bottom groove facing upwards in direction of hinge, into mortise of **Side**. Align Bottom groove and Side back groove. Insert hex screws into each of the pre-drilled holes in **Side**.

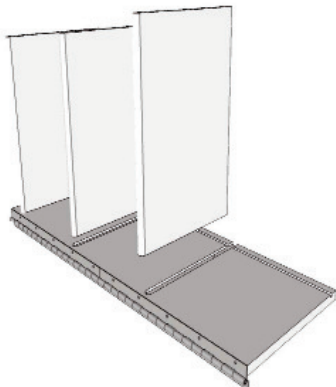

Step 4: Insert edge of **Shelf** into mortise of **Side**. Align back of Shelf flush with front edge of Side back groove. Front edge of shelf is rounded and when inserted, is edge closest to hinge. Insert hex screws into each of the pre-drilled holes in **Side**.

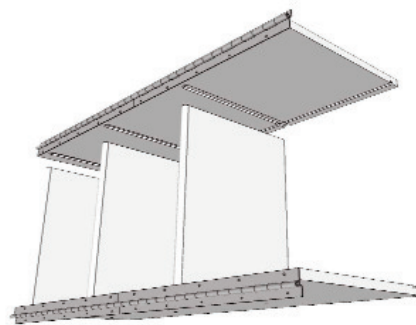

Step 4: Insert edges of second **Side** into edges of Bottom and Shelf. Make sure back groove of Side and Bottom groove are aligned, as completed in Step 2. Insert hex screws into pre-drilled holes in **Side**.

For assistance, call: Customer Service 1-800-247-8465



C990476-104 ASSEMBLY INSTRUCTIONS

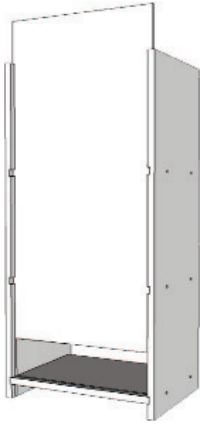

Step 6: Slide **Back** piece into back grooves of **Side** pieces and slide downward until Back sits in groove of **Bottom** piece.

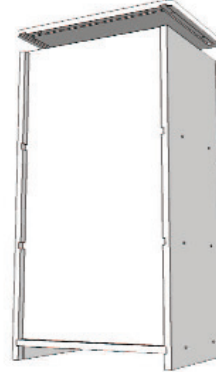

Step 7: Insert remaining edges of **Sides** and **Back** piece into grooves of **Top** piece. Insert hex screws into each of the pre-drilled holes in **Top** piece.

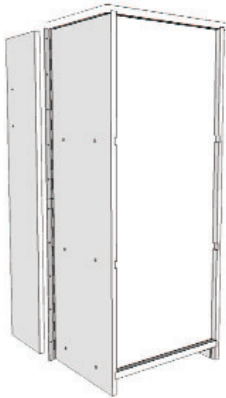

Step 9: Install **Door** to hinge pre-installed to **Side** using **Small Screws** into pre-drilled holes in door. Repeat for remaining door. Make sure handle holes are towards center of cabinet.



Step 10: Insert **Handle Screw** from back of door into the **Handle** and tighten. Repeat for remaining Door.



Step 12: Tighten all screws snugly. DO NOT OVERTIGHTEN. DO NOT DRILL. **Assembly is now complete.**

For assistance, call Customer Service: 1-800-247-8465



C990476-207 ASSEMBLY INSTRUCTIONS

Parts:

(2) Sides

(2) Doors

Hutch Assembly

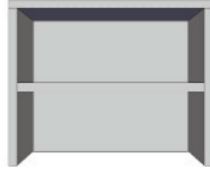

Back 1/4" Thick

Top

Bottom

Shelf



(2) Magnets

(2) Magnetic Catches



(14) Hex Screws

Allen Wrench



(4) Handle Screws

(16) Small Screws



(2) Red Handles

(4) Magnetic Screws



Phillips Head Screwdriver
(Not Included)

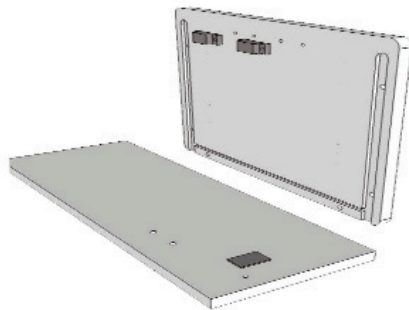

Step 1: Step 1: Attach magnetic hardware to underside of Top Piece (dados side) and inside top of Doors using pre-drilled holes. Magnets that are inside plastic case going underneath Top piece must be facing outward, away from center of Top Piece. **Magnet Catches** use a **Small Screw** and **Magnets** use **Magnet Screws**.

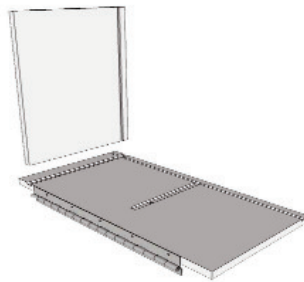

Step 2: Insert edge of **Bottom**, with Bottom groove facing upwards in direction of hinge, into mortise of **Side**. Align Bottom groove and Side back groove. Insert hex screws into each of the pre-drilled holes in **Side**.

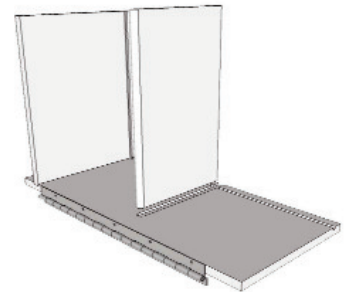

Step 3: Insert edge of **Shelf** into mortise of **Side**. Align back of Shelf flush with front edge of Side back groove. Front edge of shelf is rounded and when inserted, is edge closest to hinge. Insert hex screws into each of the pre-drilled holes in **Side**.

For assistance, call: Customer Service 1-800-247-8465



C990476-207 ASSEMBLY INSTRUCTIONS

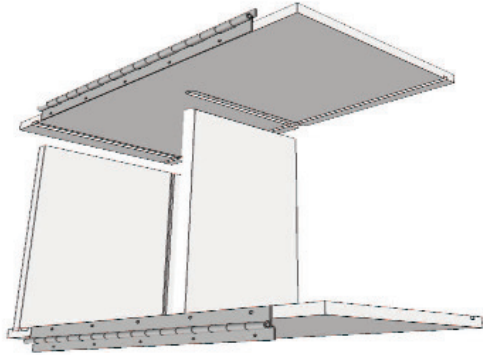

Step 4: Insert edges of second **Side** into edges of **Bottom** and **Shelf**. Make sure back groove of **Side** and **Bottom** groove are aligned, as completed in Step 2. Insert hex screws into pre-drilled holes in **Side**.

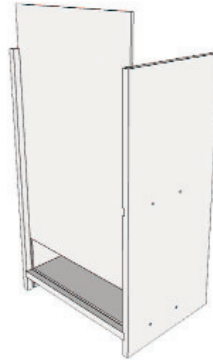

Step 5: Slide **Back** piece into back grooves of **Side** pieces and slide downward until **Back** sits in groove of **Bottom** piece.

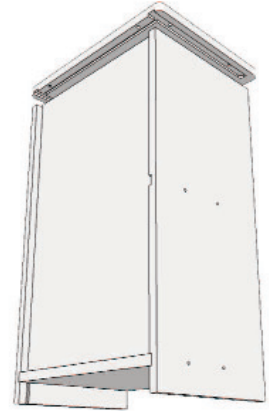

Step 6: Insert remaining edges of **Sides** and **Back** piece into grooves of **Top** piece. Insert hex screws into each of the pre-drilled holes in **Top** piece.

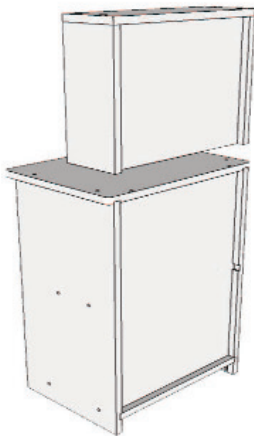

Step 7: Align holes in **Hutch Assembly** with holes in **Top** piece. Insert hex screws into each of pre-drilled holes in underside of **Top** piece, screwing upwards into **Hutch Assembly**. Tighten screws.

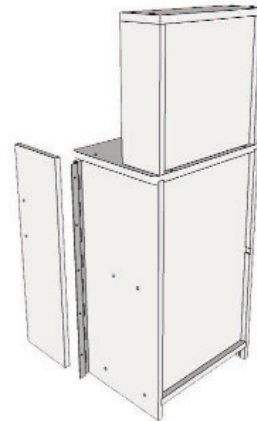

Step 8: Install **Door** to hinge pre-installed to **Side** using **Small Screws** into pre-drilled holes. Repeat for remaining door. Make sure handle holes are towards center of cabinet.

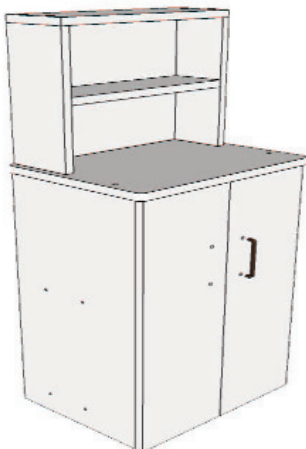

Step 9: Insert **Handle Screw** from back of door into the **Handle** and tighten. Repeat for remaining Door.

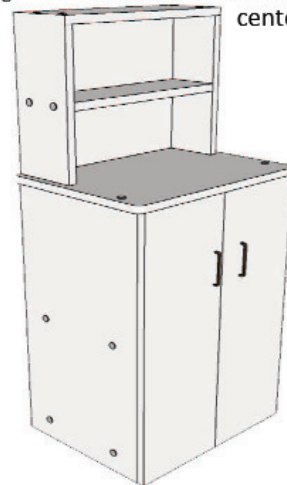

Step 10: Tighten all screws snugly. DO NOT OVERTIGHTEN. DO NOT DRILL. Assembly is now complete.

For assistance, call: Customer Service 1-800-247-8465