

Chair

IMPORTANT

Carefully remove all the parts from the carton and place them individually on a soft cloth to prevent scratches or other damage.

Carefully and strictly follow these assembly instructions to ensure a completed product as designed.

Do not use power tools above 8 volts to assemble.



Part List

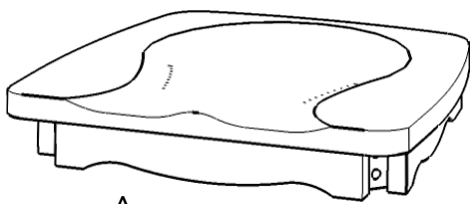

A.
Seat
1 pc.

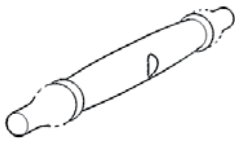

B.
Side Stretcher
2 pcs.



C.
Center Stretcher
1 pc.



D.
Leg
1 pc.



E.
Leg
1 pc.

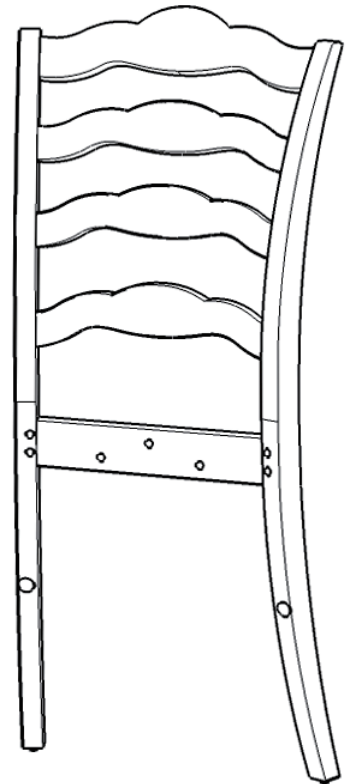

F.
Back Frame
1 pc.

Hardware List



Hex Wrench
1 pc.



Spring Washer
11 pcs. (+1 extra)

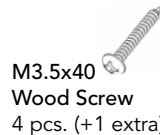

M3.5x40
Wood Screw
4 pcs. (+1 extra)



M6x50
Head Cap Bolt
4 pcs. (+1 extra)



Small Hex Wrench
1 pc.



Flat Washer
11 pcs. (+1 extra)

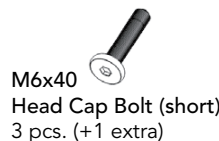

M6x40
Head Cap Bolt (short)
3 pcs. (+1 extra)



M6x70
Head Cap Bolt (long)
4 pcs. (+1 extra)

Tool(s) required for assembly: Phillips screwdriver

Assembly Instructions 2/3

IMPORTANT

- Use a soft cloth between these parts and the floor.
- Do not use power tools above 8 volts to assemble.
- Do not tighten all the bolts until each part is properly assembled.
- Keep Hex Wrench as the bolts may need to be tightened in the future.

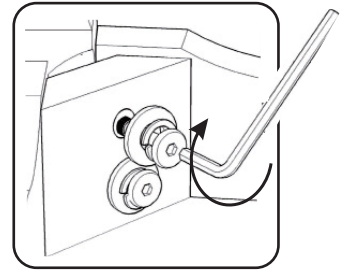
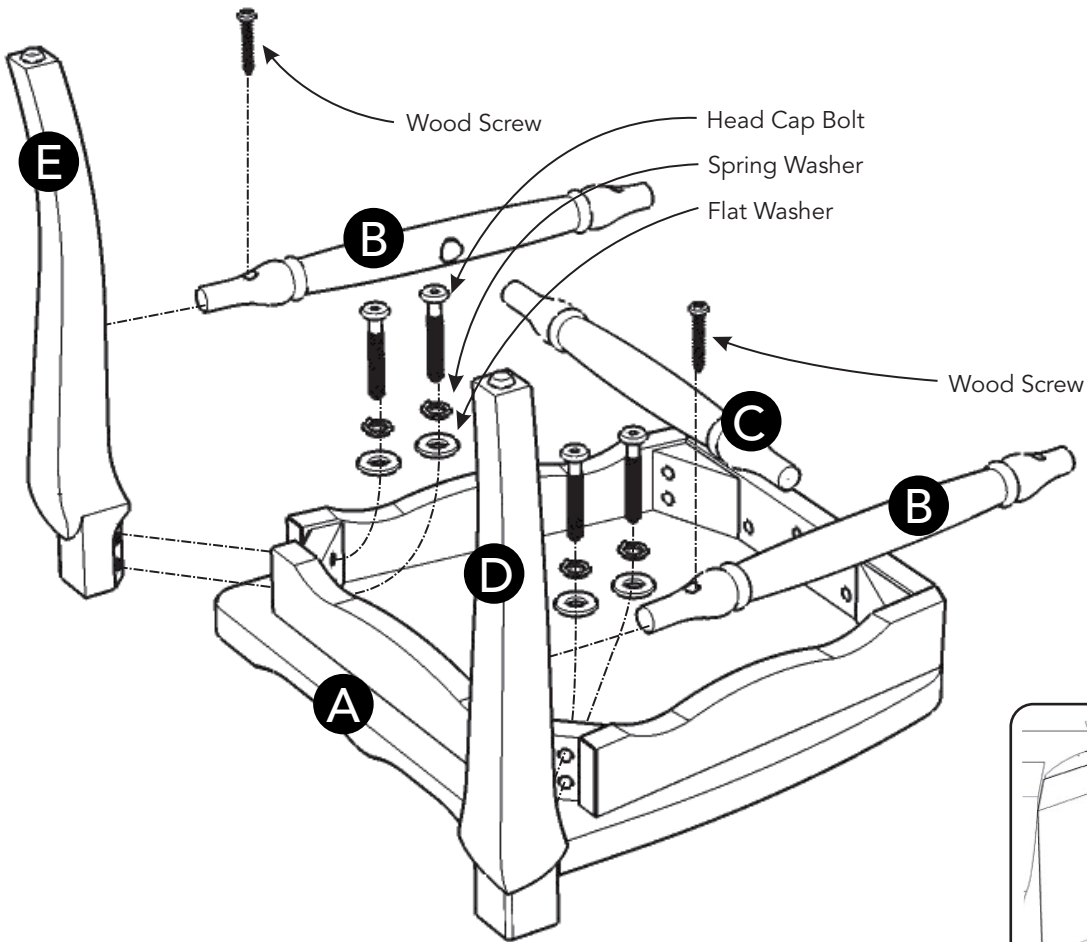

Figure 1

STEP 1

Attach Legs (D) and (E) to Seat (A) with Flat Washers, Spring Washers and Head Cap Bolts, tightening bolts only halfway.

(See Figure 1)

Attach Side Stretchers (B) to Legs (D) and (E) with Wood Screws.

(See Figure 2)

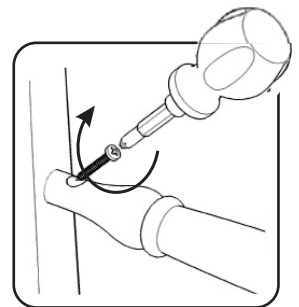

Figure 2

Slide ends of Center Stretcher (C) into pre-drilled holes in middle of Side Stretchers (B).

(See Figure 3)

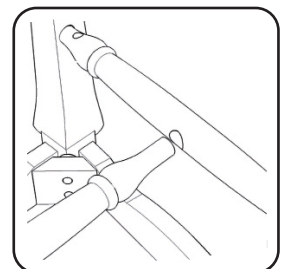
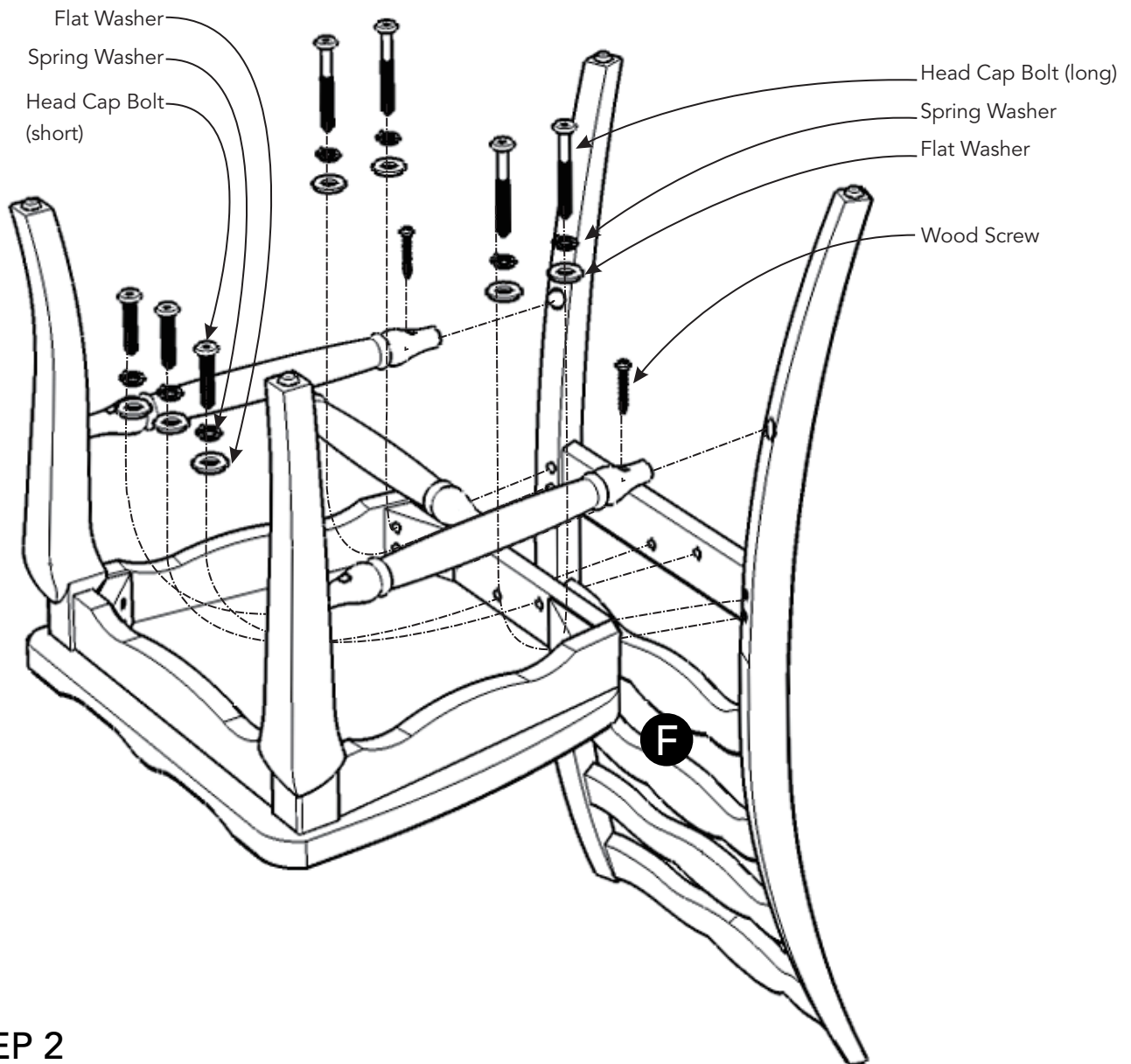

Figure 3

Assembly Instructions 3/3



STEP 2

Attach Back Frame (F) to unit with Flat Washers, Spring Washers, Head Cap Bolts (short) and Head Cap Bolts (long), tightening bolts only halfway. (See Figures 4 and 5)

Tighten all Head Cap Bolts used in Steps 1 and 2.

Attach Back Frame (F) to unit with Wood Screws.

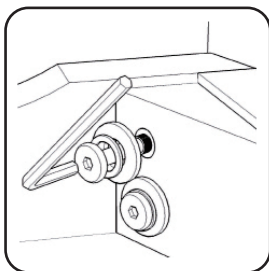

Figure 4

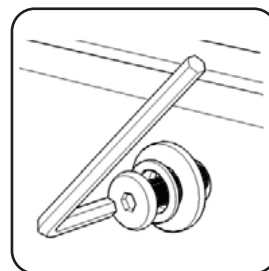

Figure 5