

# CHANDELIER

---

## Lighting Fixtures Safety & Core Instructions

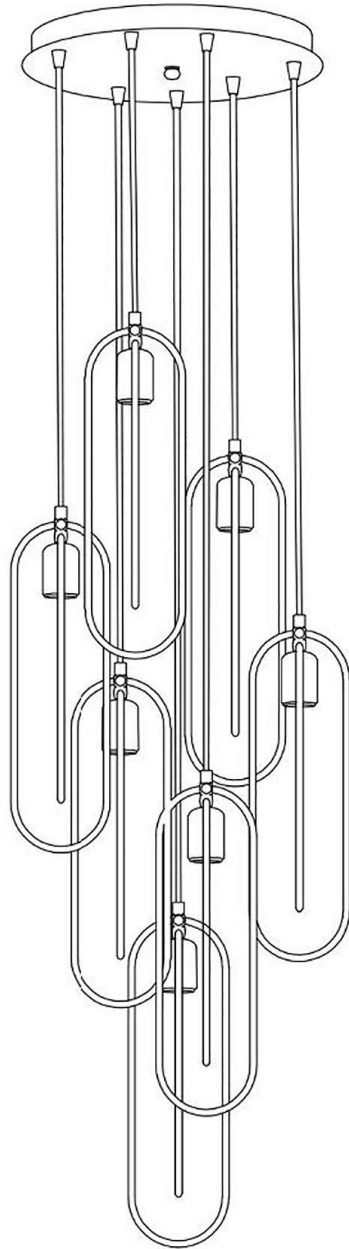

**Before You Begin ...**

- In some countries electrical installation work may only be carried out by an authorised electrical contractor. Contact your local electricity authority for advice.
- Unpack all components onto a flat surface that will not damage them or allow them to become dirty.
- Take extra care when handling glass parts, if there is any.
- Check that all the components are correct and present.
- Contact with the seller in case of a defective or damaged product.
- Familiarise yourself with the product, its component parts and how it is assembled.
- Keep all packaging until after a successful installation and retain the instructions for future reference.

**Environment**

- Use appropriate recycling bins to get rid of the packaging materials.
- Always prefer LED bulbs to save energy.

# ACCESSORY LIST

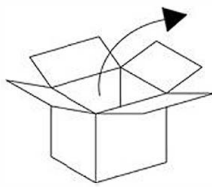
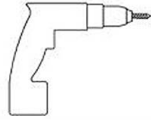
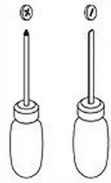

A1  
x1

A2  
x1

B  
x1

C1  
x2

C2  
x2

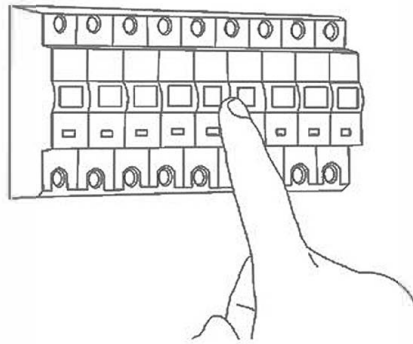

1

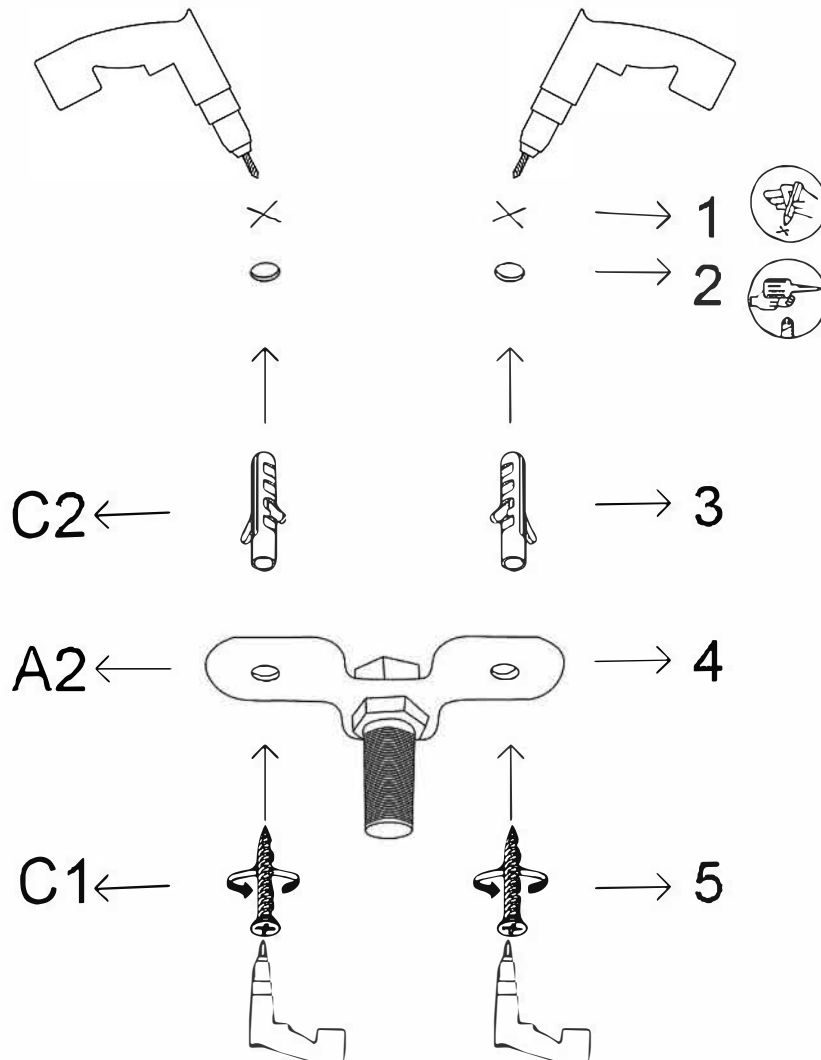

2

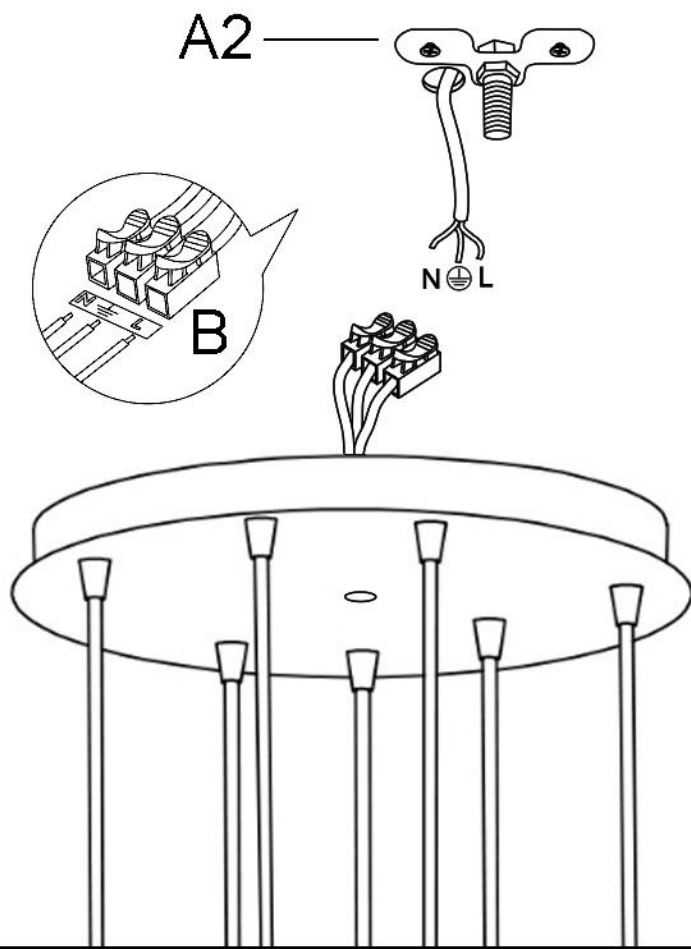

3

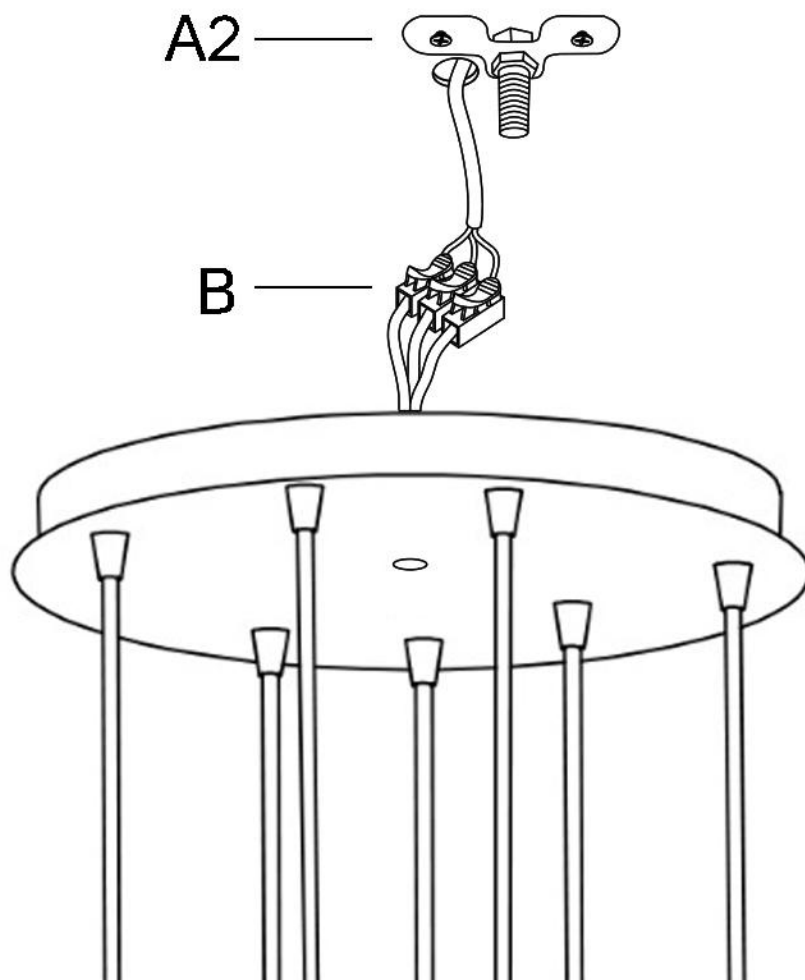

4

