

BOARD IDENTIFICATION

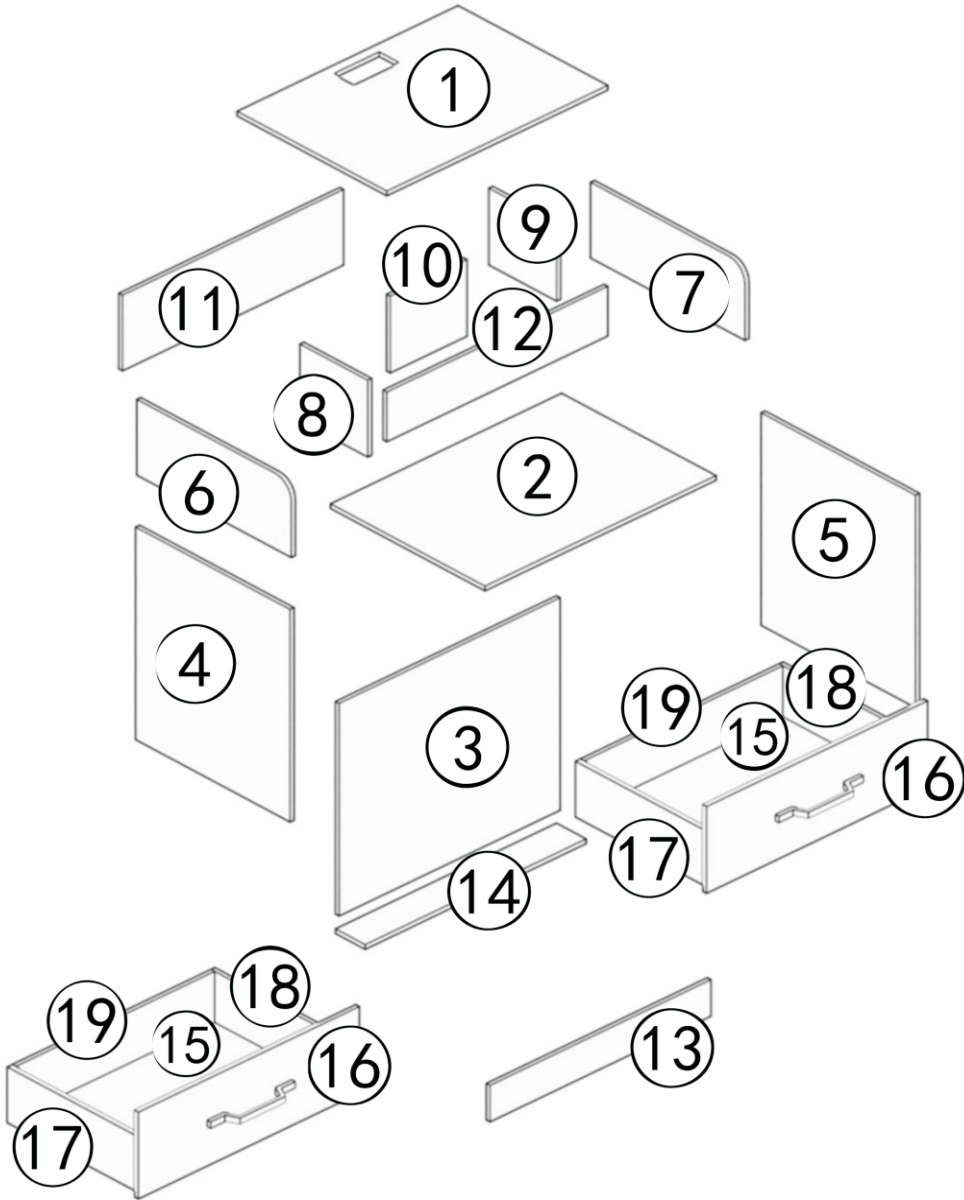

Part List

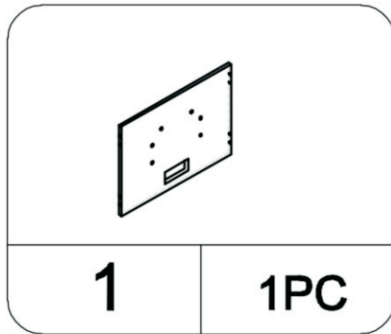

Top Board

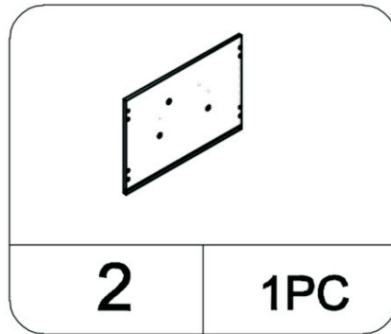

Board

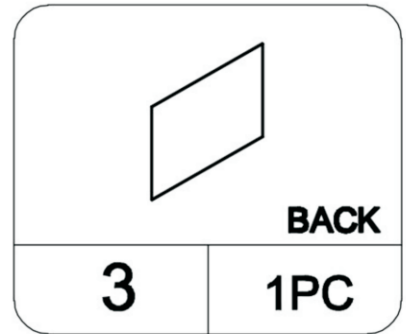

BACK

Back Board

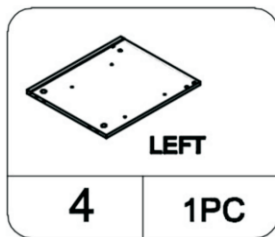

Left Board

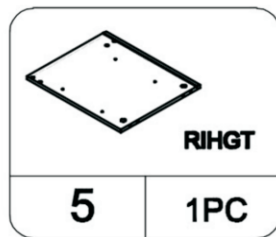

Right Board

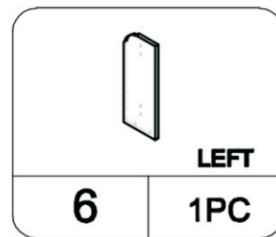

Left Board

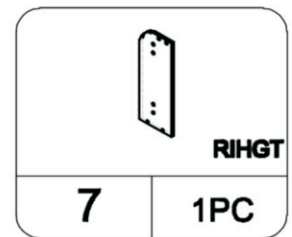

Right Board

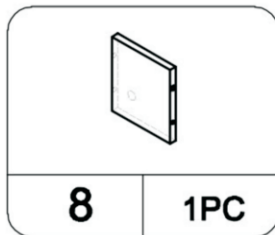

Left Middle Board

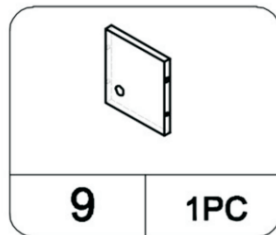

Right Middle Board

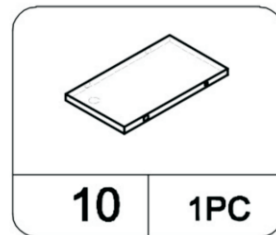

Front Middle Board

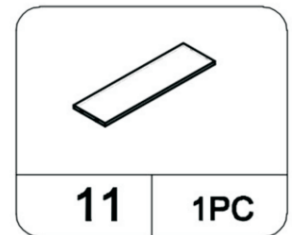

Back Board

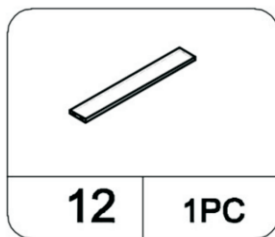

Front Middle Batten

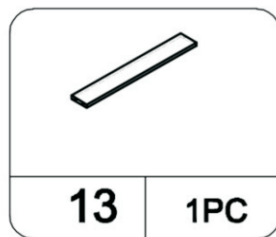

Bottom Batten

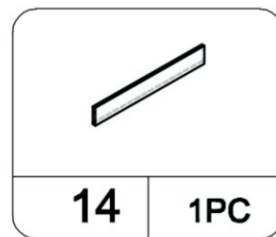

Back Batten

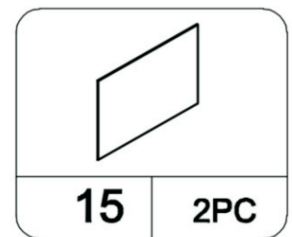

Back Board

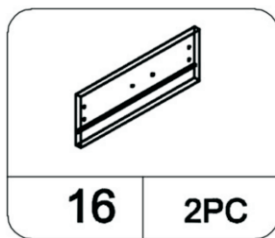

Drawer Front board

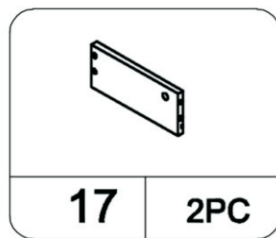

Drawer left board

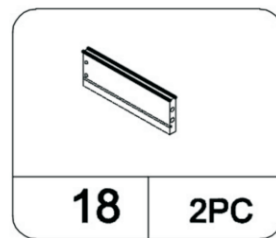

Drawer right board

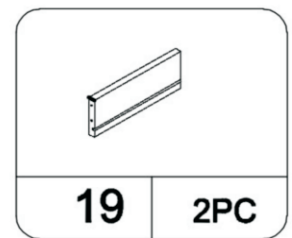

Drawer Back board

Hardware List



A **11PC**

CAM BOLT



B **11PC**

CAM LOCK



Ø6*30mm

C **26PC**

WOODEN PEG



Ø4*30mm

D **23PC**

SCREW

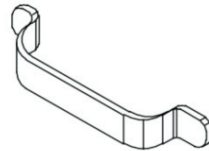

E **2PC**

HANDLE



M4*15mm

F **4PC**

SCREW

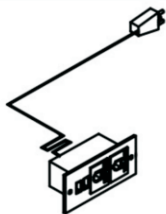

G **1PC**

USB

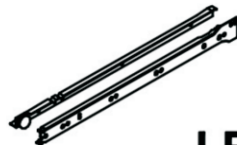

LEFT

H **2PC**

LEFT RAIL



RIGHT

I **2PC**

RIGHT RAIL



Ø3.*12mm

J **18PC**

SCREW

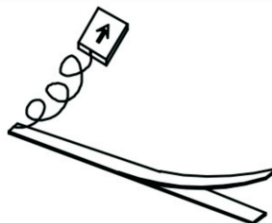

K **1PC**

LIGHT STRIP



L **12PC**

WASHERS

STEP 1

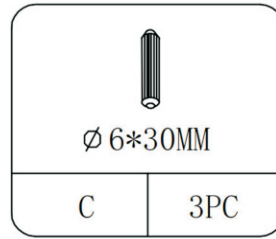
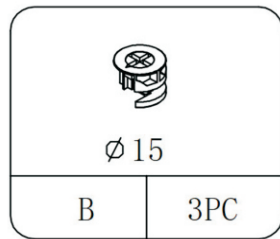
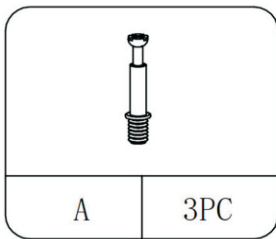

Insert (C) into part (1). Attach cam bolt (A) to part (1) with screwdriver.

Attach part (1) to part (8,9,10). Then use attach part (B) to lock them.

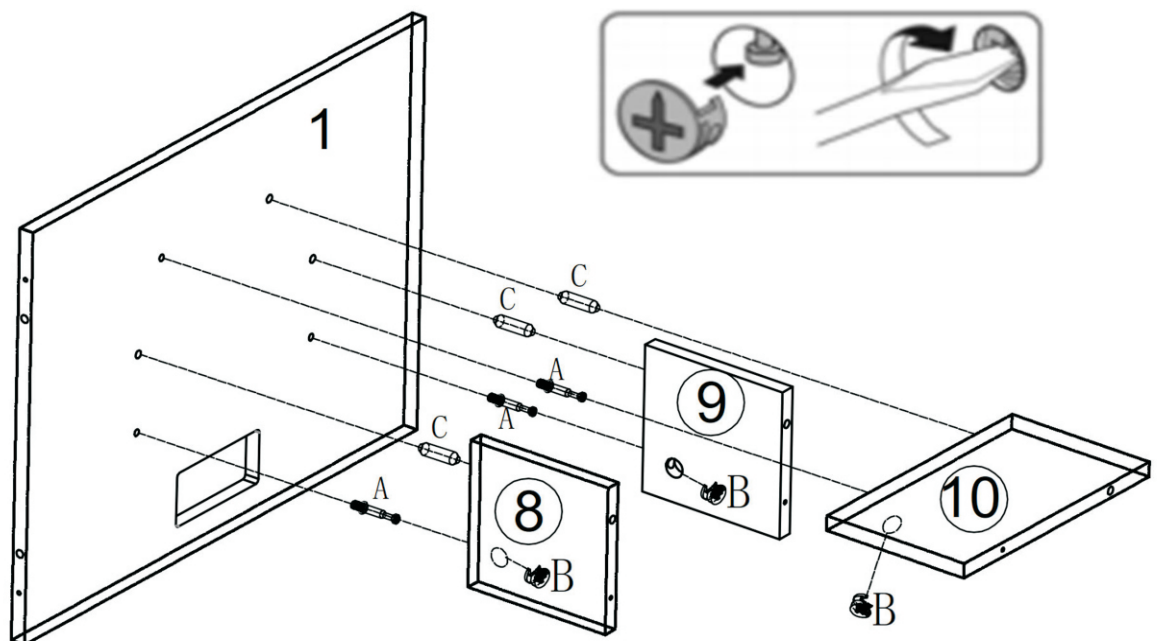

STEP 2

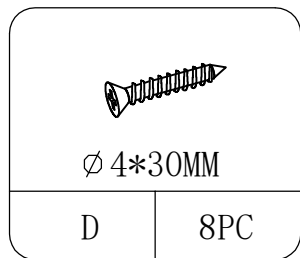
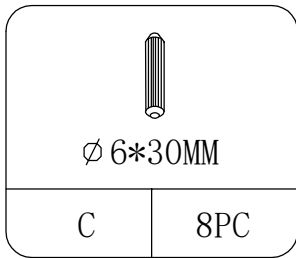

Insert (C) into part (1,11,12). Attach part (6,7) to part (1,11,12) with (D).

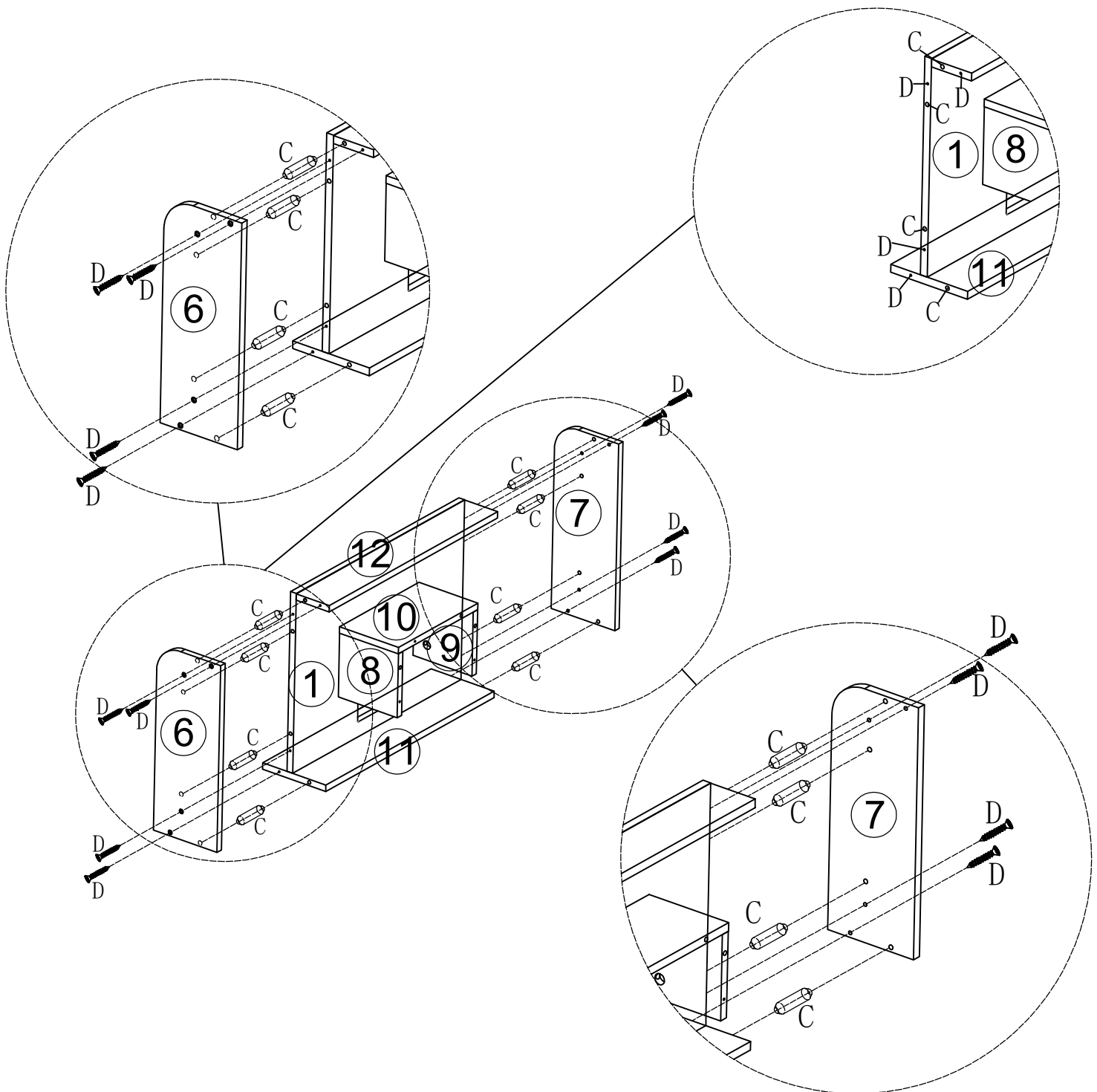

STEP 3

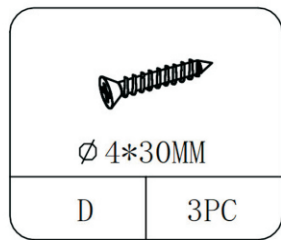
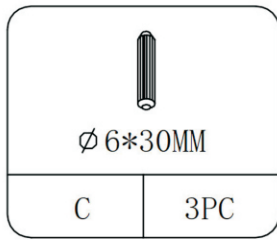

Insert (C) into part (8,9,10). Attach part (2) to part (8,9,10) with (D).

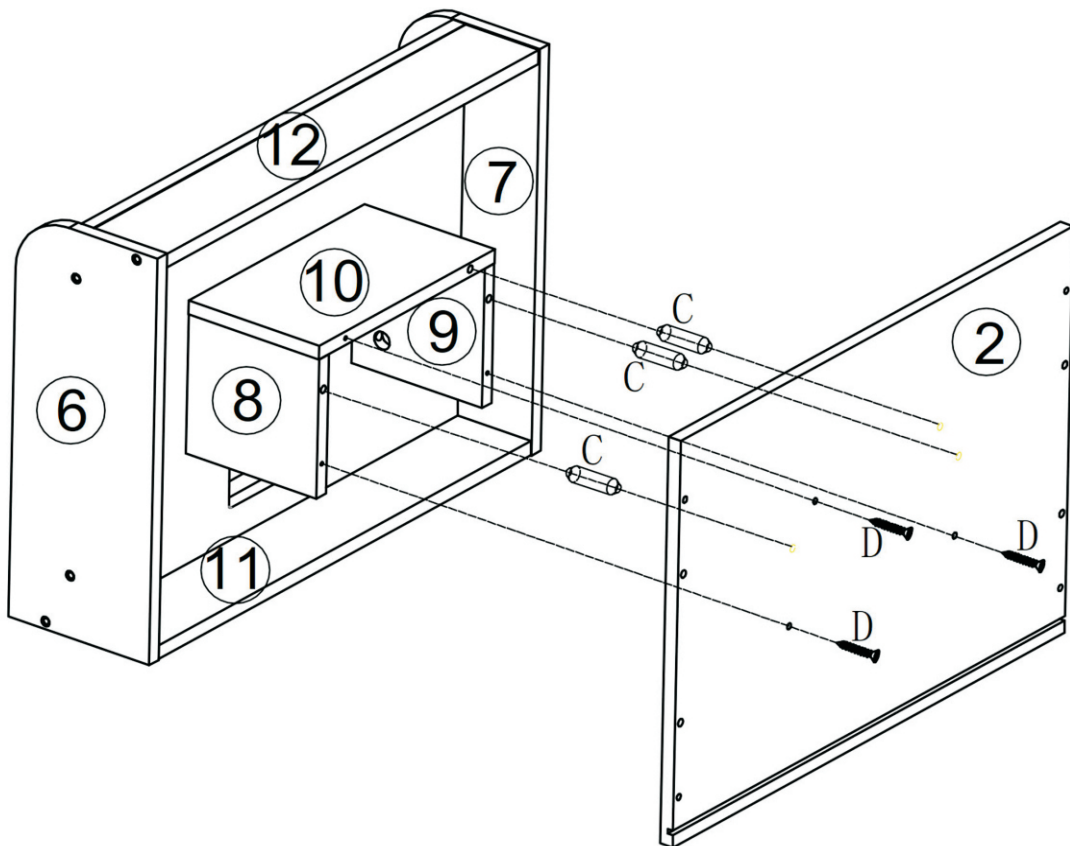

STEP 4

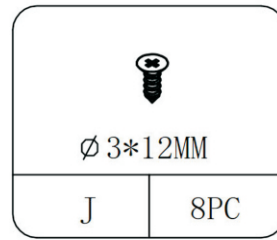
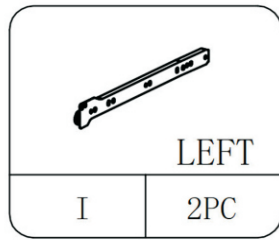
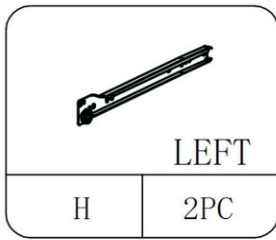

Using screw (J), attach (H) to (4).

Using screw (J), attach (I) to (5).

Notice:

Note the orientation and hole location of (H) and (I).

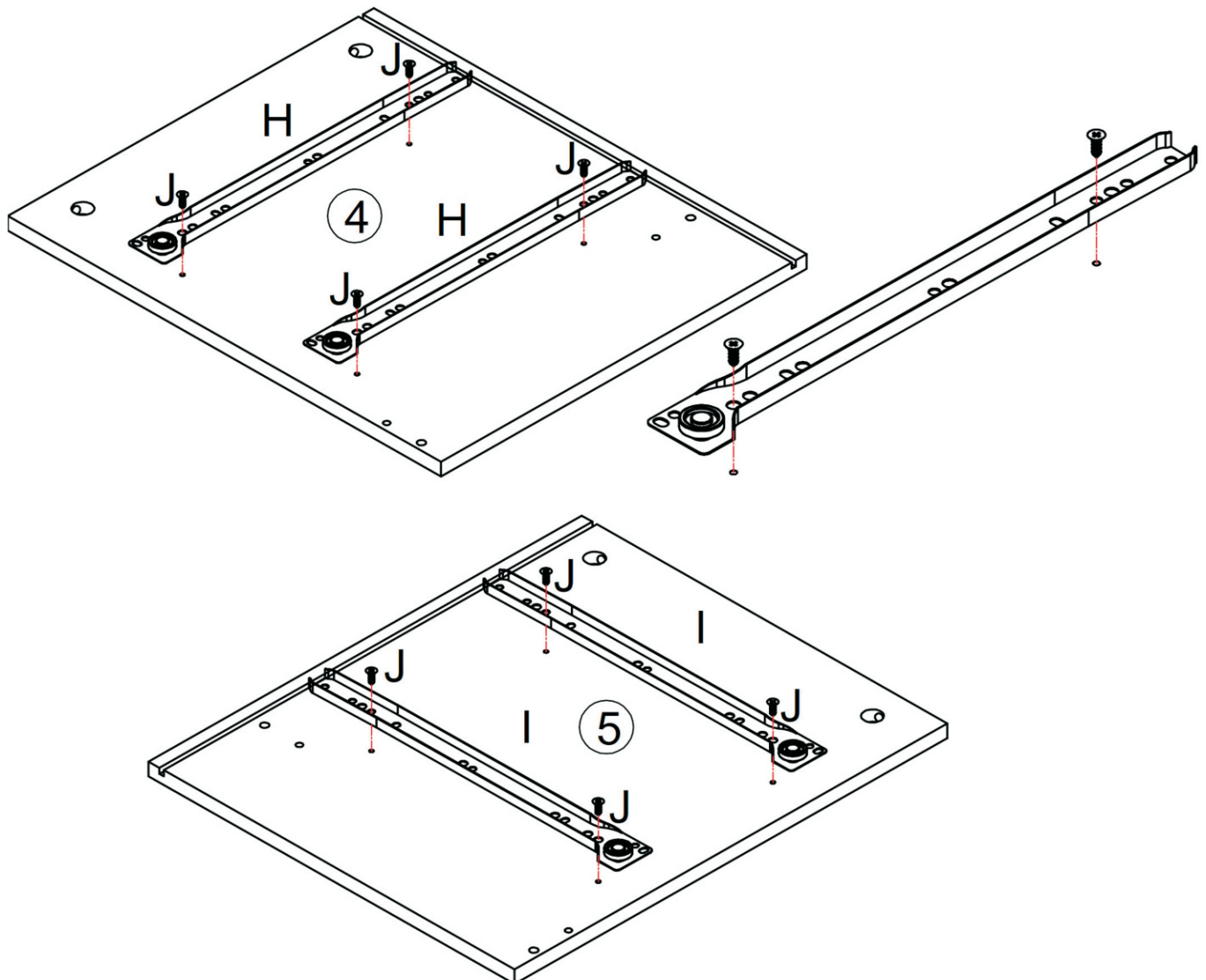

STEP 5

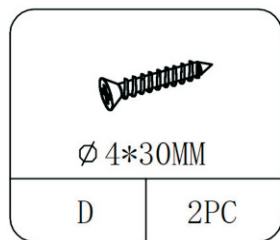
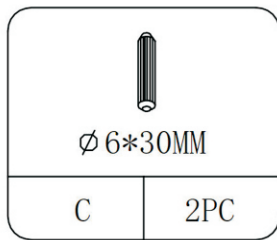

Insert (C) into part (5). Attach part (5) to part (13,14) with (D).

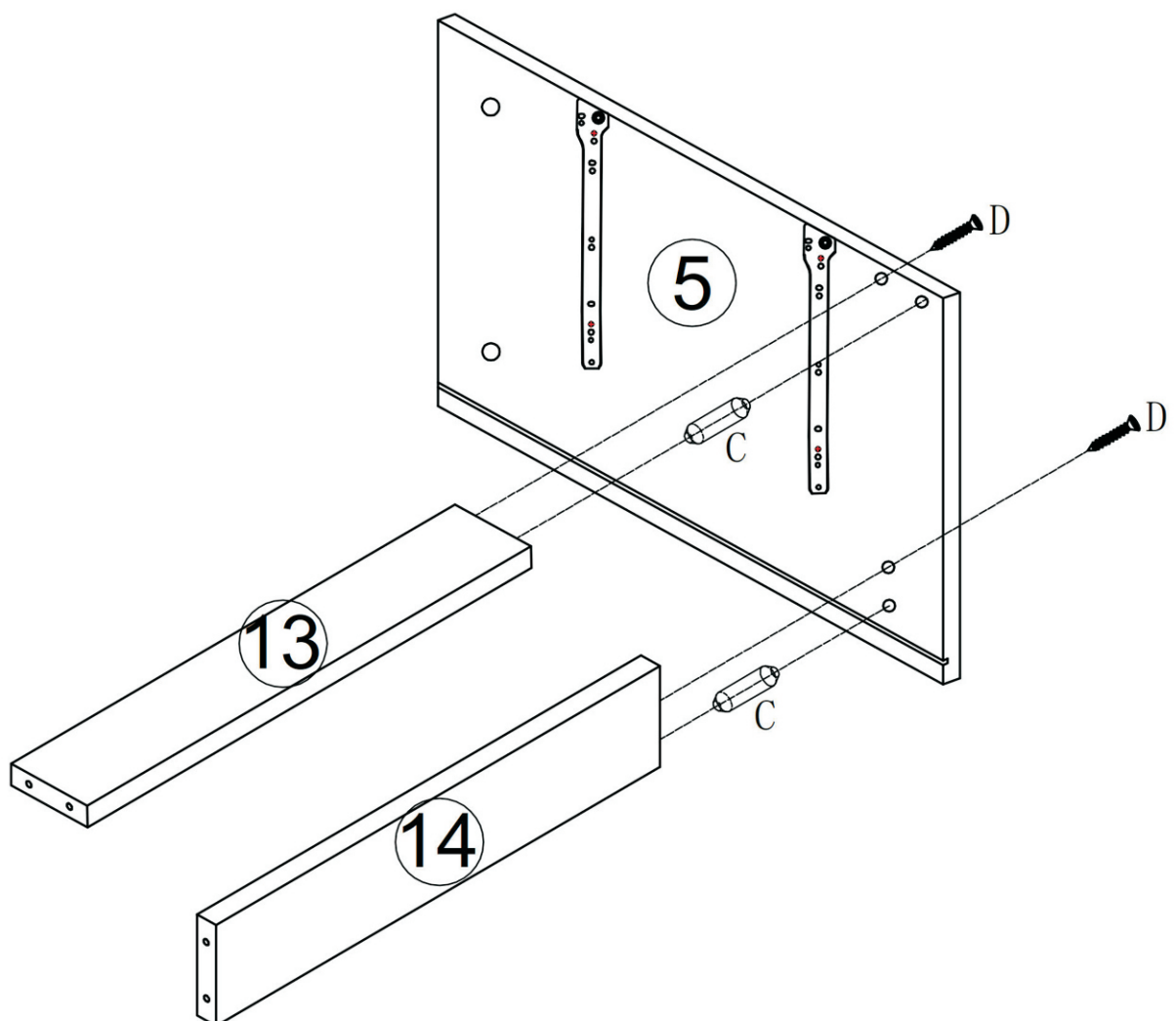

STEP 6

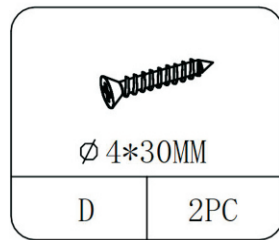
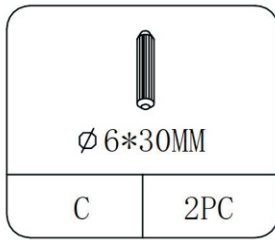

Insert (C) into part (13,14). Attach part (4) to part (13,14) with (D).

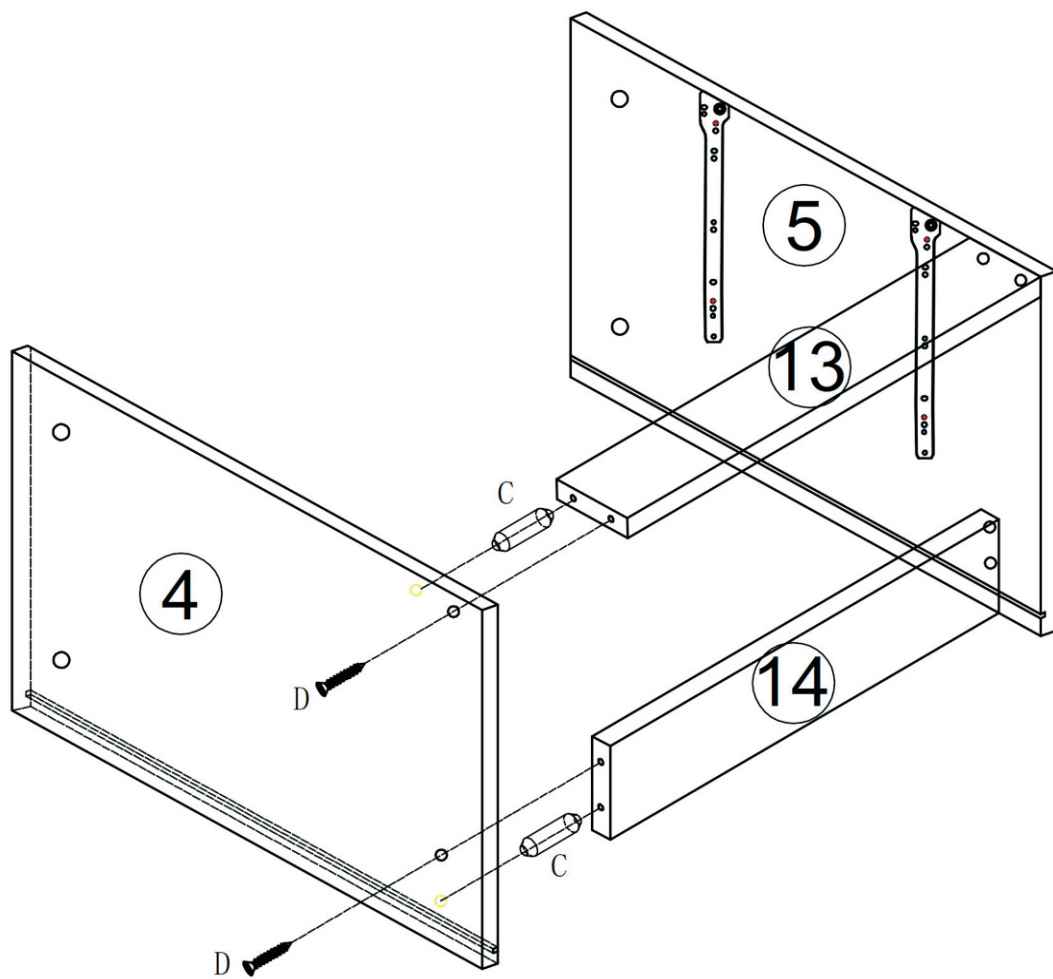

STEP 7

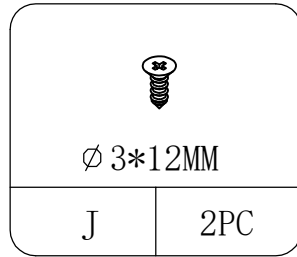
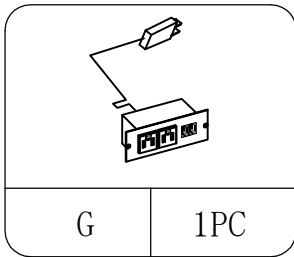

Tear off (K) tape stick (K) on parts (8,9,10)

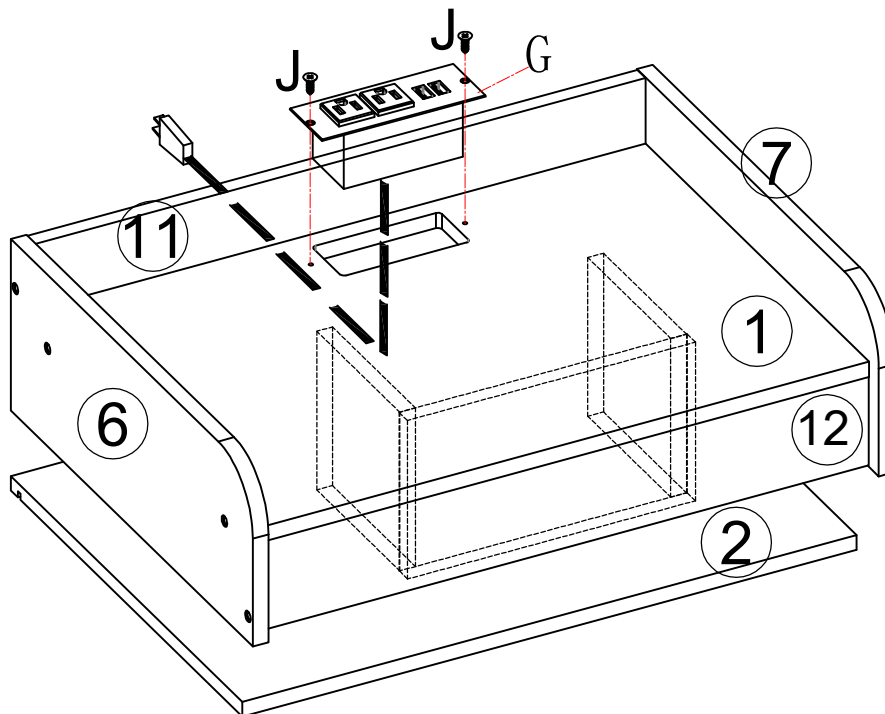

STEP 8

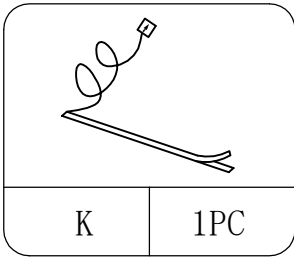

Attach part (G) to part (1) with (J) as shown.

Notice:

Note that the plug is placed under the hole as shown in the figure.

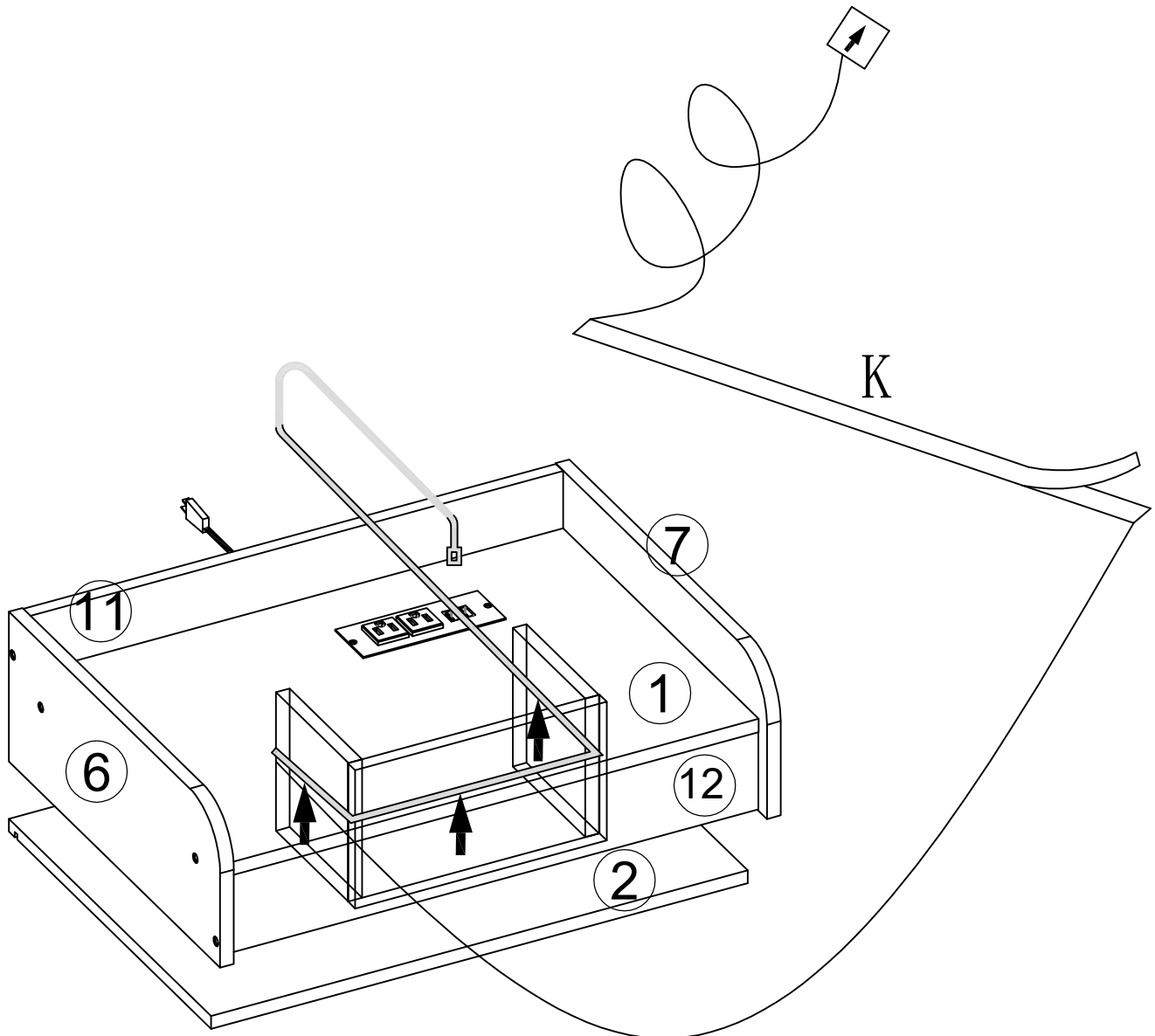

STEP 9

Put part (3) into (4,5) as shown.

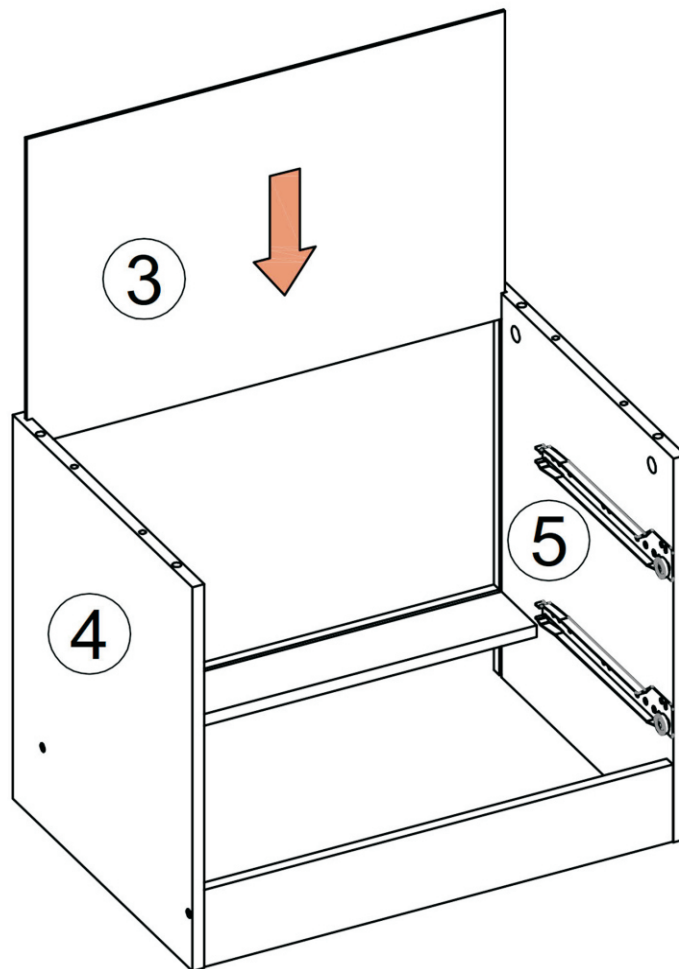

STEP 10

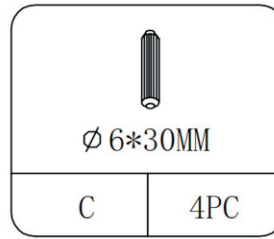
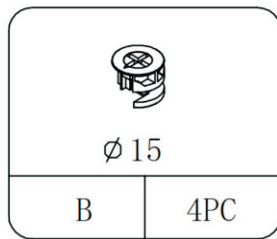
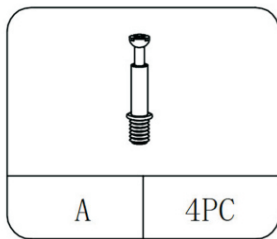

Insert (C) into part (4,5). Attach cam bolt (A) to part (2) with screwdriver.

Attach part (2) to part (4,5). Then use attach part (B) to lock them.

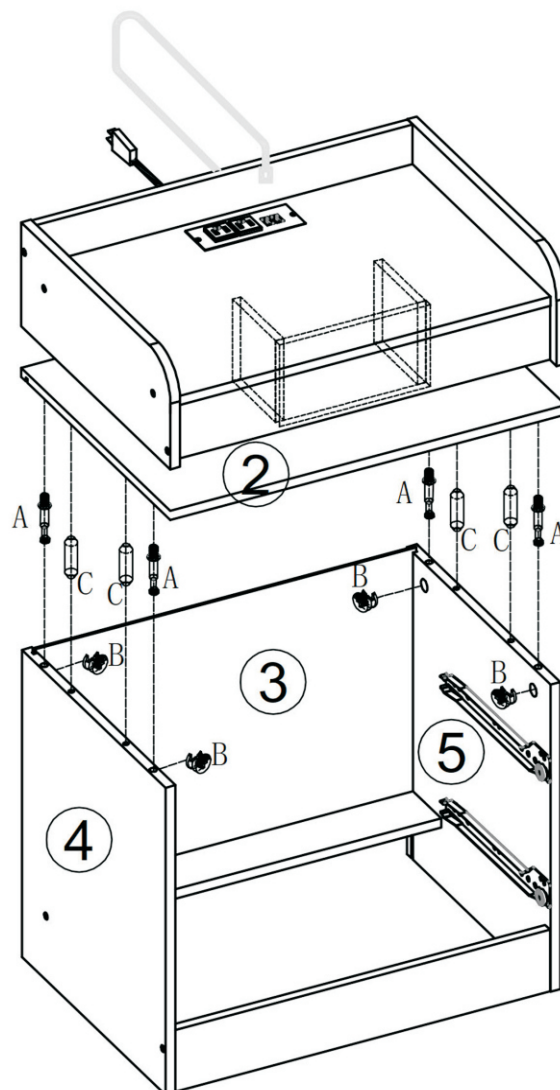

STEP 11

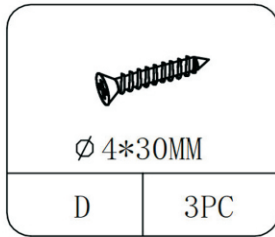

Attach part (17,18) to part (19) with (D). Then put part (15) into (17,18,19) as shown.

Repeat this step for another drawer assembly.

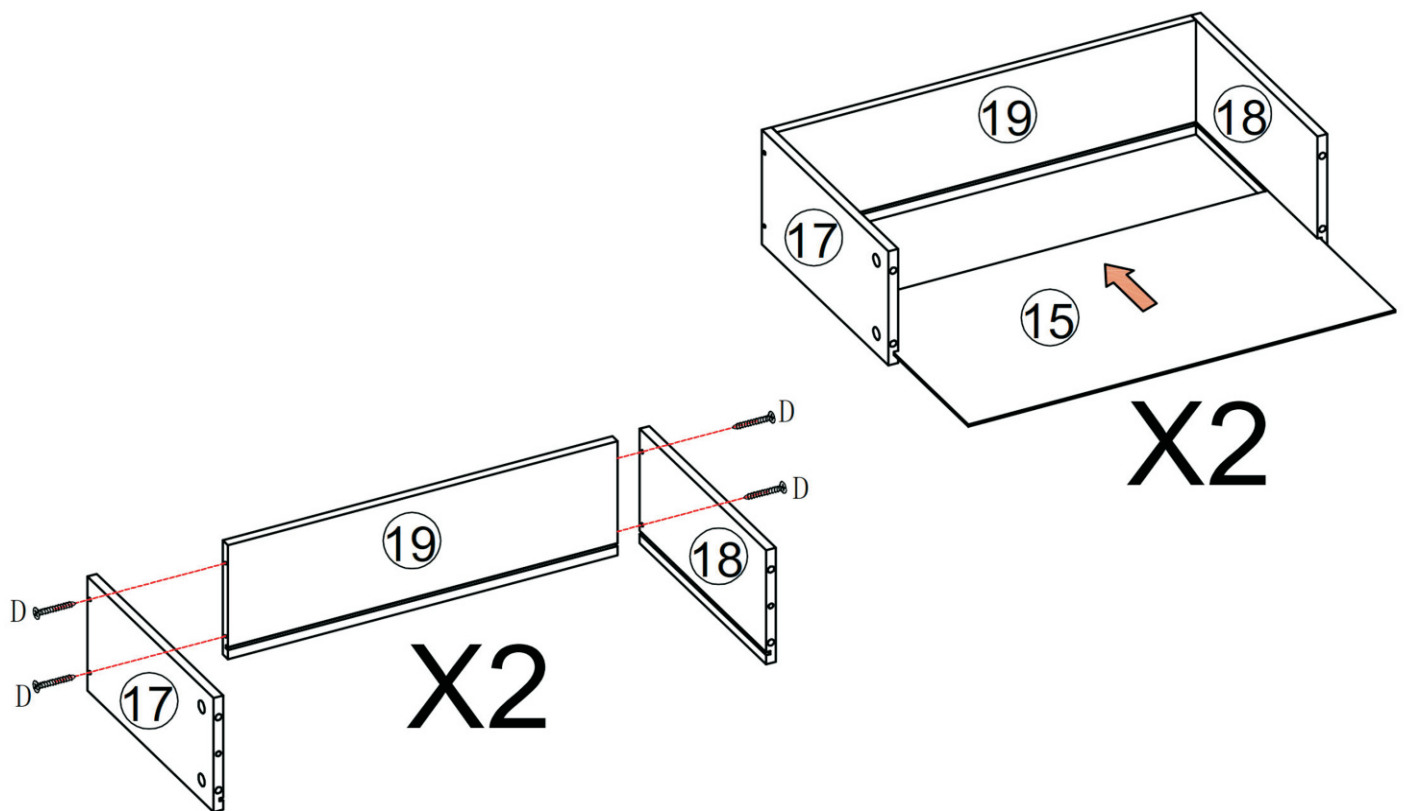

STEP 12

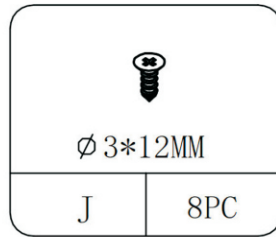
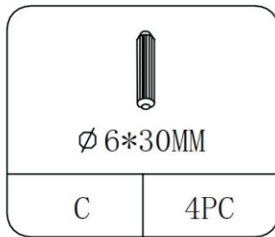
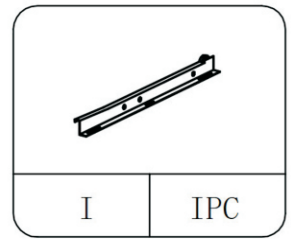
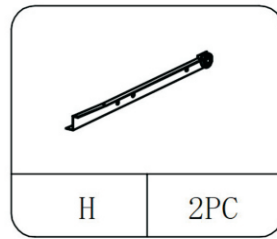
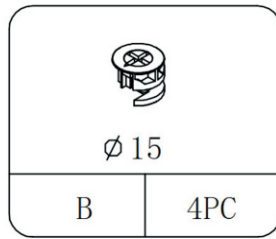
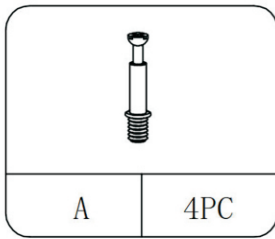

Attach cam bolt (A) to part (16) with screwdriver.
 Attach part (16) to part (17,18). Then use attach part (B) to lock them.

Using screw (J), attach (H) to part (18).

Using screw (J), attach (I) to part (17).

Notice:

Note the orientation and hole location of (H) and (I).

Repeat this step for another drawer assembly.

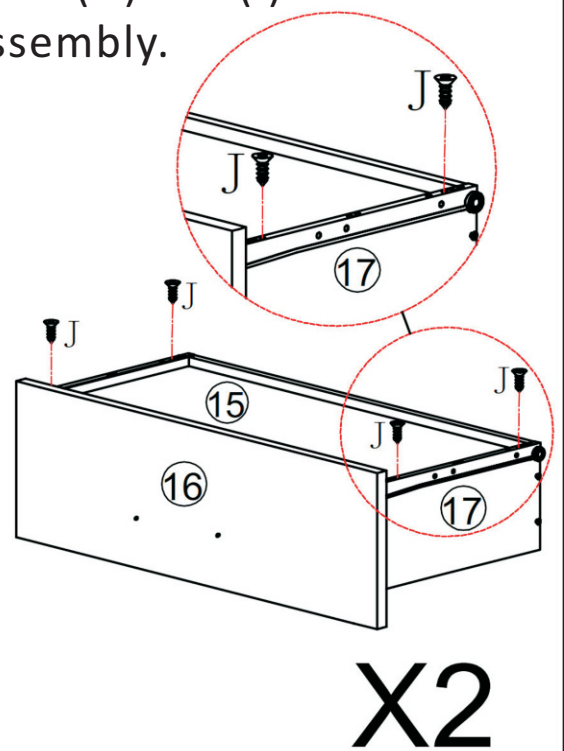
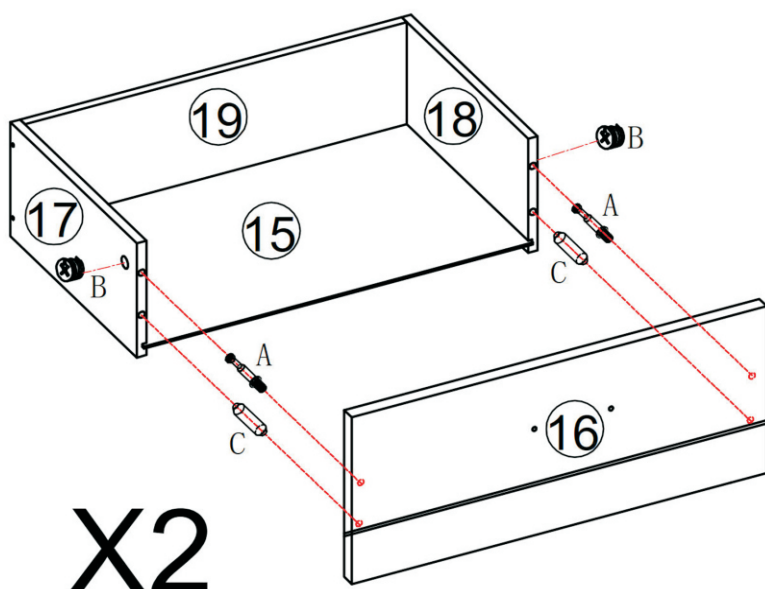

STEP 13

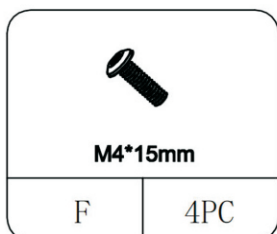
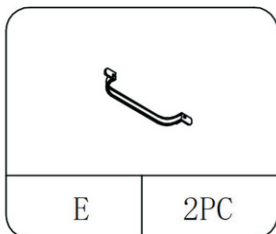

Using screw (F), attach (E) to the side part (16).
Repeat this step for another drawer assembly.

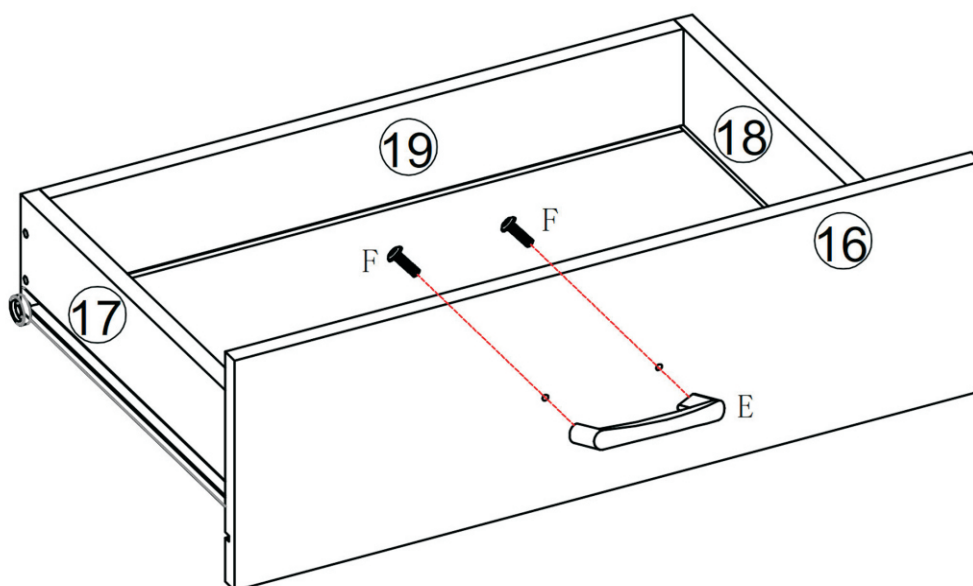

STEP 14

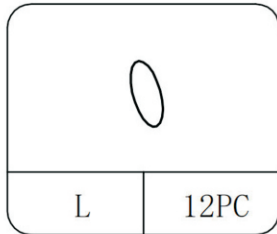

Align the 2 slide rails and put drawer into, then put (L) as shown.

