

ASSEMBLY INSTRUCTIONS

KING SIZE(ID:1950X2070X260MM)
QUEEN SIZE(ID: 1550X2070X260MM)

Thank you for purchasing this quality product. Be sure to lay all components on a soft and clean surface before assembly in order to avoid components from being scratched.

CAUTIONS :

1. Check contents against list for quantity.
2. Familiarize yourself with the components and hardware by reviewing the Assembly Instructions.
3. Do not over tighten the screws and bolts as it may damage the threads.
4. Keep all hardware parts out of the reach of children.
5. Please "LIFT UP & MOVE" the bed whenever you want to shift it.

HARDWARE LIST

NO.	DESCRIPTION	QTY
A	M6 X 40MM JCBC SCREW	4 PCS
B	M8 X 35MM JCBB SCREW *COME ATTACHED IN HEADBOARD - 4PCS *COME ATTACHED IN FOOTBOARD - 4PCS	
C	M8 X 25MM JCBB SCREW *COME ATTACHED IN HEADBOARD - 2PCS *COME ATTACHED IN FOOTBOARD - 2PCS	
D	M4 X 38MM CHIPBOARD SCREW	4 PCS
E	PVC LEG	4 PCS
F	END CAP	32 PCS
G	MIDDLE CAP	16 PCS
H	SLAT	32 PCS
I	M4 ALLEN KEY	1 PC
J	M5 ALLEN KEY	1 PC
K	MIDDLE RAIL	1 PC
L	SUPPORT MIDDLE RAIL	2 PCS
M	M6 NUT	4 PCS

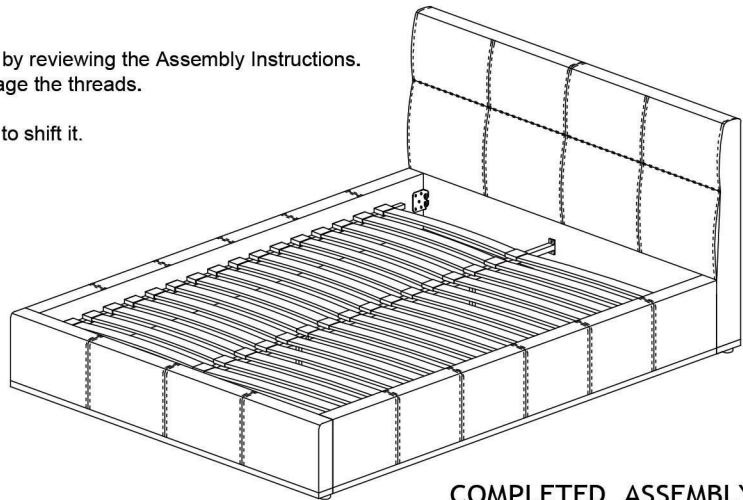

COMPLETED ASSEMBLY

STEP 1

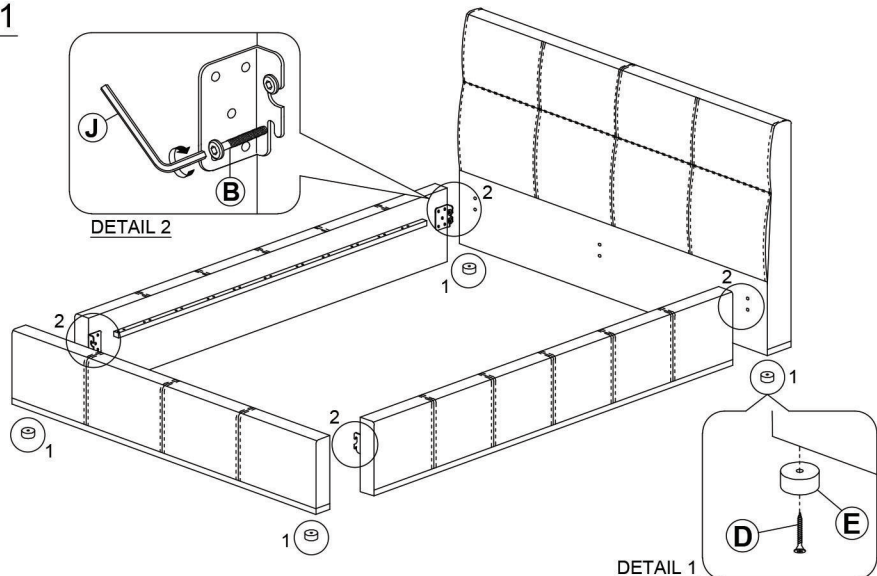

STEP 2

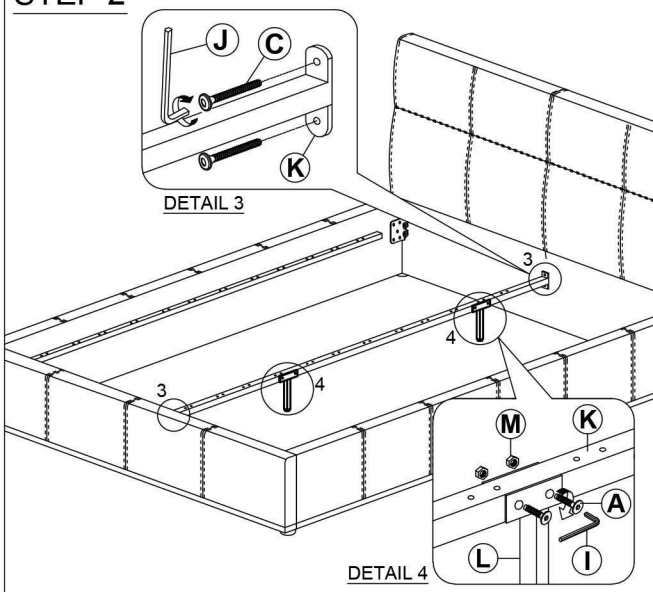

STEP 3

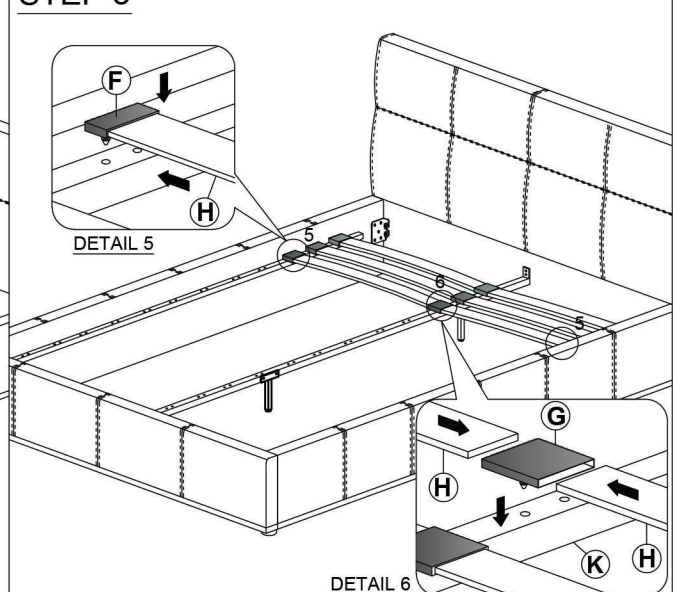

*GENERAL NOTE: ALWAYS PLACE OBJECTS ON A SMOOTH SURFACE TO AVOID SCRATCHES

