

# Bathroom Mirror Installation Manual

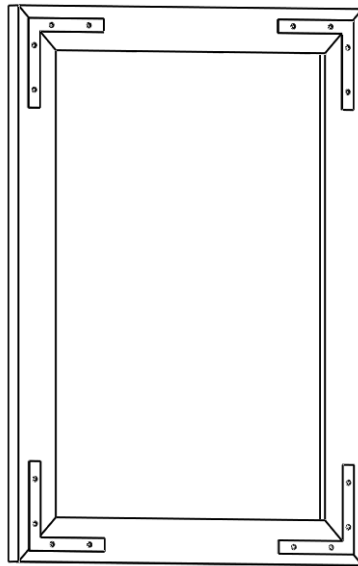

## Package Contains

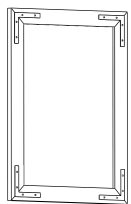

Front



Back

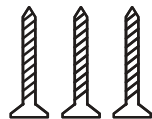

Screws \* 3



Expansion tube \* 3

There are two spare screws and expansion tubes respectively!

## Preparing the Tools:



Tapeline



Pencil



Spirit level

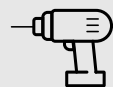

Hammer drill



Screwdriver



Hammer

## 1 Measurement

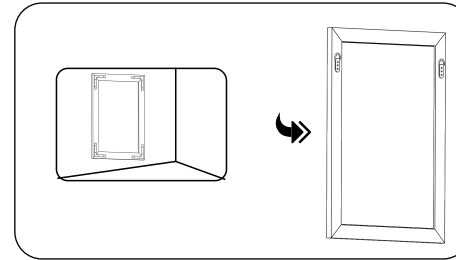

Use a tapeline to measure the distance between two metal hooks accurately.

## 2 Scale Mark

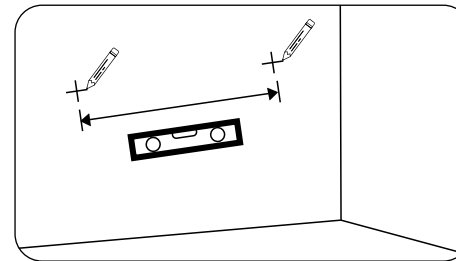

Use a pencil to draw the mark of the distance between two points.

## 3 Drill Hole

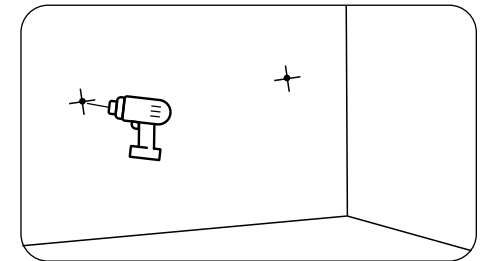

Drill holes at the mark of intersection with a hammer drill.

## 4 Expansion Tube Fixing

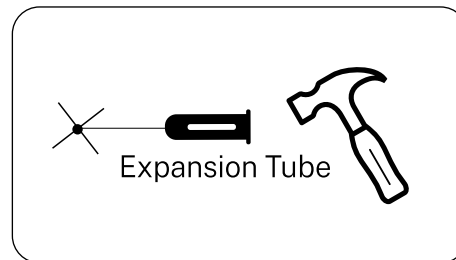

Use a hammer to drive the expansion tube into the holes.

## 5 Screws Fixing

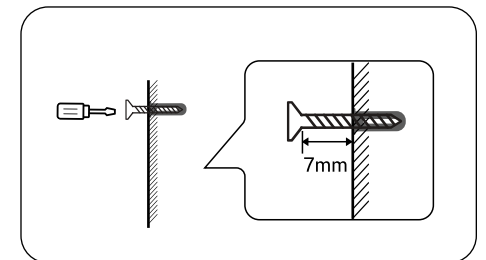

Use a screwdriver to rotate the screws into the expansion tube.

## 6 Hand Up and Install the Mirror

