

How your Pendant Arrives

Cord-Hung Pendant Setup Guide:



1

Out of the Box

Your fixture may arrive coiled in protective packaging. A bend in the cord at this stage is expected.

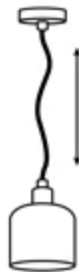

2

Unpack & Install

Install the fixture and let the cord extend to its full length before making adjustments.

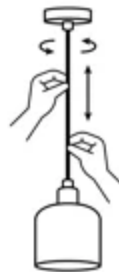

3

Smooth by Hand

Gently guide the cord straight. If needed, rotate it slightly near the canopy to help alignment. Do Not use Tools or Heat.

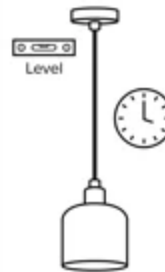

4

Let it Settle

Allow ample time for the cord to settle naturally. Check that the canopy is level and the shade hangs evenly.



Helpful tip: A slight curve after opening is normal and does not indicate a defect. If the cord still looks off after installation, review the setup or contact customer support. Electrical adjustments should be handled by a qualified electrician.