

# **iGENIX**

## **18" AIR CIRCULATOR**

Model Number: DF1800

### **INSTRUCTIONS FOR USE**



**Thank you for purchasing this product  
Please read these instructions carefully before use**

## **SAFETY INSTRUCTIONS**

**Important:** This appliance is not intended for use by persons including children with reduced physical, sensory or mental capabilities, or lack of experience and knowledge, unless they have been given supervision or instruction concerning use of the appliances by a person responsible for their safety.

1. Read all instructions before using the appliance.
2. This appliance is for domestic use only. This appliance is for indoor use only. Do not use outdoors.
3. Make sure the voltage in your home corresponds to the one shown on the rating label of the appliance.
4. Do not operate this appliance if it has a damaged cord or plug, if it is not working properly or if it has been damaged or dropped. If the supply cord is damaged, it must be replaced by the manufacturer or its service agent or a similarly qualified person in order to avoid a hazard.
5. **WARNING:** Children should be supervised to ensure that they do not play with the appliance.
6. Place fan on a flat even surface.
7. Do not use an extension lead with this fan.
8. Do not insert fingers or objects through the blade guard.
9. Do not use in damp areas such as bathrooms.
10. Do not use by a window.
11. Do not use with semi-conductors speed control.
12. This fan should not be operated without the base or safety guard fitted or laying down.
13. Do not cover the power cord. Ensure the position of the cord does not pose a hazard.
14. Unplug the fan when not in use.
15. Do not leave unattended whilst in use.
16. Do not operate in areas where flammable liquids such as paint and petrol are used.
17. This fan must be earthed.

## **Desk Fan At a Glance**

1. Front Guard
2. Blade
3. Screw
4. Motor
5. Support Leg
6. Rear Guard
7. Nut
8. Screw
9. Spring Washer
10. Washer
11. Power Cord
12. Switch Box
13. Bolt
14. Plastic Washer
15. Knob
16. Nut
17. Screw

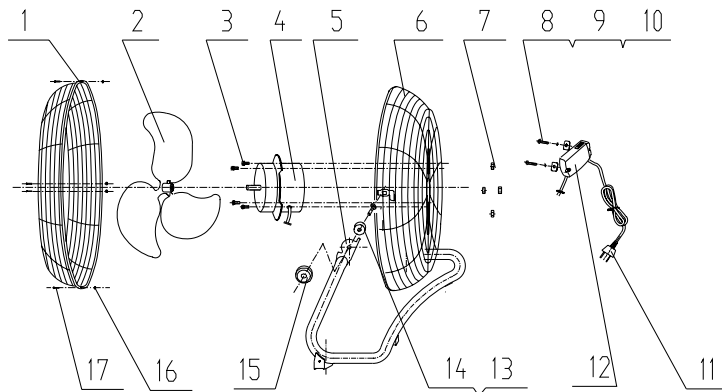

## **Blade and Guard Assembly**

1. Remove all parts from the packaging. Separate the front and rear guard.

**DO NOT OPERATE THIS FAN WITHOUT THE BLADE GUARD SECURELY FITTED**

## **Operating Instructions**

1. Check that the mains voltage complies with the voltage stated on this product.
2. Adjust the desired speed using the switch: 0---Off 1—Low 2—Medium 3—High
3. Adjust the tilt angle by moving the grill.

## Warning

- The fan must be placed on a flat even surface.
- When you turn off the fan, switch to OFF on the base. Switch off at the mains and remove the plug.

## Cleaning and Care

1. Turn off the fan and remove the power plug from the wall socket before cleaning.
2. Use a dry soft cloth to remove any dust from the fan.
3. If the fan is particularly dirty use a soft damp cloth and wipe dry.
4. Do not use any chemicals or detergents as they will damage the fan.
5. Ensure that water does not drip into the motor housing.
6. Store the fan in a ventilated and dry area.

## Changing the Plug

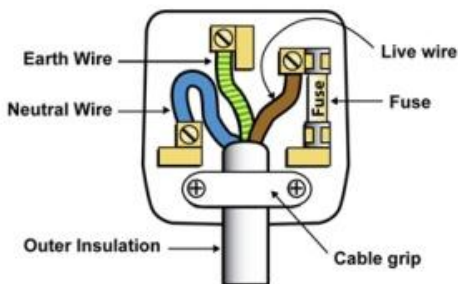

This fan must be earthed. Fit a 3A fuse in a 13A BS1363 plug. Fit the green/yellow wire to E, the blue wire to N and the brown wire to L. Fit the cord grip. If in doubt, call an electrician. Don't use a non-rewireable plug unless the fuse cover is fitted. If you remove the plug, dispose of it.

## Specifications

Voltage	220-240V, 50Hz
DF1800 Output:	90 Watts

## Disposal Information



The European Directive 2002/96/EC on Waste Electrical and Electronic Equipment (WEEE), requires that old household electrical appliances must not be disposed of in normal unsorted municipal waste. Old appliances must be collected separately in order to optimise the recovery and recycling of the materials they contain and reduce the impact on human health and the environment. The crossed out "wheeled bin" symbol on the product reminds you of your obligation, that when you dispose of the appliance it must be separately collected. Consumers should contact their local authority or retailer for information concerning the correct disposal of their old appliance.

## Guarantee Information

This product is guaranteed for a period of 2 years from the date of purchase against mechanical and electrical defects.

The warranty **does not** cover consumable parts that require replacement under normal use or accessories. This includes beaker, belts, and accessory attachments.

# 2

YEAR GUARANTEE

We will then decide whether to repair or replace the item. You will be required to return a copy of your proof of purchase. Please retain your original.

If an item is replaced under guarantee within 2 years, the guarantee for the replacement item will be calculated from the purchase date of the original.

**Before calling the Customer Service number please ensure you have checked the Troubleshooting guide.**

**IGENIX**

**Tel:** 01473 271 272

**Fax:** 01473 270 733

**Email:** [info@igenix.co.uk](mailto:info@igenix.co.uk)

**Website:** [www.igenix.co.uk](http://www.igenix.co.uk)

**Postal Address:**

Customer Service Department  
Pik-a-Pak Electrical Distributors  
38 Bluestem Road,  
Ransomes Europark,  
Ipswich, IP3 9RR

*When writing or emailing us to report a fault please ensure you attach a copy of your proof of purchase.  
Please retain your original*