

OUTDOOR SQUARE PROPANE ENCLOSURE

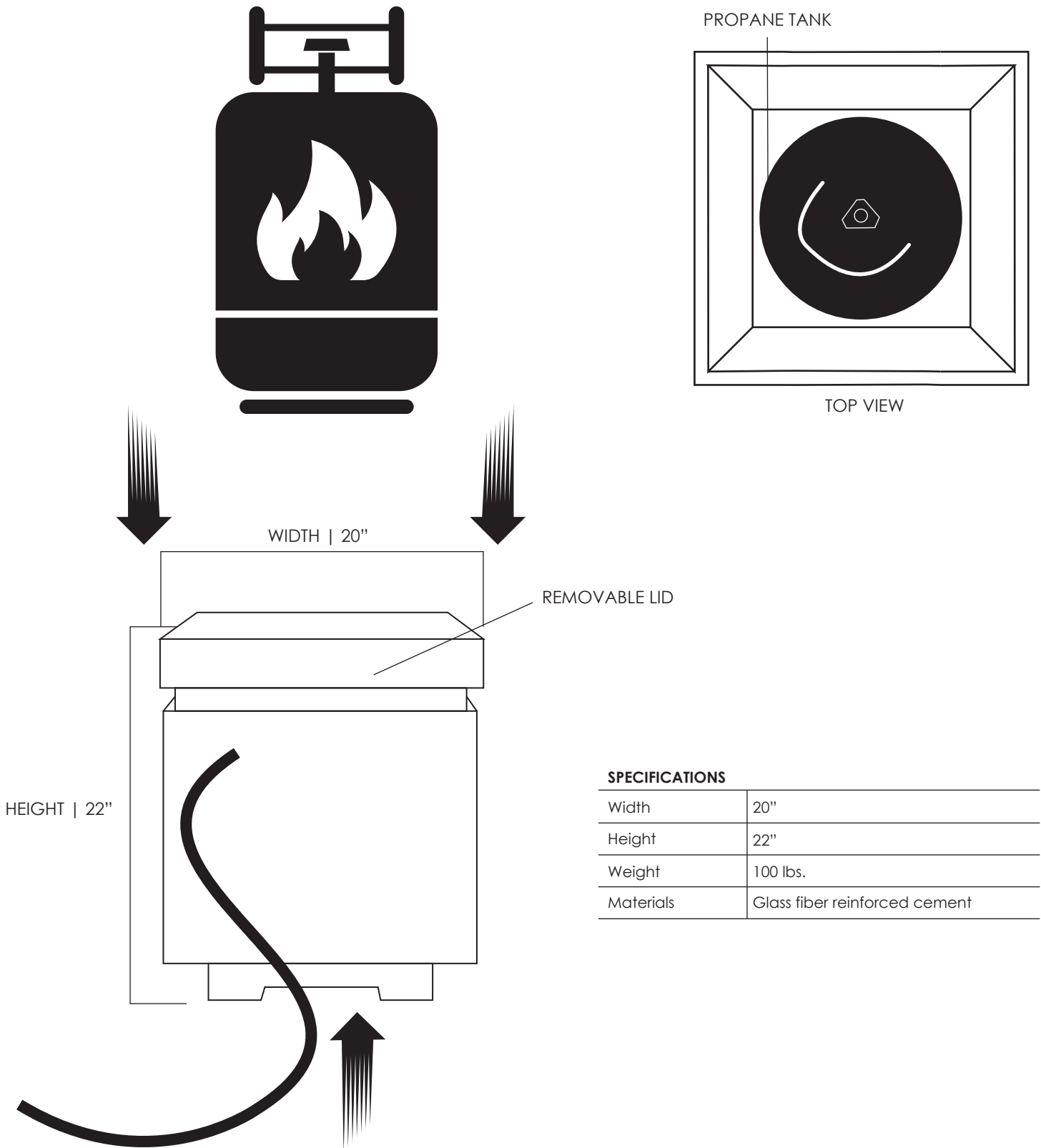

Carefully remove the lid to the enclosure. Place enclosure close enough to the fire feature to allow the hose to run freely without any kinks or pinching. Run the hose through the bottom of the enclosure. Place the propane tank (not included) into the enclosure and make sure the hose is securely connected to the propane tank. DO NOT PLACE THE PROPANE ENCLOSURE ON TOP OF THE HOSE. Place lid back on the enclosure.