

# ASSEMBLY INSTRUCTION

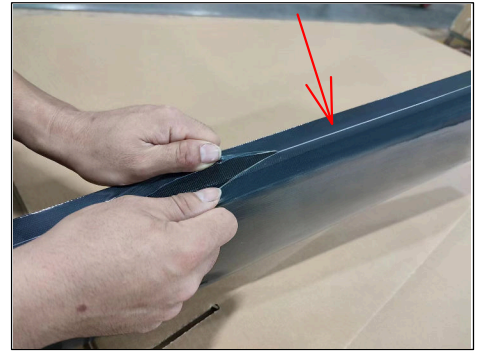
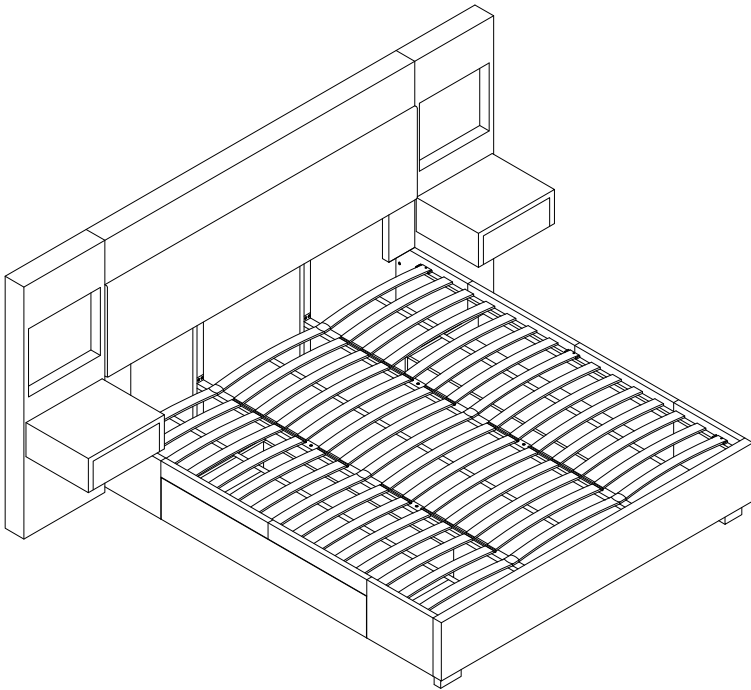

Please **TEAR OFF** this shrink film from side!  
**DO NOT USE CUTTER!**

## IMPORTANT NOTE

- 1. The product is shipped in three packages. Please check the number of packages received before assembly. If you are missing one package, receive a duplicate package, or have any assembly or after-sales issues**
2. For the protection of your furniture, place all parts on a clean and smooth surface to prevent any damage.
3. Keep fittings out of children's reach and keep children well away from construction area.
4. When moving your assembled bed, it is best to lift the bed and never to drag it.
5. Do not use this product if parts are missing, damaged or worn.
6. This product should only be used on firm, level ground.
7. Please periodically check all fittings and re-tighten as necessary.
8. Do not use the bed unless all bolts and screws are firmly secured.

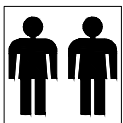

Minimum two  
person assembly

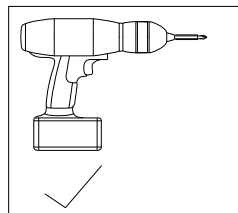

PART LIST

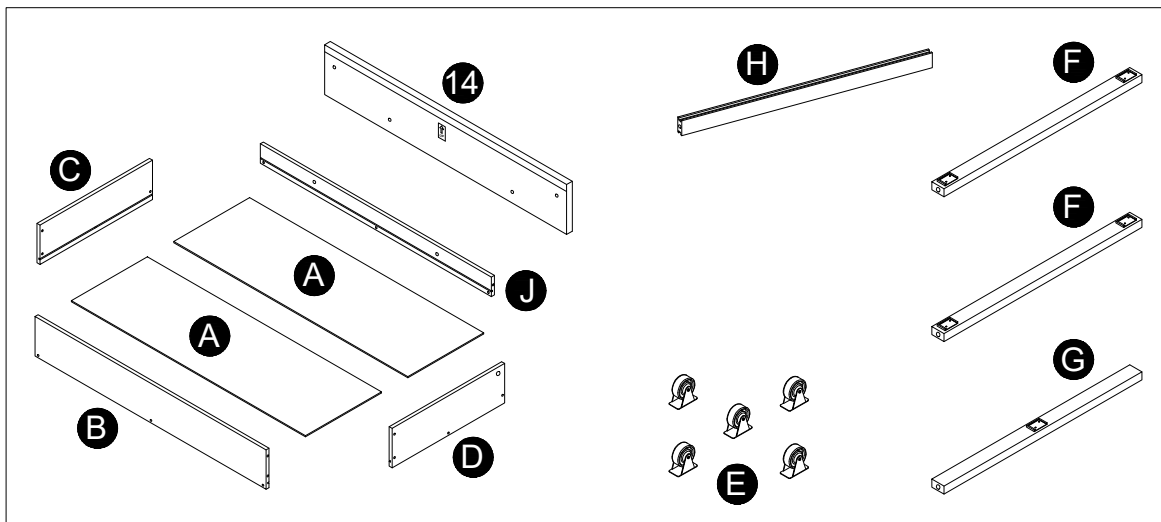
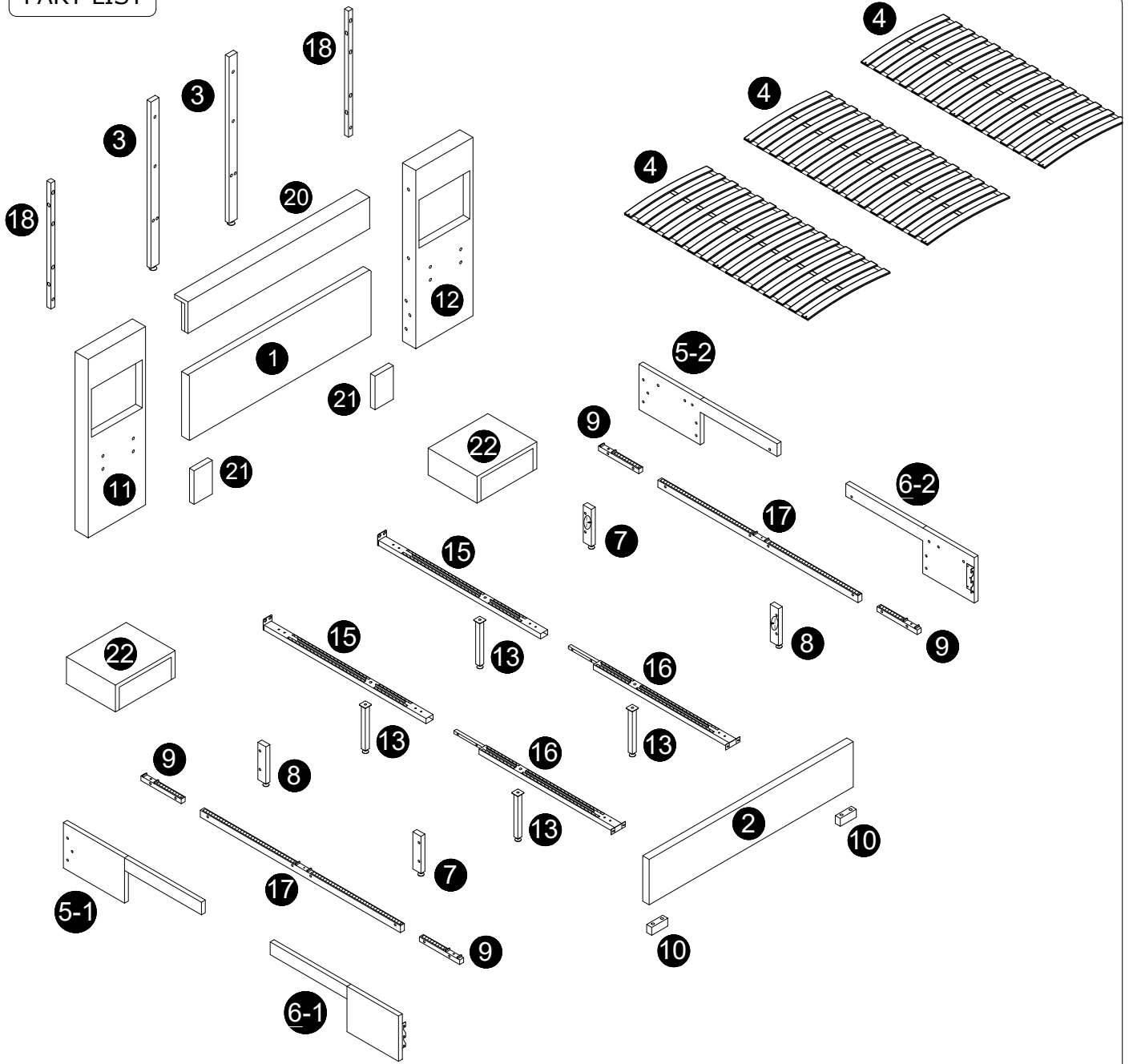

x2

PART LIST

1 x 1pc

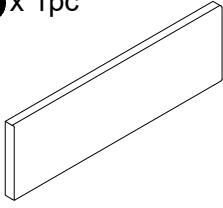

2 x 1pc

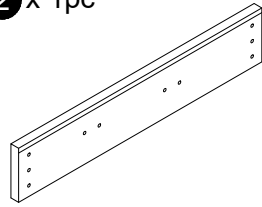

3 x 2pcs



4 x 3pcs

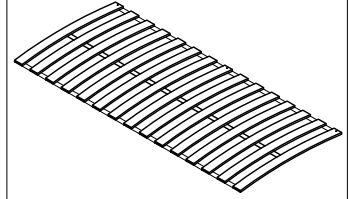

5-1 x 1pc

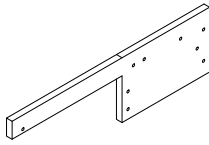

5-2 x 1pc

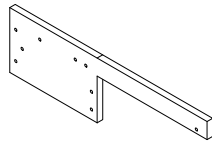

6-1 x 1pc

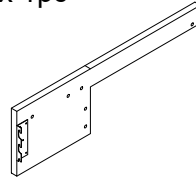

6-2 x 1pc

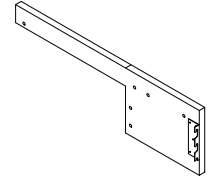

7 x 2pcs

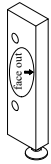

8 x 2pcs



9 x 4pcs

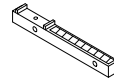

10 x 2pcs



11 x 1pc

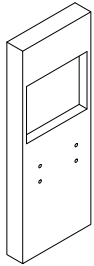

12 x 1pc

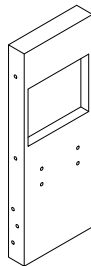

13 x 4pcs



14 x 2pcs

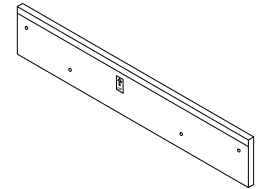

15 x 2pcs

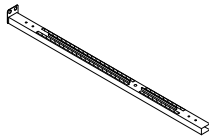

16 x 2pcs

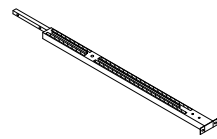

17 x 2pcs

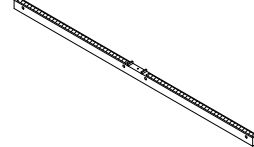

18 x 2pcs



20 x 1pc

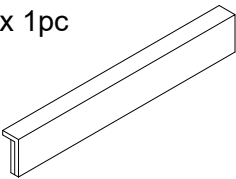

21 x 2pcs

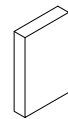

22 x 2pcs

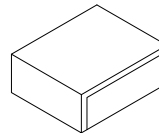

A x 4pcs

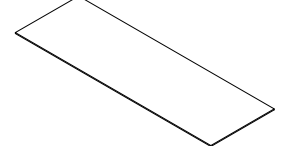

B x 2pcs

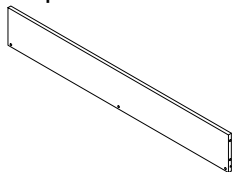

C x 2pcs

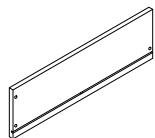

D x 2pcs

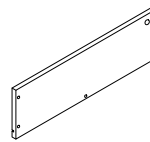

E x 10pcs



F x 4pcs

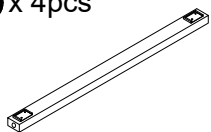

G x 2pcs

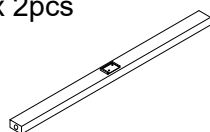

H x 2pcs

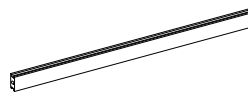



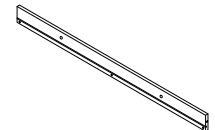





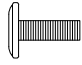
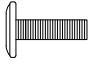

J x 2pcs

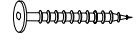

Please ensure to thoroughly inspect the small inner cardboard box containing the hardware, which are tied with a red string, before disposing of the box.

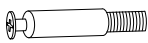
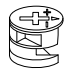
**HARDWARE LIST**

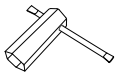
				
<b>H1</b> M5 x 1pc	<b>H2</b> M8x25mm x 14pcs	<b>H3</b> M8x35mm x 16pcs	<b>H4</b> M8x50mm x 46pcs	<b>H5</b> M8 x 22pcs
				
<b>H6</b> M8x22mm x 50pcs	<b>H7</b> M8 x 8pcs	<b>H8</b> x 6pcs	<b>H9</b> x 6pcs	<b>H10</b> M6x45mm x 28pcs
				
<b>H11</b> M4 x 1pc	<b>H12</b> x 4pcs	<b>H13</b> x 4pcs	<b>H14</b> M8x50mmx 8pcs	<b>H15</b> x 1pc

**1**

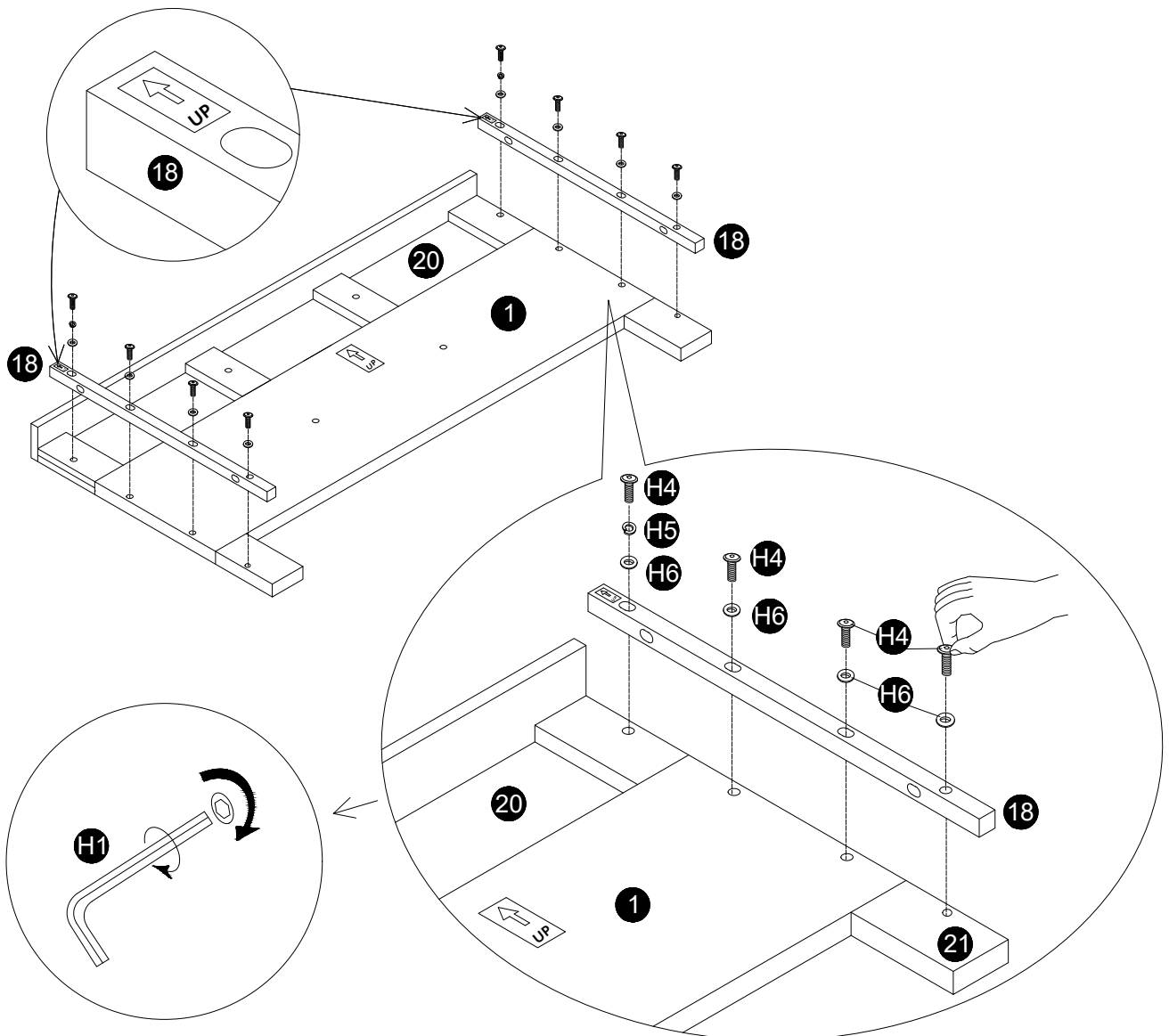

Lock the circular hole first and then the long hole!

2

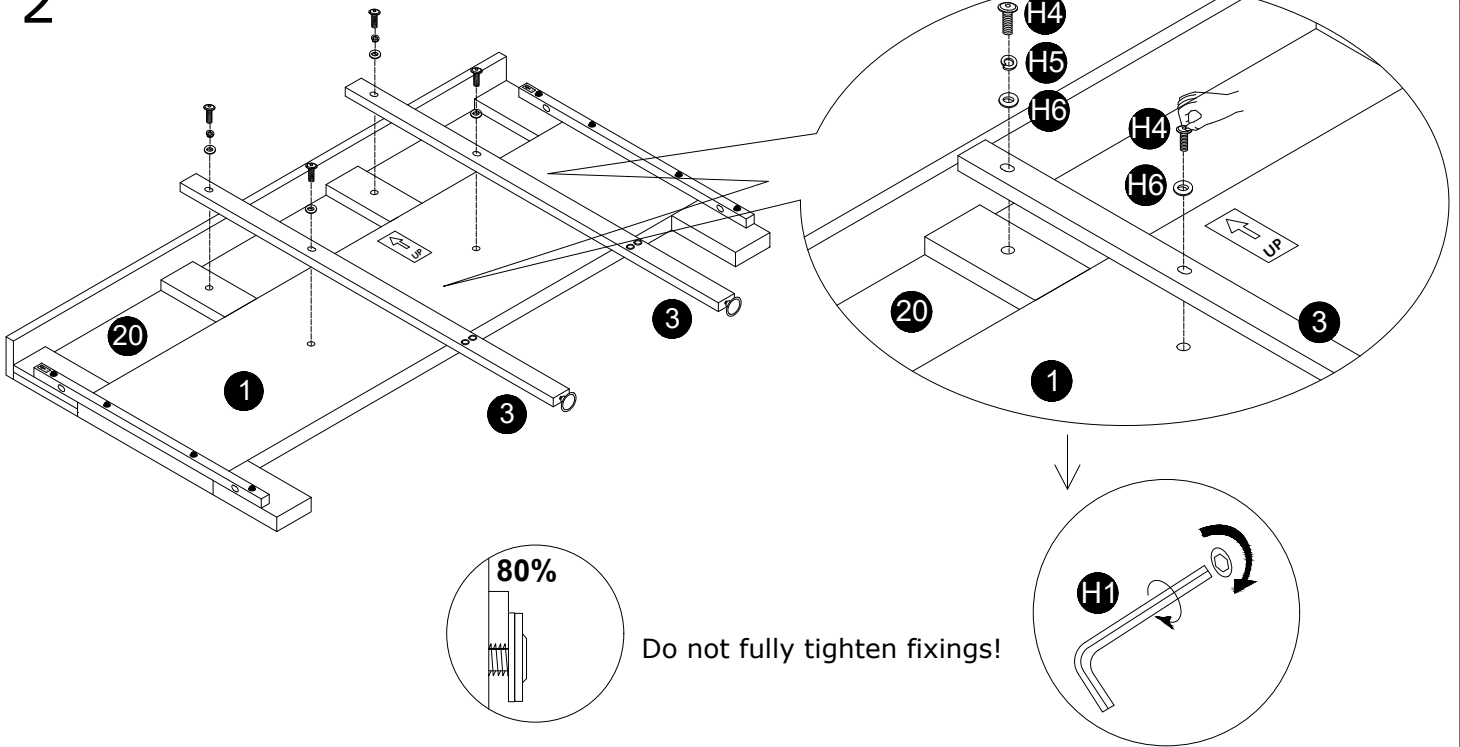

3

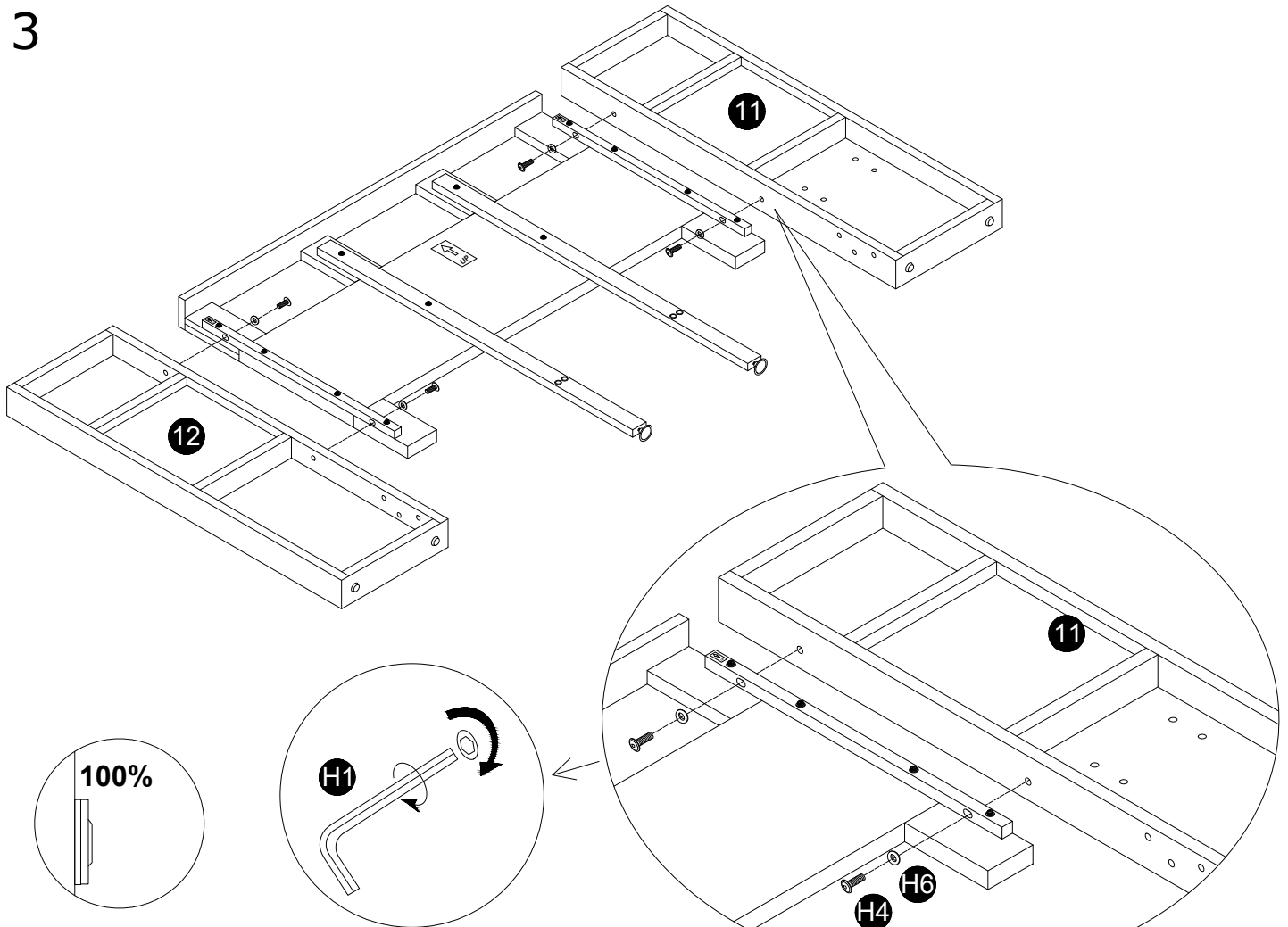

4

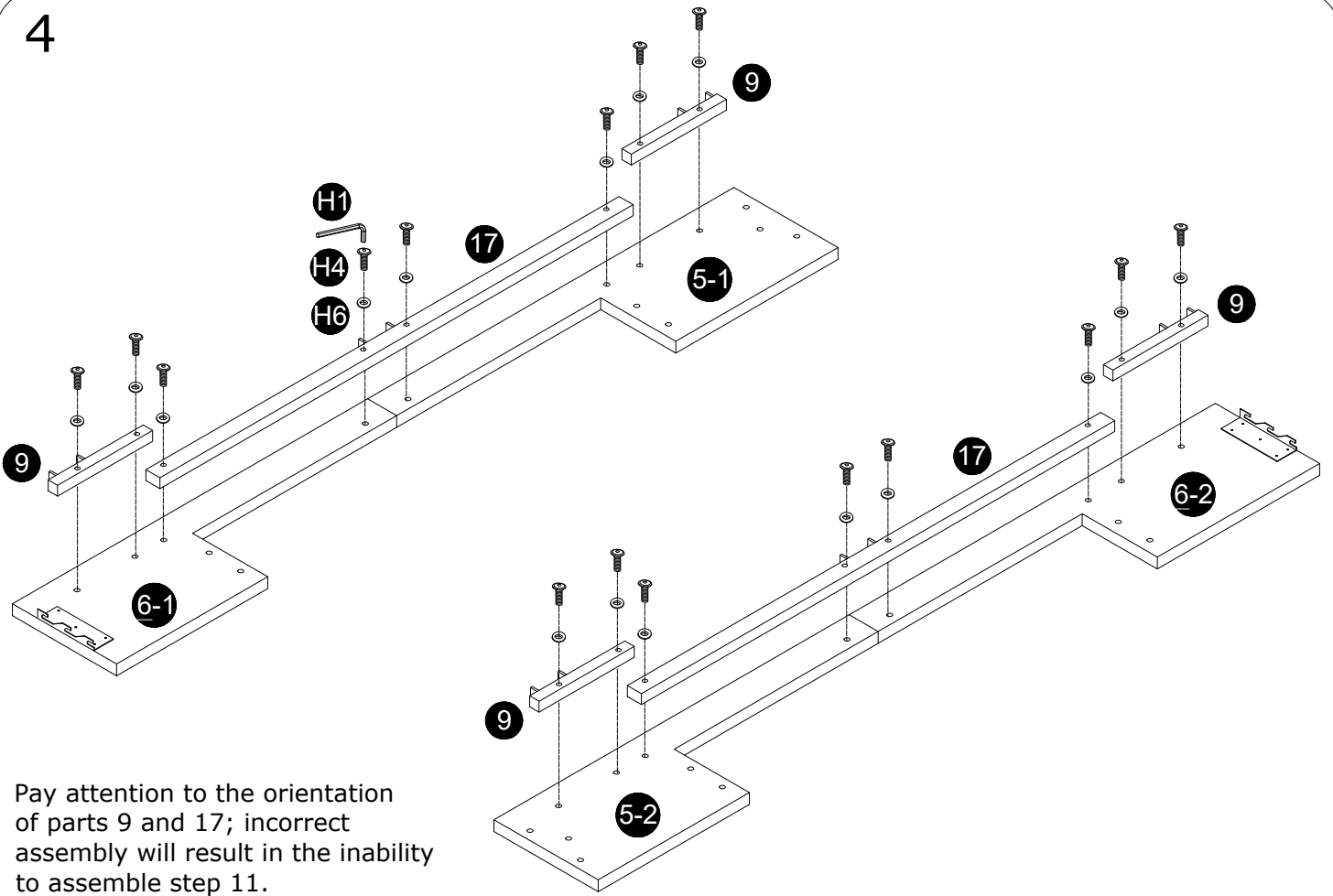

Pay attention to the orientation of parts 9 and 17; incorrect assembly will result in the inability to assemble step 11.

5

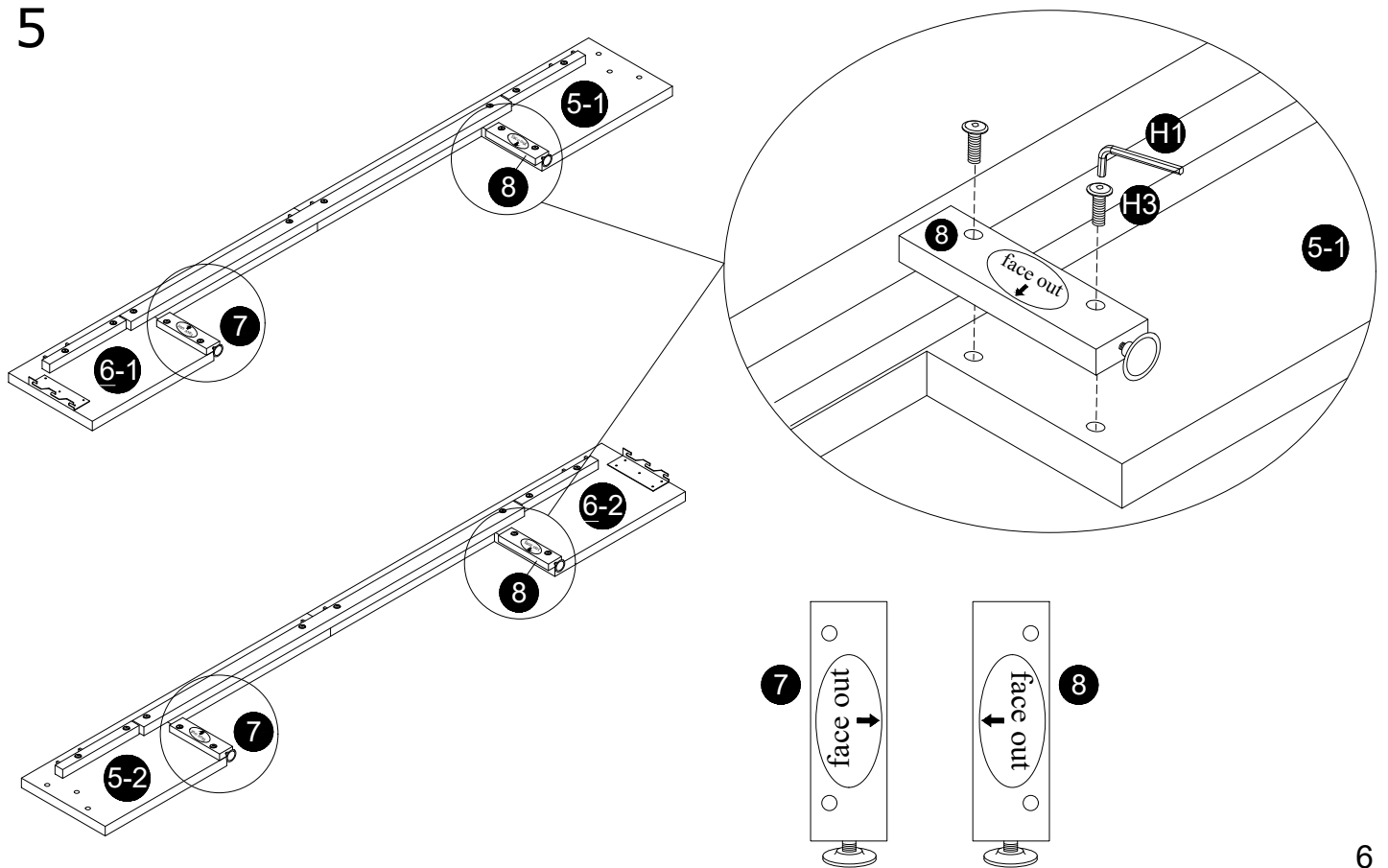

6

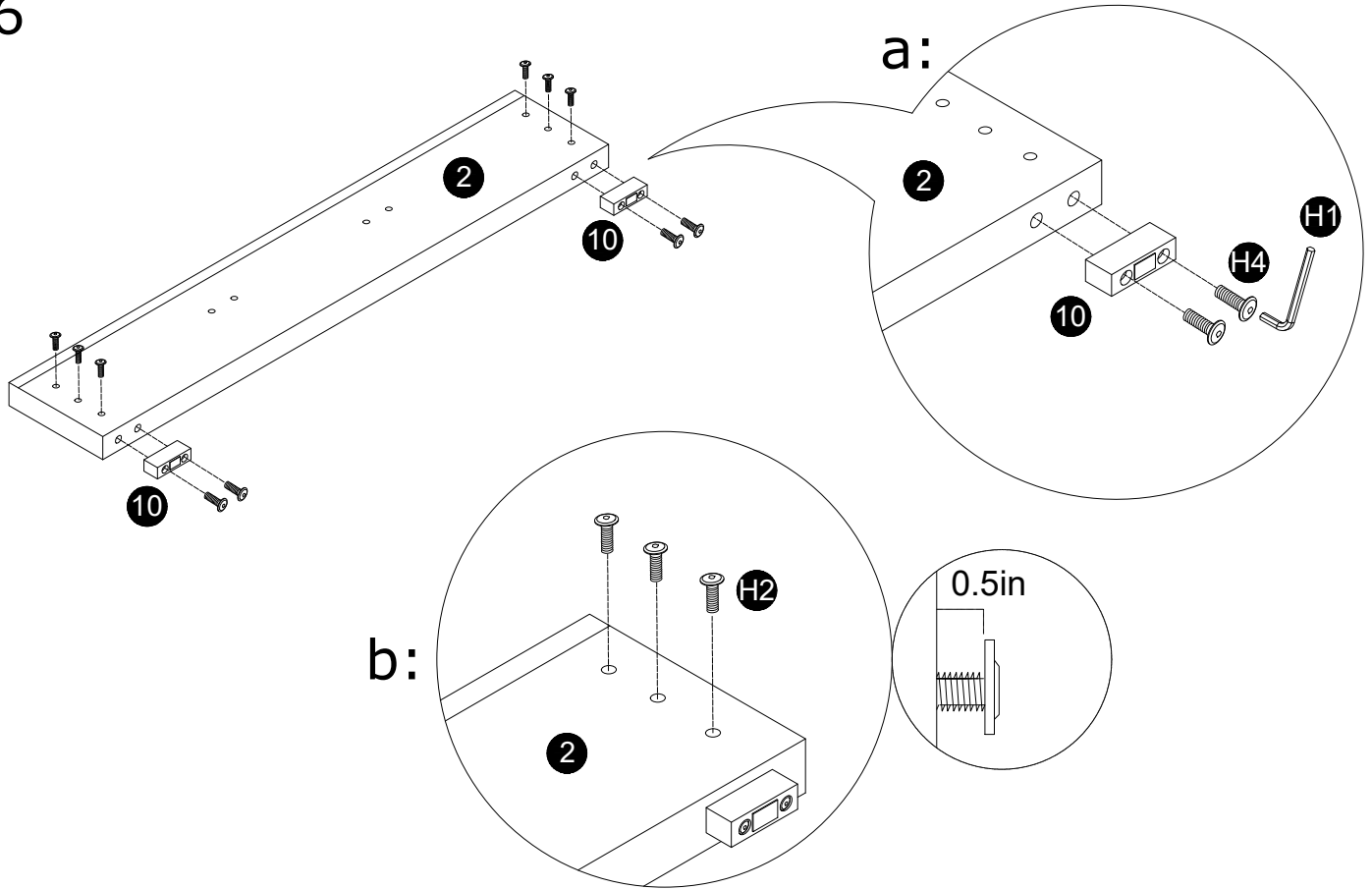

7

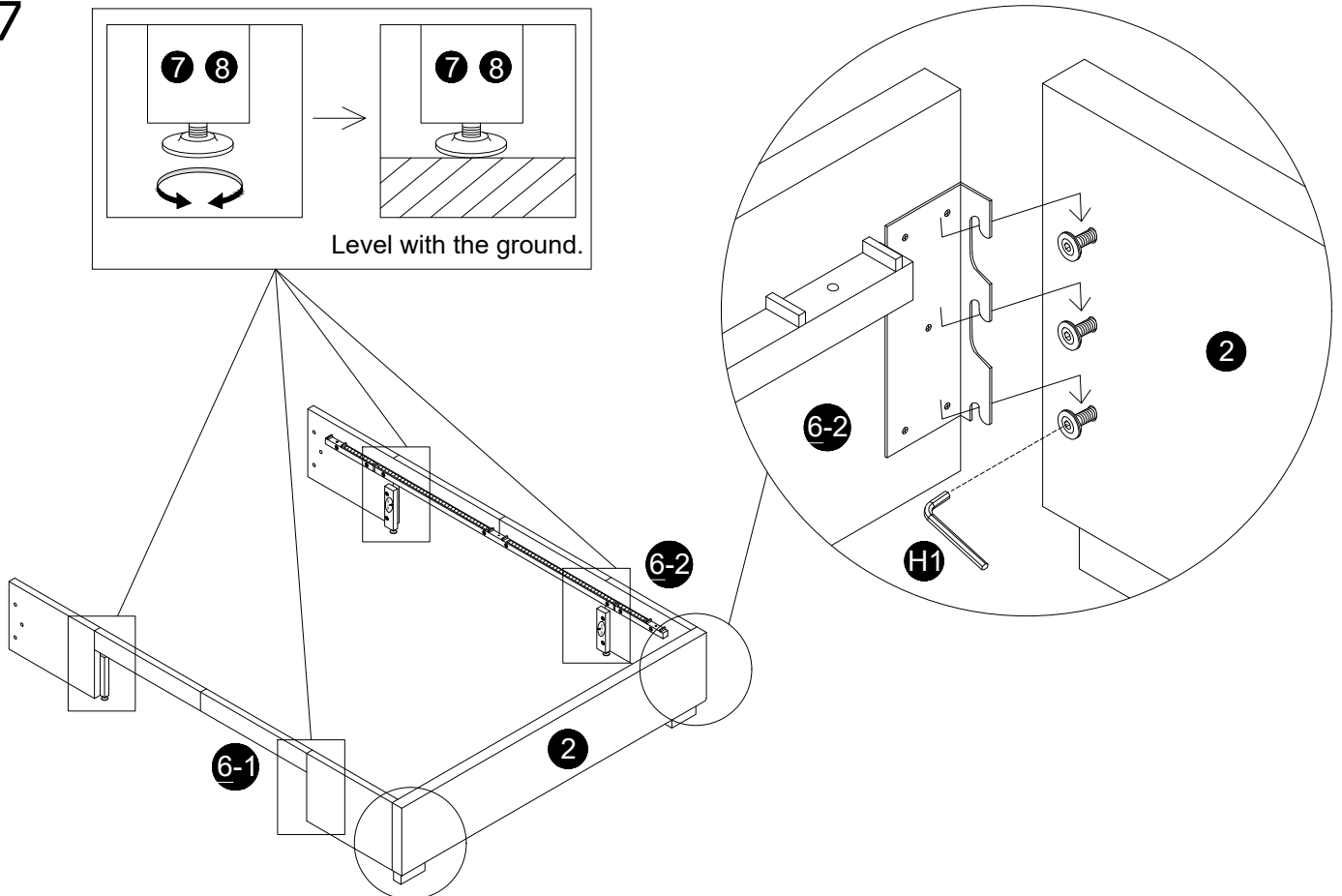

8

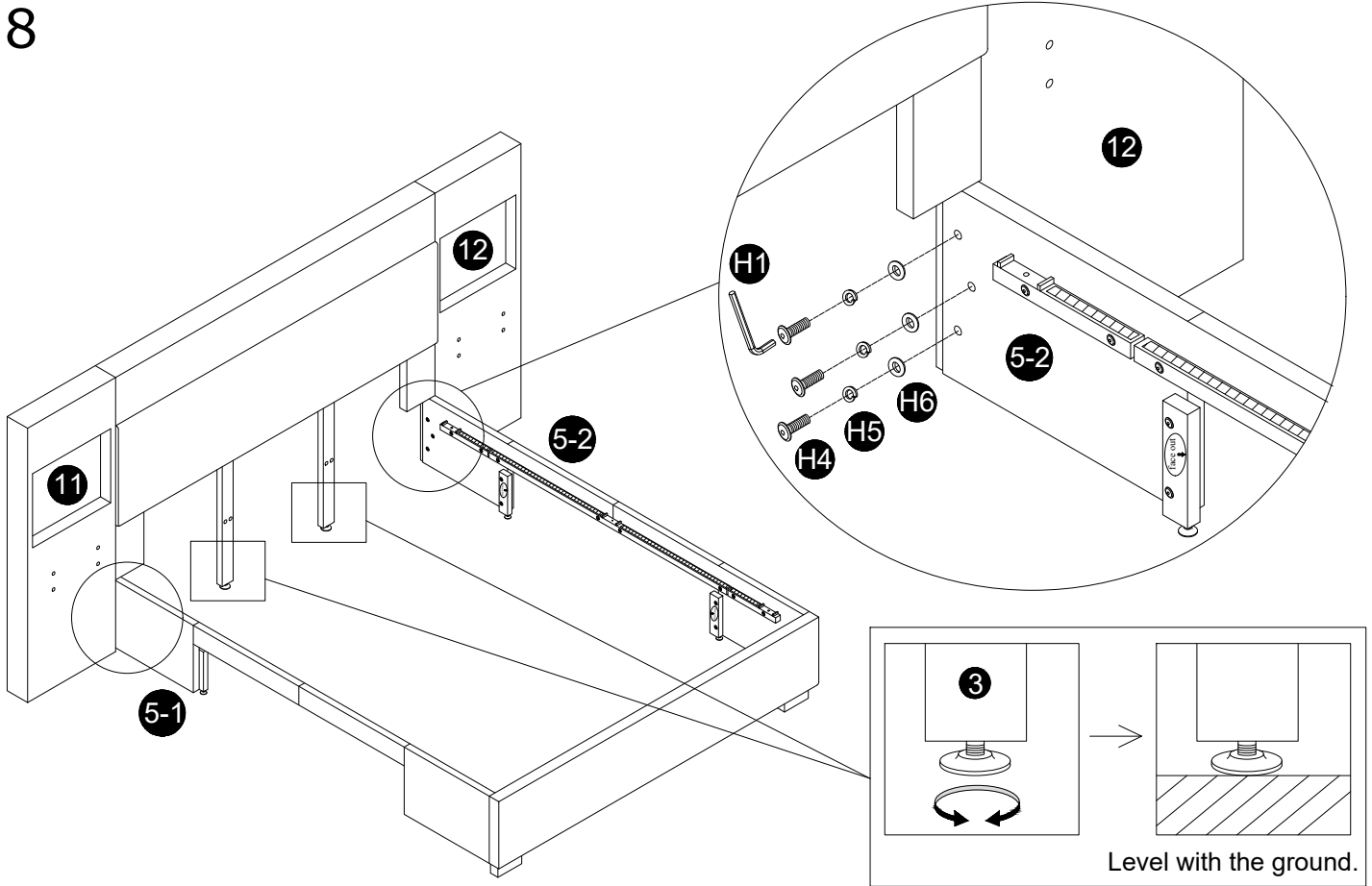

9

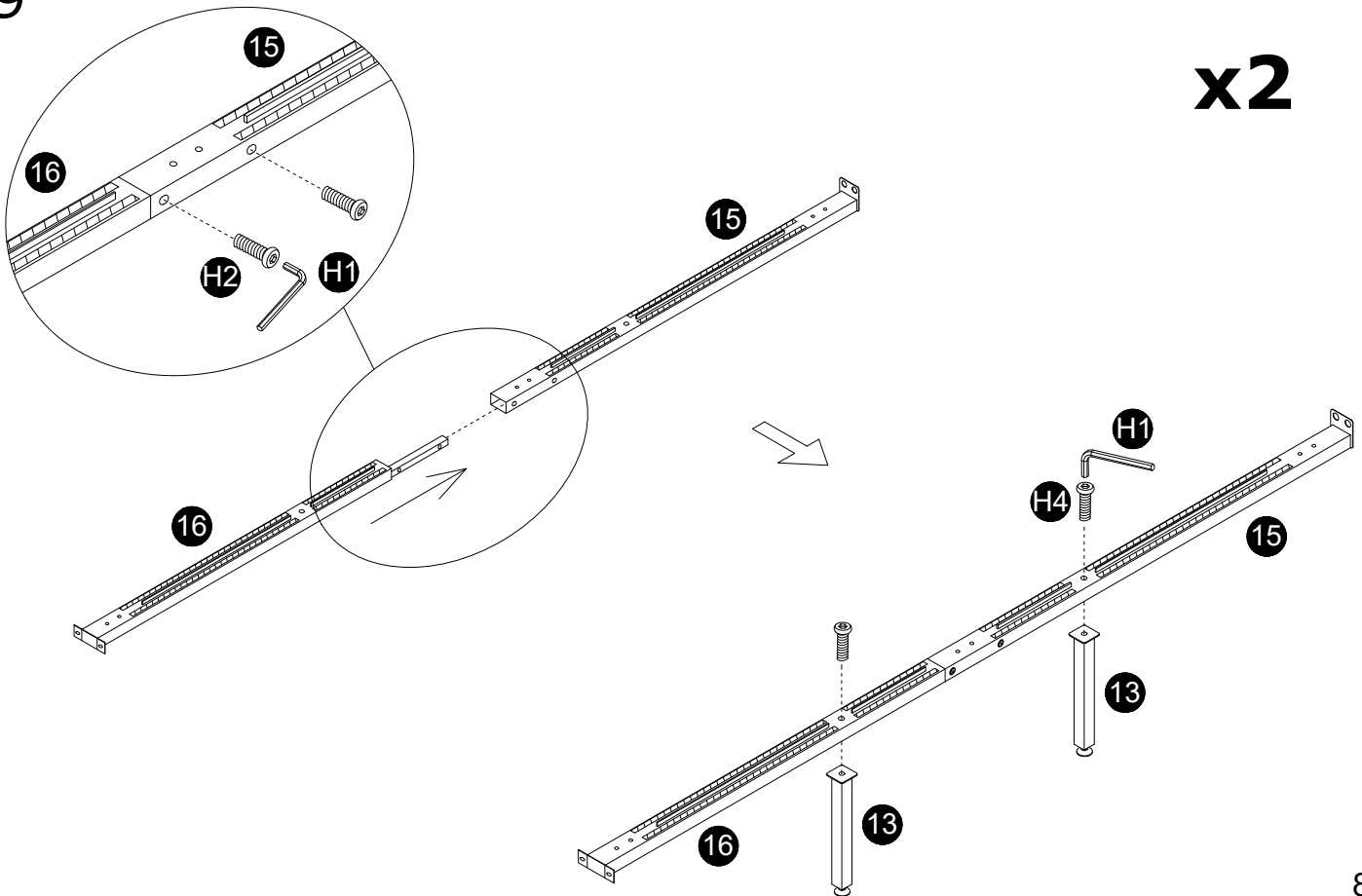

10

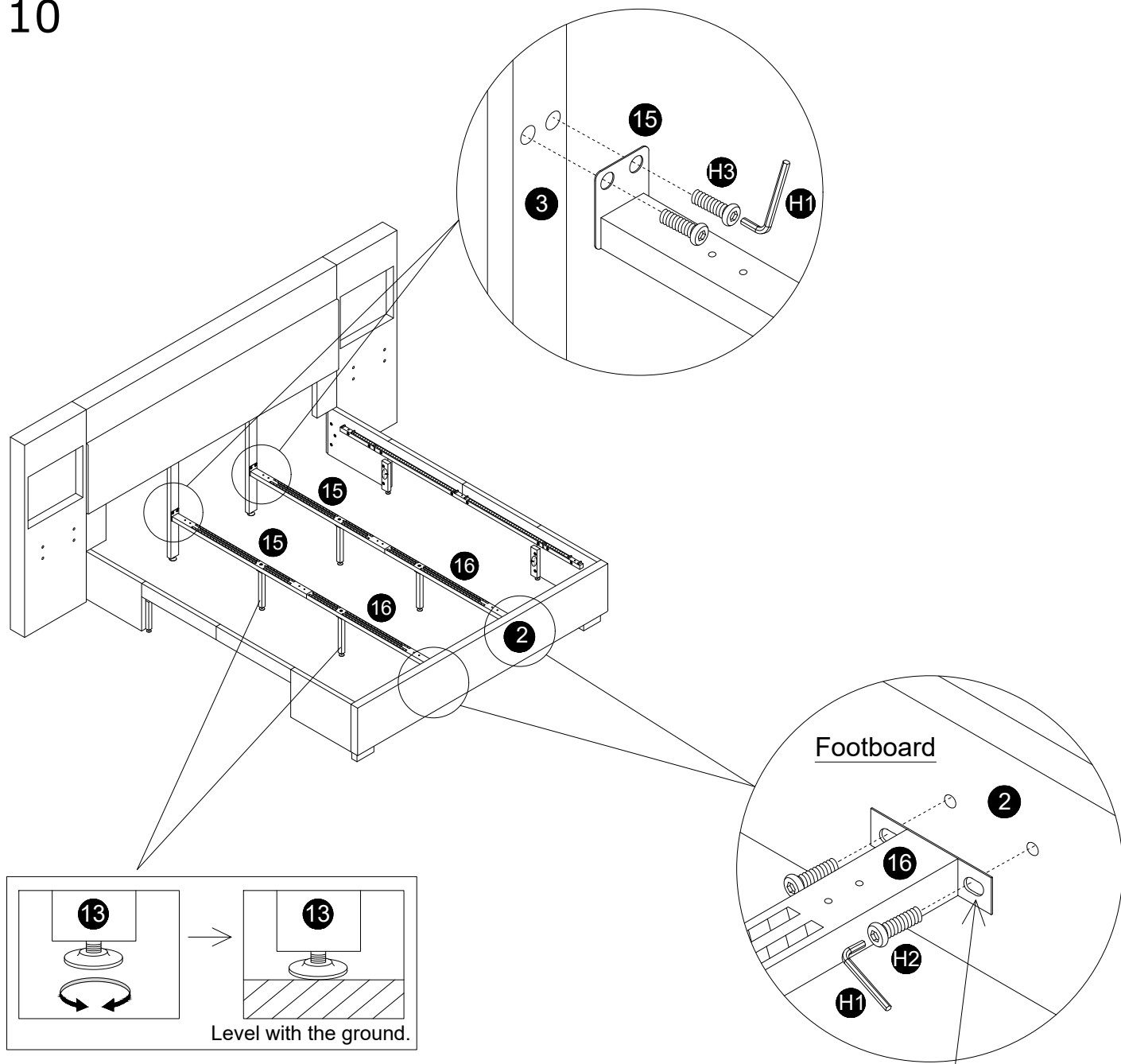

Bolts should be in center of long holes

11

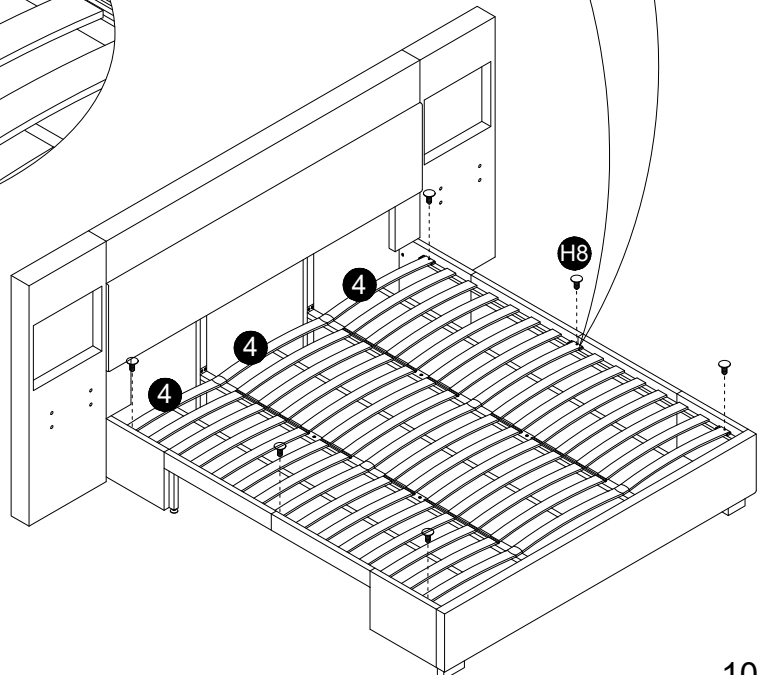
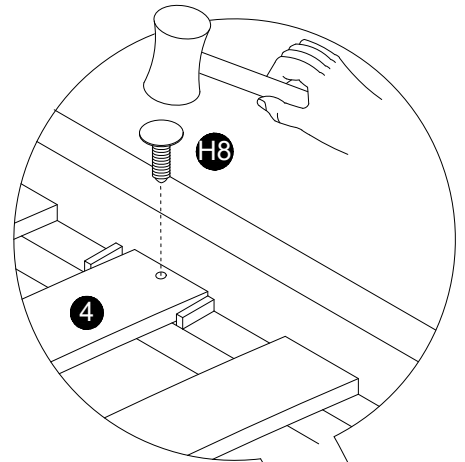
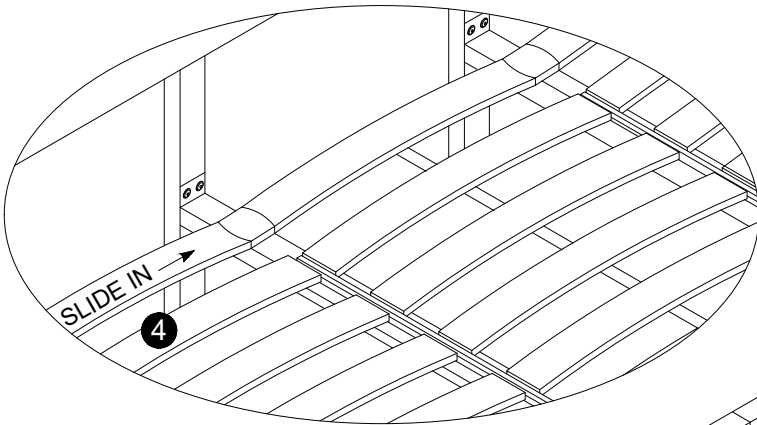
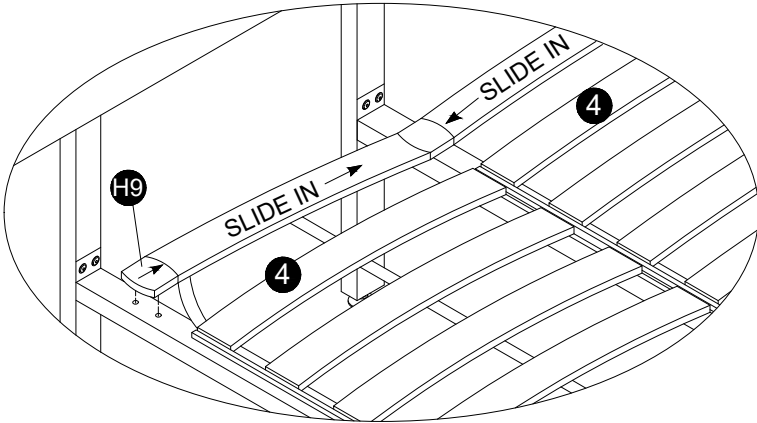
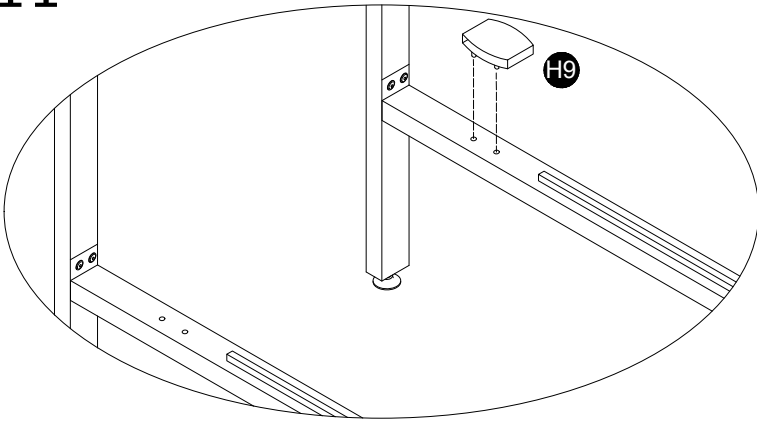

12

x2

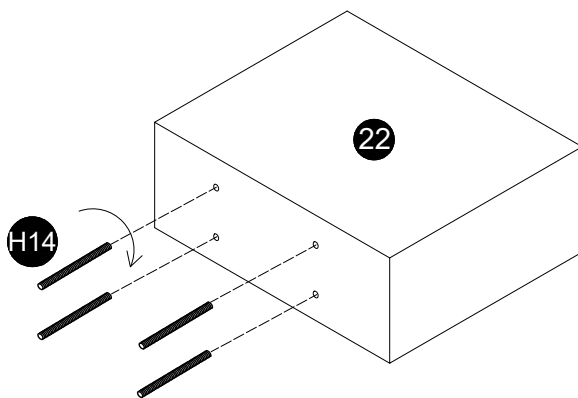

13

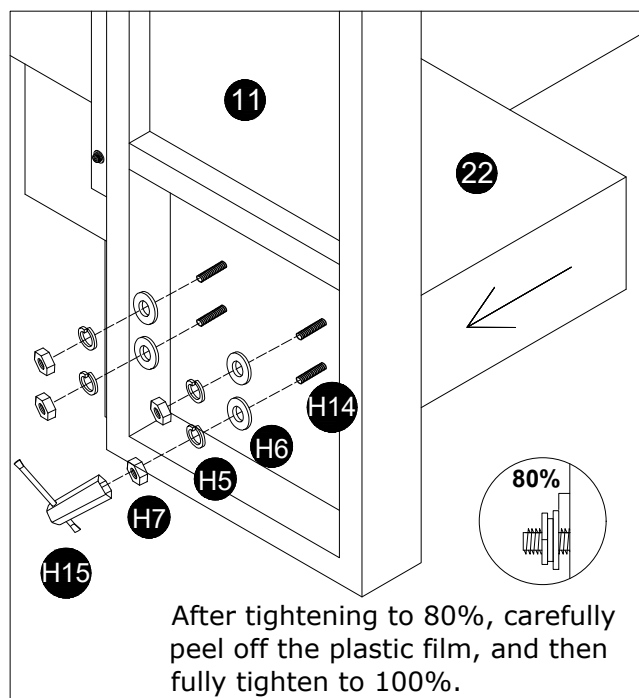

After tightening to 80%, carefully peel off the plastic film, and then fully tighten to 100%.

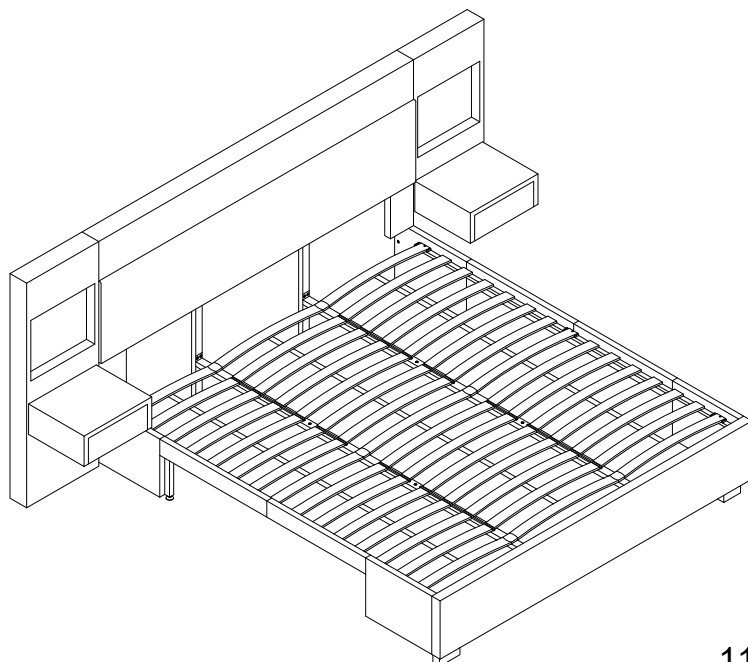
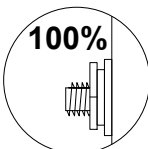
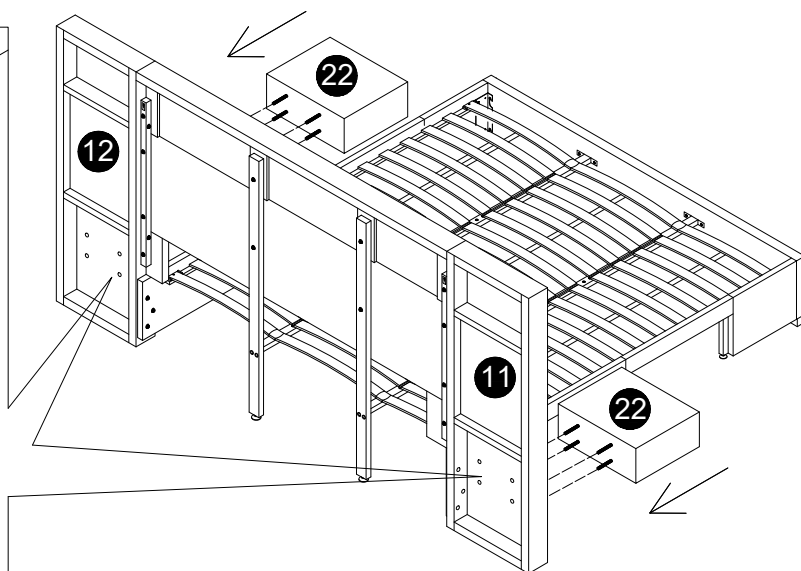

14

x2

Grooves to align

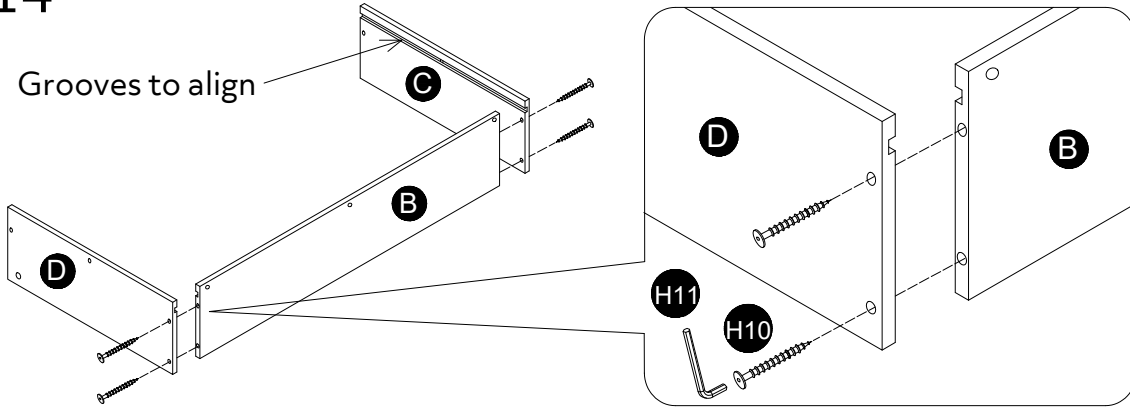

15

x2

a:

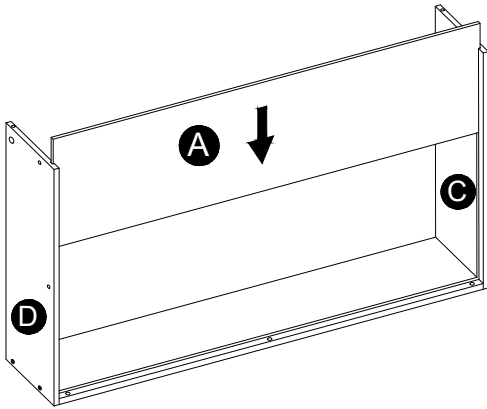

b:

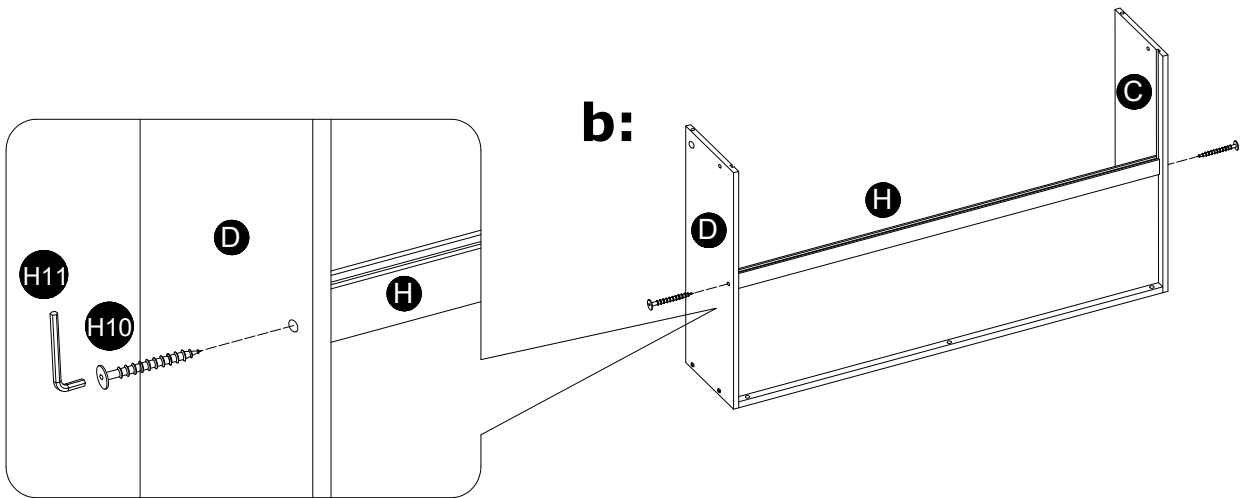

c:

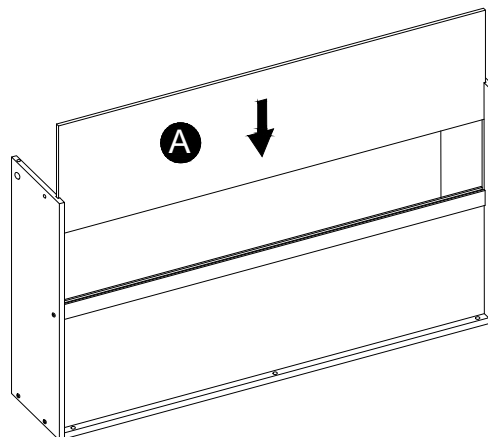

16

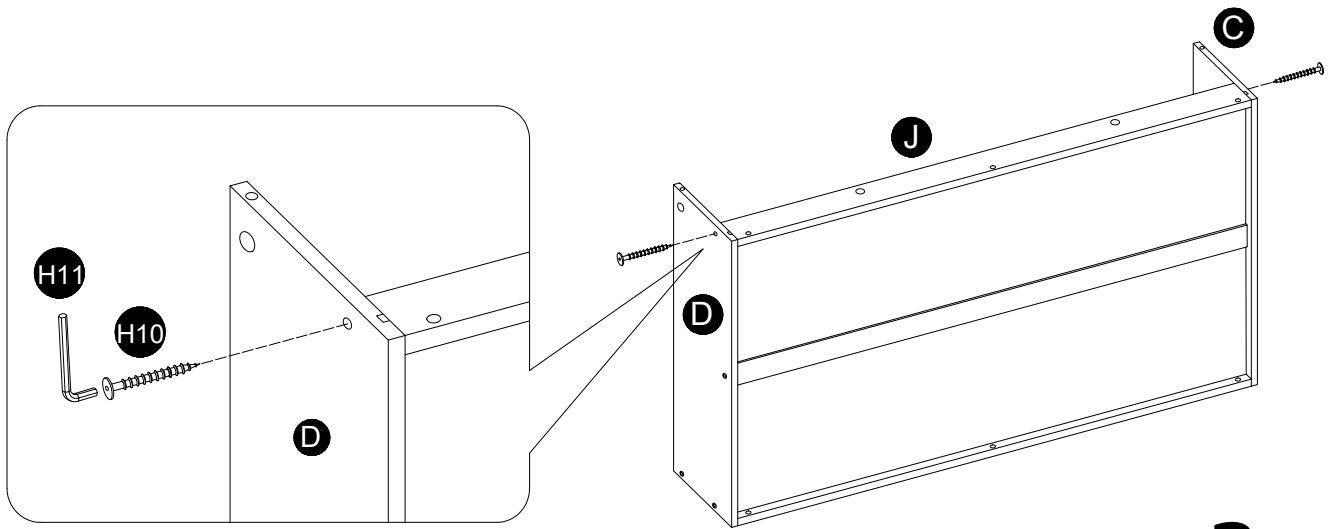

x2

17

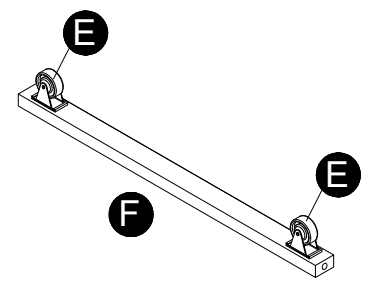
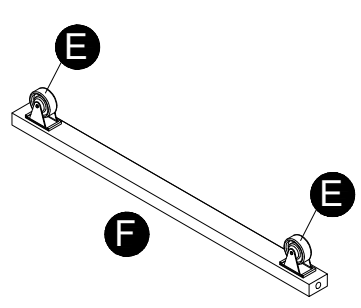

x2

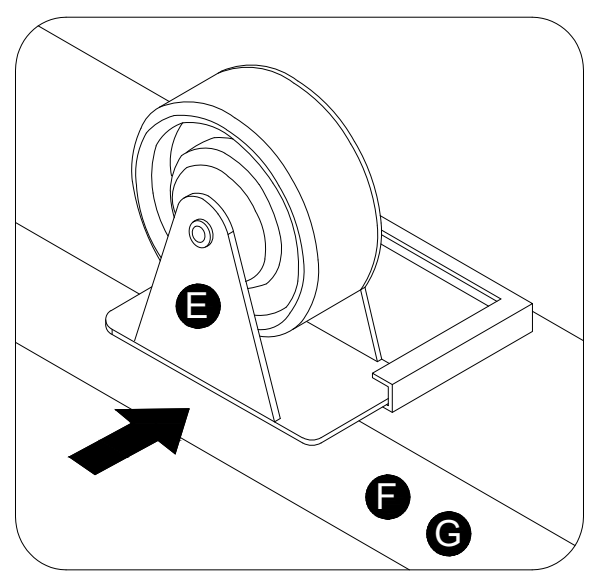
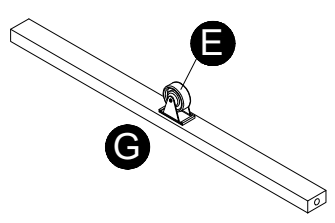

18 **x2**

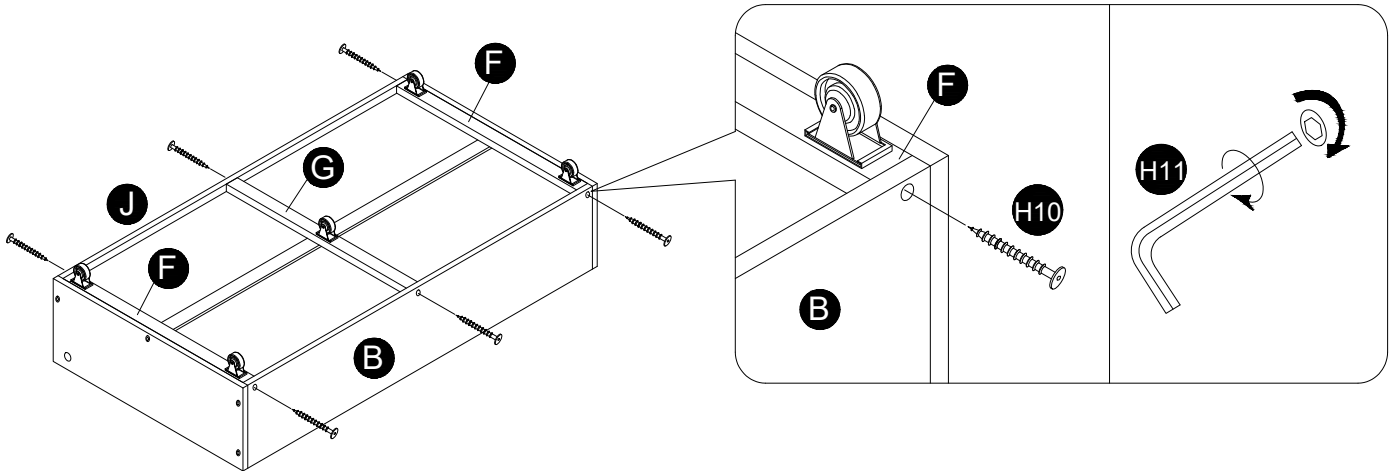

19 **x2**

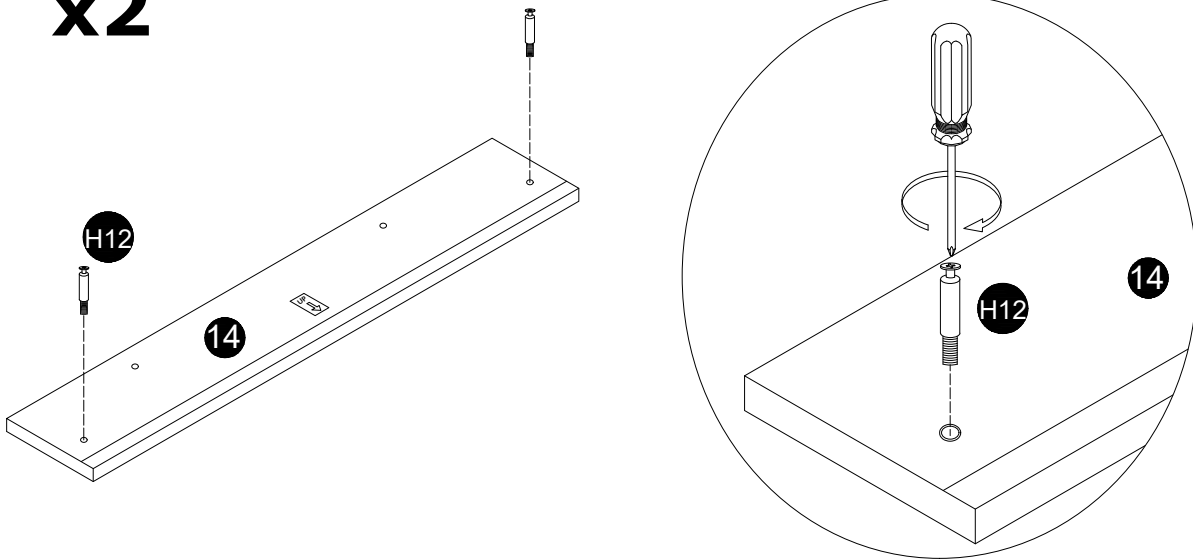

20 **x2**

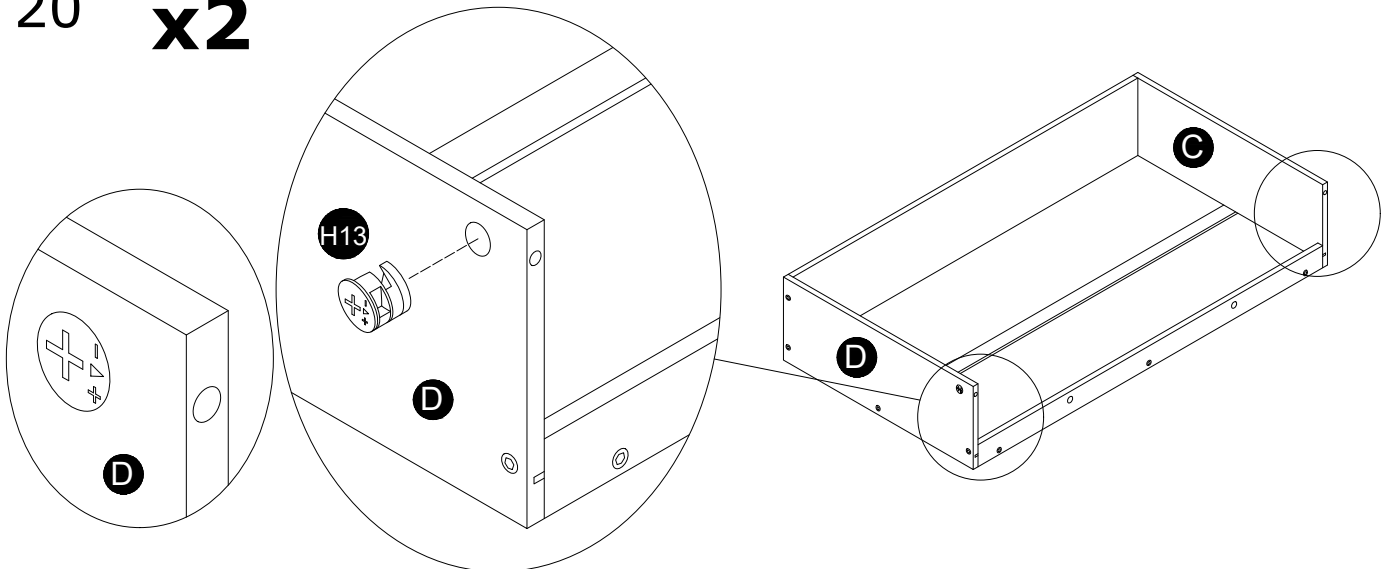

21 **x2**

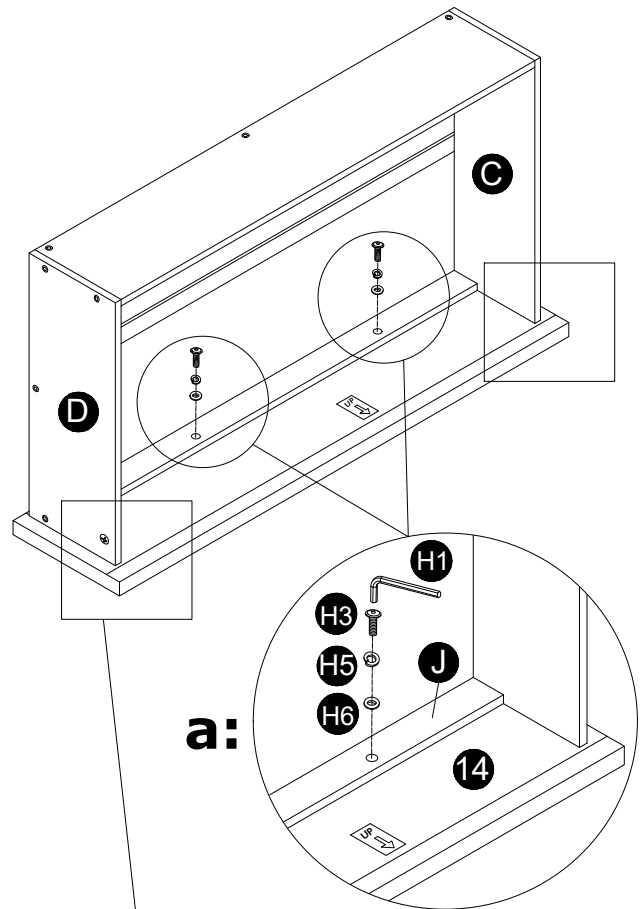
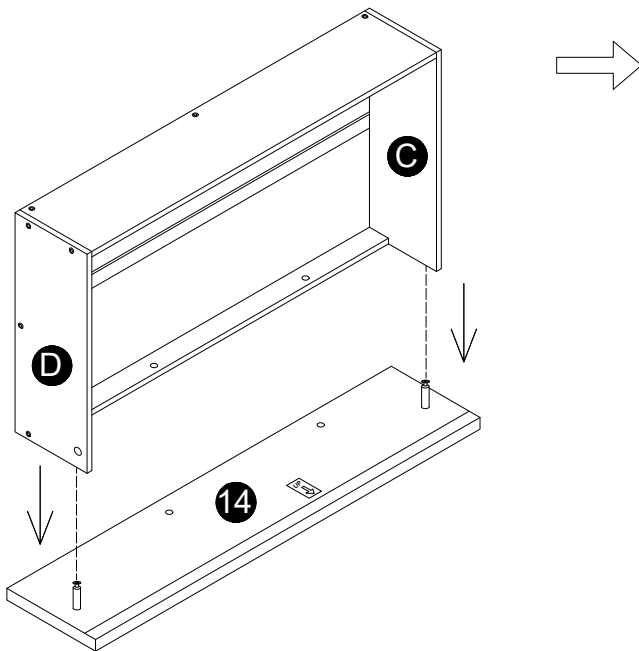

PUSH THE TWO PANELS TOGETHER ALLOWING THE DOWEL TO ALIGN WITH THE HOLE

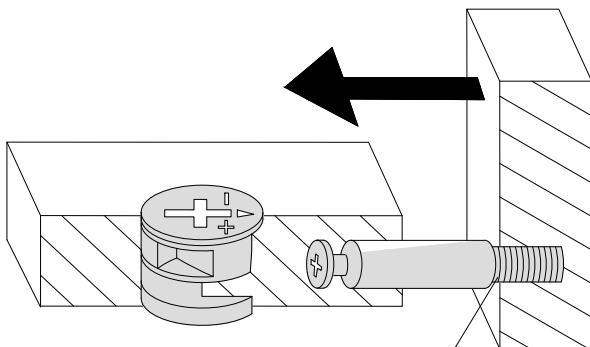

If H12 cannot lock into H13, you can adjust H12 outward by 2mm.

TURN THE CAM IN A CLOCKWISE DIRECTION

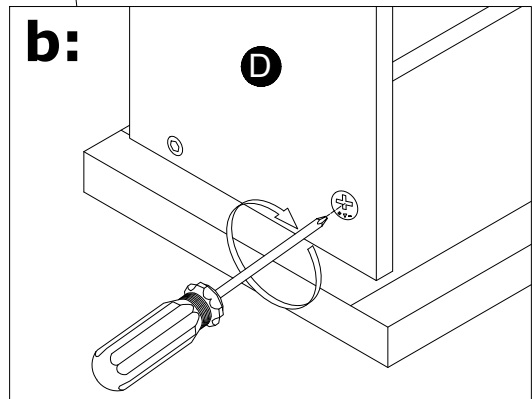
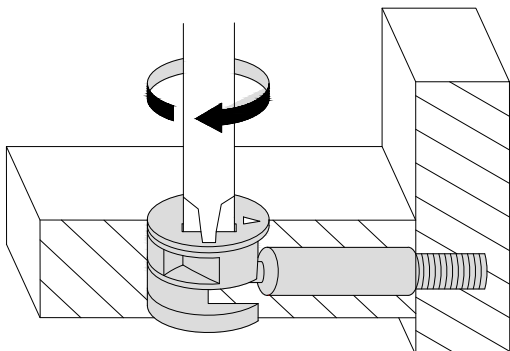

**DON'T STOP UNTIL THE 2 O'CLOCK LOCK**  
TURN THE CAM IN A CLOCKWISE DIRECTION UNTIL THE ARROW POINTS IN THE POSITIONS SHOWN IN THE DIAGRAMS BELOW

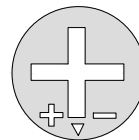

OPEN

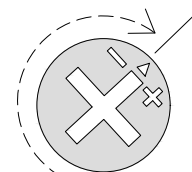

LOCKED

**Job Complete !**

*In the interest of our environment please dispose of all packaging thoughtfully.*