

# ELECTRONIC HANDLESET PROGRAMMING

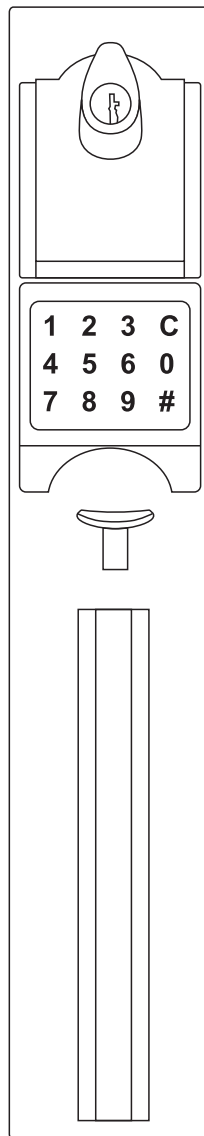

## 1. Factory Default Setting



### Explanation of Programming Code and User Code

The Programming Code and User Code are two distinct concepts within the electronic lock system.

#### Programming Code:

The programming code is used to enter the lock's programming mode, allowing the user to change settings, add or delete user codes. Essentially, it serves as an administrative password for managing the lock's configuration.

#### User Code:

The user code is the password used for daily unlocking. Each user can set one or more user codes to authorize different users for access.

### Explanation of Factory Default Settings

This lock is shipped with a 6-digit programming code and a 4-digit user code:  
\* Programming Code: 123456  
\* User Code: 0000

#### Programming Your Lock After Installation

For security purposes, after installation, you need to change the default "Programming Code 123456" and the default "User Code 0000" to new programming and user codes. (See Page 3 for programming instructions)

### Explanation on Resetting Programming Code or User Code

Please note that once you reset the programming code or user code, the factory default codes will no longer be valid. The default codes will only become active again if the lock is restored to factory setting

## 2. Locking and Unlocking Instructions

### To Lock

Manually rotate the thumbturn to engage the lock.

#### Note

For left-hand doors, turn the thumbturn to the right to lock; For right-hand doors, turn the thumbturn to the left to lock.

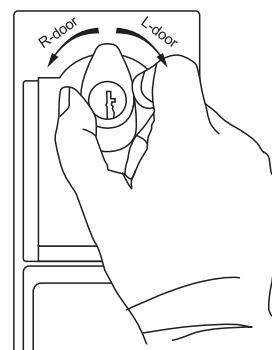

### To Unlock

1. Touch three fingers across the screen. (This will illuminate the number keys.)
2. Enter the user code.
3. Manually rotate the thumbturn to disengage the lock.

#### Note

For left-hand doors, turn the thumbturn to the right to unlock. For right-hand doors, turn the thumbturn to the left to unlock.

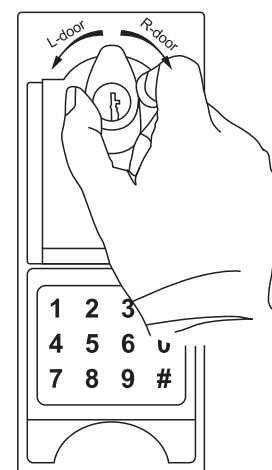

## 3. Testing the Lock Functionality

To ensure the lock is functioning correctly after installation, you can use the factory default 4-digit user code "0000" to perform a simple test. Follow the steps below to verify that the lock is operating as expected.

- STEP1:** Lock the door from the outside. (Please carry your key to avoid being locked out.)  
**STEP2:** Wake up the screen by swiping your fingers across it.  
**STEP3:** Enter the factory default user code "0000".  
**STEP4:** Manually turn the thumbturn to unlock the door.

## 4. Programming Code Setup

### Setting the Program Code (6-digit number)

- STEP1:** Wake up the lock by swiping your fingers across the screen.  
The number keys will illuminate.
- STEP2:** Press and hold the # button for 5 seconds.  
The orange LED lights up, and a "Do So Mi" tone sounds, indicating that the lock is in programming mode. (Note: The system will exit programming mode if inactive for 15 seconds.)
- STEP3:** Enter the current 6-digit programming code.  
The green LED flashes once, and a "Do Re Mi" tone confirms successful authorization.
- STEP4:** Press 1 to set a new programming code.  
The green LED flashes once, accompanied by a single beep.
- STEP5:** Enter the new 6-digit programming code.  
The green LED flashes once, followed by a single beep.
- STEP6:** Re-enter the new 6-digit programming code to confirm.  
The green LED flashes once, and a "Do Re Mi" tone confirms successful programming.
- STEP7:** Press C to exit programming mode.

**Note:** Once the program code is reset, the factory default program code (123456) will no longer be valid, unless the lock is restored to factory settings.

## 5. User Code Setup

### Setting the User Code (6-digit number)

- STEP1:** Wake up the lock by swiping your fingers across the screen.  
The number keys will illuminate.
- STEP2:** Press and hold the # button for 5 seconds.  
The orange LED lights up, and a "Do So Mi" tone sounds, indicating that the lock is in programming mode. (Note: The system will exit programming mode if inactive for 15 seconds.)
- STEP3:** Enter the current 6-digit programming code.  
The green LED flashes once, and a "Do Re Mi" tone confirms successful authorization.
- STEP4:** Press 2 to set a new user code.  
The green LED flashes once, accompanied by a single beep.
- STEP5:** Enter the new 6-digit user code.  
The green LED flashes once, followed by a single beep.
- STEP6:** Re-enter the new 6-digit user code to confirm.  
The green LED flashes once, and a "Do Re Mi" tone confirms successful programming.
- STEP7:** Press C to exit programming mode.

**Note:** Once the user code is successfully set, the factory default user code (0000) will no longer be valid, unless the lock is restored to factory settings.

## 6. Additional Settings

### Add User Code (6 digits) (Store up to 20 User Codes)

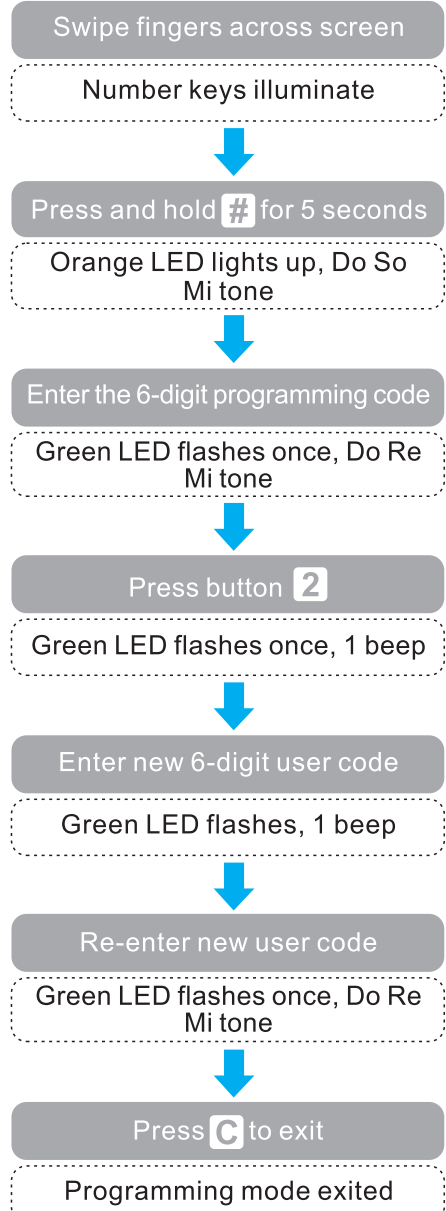

5

### Delete User Code

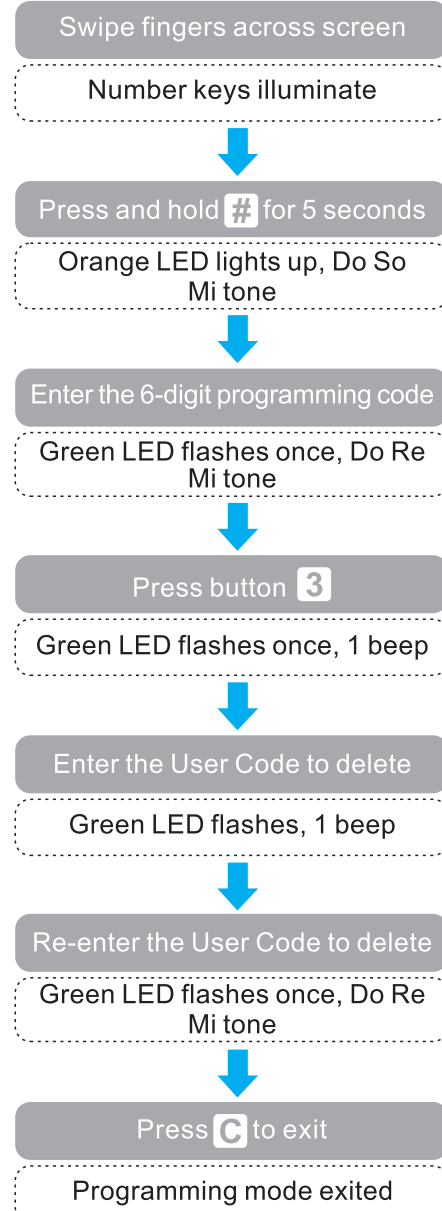

### Enable/Disable All User Codes

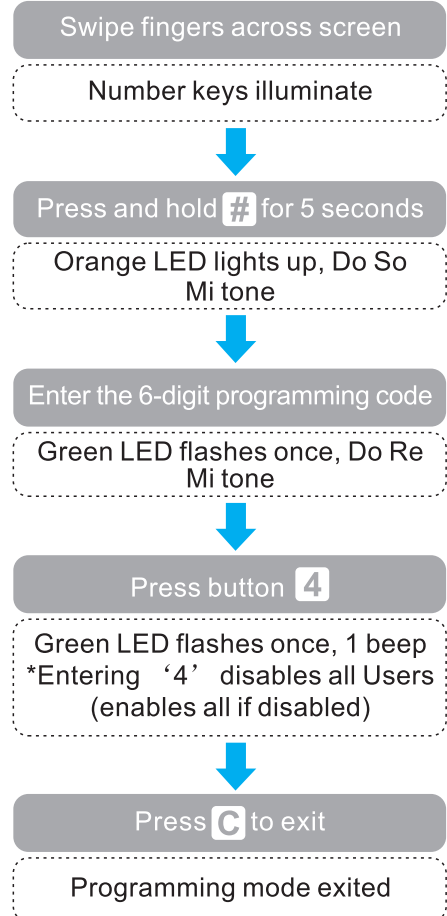

6

### Delete All User Code

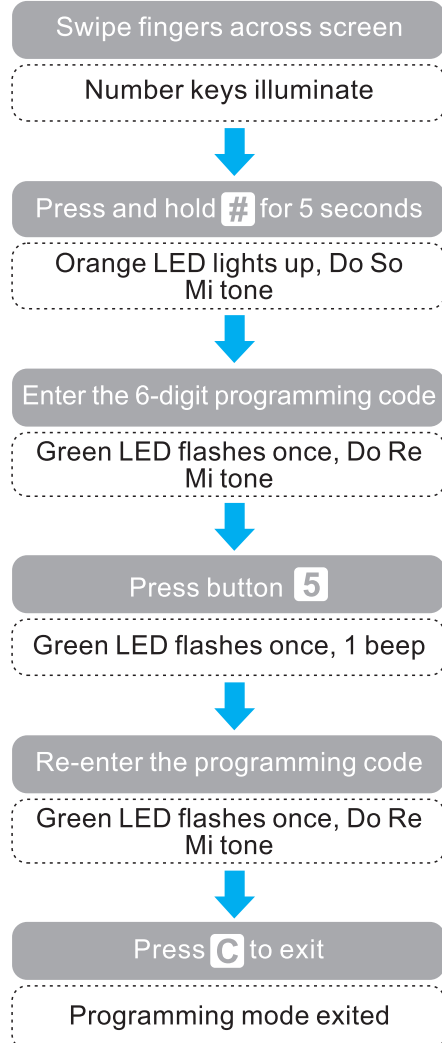

## 7. Keypad Operation - Beep

FUNCTION	INDICATORS
Valid Code	*1 <b>Green</b> LED flashes *1 beep ( <b>do re mi</b> )
Invalid Code/Access Denied*	*2 <b>Red</b> LED flashes *2 short beeps
Low Battery	*4 <b>Red</b> LED flashes *4 short beeps

7

### Turn Beeper On/Off

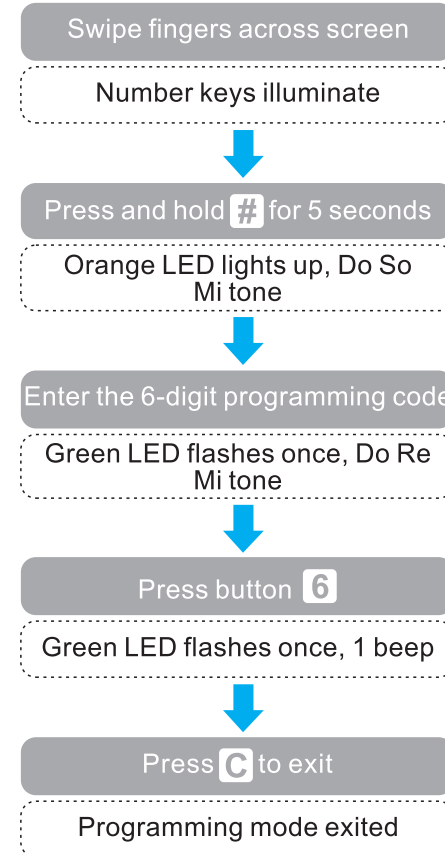

Blackout Battery\*\*

\*1 long **Red** LED flash  
\*4 long beeps

If 5 consecutive incorrect codes are entered, the lock emits 4 short beeps and a flashing Red. The lock will not accept additional input for 20 seconds. When the next valid code is entered the lock will beep quickly 5 times to alert of the incorrect codes.

## 8. Restoring the Lock to Factory Default

**STEP 1.** Press and hold RESET button for 12 seconds as shown in figure

**STEP 2.** Number keys illuminate and flash 5 beeps

**STEP 3.** 1 GREEN LED flash  
1 beep (**do re mi**)

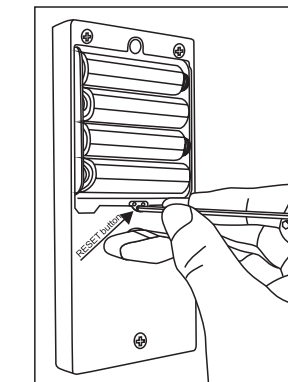

## 9. Troubleshooting

- Issue:** If you are unable to unlock the door after entering the code  
**Solution:** You need to manually rotate the thumbturn to unlock the door. (Refer to page 2 of the manual for details.)
- Issue:** If you unable to lock the door from outside by rotate the thumbturn  
**Solution:** This is likely due to an incorrect left-hand or right-hand setting. You will need to reinstall the lock. Please follow the guidance in the installation manual to correctly set the left-hand or right-hand configuration. (Refer to the installation manual or scan the QR code on the battery cover for the digital version of the manual.)
- Issue:** Forgot the programming code or user code.  
**Solution:** Restore the lock to factory settings. (Refer to page 8 of the manual for details.)
- Issue:** The lock screen does not get woken up.  
**Solution:** Check the battery power or verify if the lock's internal connection interface has become disconnected.  
**For any other issues, please contact our customer service. We will respond within 24 hours.**

8

# ELECTRONIC HANDLESET INSTALLATION INSTRUCTIONS

### 1. MARK DOOR

Use template enclosed to mark holes on door face

Make mark for 1" (25.4 mm) hole on center of door edges

Make mark for 2-1/8" (54mm) hole on door face

Height 36" to 38" (914mm - 965mm) from floor

### 2. DRILL HOLES

- Drill 2-1/8" (54mm) hole
- Drill 2-1/8" (54mm) hole
- Drill 25.4mm (1") hole for DEADBOLT latch.
- Drill 25.4mm (1") hole for GRIPSET latch.
- Drill 7/16" (11mm) hole for exterior handle mounting screw

1" (25.4mm) holes

2-1/8" (54mm) hole

7/16" (11mm) hole

### 3. INSTALL LATCHES

- Insert latches in holes, keeping parallel to edge of door mark outline and remove latch.
- Chisel 1/8" (3mm) deep or until latch face is flush with door edge. Note: cut out must be parallel to edges of door
- Insert GRIPSET latch and secure with wood screws. Insert DEADBOLT latch and secure with wood screws

Top DEADBOLT latch

Bottom GRIPSET latch

Chisel 1/8" (3mm) deep

Note: watch the up mark stamped on deadbolt latch

### NOTICE

**Adjustable Latch**

60mm (2-3/8") BACKSET

70mm (2-3/4") BACKSET

**Adjustable Latch**

60mm (2-3/8") BACKSET

70mm (2-3/4") BACKSET

### 4. Determine Door Orientation and Match Lock Configuration

- Confirm whether the door is left-opening or right-opening.
- Match the lock to the left-opening or right-opening setting.
- How to adjust the lock for left-opening or right-opening door settings.

R-door

L-door

Pull out and turn the tailpiece to change direction

**IMPORTANT:**  
The lock must be correctly set for left-opening or right-opening doors, otherwise, it will not unlock.

### 5. INSTALL EXTERIOR HANDLE

Place exterior handle with stems and square spindle into latch as shown press tightly against door face

Exterior handle

Stems

Square spindle

**NOTICE**  
The stem can be moved to the position you need according to the door hole.

### 6. INSTALL INTERIOR MECHANISM

Secure and fasten the interior mechanism firmly through the screws respectively as shown in figure

Machine screws

Pass through the square hole

Machine screws

Machine screw

Washer

Decorative cover

### NOTICE

42mm (1-21/32")	35mm (1-3/8")
Long screws for door thickness 45-51mm (1-3/4" to 2")	Short screws for door thickness 35-45mm (1-3/8" to 1-3/4")

Short screws

Connect together

Four batteries No.5

Short screw

### 7. MARK JAMB

- Close door until latchbolt touches door jamb. Mark door jamb as shown with a pencil.
- Center the strike plates on the door jamb.

Jamb

Center of strike

Center of strike

### 8. MARK OUTLINE OF STRIKES

- Measure one half of door thickness from door stop and mark vertical centerline of jamb
- Mark horizontal line through center of strike
- Where the lines meet, mark drill points
- Place strikes in position and mark outline of strike plates.

Vertical centerline of jamb

horizontal line

Drill point

Door stop

Mark outline of strike plates

### 9. DRILL HOLES AND INSTALL STRIKES

- Drill 1" (25.4mm) hole in door jamb, 1" (25.4mm) deep.
- Chisel outline for strike plates 1/16" (1.5mm) deep or until plates are flush with door jamb
- Install strikes plates and secure with wood screws

A

B

C

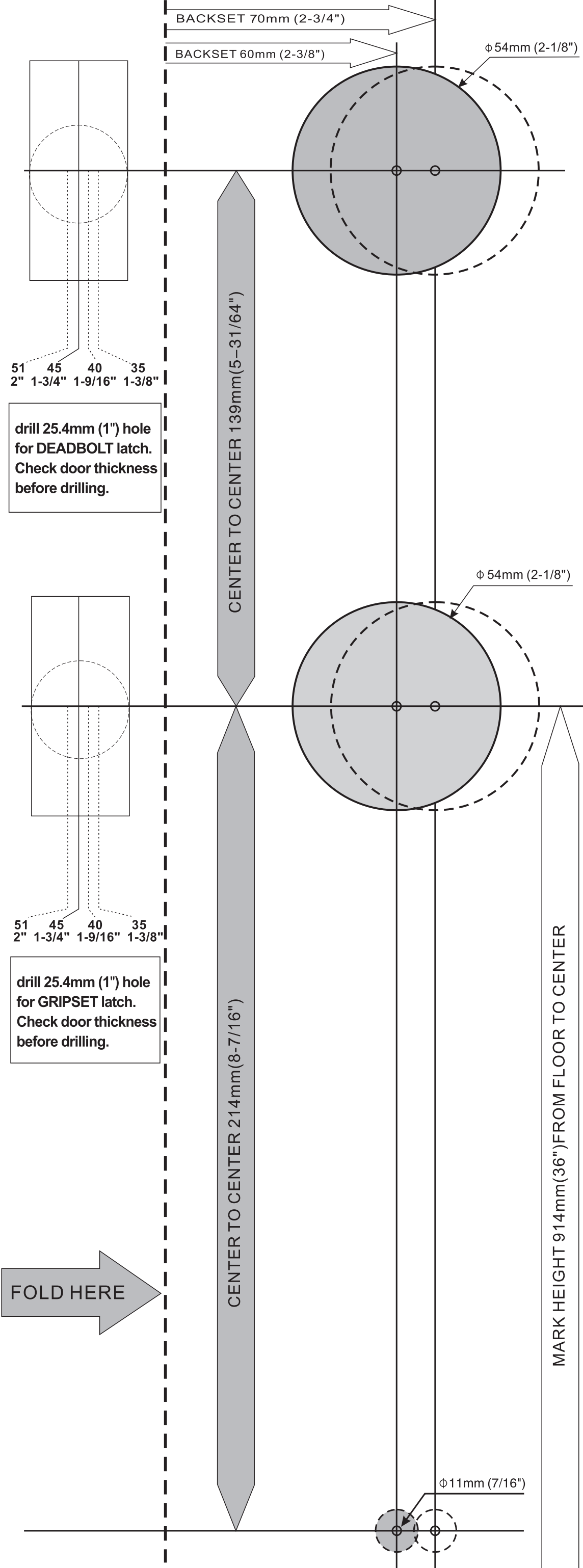

drill 25.4mm (1") hole for DEADBOLT latch. Check door thickness before drilling.

drill 25.4mm (1") hole for GRIPSET latch. Check door thickness before drilling.

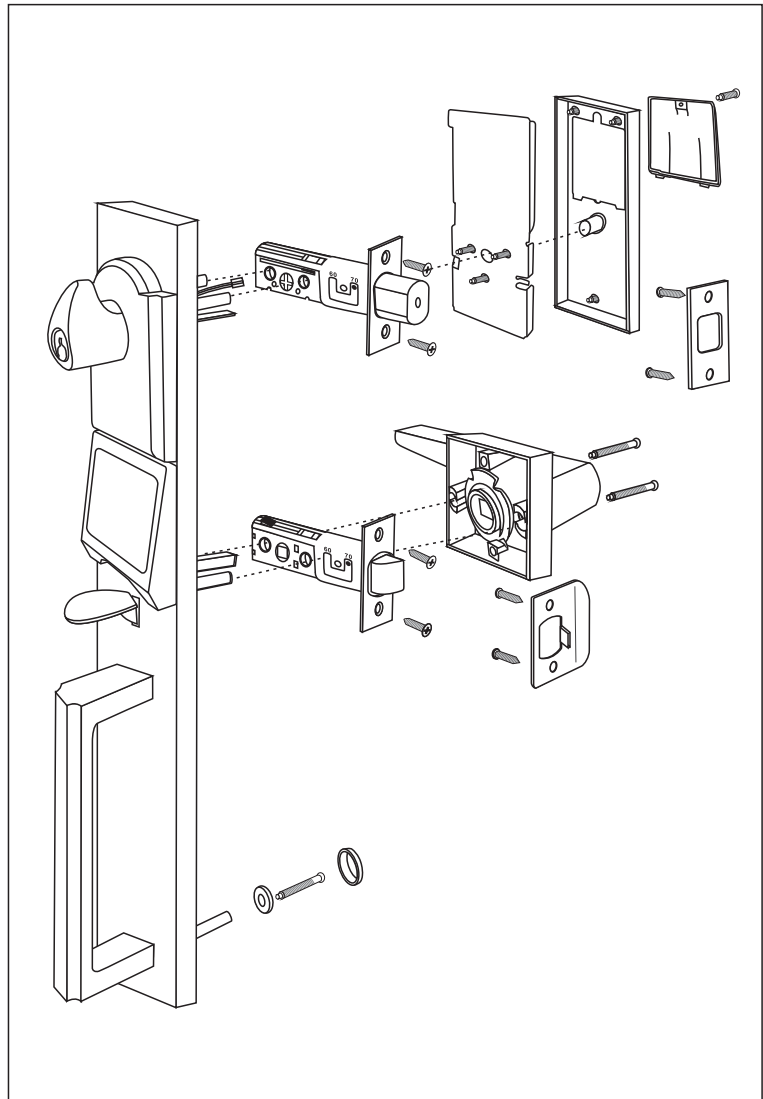

**HOLE DIAMETERS:**

A=2-1/8"  
B=1"  
C=7/16"  
D=2-1/8"  
E=1"

**TOOL REQUIRED :**

- PHILLIPS HEAD SCREWDRIVER
- 3/8" ELECTRIC POWER DRILL
- 2-1/8" 1" AND 7/16" DRILL BITS
- 1" CHISEL
- HAMMER

