

Assembly Instruction Sheet for Model HL562689

Package Contents

Part	Description	Quantity
A	Mounting Bracket	1 pc.
B	Fixture Body	1 pc.

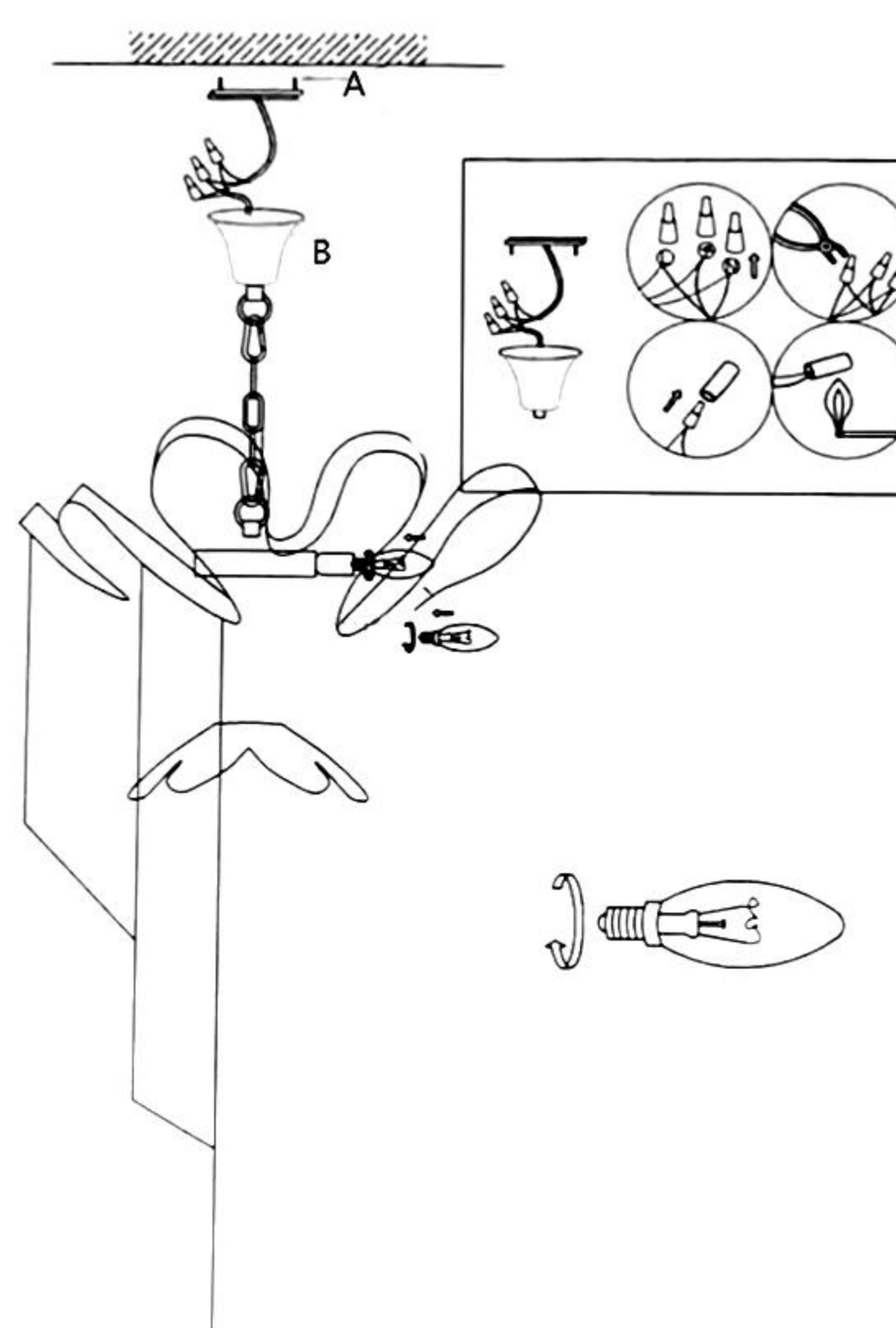

- Maintenance
1. Turn off the power and pick up the lights.
 2. Do not clean the lamp with a wet wipe
 3. Clean the lamp with dry fabric
 4. Clean the lamp with special wax or liquid
 5. Do not scratch the surface of the lamp

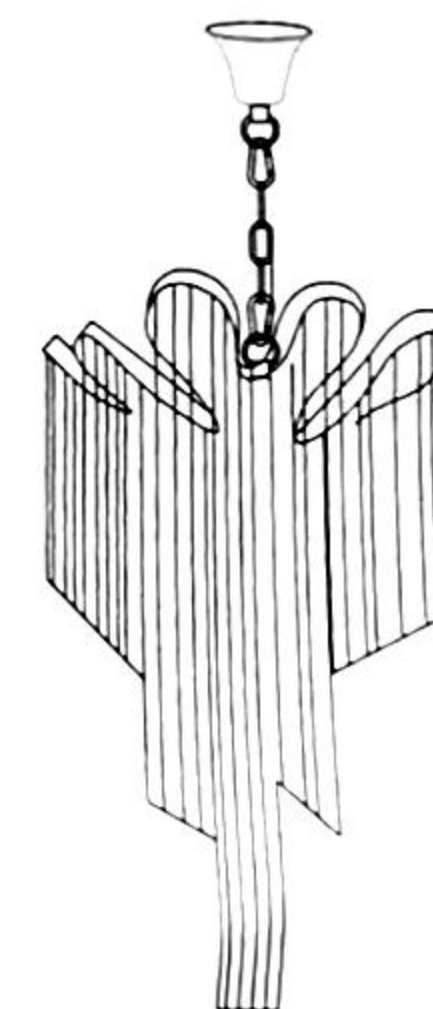

STEP 1

Mark the drilling position on ceiling with the help of the Mounting Bracket(A).
Drill holes on the marks and stick the expansion anchors into the holes.
Fix the Mounting Bracket(A) to the expansion anchors with self-tapping screws.

STEP 2

Hold the fixture close to the ceiling.
Connect live line to wire color Black/Red from the canopy of Fixture Body(B).
Connect neutral line to wire color White/Blue from the canopy of Fixture Body(B).
If two wires are identical, the wires do not distinguish between a live line and a neutral line.

STEP 3

Attach the canopy of Fixture Body(B) to the Mounting Bracket(A).

STEP 4

Insert your bulb into the bulb base.

Your fixture is now assembled and ready to use.