



## CARE INSTRUCTIONS FOR CONCRETE SINKS

### Thank You for Choosing an Eden Bath™ Concrete Sink!

To help you stay as happy with your Eden Bath™ concrete sink as the day it was installed, please follow the cleaning instructions provided in this document. If you have other questions, please feel free to contact our Customer Service department at 1.877.578.5584 or [sales@edenbath.com](mailto:sales@edenbath.com). For more information about your Eden Bath™ sink, please visit our website at [www.EdenBath.com](http://www.EdenBath.com).

### GENERAL

Your Eden Bath™ concrete sink has been handcrafted to be functional and to look amazing at the same time. Please be proud of the fact that no other sink in the world will ever look exactly as yours. The fact that your sink has been handmade using only natural raw materials guarantees its uniqueness.

We have worked hard to deliver a **CARE FREE** product, and we would like to provide some tips to maintain the look and functionality of your sinks for years to come.

### CLEANING YOUR SINKS

We have selected the easiest finishes to care for and maintain. Your sink's surface has been treated with an industrial sealing product to provide full waterproofness.

A gentle soap with a medium pH, diluted in warm water will remove dirt and keep your finish like new. Alternatively, you could use a mixture of 1 ounce (30 grams) of white vinegar to every 1 gallon (3.8 Liters) of warm water.

Most household cleaners contain harsh chemicals that could damage the look and protection of the finish.

Ammonia-based glass and floor cleaners are examples of products that contain ingredients that have an adverse effect on the protection of the sink's surface.

Avoid using any sort of solvent, acids, cutting or abrasive materials for daily care.

These products may attack the coating and reduce the waterproofness of your sink in time.

In the unfortunate event that your sink's coating needs to be redone, don't worry! It's easier than you think to renew your sink.

A bit of sandpaper, a damp cloth and a few drops of a sealing agent, and the job is done.

All Eden Bath products are covered under a 1 year limited warranty against manufacturing defects.

The following installation guide and its associated photos are merely an informative example of how a vessel sink is installed and may not be an exact representation of the sink you are installing. We recommend that installation should only be completed by a trained plumber. Eden Bath, its dealers, and affiliates take no responsibility for the information provided below and will not be liable for any misuse or damages caused by using this information.

## Vessel Sink Installation



Above Counter Installation



Recessed Installation

Above: Above Counter Vs. Recessed Installation



Above: Process for "Above Counter Mounting"



Above: Process for "Recessed Mounting"

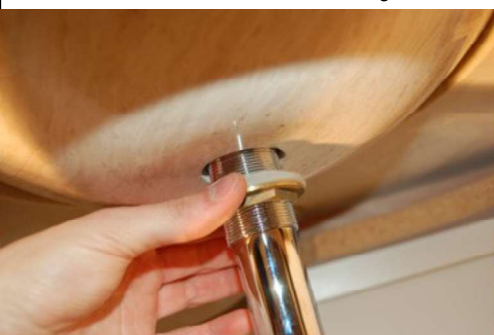
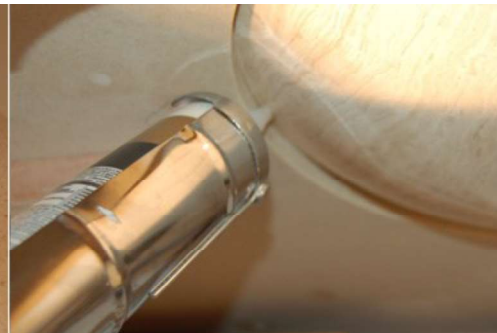

Above: Drain Attachment

There are two different ways to mount a vessel sink.

The first is the "above counter method" which is the most popular method and can be used for any shape or style of vessel sink. The second is the "recessed method" which can only be used for perfectly rounded vessel sinks (bowl or cone) that have a smooth outer edge and are made of a solid material such as stone, wood or copper.

In the "above counter method" the vessel sink is held in place by the drain, adhesive between the flat bottom of the sink and the countertop, and the weight of the sink itself.

The "recessed method" results in a much sturdier installation as a larger contact area between the sink and countertop exists, adhesive used underneath the counter holds the sink in place. The process for installing a glass vessel is the same, however a mounting ring or thick rubber gasket needs to be used between the top of the counter and the bottom of the sink to prevent cracking.

### ABOVE COUNTER MOUNTING

Ensure you have the appropriate sized hole in your countertop. It should be just large enough to allow the threaded drain pipe to fit through it but not the nut that is screwed on to this pipe.

Apply a moderate amount of clear kitchen and bath rated adhesive / caulk underneath the sink on the flattest part around the drain. Flip the sink over and set it on your countertop, lining up the hole in your sink and the hole in the countertop.

Remove the nut attached to the threaded pipe of the drain and place the drain assembly along with the upper most rubber drain gasket (if provided) into the sink's drain hole.

### RECESSED MOUNTING

Ensure you have a hole cut out in your countertop large enough to accommodate the sink without letting it fall through the opening.

Place the sink in the cut out area, leveling each axis to make sure the fit is correct. From underneath the counter, apply a bead of silicone between the sink and countertop.

Remove the nut attached to the threaded pipe of the drain and place the drain assembly along with the upper most rubber drain gasket (if provided) into the sink's drain hole.

### DRAIN ATTACHMENT

From underneath the countertop, attach the lower most rubber gasket and the nut onto the drain pipe. Ensure the drain tail pipe is seated inside the P trap adapter / female trap adapter as shown.

Thoroughly tighten the nut onto the threaded pipe of the drain, securing the sink and drain in place.

Tighten the female trap adapter attached to your drainage pipe until it securely grips the drain's tailpipe.

\* Occasionally plumbers putty or silicone may be required between the drain and sink to ensure a leak proof seal. Test this by running the water and evaluating.