

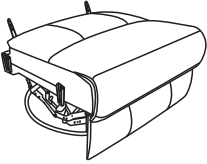

Assembly Instructions

Package Contents

				
A 1* Chair Seat	B 1* Left Armrest	C 1* Right Armrest	D 1* Backrest	E 1* Power Source

Step 1

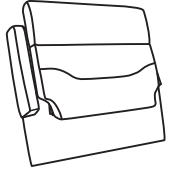
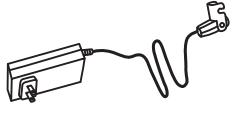
Take out a small package. This small package contains accessories E.
If this small package is lost during transportation, please email us.

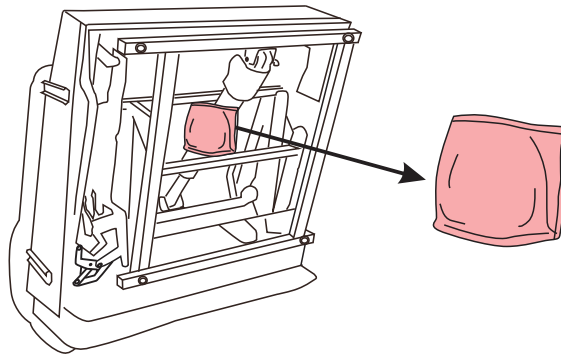

Step 2

Connect the Armrests (B&C) to the chair seat (A) by aligning the metal latches (male brackets) and grooves (female brackets) and sliding the right/left armrest down to the bottom. Push down on the top of the armrest to lock the armrest into position. You will hear a click from each side of the armrest to ensure the back is locked properly.

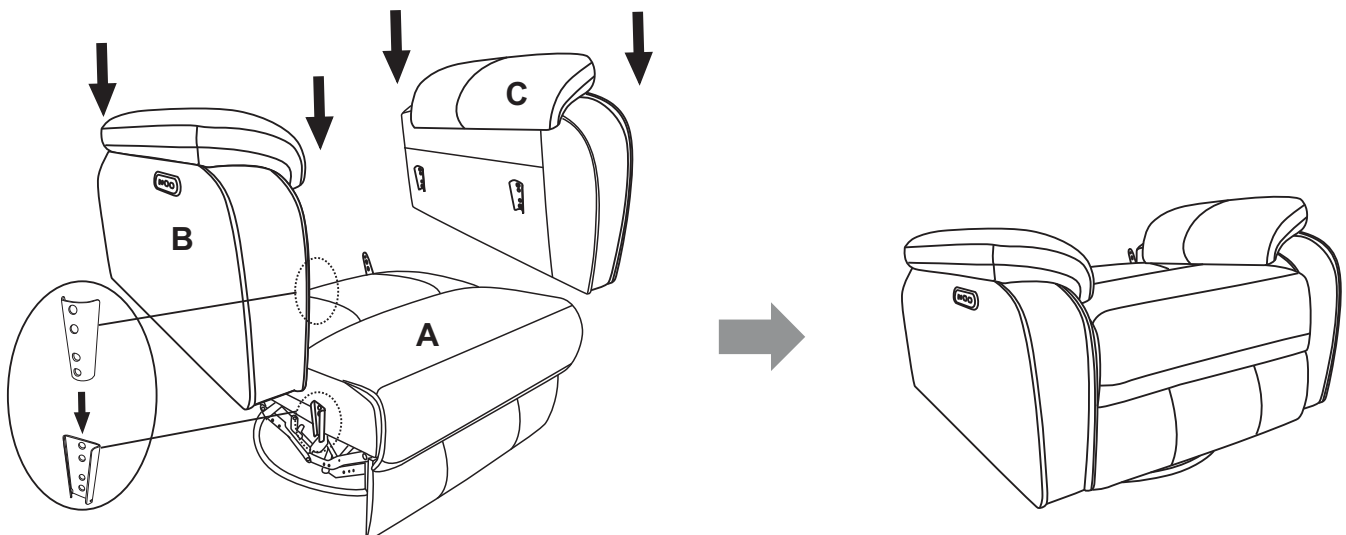

Step 3

Connect the chair backrest(D) to the chair seat(A) by aligning the metallatches (male brackets) and grooves (female brackets) and sliding the backrest down to the bottom. Push down on the top of the back to lock the back into position. You will hear a click from each side of the backrest to ensure the back is locked properly.

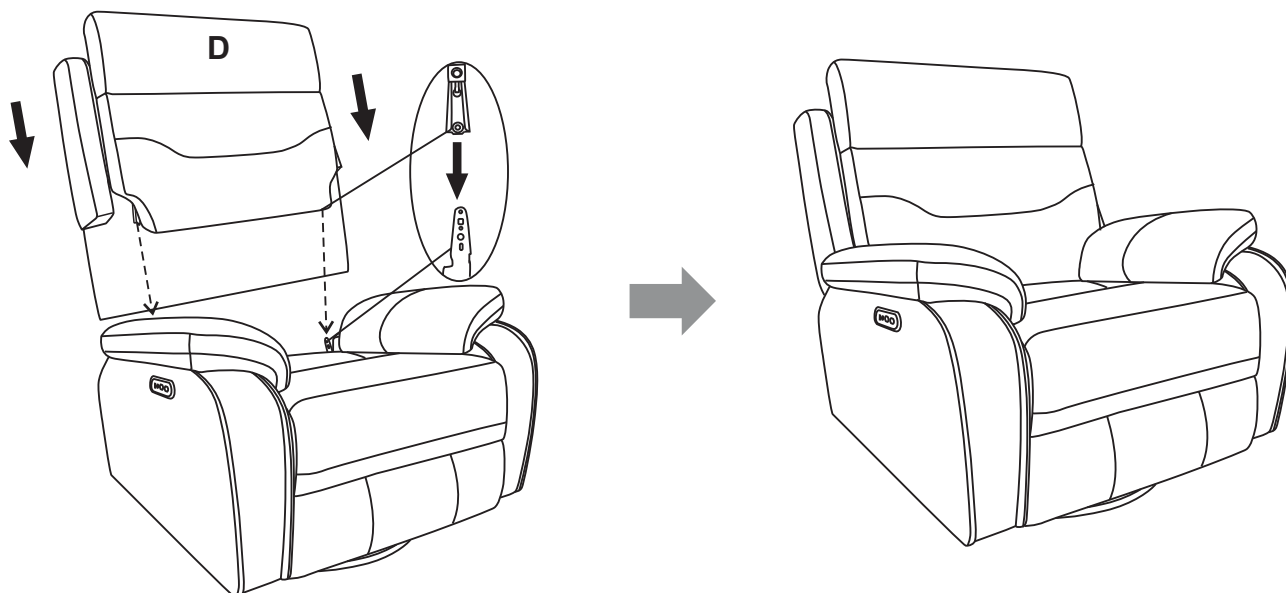

Instructions for Connecting Power

