

# ZANUSSI

## 18L Dehumidifier

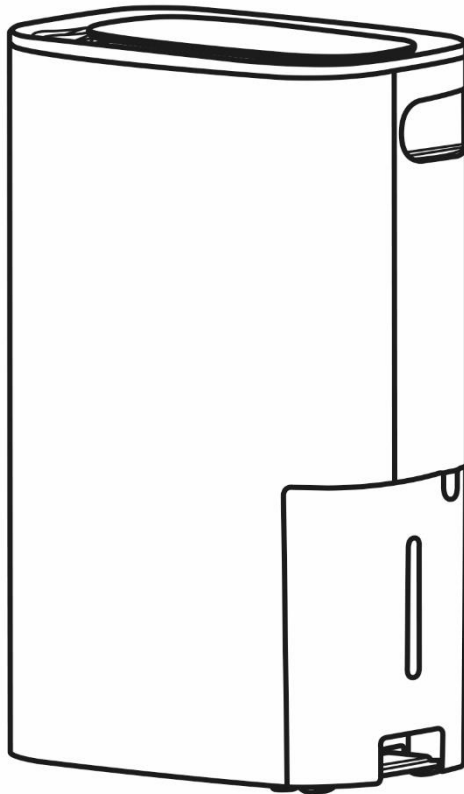

**Model Number: ZDH1802**

**220-240V AC 50Hz 380W**

For Customer Services & Spare Parts please call **0330 1230 597**

Or visit us at [www.zanussiheatingandcooling.uk](http://www.zanussiheatingandcooling.uk)

**PLEASE RETAIN**  
**FOR FUTURE REFERENCE**

# CONTENTS

	<b>Page(s)</b>
Safety Instructions and Electrical Safety	<b>3 – 5</b>
Feature Diagram	<b>6</b>
Control Panel Diagram	<b>7</b>
Positioning your Dehumidifier	<b>8</b>
Using your Dehumidifier	<b>9 - 14</b>
Emptying your Dehumidifier	<b>15 – 16</b>
Cleaning and Care	<b>17 – 18</b>
Troubleshooting	<b>19</b>
Guarantee and Customer Services	<b>20</b>
Spare Parts	<b>21</b>
Connection to the Mains Supply	<b>22</b>
Specification	<b>23</b>
Notes	<b>24</b>

# Safety Instructions

**Important note:** Please read this booklet before installing and switching on this appliance. The manufacturer assumes no responsibility for incorrect installation and usage as described in this booklet.

- This model uses natural refrigerant gas as part of its cooling system. This gas is known as R290 (Propane) and is environmentally friendly but can be combustible. Care should therefore be taken when handling or transporting the product to ensure that none of the refrigeration circuit components are damaged.
- Do not obstruct ventilation openings on the appliance and never insert your finger or any other object into the air outlet.
- Do not cover the appliance or place any object on the control panel.
- The appliance must not be placed or rested on its power cord.
- Do not use adaptors or extension leads when connecting the appliance to the electrical power supply.
- Do not use the appliance if the plug is damaged.
- Do not pull, twist or damage the power cable.
- Do not plug-in or un-plug the appliance with wet hands to prevent electrical shock.
- Always store the unit in an upright position in order to maintain the compressor working in a proper condition.
- This appliance can be used by children aged from 8 years and above and persons with reduced physical, sensory or mental capabilities or lack of experience and knowledge if they have been given supervision or instruction concerning use of the appliance in a safe way and understand the hazards involved. Children should not play with the appliance.
- This appliance is designed to be used by adults, do not allow children to play with the appliance.
- The appliance is intended for residential use only.
- When defrosting and cleaning the appliance, do not use any tools other than those recommended by the manufacturing company.
- The appliance must be installed, used and stored in an area that is greater than 13 m<sup>2</sup>.

# Safety Instructions

- The appliance must be placed in an area without any continuous sources of ignition (for example: open flames, gas or electrical appliances in operation).
- R290/R32 is a refrigerant gas that complies with the European directives on the environment. Do not puncture or damage any part of the refrigerant circuit.
- If the appliance is installed, operated or stored in a non-ventilated area, the room must be designed to prevent the accumulation of refrigerant leaks.
- Individuals who operate or work on the refrigerant circuit must have the appropriate certification issued by an accredited organisation that ensures competence in handling refrigerants according to a specific evaluation recognized by associations in the industry.
- Maintenance and repairs that require the assistance of other qualified personnel must be performed under the supervision of an individual specified in the use of flammable refrigerants.
- Be aware that the refrigerants may not contain an odour.
- Compliance with national gas regulations shall be observed.
- The appliance shall be stored so as to prevent mechanical damage from occurring.
- **WARNING:** System contains refrigerant under very high pressure. The system must be serviced and repaired as recommended by the equipment manufacturer and by qualified persons only.
- Do not use in the following locations:-
  - Next to a source of fire.
  - An area where oil is likely to splash.
  - An area exposed to direct sunlight.
  - An area where water is likely to splash.
  - Near a bath, shower or a swimming pool.
  - In a greenhouse.
  - An area where flammable gasses or liquids are present.

# Safety Instructions

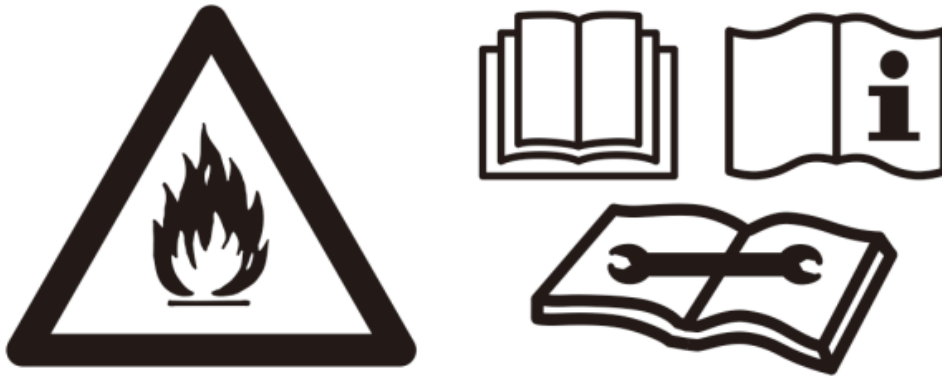

## Electrical Safety

**THIS APPLIANCE MUST BE PLUGGED INTO AN EARTHED SOCKET**

- Before switching on, make sure that the voltage of your electricity supply is the same as that indicated on the rating plate. This product is designed to operate on 220 – 240V AC; 50Hz. Connection to any other power source may damage the unit.
- This product may be fitted with a non re-wireable plug. If it is necessary to change the fuse in the plug, the fuse cover must be refitted. If the fuse cover becomes lost or damaged, the plug must not be used until a suitable replacement is obtained. Please reference page 25 of this document for instructions on how to change the fuse.
- A wiring diagram with a clear indication of the connections and wiring to external control devices (if any) and supply cord.

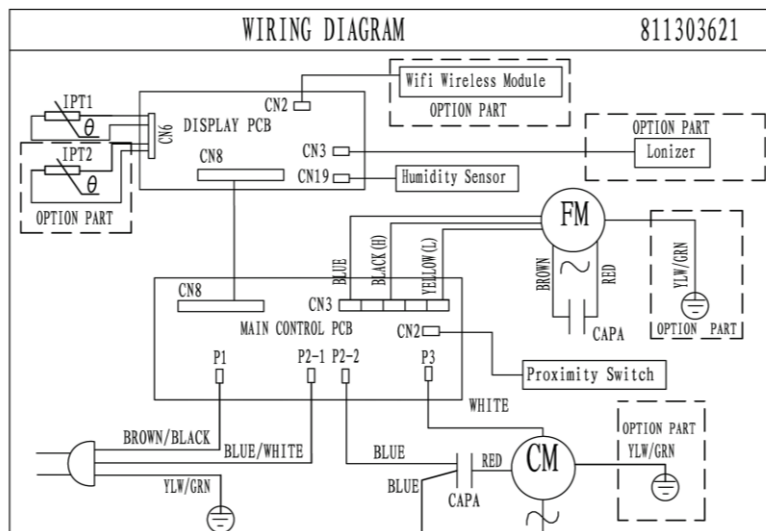

# FEATURE DIAGRAM

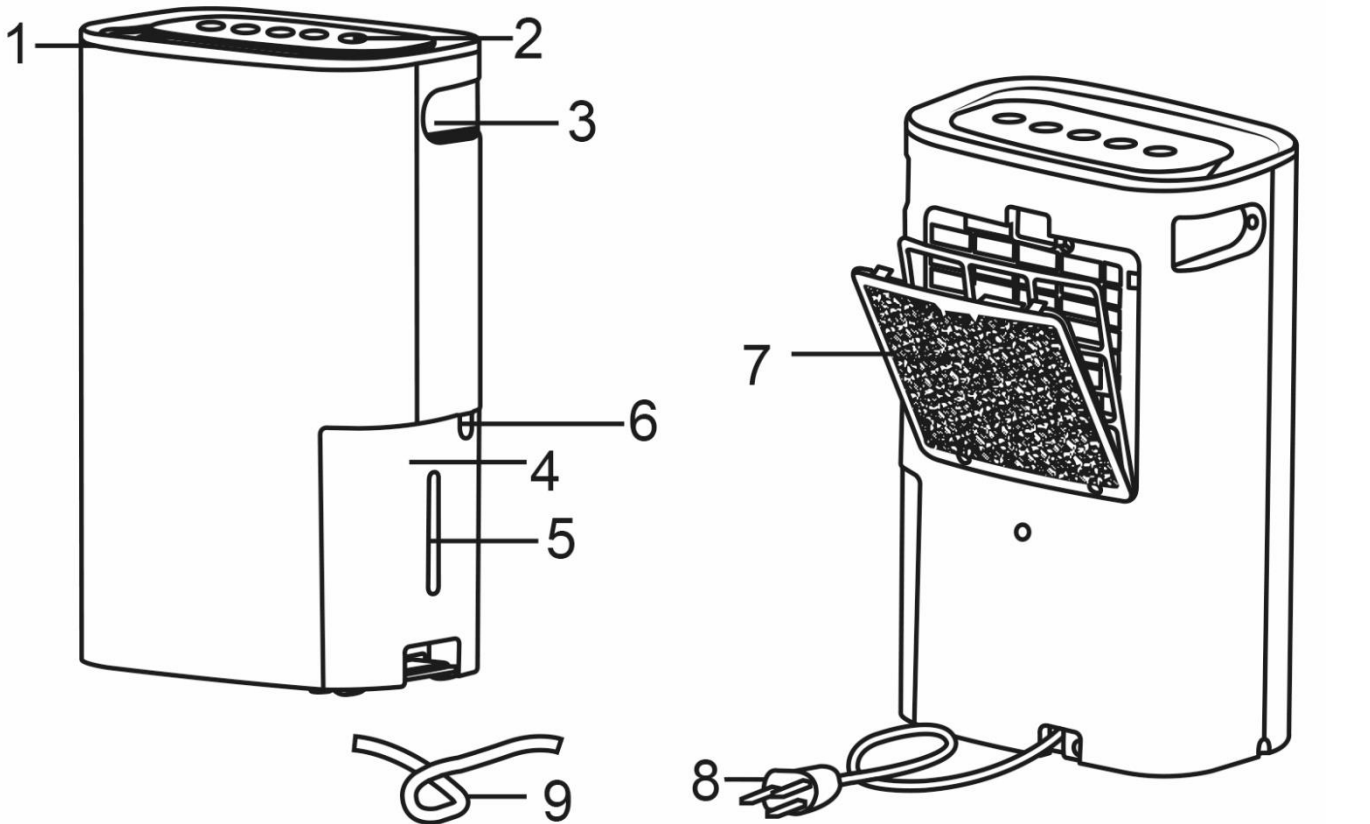

## Front

1. Air outlet grille
2. Control panel
3. Handle
4. Water tank
5. Water tank window
6. Drainage hole

## Rear

7. Air inlet grille & Air filter  
(behind the air intake grille)
8. Power cord
9. Drain hose

For Customer Services & Spare Parts please call **0330 1230 597**  
Or visit us at [www.zanussiheatingandcooling.uk](http://www.zanussiheatingandcooling.uk)

# CONTROL PANEL DIAGRAM

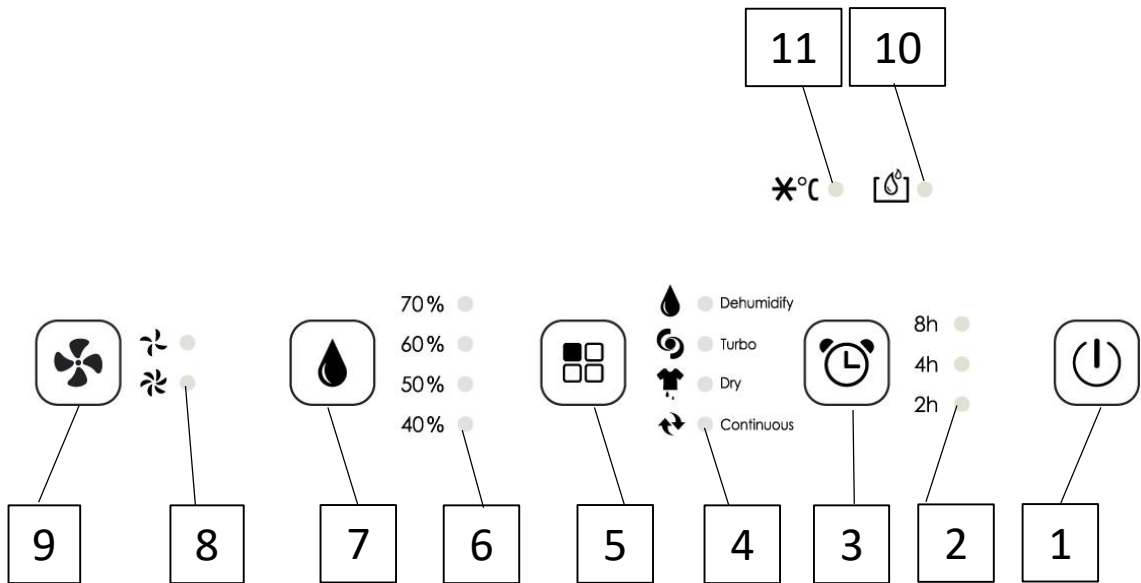

- |                             |                                     |
|-----------------------------|-------------------------------------|
| 1. Power                    | 7. Humidity level selection button  |
| 2. Timer indicators         | 8. Fan speed indicators             |
| 3. Timer button             | 9. Fan speed selection button       |
| 4. Mode indicators          | 10. Water tank full indicator light |
| 5. Mode selection button    | 11. Defrost indicator light         |
| 6. Humidity level indicator |                                     |

# POSITIONING YOUR DEHUMIDIFIER

- This dehumidifier is intended for indoor residential applications only. This dehumidifier should not be used for commercial or industrial applications.
- Place the dehumidifier on a smooth, level floor strong enough to support the unit with a full drawer of water.
- Allow at least 45cm of air space on all sides of the unit for good air circulation.
- Allow at least 45cm of air space above the unit for good air circulation.

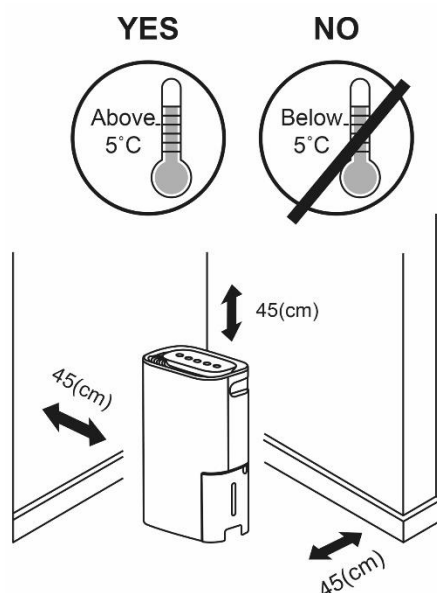

- Place the unit in an area where the temperature will not fall below 5°C (41 ° F). The coils can become covered with frost at temperatures below 5°C (41 ° F), which may reduce performance.
- Place the unit away from clothes dryers, heaters or radiators.
- The dehumidifier must be operated in an enclosed area to be most effective.
- Close all doors, windows and other outside openings
- Do not use outdoors.

# **USING YOUR DEHUMIDIFIER**

***When the dehumidifier reaches its pre-set level, the fan motor will continue running and the compressor will stop working***

***When the water tank is full or removed the unit will automatically shut off. Both the fan motor and compressor will stop immediately.***

***After the unit has stopped, the unit cannot be restarted for 3 minutes. This is a safety feature to protect the appliance. If the unit is not turned off then unit will automatically start after 3 minutes.***

***The unit has frost protection, this means that when frost builds up inside the unit the compressor will turn off and the fan will continue to run to remove the frost. Once the frost is removed the compressor will operate again.***

***If power to the unit is broken unexpectedly (power cut), once power is restored the unit will restart on the function it was running prior to the power being broken.***

## **Turning the Unit On**

- Remove all packaging and plug the unit into a socket.
- Ensure the water tank is correctly positioned, the drain hole is clear in water tank area if you are using the tank to collect the water.
- Press the Power button to turn the dehumidifier on and off. The power indicator light will illuminate when the unit is turned on.
- When the unit is first switched on, continuous extraction mode (at maximum extraction rate) and high fan speed will be selected.

# USING YOUR DEHUMIDIFIER

## Setting the Humidity

- For drier air, select a lower humidity percent value(%)
- For damper air, select a higher percent value(%).

**Note:** The humidity level cannot be set when the unit is operating in Turbo Mode, Dryer Mode or Continuous Dehumidifier (Extraction) Mode.

## Dehumidify Mode

- Press the Mode button on the control panel until the Dehumidify indicator light is illuminated.
- In the Dehumidify mode the humidity level can be selected; 40%, 50%, 60% and 70%. Press the Humidity level button to select the humidity level you require, if after 5 seconds if the humidity button is not pressed then the humidity level will activate.
- Press the Power button or Mode button to cancel the Dehumidify mode.

**Note:** The fan speed can be set when the unit is operating in Dehumidify Mode.

**Note:** The timer function can be set when the unit is operating in Dehumidify Mode.

## Turbo Mode

- Press the Mode button on the control panel until the Turbo indicator light is illuminated.
- In the Turbo dehumidifying mode, the fan is automatically set to high speed and the humidity level is automatically set at 30% (all humidity indicators are off).
- Press the Power button or Mode button to cancel the Turbo Mode.

**Note:** The humidity and fan speed cannot be set when the unit is operating in Turbo Mode.

# USING YOUR DEHUMIDIFIER

**Note:** The timer function can be set when the unit is operating in Turbo Mode.

## Dry Mode

- Press the Mode button until the Dry indicator light is illuminated
- In the Dry mode the humidity level is automatically set at 15% (all humidity indicators are off) and the fan is automatically set to high speed.
- Press the Power button or Mode button to cancel the dryer function.

**Caution:** Do not cover the air outlet with wet clothing, or do not place wet clothing above the unit.

**Note:** The dry mode must be operated in a closed room. Do not operate with a door or window open

**Note:** Place clothes 30-50cm from the unit for best drying results.

**Note:** The timer function cannot be set when the unit is operating in Dry Mode. If the Dry mode is chose after 24 hours the appliance will automatically change to Dehumidify mode if there is no operation

**Note:** The humidity cannot be set when the unit is operating in Dry Mode.

## Continuous Dehumidifier (Extraction) Mode

- Press the Mode button on the control panel until the Continuous Dehumidifier indicator light is illuminated.
- In the Continuous Dehumidifier (Extraction) mode the humidity level is automatically set at 15% (all humidity indicators are off).
- The unit will continue to run at the maximum extraction rate until the water tank reaches the max fill level.
- Press the Power button or Mode button to cancel the Continuous Dehumidifier (Extraction) mode.

# USING YOUR DEHUMIDIFIER

**Note:** The humidity cannot be set when the unit is operating in Continuous Dehumidifier (Extraction) Mode

**Note:** The timer function cannot be set when the unit is operating in Continuous Dehumidifier (Extraction) Mode.

**Note:** The fan speed can be set when the unit is operating in Continuous Dehumidifier (Extraction) Mode.

## Setting the Timer

### **Delayed Start**

- The unit must be switched OFF for the Auto Start function to be programmed.
- With the unit switched off, press the Timer button and the 2h indicator will light up. Press again to select another time, after 5 seconds if the timer button is not pressed then the timer will activate.
- The delayed start time can be off, 2 hours, 4 hours or 8 hours.
- The selected time indicator light will stay illuminated. The countdown to the start time will start.

### **Auto Stop**

- The Auto Stop function can only be set when the unit is ON.
- With the power on, press the Timer button and the 2h indicator will light up. Press again to select another time, after 5 seconds if the timer button is not pressed then the timer will activate.
- The stop time can be off, 2 hours, 4 hours or 8 hours.
- The selected time indicator light will stay illuminated. The countdown to the stop time will start.

**Note:** Turning the unit On or Off at any time will cancel the Delayed Start or Auto Stop functions and the unit can take 2 minutes to restart.

If the time is adjusted to “off” this will also cancel the Timer function.

If the water drawer is full, the Delayed Start and Auto Stop functions will be cancelled.

# USING YOUR DEHUMIDIFIER

## Fan

- Control the fan speed by pressing the fan speed button and select from Low and High fan speed settings.
- Set the fan speed to High to obtain the maximum moisture removal.
- When the humidity has been reduced and quiet operation is preferred (night time for example), you can set the fan control to Low.

**Note:** The fan speed can be set when the unit is operating in Dehumidify Mode and Continuous Dehumidify Mode.

**Note:** The fan speed cannot be set when the unit is operating in Turbo Mode or Dry Mode.

## Other features

### **Auto Shut Off**

The dehumidifier will shut off automatically under the following conditions:

- When the water tank is full
- When the water tank is removed
- When the water tank is not replaced in the proper position
- When the selected humidity level is reached

### **Water Drawer Full Indicator light**

- The indicator light will illuminate under the following conditions:
- When the water tank is full
- When the water tank is removed
- When the water tank is not replaced in the proper position

### **3 Minute Restart**

After the unit has stopped, it cannot be restarted for 3 minutes. This is to protect the unit. Operation will automatically start after 3 minutes.

# **USING YOUR DEHUMIDIFIER**

## **Auto Defrost**

When frost builds up on the evaporator coils, the compressor will cycle off and the fan will continue to run until the frost disappears.

## **Auto-Restart**

If the unit turns off unexpectedly due to a power cut, it will restart with the previous function setting automatically when the power resumes.

# EMPTYING YOUR DEHUMIDIFIER

There are two ways to remove collected water:

## Collection in the Water Tank

- When the water tank is full, the unit will automatically stop running, and the Full indicator light will illuminate.
- Slowly pull out the tank and grip the left and right handles securely and carefully. Pull out the water tank straight so the water in the tank does not spill. Do not put the tank down because the bottom of the drawer is uneven.
- Empty the water and replace the tank. The tank must be correctly inserted for the dehumidifier to restart operation.
- The machine will restart operation after 3 minutes.

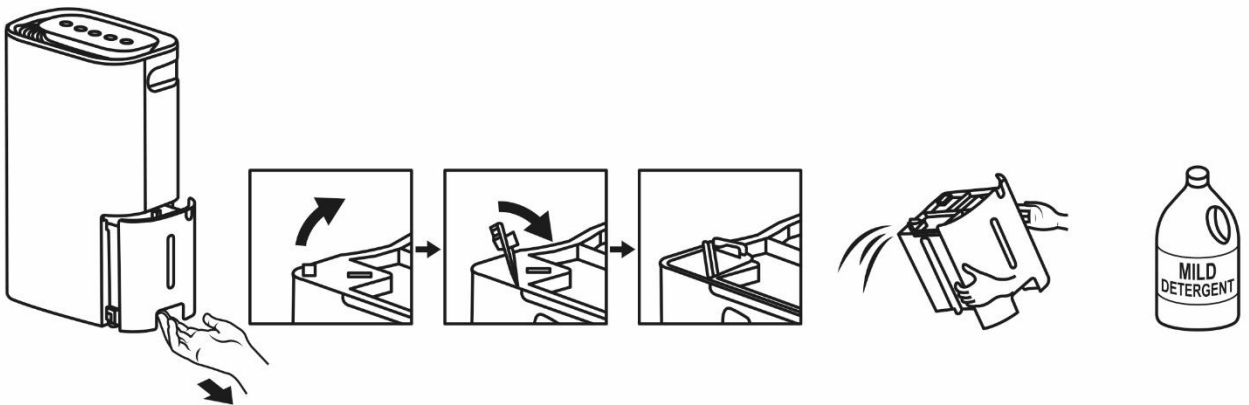

- When you remove the water tank, do not touch any parts inside of the unit. Doing so may damage the product.
- Be sure to push the water tank gently all the way into the unit. Banging the tank against anything or failing to push it in securely may cause the unit not to operate.
- When you remove the water tank, if there is some water in the unit you must dry it .

# EMPTYING YOUR DEHUMIDIFIER

## Continuous Draining

- Water can be automatically emptied into a floor drain by attaching the unit with a inner diameter 13.5mm hose .
- Remove the rubber bung from the Drain Hose Outlet on the back of the unit.
- Attach the hose into the Drain Hose Outlet in the side of the unit as shown below.

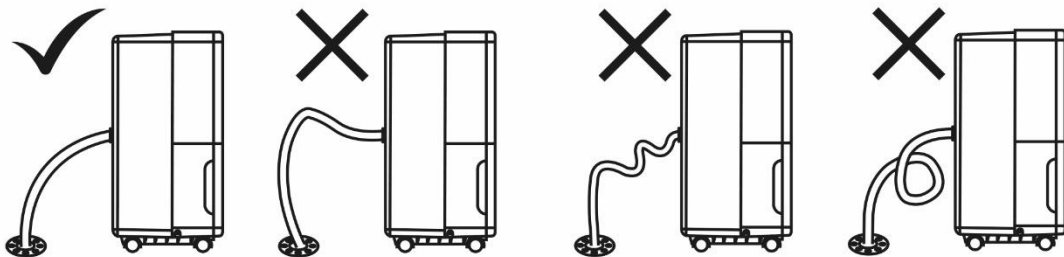
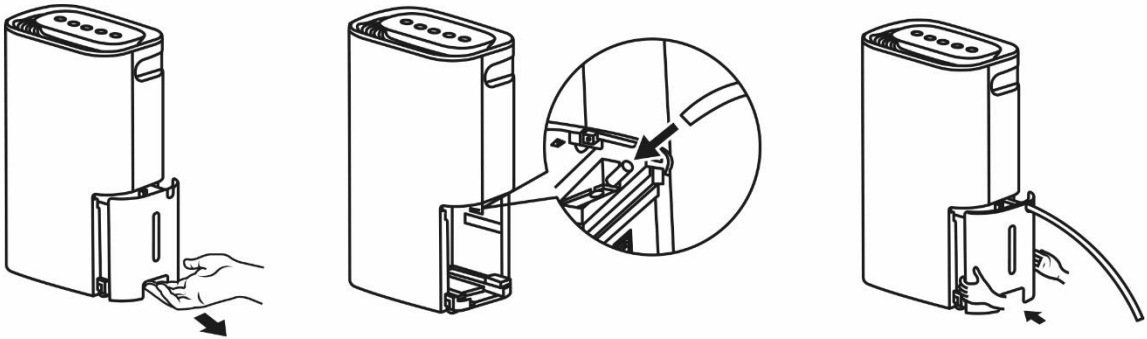

- Lead the water hose to a suitable drainage facility. The drainage facility should be lower than the drain outlet of the unit.
- Be sure to run the water hose sloping downward and let the water to flow out smoothly.

# CLEANING AND CARE

## **Cleaning the Air Filter**

The air filter is located behind the air intake grille on the rear of the appliance and should be checked and cleaned at least every 30 days or more often if necessary.

**NOTE: DO NOT PUT THE FILTER IN AN AUTOMATIC DISHWASHER**

## **To Remove the Air Filter:**

- Push both tabs on the Air Inlet Grille upwards.
- Clean the filter with warm, soapy water. Rinse and let the filter dry before replacing it. Do not clean the filter in a dishwasher.

## **To Replace the Air Filter**

- Insert the top of the Air Inlet Grille/Filter into the unit, then click the bottom tabs into place.

## **CAUTION:**

DO NOT operate the dehumidifier without a filter. This will cause dirt and lint to build up and clog the unit and will reduce performance.

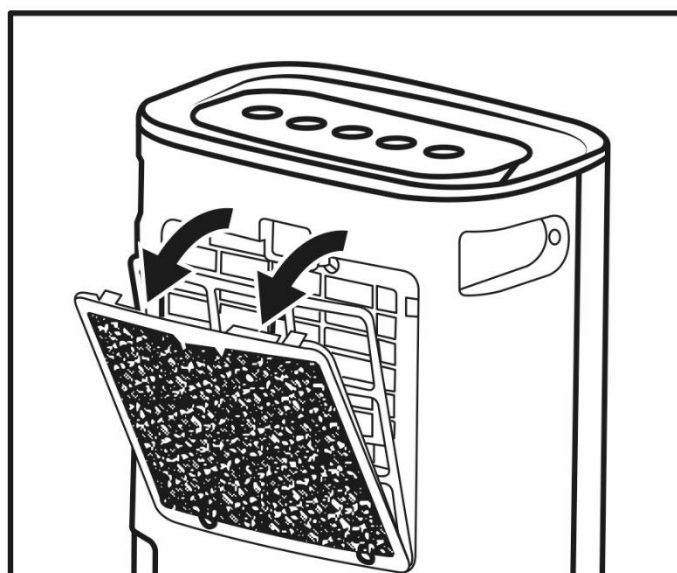

# **CLEANING AND CARE**

***Turn the dehumidifier off and remove the plug from the wall outlet before cleaning.***

## **Cleaning the Grille and Case**

- Use water and a mild detergent. Do not use bleach or abrasives.
- Do not splash water directly onto the main unit. Doing so may cause an electrical shock, cause the insulation to deteriorate, or cause the unit to rust.
- The air intake and outlet grilles get soiled easily, so use a vacuum attachment or brush to clean.

## **Cleaning the Water Tank**

- Every few weeks, clean the tank to prevent growth of mould, mildew and bacteria. Partially fill the tank with clean water and add a little mild detergent. Swish it around in the tank, empty and rinse.

**NOTE:** Do not use a dishwasher to clean the tank. After clean, the tank must be in place and securely seated for the dehumidifier to operate.

## **When not using the unit for long time periods**

- After turning off the unit, wait 24 hours before emptying the drawer.
- Clean the main unit, drawer and air filter.
- Wrap the cord and bundle it with the band and cover the unit with a plastic bag.
- Store the unit upright in a dry, well-ventilated place.

# TROUBLE SHOOTING

Problem	What to check
Unit does not start	<ul style="list-style-type: none"> <li>• Make sure the dehumidifier's plug is pushed completely into the socket outlet.</li> <li>• Check the house fuse/circuit breaker box.</li> <li>• Drawer is full.</li> <li>• Drawer is not in the proper position.</li> <li>• If the unit is being restarted there is a 3 min delay before the unit will start running.</li> <li>• Ensure the unit is not set on delayed start function.</li> <li>• Ensure the room humidity is not lower than 35%.</li> </ul>
Dehumidifier does not dry the air as it should	<ul style="list-style-type: none"> <li>• Did not allow enough time to remove the moisture.</li> <li>• Make sure there are no curtains, blinds or furniture blocking the front or back of the dehumidifier.</li> <li>• The humidity selector may not be set low enough.</li> <li>• Check that all doors, windows and other openings are securely closed.</li> <li>• Room temperature is too low, below 5<sup>o</sup> C(41<sup>o</sup> F).</li> <li>• There is a kerosene heater or something giving off water vapour in the room.</li> </ul>
The unit makes a loud sound when operating	<ul style="list-style-type: none"> <li>• The air filter is clogged.</li> <li>• The unit is tilted instead of upright as it should be.</li> <li>• The floor surface is not level.</li> </ul>
Frost appears on the coils	<ul style="list-style-type: none"> <li>• This is normal. The unit has Auto defrost feature.</li> </ul>
Water on the floor	<ul style="list-style-type: none"> <li>• Hose to connector or hose connection may be loose.</li> <li>• Intend to use the drawer to collect water, but the back drain plug is removed.</li> </ul>

# **GUARANTEE AND CUSTOMER SERVICES**

At Zanussi, we take all our customer feedback seriously.

**Feel free to contact our Product Care Team, on 0330 1230 597  
who will be more than happy to assist you.**

This product is guaranteed for **12 months** from the date of the original purchase. If any defect arises due to faulty materials or workmanship, the faulty product must be returned to the place of purchase.

Refund or replacement is at the discretion of the retailer.

## **The following conditions apply:**

- The product must be returned to the retailer with the original proof of purchase.
- The product must be installed and used in accordance with the instructions contained in this instruction guide and any other instructions for use which are supplied.
- It must be used for domestic purposes only and for its intended use.
- This warranty does not cover wear and tear, damage, misuse or consumable parts.

**This does not affect your statutory rights.**

For Customer Services & Spare Parts please call **0330 1230 597**

Or visit us at [www.zanussiheatingandcooling.uk](http://www.zanussiheatingandcooling.uk)

# **SPARE PARTS**

To check the availability of the following spare parts, simply contact our friendly Customer Services team using the details provided at the bottom of this page.

**Air Filter**

**Drain Hose**

For Customer Services & Spare Parts please call **0330 1230 597**  
Or visit us at [www.zanussiheatingandcooling.uk](http://www.zanussiheatingandcooling.uk)

# CONNECTION TO THE MAINS SUPPLY

This appliance is designed to operate from a mains supply of  
220-240V~ 50Hz.

Check that the voltage marked on the product corresponds  
with your supply voltage.

## How to change the fuse

1. Slot the end of a screwdriver into the recess in the fuse holder of the plug.
2. Pull the fuse holder upwards until free of the plug and slide the fuse out.
3. Replace the fuse and replace fuse holder, pushing down until locked into place.

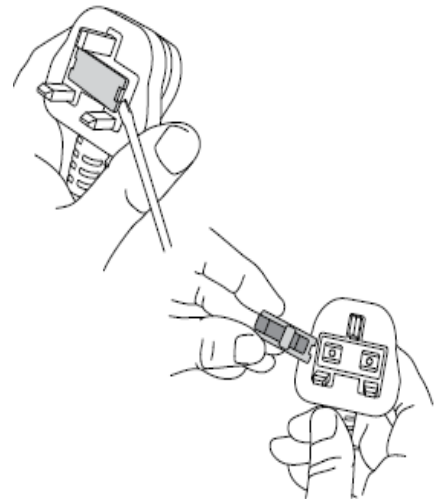

**Important:** Only ever use a 13 amp fuse.

# SPECIFICATION

<b>Model</b>	ZDH1802
<b>Voltage</b>	220 – 240V 50Hz
<b>Power Input</b>	380W
<b>Moisture Removal</b>	18L per day (DB 32°C RH = 80%)
<b>Refrigerant</b>	R290/85g
<b>Overall Size (D x W x H)</b>	19.2cm 30.5cm 49.0cm
<b>Operating Temperature</b>	5°C - 32°C
<b>Weight</b>	10.7Kg
<b>Operation humidity</b>	30%RH ~ 90%RH

# NOTES

# ZANUSSI

For Customer Services & Spare Parts  
please call

**0330 1230 597**

Or visit us at

[www.zanussiheatingandcooling.uk](http://www.zanussiheatingandcooling.uk)

Revision 1

**Model: ZDH1802**

ZANUSSI is a registered trademark used  
under license from AB Electrolux (publ).  
Made under license by G2S Limited, Wigan,  
WN2 4AY.



This symbol is known as the 'Crossed-out wheellie bin Symbol'. When this symbol is marked on a product/batteries, it means that the product/batteries should not be disposed of with your general household waste. Only discard electrical/electronic/battery items in separate collection schemes, which cater for the recovery and recycling of materials contained within. Your co-operation is vital to ensure the success of these schemes and for the protection of the environment. For your nearest disposal facility, visit [www.recycle-more.co.uk](http://www.recycle-more.co.uk) or ask in store for details.

We reserve the right, due to possible changes to design, to alter the instruction manual without prior notice.