

Parts

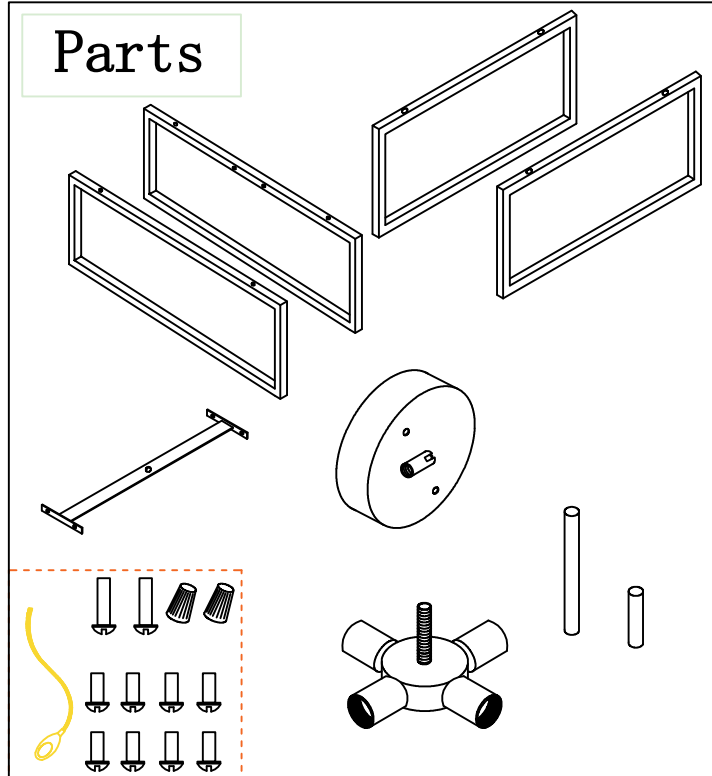

Steps 2

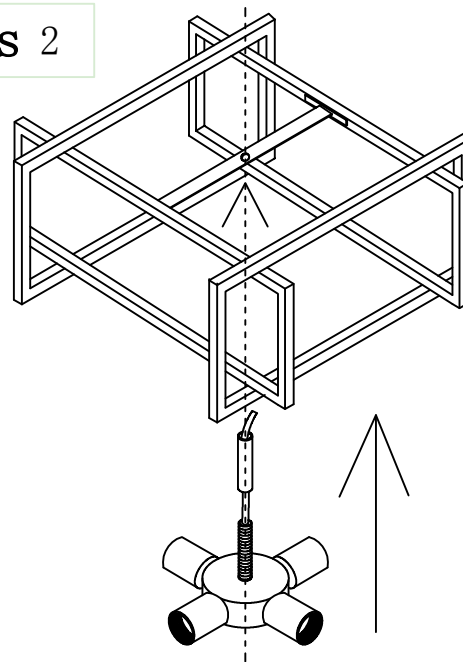

Get through the lamp wire to the short hanging rod, and screw hanging rod to the light fixture.

Steps 4

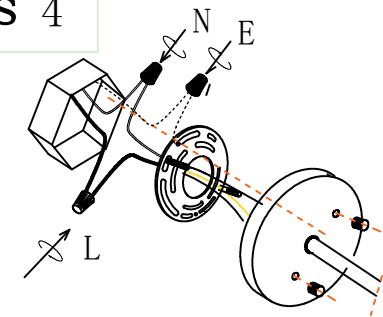

1. Assemble the mounting bracket to the ceiling junction box with the screw
2. Connect the power cord out from the ceiling junction box to lamp wires with the lead wire and wire nut, according to the wire color, to connect. (U.S. - black for "L", white for "N", copper wire for "Ground E")
3. Assemble the canopy to the mounting bracket by tightening the ball nuts

Steps 1

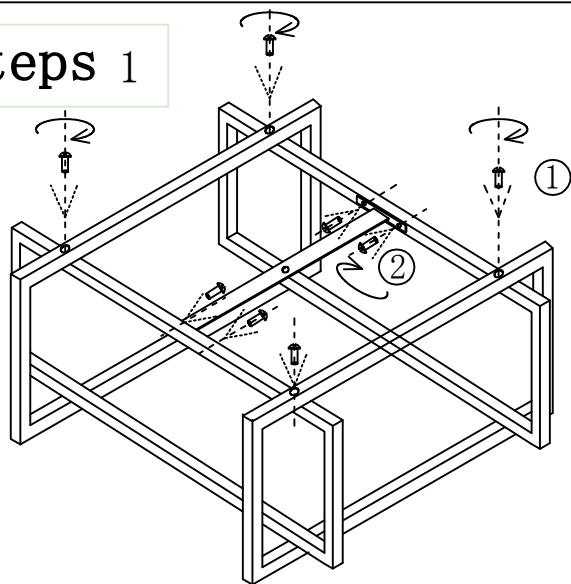

1. The small frame is inserted into the large frame as shown in the figure; the holes on the frame are aligned with the holes and tighten the frame from above with screws.
2. Install the flat iron on the small frame and fix it with screws.

Steps 3

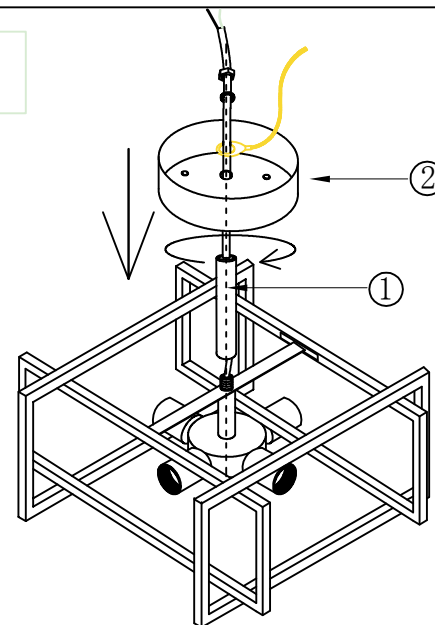

Get through the lamp wire to the long hanging rod, and screw hanging rod to the light fixture. Get through the lamp wire to the canopy, and installation ground wire is fixed by screws.

Steps 5

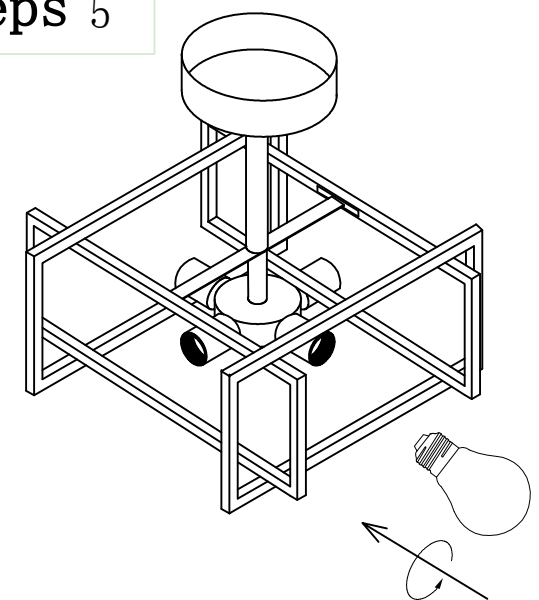

1. Install the lamp shade
2. Install the light bulb (bulb not included)