

BED ASSEMBLY INSTRUCTIONS

PARTS INCLUDED

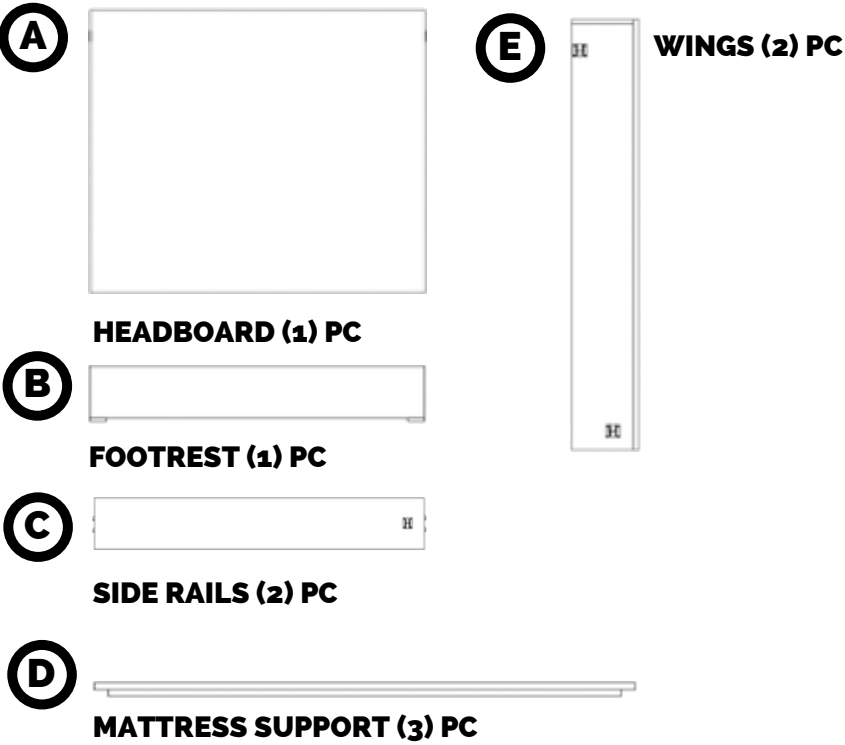

TOOLS REQUIRED (NOT INCLUDED):



MALLET



SCREWDRIVER

ASSEMBLY INSTRUCTIONS

MAY REQUIRE OF 2 ADULTS

IDENTIFY ALL THE PARTS INCLUDED LISTED AT THE BEGINNING OF THIS DOCUMENT ACCORDING TO THE MODEL OF YOUR BED.

1

1 SIDERAILS & FOOTBOARD ASSEMBLY

- Carefully insert the hooks at the edge of the siderail (C) into the holes of the footrest (B) and push it down.
- Using a mallet, hit the top of the siderail (C) for better attaching results until both of them are perfectly aligned
- Make sure there are no spaces between both pieces
- Follow the same process with the second siderail (C).

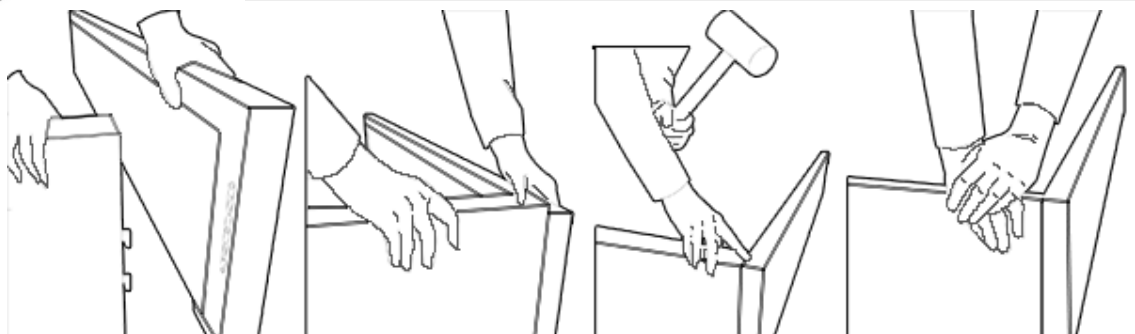

2

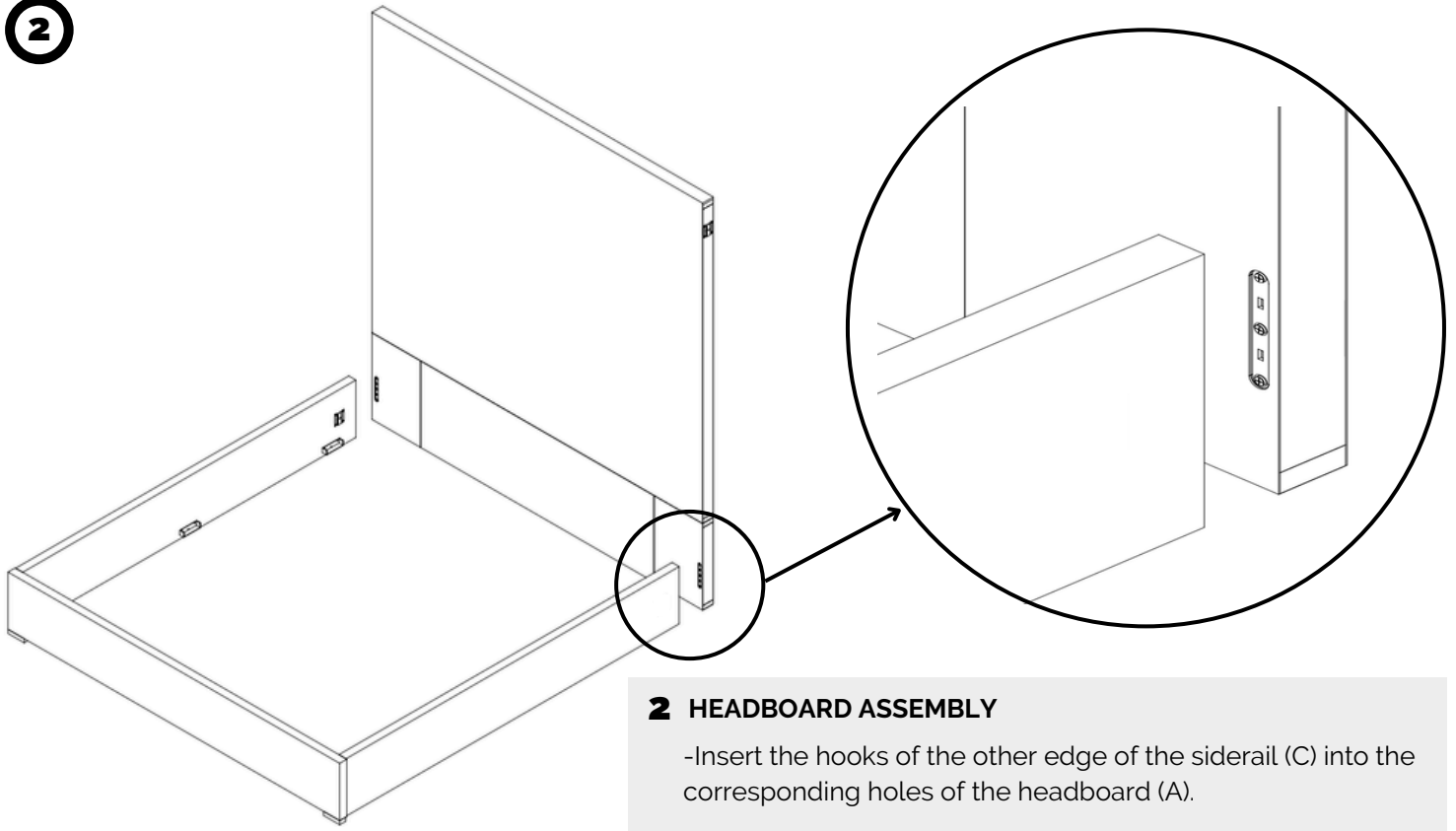

2 HEADBOARD ASSEMBLY

- Insert the hooks of the other edge of the siderail (C) into the corresponding holes of the headboard (A).
- Use the mallet to gently hit the top. Make sure it is firmly attached with no spaces between both pieces.
- Complete the same process with the other siderail (C).

3

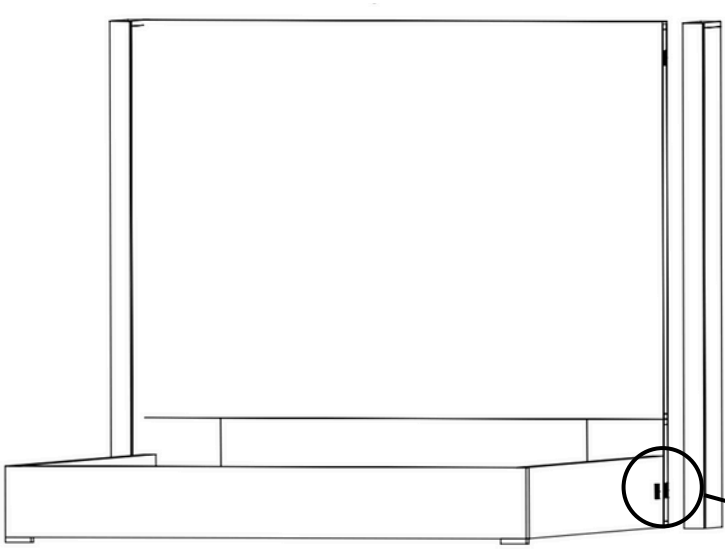

4 WINGS ASSEMBLY

- Please insert each wing (E) using the clips to the headboard (A) and siderails (C). Use a screwdriver to open each clip for better engagement.

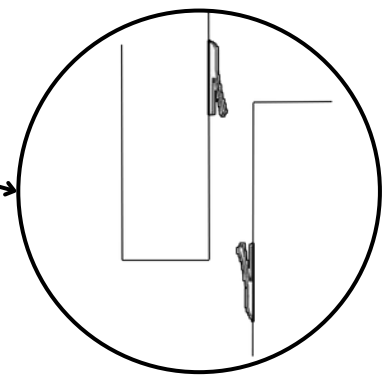
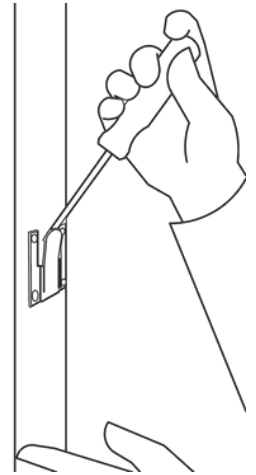

4

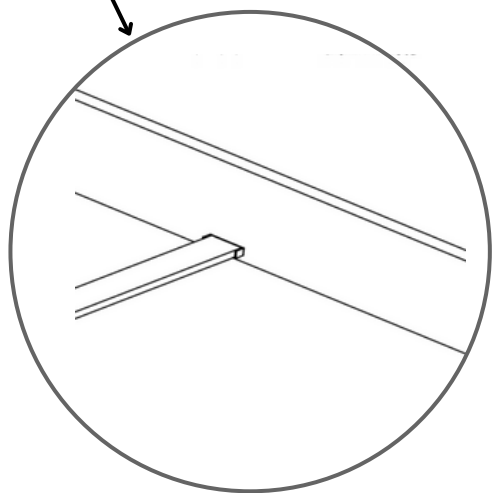
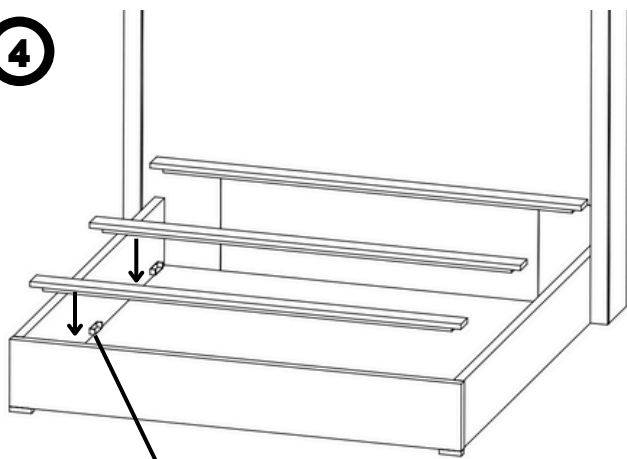

5 SUPPORTING SLATS PLACEMENT

-Place the solid wood slats (D) in the corresponding supporting base inside of the siderails (C).

FOR ADJUSTABLE BEDS

Remove the 6 brackets with a screwdriver and do not use the mattress support (D)

