

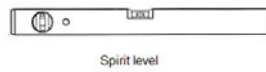

- 10mm Masonry drill.
- Torque driver bit.
- Screwdriver bit.
- 2 x 100mm x No 5 Screws.
- 2 x 50mm x No 5 Screws.
- 2 x Screw Cover Washers and Caps.
- 3x Fischer Wall bolts.
- 3x Wall bolt covers.

Equipment required:

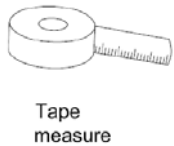

ladders x 2

Notes to customers:

- For ease and speed of assembly we recommend that before you commence each step of the assembly that you identify all the parts required to complete that step.
- We recommend that where possible you allow sufficient space to assemble the item as close as possible to the place where it will be once assembled.
- For the protection of your canopy, we recommend that the product is placed on protected surfaces during assembly to prevent any damage.
- This is a **TWO** person build please take appropriate precautions when handling this product.
- Please ensure you retain all the product packaging until the item is assembled and you are happy. We can only accept the return of this product if it is in the original packaging.

Building the Canopy:



- Position the curved brackets into the predrilled location holes using the pre inserted dowels.
- Screw the bracket in place using the 50mm No5 screw and cap washer (do not over tighten).



- Clip the screw cap cover in place.



- Insert the 100mm no5 screw into the diagonal hole at the rear of the bracket and lightly tighten.

Fitting the canopy to the wall:

This is a **TWO** person build please take appropriate precautions when handling this product.

- Hold the canopy in place above your doorway and mark through the 3 holes shown in **FIG 1.** on the wall.

CHECK AT ALL STAGES THAT THE CANOPY IS LEVEL USING A SPIRIT LEVEL.

FIG1

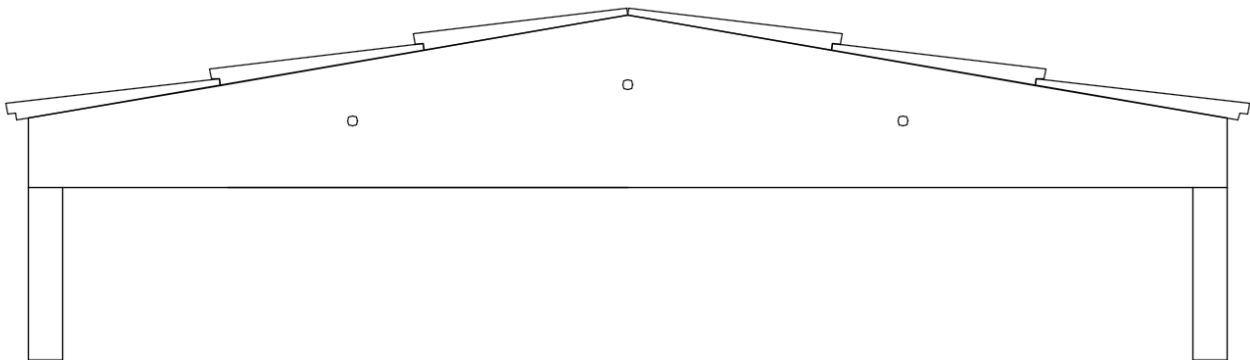

- Remove the canopy from the wall and drill the 3 holes 75mm deep with the 10mm masonry drill provided.
- Tap the 3 Wall bolts through the back face of the canopy then hold the canopy back in position.
- Tap the 3 Wall bolts into the brick work until the flange face of the wall plug touches the back face of the canopy.
- Tighten each of the bolts until secure against the face of the canopy.