

USER MANUAL

CAUTION

- 1) BE SURE THE ELECTRICITY TO THE WIRES YOU ARE WORKING ON IS SHUT OFF; EITHER THE FUSE IS REMOVED OR THE CIRCUIT BREAKER IS TURNED OFF. TURNING THE POWER OFF USING THE LIGHT SWITCH IS NOT SUFFICIENT TO PREVENT ELECTRICAL SHOCK.
- 2) DO NOT INSTALL OR USE THE LIGHT FIXTURE IF ANY PART IS MISSING OR DAMAGED.
- 3) TO PROTECT THE FINISH, DO NOT USE CLEANSERS OR ABRASIVES DURING MAINTENANCE.
- 4) TO AVOID POSSIBLE FIRE OR ELECTRICAL SHOCK, MAKE SURE NO BARE WIRE STRANDS ARE EXPOSED OUTSIDE WIRE CONNECTORS.



INSTALLATION DIAGRAM

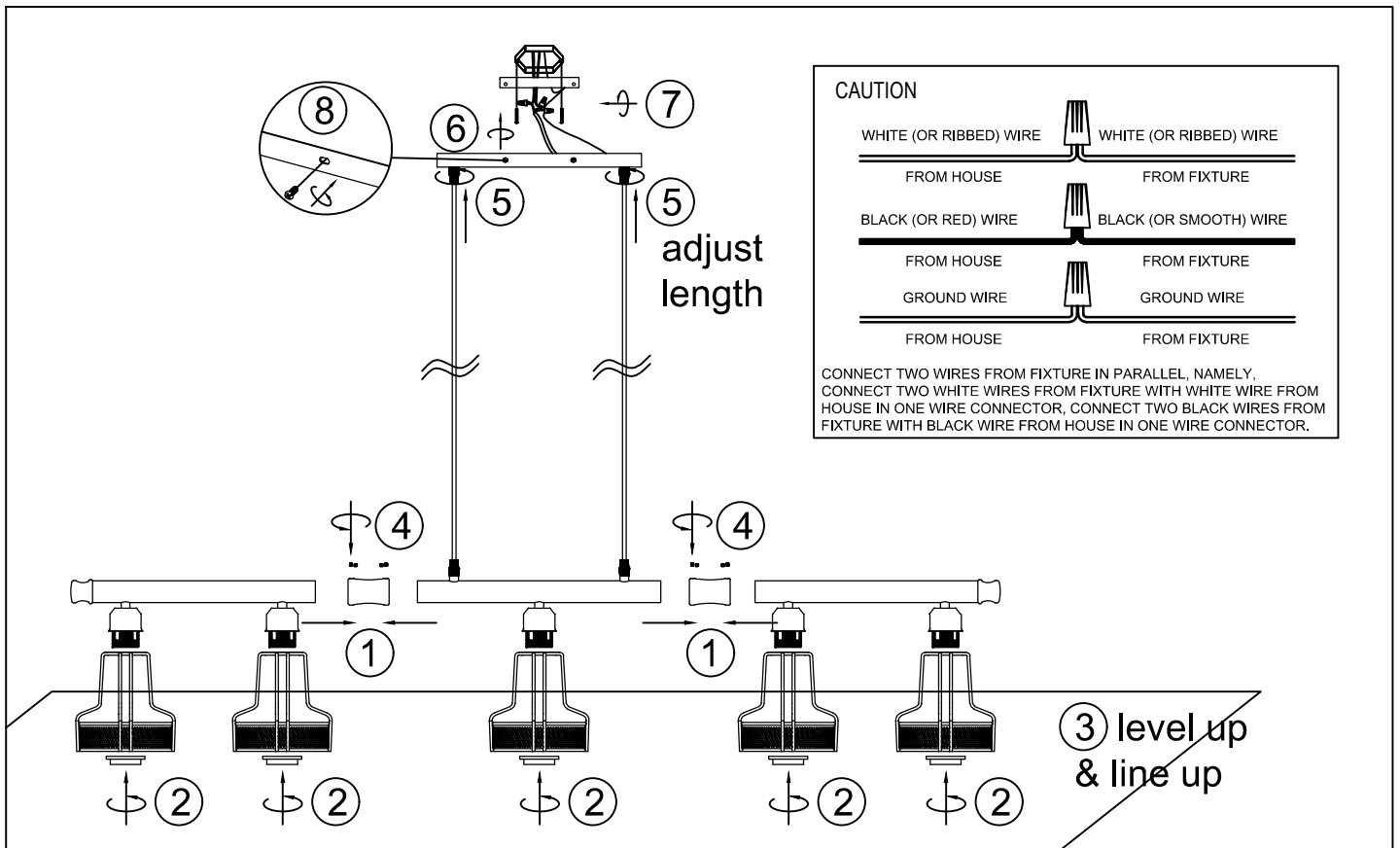

CAUTION

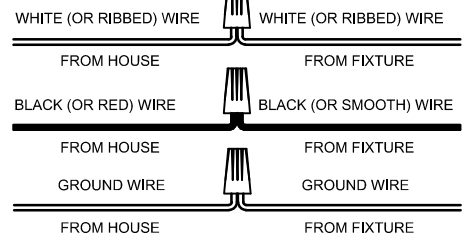

CONNECT TWO WIRES FROM FIXTURE IN PARALLEL, NAMELY, CONNECT TWO WHITE WIRES FROM FIXTURE WITH WHITE WIRE FROM HOUSE IN ONE WIRE CONNECTOR, CONNECT TWO BLACK WIRES FROM FIXTURE WITH BLACK WIRE FROM HOUSE IN ONE WIRE CONNECTOR.

NOTE

- 1) step 1, make sure push the bars into 2 tube connectors till the end.
- 2) step 3, make sure put 5 lamp cover on a flat surface, such as floor or table, to level up the lamp covers and line up the bars before fastening the 8 nuts on 2 tube connectors at step 4.

SPECIFICATION

Input Voltage:	110~120V 50/60Hz
Wattage:	E26 Max 60W per socket, bulb not included
Dimension:	Canopy Size: Length 11.81in (30cm)Width 4.72in (12cm)Height 0.79in (2cm) Fixture Size: Length 42.91in (109cm)Width 5.91in (15cm)Height 9.84in (25cm) Cord Length 59.06in (150cm)

01



push bars into
2 tube connectors
till the end

02



mount
lamp covers

03



level up
& line up

04



fasten
lock nuts

05

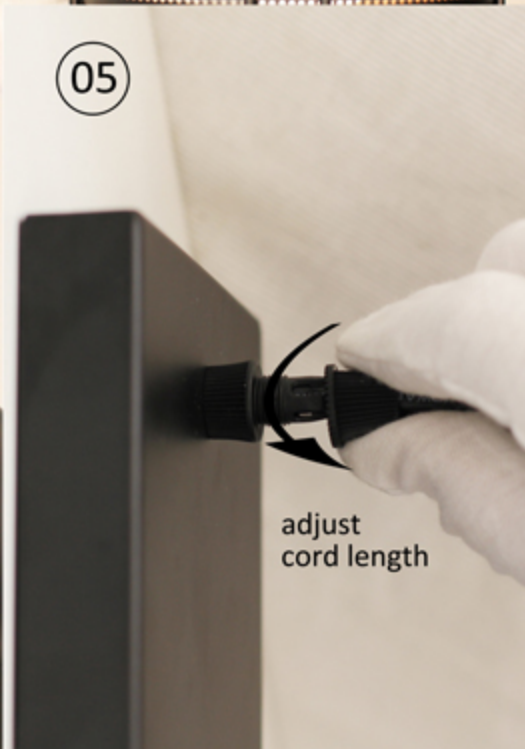

adjust
cord length

06

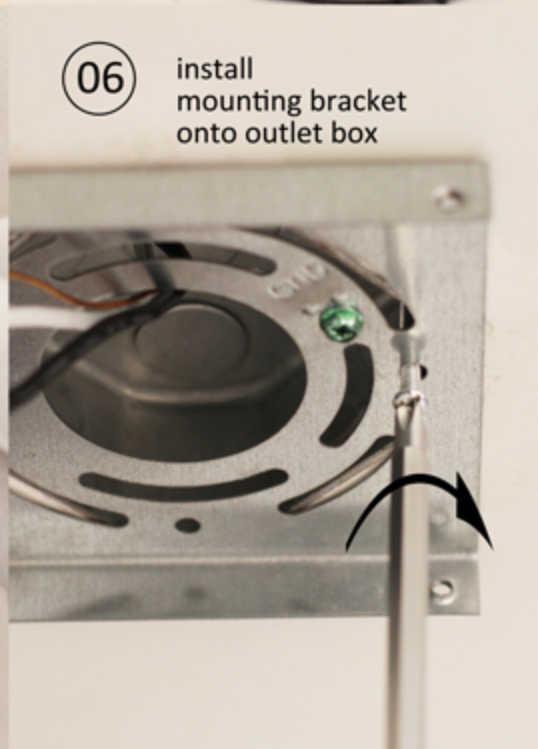

install
mounting bracket
onto outlet box

07

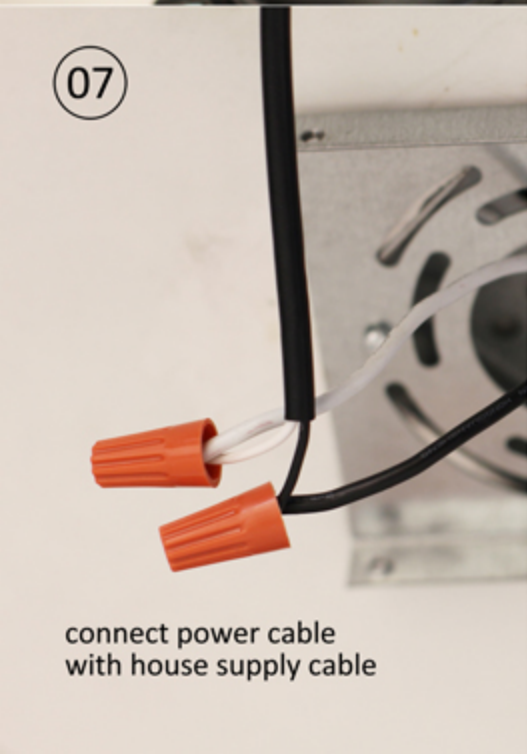

connect power cable
with house supply cable

08

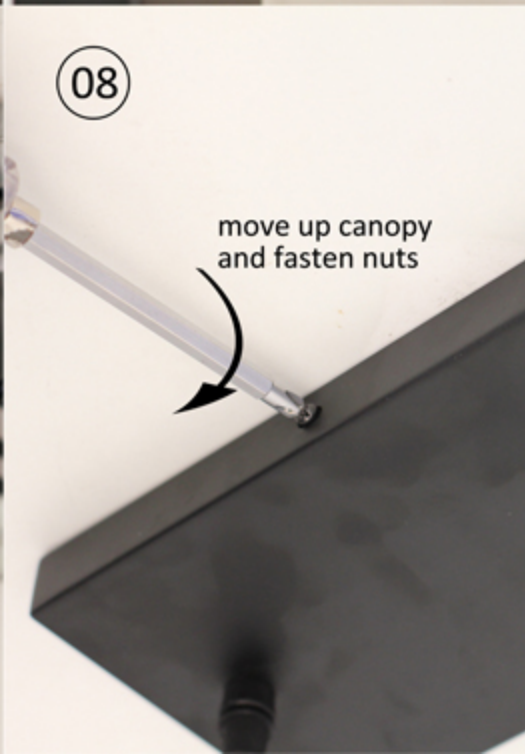

move up canopy
and fasten nuts