

# MIRROR

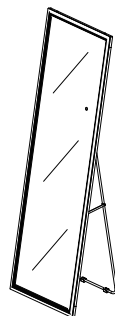

## Installation Instruction

## MIRROR PRODUCT POWER METER

| LED FULL LENGTH MIRROR PARAMETERS<br>(Straight Light Belt) |       |        |
|--|-------|--------|
| Product Specification                                      | Power | Lumen  |
| 1415*450   | 20W   | 2000LM |
| 1700*500   | 25W   | 2400LM |
| 1700*550   | 26W   | 2460LM |
| 1700*600   | 27W   | 2520LM |
| 1800*600   | 29W   | 2640LM |
| 2000*800   | 54W   | 5200LM |
| 1900*700   | 48W   | 4760LM |
| 2000*900   | 55W   | 5360M  |
| 2050*850   | 55W   | 5360LM |
| 2100*900   | 56W   | 5560LM |
| 1800*700   | 46W   | 4560LM |
| 1800*800   | 48W   | 4760LM |
| 2400*1000  | 64W   | 6360LM |

| THE PERFORMANCE PARAMETERS |          |
|----------------------------|----------|
| Input Voltage              | 100-240V |
| Output Voltage             | DC 24V   |
| Working Hours              | 30000H   |
| CRI                        | 82       |

# PRODUCT DISPLAY

## Mirror Accessories



**Expansion nails**  
X 3PCS



**Screws**  
X 3PCS



**Adapter**  
X 1PCS

## Floor Standing

1. Press the touch button to turn on/off the mirror light.
2. Short press the button to change the light colors.
3. Long press the button to adjust the light brightness.

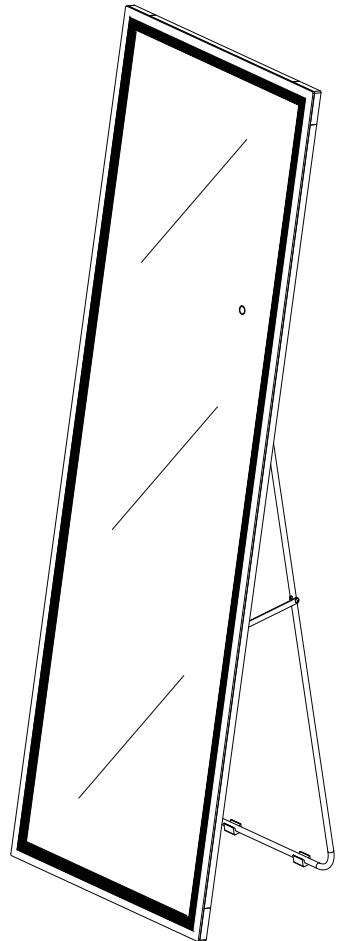
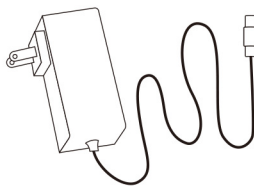

# PRODUCT DISPLAY

## Wall Mount

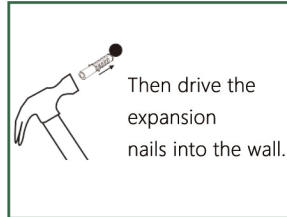
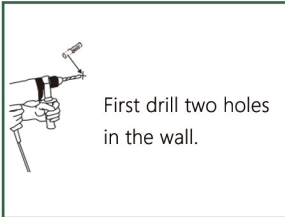

## Backside

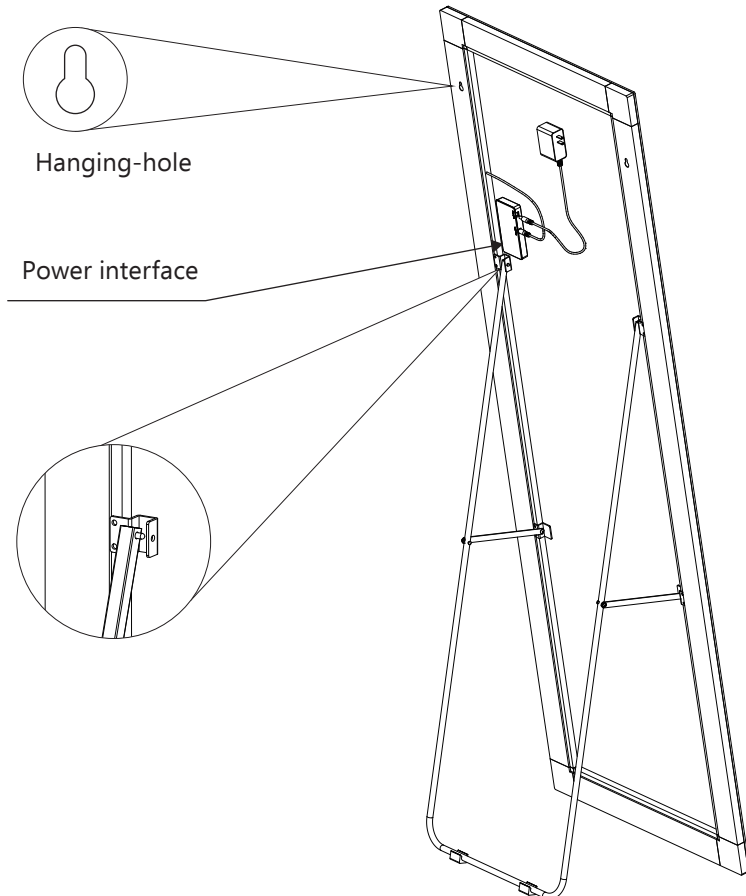

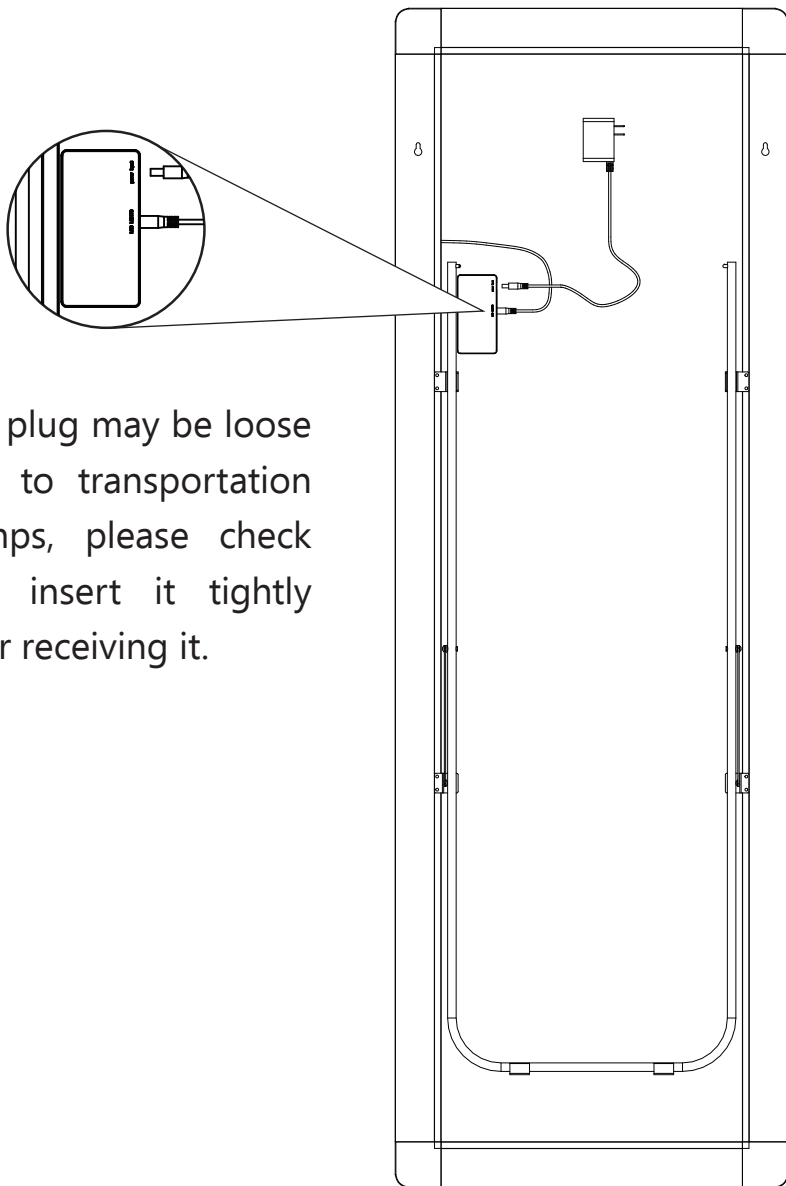

The plug may be loose due to transportation bumps, please check and insert it tightly after receiving it.

## PRODUCT DISPLAY

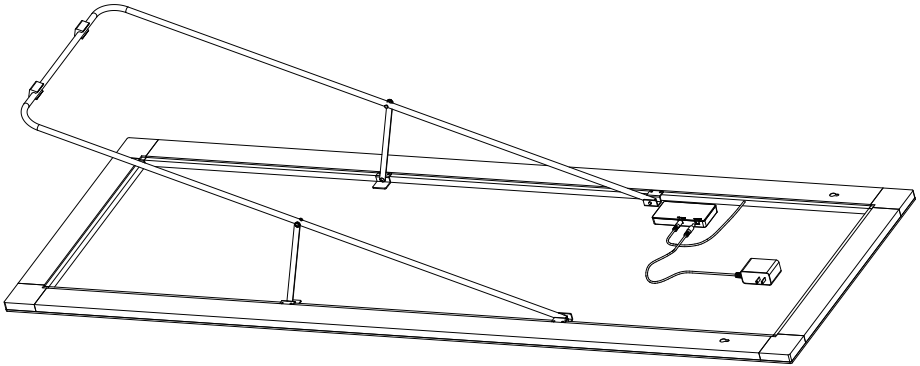

### Installation Notes:

- ❶ The mirror must be placed horizontally before installation.
- ❷ Pull up the bracket and align the holes.
- ❸ Press the extensible-button on both sides of the bracket, align with the holes and release to complete the installation.

### Notes:

Please pay attention to the sharp part of the bracket avoiding hit and break the mirror when pull up the bracket!