

ASSEMBLY TIPS

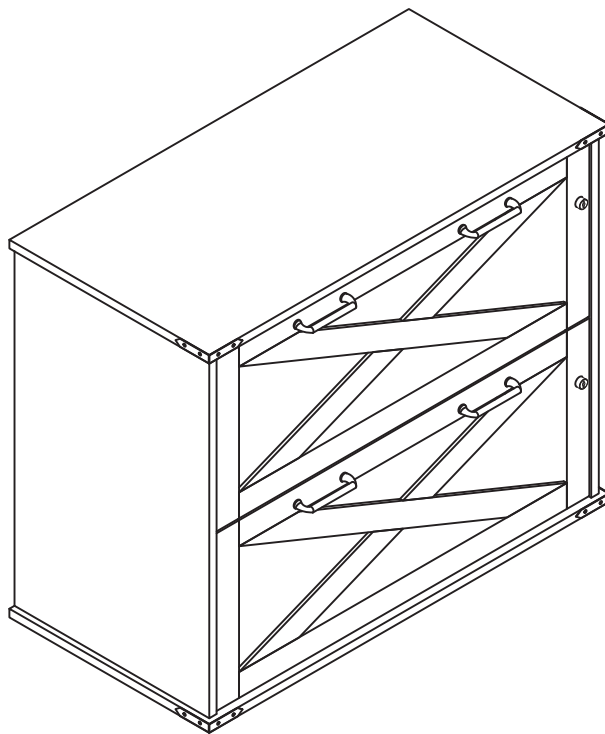

! WARNING :

- Do not allow children to climb on unit
- Serious or fatal crushing injuries can occur from furniture tip-over. To prevent this furniture from tipping over, it must be permanently fixed to the wall. Fixing devices for the wall are not included since different wall materials require different types of fixing devices. Use fixing devices suitable for the walls in your home. For advice on suitable fixing systems, contact your local specialized dealer
- Avoid sharp objects or corrosive chemicals to prevent damage to the product
- During assembly, keep parts and packaging materials away from children and pets as there could be potential injury and choking hazards

Caution:

1. This product is designed for home use and not intended for commercial use.
2. This product contains small components. Please ensure that they are kept away from small children.
3. Be careful when using power tools to assemble your furniture. Power tools may strip or damage the parts.

IDENTIFY PARTS

One unit per box

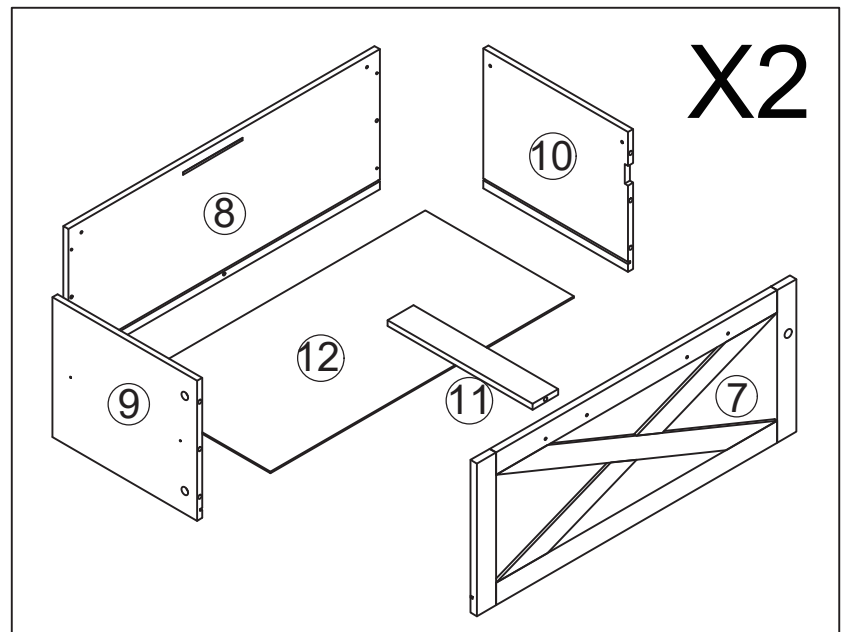
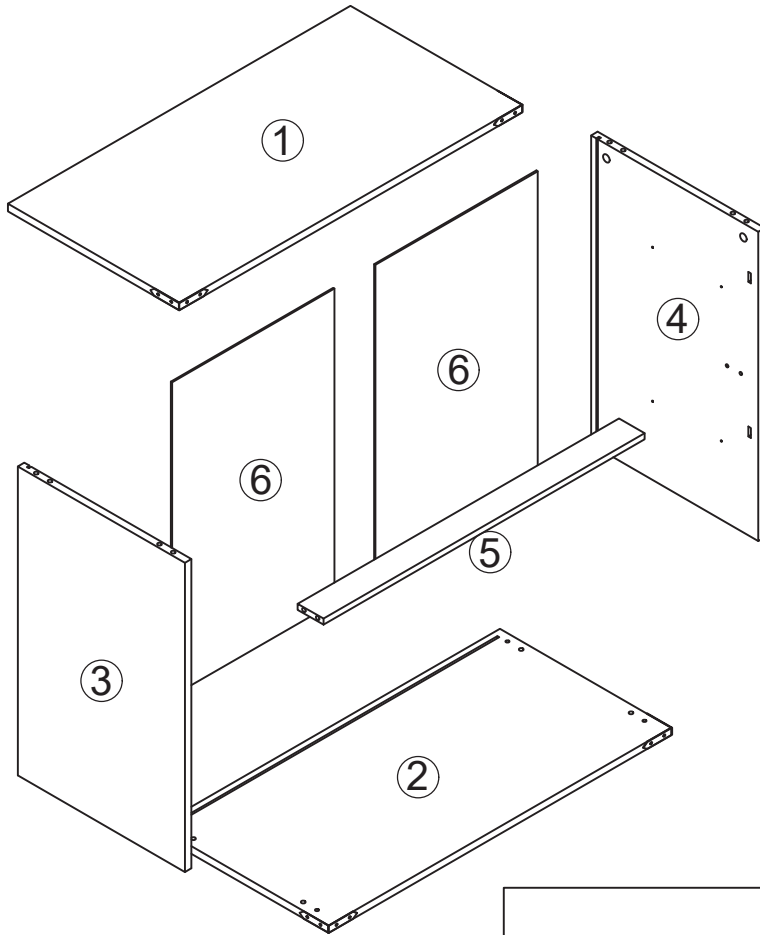

COMPONENTS

1

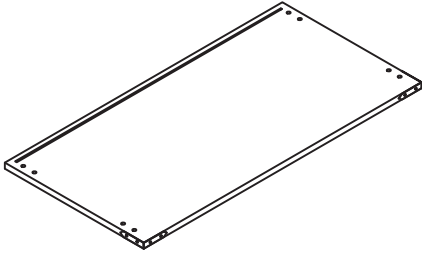

800x400x15mm

Top Panel x1

2

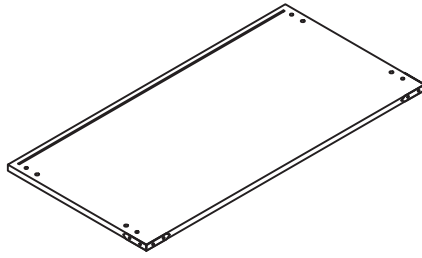

800x400x15mm

Bottom Panel x1

3

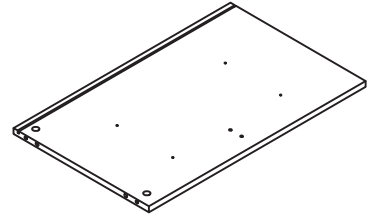

625x390x15mm

Left Side Panel x1

4

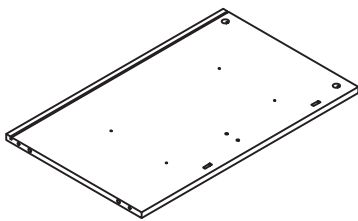

625x390x15mm

Right Side Panel x1

5

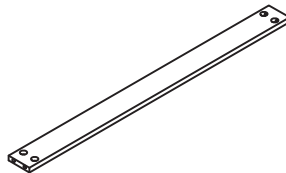

750x60x12mm

Middle Shelf x1

6

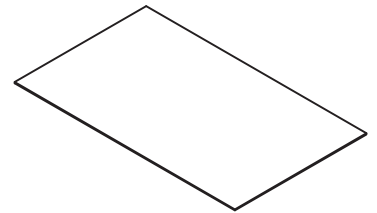

635x379x3mm

Back Panel x2

7

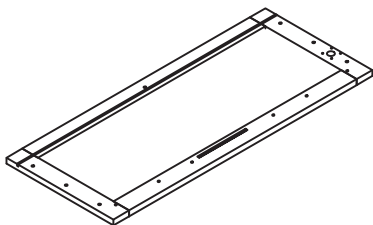

746x308.5x15mm

Drawer Front Panel x2

8

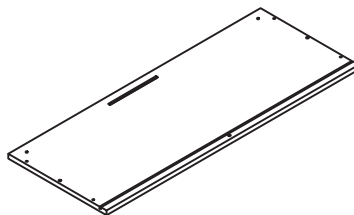

727x283x12mm

Drawer Back Panel x2

9

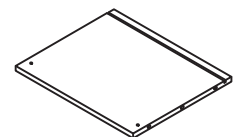

338x283x12mm

Drawer Left Panel x2

COMPONENTS

10

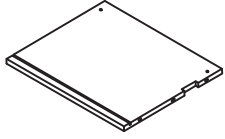

338x283x12mm

Drawer Right Panel x2

11

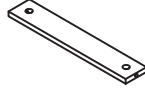

338x60x12mm

Drawer Bottom Pull Strip x2

12

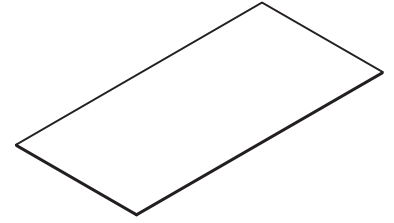

709x347x3mm

Drawer Bottom Panel x2

COMPONENTS

A

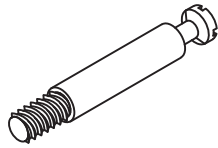

+2(spare)

M6x35mm

Cam Bolt x20

B



+2(spare)

M15x10mm

Cam Lock x20

C

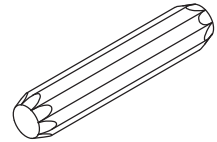

+1(spare)

M8*40mm

Long Wood Dowel x8

D

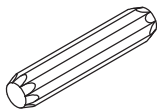

+1(spare)

M6*30mm

Short Wood Dowel x8

E

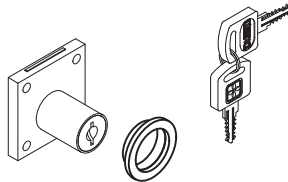

Lock & Keys x2

F



+2(spare)

M3.5x12mm

Screw x16

G

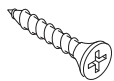

+1(spare)

M3.5x16mm

Screw x8

H

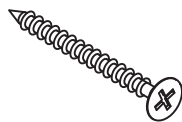

+1(spare)

M3.5x30mm

Screw x8

I

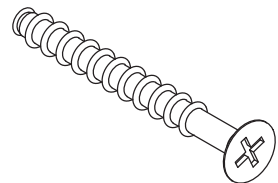

+1(spare)

M7x50mm

Screw x4

J

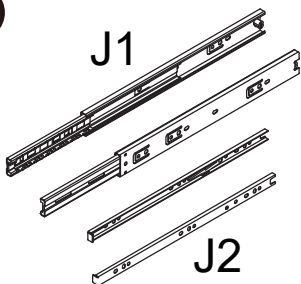

350mm

Three-section Rail x2

K

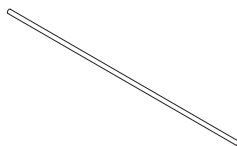

348mm

Short Hanging Rod x8

L

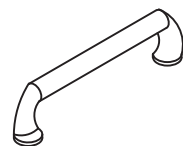

Drawer Handle x4

COMPONENTS

M



M4x19mm

Handle Screw x8

N



Foot Peg x4

O



Back Panel Wedge x8

P



M3x12mm

Screw x8

Q

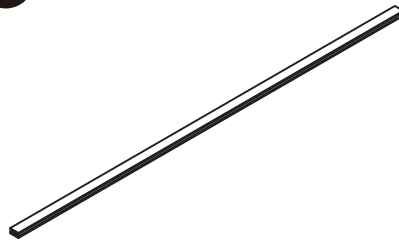

623mm

Back Panel Seam Strip x1

R



R1



R3



R2



R4

Anti-tipping Kit x2

S

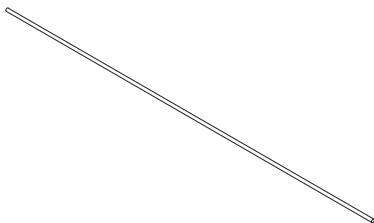

711mm

Long Hanging Rod x4

"A & B" Hardware installation example

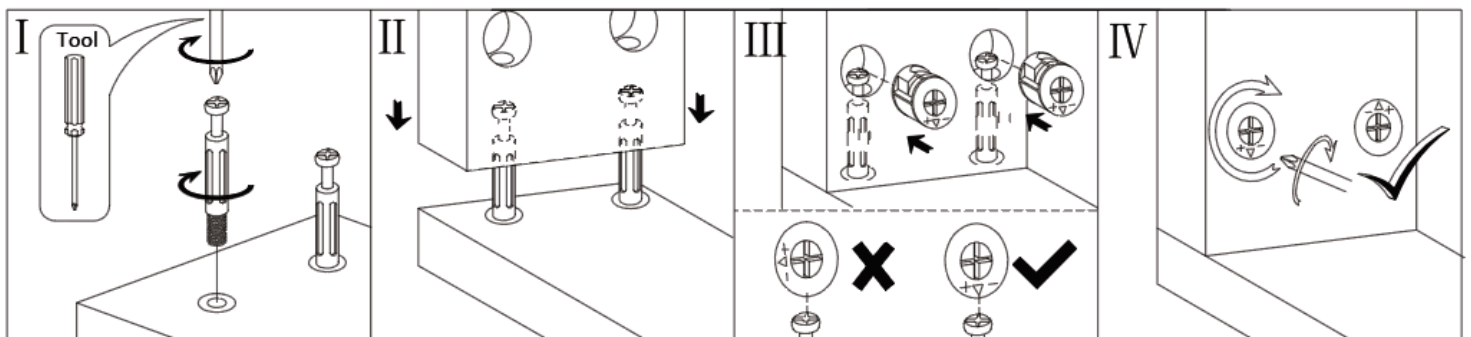

ASSEMBLY STEPS

A x 8



F x 8



J1 x 2



STEP 1

1. Fix rail (J1) on the panel (3) and panel (4) with screws (F).
2. Fix cam bolt (A) on panels (1), (3) and (4).

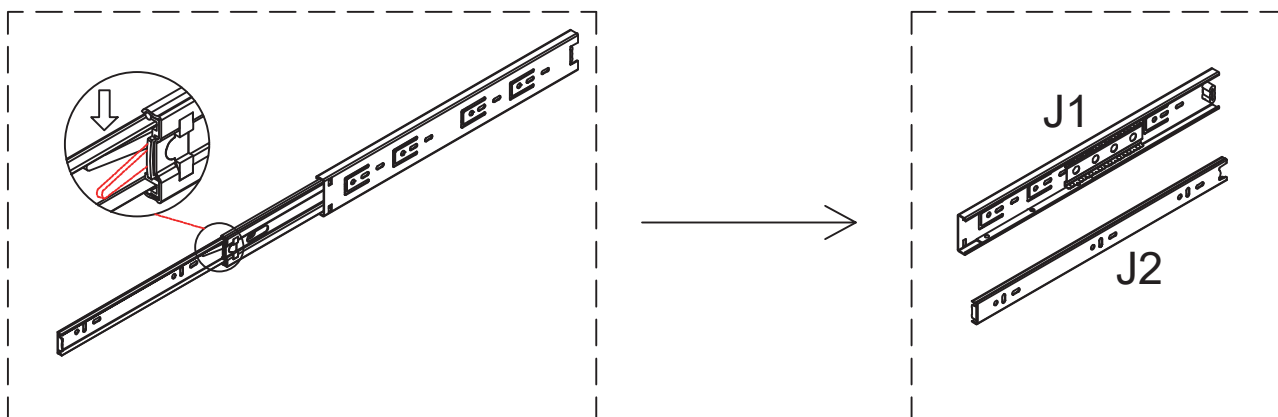

Note: The guide rail is undivided into left and right sides.

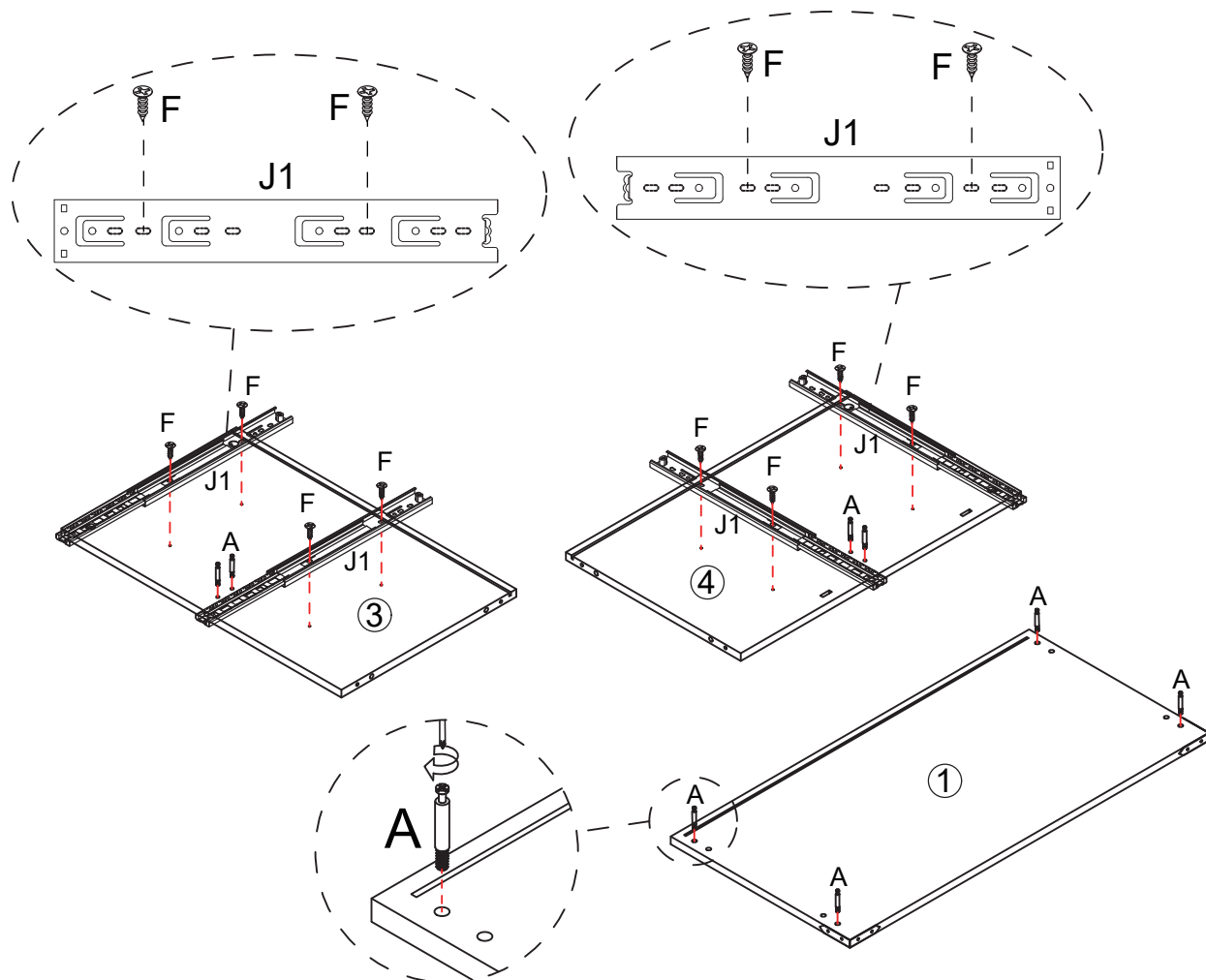

ASSEMBLY STEPS

B x 4



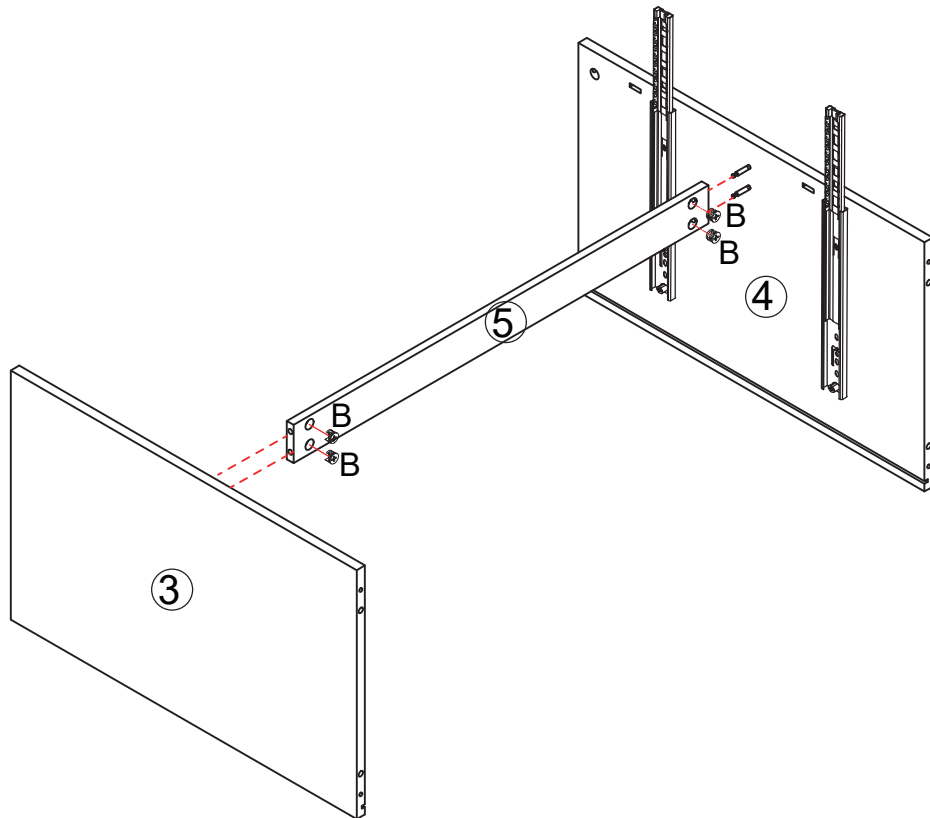

STEP 2

Attach panels (3) and (4) to the panel (5) with cam lock (B).

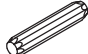

ASSEMBLY STEPS

C x 4		I x 4	 M7*50mm
-------	-----------------------------------------------------------------------------------	-------	-------------------------------------------------------------------------------------------

STEP 3

1. Connect wood dowels (C) to the panels (3) and (4) respectively.
2. Connect screw (I) to the panels (3) and (4) through the panel (2).

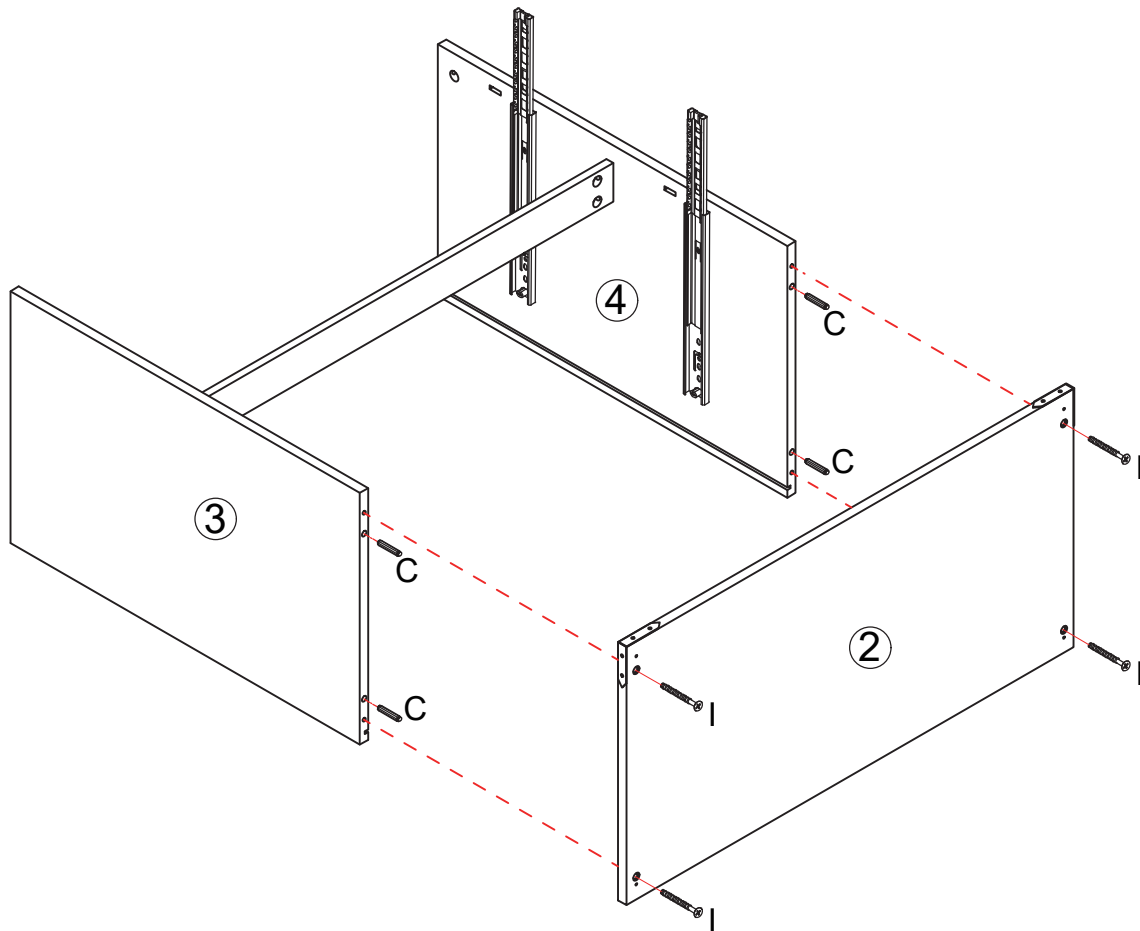

ASSEMBLY STEPS

N x 4



STEP 4

Fix foot peg (N) on the panel (2).

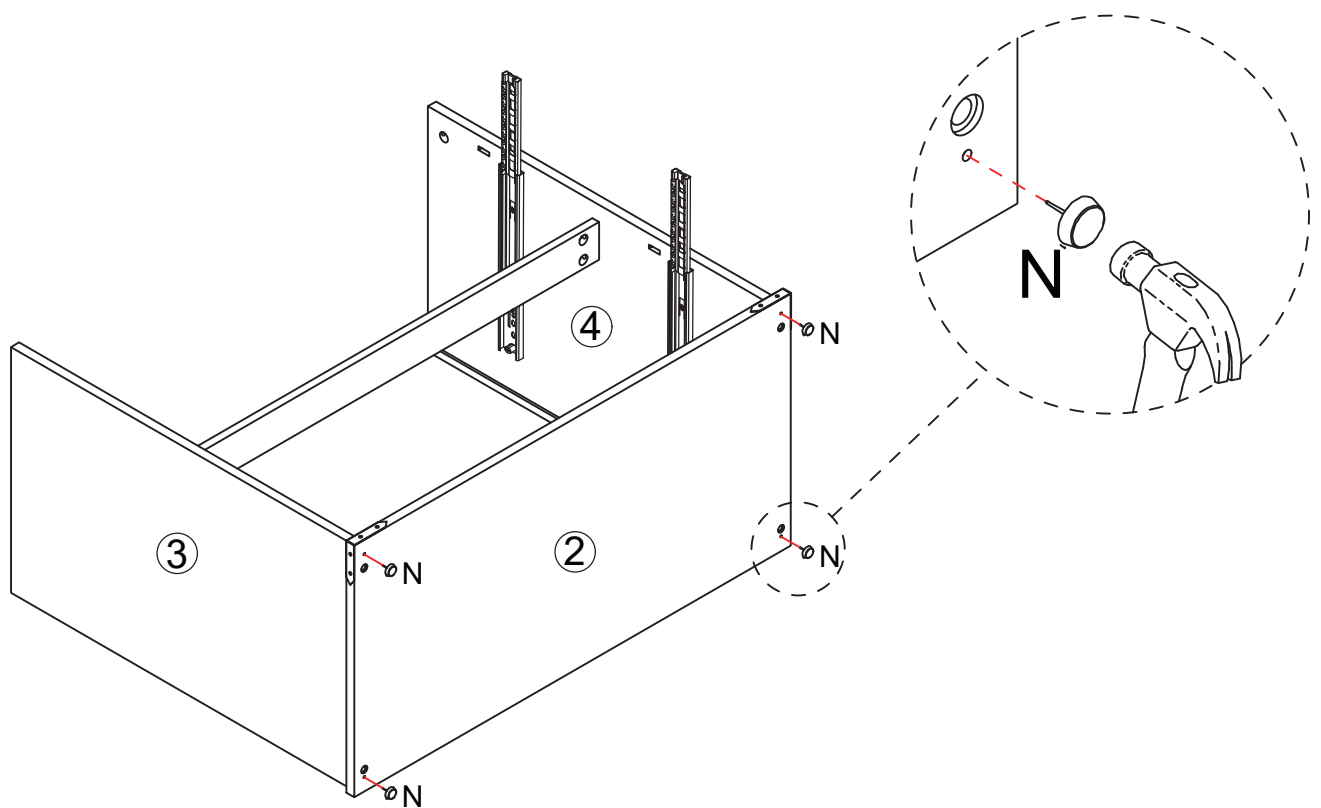

ASSEMBLY STEPS

Q x 1



STEP 5

Insert the two back panels (6) and connect them with back panel seam strip (Q).

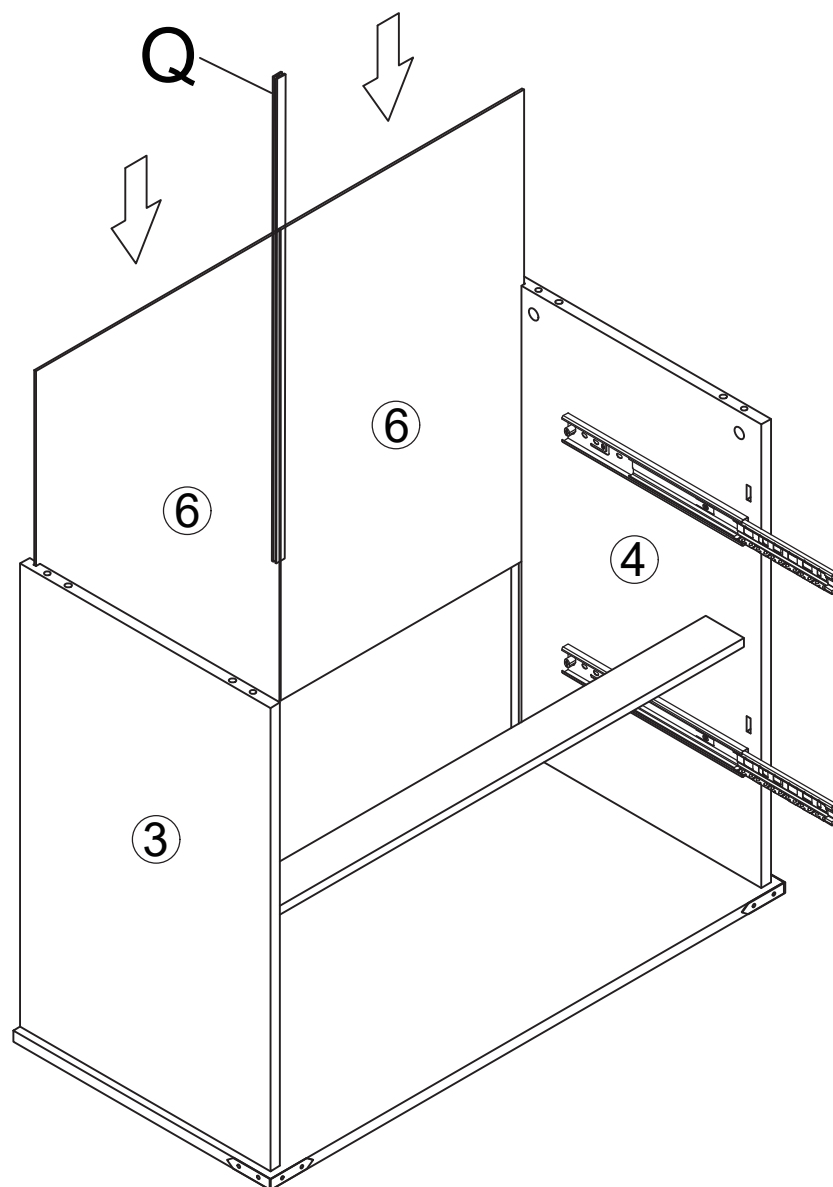

ASSEMBLY STEPS

B x 4



C x 4



STEP 6

1. Connect wood dowels (C) to the panels (3) and (4) respectively.
2. Connect panel (1) to the panels (3) and (4) and lock them with cam locks (B).

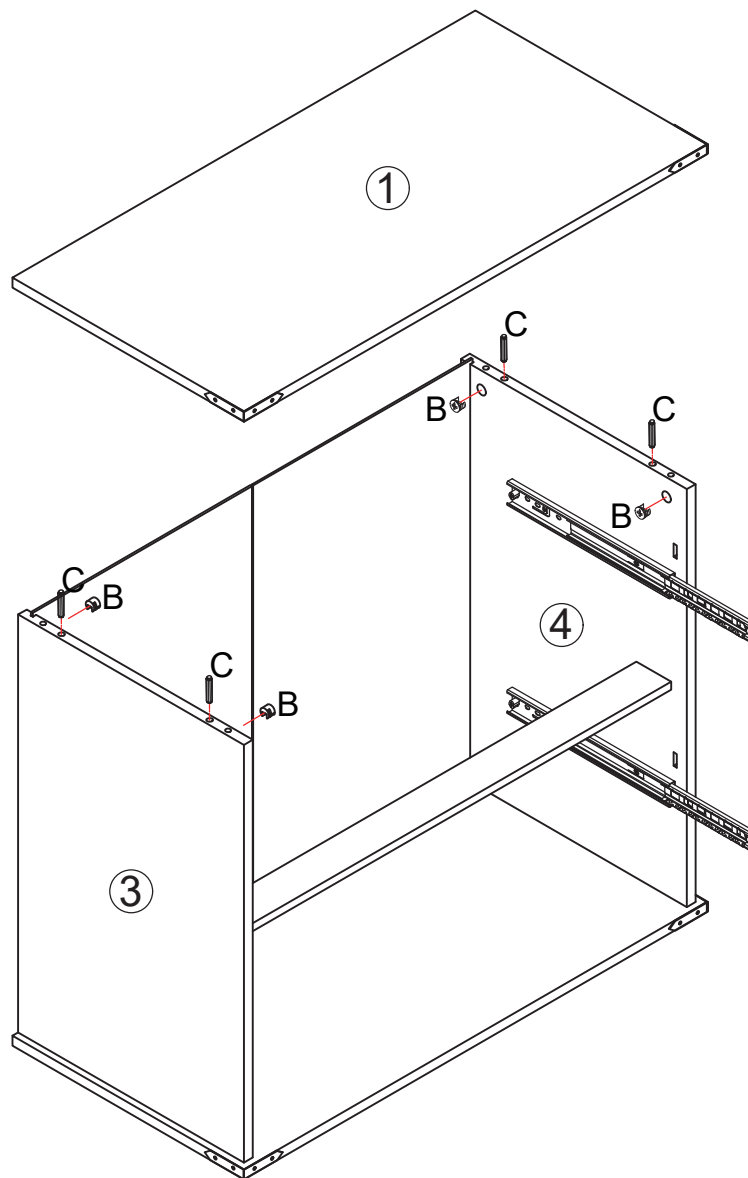

ASSEMBLY STEPS

A x 12



STEP 7

Fix cam bolt (A) to the panels (7) and (8).

X2

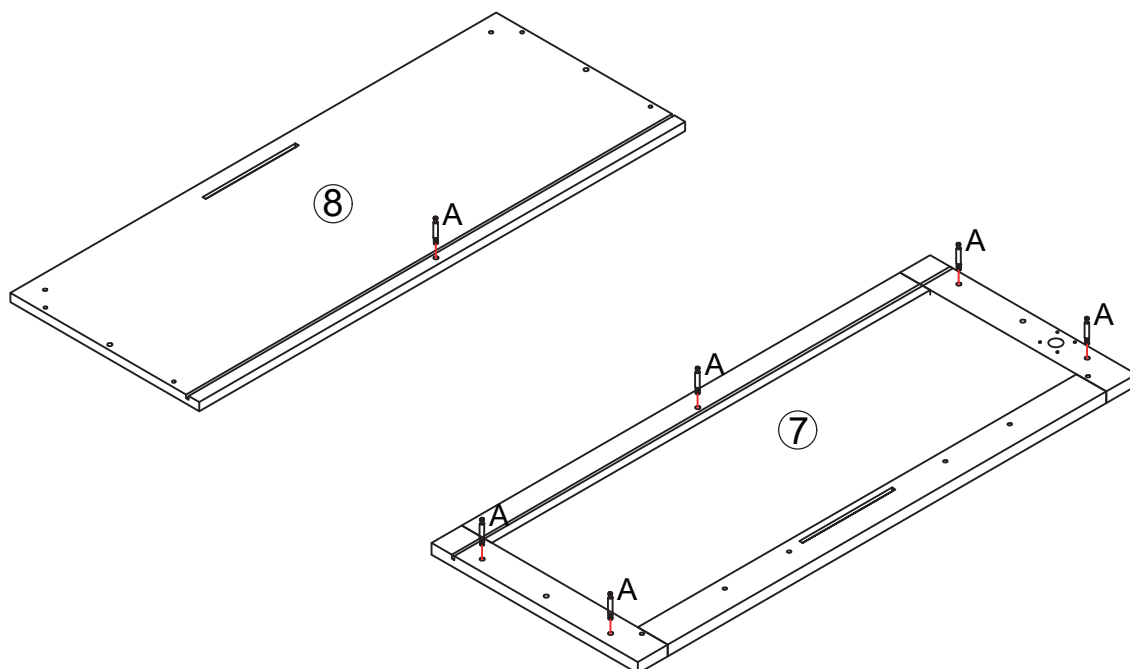

ASSEMBLY STEPS

E x 2		G x 8	M3.5*16mm 	L x 4		M x 8	M4*19mm 
-------	-----------------------------------------------------------------------------------	-------	------------------------------------------------------------------------------------------------	-------	------------------------------------------------------------------------------------	-------	------------------------------------------------------------------------------------------------

STEP 8

1. Assemble lock (E) to panel (7) using screw (G).
2. Assemble handle (L) to panel (7) using handle screw (M).

X2

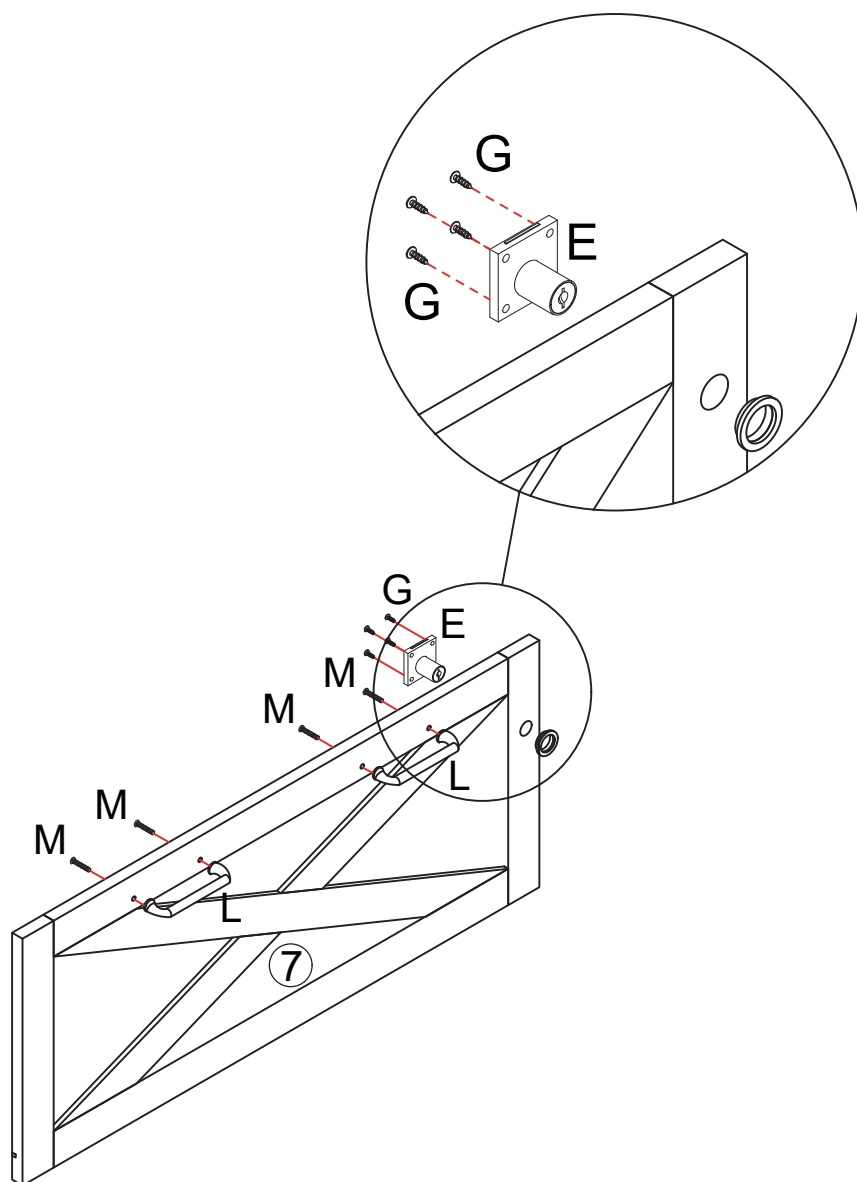

ASSEMBLY STEPS

S x 4

STEP 9

Fix hanging rod (S) to the panels (9) and (10).

X2

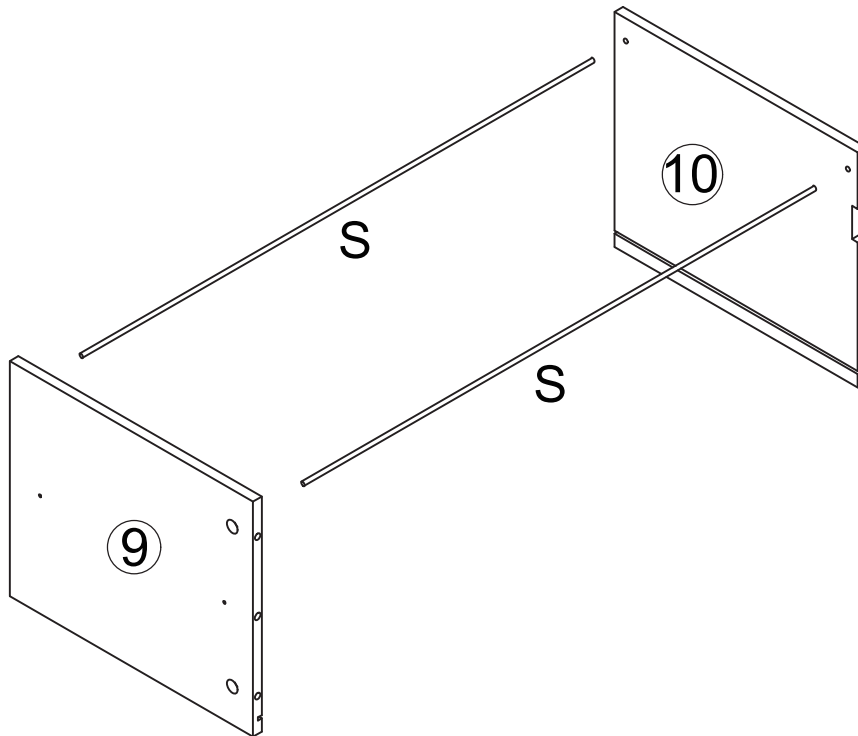

ASSEMBLY STEPS

B x 10



D x 4



STEP 10

1. Connect wood dowel (D) to panel (7).
2. Connect panels (9), (10) and (11) to panel (7) and lock them with cam lock (B).

X2

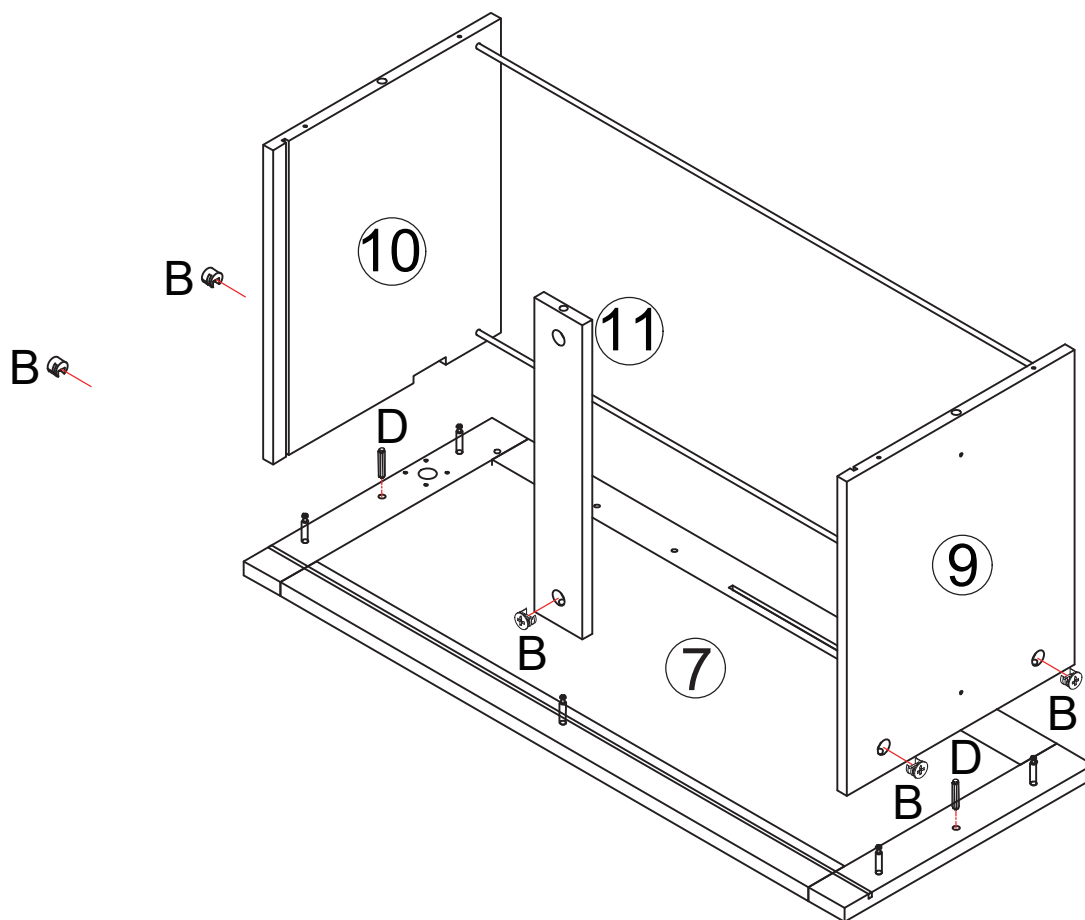

ASSEMBLY STEPS

K x 4



STEP 11

Fix hanging rod (K) to the panel (12).

X2

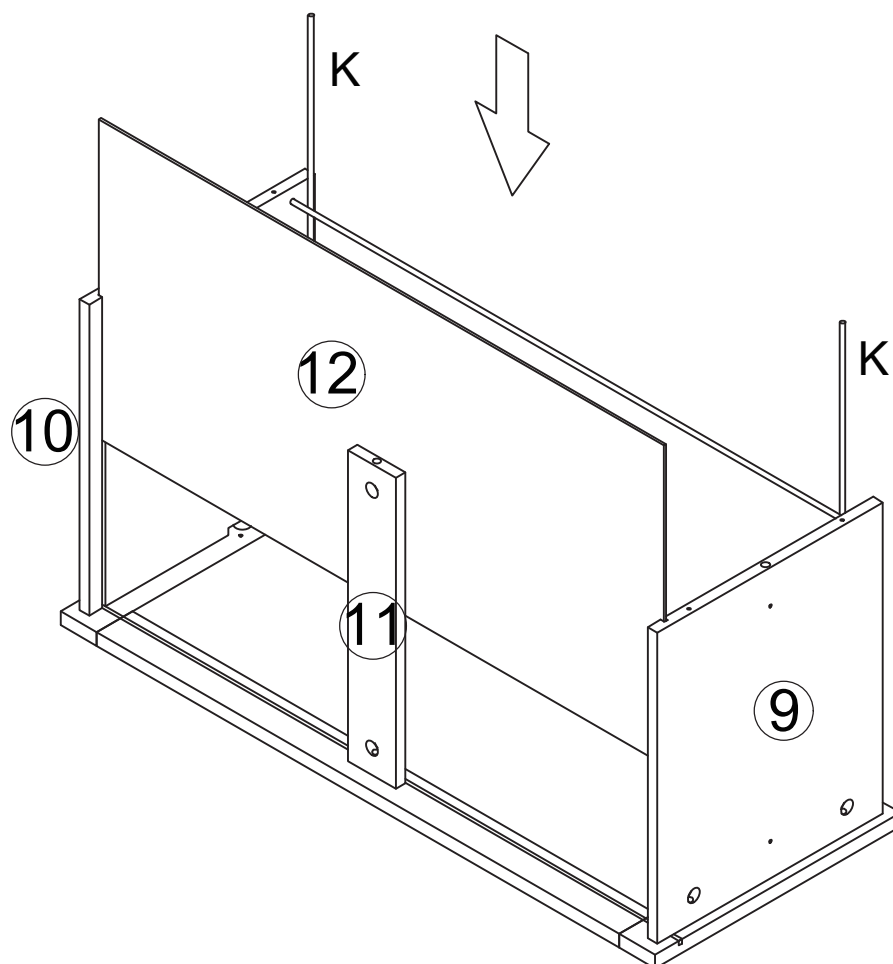

ASSEMBLY STEPS

B x 2		D x 4		H x 8	 M3.5*30mm
-------	-----------------------------------------------------------------------------------	-------	-----------------------------------------------------------------------------------	-------	----------------------------------------------------------------------------------------------

STEP 12

1. Place wood dowels (D) on the panels (9) and (10) respectively.
2. Connect panel (8) with the panels (9) and (10) using the screws (H).

X2

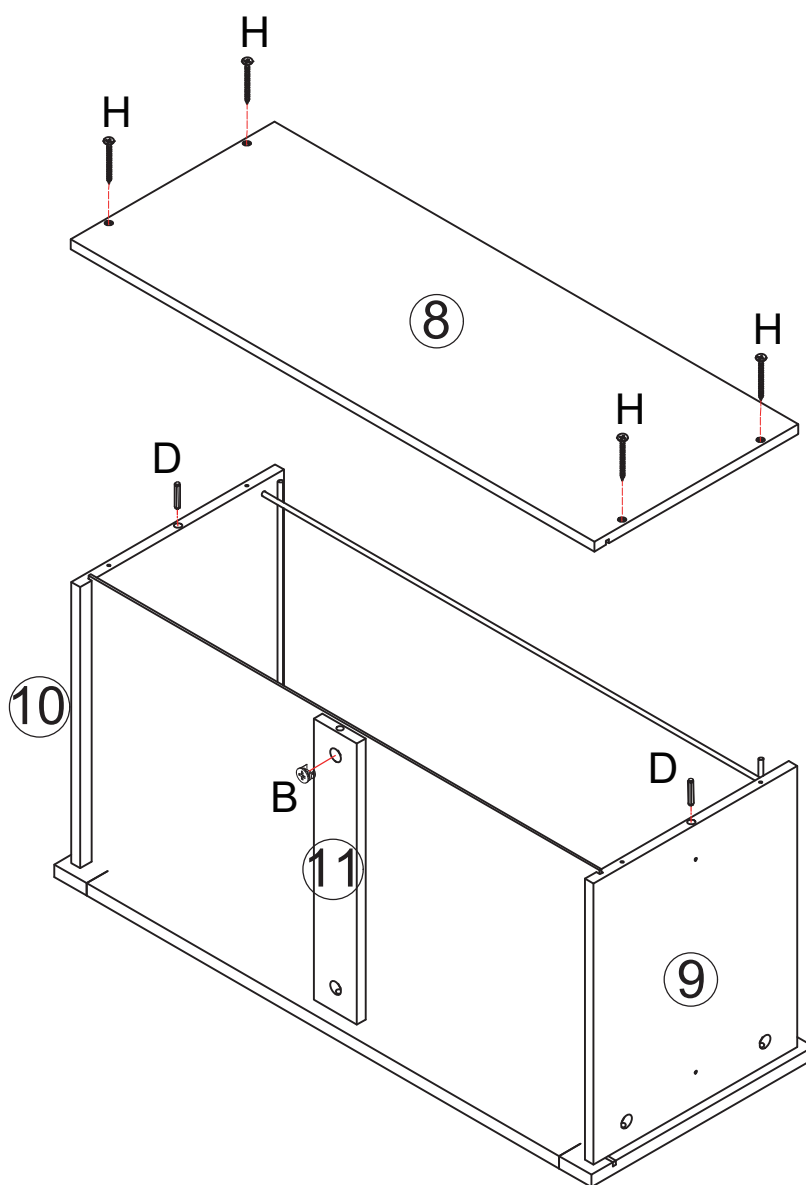

ASSEMBLY STEPS

F x 8	M3.5*12mm 	J2 x 2 	K x 4 
-------	------------------------------------------------------------------------------------------------	---------------------------------------------------------------------------------------------	---------------------------------------------------------------------------------------------

STEP 13

1. Connect rail (J2) to the panels (9) and (10) with screws (F).
2. Install hanging rod (K) to the panels (7) and (8).

X2

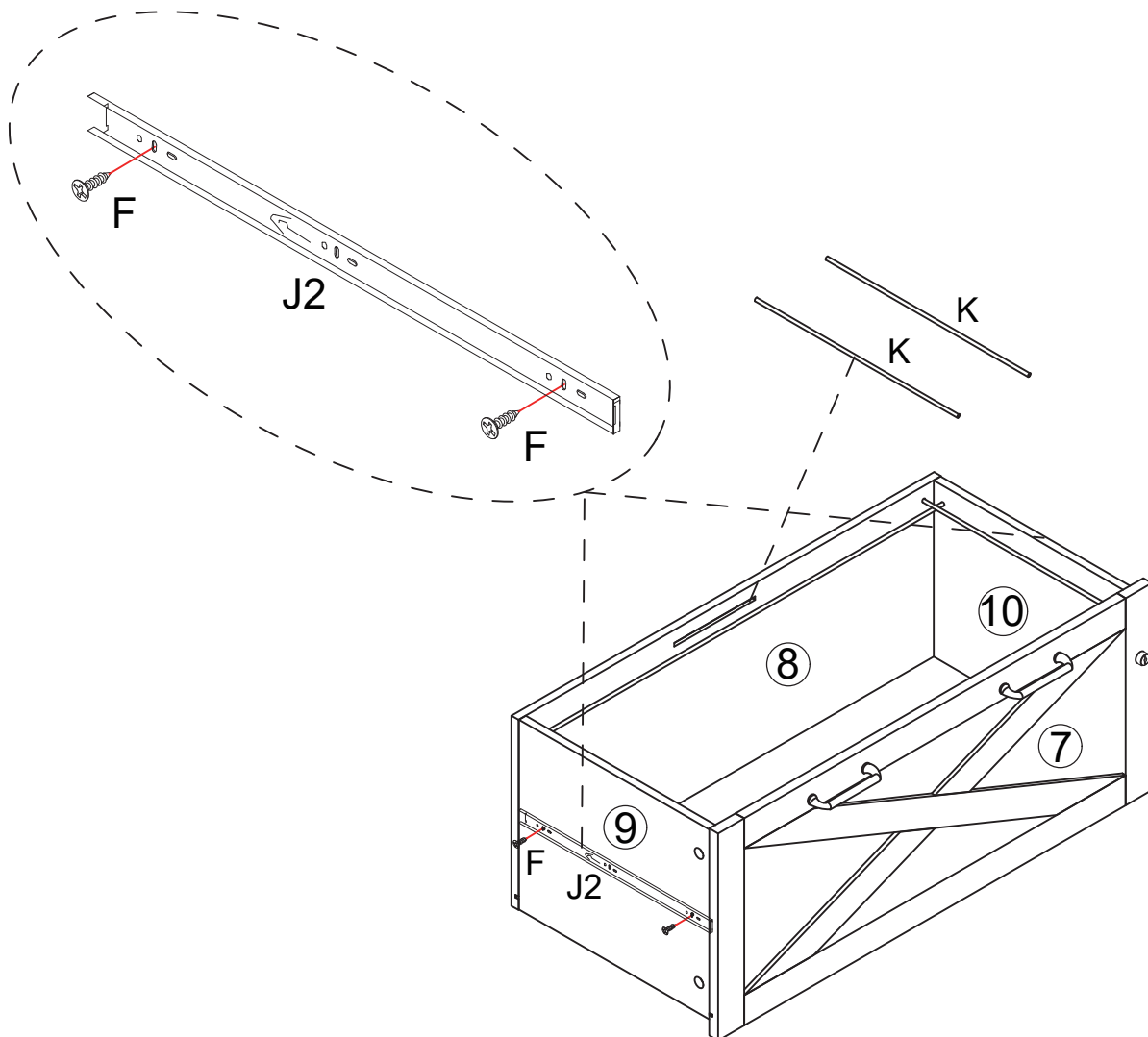

ASSEMBLY STEPS

STEP 14

Align the three-section rail (J1) with the (J2) and push it carefully inside until it stops.

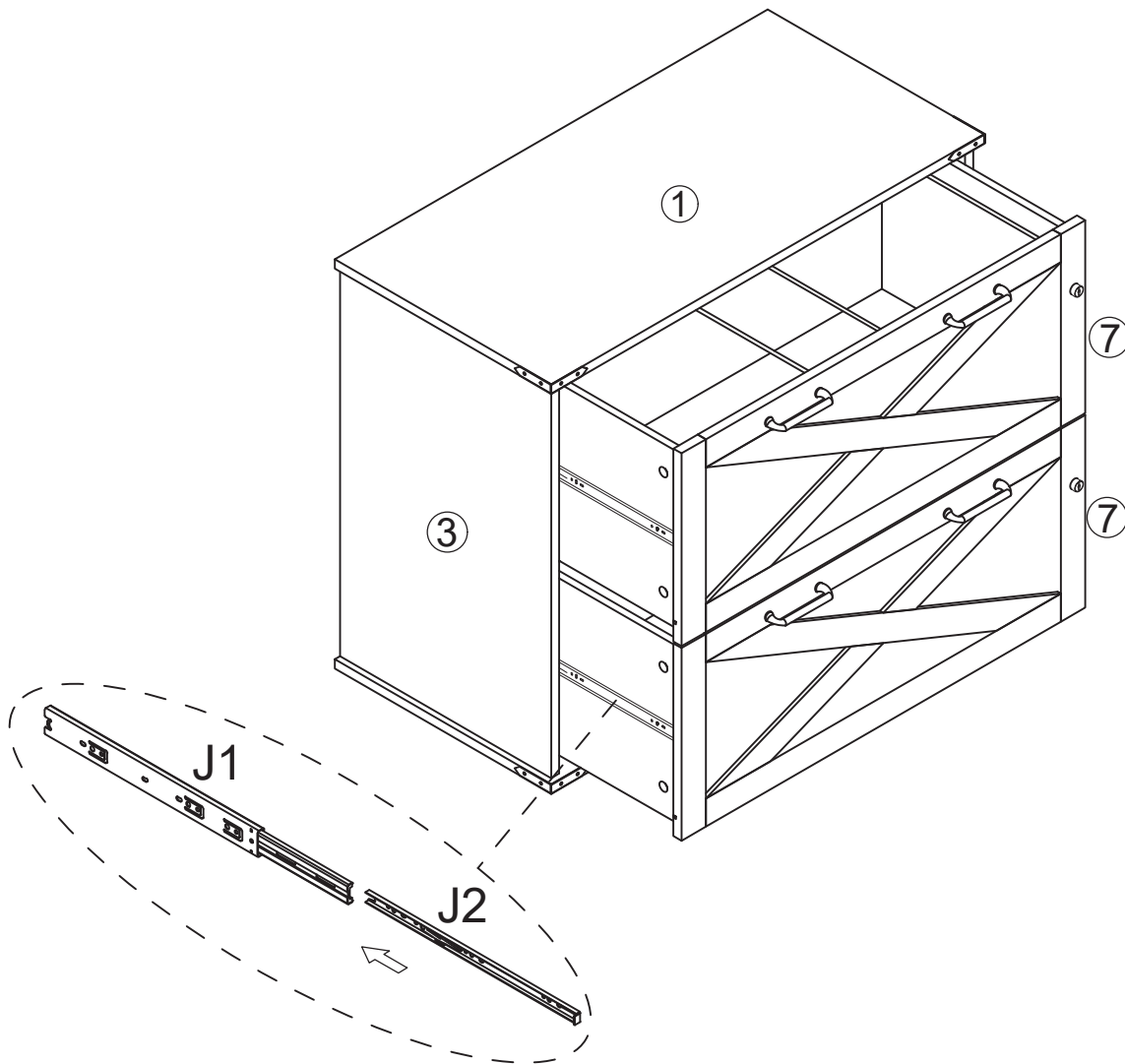

ASSEMBLY STEPS

O x 8



P x 8



M3*12mm

STEP 15

Install back panel wedge (O) to the cabinet with screws (P).

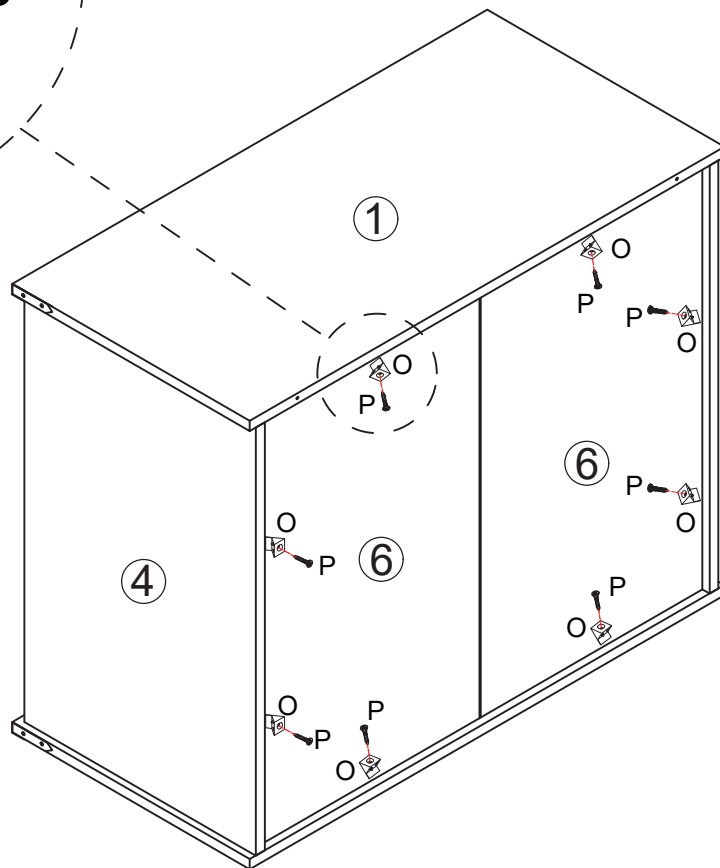
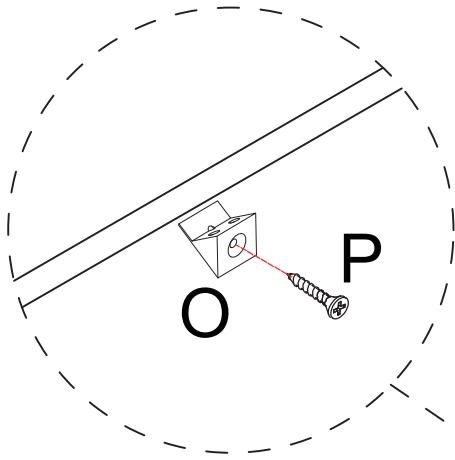

ASSEMBLY STEPS

R1 x 2		R2 x 2	M3.5*14mm 
--------	-----------------------------------------------------------------------------------	--------	------------------------------------------------------------------------------------------------

STEP 16

Assemble anti-tipping kit (R1) to the board using screws (R2).

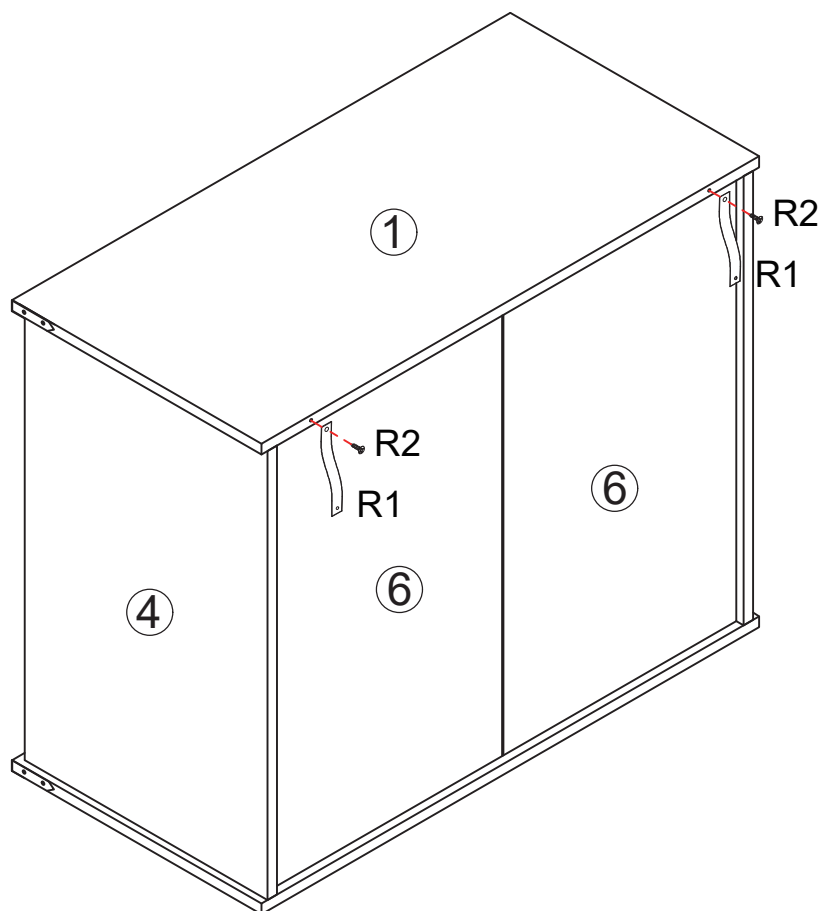

ASSEMBLY STEPS

R3 x 2	M3.5*35mm 	R4 x 2	
--------	------------------------------------------------------------------------------------------------	--------	-----------------------------------------------------------------------------------

STEP 17

1. Install anti-tipping kit (R4) into the wall.
2. Use the anti-tipping kit (R1) to connect the screws (R3) to the anti-tipping kit (R4).

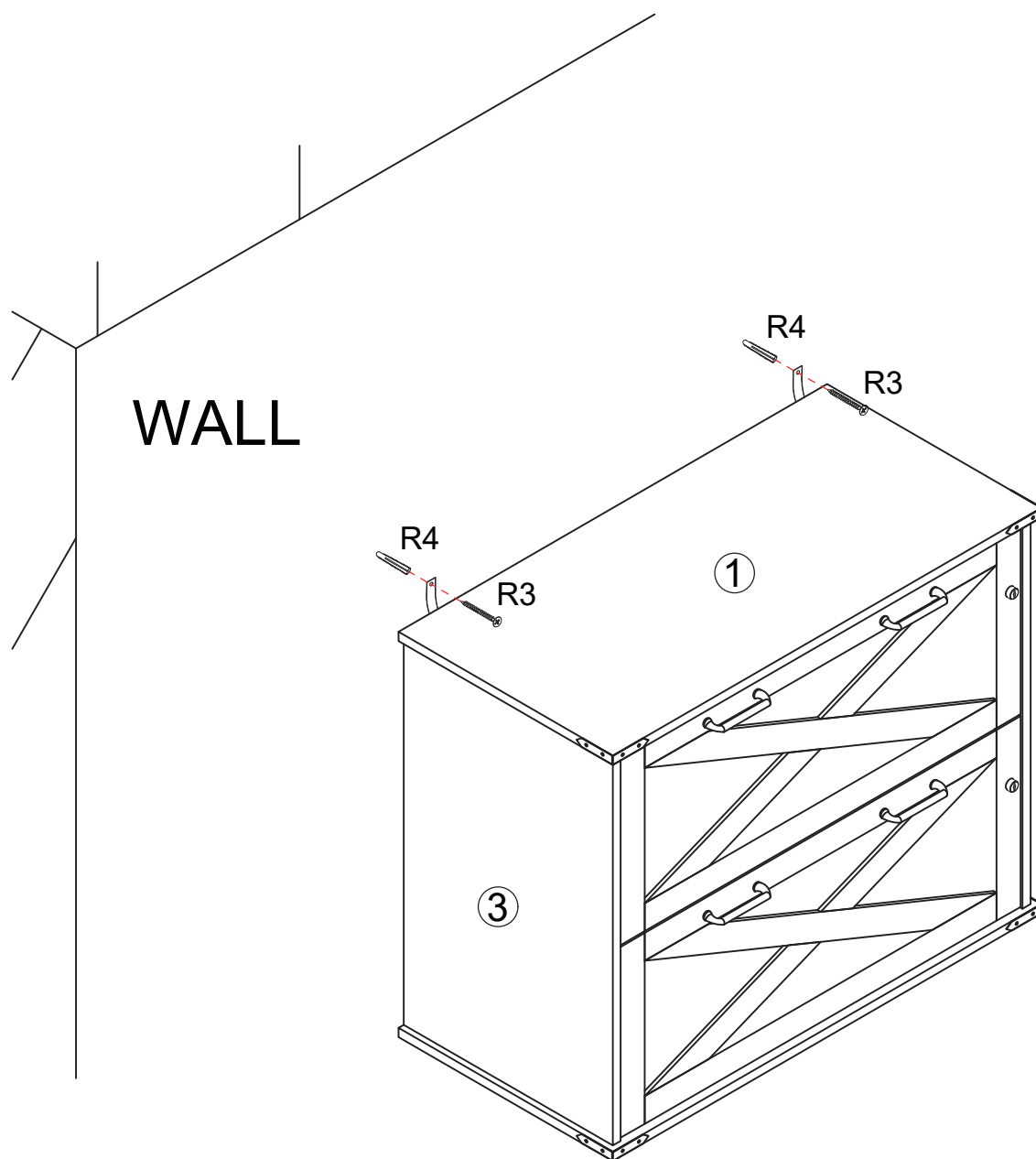

Supplementary Instructions for Safe Use

English

WARNING



Children have died from furniture tipover. To reduce the risk of furniture tipover:

- ALWAYS install tipover restraint provided.
- NEVER put a TV on this product.
- NEVER allow children to stand, climb or hang on drawers, doors, or shelves.
- NEVER open more than one drawer at a time.
- Place heaviest items in the lowest drawers.
- Do not defeat or remove the drawer interlock system.

This is a permanent label.

Do not remove!

French

ATTENTION



Des enfants sont morts du basculement des meubles. Pour réduire le risque de basculement des meubles:

- TOUJOURS installer la retenue de basculement fournie.
- NE JAMAIS mettre de téléviseur sur ce produit.
- NE JAMAIS permettre aux enfants de se tenir debout, de grimper, ou de s'accrocher à des tiroirs, des portes ou des étagères.
- N'ouvrez JAMAIS plus d'un tiroir à la fois.
- Placez les objets les plus lourds dans les tiroirs les plus bas.
- Ne désactivez pas et ne retirez pas le système de verrouillage du tiroir.

Ceci est une étiquette permanente.

Ne pas enlever!

German

WARNUNG



Kinder sind an einem Möbelkipp gestorben. So verringern Sie das Risiko eines Umkippens von Möbeln:

- Installieren Sie **IMMER** die mitgelieferte Kipprückhaltevorrichtung.
- Stellen Sie **NIEMALS** einen Fernseher an dieses Produkt.
- Lassen Sie Kinder **NIEMALS** an Schubladen, Türen oder Regalen stehen klettern oder hängen.
- Öffnen Sie **NIEMALS** mehr als eine Schublade gleichzeitig.
- Legen Sie schwerste Gegenstände in die untersten Schubladen.
- Besiegen oder entfernen Sie das Schubladenverriegelungssystem nicht.

Dies ist ein dauerhaftes Etikett.

Nicht entfernen!