

# PLASTIC PALLET/SKID - PLPS-WD

\*\*\* ANY ADDITIONS, DELETIONS, OR OMISSIONS MUST BE CORRECTED ON THIS DRAWING AS THIS DRAWING WILL BE CONSIDERED ALL INCLUSIVE \*\*\*  
 ALL GRAPHICS PROVIDED ARE FOR REFERENCE ONLY. IF CERTAIN DIMENSIONS ARE CRITICAL PLEASE VERIFY THOSE DIMENSIONS WITH YOUR SALESPERSON

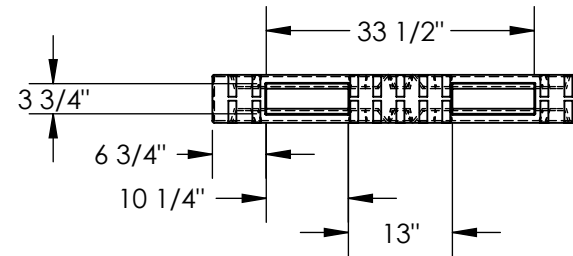
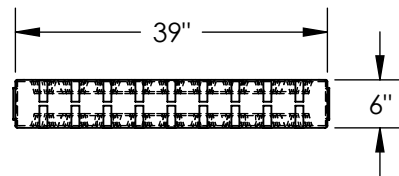
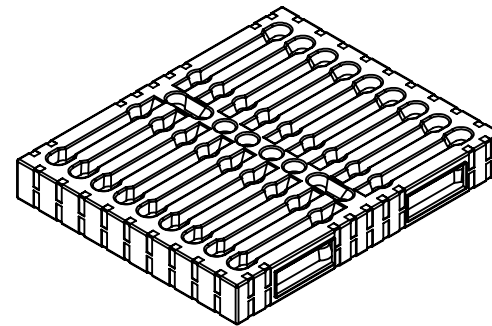
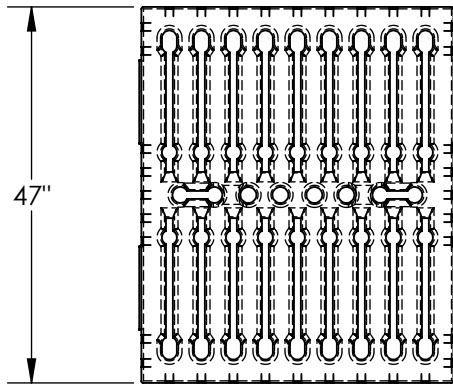

DIMENSION TOLERANCE  $\pm 1/2"$

## STANDARD FEATURES

- MODEL NUMBER IS PLPS-WD
- OVERALL WIDTH IS 39"
- OVERALL LENGTH IS 47"
- OVERALL HEIGHT IS 6"
- FLOOR (STATIC) WEIGHT CAPACITY: 8,000 LBS
- FORK (DYNAMIC) WEIGHT CAPACITY: 3,300 LBS
- UNSUPPORTED PALLET RACK WEIGHT CAPACITY: NOT RATED
- FORK OPENING (W X H): 10 1/4" X 3 3/4"
- BLUE IN COLOR
- APPROX. WEIGHT IS 40 LBS

## SPECIAL FEATURES

NONE

<b>A P P R O V A L</b>	I, THE UNDERSIGNED, AGREE THAT THE PRODUCT AS REPRESENTED SATISFIES DESIGN AND DIMENSION REQUIREMENTS. I ALSO ACKNOWLEDGE MY DUTY TO CONFIRM PRODUCT AND INSTALLATION COMPLIANCE WITH ALL APPLICABLE FEDERAL, STATE AND LOCAL REGULATIONS AND STANDARDS.	
	<b>ALL SPECIAL UNITS ARE NON-RETURNABLE</b> <input type="checkbox"/> As drawn <input type="checkbox"/> As marked	
Signed: _____		Date: _____
<b>LEAD TIME WILL START UPON RECEIPT OF SIGNED APPROVAL DRAWING</b>		

DISTRIBUTOR'S NAME: <b>VESTIL MANUFACTURING</b>		P.O.# X
DRAWN BY: DEY		W.O.# X
DATE: 11/19/10		SALES: X
REFERENCE: X		SCALE: 1:24
QUOTED LEAD TIME: X		FILE NAME: 30-007-199
QUOTE # X		