

**WARNING!**



Be sure electrical power is OFF before and during installation or maintenance.  
The luminaire must be installed by a qualified electrician, in accordance with all applicable local codes.

Ensure that the rated luminaire voltage requirements are compatible with the available mains supply in which it will be installed.  
All LEDs are included in your lamp. Never touch the LED surface with your bare hands as this may reduce the life of your LED.  
Do not alter, relocate or remove any electrical component.

Line: Esfera  
Family: Table lamp / Floor lamp  
Input voltage: 120 - 240V  
Input frequency: 60 Hz  
Isolation: Class II

Material: Natural Wood Veneer MDF and Glass Globe

**MOUNTING ON THE FIXTURE**

Read carefully all the assembling instructions below and turn OFF energy power before starting the installation.

- ① Remove the protecting package from the pieces taking care to not harm any parts with cutting surfaces or objects.
- ② Install an A15 E26 light bulb, with a maximum wattage rating of 25W, globe on one of its ends, carefully sliding it in and releasing
- ③ After the lamp and glass globe installation is complete, use the power switch to turn ON/OFF.

Your luminaire is ready for use.

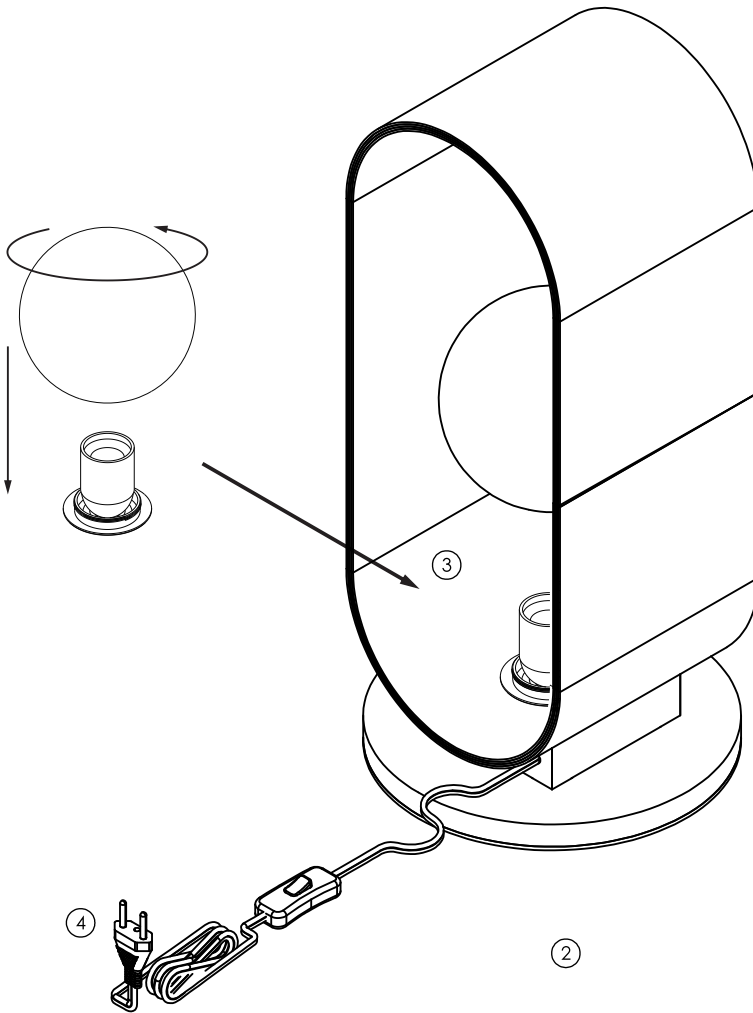

**ATTENTION!**

FAILURE TO COMPLY WITH THESE INSTRUCTIONS MAY CAUSE ACCIDENTS AND LOSS OF PRODUCT WARRANTY.  
It's recommended to read these instructions completely and carefully before proceeding.

**SAVE THESE INSTRUCTIONS FOR FUTURE REFERENCE.**

ACCORD Lighting guarantees coverage against manufacturing defects including electrical components and finishes, for a period of three years, under normal use, from the date of purchase. For warranty service, please contact your local dealer for further instructions. Proof of date of purchase will be required for validation of warranty service.

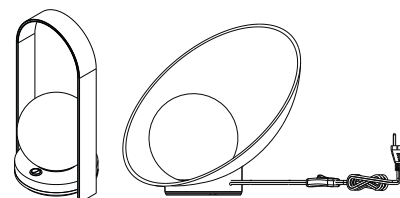

The responsibility of the manufacturer regarding the product warranty is related to the correct observation of the instructions contained in this manual.  
The manufacturer is not responsible for any damage to the product caused by accidents, alterations of any kind, improper usage or improper installation.  
See the website for additional warranty details.

ACCORD Lighting reserves the right to change the dimensions and specifications contained in this manual without prior notice, in accordance with its policy of continuous product improvement. Please, contact the manufacturer if additional information is necessary. The illustrations in this manual are for guidance only and may vary in scale, dimensions and model details.

**WARNING!**



Be sure electrical power is OFF before and during installation or maintenance.  
The luminaire must be installed by a qualified electrician, in accordance with all applicable local codes.

Ensure that the rated luminaire voltage requirements are compatible with the available mains supply in which it will be installed.  
All LEDs are included in your lamp. Never touch the LED surface with your bare hands as this may reduce the life of your LED.  
Do not alter, relocate or remove any electrical component.

Line: Esfera  
Family: Table lamp

Input voltage: 120 - 240V  
Input frequency: 60 Hz  
Isolation: Class II

Material: Natural Wood Veneer MDF and Glass Globe

**MOUNTING ON THE FIXTURE**

Read carefully all the assembling instructions below and turn OFF energy power before starting the installation.

- 1 Remove the protecting package from the pieces taking care to not harm any parts with cutting surfaces or objects.
- 2 Install an A15 E26 light bulb, with a maximum wattage rating of 25W.
- 3 After the lamp and glass globe installation is complete, use the power switch to turn ON/OFF.

Your luminaire is ready for use.

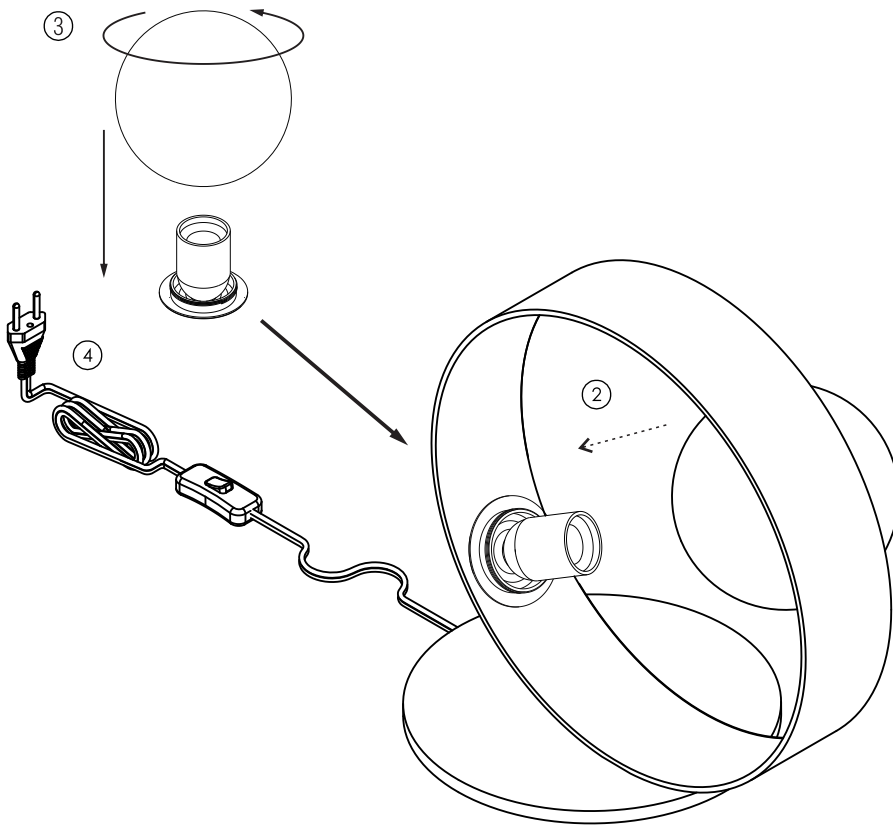

**ATTENTION!**

FAILURE TO COMPLY WITH THESE INSTRUCTIONS MAY CAUSE ACCIDENTS AND LOSS OF PRODUCT WARRANTY.  
It's recommended to read these instructions completely and carefully before proceeding.

**SAVE THESE INSTRUCTIONS FOR FUTURE REFERENCE.**

ACCORD Lighting guarantees coverage against manufacturing defects including electrical components and finishes, for a period of three years, under normal use, from the date of purchase. For warranty service, please contact your local dealer for further instructions. Proof of date of purchase will be required for validation of warranty service.

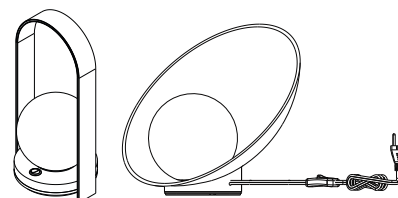

The responsibility of the manufacturer regarding the product warranty is related to the correct observation of the instructions contained in this manual.  
The manufacturer is not responsible for any damage to the product caused by accidents, alterations of any kind, improper usage or improper installation.  
See the website for additional warranty details.

ACCORD Lighting reserves the right to change the dimensions and specifications contained in this manual without prior notice, in accordance with its policy of continuous product improvement. Please, contact the manufacturer if additional information is necessary. The illustrations in this manual are for guidance only and may vary in scale, dimensions and model details.