

ASSEMBLY INSTRUCTIONS

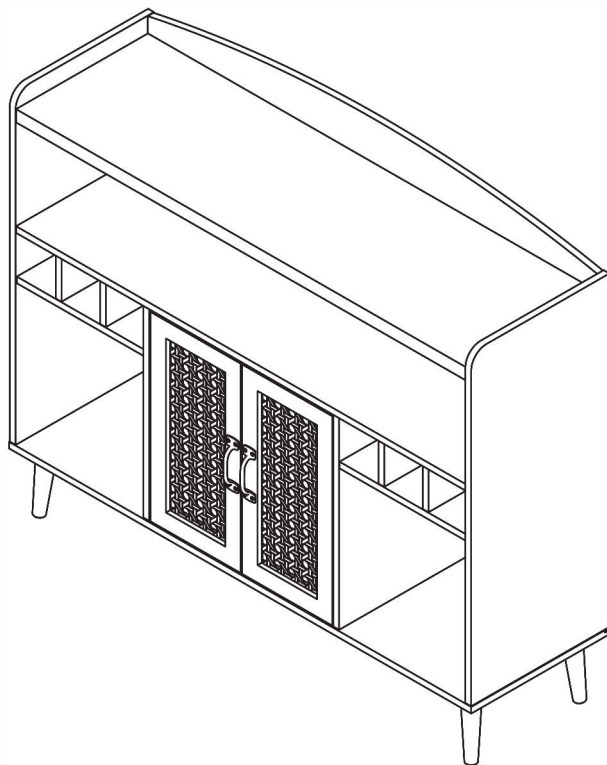

TOOLS REQUIRED



Hammer

(Not Included)



Philips Screwdriver

(Not Included)



**2 - People
Recommended**

ASSEMBLY RATING



EASY —————> DIFFICULT

The Assembly Rating is a 5-point system showing the level of effort needed to assemble a specific product.



CHECK BEFORE STARTING



Are you missing anything?

Double-check all parts, hardware and accessories listed on Page 6 are accounted for.



Check out our Quick Tips!

We recommend reviewing the pre-assembly handouts. Even experts need a refresher now and then!



Prep Time!

Please review the assembly instructions and all diagrams prior to assembling. Arrange parts as recommended on Page 7 and group identical hardware together to make assembling easier.

PRE ASSEMBLY INTRODUCTION

We understand building ready-to-assemble furniture can be a challenging experience for some. To help avoid confusion, we have provided some helpful tips that may speed up the process.



Teamwork

ALWAYS have at least two people to help with transporting and assembling the product to avoid potential injury and/or damage.

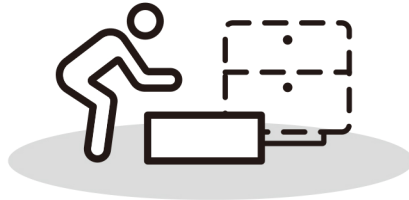

Suitable Location

Assembling near the area of the intended location is highly recommended.



Sufficient Space

Make sure you have enough space to move around during the assembly.



Avoid Scratches

Use cardboard, blankets or a carpeted area while assembling furniture to prevent scratches.

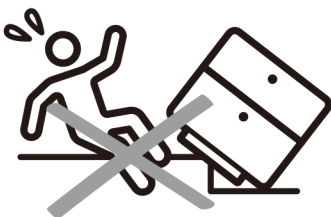

Flat Surface

Make sure the furniture rests on a flat and level surface with each leg evenly touching the floor.

ASSEMBLY AND CARE ADVICE



**FAILURE TO FOLLOW THE GUIDELINES BELOW MAY
RESULT IN INJURY AND/OR PROPERTY DAMAGE.**



Position each part correctly
and insert screws or bolts into
their respective holes.

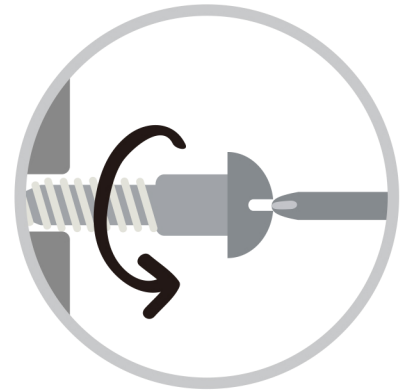

Turn clockwise to tighten and
only tighten when step is
completed or when instructed
to do so.



Save the instructions and store
any supplied tools for later
maintenance.

Use the appropriate hand tools
or power tools for assembly.
Select steps, such as tightening
screws and/or bolts, may require
hand tools to avoid causing
damage during assembly.

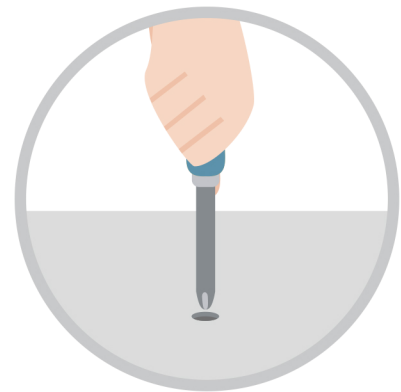

After two weeks, check and
tighten any loose hardware and
repeat again every six months
thereafter.

IT IS THE USER'S RESPONSIBILITY TO MAINTAIN THE FURNITURE. THE HARDWARE MAY LOOSEN OVER TIME AND MAY CAUSE THE FURNITURE TO BE WOBBLY AND UNABLE TO SUPPORT ITS INTENDED WEIGHT CAPACITY. THIS MAY LEAD TO COLLAPSE AND MAY CAUSE SERIOUS INJURY.

CAM LOCK FASTENER ASSEMBLY INSTRUCTIONS

Note :

Every cam lock bolt must have a cam lock connector in order to fasten the parts together.

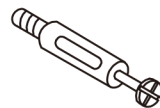

cam bolt



cam lock

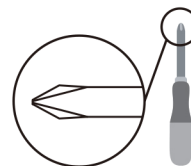

screwdriver

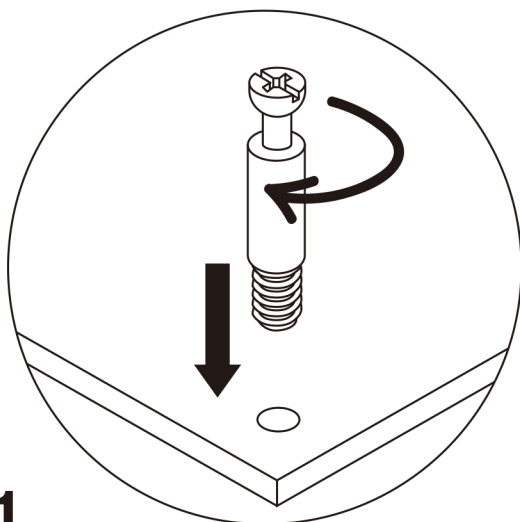

1

Screw the cam bolt into panel.

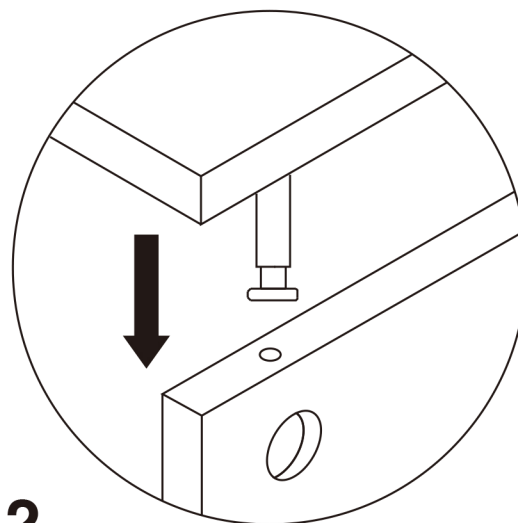

2

Insert the cam bolt into the bolt hole of joint panel.

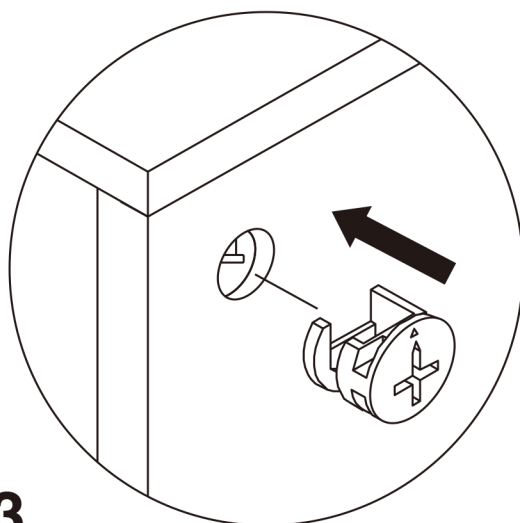

3

Align the cam lock with its side opening (or arrow) pointing to cam bolt.

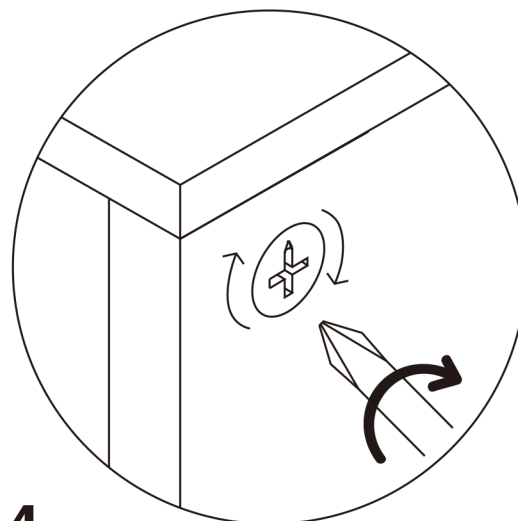

4

Turn the cam lock clockwise gently until it will not turn any more.

BUFFET



- Please keep instructions for future reference.
- Check the quantity and irregularity of parts and hardware before you start.

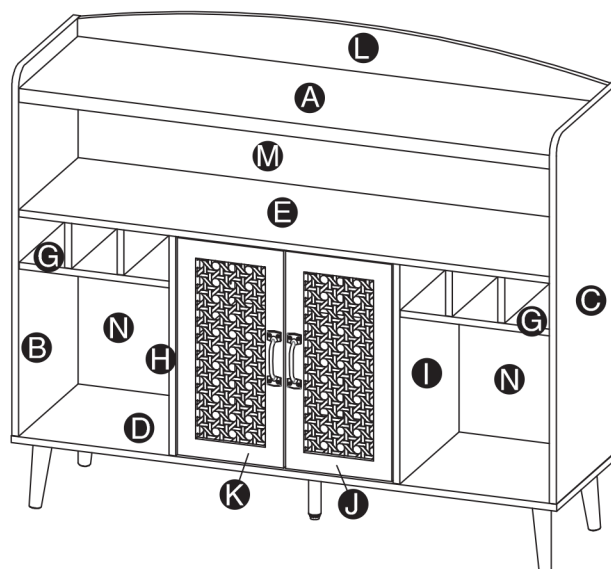

PARTS

A1PC

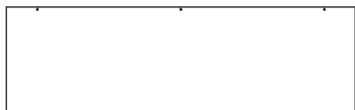

B1PC



C1PC

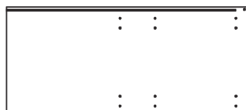

D1PC

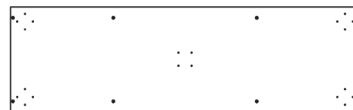

E1PC



F4PCS



G2PCS

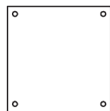

H1PC

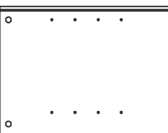

I1PC

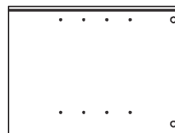

J1PC

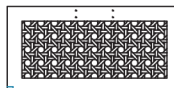

K1PC

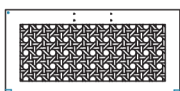

L1PC



M1PC



N2PCS



O2PCS



P1PC



HARDWARE

① 20PCS ② 20PCS ③ 46PCS ④ 11PCS

0.47"

0.98"

1.49"



⑤ 8PCS

⑥ 20PCS

⑦ 1PC

⑧ 2PCS



⑨ 2PCS

⑩ 2PCS

⑪ 4PCS

⑫ 1PC

(Fixed)



ACCESSORIES

A14PCS



A24PCS



A31PC



A41PC



A516SETS



A64PCS



A72PCS



A82PCS



A91PC



A101PC



A111PC



A121PC



A132PCS



A141PC



A151PC



GET READY

Please group boards as below.

L1PC

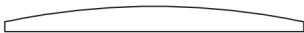

A1PC

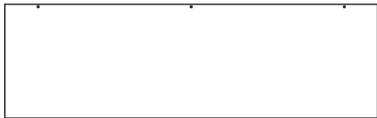

G2PCS

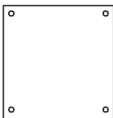

H1PC



I1PC

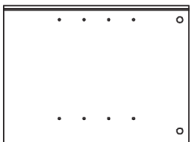

E1PC



F4PCS



B1PC

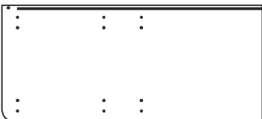

M1PC



C1PC

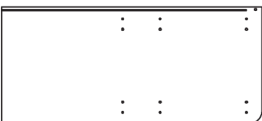

N2PCS



O2PCS



D1PC

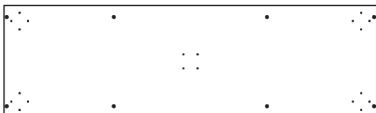

Body

J1PC

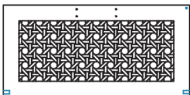

K1PC

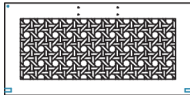

P1PC



Doors
/Shelf

ASSEMBLY INSTRUCTIONS

1

Hardware ① x 20PCS

Hardware ③ x 46PCS

Accessory A7 x 1PC

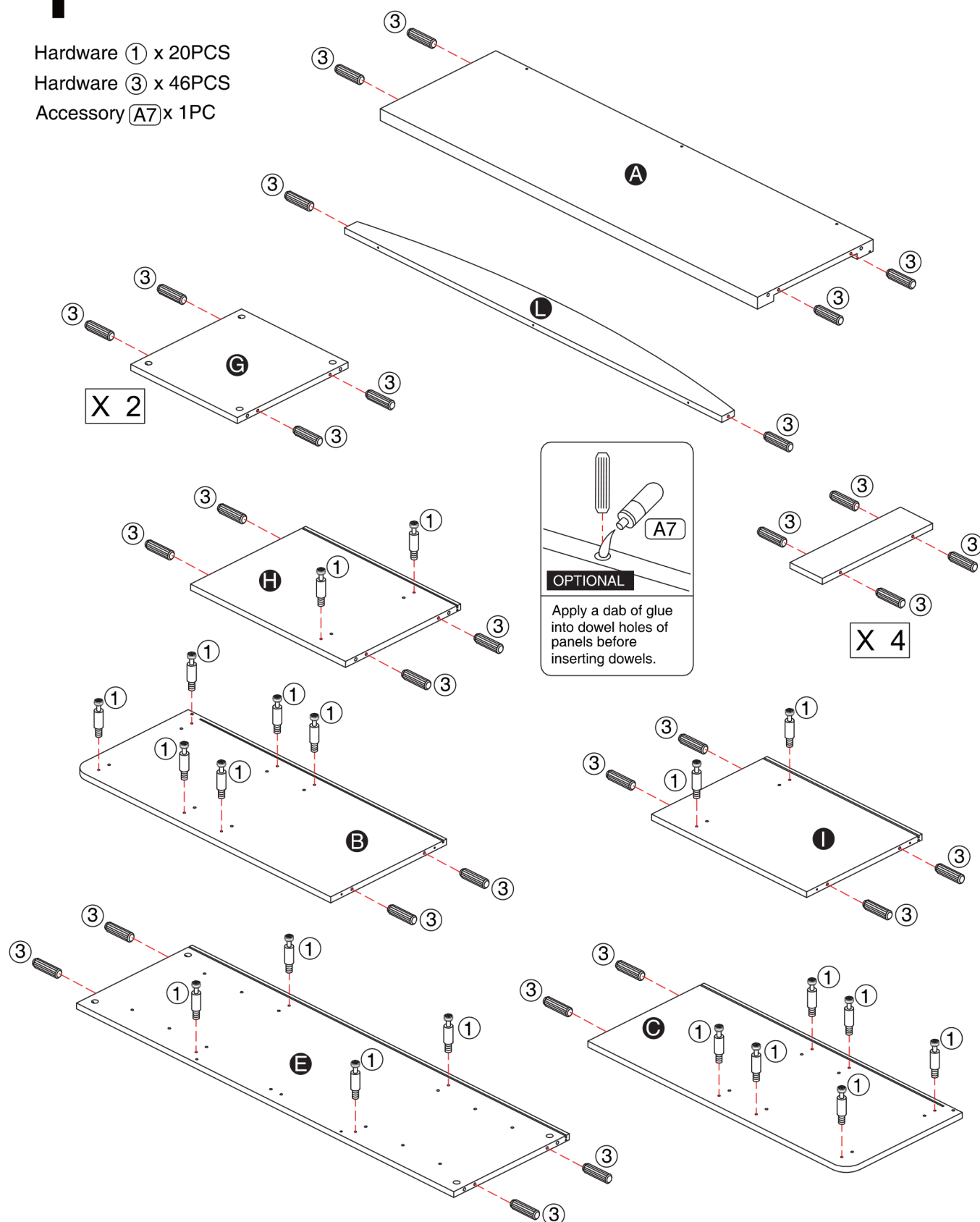

ASSEMBLY INSTRUCTIONS

2

Hardware ⑤ x 8PCS
 Hardware ⑧ x 2PCS
 Hardware ⑨ x 2PCS
 Hardware ⑩ x 2PCS
 Accessory (A8) x 2PCS

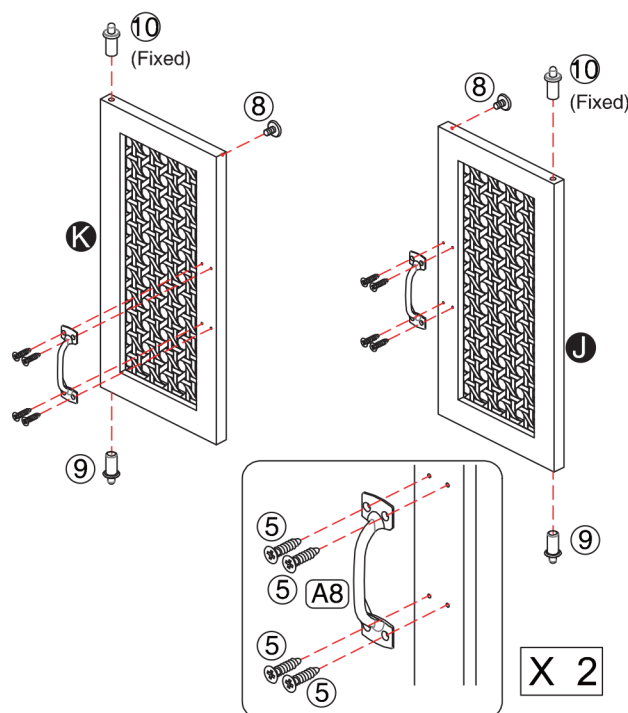

3

Hardware ⑥ x 16PCS
 Accessory (A2) x 4PCS

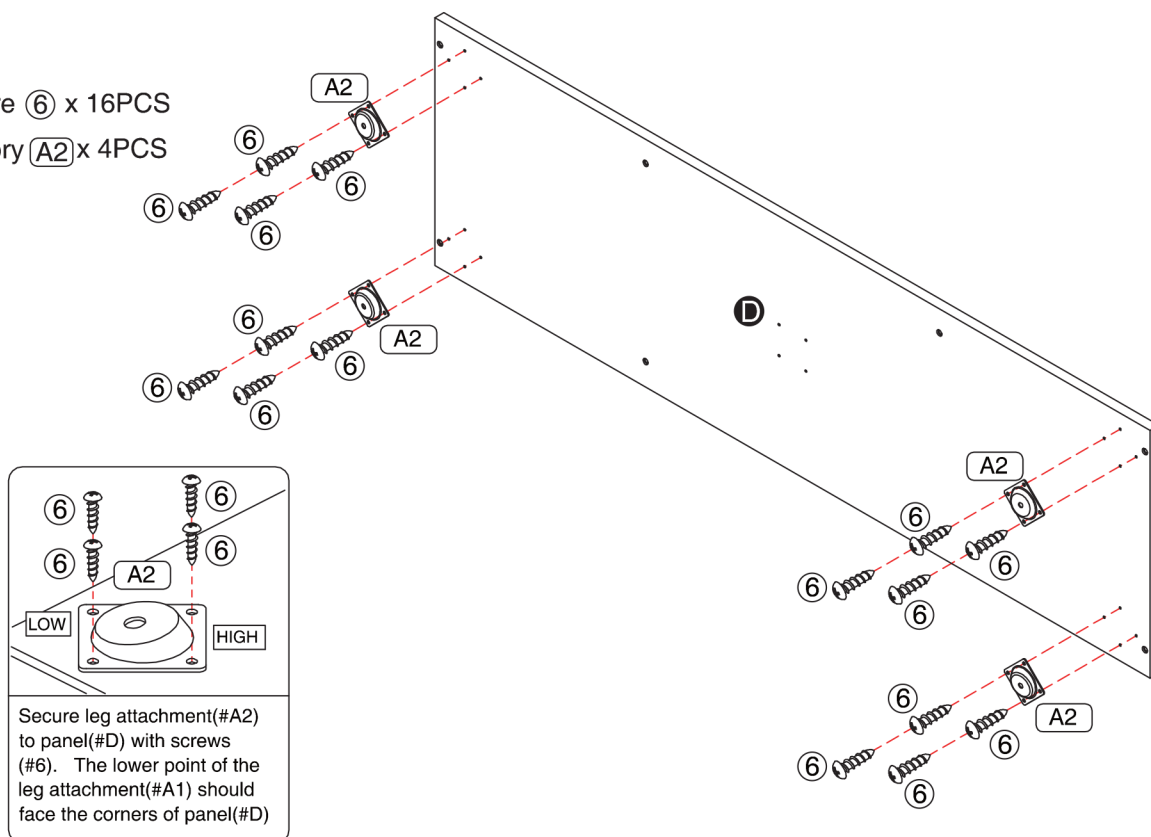

ASSEMBLY INSTRUCTIONS

4

Part **A** x1PC
 Part **L** x1PC
 Hardware **4** x 3PCS

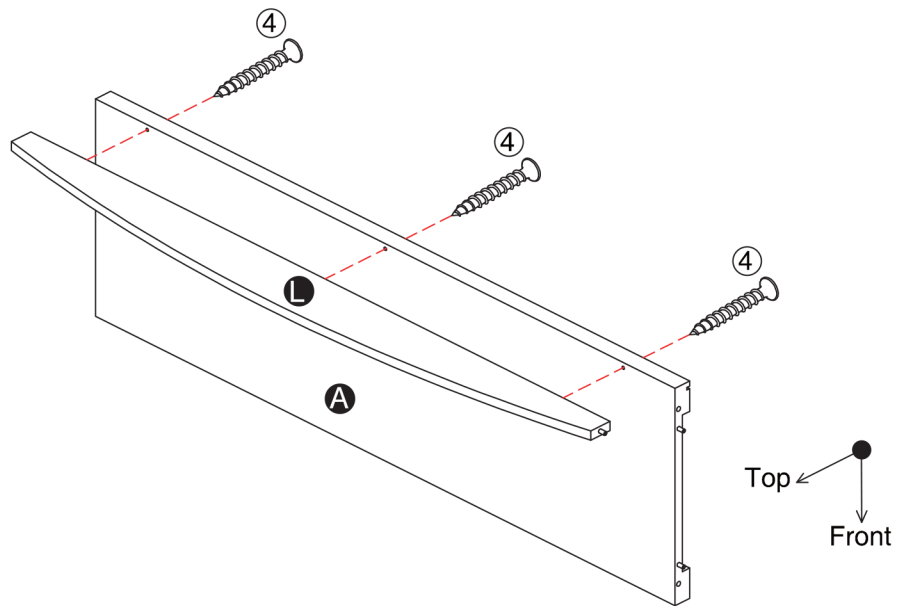

5

Part **G** x2PCS
 Part **H** x1PC
 Part **I** x1PC
 Hardware **2** x 4PCS

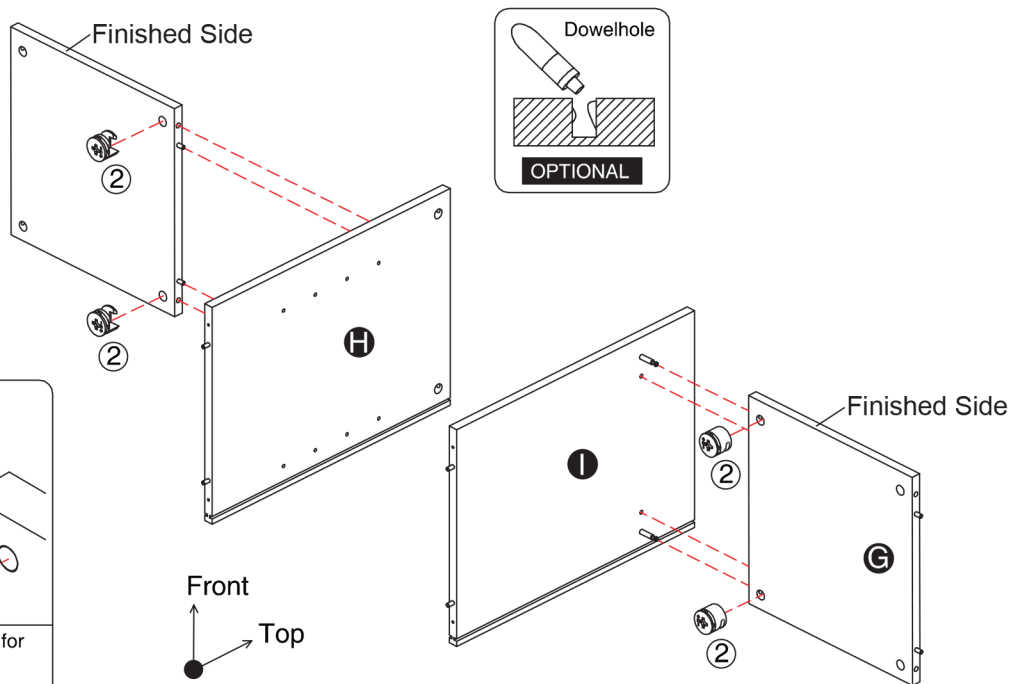
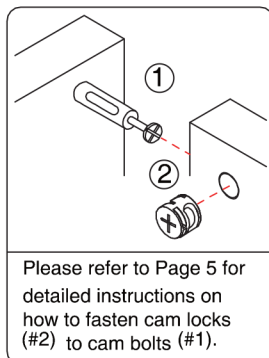

ASSEMBLY INSTRUCTIONS

6

Part **E** x1PC

Part **F** x4PCS

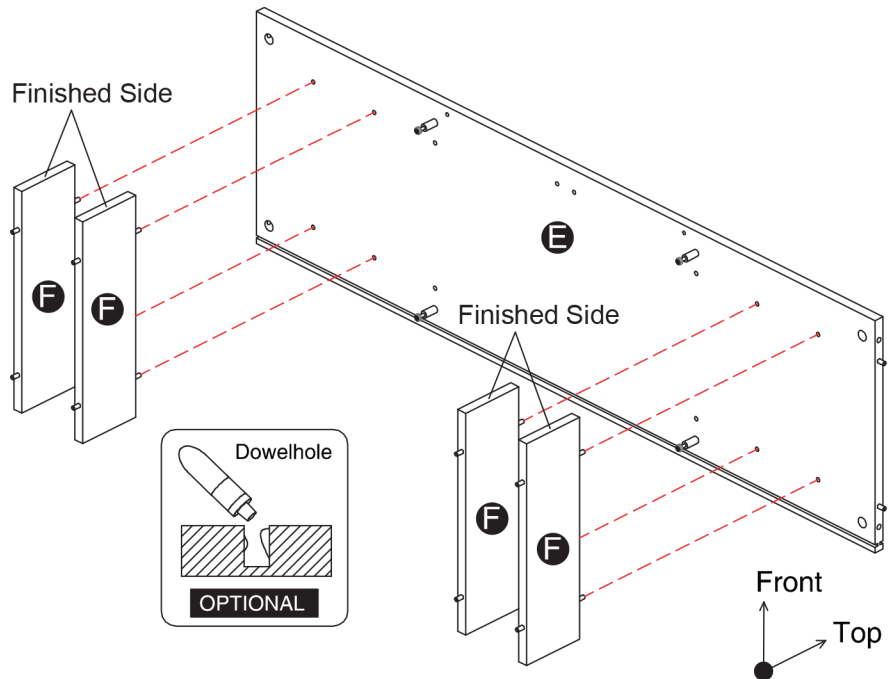

7

Hardware **2** x 4PCS

Accessory **A6** x 4PCS

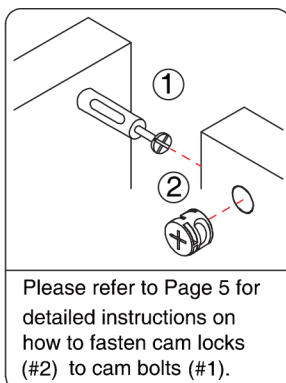

Please refer to Page 5 for detailed instructions on how to fasten cam locks (#2) to cam bolts (#1).

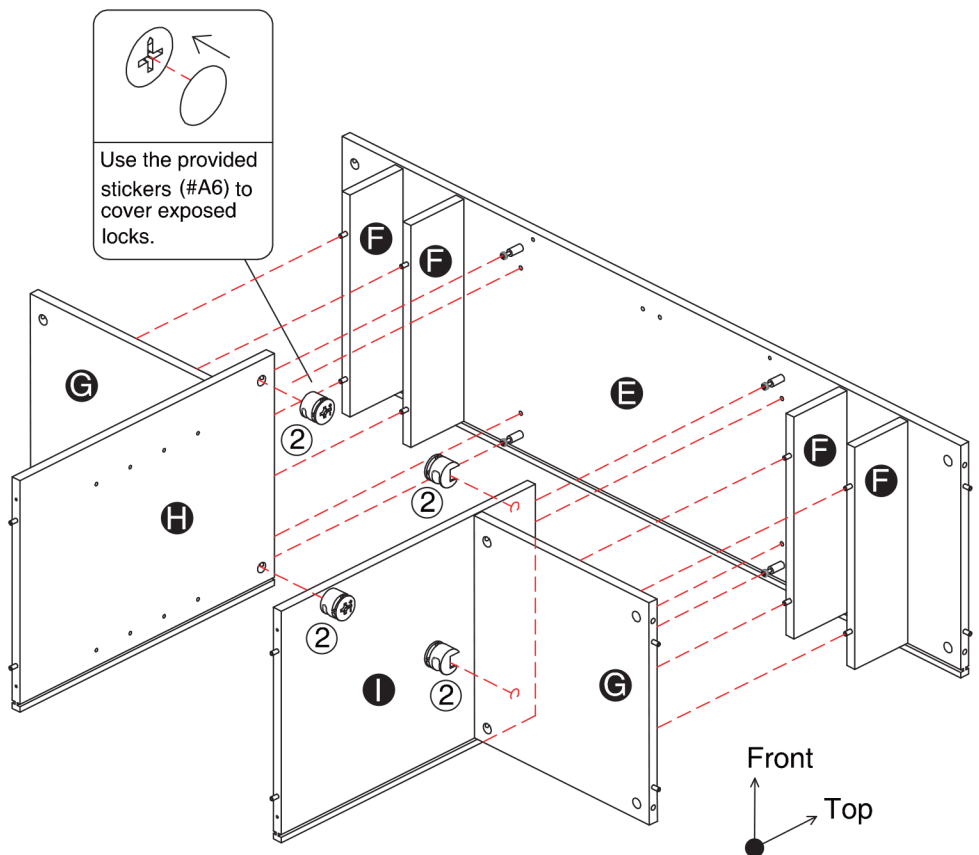

ASSEMBLY INSTRUCTIONS

8

Part **B** x1PC

Hardware **②** x 6PCS

Accessory **A15** x 1PC

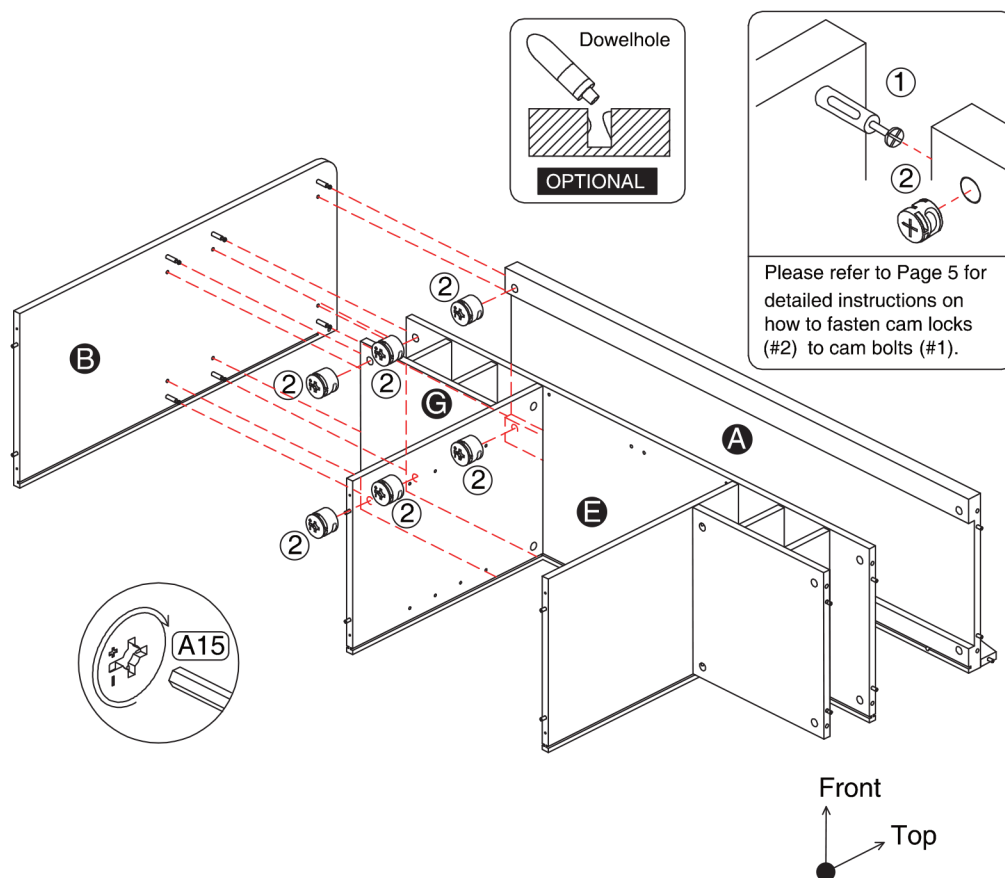

9

Part **M** x1PC

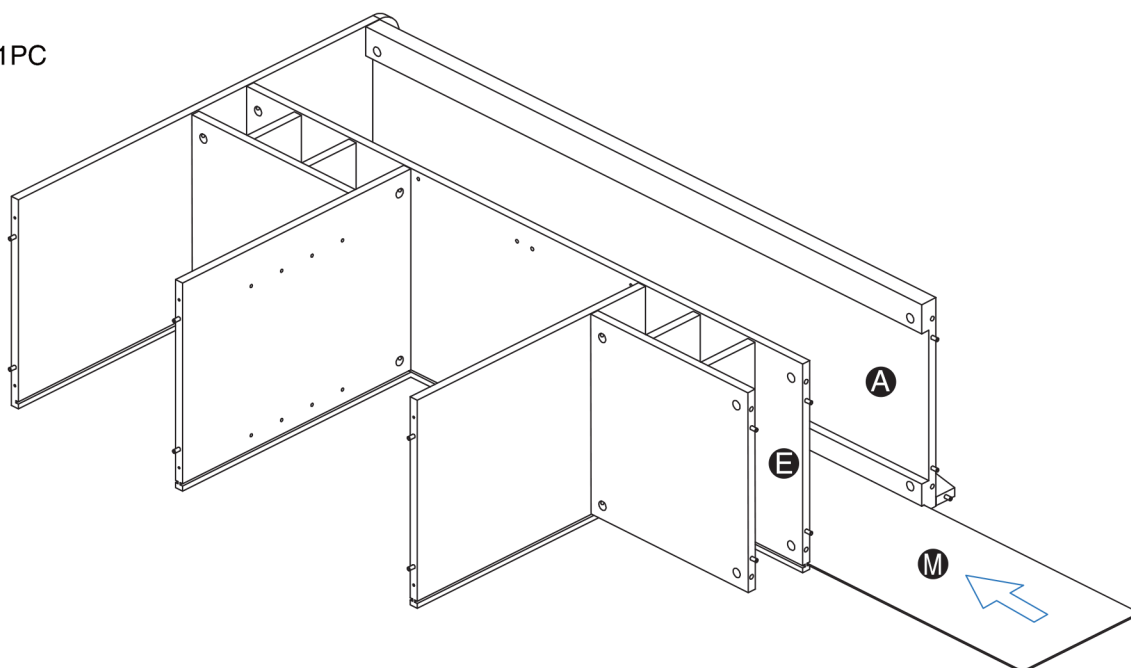

ASSEMBLY INSTRUCTIONS

10

Part **C** x1PC

Hardware **2** x 6PCS

Accessory **A15** x 1PC

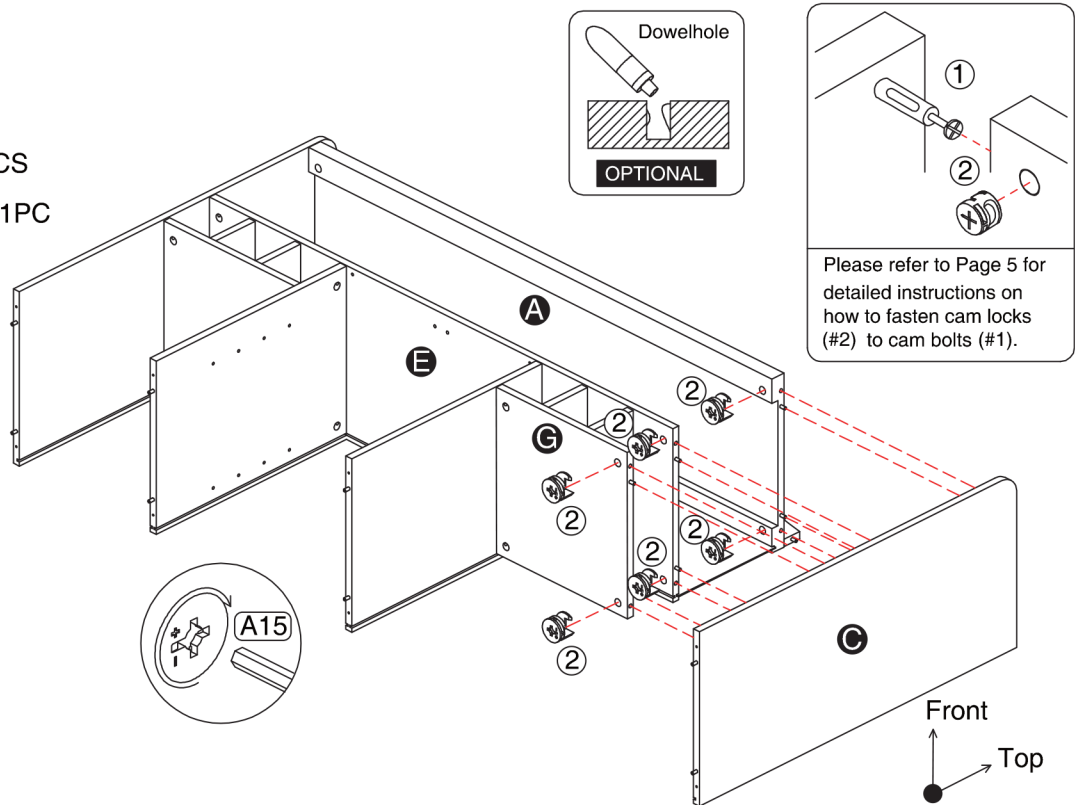

11

Part **N** x2PCS

Part **O** x2PCS

Hardware **12** x 1PC

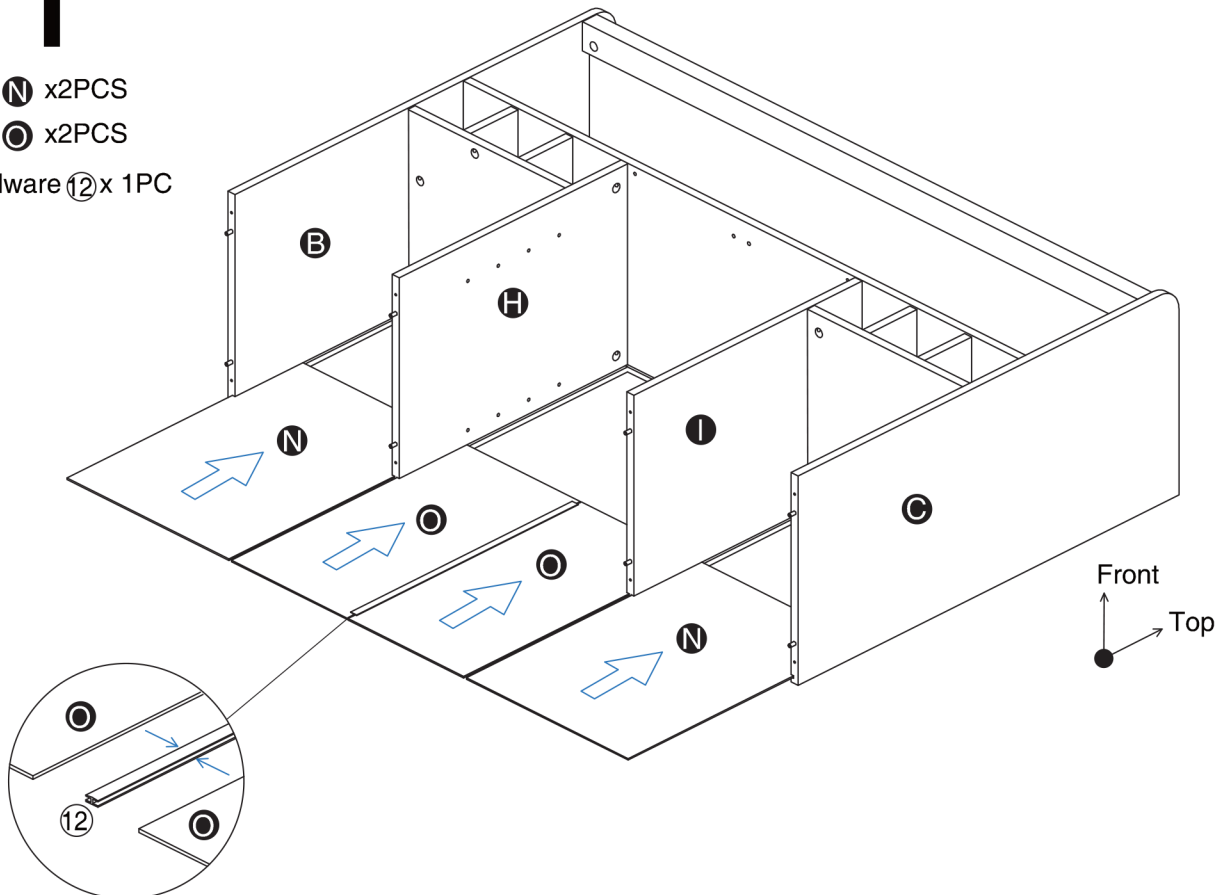

ASSEMBLY INSTRUCTIONS

12

Part **D** x1PC

Hardware **④** x 8PCS

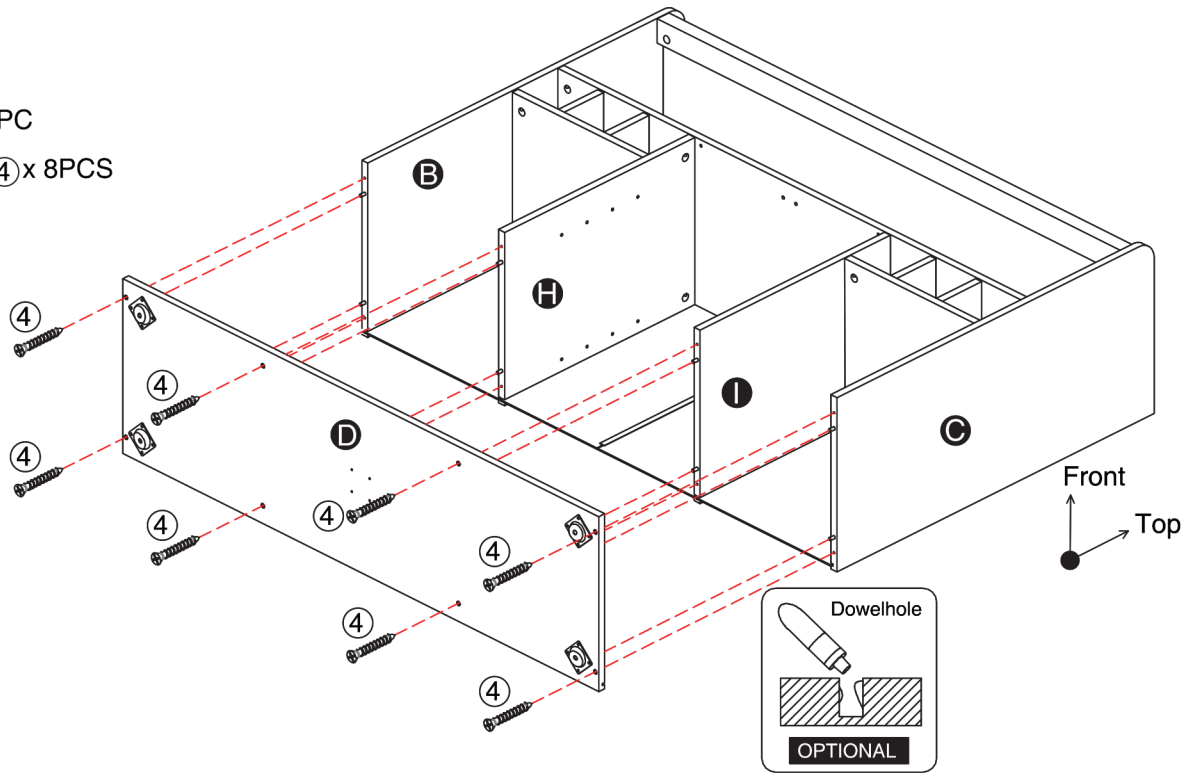

13

Hardware **⑥** x 4PCS

Accessory **A1** x 4PCS

Accessory **A3** x 1PC

Accessory **A4** x 1PC

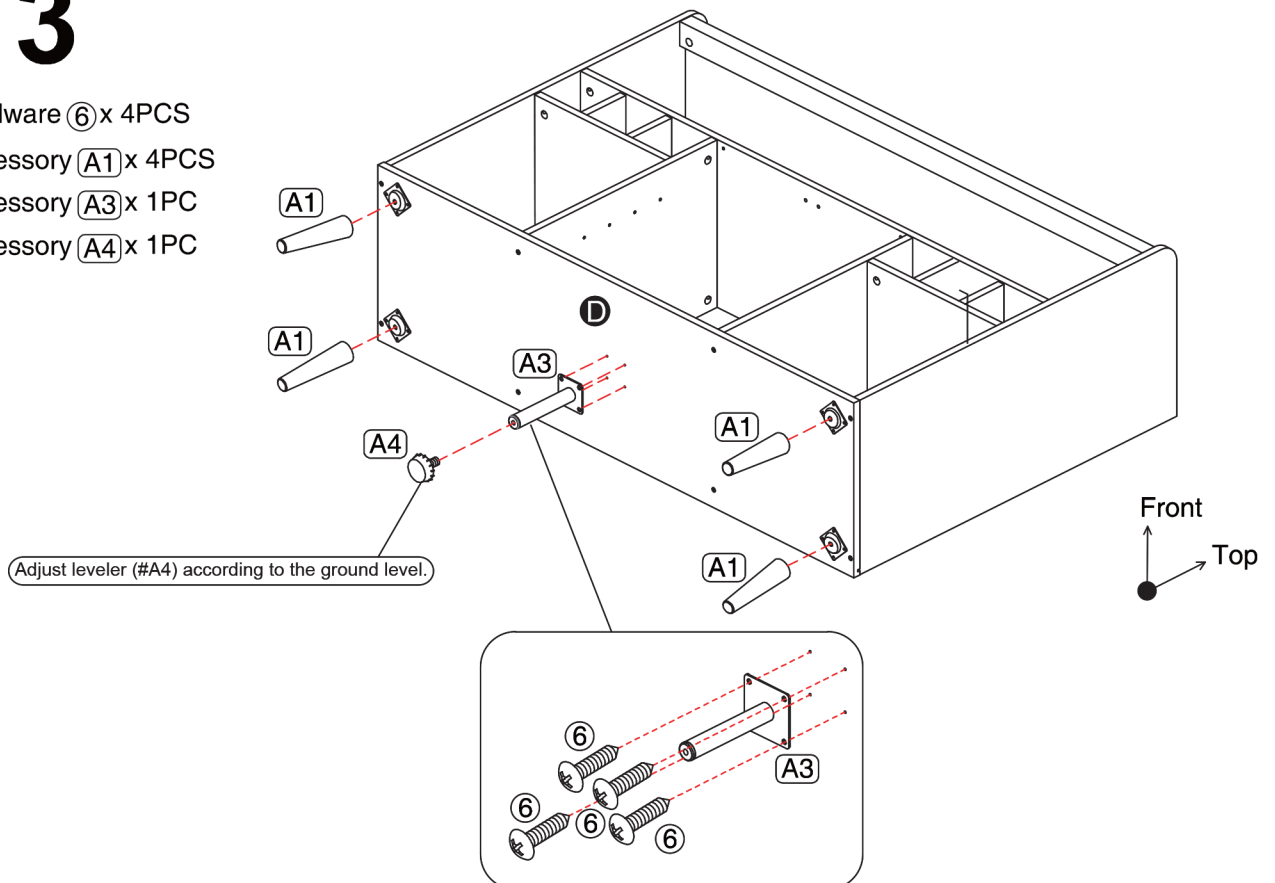

ASSEMBLY INSTRUCTIONS

14

Part **P** x1PC

Hardware **11** x 4PCS

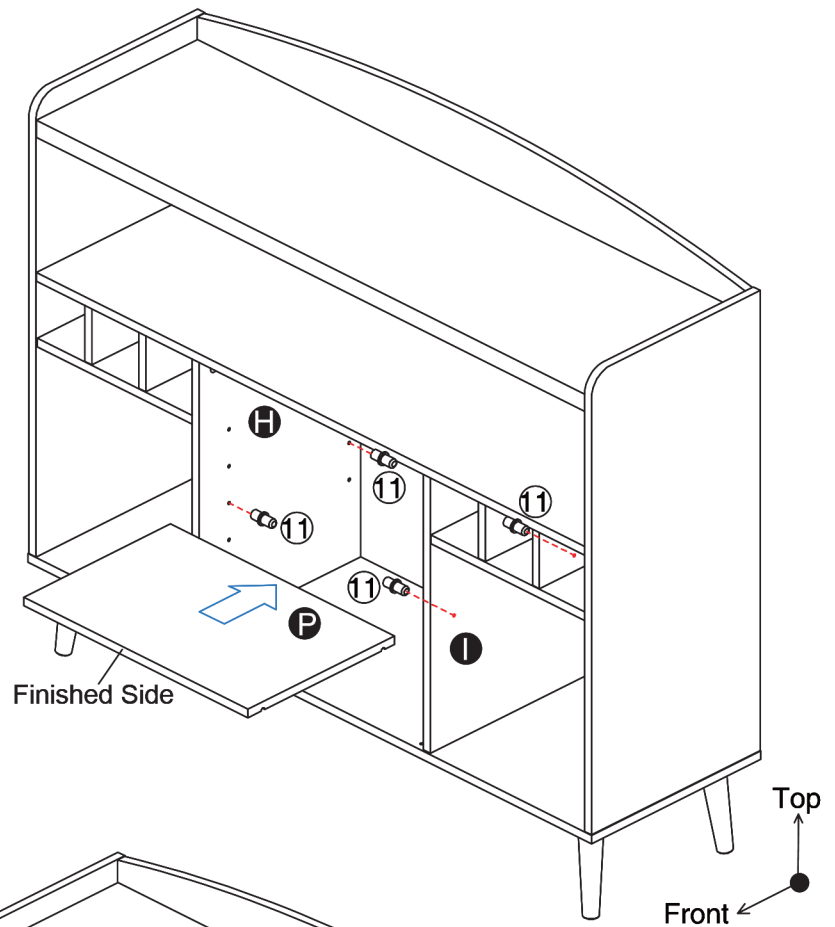
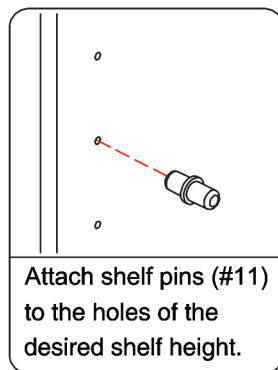

15

Hardware **7** x 1PC

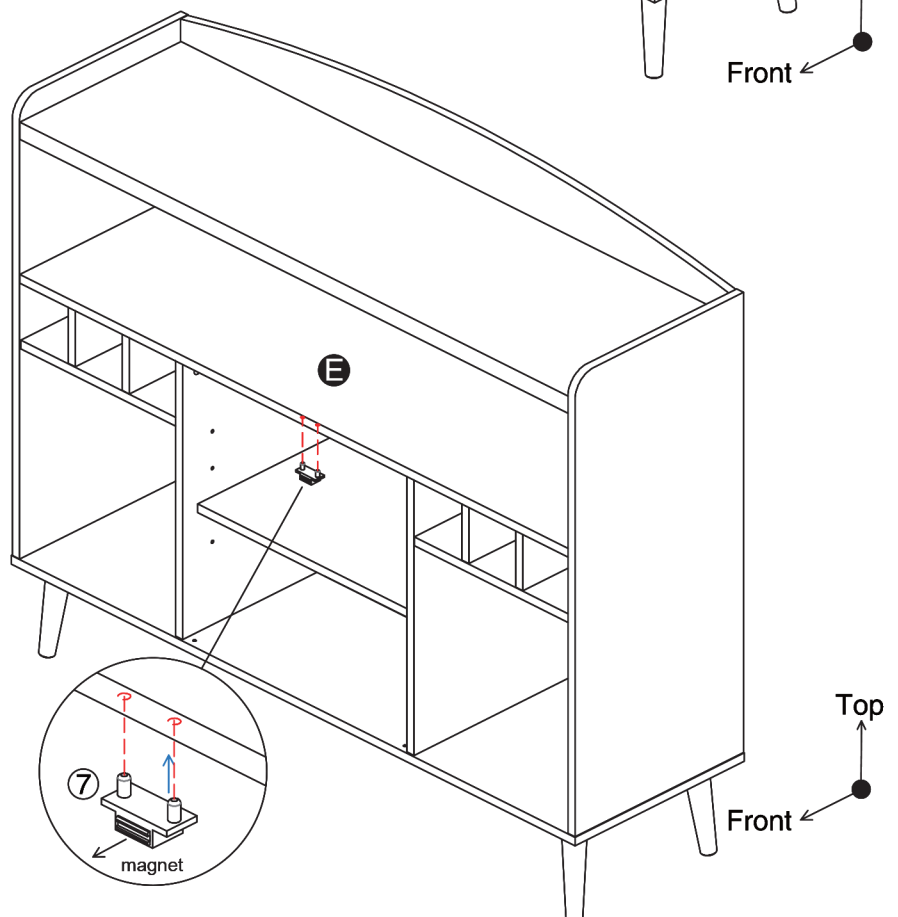

ASSEMBLY INSTRUCTIONS

16

Part **J** x1PC

Part **K** x1PC

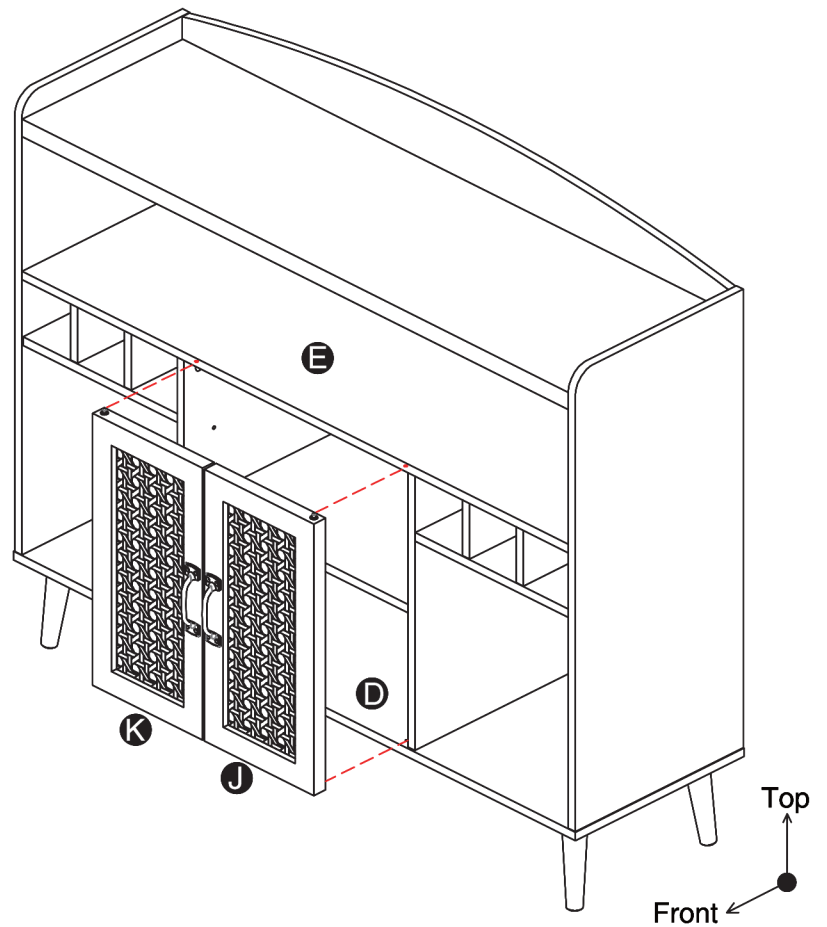
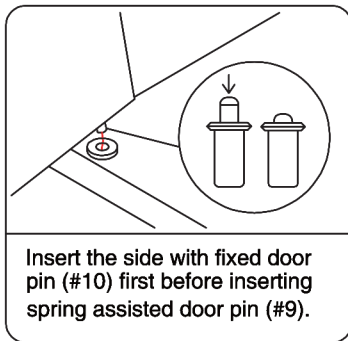

17

Accessory **A5** x 16SETS

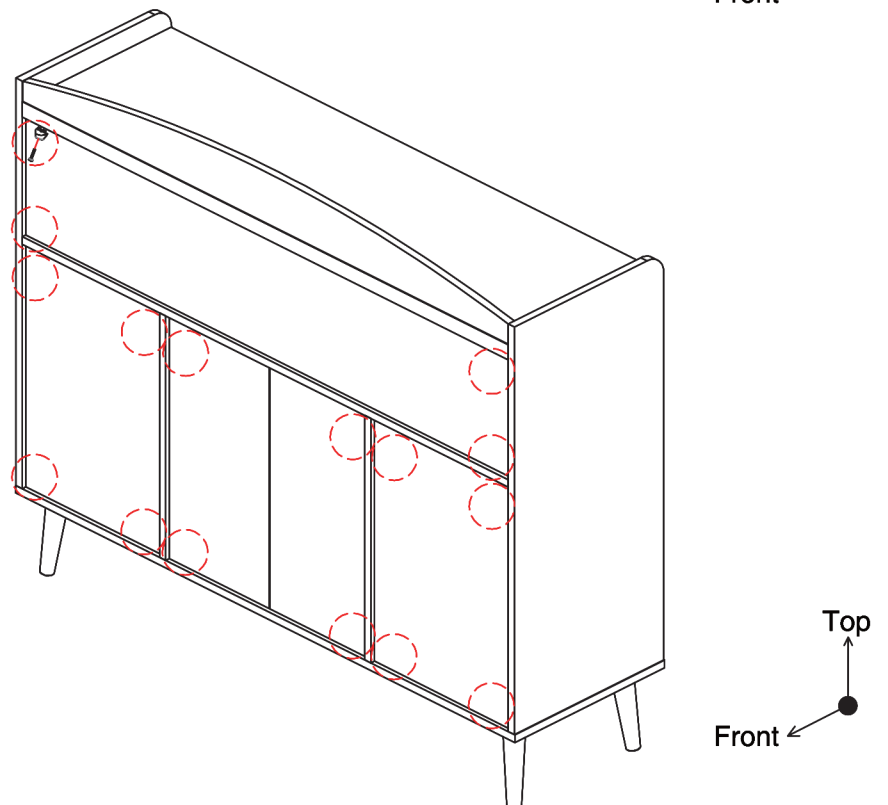
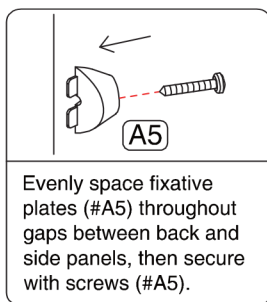

ASSEMBLY INSTRUCTIONS

18

- Accessory (A9) x 1PC
- Accessory (A10) x 1PC
- Accessory (A11) x 1PC
- Accessory (A12) x 1PC
- Accessory (A13) x 2PCS
- Accessory (A14) x 1PC

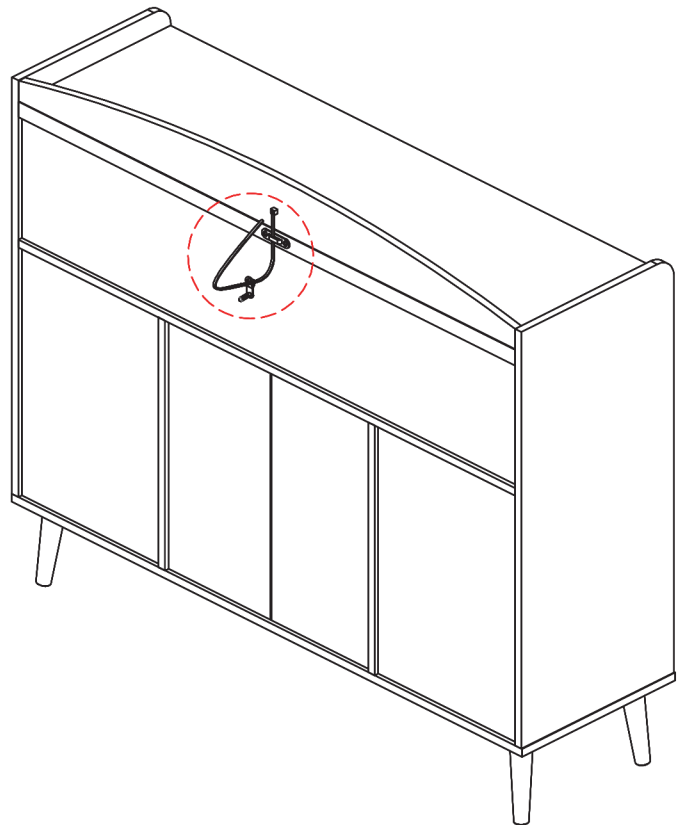
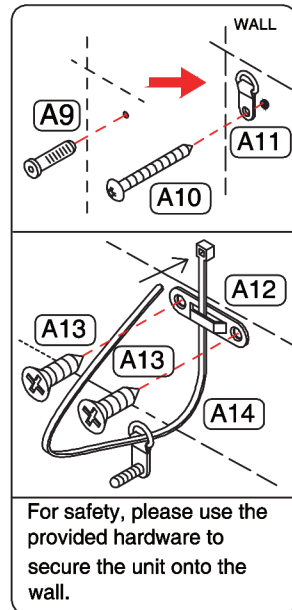

Top
Front

19

ASSEMBLY COMPLETED



Please ensure the furniture rests on an even and flat surface. If the product wobbles or feels loose, double-check all bolts and/or screws are properly tightened and secured.



Keep this handy!

Please retain this instruction manual and any order-related information for future reference.



Lift, don't drag!

To avoid damage to product please always LIFT the product when transporting or adjusting the placement.

